

1 mile

Fees
 Thomas G Smith one day
 viewings Pa \$1.00
 Andrew Darnon
 viewing and returning
 the same Pa \$2.00
 John Floyde
 Chain Carrying and
 qualifying reviews Pd 5 00
 William Neptune
 Chain Carrier Pd 75
 Josephus Bishop
 Mara Paid 75
 Paid 5.50

Fees
 1 Day surveying 1.50
 1 do Platting 1.50
 Paid \$3.00
 5.50
 8.50

I do certify that the above plat is a
 correct representation of the above
 described road as surveyed agreeably
 to the direction of Thomas G Smith and
 Andrew Darnon Viewers appointed by the
 Commissioners of Belmont County Ohio
 Asa Garretson Surveyor



Plan of the road leading from the Mill of Moses Davis passing the residence of William Hodgins and intersecting the road leading from the Town of Somerton to the Town of St. Clairville at the Bridge near the Fan Yard of Hugh Woodmass as surveyed on the 21st of the 12th Month (December) 1843 Length 1 Mile and 155 perches Beginning 2 perches North 55 West of the N W corner of said Mill running thence

| | | | | Perches |
|----|---|----------|------------|---------|
| 1 | S | 18 W | 21 | |
| 2 | S | 83 W | 18 | |
| 3 | S | 65 W | 19 | |
| 4 | S | 68 W | 16 | |
| 5 | N | 75 W | 13 | |
| 6 | W | | 57 | |
| 7 | N | 62 W | 20 | |
| 8 | S | 70 W | 22 | |
| 9 | S | 63 W | 11 | |
| 10 | S | 66 W | 17 | |
| 11 | S | 73 W | 7 | |
| 12 | S | 46 W | 11 | |
| 13 | N | 71 W | 25 | |
| 14 | N | 57 W | 15 | |
| 15 | N | 41 W | 34 | |
| 16 | N | 34 W | 11 | |
| 17 | N | 21 W | 20 | |
| 18 | N | 17 W | 15 | |
| 19 | N | 40 W | 11 | |
| 20 | N | 70 W | 25 | |
| 21 | S | 86 W | 46 | |
| 22 | N | 70 W | 12 | |
| 23 | S | 52 1/2 W | 12 | |
| 24 | N | 70 W | 6 | |
| 25 | N | 40 W | 11 | |
| | | | <u>475</u> | |

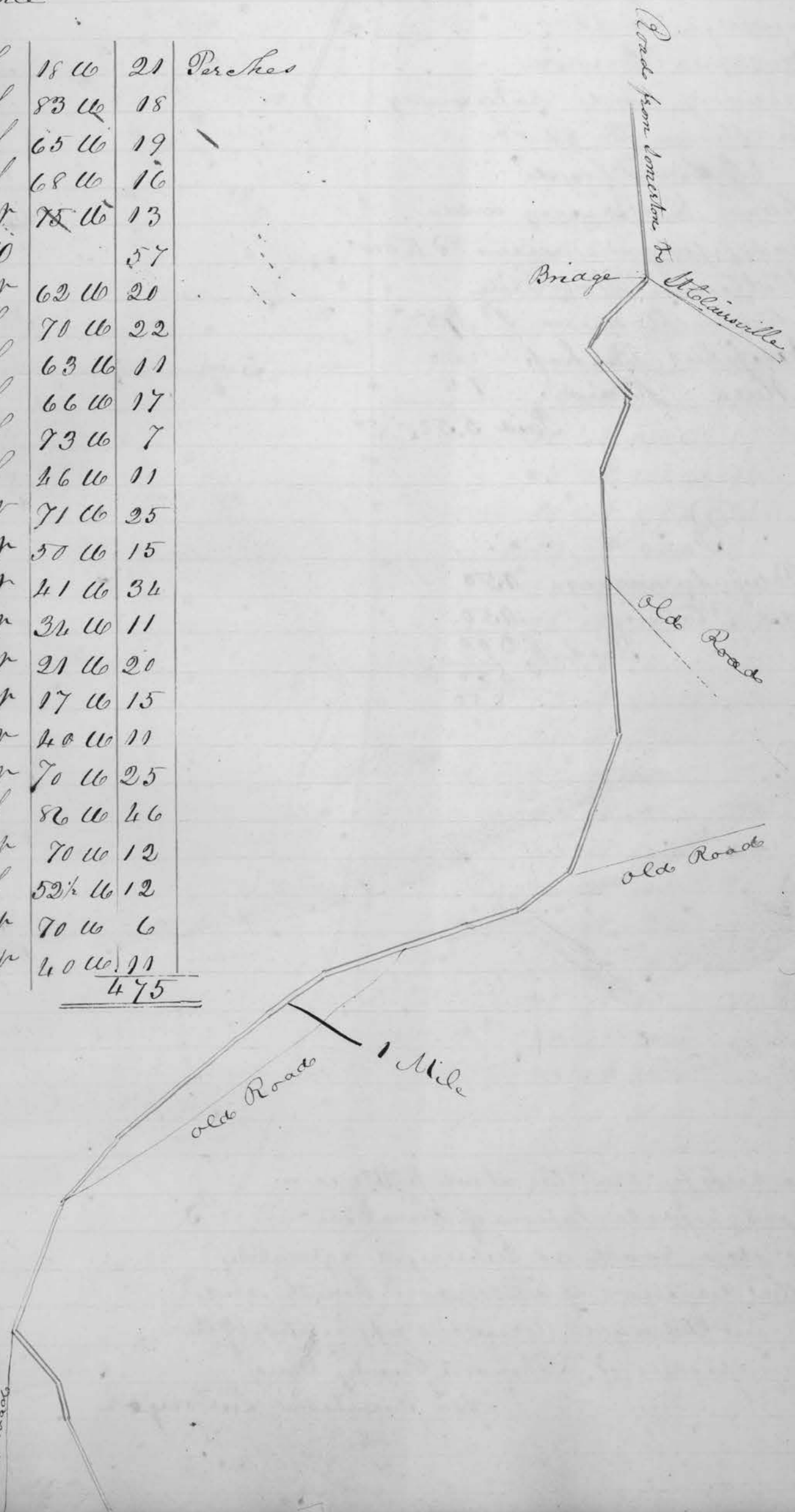

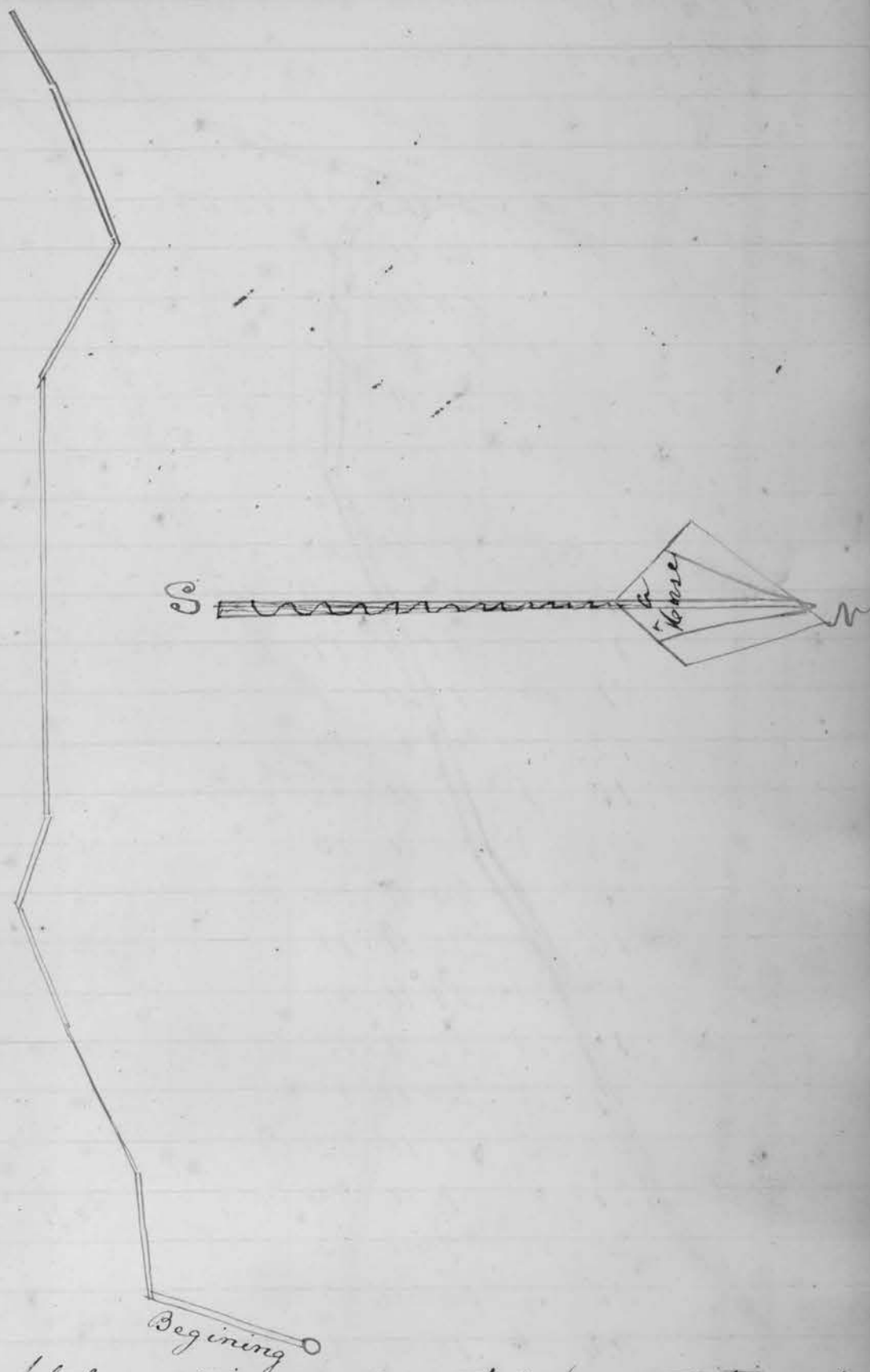

Fees
 1 Day Surveying 1.50
 1 Do Plotting 1.50
 Paid \$3.00

I do Certify that the above plat contains a correct representation of the above described road as surveyed agreeably to the direction of Rufus W Barnes Enoch Stanton and David Brock Viewers appointed by the Commissioners of Belmont County Ohio
 Asa Barrettson Surveyor

373

Plot shewing the course and distances of a County Road in Somerset Township Belmont County Ohio as surveyed the 8th of March 1844. Beginning in the middle of the road leading from McKennys to Marietta South 66° East 2 Perch $\frac{88}{100}$ from the S.E. corner of R English's Black Smith Shop and running thence

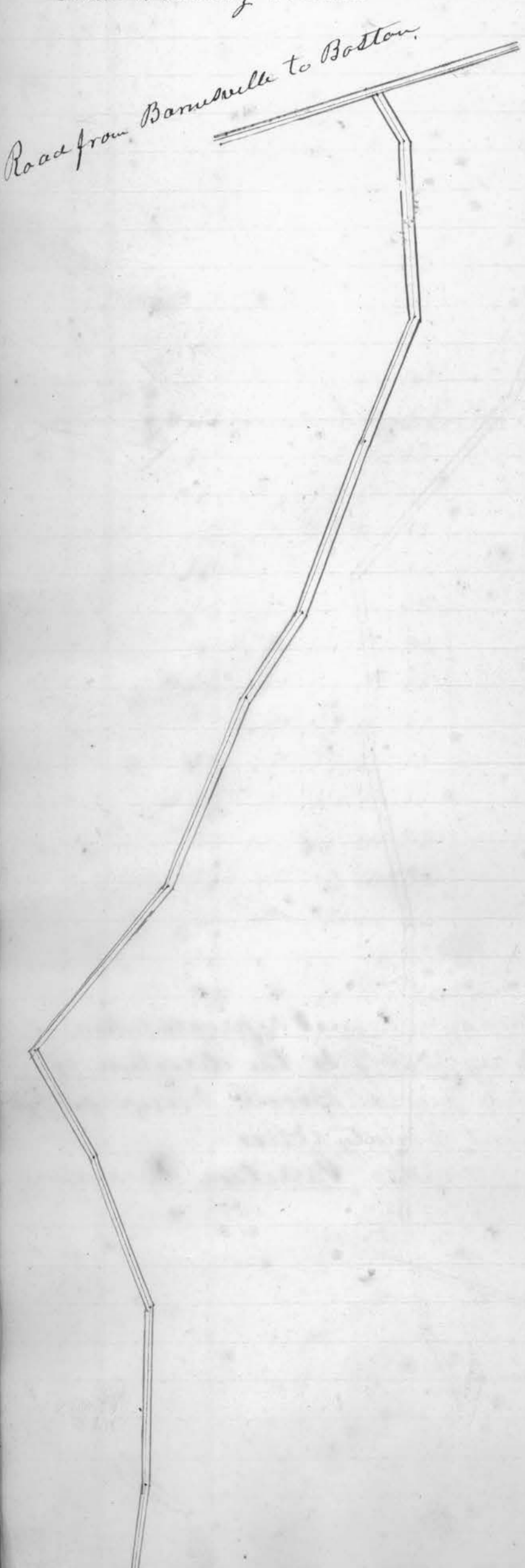

| | | | |
|--------|-------|-----------|-------------|
| | South | 85° E | 17 Perches. |
| Thence | S | 45 1/2° E | 20 " |
| " | S | 84° E | 8 " |
| " | S | 76 1/2° E | 20 " |
| " | S | 62° E | 20 " |
| " | S | 65° E | 25 " |
| " | S | 67° E | 14 " |
| " | S | 53° E | 13 " |
| " | S | 40° E | 14 " |
| " | S | 29° E | 18 " |
| " | North | 81° E | 20 " |
| " | S | 80 1/2° E | 10 " |
| " | S | 68 1/2° E | 6 " |
| " | S | 72 1/2° E | 26 " |
| " | N | 89° E | 20 " |
| " | N | 82° E | 13 " |
| " | S | 47 1/2° E | 10 " |
| " | S | 62 1/2° E | 16 " |
| " | S | 73° E | 42 " |
| " | S | 59° E | 24 " |
| " | S | 75° E | 10 " |
| " | S | 61 1/2° E | 14 " |
| " | N | 68 1/2° E | 14 " |
| " | N | 66 1/4° E | 19 " |
| " | N | 88 1/2° E | 22 " |
| " | S | 84 1/2° E | 25 " |
| " | N | 64 1/2° E | 32 " |
| " | S | 82° E | 26 " |
| " | S | 59° E | 12 " |
| " | S | 64° E | 24 " |
| " | S | 86 1/4° E | 22 " |
| " | N | 84° E | 16 " |
| " | S | 29 1/2° E | 14 " |
| " | S | 23° E | 18 " |
| " | S | 42° E | 28 " |
| " | S | 3 1/2° E | 14 " |
| " | S | 42 1/2° E | 10 " |
| " | S | 48° E | 15 " |
| " | S | 43° E | 18 " |
| " | S | 68 1/2° E | 24 " |
| " | N | 85° E | 7 " |

To the road leading from

Danversville to Boston
being a distance of
2 miles & 100 perches

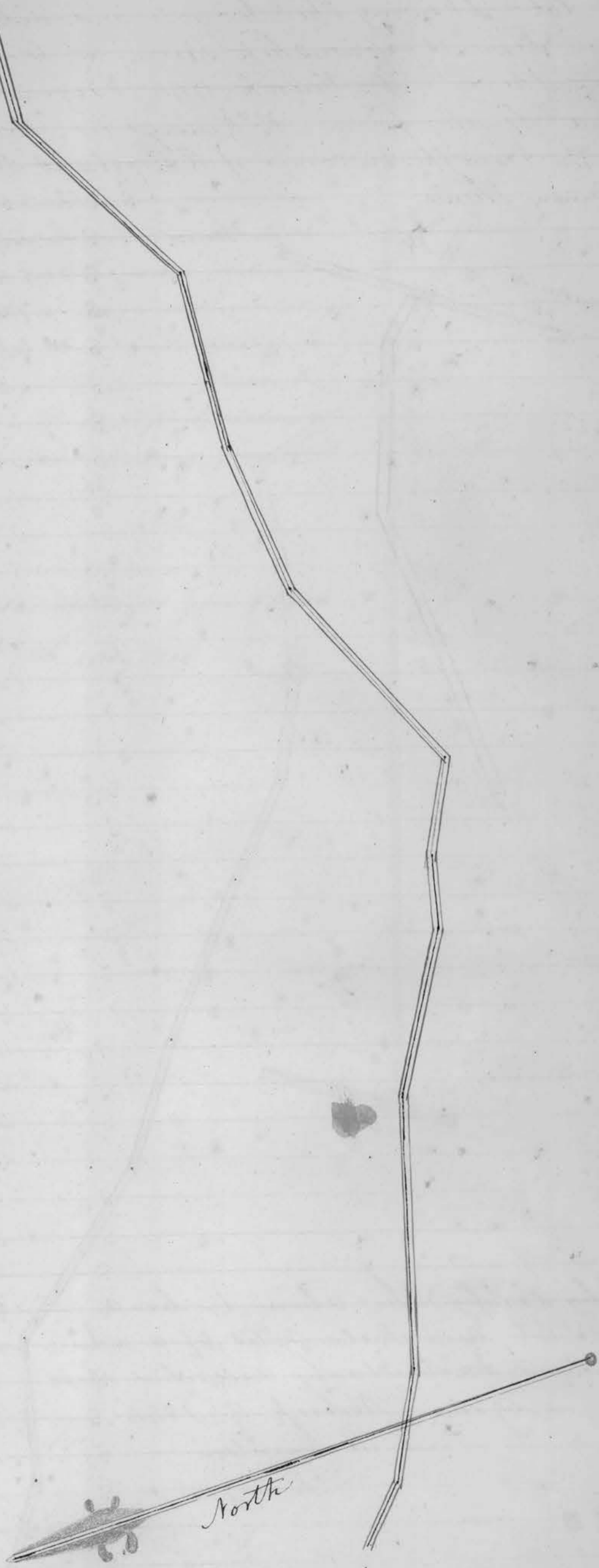

325

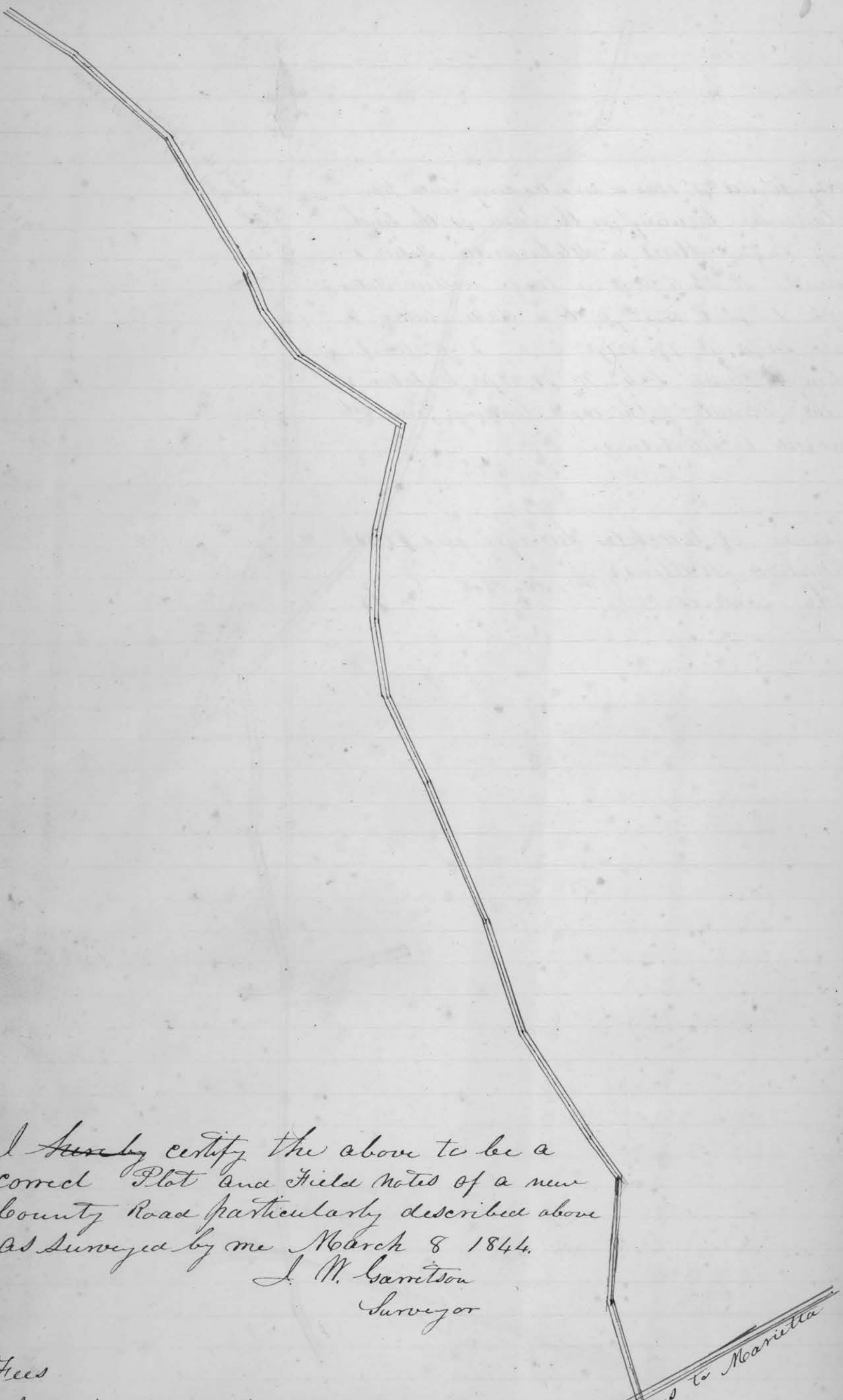

I ~~hereby~~ certify the above to be a correct Plot and Field Notes of a new County Road particularly described above as surveyed by me March 8 1844.
 J. M. Garrison
 Surveyor

Fees

Surveying 1 day 1.50
 Platting 1 day 1.50
 \$3.00

Beginning
 Road from McKinney to Manila

Survey August 28. 1844 a road leading South from
 St. Clairsville beginning for the same at the south
 End of Sugar Street in St. Clairsville. Station 1
 thence S 2° N. 23.6 ps to a large willow Station 2
 thence S 2 3/4° E 15.52 ps to a Stake Station 3
 thence S 1 3/4° W. 77.42 ps to a B Walnut
 Station 4 thence S 4° W. 31.28 ps to Station 5
 in the Middle of the road leading from St. C
 Clairsville to Jacobsburg.

Casper N Luckles-Surveyor fees \$1.50
 Ambrose Collins } ch. 1 day each } " 75
 Eli Davis } " " " } " 75

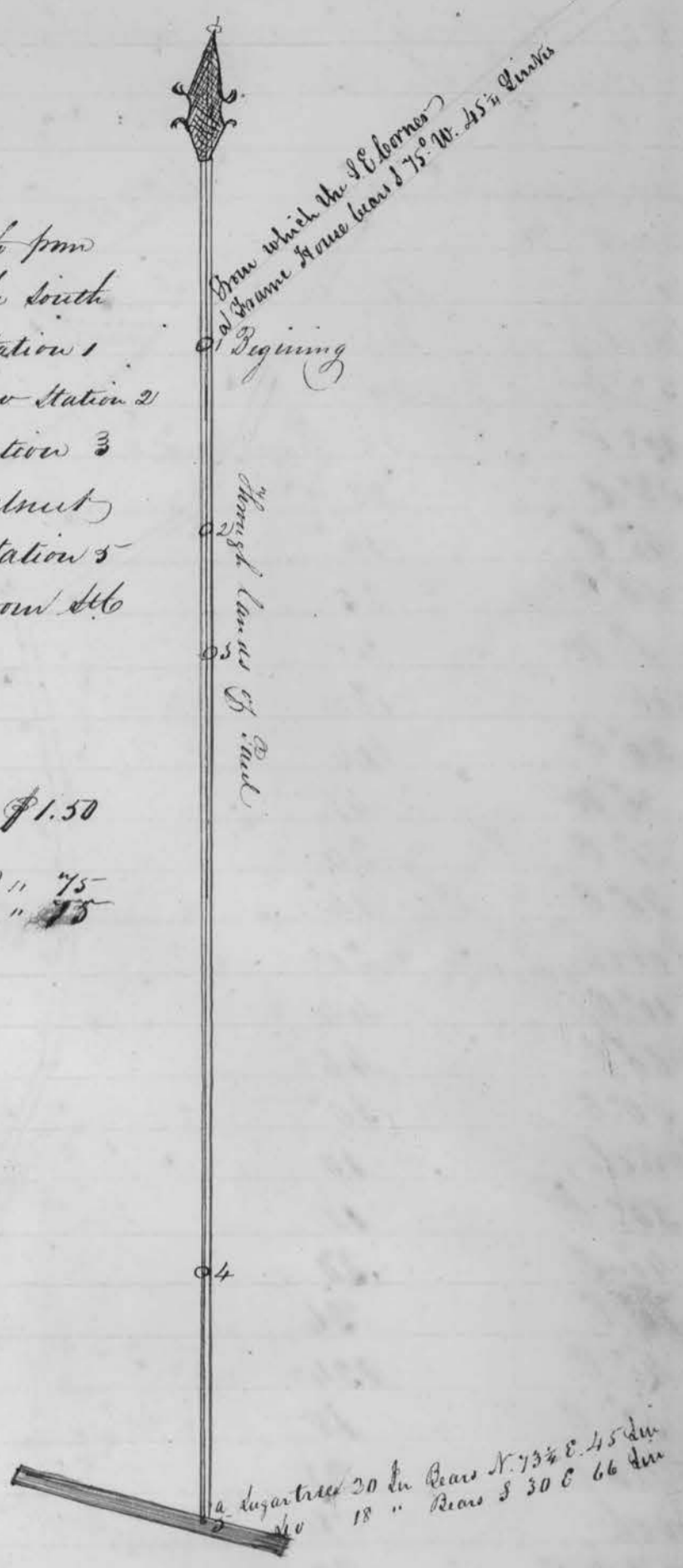

321

North

County road leading from J. H. Green's to Narrows
run on the Ohio River.

Beginning & running as follows

| | |
|----------|---------------|
| S. 30° E | 57 Poles |
| South | 10 .. |
| S 5° W | 34 |
| S 40° E | 56 Grave Yard |
| S 33° E | 28 |
| S 45° E | 56 |
| S 50° E | 24 |
| S 5° W | 48 |
| East | 102 |
| S 20° E | 116 |
| S 30° W | 48 |
| S 20° E | 24 |
| S 30° E | 14 |
| North | 20 |
| S 10° E | 44 |
| S 60° E | 46 |
| S 30° E | 30 |
| South | 10 |
| S 50° E | 12 |
| S 40° E | 30 |
| S 70° E | 36 |
| S 40° E | 124 |
| S 50° E | 18 |
| N. 30° E | 28 |
| North | 8 |
| N. 30° E | 32. |

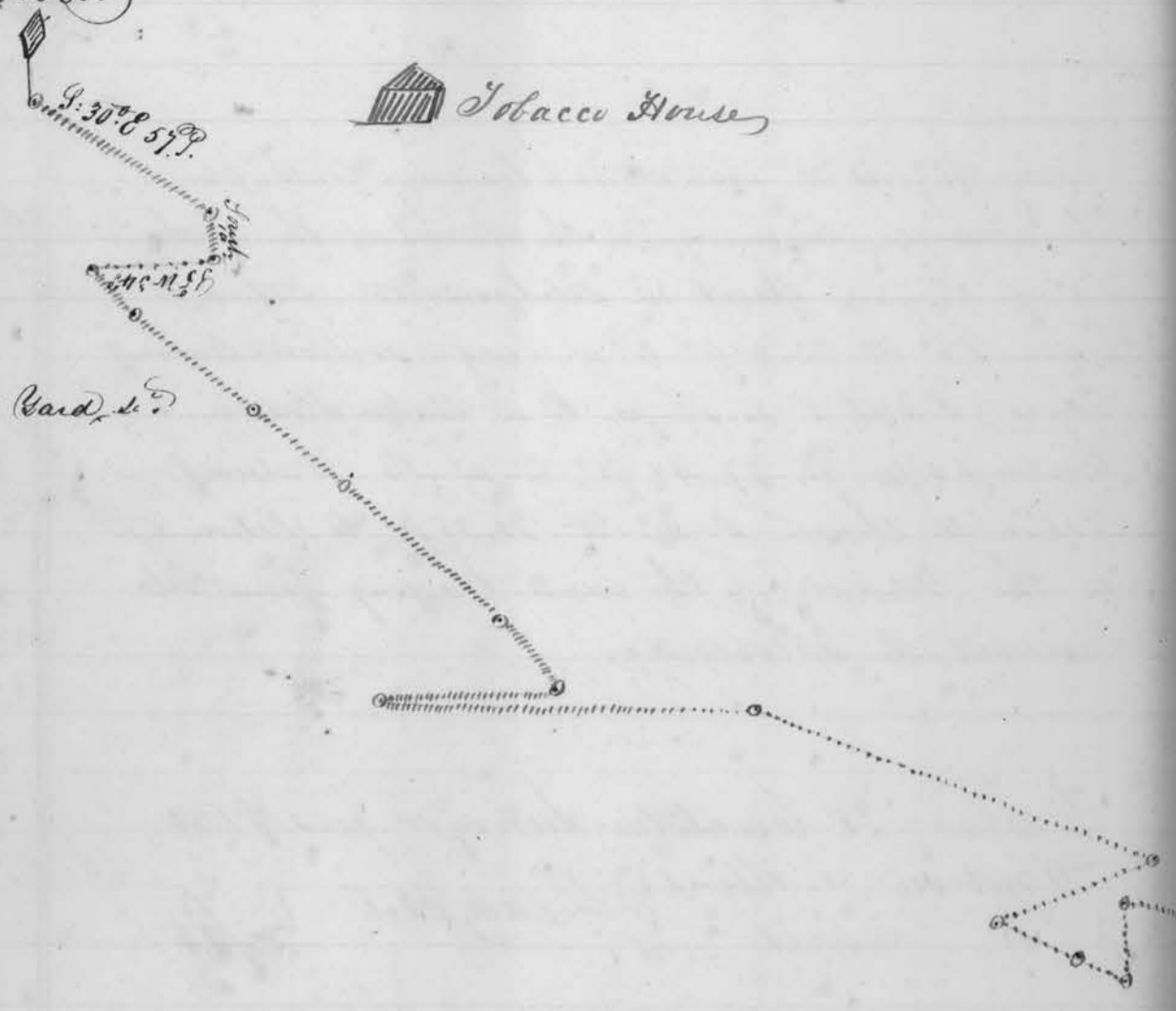

To the river road being 1055 perches in distance.

The above road runs agreeably to the petition of the citizens and land holders of North Township Belmont County Ohio.

J. H. Green (Running as previously)

By Gunter's scale 50 perches to the Inch

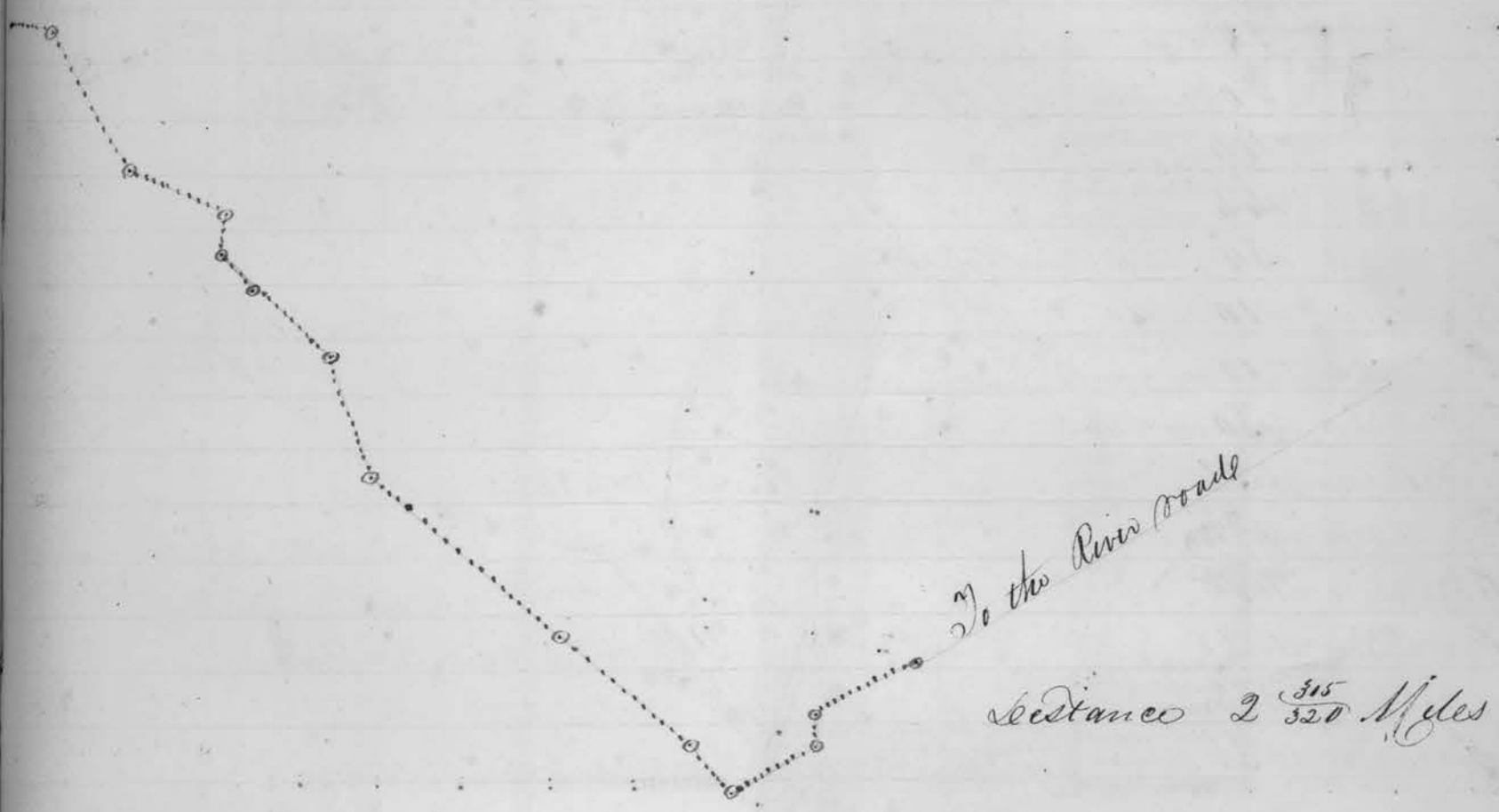

(viewed)

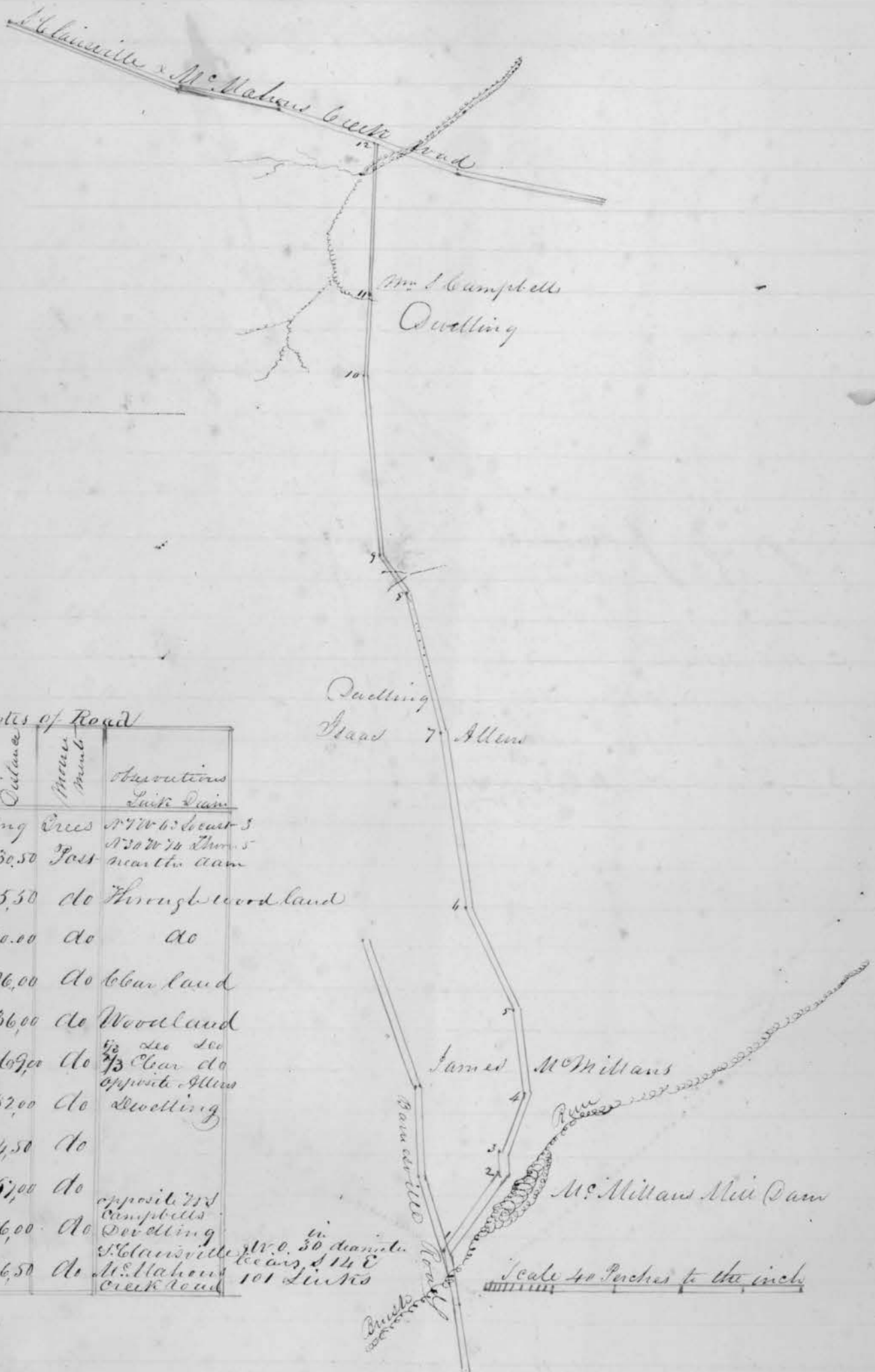

Field notes of Road

| No | Bearing | Distance | Notes | Observations |
|----|---------------|----------|-------|---|
| 1 | Bearing Creek | | | N 77 W 65 feet 3 |
| 2 | S 56 E | 30.50 | Post | N 20 W 74 1/2 Thms 5 near the dam |
| 3 | S 89 E | 5.50 | do | Through wood land |
| 4 | S 65 E | 20.00 | do | do |
| 5 | N 2 E | 26.00 | do | Clear land |
| 6 | N 64 E | 36.00 | do | Woodland |
| 7 | N 81 E | 107.00 | do | Clear do opposite Allens |
| 8 | N 73 E | 52.00 | do | Dwelling |
| 9 | N 33 E | 14.50 | do | |
| 10 | N 86 E | 57.00 | do | opposite Mrs Campbells Dwelling |
| 11 | S 85 E | 26.00 | do | |
| 12 | S 88 E | 46.50 | do | S. Glauville N. 0. 30 diam. near S 11 E 101 Links McMahons Creek land |

Map of a County Road located between the points thereon designated with the bearing distance given in the above table. Surveyed March 6th A.D. 1845
 Andrew W. Anderson }
 John Scott } Chainmen
 Charles Sechass }
 Surveyor Belmont Co. Ohio

| No. | Bearing | Distance | Monuments | Observations |
|-----|--------------|----------|-----------|---------------------------------------|
| 1 | Placing line | | | Juste Olin \$45.00 21. 100. 17 |
| 2 | S 16° E. | 25.00 | Stumps | Poplar through Lances Cremat. Hay |
| 3 | S 2 1/2° W | 10.50 | Post | SW |
| 4 | S 32° E | 18.65 | Ch | At NW corner bearing SW |
| 5 | S 69° E | 20.20 | Ch | to Tobacco House S 25° W. 70 links |



Jacob Keifer }
Christian Craft } chairmen

Scale 20 ft to the inch

Plat of the attuation of a county road between the points thereon designated, with the bearings and distance given in the above table. The new location was ascertained by measurement to be 17 poles shorter than the former.

Surveyed March 13th A.D. 1845.

Charles Dehass
Surveyor Putnam Co. Ind.

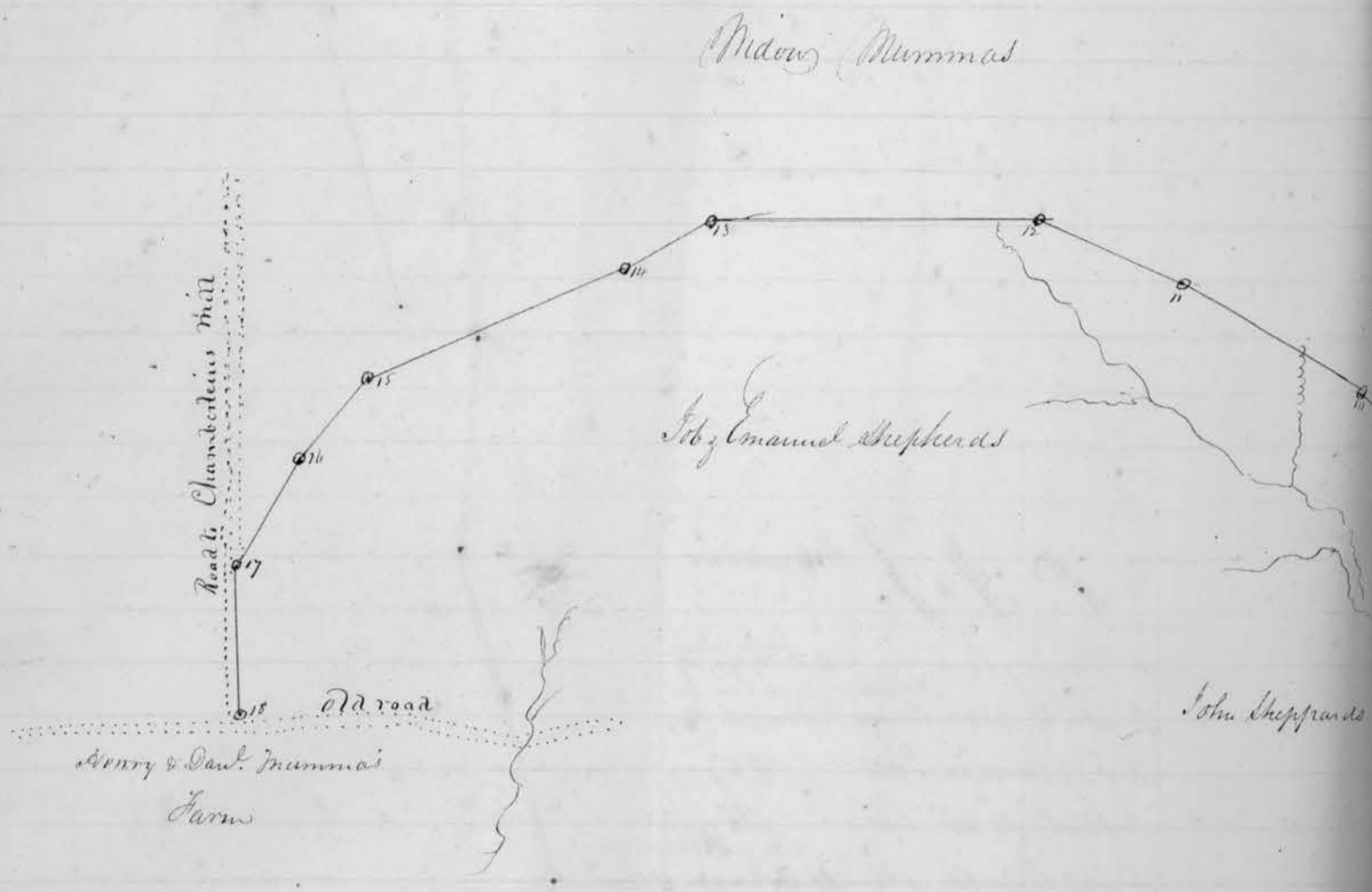

| No | Bearing | Distance | monument |
|----|-------------------------|----------|----------|
| 1 | N 26 1/2 W | 53.00 | Post |
| 2 | N 3 1/2 W | 40.80 | do |
| 3 | N 6 W | 8.20 | do |
| 4 | N 61 W | 34.00 | do |
| 5 | N 59 1/2 W | 41.70 | do |
| 6 | N 52 W | 37.10 | W. C. |
| 7 | N 51 W | 20.80 | Post |
| 8 | N 20 W | 6.00 | do |
| 9 | N 64 1/2 W | 20.00 | do |
| 10 | N 57 1/2 W | 38.00 | do |
| 11 | N 59 1/2 W | 28.00 | do |
| 12 | West | 57.50 | do |
| 13 | S 5 1/2 W | 17.25 | do |
| 14 | S 67 W | 50.00 | do |
| 15 | S 42 W | 21.00 | do |
| 16 | S 26 W | 20.24 | do |
| 17 | S E | 25.70 | |
| 18 | Post in Lewisville Road | | |
| | | 519.29 | |

Paid Charles Dehaas Surveyor 2 days
 Amos Moore Chainman 1 "
 Tho' J. Grondels do 1 "
 John Major, Witness 1 "



Philip Ward

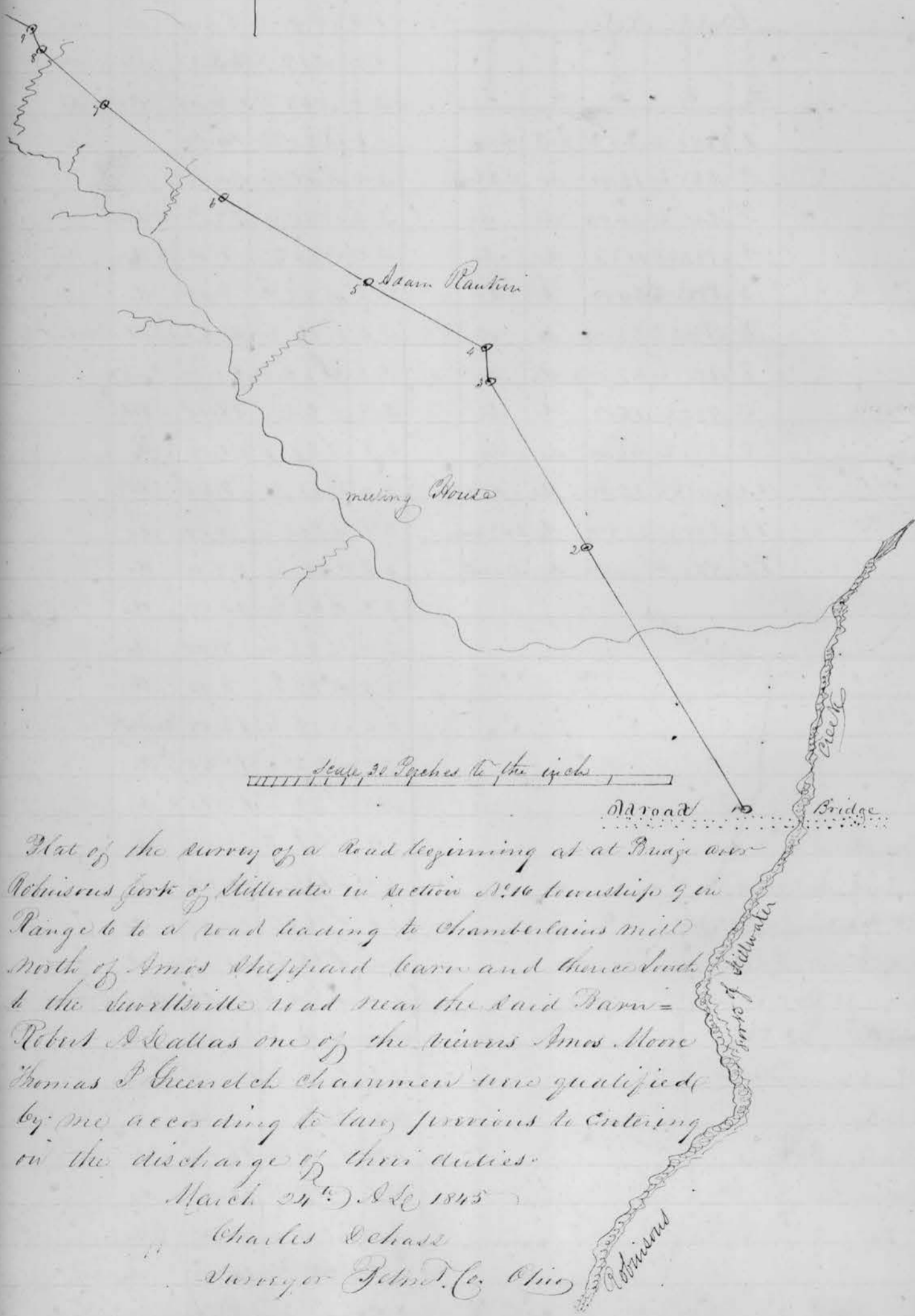

That of the survey of a Road beginning at at Bridge over Robinsons ford of Millwater in section N. 16 township 9 in Range 6 to a road leading to Chamberlains mill north of Amos Sheppard barn and thence south to the Swarthwille road near the said Barn = Robert A. Scallas one of the jurors Amos Moore Thomas J. Greenetck chambermen were qualified by me according to law previous to entering on the discharge of their duties.

March 24th A. D. 1843

Charles Dehass
Surveyor Genl. Co. Ohio

Old road Bridge

Robinson
some of Millwater

333 Plat of ~~the~~ alteration of the State Road leading from Fanesville to the Flats of Grave Creek; and commencing for the same at the County line and terminating West of Barnesville

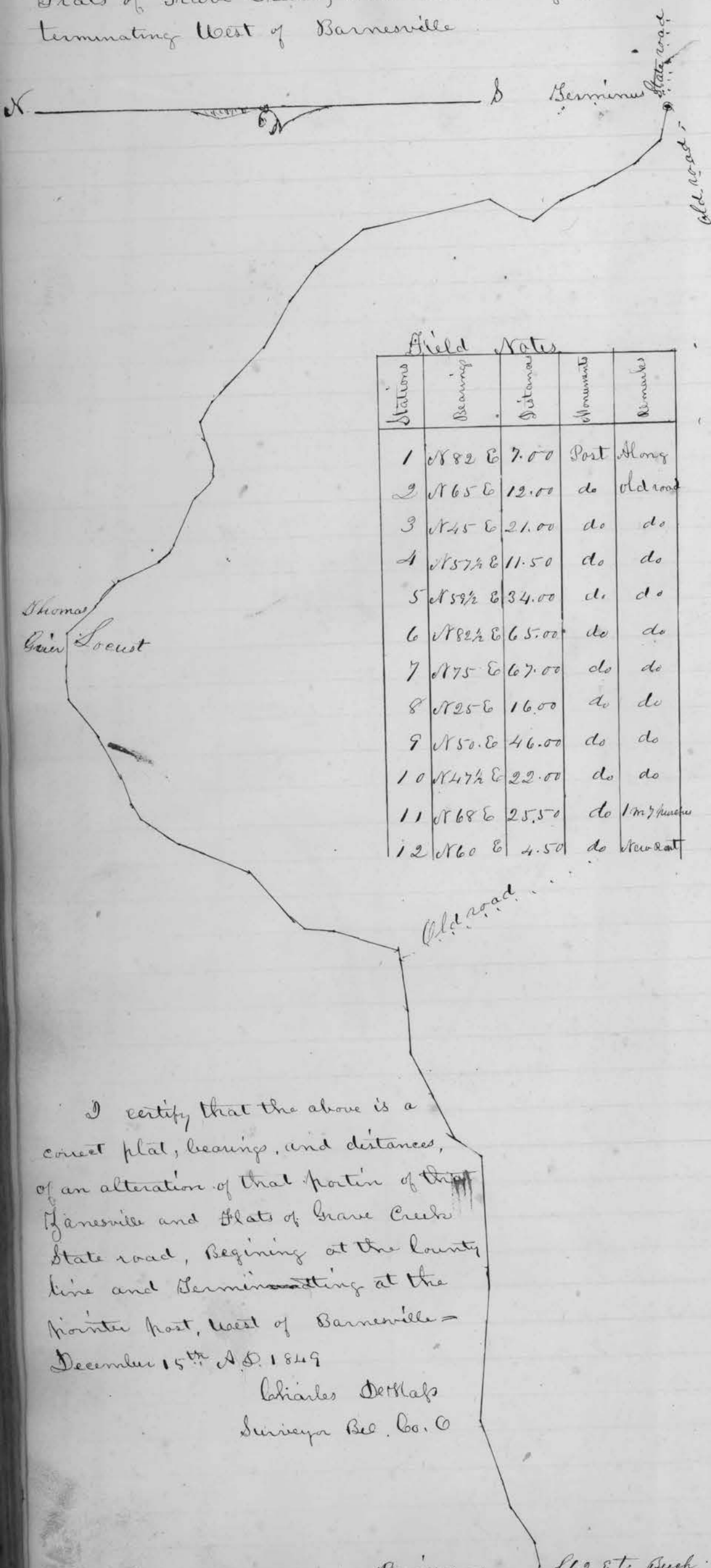

Field Notes

| Stations | Bearings | Distances | Monuments | Remarks |
|----------|------------|-----------|-----------|--------------|
| 1 | N 82 E | 7.00 | Post | Along |
| 2 | N 65 E | 12.00 | do | old road |
| 3 | N 45 E | 21.00 | do | do |
| 4 | N 57 1/2 E | 11.50 | do | do |
| 5 | N 59 1/2 E | 34.00 | do | do |
| 6 | N 82 1/2 E | 65.00 | do | do |
| 7 | N 75 E | 67.00 | do | do |
| 8 | N 25 E | 16.00 | do | do |
| 9 | N 50 E | 46.00 | do | do |
| 10 | N 47 1/2 E | 22.00 | do | do |
| 11 | N 68 E | 25.50 | do | 1 m 7 inches |
| 12 | N 60 E | 4.50 | do | New road |

Continued

| Stations | Bearings | Distances | Monuments | Remarks |
|----------|------------|-----------|-----------|-------------|
| 13 | N 8 E | 20.00 | Post | New road |
| 14 | North | 12.00 | do | do |
| 15 | N 9 1/2 W | 14.00 | do | do |
| 16 | N 16 E | 6.00 | do | do |
| 17 | N 34 1/2 E | 32.00 | do | do |
| 18 | N 9 E | 38.00 | do | do |
| 19 | N 18 E | 23.50 | do | do |
| 20 | N 43 E | 8.00 | do | do |
| 21 | N 55 E | 14.00 | | " |
| 22 | N 48 E | 24.00 | | " |
| 23 | N 38 E | 23.50 | Walnut | " |
| 24 | N 60 E | 8.00 | Post | " |
| 25 | N 82 E | 8.00 | do | " |
| 26 | N 76 E | 17.50 | Locust | Stump |
| 27 | S 56 1/2 E | 20.00 | Post | " |
| 28 | S 63 E | 18.00 | do | " |
| 29 | S 37 E | 21.00 | do | " |
| 30 | S 47 E | 7.50 | do | " |
| 31 | S 76 1/2 E | 4.00 | do | " |
| 32 | S 82 E | 25.00 | do | " |
| 33 | S 63 E | 12.00 | do | " |
| 34 | S 83 E | 3.00 | do | " |
| 35 | N 77 E | 3.00 | do | " |
| 36 | N 56 E | 13.00 | Walnut | Narrow Road |
| 37 | N 63 E | 11.50 | Post | " |
| 38 | S 73 E | 10.00 | do | " |
| 39 | S 67 E | 5.00 | do | " |
| 40 | S 61 1/2 E | 32.50 | do | " |
| 41 | S 76 1/2 E | 26.50 | do | " |
| 42 | S 69 E | 21.00 | do | " |
| 43 | S 54 E | 30.00 | do | Lab. Magon |
| 44 | S 28 1/2 E | 65.50 | do | " |
| 45 | S 14 W | 18.00 | do | " |
| 46 | S 12 E | 5.50 | do | " |
| 47 | S 58 E | 16.00 | do | " |
| 48 | S 42 E | 15.00 | do | " |
| 49 | S 24 E | 14.50 | do | " |
| 50 | S 36 E | 18.00 | do | " |
| 51 | S 56 E | 18.00 | do | " |

I certify that the above is a correct plat, bearings, and distances, of an alteration of that portion of the State road, beginning at the County line and terminating at the Mount post, West of Barnesville -
December 15th A.D. 1849

Charles DeKlapp
Surveyor Bel. Co. O

Beginning $S 62 E$ to Bush 18 diameter Belmont and Gurney County line

Total on New road 687.50 2 mile 47 perches from Diverging point

At the meeting of the Commissioners of Belmont County, it being a regular session commenced on the 1st Monday of June 1837 it was agreed by them in conformity with a petition presented, praying for an alteration of the Townships of Colerain & Pease, which said petition is filed in this Office, and ordered by said Commissioners that said alteration be made agreeable to said petition, and that said alteration be placed on record - Said alteration takes from the Township of Pease and attached to the Township of Colerain the following Sections to wit - 10. 11. 12. 14. 17 of Township 6 and Range 3. and 7. 8 & 9 of Township 7 and Range 3. —

George T. Nagle Clerk
+ Clk to court —

At the above named session of the Commissioners, a petition was presented praying for an alteration of the Townships of Putney & Mead, which said is filed in this Office, and ordered by said Commissioners, that said alteration be made agreeable to said Petition, and that said alteration be placed on record - Said alteration takes from the Township of Mead and attached to the Township of Putney the following Sections to wit - Nos 28 & 34 of Township 2 & Range 2 -

George T. Nagle
Clerk

At the meeting of the Commissioners of Belmont County, it being a regular session, commenced on the 1st Monday of December 1838, it was agreed by them in conformity with a petition presented praying for an alteration of the Townships of Pease & Putney, which said petition is filed in this Office, and ordered by said Commissioners that said alteration be made agreeable to said petition and that said alteration be placed on record - Which petition sets forth that a Town has been laid out on a portion of Fractional Sections twenty & twenty one in Township 3 - and Range 2. it was ordered that Fractional Section 21, containing about 10 Acres be taken from Pease Township and added to Putney Township —

George T. Nagle
Clerk

At the meeting of the Commissioners of Belmont County it being a regular Session commenced on the first Monday of March 1832 it was by them agreed that a new Township in said County be organized, composed of what was originally parts of York and Wayne Townships, and it was by them ordered at said meeting that a record be made of the metes & bounds of said new Township and also a record of the metes & bounds of all the other Townships in said County, said record to be so made as to describe the part or parts of each original surveyed Township as composed, each incorporated Township - as the same is incorporated & organized for civil & political purposes - and also that the name of each be attached to its description in said record.

Record of Organized Townships in Belmont County Ohio

No. 1 Colerain Township - Is composed of Sections 13=14=15=19.. 20.. 21.. 25.. 26.. 27.. 31.. 32.. & 33 in Township Seven Range Three, and Sections 18.. 24.. 30.. & 36 in Township six Range Three.

No. 2 - Glushing Township - Is composed of Sections 13.. 14.. 15.. 19.. 20 21.. 25.. 26.. 27.. 31.. 32 & 33 in Township nine Range 5 and The South Half of Township ten Range six - - - - -

No. 3 Goshen Township - Is composed of the whole of the original surveyed Township 7 Range 5.

No. 4 Kirkwood Township - Is composed of the whole of the original surveyed Township 9 Range 6.

No. 5 Mead Township - Is composed of fractional Township 8^o 1 Range 2 & Sections 31.. 32.. 33.. 34.. 27 & 28 in Township 2 Range 2 - and of Sections 5.. 6.. 11.. 12.. 17.. 18.. 23.. 24.. 30.. 36 in Township 4 Range 3 and the South Half of Township 5 Range 3. - - - - -

No. 6 Pease Township - Is composed of Sections 23.. 24.. 27.. 28.. 29 30.. 33.. 34.. 35.. 36 in Township 3 Range 2 of Sections 19.. 20.. 21.. 25.. 26.. 27.. 31.. 32.. 33 in Township 4 Range 2 - and of Sections 3.. 4.. 5.. 6.. 9.. 10.. 11.. 12.. 15.. 16.. & 17 in Township six Range 3 - and Sections 1.. 2.. 3.. 7.. 8.. 9 in Township 7 Range 3. - - - - -

N^o 7 Putney Township - Is composed of sections 29..30..35 & 36 in Township 2 Range 2 & sections 25..26..31..32 in Township 3 Range 2 & sections 4..5..6..10..11..12..16..17..18 in Township 5 Range 3 & sections 1..2..7..8..13..14 in Township 6 Range 3. *Q*

N^o 8 Richland Township - Is composed of the whole of Township 7 Range 4 except sections 24..30..36 - and of sections 22..23..24..28..29..30..34..35..36 in Township 5 Range 3 & of sections 19..20..21..22..23..25..26..27..28..29..31..32..33..34..35 in Township 6 Range 3. *Q*

N^o 9 Somerset Township - Is composed of the whole of the original Surveyed Township 7 Range 6. *Q*

N^o 10 Smith Township - Is composed of the whole of the original Surveyed Township 6 Range 4. *Q*

N^o 11 Union Township - Is composed of the whole of the original Surveyed Township 8 & Range 5. *Q*

N^o 12 Wayne Township - Is composed of the whole of the original Surveyed Township 6 Range 5. *Q*

N^o 13 Wheeling Township - Is composed of sections 24..30..36 in Township 7 Range 4 - of the south half of Township 8 Range 4 and of sections 1..2..3..7..8..9 in Township 9 Range 5. *Q*

N^o 14 Warren Township - Is composed of the whole of the original Surveyed Township 8 & Range 6. *Q*

N^o 16 Washington Township - Is composed of the whole of the original Surveyed Township 5 Range 4. *Q*

N^o 15 York Township - Is composed of sections 1..2..3..7..8..9..10 13..14..15..16..19..20..21..22..25..26..27..28..29 31..32..33..34.. & 35 in Township 6 Range 3. *Q*

Those Townships bounded on the east by the Ohio river each embrace such fractional sections not numbered on the plat of the County as lie on their eastern boundary

Wm. A. Healy and *W. H.*