

Record of State road continued

N:22

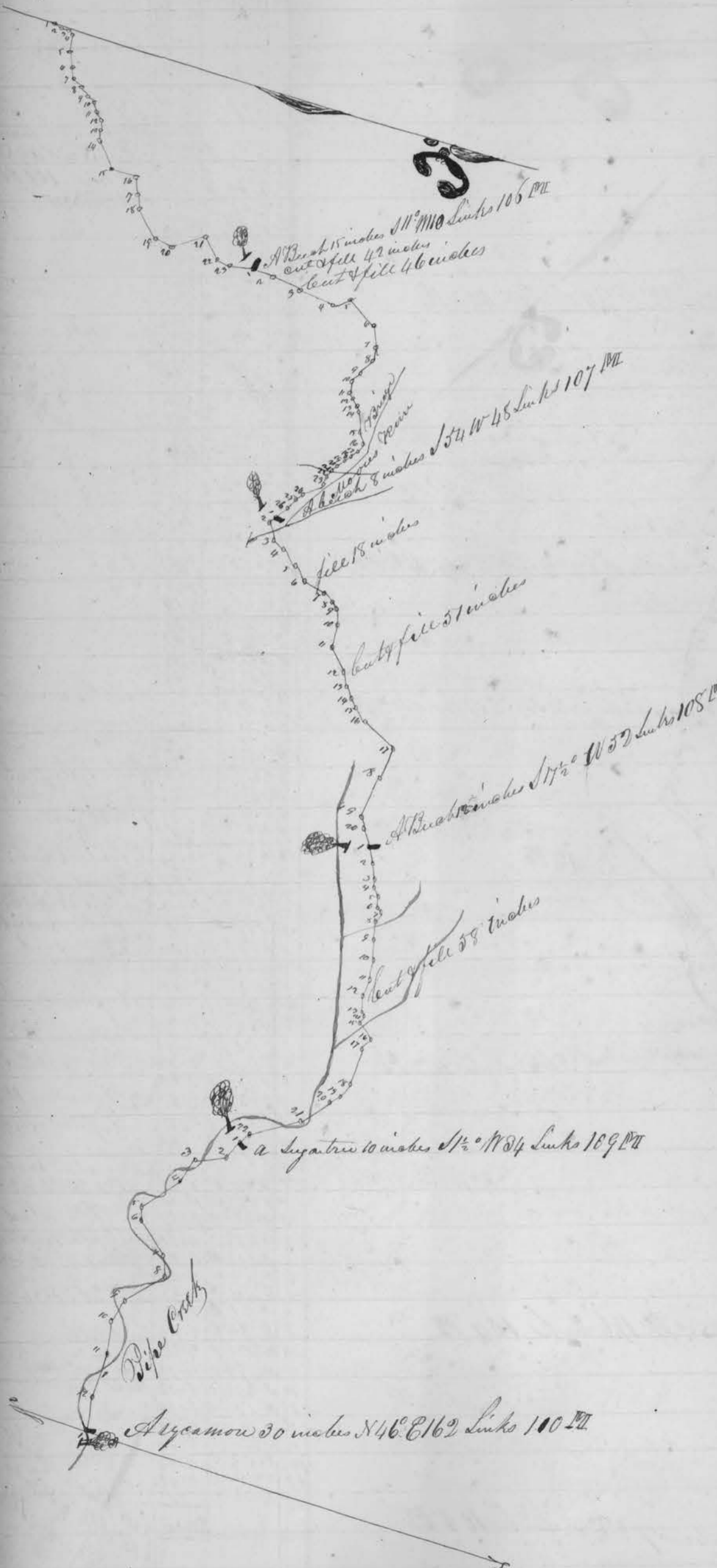

No.	Course	Distance	Observations
1	X 15 1/2	E 3.34	
2	X 5 1/2	E 1.94	
3	X 5 1/2	E 3.52	
4	X 80 3/4	E 3.77	
5	X 0 1/2	E 3.07	
6	X 62 3/4	E 2.73	
7	X 33 1/2	E 2.44	
8	X 32 1/2	E 2.50	
9	X 0 1/2	E 2.52	
10	X 1 1/2	E 1.06	
11	X 4 1/2	E 2.47	
12	X 6 1/2	E 2.26	
13	X 7 1/2	E 6.45	
14	X 5 1/2	E 5.26	
15	X 3 1/2	E 3.33	
16	X 7 1/2	E 3.64	
17	X 4 1/2	E 7.00	
18	X 5 1/2	E 4.30	
19	X 2 1/2	E 7.39	
20	X 4 1/2	E 5.12	
21	X 5 1/2	E 2.52	
22	X 7	E 5.23	
			80.00
1	X 9 1/2	E 4.03	Cut & fill 42 inches
2	X 9 1/2	E 6.95	cut & fill 46 do
3	X 8 1/2	E 4.10	
4	X 8 1/2	E 6.64	
5	X 63 3/4	E 4.57	
6	X 8 1/2	E 2.68	
7	X 8 1/2	E 3.77	
8	X 5 1/2	E 2.72	
9	X 7 1/2	E 2.08	
10	X 5 1/2	E 1.16	
11	X 8 1/2	E 2.00	
12	X 6 1/2	E 1.08	
13	X 66 3/4	E 4.39	
14	X 7 1/2	E 2.30	
15	X 50 1/2	E 1.48	
16	X 5 1/2	E 1.78	
17	X 4 1/2	E 1.83	
18	X 5 1/2	E 2.06	
19	X 5 1/2	E 1.74	
20	X 5 1/2	E 1.55	
21	X 6 1/2	E 1.72	
22	X 4 1/2	E 4.71	
23	X 4 1/2	E 1.62	
24	X 8 1/2	E 3.00	
25	X 8 1/2	E 3.43	
26	X 5 1/2	E 80.00	
1	X 5 1/2	E 3.32	
2	X 5 1/2	E 3.55	proping at forks of
3	X 20 3/4	E 2.17	clover Run
4	X 3 1/2	E 4.64	
5	X 4 1/2	E 3.50	fill 18 inches
6	X 1 1/2	E 5.00	Sept 21 st 1834 22 nd
7	X 2 1/2	E 2.70	
8	X 5 1/2	E 1.57	
9	X 7 1/2	E 3.46	
10	X 7 1/2	E 4.53	
11	X 20 1/2	E 5.77	
12	X 6 1/2	E 3.47	cut & fill 51 inches
13	X 4 1/2	E 2.13	
14	X 32 1/2	E 2.25	
15	X 2 1/2	E 3.73	
16	X 4 1/2	E 7.91	
17	X 8 1/2	E 6.90	
18	X 5 1/2	E 8.40	
19	X 6 1/2	E 2.55	
20	X 6 1/2	E 3.99	
			80.00
1	X 60 1/2	E 3.51	
2	X 63 1/2	E 3.13	
3	X 7 1/2	E 1.84	
4	X 5 1/2	E 2.05	
5	X 6 1/2	E 2.06	
6	X 4 1/2	E .97	
7	X 7 1/2	E 2.16	
8	X 7 1/2	E 3.94	
9	X 7 1/2	E 4.21	Down the North side
10	X 7 1/2	E 4.46	of a branch of Pipe creek
11	X 8 1/2	E 3.05	
12	X 7 1/2	E 3.24	
13	X 44 1/2	E .85	cut & fill 58 inches
14	X 64 1/2	E 1.53	at forks of Pipe creek
15	X 26 1/2	E 4.73	then down at creek
16	X 5 1/2	E 2.71	
17	X 8 1/2	E 7.09	
18	X 68 1/2	E 3.66	
19	X 4 1/2	E 2.91	
20	X 5 1/2	E 7.04	
21	X 32 1/2	E 11.53	
22	X 63 1/2	E 2.63	
			80.00
1	X 60 1/2	E 3.63	
2	X 25 1/2	E 6.84	
3	X 7 1/2	E 5.16	
4	X 5 1/2	E 10.00	
5	X 7 1/2	E 2.36	
6	X 4 1/2	E 8.88	
7	X 6 1/2	E 4.50	
8	X 4 1/2	E 10.07	
9	X 8 1/2	E 5.23	
10	X 7 1/2	E 6.60	
11	X 8 1/2	E 9.69	
12	X 8 1/2	E 7.04	
			80.00

A Bench 15 inches S 11° 11' 10" W 106 links 106th

A Bench 8 inches S 54° 10' 45" W 107 links 107th

A Bench 10 inches S 17° 1/2° W 108 links 108th

A Sugar tree 10 inches S 17° 1/2° W 109 links 109th

Aycamow 30 inches N 46° E 100 links 100th

Cut & fill 42 inches

cut & fill 46 do

fill 18 inches

cut & fill 51 inches

cut & fill 58 inches

proping at forks of clover Run

fill 18 inches Sept 21st 1834 22nd

cut & fill 51 inches

A Bench 10 inches S 17° 1/2° W 109 links marked 109th

Down the North side of a branch of Pipe creek

cut & fill 58 inches at forks of Pipe creek then down at creek

Aycamow 30 inches N 46° E 100 links marked 100th

A Bench 15 inches S 11° 11' 10" W 106 links marked 106th

A Bench 8 inches S 54° 10' 45" W 107 links marked 107th

A Bench 10 inches S 17° 1/2° W 108 links marked 108th

A Sugar tree 10 inches S 17° 1/2° W 109 links marked 109th

Aycamow 30 inches N 46° E 100 links marked 100th

231 Record of State Road Continued
No 93

No	Bearing	Distance	Observations
1	N 82 E	11.36	
2	S 31 1/2 E	8.10	
3	S 38 1/2 E	7.27	
4	S 29 1/2 E	14.91	
5	S 2 1/2 E	8.32	
6	S 43 1/2 E	9.57	
7	S 53 E	5.55	
8	S 83 1/2 E	5.58	
9	S 65 E	7.58	
10	S 58 E	10.94	
11	S 76 1/2 E	1.24	
			80.00
1	S 76 1/2 E	3.84	
2	N 85 1/2 E	2.59	
3	N 81 E	5.71	cut & fill 25 inches
4	S 78 1/2 E	8.50	
5	S 86 E	6.00	
6	N 40 E	5.22	
7	N 9 1/2 E	8.60	
8	N 60 1/2 E	14.85	
9	N 41 1/2 E	5.37	
10	N 75 1/2 E	3.35	cut & fill 34 inches
11	S 16 E	6.87	
12	S 11 1/2 E	7.22	
13	S 65 1/2 E	1.88	
			80.00
1	S 67 1/2 E	9.36	
2	S 35 1/2 E	3.06	
3	S 76 1/2 E	8.50	
4	S 60 E	2.45	
5	S 43 1/2 E	2.70	
6	S 74 E	2.24	
7	S 47 E	5.84	
8	S 66 1/2 E	7.93	
9	S 52 1/2 E	7.03	
10	S 80 1/2 E	3.19	
11	N 77 1/2 E	6.77	
12	N 54 E	5.31	
13	N 62 1/2 E	6.42	
14	N 46 1/2 E	3.93	
15	N 03 E	3.24	
16	N 59 1/2 E	1.20	
			80.00
1	N 59 1/2 E	7.06	
2	N 58 E	6.83	
3	N 67 1/2 E	1.81	cut & fill 52 inches
4	S 54 1/2 E	3.70	
5	S 78 1/2 E	3.16	
6	N 58 E	11.72	cut & fill 24 inches
7	N 62 1/2 E	3.65	
8	N 71 E	4.00	
9	S 89 1/2 E	6.74	cut & fill 63 inches
10	N 78 1/2 E	6.50	
11	N 53 1/2 E	3.60	
12	N 73 E	7.68	
13	N 74 1/2 E	3.71	
14	N 73 1/2 E	10.82	
15	N 71 1/2 E	5.02	
			80.00
1	N 71 1/2 E	8.00	
2	N 68 1/2 E	11.86	links marked 114 M
3	S 65 E	3.83	
4	S 64 E	5.17	
5	S 59 E	6.16	
6	S 67 1/2 E	6.50	
7	S 72 1/2 E	6.72	
8	S 61 1/2 E	6.85	cut & fill 20 inches
9	S 70 E	24.87	cut & fill 20 do cut & fill 43 inches
			80.00

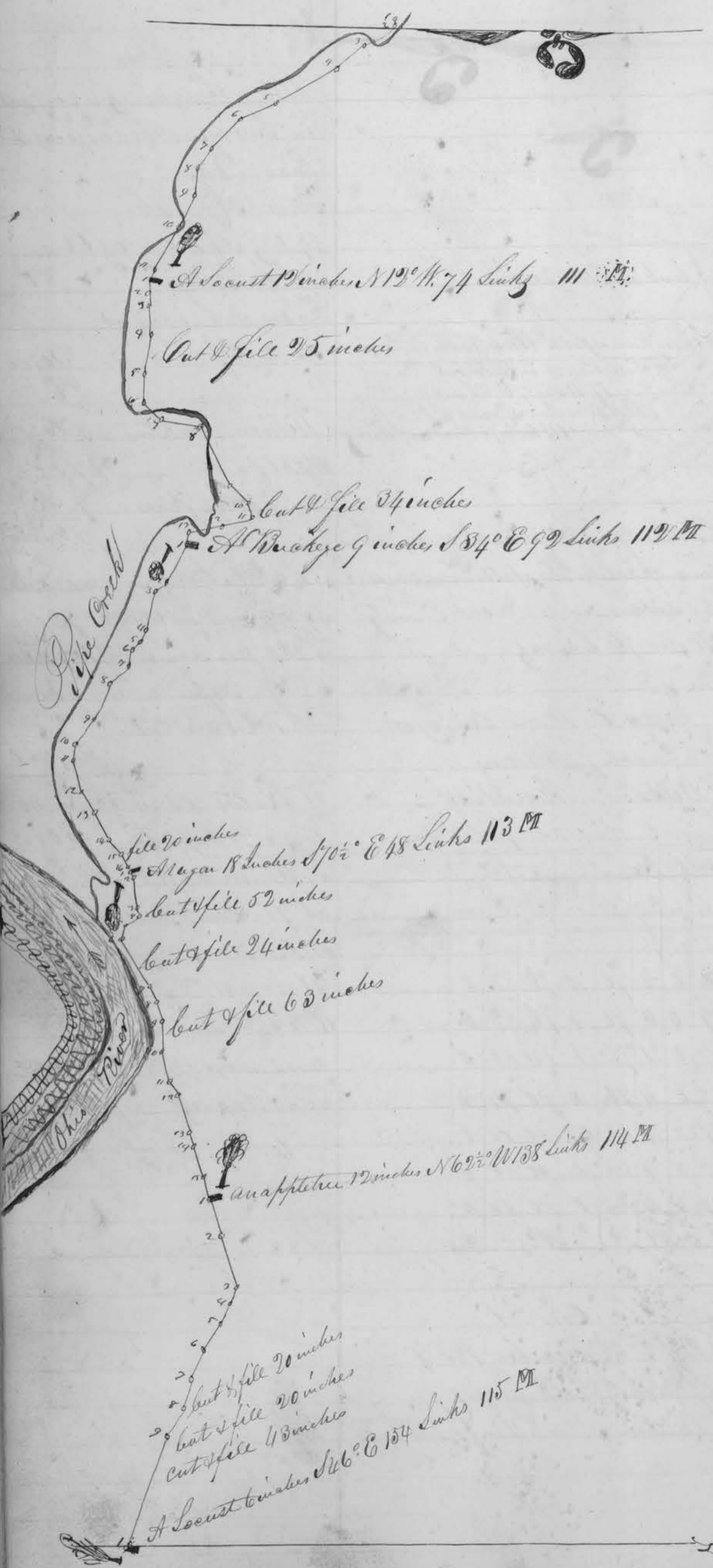

A Locust 19 inches N 19° W 74 Links 111 M
 cut & fill 25 inches
 cut & fill 34 inches
 A Buckeye 9 inches S 34° E 99 Links 119 M
 cut & fill 20 inches
 A hazel 18 inches S 70 1/2° E 48 Links marked 113 M
 cut & fill 52 inches
 cut & fill 24 inches
 cut & fill 63 inches
 An apple tree 12 inches N 69 1/2° W 138 Links marked 114 M
 cut & fill 20 inches
 cut & fill 20 do cut & fill 43 inches
 A Locust 6 inches S 46° E 154 Links marked 115 M

Record of State Road Continued

N^o 24

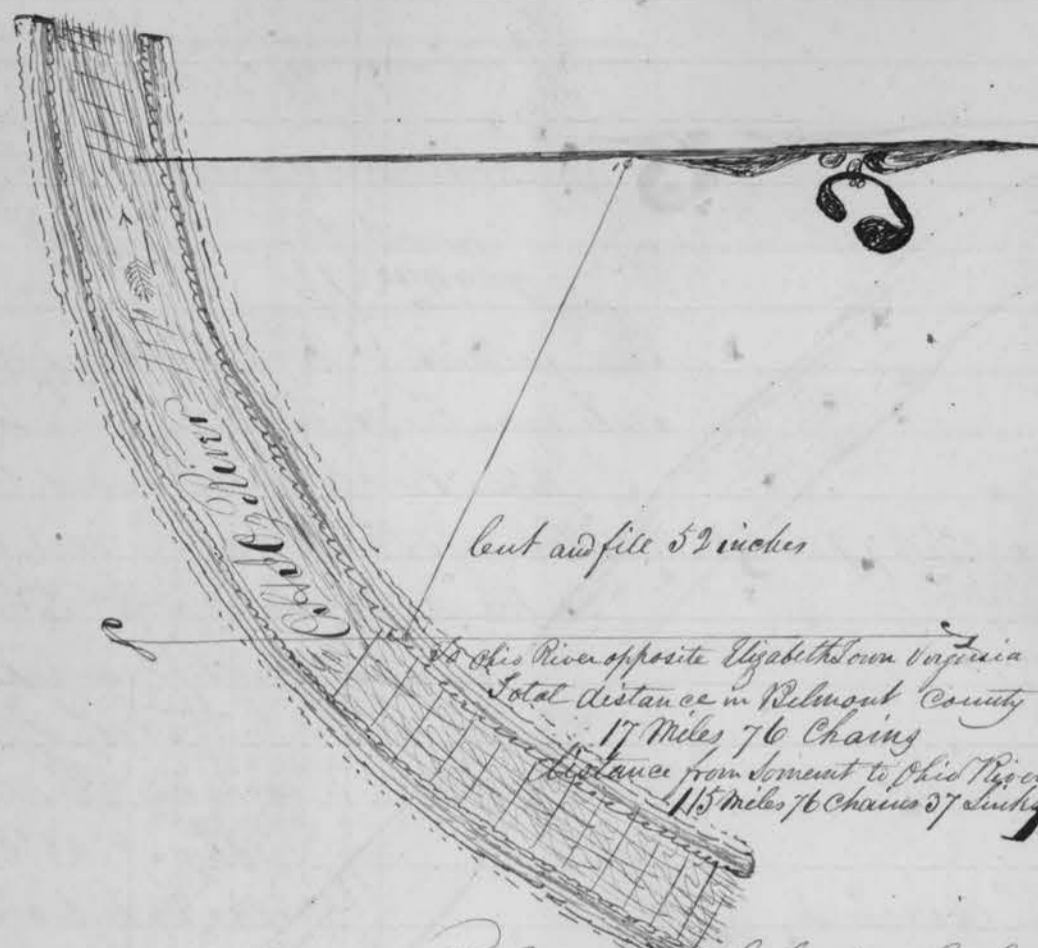

To the edge of the bank of the Ohio River opposite Elizabeth Town Virginia
 Total distance in Belmont County
 17 Miles 76 Chains

James C. Moore Surveyor
 Jacob Adams
 William Meckling

The apportionment for each County is as follows

Names	Perry Co			Morgan Co			Monroe Co			Belmont Co			Total		
	D	C	m	D	C	m	D	C	m	D	C	m	D	C	m
J Adams	10	32	6	28	79	0	25	78	0	11	90	4	76	80	0
W Meckling	10	32	6	28	80	0	25	79	0	11	90	4	76	82	0
J C Moore	19	02	5	53	04	4	47	50	0	21	93	1	141	50	0
Robt Adams	4	13	5	11	52	5	10	32	0	4	76	0	30	74	3
P Kenin	4	03	0	11	24	5	10	07	5	4	65	0	30	00	0
W Rutledge	4	03	0	11	24	5	10	07	5	4	65	0	30	00	0
Eli Adams	4	03	0	11	24	5	10	07	5	4	65	0	30	00	0
Total	55	90	2	155	89	4	139	61	5	64	45	2	415	86	3

Station 1 170³/₄ 66.37 Cut & fill 5 1/2 inches

Bill of the expenses laying out and surveying the foregoing State Road viz.

Jacob Adams Commissioner
 44 days at \$1.50 \$66.00
 for Postage " 80
 For one Horse 40 days at 25 Cents per day 10.00
 \$76.80

William Meckling 45 days at \$1.50 per day 67.50
 Postage paid 9.32
 \$76.82

J. C. Moore surveyor in surveying & platting &c 93 days @ 1.50 per day \$139.50
 Paid for mesage from Sommet to W Connelville 9.00
 \$141.50

W Rutledge Chain Carrier 40 days @ 75 Cts per day 30.00
 P. Kenin do 40 days at 75 Cents per day 30.00
 Robt Adams marker 41 days at 75 Cts 30.75
 Eli Adams binder 40 days at 75 Cts 30.00
 Total amount \$415.87

We certify the foregoing to be correct
 Given under our hands 24th December 1834

Jacob Adams
 William Meckling
 Commissioners
 State Road

233
 Record of a State road leading from the Mouth of
 Captina Creek in Belmont County Ohio to the Seventeen mile tree
 near the dwelling house of Daniel Gately in Sumbury Township Monroe
 County

(Scale 1 inch to the hundred feet)

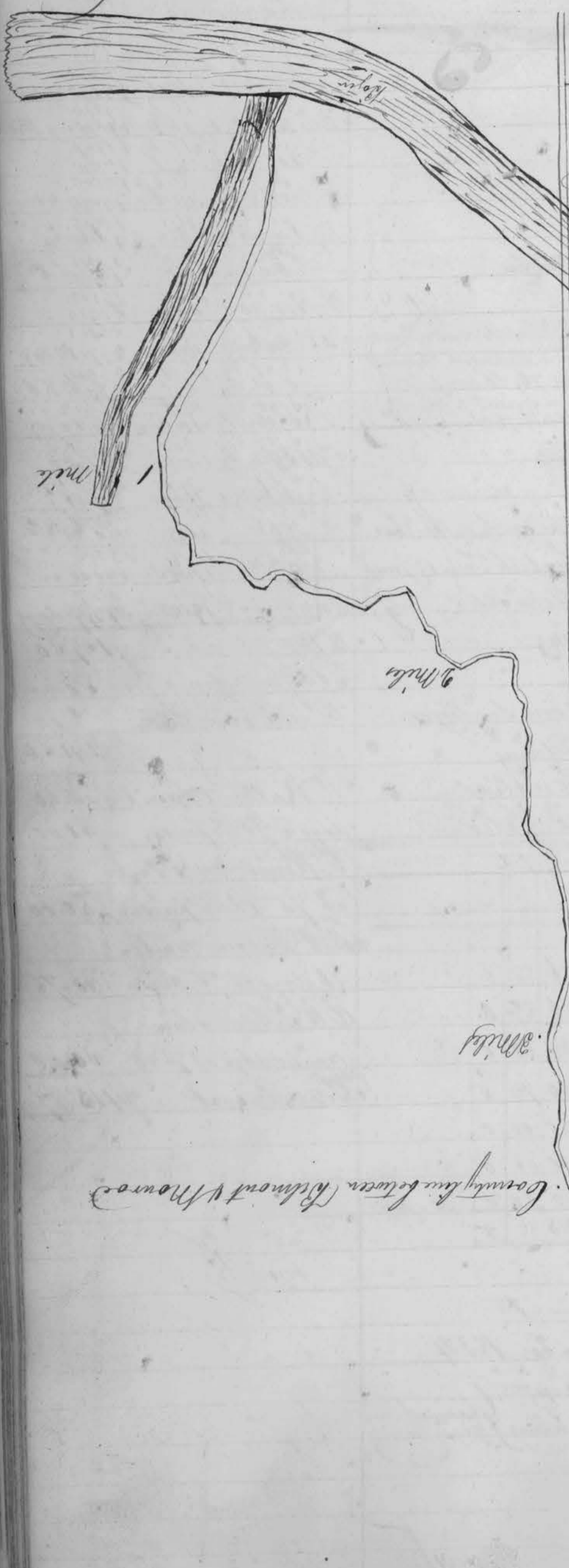

The following are the field notes of a
 State road leading from the Mouth of
 Captina Creek in Belmont County
 Ohio to the Seventeen mile tree near
 the dwelling house of Daniel Gately
 in Sumbury Township Monroe
 County and State of Ohio.
 Beginning for the same 10
 perches N 58° E from
 the NE Corner of a
 Tavern house on the
 lower side of the
 Mouth of said Creek now occupied by
 James Smith and owned by Archibald
 Wood of Virginia.

N 70 W	24.6	" 24.6
N 85 W	48.9	" 73.5
N 80 W	44.0	" 117.5
N 68 W	62.0	" 179.5
N 72 W	26.0	" 195.5
N 59 W	23.0	" 218.5
N 62 W	21.8	" 230.3
N 61 W	18.6	" 248.9
N 54 W	8.5	" 257.4
N 65 W	12.6	" 269.0
N 66 W	11.7	" 281.3
N 73 W	8.6	" 289.9
N 86 W	25.7	" 315.6
N 83 W	4.4	" 320.0
Same	10.8	" 10.8
N 86 W	9.0	" 29.8
N 57 W	12.0	" 41.8
N 69 W	14.0	" 55.8
N 35 W	8.0	" 69.8
N 86 W	8.5	" 72.3
N 86 W	8.5	" 84.7
N 78 W	12.4	" 92.7
N 72 W	2.8	" 101.2
N 70 W	8.5	" 112.5
N 70 W	11.1	" 123.6
N 80 W	6.3	" 129.9
N 8 E	5.6	" 135.5
N 47 E	8.5	" 140.0
N 11 E	8.0	" 148.2
N 33 W	12.4	" 160.2
N 35 W	2.4	" 168.2
N 5 W	9.8	" 178.1
N 13 W	5.5	" 183.8
N 16 W	9.8	" 193.6
N 26 W	8.7	" 202.1
N 8 E	2.4	" 204.5
N 36 E	5.1	" 209.6
N 39 E	9.0	" 218.6
N 47 E	5.5	" 224.1
N 11 E	15.7	" 239.8
N 61 W	13.2	" 255.0
N 63 W	11.2	" 268.2
N 61 W	6.6	" 281.0
N 29 W	7.5	" 288.5
N 58 W	9.1	" 297.6

Record of State Road Continued

183 W 11.3	308.9	313.5
184 W 6.3	315.2	315.5
185 W 11.5	320.0	320.0 M
Same	6.6	6.6
186 W 10.7	17.8	17.8
187 W 5.0	25.9	25.9
188 W 6.0	31.3	31.3
189 W 12.0	43.3	43.3
189 W 4.9	48.0	48.0
185 W 11.0	58.0	58.0
185 W 8.0	66.0	66.0
189 W 7.5	73.5	73.5
187 W 12.0	85.5	85.5
189 W 10.7	96.2	96.2
189 W 14.0	100.2	100.2
181 W 12.5	122.7	122.7
189 W 8.8	131.5	131.5
186 W 12.7	143.2	143.2
188 W 10.5	150.7	150.7
182 W 10.6	164.3	164.3
184 W 10.8	175.1	175.1
186 W 11.5	185.9	185.9
189 W 11.7	196.0	196.0
188 W 11.3	221.9	221.9
188 W 11.8	239.1	239.1
182 W 13.2	246.3	246.3
187 W 12.4	274.7	274.7
187 W 12.0	288.7	288.7
181 W 14.0	307.7	307.7
181 W 12.3	320.0	320.0 M
Same	8.0	8.0
188 W 10.5	281.5	281.5
189 W 15.0	461.5	461.5
184 W 18.8	571.3	571.3
184 W 15.5	721.8	721.8
186 W 13.6	86.4	86.4
182 W 7.9	94.2	94.2
187 W 14.5	131.8	131.8
186 W 18.0	131.8	131.8
180 W 20.3	107.1	107.1
184 W 7.0	158.7	158.7
Same	30.0	170.0
184 W 20.0	190.7	190.7
188 W 21.0	191.7	191.7
188 W 9.4	229.1	229.1
186 W 8.0	137.1	137.1
180 W 36.5	273.6	273.6
188 W 19.2	292.9	292.9

180 W 8.9	301.7	301.7
188 W 11.1	312.8	312.8
186 W 7.2	201.4	201.4 M
Same	9.5	9.5
185 W 12.9	214.1	214.1
188 W 18.9	411.0	411.0
182 W 15.6	50.9	50.9
189 W 6.5	109.4	109.4
184 W 6.7	170.1	170.1
184 W 10.5	180.6	180.6
185 W 12.9	193.5	193.5
188 W 11.4	104.9	104.9
187 W 9.6	111.5	111.5
188 W 20.0	134.5	134.5
183 W 24.0	158.5	158.5
181 W 9.1	168.2	168.2
182 W 24.0	192.2	192.2
186 W 31.3	203.5	203.5
181 W 20.8	243.3	243.3
181 W 11.0	254.3	254.3
182 W 13.0	267.3	267.3
186 W 22.0	289.3	289.3
187 W 24.0	303.7	303.7
185 W 16.3	320.0	320.0 M
Same	9.9	9.9
184 W 21.6	311.7	311.7
183 W 10.0	411.7	411.7
182 W 8.5	501.2	501.2
180 W 16.5	76.7	76.7
184 W 14.0	90.7	90.7
181 W 20.0	116.7	116.7
185 W 15.3	132.0	132.0
187 W 14.0	146.0	146.0
186 W 29.0	169.0	169.0
186 W 20.0	189.0	189.0
189 W 8.0	197.1	197.1
181 W 11.1	208.1	208.1
180 W 16.0	224.1	224.1
184 W 6.0	230.1	230.1
185 W 17.7	247.8	247.8
186 W 27.6	275.4	275.4
186 W 10.0	281.4	281.4
185 W 14.1	285.4	285.4
187 W 7.7	288.1	288.1

189 W 10.0	313.1	313.1
185 W 6.9	320.0	320.0 M
Same	2.7	2.7
183 W 7.7	101.4	101.4
184 W 8.8	19.2	19.2
184 W 6.8	25.6	25.6
184 W 22.0	47.0	47.0
187 W 8.7	55.7	55.7
185 W 10.5	66.2	66.2
184 W 14.1	81.3	81.3
181 W 10.7	92.0	92.0
180 W 10.0	102.0	102.0
183 W 17.7	119.7	119.7
186 W 4.7	124.4	124.4
181 W 6.0	130.4	130.4
183 W 12.0	144.4	144.4
185 W 11.1	159.5	159.5
185 W 8.0	161.5	161.5
188 W 12.0	173.5	173.5
184 W 10.0	185.5	185.5
180 W 12.0	195.5	195.5
180 W 24.0	219.5	219.5
189 W 13.0	231.5	231.5
Same	16.0	247.5
187 W 16.7	264.2	264.2
181 W 6.0	270.2	270.2
186 W 14.0	284.2	284.2
180 W 10.5	294.7	294.7
182 E 8.3	308.0	308.0
182 E 14.0	317.0	317.0
189 E 3.0	320.0	320.0 M
Same	10.0	10.0
184 E 8.0	18.0	18.0
180 W 4.8	22.8	22.8
188 W 10.8	33.6	33.6
180 W 7.8	41.4	41.4
182 W 13.0	54.7	54.7
182 W 19.2	73.9	73.9

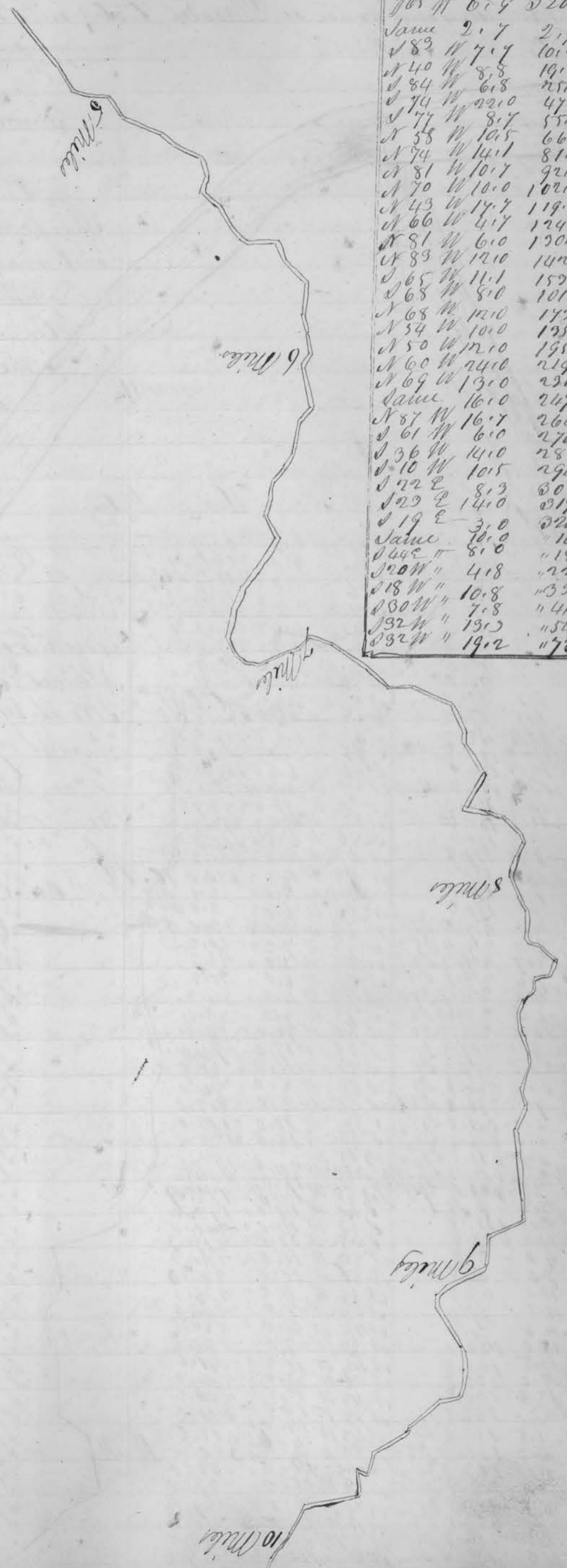

235

Record of State road Continued

N 15 W	10.5	841.4
N 26 W	14.4	98.4
N 28	22.2	201.6
N 12 W	9.5	130.1
N 9 W	4.7	134.7
N 26 W	15.6	150.3
N 63 W	12.0	162.9
N 64 W	7.5	169.8
N 50 W	2.7	174.5
N 87 W	5.2	179.7
N 57 W	11.0	190.7
N 59 W	5.5	196.2
N 65 W	14.6	213.8
N 24 W	5.4	219.2
N 76 W	5.0	224.0
N 60 W	4.8	229.0
N 66 W	4.0	243.0
N 80 W	2.3	245.3
N 3 E	6.0	257.3
N 3 E	11.5	262.8
N 15 W	12.7	276.5
N 28 W	8.0	284.5
N 45 W	8.0	292.5
N 68 W	7.2	299.1
N 69 W	10.5	310.2
N 69 W	9.8	322.0
N 88 W	0.0	06.0
N 55 W	8.0	42.0
N 72 W	6.0	20.2
N 58 W	9.3	27.3
N 85 W	9.5	38.5
N 89 W	8.0	46.5
N 64 W	4.0	50.0
N 19 W	3.5	54.2
N 10 W	3.4	57.4
N 29 W	5.0	62.4
N 49 W	5.6	68.0
N 83 W	4.0	72.0
N 33 W	3.0	75.0
N 20 W	5.7	80.7
N 87 W	6.5	87.2
N 45 W	10.8	98.2
N 70 W	14.0	122.0
N 70 W	12.4	124.8
N 69 W	19.5	138.3
N 62 W	16.5	154.3
N 78 W	11.5	165.6
N 78 W	4.7	170.3
N 75 W	7.6	177.9
N 68 W	5.1	182.0
N 75 W	7.1	190.1
N 83 W	7.1	197.9
N 71 W	10.0	207.2
N 65 W	8.4	215.6
N 71 W	5.7	221.3
N 71 W	7.6	228.9
N 71 W	4.8	233.7
N 80 W	4.6	238.3
N 84 W	10.0	248.3
N 86 W	9.0	257.3
N 81 W	24.0	281.3
N 87 W	5.3	286.6
N 80 W	9.4	296.0
N 16 W	5.0	301.0
N 24 W	6.5	306.5
N 27 W	3.6	310.0
N 80 W	2.4	312.4
N 86 W	7.4	320.9
Same	10.8	33.8
N 75 W	12.0	35.8
N 83 W	10.0	37.8
N 20 W	9.0	37.8
N 28 W	7.1	46.8
N 45 W	14.0	67.9
N 55 W	11.5	79.4
N 57 W	11.6	80.0
N 58 W	16.0	106.0
N 58 W	13.8	120.8
N 81 W	8.0	128.8
N 84 W	12.0	140.8
N 88 W	8.0	148.8
N 63 W	5.8	154.6
N 15 W	3.7	158.3
N 9 W	8.7	162.0
N 19 W	6.5	168.5
N 42 W	5.5	178.0
N 37 W	4.0	182.5
N 31 W	4.5	186.5
N 43 W	4.0	194.0

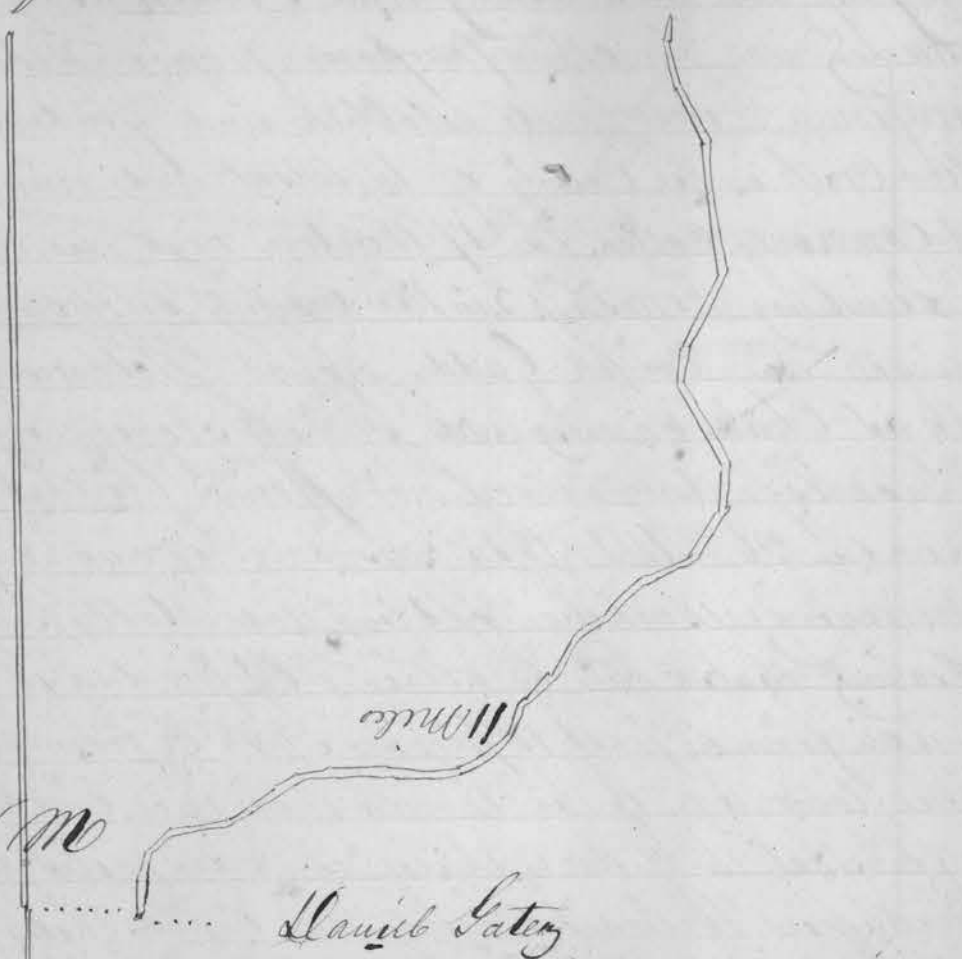

N 62 W	6.7	200.7	D 50
N 40 W	6.0	206.7	D 50
N 26 W	5.0	211.7	D 50
N 31 W	3.7	215.4	D 50
N 33 W	4.4	219.8	D 50
N 39 W	3.3	224.1	D 50
N 71 W	3.3	227.4	D 50
N 86 W	5.0	232.4	D 50
N 24 W	8.0	240.4	D 50
N 82 W	5.6	246.0	D 50
N 57 W	6.8	251.8	D 50
N 78 W	4.4	257.2	D 50
N 20 W	6.4	263.6	D 50
N 9 W	5.4	269.0	D 50
N 4 W	7.5	276.5	D 50
N 14 W	7.4	283.9	D 50
N 26 W	6.8	289.9	D 50
N 67 W	14.8	290.7	D 50
N 64 W	14.5	305.5	D 50
Same	2.0	320.0	10.0
N 68 W	6.0	2.0	D 50
N 49 W	5.0	8.0	D 50
N 55 W	7.2	13.0	D 50
N 62 W	5.0	20.2	D 50
N 88 W	5.0	25.2	D 50
N 73 W	4.0	30.2	D 50
N 72 W	9.2	34.2	D 50
N 60 W	16.0	43.4	D 50
N 59 W	17.0	59.0	D 50
N 81 W	10.3	76.0	D 50
N 84 W	8.0	86.9	D 50
N 74 W	8.0	96.0	D 50
N 75 W	10.0	102.0	D 50
N 88 W	18.0	112.0	D 50
N 65 W	24.0	128.0	D 50
N 68 W	21.0	152.0	D 50
N 89 W	14.0	104.0	D 50
N 60 W	14.0	178.0	D 50
N 57 W	14.0	192.0	D 50
N 65 W	11.0	206.0	D 50
N 86 W	11.0	217.3	D 50
N 86 W	10.0	220.3	D 50
N 58 W	10.0	220.3	D 50
N 59 W	6.2	233.3	D 50
N 24 W	7.0	239.5	D 50
N 28 W	6.0	240.5	D 50
N 32 W	8.0	240.5	D 50
N 45 W	11.2	260.5	D 50
N 26 W	5.0	271.6	D 50
N 48 W	12.0	276.0	D 50
N 58 W	13.0	280.6	D 50
N 45 W	14.0	301.6	D 50
N 45 W	4.0	315.6	D 50
N 65 W	4.0	320.7	D 50
Same	7.0	12.0	D 50
N 42 W	15.0	37.0	D 50
N 29 W	7.0	34.0	D 50
N 16 W	6.0	40.0	D 50
N 2 W	8.0	48.0	D 50
N 6 2	11.8	59.8	D 50

To the 1/4 mile
near the dwelling
house of Lamb Gate
M. Lamb Gray surveyor

1/4 mile

Being by the 13th Section of an act of the Legislature entitled an act to provide for laying out establishing and constructing certain State Roads therein named and for other purposes passed February twelfth A.D. 1829 appointed Commissioners to view locate establish and grade a State Road from the mouth of Captina Creek in the County of Belmont and running thence on the best ground to what is commonly called the 17 Mile tree near the dwelling house of Daniel Gatz in Sumbury Township in the County of Monroe: and employing Daniel Gray Surveyor and Joseph Gadd, Robert Hathaway, James Nospinger and William Sword as Chain carriers and Samuel Nospinger as marker, We after being by Joseph Gadd Esq. duly sworn and affirmed for that purpose as the laws direct proceeded on the 26th Ult to the discharge of our respective duties by viewing, grading, surveying, marking, locating and establishing the same on the nearest and best ground that could be obtained by grading it at an angle of five degrees of the horizon from a post 10 perches N 55° E from the N E Corner of a Tavern house on the lower side of the mouth of the said Creek owned by Archibald Wood Wherry we find that the distance thereof is three miles and one hundred and fifty eight perches in Belmont County and eight miles and thirty six perches in said Monroe County: Making in all eleven miles one hundred and ninety four perches as will appear by a reference to the above Plat and Field notes which we hereby certify to be a copy from the original survey as by enactment.

Given under our hands this thirteenth day of June A.D. 1829.

William Smith
Richard Truax
Thomas Harmon

Commissioners

Daniel Gray Surveyor

To the Honorable Commissioners of Belmont County Ohio
We hereby certify that the following named persons each performed the following number of days labor in & about the locating, grading, & establishing a certain State Road beginning at the mouth of Captina Creek in said Belmont County and running thence to the seventeen Mile tree near the dwelling house of Daniel Gatz in Sumbury Township Monroe County authorized by an act to provide for locating laying out & establishing & constructing certain State Roads therein mentioned and other purposes passed Feb 12th 1829 viz

Commissioners	Wm Smith	each 7 days @ 1.50	10.50
	Richard Truax		10.50
	Thomas Harmon		10.50
			<hr/> 31.50
Surveyor	Daniel Gray	19 days @ 1.50	18.00
Chain carriers	Joseph Gadd	5 days @ 75 cts	3.75
	William Sword	1 day @ 75	0.75
	Robert Hathaway	4 days @ 75	3.00
	James Nospinger	1 do @ 75	0.75
Marker	Samuel Nospinger	6 do @ 75	4.50
			<hr/> 41.50
Witness our hands this 13 th day of June 1829	Wm Smith	Commissioner	69.25
Surveyor Daniel Gray	Richard Truax		
	Thomas Harmon		

To the Commissioners of Belmont County
 We the undersigned after being duly qualified according to Law have
 proceeded to lay out & survey a Road agreeable to the Act of the General
 Assembly of the State of Ohio passed March 3rd 1834, Beginning at the
 Corner therein named between the land of Joshua Ellis & John Baker
 in the County of Cuyahoga thence by the several points named to the
 Antwerp Road near Tallman & Chandler Saw Mill in Harrison County
 The following being the courses, distances &c of the several Stations together
 with the Plot of the whole length of said Road.
 Nov 1st 1834

Thos. Dean
 Commissioners
 James Brown
 George Rouse
 Surveyors
 Wm. McMillan

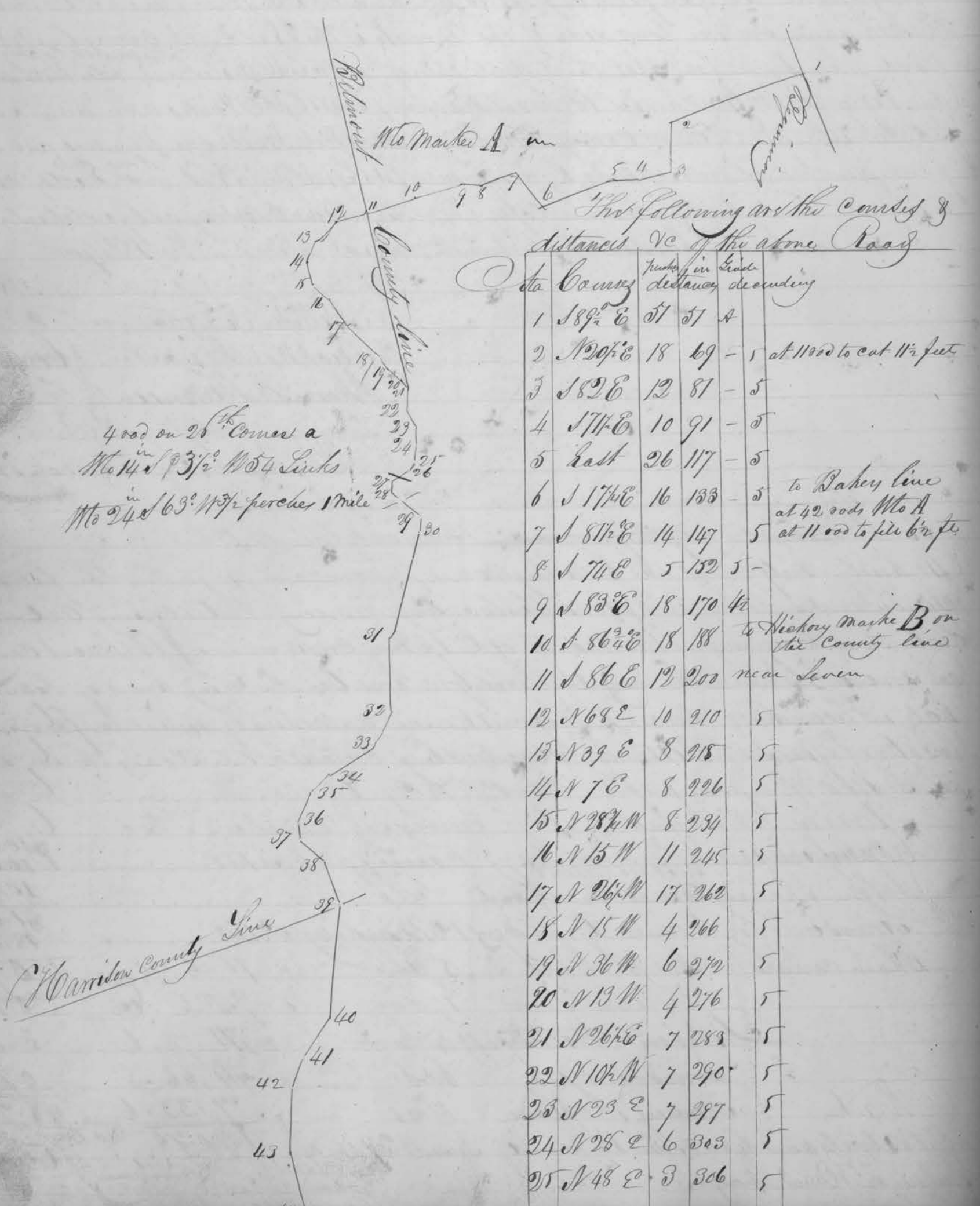

Record of State roads Continued

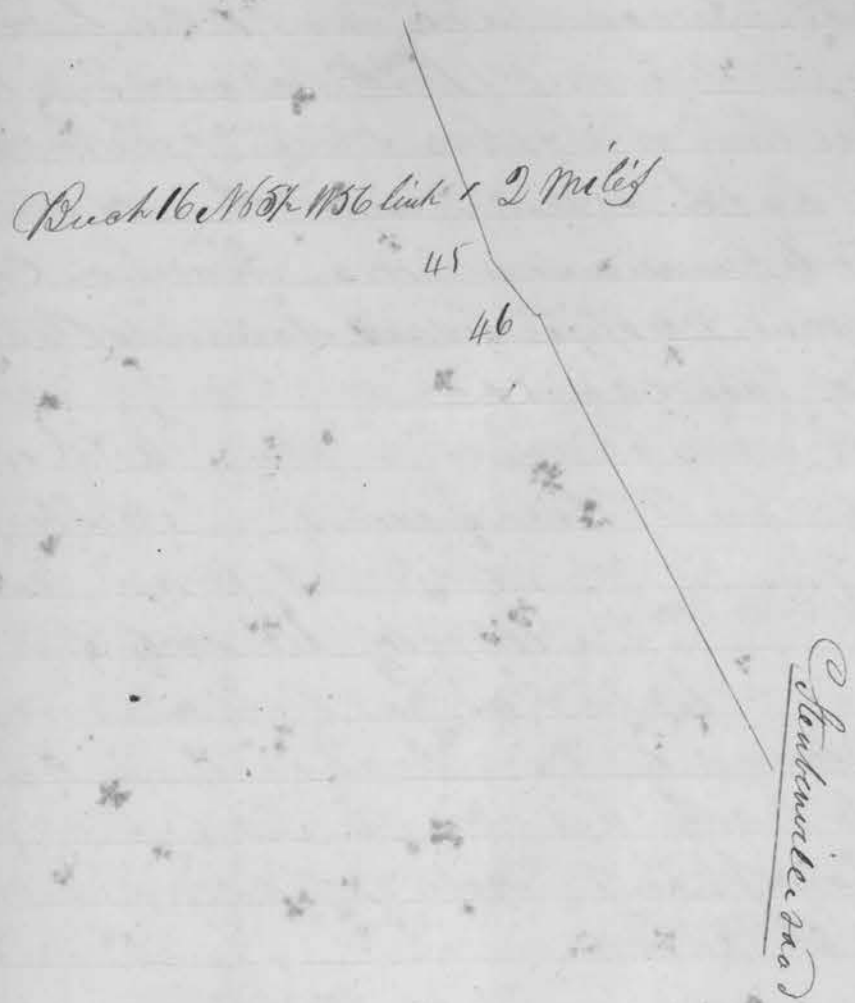

Sta	Course	Distance	Remarks
26	N 79 E	6 312 5	
27	N 26 E	4 316 5	
28	N 23 W	13 ³⁷⁰ / ₇ 5	at 4 rods 1 Mile
29	N 28 E	6 15 2	
30	N 35 E	40 55	level at 4 Rods a run
31	N 18 E	26 81	to Meadon
32	N 44 E	14 95	to South side of Bottom
33	N 71 E	19 114 5	into Rod
34	N 64 E	8 152	
35	N 45 E	13 135	
36	N 42 E	6 141	
37	N 74 W	12 153	
38	N 12 E	16 169	to Harrison County Line
39	N 25 E	42 211	
40	N 32 E	16 227	
41	N 3 1/2 E	12 239	along hill side
42	N 23 E	22 261	
43	N 62 E	22 283	uneven
44	N 2 W	52 ³²⁰ / ₁₅	2 nd Mile Rush 16 S 136 links
45	N 19 W	26 41	uneven
46	N 8 W	107 148	to the Road

From Steubenville to Cambridge Square with the North end of Debate house

The total length of the above road is 2 Miles 148 Perches
 In Guernsey County 188 Perches
 In Belmont " 301 Perches
 In Harrison " 299 Perches
 785 2 Miles 148 perches

Name	Days	Task	Cost
Thomas Dunn	4	Surveying & Making return	6 " 00
James Brown	4	do do	6 " 00
George Rouse	4	do do	6 " 00
Walter McMillan	4	Surveying & Making Plot	6 " 00
John Dunn	3	Carrying chain	2 " 25
John Pennington	3	do do	2 " 25
Amos Wright	3	Marking	2 " 25
Total			\$30 75

County	Pays	Amount
Belmont County	pays	11 74 6
Harrison do	do	11 66 8
Guernsey do	do	7 33 6
Total		30 75

We certify the above to be a correct account of the time & amount each person has served on the above Road.

Thomas Dunn
 James Brown
 George Rouse

To the Commissioners of Belmont County
 In pursuance of an act of the General Assembly of the State of Ohio passed July 19th 1833 for the Reviewing & Altering parts of a State road leading from a point at which it intersects the State road leading from the mouth of Captina Creek in Belmont County to Freeport in Harrison County to where said road crosses the west line of Sec 16 in Harrison Co. as said Commissioners therein named may think

We the undersigned after being duly qualified as the Law directs have proceeded to review the path of said road and agree to make such alterations as are represented in the annexed plat.

Given under our hands this 2nd of Jan: 1834.
 Tho: Denny
 Commissioner James Lloyd
 Wm. M. McMillan Surveyor

The following is the course & distance of the alteration of that part of the road from Morristown to Cadiz between the sixth station of the 6th mile and the 13th station of the 7th mile of the original survey beginning 56 Perches on the 6th line

Station no	Course	dist	D	grade
1	N 20 W	29	32	4 3/4
2	N 45 E	24	46	1/2
3	N 35 E	11	57	1
4	N 5 W	15	72	3
5	N 37 W	16	88	3
6	N 25 W	17	105	2 1/2
7	N 4 W	16	121	1
8	N 3 E	20	141	0
9	N 16 W	50	191	
10	N 19 1/4 E	17	208	1/2
11	N 26 E	13	221	1/2
12	N 6 E	21	232	even
13	N 91 W	12	254	5
14	N 47 W	8	262	5
15	N 15 E	23	285	3 1/2 to the rd survey

poplar 14 in
 line N 79 W 56 Links
 Poplar 13 1/2 in N 39 E
 6 Miles

Where as his Roy 14 in Bear N 77 W 38 Links
 The distance altered in this place is 205 Perches

