

Record of State Road Continued

N^o 2

Courses Distances & of N^o 2

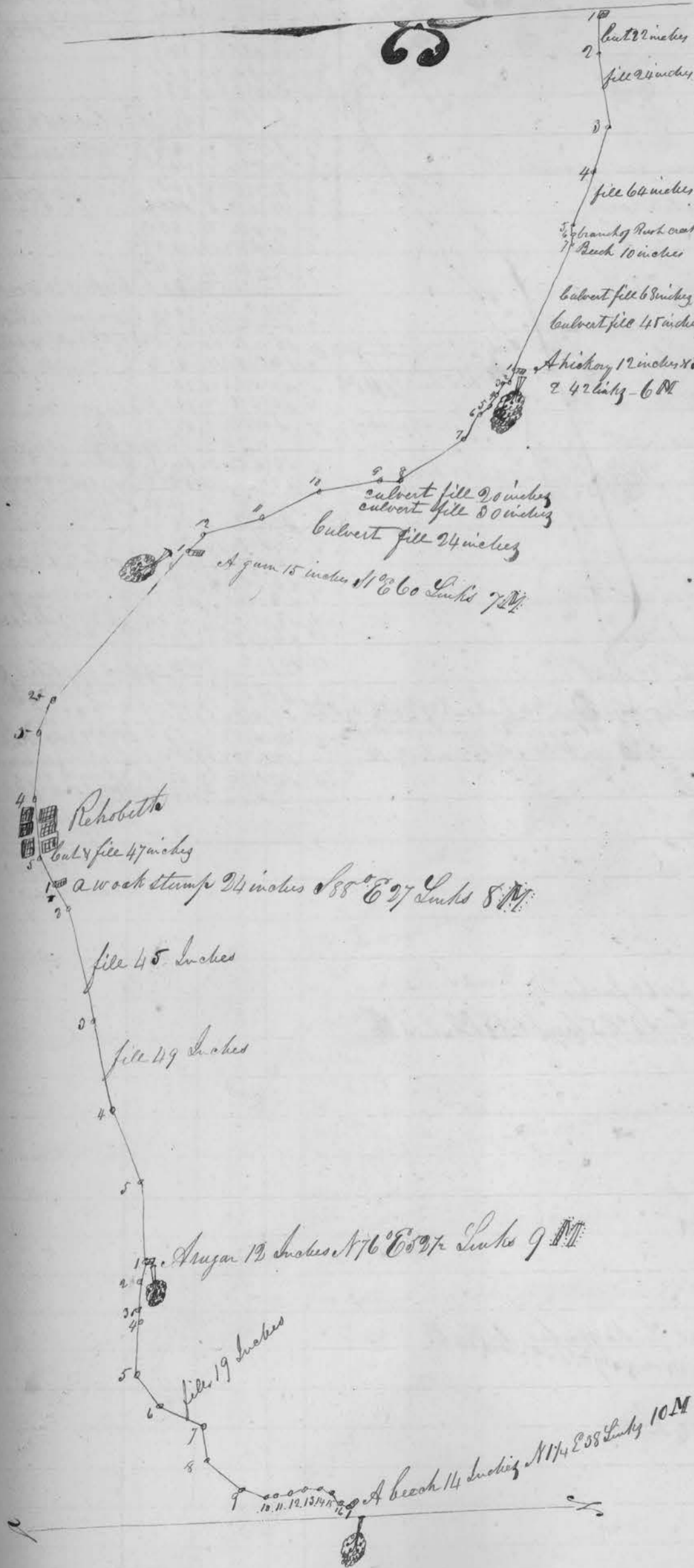

| Sta. | Courses | Distances | Observations |
|------|---------|-----------|--|
| 1 | 88 2/2 | 7.55 | cut 22 inches |
| 2 | 88 7/4 | 15.13 | fill 24 inches |
| 3 | 86 5/2 | 9.37 | |
| 4 | 86 4/2 | 12.22 | fill 64 inches |
| 5 | 88 1/2 | 3.22 | |
| 6 | 87 1/2 | 3.89 | Branch 10 inches small branch of rock creek |
| 7 | 86 1/4 | 28.62 | cut 22 inches do do |
| | | 80.00 | 88 links 3 |
| 1 | 86 1/2 | 21.57 | Hickory 12 inches at 1/2 |
| 2 | 87 1/2 | 14.42 | W 78 5/2 42 mh 6 M |
| 3 | 84 9/2 | 2.20 | |
| 4 | 85 7/2 | 2.79 | cut 22 inches |
| 5 | 83 0/2 | 2.83 | |
| 6 | 85 6/2 | 5.88 | |
| 7 | 82 7/2 | 15.83 | |
| 8 | 81 1/2 | 4.09 | cut 22 inches do do do do |
| 9 | 86 6/2 | 12.41 | |
| 10 | 82 2/2 | 13.00 | cut 22 inches |
| 11 | 81 2/2 | 13.14 | |
| 12 | 84 3/4 | 4.72 | A gum 15 inches 1/2 60 Links 7 M |
| | | 80.00 | 81 2/2 60 links m P 7 M |
| 1 | 84 3/4 | 41.29 | |
| 2 | 86 0/2 | 7.28 | |
| 3 | 88 2/2 | 10.39 | |
| 4 | cut | 12.20 | through Rehoboth |
| 5 | 86 1/2 | 5.84 | cut 22 inches |
| | | 80.00 | A work stump 24 inches in 5 1/2 3 1/2 2 1/2 links marked 8 M |
| 1 | 86 1/2 | 6.00 | |
| 2 | 88 3/2 | 29.53 | fill 45 inches |
| 3 | 88 1/2 | 18.30 | fill 49 inches |
| 4 | 87 1/4 | 16.42 | August 21 1834 |
| 5 | 88 9/2 | 15.75 | fill 12 inches |
| | | 80.00 | 8 1/2 73 1/2 76 2 5/2 2 links marked 9 M |
| 1 | 87 0/2 | 4.00 | |
| 2 | 88 4/2 | 5.76 | |
| 3 | 88 1/4 | 2.98 | |
| 4 | 88 0/2 | 10.92 | |
| 5 | 85 3/2 | 8.03 | |
| 6 | 88 2/2 | 9.23 | fill 19 inches |
| 7 | 88 7/2 | 6.65 | |
| 8 | 84 5/2 | 8.95 | |
| 9 | 81 9/2 | 5.19 | |
| 10 | 85 7/2 | 2.45 | |
| 11 | 85 1/2 | 2.78 | |
| 12 | 82 3/2 | 3.29 | |
| 13 | 87 2/2 | 2.68 | |
| 14 | 88 2/2 | 2.60 | |
| 15 | 84 3/2 | 3.00 | |
| 16 | 85 7/2 | 1.49 | |
| | | 80.00 | A beech 14 inches at 1/2 3 1/2 2 38 links marked 10 M |

Record of State Road Continued

No 3

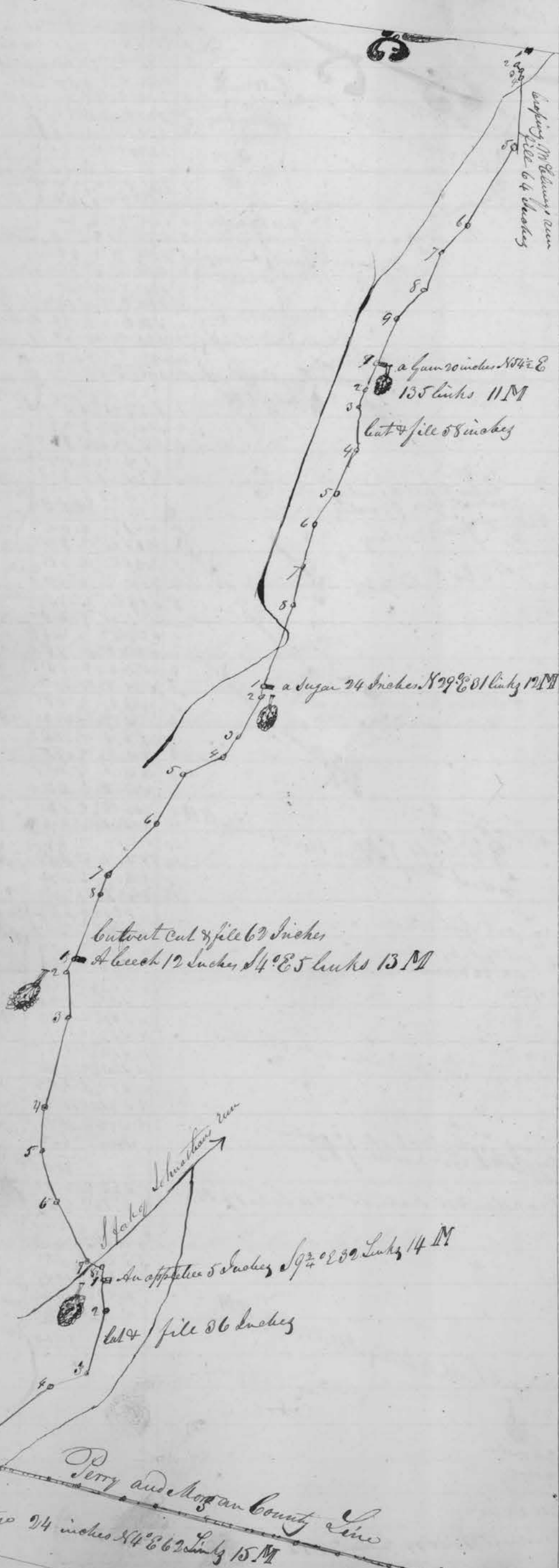

| Station | County | Distance | Observations |
|---------|------------|----------|---------------------------------|
| 1 | N 87 1/2 E | 85 | |
| 2 | N 87 1/4 E | 177 | |
| 3 | N 88 1/2 E | 190 | |
| 4 | N 88 1/2 E | 16.27 | To M. Blunys run fill 64 inches |
| 5 | N 71 1/2 E | 20.60 | |
| 6 | N 57 1/2 E | 8.28 | |
| 7 | N 76 E | 9.61 | |
| 8 | N 57 1/2 E | 8.94 | |
| 9 | N 78 1/2 E | 11.80 | |
| | | 80.00 | |
| 1 | N 78 1/2 E | 6.87 | |
| 2 | N 81 1/4 E | 4.56 | |
| 3 | N 78 1/2 E | 10.17 | |
| 4 | N 80 E | 11.00 | |
| 5 | N 68 E | 8.04 | |
| 6 | N 85 1/2 E | 10.48 | |
| 7 | N 88 1/2 E | 9.48 | |
| 8 | N 85 1/2 E | 10.60 | |
| | | 80.00 | |
| 1 | N 88 1/2 E | 2.70 | |
| 2 | N 70 E | 10.15 | |
| 3 | N 64 1/2 E | 5.70 | |
| 4 | N 66 1/2 E | 10.39 | |
| 5 | N 76 E | 13.22 | |
| 6 | N 88 1/4 E | 16.22 | |
| 7 | N 77 1/2 E | 5.00 | |
| 8 | N 52 E | 16.37 | |
| | | 80.00 | |
| 1 | N 82 E | 2.46 | |
| 2 | N 75 1/4 E | 10.82 | |
| 3 | N 87 1/2 E | 20.62 | |
| 4 | N 76 1/2 E | 10.65 | |
| 5 | N 85 1/2 E | 12.19 | |
| 6 | N 48 E | 15.56 | |
| 7 | N 74 E | 4.65 | |
| 8 | N 72 E | 9.39 | |
| | | 80.00 | |
| 1 | N 72 E | 6.62 | |
| 2 | N 87 1/2 E | 15.50 | |
| 3 | N 88 1/4 E | 8.74 | |
| 4 | N 48 1/2 E | 28.37 | |
| 5 | N 65 1/2 E | 5.20 | |
| 6 | N 77 1/4 E | 15.57 | |
| | | 80.00 | |

To M. Blunys run fill 64 inches
 a gum 20 inches, etc.
 N 85 1/2 E 2135
 links marked 11 M
 cut & fill 58 inches
 Cropping S. run twice
 a sugar 24 inches etc.
 N 82 1/2 E 31 links
 marked 12 M
 Culvert cut & fill
 62 inches
 A beech 12 inches
 S 4 E 5 links 13 M
 links marked 13 M
 Aug 22/1834
 To east side of south
 fork of Southans
 creek
 An apple tree 5 in
 cut, etc. 13 1/2 1/2 0
 E 32 S 14 M
 cut & fill 36 inches
 To Perry & Morgan
 County line
 up side of Blacks
 fork of Southans creek
 Cropping S. fork
 a sugar 24 inches
 N 79 1/2 E 262
 links marked 14 M

Perry and Morgan County line
 a sugar 24 inches N 4 E 62 links 15 M

213

Record of Chain Road Continued

87

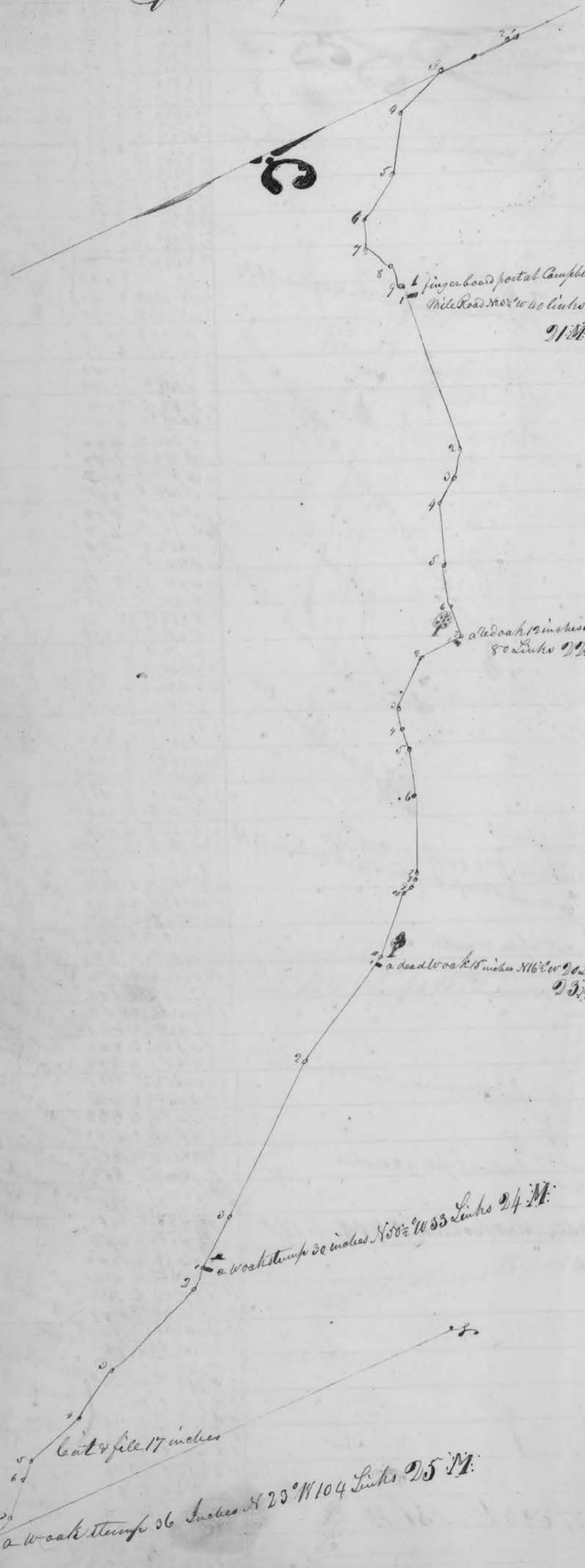

| Sta. | Course | Distance | Observations |
|------|-------------|----------|--------------|
| 1 | S 43° E | 2-00 | |
| 2 | South | 18-20 | |
| 3 | S 21° E | 13-16 | |
| 4 | S 50° E | 10-50 | |
| 5 | S 42° E | 14-26 | |
| 6 | S 69 1/2° E | 7-00 | |
| 7 | N 56° E | 6-37 | |
| 8 | N 77 1/2° E | 5-31 | |
| 9 | S 85 1/2° E | 0-20 | |
| | | 80.00 | |
| 1 | S 83 1/2° E | 36-00 | |
| 2 | S 57° E | 6-41 | |
| 3 | S 55 1/2° E | 6-37 | |
| 4 | S 60 1/2° E | 14-07 | |
| 5 | S 77 1/2° E | 8-50 | |
| 6 | S 81 1/2° E | 4-50 | |
| 7 | S 80 1/2° E | -95 | |
| | | 80.00 | |
| 1 | S 31° E | 8-36 | |
| 2 | S 40 1/2° E | 12-44 | |
| 3 | S 69 1/2° E | 4-63 | |
| 4 | S 84 1/2° E | 4-65 | |
| 5 | S 70 1/2° E | 10-60 | |
| 6 | S 67 1/2° E | 17-35 | |
| 7 | S 45 1/2° E | 1-29 | |
| 8 | South | 1-57 | |
| 9 | S 15 1/2° E | 2-56 | |
| 10 | S 47° E | 14-86 | |
| 11 | S 00° E | 1-61 | |
| | | 80.00 | |
| 1 | S 30° E | 27-59 | |
| 2 | S 39° E | 39-07 | |
| 3 | S 37 1/2° E | 13-34 | |
| | | 80.00 | |
| 1 | S 39° E | 4-60 | |
| 2 | S 20 1/2° E | 26-50 | |
| 3 | S 29 1/2° E | 12-89 | |
| 4 | S 18 1/2° E | 14-29 | |
| 5 | S 41 1/2° E | 4-49 | |
| 6 | S 48 1/2° E | 8-38 | |
| 7 | S 15° E | 9-01 | |
| | | 80.00 | |

finger board post at Campbell's Mill Road. N 80° W 40 links
21 M

Monday 24th Aug 1854
25

A dead oak 12 inches 80 links 21 M

A dead wood 15 inches 10 links 21 M

A w oak stump 30 inches 80 links 21 M

August 26th 1854
cut & file 17 inches

A w oak stump 36 inches 104 links 25 M

13th 5th 3rd 1104 links
marked 25 M

Record of State Road Continued

N. 6



| Station | Course | Distance | Observations |
|---------|-------------|----------|---------------------------|
| 1 | N 15° E | 4-39 | Culvert 24 inches |
| 2 | N 12° E | 2-14 | |
| 3 | N 58 1/2° E | 2-14 | |
| 4 | N 71° E | 1-65 | cut & fill 8 inches |
| 5 | N 85 1/2° E | 3-35 | Bridge 90 feet long over |
| 6 | N 80 1/2° E | 2-96 | Wolf creek |
| 7 | N 82 1/2° E | 2-96 | Wolf creek |
| 8 | N 71 1/2° E | 1-48 | |
| 9 | N 41° E | 16-88 | To branch of wolf creek |
| 10 | N 42 1/2° E | 2-58 | Bridge over Branch of |
| 11 | N 70 1/2° E | 2-07 | wolf creek 94 inches high |
| 12 | N 52 1/2° E | 2-21 | |
| 13 | N 61° E | -64 | |
| 14 | N 80 1/2° E | 2-92 | |
| 15 | N 45° E | 4-95 | |
| 16 | N 86° E | 10-77 | |
| 17 | N 70° E | 6-58 | |
| 18 | N 78° E | 2-09 | |
| 19 | N 66 1/2° E | 2-47 | |
| 20 | N 56 1/2° E | 2-79 | |
| 21 | N 56 1/2° E | 80.00 | |
| 22 | N 56 1/2° E | 2-43 | |
| 23 | N 68° E | 1-90 | |
| 24 | N 77° E | 20-4 | |
| 25 | N 76° E | 6-29 | |
| 26 | N 57 1/2° E | 2-13 | |
| 27 | N 47 1/2° E | 2-00 | |
| 28 | N 83° E | 2-15 | |
| 29 | last | 5-42 | |
| 30 | N 76 1/2° E | 4.00 | |
| 31 | N 66 1/2° E | 1-30 | |
| 32 | N 68° E | 3-42 | |
| 33 | N 64° E | 8.91 | |
| 34 | N 37 1/2° E | 9.50 | |
| 35 | N 31° E | 6.50 | |
| 36 | N 66 1/2° E | 1-40 | |
| 37 | N 66° E | 2-38 | |
| 38 | N 54° E | 2-12 | |
| 39 | N 69 1/2° E | 1-70 | |
| 40 | N 83 1/2° E | 2-30 | |
| 41 | N 64° E | 2-50 | |
| 42 | N 77° E | 3-54 | |
| 43 | N 86 1/2° E | 2-75 | |
| 44 | N 62 1/2° E | 2-46 | |
| 45 | N 68 1/2° E | 7-90 | |
| 46 | N 54° E | 2-22 | |
| 47 | N 59 1/2° E | 6-50 | |
| 48 | N 46 1/2° E | 4-09 | |
| 49 | N 57° E | 3-11 | |
| 50 | N 37° E | 10-60 | |
| 51 | N 38 1/2° E | 4-30 | |
| 52 | N 21 1/2° E | 6-77 | |
| 53 | N 53° E | 5-58 | |
| 54 | N 28 1/2° E | 1-68 | |
| 55 | N 65 1/2° E | 6-09 | |
| 56 | N 78 1/2° E | 5-59 | |
| 57 | N 65° E | 3-69 | |
| 58 | N 87 1/2° E | 7-64 | |
| 59 | N 64 1/2° E | 3-32 | |
| 60 | N 64 1/2° E | 1-50 | |
| 61 | N 59 1/2° E | 14-39 | |
| 62 | N 87° E | 5-50 | |
| 63 | N 86° E | 4-79 | |
| 64 | N 66° E | 6-81 | |
| 65 | N 54 1/2° E | 8-04 | |
| 66 | N 75 1/2° E | 4-04 | |
| 67 | N 49 1/2° E | 2-71 | |
| 68 | N 81 1/2° E | 2-91 | |
| 69 | N 70 1/2° E | 3-14 | |
| 70 | N 56 1/2° E | 2-95 | |
| 71 | N 75 1/2° E | 3-12 | |
| 72 | N 84 1/2° E | 3-90 | |
| 73 | N 76° E | 4-92 | |
| 74 | N 86° E | 2-70 | |
| 75 | N 85 1/2° E | 4-82 | |
| 76 | N 79 1/2° E | 3-76 | |
| 77 | N 79 1/2° E | 80.00 | |
| 78 | N 74 1/2° E | 4-74 | |
| 79 | N 85 1/2° E | 4-06 | |
| 80 | N 77 1/2° E | 2-85 | |
| 81 | N 71 1/2° E | 6-64 | |
| 82 | N 72° E | 1-63 | |
| 83 | N 87 1/2° E | 3-81 | |
| 84 | N 84 1/2° E | 2-52 | |
| 85 | N 78° E | 3-54 | |
| 86 | N 65 1/2° E | 5-71 | |
| 87 | N 81 1/2° E | 5-08 | |
| 88 | N 53 1/2° E | 14-00 | |
| 89 | N 66° E | 11-03 | |
| 90 | N 77 1/2° E | 5-65 | |
| 91 | N 55 1/2° E | 7-70 | |
| 92 | N 55 1/2° E | 80.00 | |

A beech 12 inches N 110° W 50 links 26 M
 west 30 links marked 26 M

A beech 12 inches N 110° W 50 links 26 M

A beech 12 inches N 110° W 50 links 26 M

A beech 12 inches N 110° W 50 links 26 M

A cherry tree 8 inches N 2° E 37 links 28 M
 file 8 inches
 file 38 inches

A beech 12 inches N 45° W 30 links 29 M
 cut & fill 25 inches

A beech 20 inches N 77° E 93 links 30 M

A beech 20 inches N 77° E 93 links 30 M

Record of New Road Continued



| No. Corners | distance | observations |
|-------------|----------|--------------|
| 1 | 11.00 | 4-50 |
| 2 | 9 1/2 | 1-56 |
| 3 | 8 1/2 | 1-16 |
| 4 | 8 1/2 | -57 |
| 5 | 8 1/2 | 1-94 |
| 6 | 8 1/2 | 2-18 |
| 7 | 8 1/2 | -40 |
| 8 | 8 1/2 | 2-24 |
| 9 | 8 1/2 | 1-52 |
| 10 | 8 1/2 | 1-37 |
| 11 | 8 1/2 | 1-54 |
| 12 | 8 1/2 | 2-08 |
| 13 | 8 1/2 | 4-10 |
| 14 | 8 1/2 | 4-11 |
| 15 | 8 1/2 | 1-62 |
| 16 | 8 1/2 | -71 |
| 17 | 8 1/2 | 2-08 |
| 18 | 8 1/2 | 7-18 |
| 19 | 8 1/2 | 21-78 |
| 20 | 8 1/2 | 2-95 |
| 21 | 8 1/2 | 2-95 |
| 22 | 8 1/2 | 10-10 |
| | | 80.00 |
| 1 | 8 1/2 | -60 |
| 2 | 8 1/2 | 18-05 |
| 3 | 8 1/2 | 9-16 |
| 4 | 8 1/2 | 8-57 |
| 5 | 8 1/2 | 11-55 |
| 6 | 8 1/2 | 9-70 |
| 7 | 8 1/2 | 2-99 |
| 8 | 8 1/2 | 2-50 |
| 9 | 8 1/2 | 1-52 |
| 10 | 8 1/2 | 1-61 |
| 11 | 8 1/2 | 2-19 |
| 12 | 8 1/2 | 1-65 |
| 13 | 8 1/2 | 1-32 |
| 14 | 8 1/2 | 1-40 |
| 15 | 8 1/2 | 1-73 |
| 16 | 8 1/2 | 1-29 |
| 17 | 8 1/2 | 1-06 |
| 18 | 8 1/2 | 1-04 |
| | | 80.00 |
| 1 | 8 1/2 | 2-6 |
| 2 | 8 1/2 | 1-9 |
| 3 | 8 1/2 | 1-57 |
| 4 | 8 1/2 | 1-77 |
| 5 | 8 1/2 | 1-20 |
| 6 | 8 1/2 | 2-27 |
| 7 | 8 1/2 | 2-00 |
| 8 | 8 1/2 | 6-60 |
| 9 | 8 1/2 | 15-59 |
| 10 | 8 1/2 | 2-76 |
| 11 | 8 1/2 | 2-25 |
| 12 | 8 1/2 | 2-42 |
| 13 | 8 1/2 | 4-98 |
| 14 | 8 1/2 | 8-12 |
| 15 | 8 1/2 | 6-60 |
| 16 | 8 1/2 | 2-10 |
| 17 | 8 1/2 | 1-80 |
| 18 | 8 1/2 | 3-30 |
| 19 | 8 1/2 | 2-50 |
| 20 | 8 1/2 | 8-22 |
| | | 80.00 |
| 1 | 8 1/2 | 2-00 |
| 2 | 8 1/2 | 10-15 |
| 3 | 8 1/2 | 7-94 |
| 4 | 8 1/2 | 4-94 |
| 5 | 8 1/2 | 11-01 |
| 6 | 8 1/2 | 7-32 |
| 7 | 8 1/2 | 8-34 |
| 8 | 8 1/2 | 3-27 |
| 9 | 8 1/2 | 2-42 |
| 10 | 8 1/2 | 10-30 |
| 11 | 8 1/2 | 2-68 |
| 12 | 8 1/2 | 1-28 |
| 13 | 8 1/2 | 1-93 |
| 14 | 8 1/2 | 1-96 |
| 15 | 8 1/2 | 2-27 |
| 16 | 8 1/2 | 1-19 |
| | | 80.00 |
| 1 | 8 1/2 | 1-24 |
| 2 | 8 1/2 | 1-76 |
| 3 | 8 1/2 | 3-74 |
| 4 | 8 1/2 | 3-24 |
| 5 | 8 1/2 | 5-44 |
| 6 | 8 1/2 | 4-62 |
| 7 | 8 1/2 | 1-56 |
| 8 | 8 1/2 | 1-72 |
| 9 | 8 1/2 | 2-13 |
| 10 | 8 1/2 | 2-92 |
| 11 | 8 1/2 | 5-21 |
| 12 | 8 1/2 | 5-90 |
| 13 | 8 1/2 | 1-364 |
| 14 | 8 1/2 | 4-54 |
| 15 | 8 1/2 | 7-78 |
| 16 | 8 1/2 | 6-95 |
| 17 | 8 1/2 | 7-62 |
| | | 80.00 |

To Clumens' run
 cut & file 60 inches to
 on Centre street Malta
 cut & file 36 inches cut 36 inches
 Mustangum River a bridge
 70 inches high over a run
 To mile in Mustangum
 River 60 links W of low
 water mark on S side east
 bank of river a poplar
 marked 31 M in west end
 of Centre street M Councils
 up Centre street M Councils
 Aug 28 29 1854
 Culvert
 bridge over run
 84 inches high
 A beech 8 inches D.B. 27 7/8
 246 links marked B 2 M
 Point cut 30 inches
 cut & file 8 inches
 A beech 14 inches D.B. 27 1/2
 Links marked B 3 M
 August 30 1854
 cut 13 inches
 cut 36 inches
 A beech 12 inches D.B. 27 1/2
 270 links marked B 4 M
 fill 78 inches
 fill 30 inches
 Cropping 4 mile Creek
 cut 36 inches
 To a Black oak
 A beech 10 inches D.B.
 (B.D. 40° W 32 links
 marked B 5 M.

Records of State Road Continued

No. 5

Sta. course distance observations

| | | |
|-------|------------|-------|
| 1 | 897 | 29.08 |
| 2 | 874 | 6.28 |
| 3 | 851 | 4.68 |
| 4 | 836 | 4.71 |
| 5 | 827 | 3.47 |
| 6 | 822 | 6.63 |
| 7 | 812 | 2.65 |
| 8 | 801 | 4.00 |
| 9 | 787 | 4.50 |
| 10 | 774 | 1.30 |
| 11 | 761 | 3.08 |
| 12 | 747 | 41.31 |
| 13 | 739 | 1.60 |
| 14 | 722 | 1.68 |
| 15 | 702 | 1.27 |
| 16 | 688 | 1.51 |
| 17 | 672 | 1.78 |
| 18 | 663 | 1.18 |
| 19 | 657 | 7.63 |
| 20 | 654 | 3.40 |
| 21 | 649 | 6.40 |
| 22 | 639 | 1.15 |
| <hr/> | | |
| 1 | 532 | 35 |
| 2 | 462 | 3.80 |
| 3 | 332 | 32.82 |
| 4 | Cast 41-02 | |
| <hr/> | | |
| 1 | cast | 14.50 |
| 2 | 602 | 7.67 |
| 3 | 712 | 7.95 |
| 4 | 64 | 4.90 |
| 5 | 562 | 5.50 |
| 6 | 602 | 6.71 |
| 7 | 892 | 5.90 |
| 8 | 837 | 3.20 |
| 9 | 40 | 6.17 |
| 10 | 684 | 7.16 |
| <hr/> | | |
| 1 | 684 | 9.40 |
| 2 | 892 | 25.36 |
| 3 | 834 | 9.17 |
| 4 | 69 | 7.40 |
| 5 | 574 | 1.90 |
| 6 | 57 | 2.39 |
| 7 | 71 | 2.29 |
| 8 | 774 | 4.13 |
| 9 | 652 | 3.11 |
| 10 | 654 | 3.94 |
| 11 | 042 | 2.64 |
| 12 | 642 | 2.91 |
| 13 | 67 | 4.10 |
| 14 | 732 | 1.32 |
| <hr/> | | |
| 1 | 702 | 1.03 |
| 2 | 77 | 31.41 |
| 3 | 57 | 8.54 |
| 4 | 67 | 9.80 |
| 5 | 26 | 6.32 |
| 6 | 25 | 2.18 |
| 7 | 7 | 6.29 |
| 8 | 372 | 5.9 |
| 9 | 70 | 1.43 |
| 10 | 862 | 37 |
| 11 | 652 | 1.83 |
| 12 | 60 | 1.81 |
| 13 | 652 | 5.72 |
| 14 | 662 | 4.28 |
| <hr/> | | |
| 1 | 702 | 1.03 |
| 2 | 77 | 31.41 |
| 3 | 57 | 8.54 |
| 4 | 67 | 9.80 |
| 5 | 26 | 6.32 |
| 6 | 25 | 2.18 |
| 7 | 7 | 6.29 |
| 8 | 372 | 5.9 |
| 9 | 70 | 1.43 |
| 10 | 862 | 37 |
| 11 | 652 | 1.83 |
| 12 | 60 | 1.81 |
| 13 | 652 | 5.72 |
| 14 | 662 | 4.28 |

file 82 inches
cut 72 inches
culvert file 140 inches
A Branch 20 links N 13° 24' E
18 links marked 86 M
August 31 1824
Sept 1 - file 80 inches
file 9 inches
Anaphletes B 367 E 270
links marked 87 M
cut & file 79 inches
Culvert & file 56 inches
stone culvert
cut & file 36 inches through Bristol
file 53 inches
cut & file 40 inches
Bridge over Bear run
A wild cherry tree 5 inches D 39
150 links marked 88 M

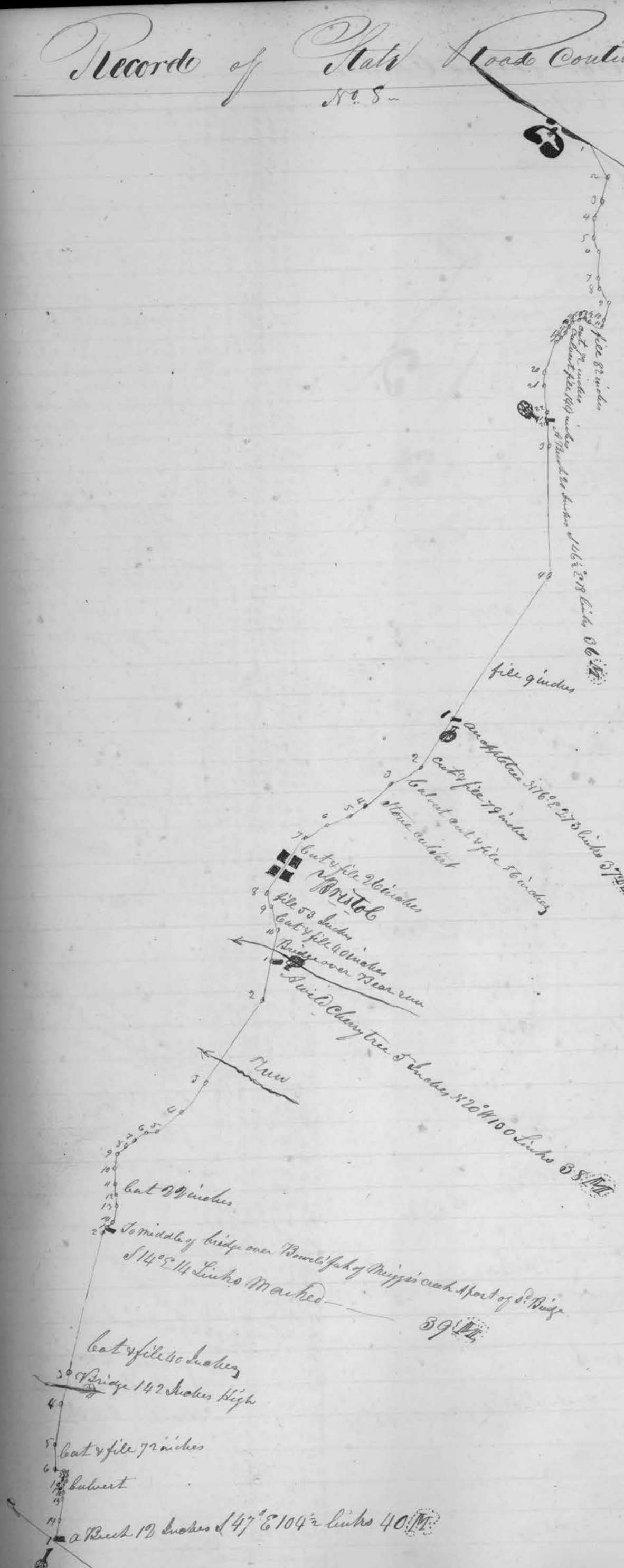

file 9 inches
cut & file 79 inches
stone culvert
cut & file 9 inches
file 53 inches
cut & file 40 inches
Bridge over Bear run
Wild Cherry tree 5 inches
A Branch 13 links N 14° E 114 links marked 39 M
cut & file 40 inches
Bridge 142 inches High
cut & file 72 inches
culvert
A Branch 13 links N 47° E 104 1/2 links 40 M

217

Record of State Road Continued

No. 9

| Sta | Course | distance | observations |
|-----|----------|----------|-------------------------------------|
| 1 | X 66 1/2 | 1.53 | |
| 2 | X 69 1/2 | 1.58 | |
| 3 | X 50 1/2 | 1.49 | file 94 inches |
| 4 | X 74 | 1.48 | cut 48 inches |
| 5 | X 63 1/2 | 1.82 | |
| 6 | X 80 | 1.88 | |
| 7 | X 68 1/2 | 1.79 | |
| 8 | X 78 1/2 | 2.00 | |
| 9 | X 83 1/2 | 2.40 | |
| 10 | X 79 1/2 | 1.88 | |
| 11 | X 15 | 7.41 | cut 77 inches file 38 inches |
| 12 | X 69 | 5.02 | |
| 13 | X 62 1/2 | 6.58 | |
| 14 | X 89 1/2 | 8.47 | |
| 15 | X 66 1/2 | 9.14 | file 18 inches New Bedford |
| 16 | X 54 | 9.10 | |
| 17 | X 16 | 4.10 | |
| 18 | X 56 1/2 | 2.18 | |
| 19 | X 50 1/2 | 2.47 | |
| 20 | X 48 1/2 | 1.45 | |
| 21 | X 40 1/2 | 1.47 | |
| 22 | X 84 | 1.27 | |
| 23 | X 83 1/2 | 1.78 | |
| 24 | X 49 | 1.50 | |
| 25 | X 81 | 1.56 | |
| 26 | X 73 | 1.40 | |
| 27 | X 79 | 2.80 | |
| 28 | X 62 | 1.48 | |
| | | 80.00 | |
| 1 | X 62 | 2.56 | |
| 2 | X 70 | 2.59 | |
| 3 | X 56 1/2 | 2.00 | |
| 4 | X 57 1/2 | 2.17 | |
| 5 | X 60 1/2 | 1.29 | |
| 6 | X 54 | 1.48 | |
| 7 | X 54 1/2 | 2.65 | |
| 8 | X 45 1/2 | 2.28 | Ridge 42 inches high |
| 9 | X 83 1/2 | 2.22 | |
| 10 | X 76 1/2 | 2.00 | cut 48 inches |
| 11 | X 73 1/2 | 1.63 | |
| 12 | X 11 1/2 | 8.18 | |
| 13 | X 2 1/2 | 7.79 | file 32 inches |
| 14 | X 26 1/2 | 2.48 | cut 78 inches |
| 15 | X 11 1/2 | 2.29 | file 22 inches |
| 16 | X 20 1/2 | 2.25 | culvert |
| 17 | X 25 1/2 | 2.83 | |
| 18 | X 24 1/2 | 2.70 | |
| 19 | X 84 1/2 | 2.65 | |
| 20 | X 1 1/2 | 2.27 | |
| 21 | X 16 1/2 | 2.88 | |
| 22 | X 5 1/2 | 4.76 | |
| 23 | X 13 | 3.92 | |
| | | 80.00 | |
| 1 | X 13 | 2.03 | |
| 2 | X 15 | 1.04 | |
| 3 | X 11 1/2 | 8.50 | |
| 4 | X 31 1/2 | 6.99 | Sept 3 1884 |
| 5 | X 20 | 7.53 | Sept 4 - |
| 6 | X 30 | 4.46 | |
| 7 | X 52 1/2 | 6.68 | |
| 8 | X 55 | 5.07 | |
| 9 | X 47 1/2 | 4.60 | |
| 10 | X 39 | 4.34 | |
| 11 | X 32 | 3.38 | |
| 12 | X 41 1/2 | 3.50 | cut & file 96 inches |
| 13 | X 28 | 2.21 | cut oak stump 24 inches |
| 14 | X 22 1/2 | 3.50 | Sept. No. 10 77 links marked 4 B.M. |
| 15 | X 4 1/2 | 2.90 | |
| | | 80.00 | |
| 1 | X 4 1/2 | 1.50 | |
| 2 | X 5 1/2 | 4.00 | |
| 3 | X 24 1/2 | 2.19 | |
| 4 | X 6 | 4.28 | |
| 5 | X 9 1/2 | 5.75 | |
| 6 | X 33 1/2 | 5.45 | |
| 7 | X 53 1/2 | 2.75 | |
| 8 | X 68 | 3.95 | |
| 9 | X 57 1/2 | 6.33 | |
| 10 | X 83 1/2 | 7.82 | |
| 11 | X 85 1/2 | 4.00 | |
| 12 | X 85 1/2 | 6.00 | |
| 13 | X 60 1/2 | 3.50 | |
| 14 | X 18 1/2 | 5.50 | |
| 15 | X 63 | 3.92 | |
| 16 | X 50 | 3.29 | |
| 17 | X 88 1/2 | 5.30 | |
| 18 | X 73 1/2 | 1.68 | |
| | | 80.00 | |
| 1 | X 52 1/2 | 2.02 | |
| 2 | X 89 1/2 | 4.18 | |
| 3 | X 75 1/2 | 2.41 | |
| 4 | X 55 1/2 | 2.76 | |
| 5 | X 18 1/2 | 2.62 | |
| 6 | X 57 | 2.50 | |
| 7 | X 35 | 4.11 | |
| 8 | X 60 1/2 | 2.07 | |
| 9 | X 47 1/2 | 1.13 | |
| 10 | X 49 1/2 | 2.41 | |
| 11 | X 42 | 1.78 | |
| 12 | X 57 | 2.05 | |
| 13 | X 57 1/2 | 1.76 | |
| 14 | X 67 1/2 | 1.99 | |
| 15 | X 50 | 1.76 | |
| 16 | X 24 | 1.11 | |
| 17 | X 6 1/2 | 1.00 | |
| 18 | X 2 1/2 | 2.08 | |
| 19 | X 5 1/2 | 4.79 | |
| 20 | X 67 | 16.27 | |
| 21 | X 86 | 25.10 | |
| 22 | X 50 | 2.30 | |
| 23 | X 26 1/2 | 1.78 | |
| 24 | X 13 1/2 | 1.75 | |
| 25 | X 72 1/2 | 2.00 | |
| 26 | X 21 | 1.70 | |
| 27 | X 49 1/2 | 2.08 | |
| 28 | X 57 | 1.66 | |
| 29 | X 36 1/2 | .88 | |
| | | 80.00 | |

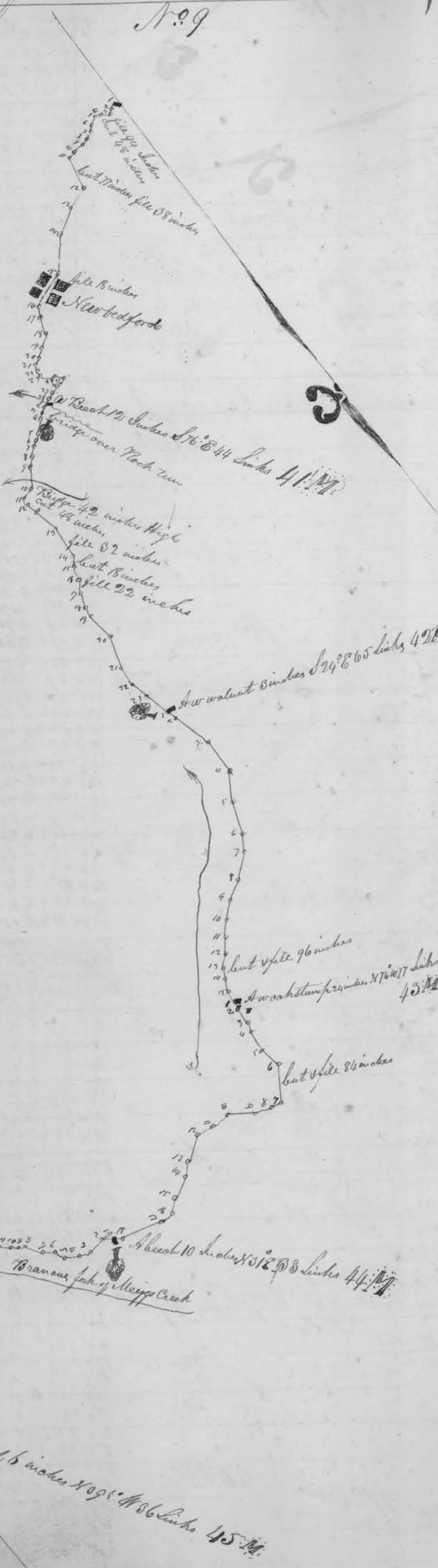

file 94 inches
cut 48 inches

cut 77 inches file 38 inches

file 18 inches New Bedford

A Branch 12 inches Oct 13 1884 76° E 44
links marked 4 B.M.

Bridge over rock run

Ridge 42 inches high

cut 48 inches

file 32 inches
cut 78 inches
file 22 inches
culvert

A Walnut 3 inches Oct 13 1884
links marked 4 B.M.

Sept 3 1884
Sept 4 -

cut & file 96 inches
cut oak stump 24 inches
Sept. No. 10 77 links marked 4 B.M.

A Branch 10 inches Oct 13 1884 81° E 33
links marked 4 B.M.

So Branches fork of Meigs Creek

A Branch 6 inches Nov 9 1884 86° E 36 links 45 B.M.

219
 Record of State road Continued
 No. 11

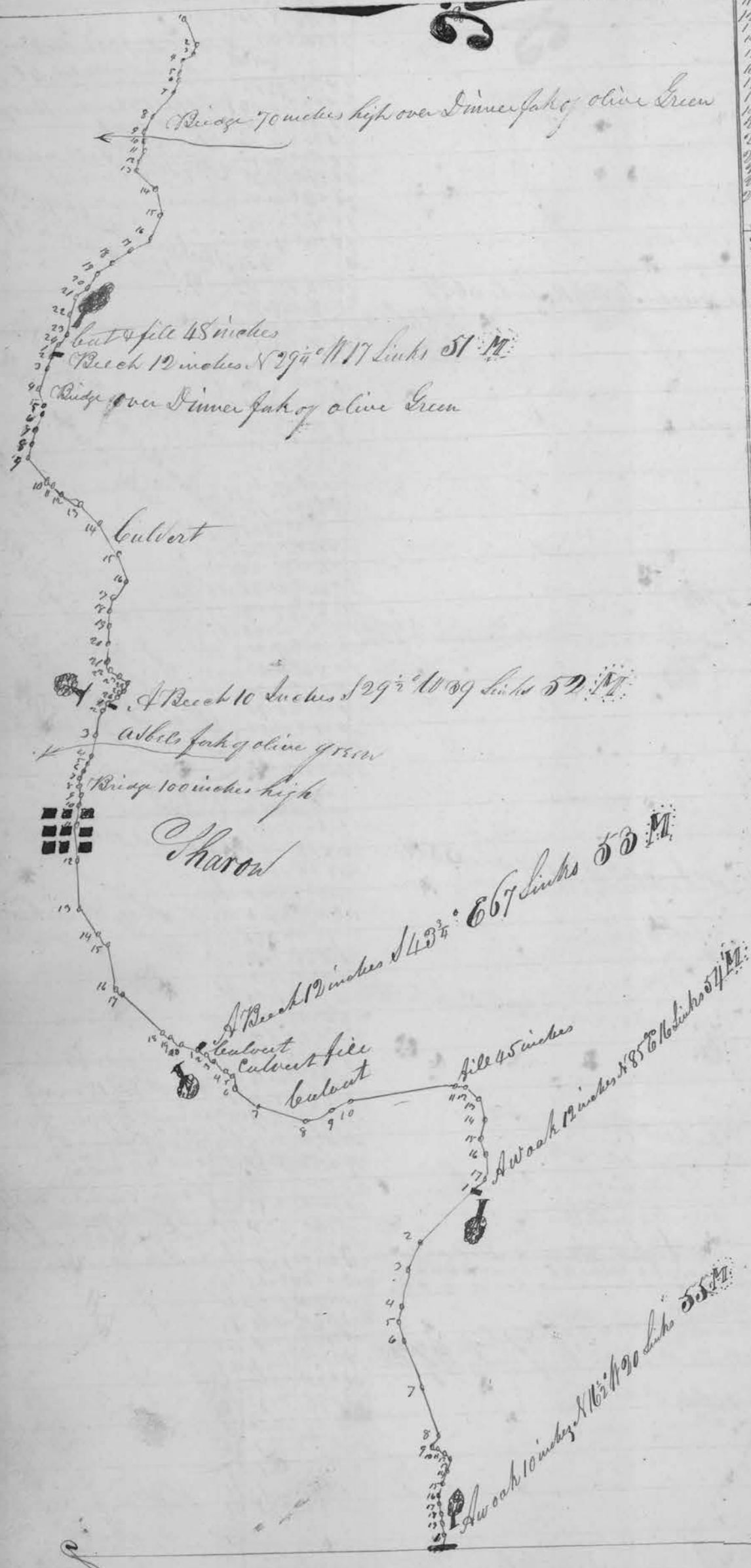

| No. | Covering | Station | Observations |
|-----|----------|---------|--|
| 1 | X68 1/2 | 5.97 | |
| 2 | 55 1/2 | 1.98 | |
| 3 | 36 | 2.11 | |
| 4 | 36 1/2 | 2.50 | |
| 5 | 36 1/2 | 1.57 | |
| 6 | 36 1/2 | 2.36 | |
| 7 | 36 1/2 | 6.21 | |
| 8 | 65 1/2 | 3.40 | |
| 9 | 87 1/2 | 1.21 | Bridge 70 inches high over Dinner |
| 10 | 85 1/2 | 2.47 | Sept 1834 Fork of olive Green |
| 11 | 87 1/2 | 1.61 | |
| 12 | 70 1/2 | 1.82 | |
| 13 | 48 | 5.04 | |
| 14 | 79 | 5.00 | |
| 15 | 61 | 5.11 | |
| 16 | 80 | 4.71 | |
| 17 | 83 1/2 | 4.50 | |
| 18 | 35 1/2 | 3.59 | |
| 19 | 83 1/2 | 3.57 | |
| 20 | 44 | 2.83 | |
| 21 | 59 | 0.66 | |
| 22 | 81 1/2 | 4.31 | |
| 23 | 44 1/2 | 2.10 | |
| 24 | 21 1/2 | 1.20 | |
| 25 | 86 | 1.52 | |
| | | | Culvert file 48 inches |
| | | | A Breach 12 inches D.P. 13 1/2 29 1/2 |
| | | | 10 1/2 Links marked 51 1/2 |
| 1 | 36 | 6.2 | |
| 2 | 67 1/2 | 2.69 | |
| 3 | 65 | 4.36 | |
| 4 | 75 1/2 | 3.76 | |
| 5 | 75 1/2 | 1.18 | |
| 6 | 63 1/2 | 2.09 | |
| 7 | 70 1/2 | 2.67 | |
| 8 | 81 1/2 | 2.23 | |
| 9 | 77 1/2 | 5.90 | |
| 10 | 46 | 1.58 | |
| 11 | 110 1/2 | 2.35 | |
| 12 | 81 1/2 | 11.26 | |
| 13 | 48 1/2 | 11.81 | |
| 14 | 57 1/2 | 6.81 | |
| 15 | 77 1/2 | 5.88 | |
| 16 | 45 | 11.48 | |
| 17 | 83 1/2 | 2.17 | |
| 18 | 82 1/2 | 3.79 | |
| 19 | 87 1/2 | 3.03 | |
| 20 | 86 1/2 | 3.70 | |
| 21 | 86 1/2 | 1.38 | |
| 22 | 72 | 2.19 | |
| 23 | 77 1/2 | 1.95 | |
| 24 | 89 1/2 | 1.49 | |
| 25 | 89 | 1.15 | |
| 26 | 82 1/2 | 2.28 | |
| | | | 80.00 |
| | | | Culvert |
| | | | Cut 18 inches |
| | | | Culvert file 94 inches |
| | | | A Breach 10 inches D.P. 10 1/2 19 1/2 |
| | | | 10 1/2 Links marked 52 1/2 |
| 1 | 41 | 1.94 | |
| 2 | 68 | 4.94 | |
| 3 | 81 1/2 | 4.87 | |
| 4 | 43 | 1.72 | |
| 5 | 65 1/2 | 1.75 | |
| 6 | 60 1/2 | 2.20 | |
| 7 | 78 | 1.14 | |
| 8 | 79 1/2 | 1.12 | |
| 9 | 53 1/2 | 2.74 | |
| 10 | 81 1/2 | 4.00 | |
| 11 | 89 | 6.73 | |
| 12 | 89 | 9.44 | |
| 13 | 77 1/2 | 5.66 | |
| 14 | 54 1/2 | 2.87 | |
| 15 | 78 | 8.85 | |
| 16 | 46 1/2 | 1.46 | |
| 17 | 45 | 1.13 | |
| 18 | 82 1/2 | 1.46 | |
| 19 | 89 1/2 | 2.53 | |
| 20 | 81 1/2 | 4.05 | |
| | | | 80.00 |
| | | | Culvert |
| | | | Culvert file |
| 1 | 82 1/2 | 1.77 | |
| 2 | 87 | 1.65 | |
| 3 | 81 1/2 | 3.30 | |
| 4 | 46 1/2 | 1.83 | |
| 5 | 66 1/2 | 3.13 | |
| 6 | 10 1/2 | 5.26 | |
| 7 | 15 1/2 | 9.79 | |
| 8 | 21 1/2 | 4.91 | |
| 9 | 18 1/2 | 4.50 | |
| 10 | 7 1/2 | 20.84 | |
| 11 | 11 1/2 | 2.47 | |
| 12 | 89 1/2 | 3.16 | |
| 13 | 78 1/2 | 4.82 | |
| 14 | 77 1/2 | 3.54 | |
| 15 | 67 1/2 | 3.09 | |
| 16 | 87 1/2 | 4.44 | |
| 17 | 41 1/2 | 3.00 | |
| | | | 80.00 |
| | | | file 48 inches |
| 1 | 41 1/2 | 14.72 | |
| 2 | 60 | 5.75 | |
| 3 | 79 | 7.81 | |
| 4 | 71 1/2 | 2.42 | |
| 5 | 72 | 3.89 | |
| 6 | 70 | 10.83 | |
| 7 | 74 | 16.00 | |
| 8 | 45 1/2 | 2.99 | |
| 9 | 81 1/2 | 11.66 | |
| 10 | 86 1/2 | 11.71 | |
| 11 | 60 | 1.54 | |
| 12 | 88 1/2 | 1.94 | |
| 13 | 46 1/2 | 2.90 | |
| 14 | 74 1/2 | 2.17 | |
| 15 | Cast | 1.53 | |
| 16 | 75 | 1.65 | |
| 17 | 81 | 20.88 | |
| 18 | 78 1/2 | 1.93 | |
| 19 | 79 | 5.30 | |
| | | | 80.00 |
| | | | A breach 12 inches D.P. 10 1/2 16 1/2 20 1/2 |
| | | | 6 1/2 Links marked 57 1/2 |
| | | | A breach 10 inches D.P. 10 1/2 16 1/2 20 1/2 |
| | | | Links marked 55 1/2 |