

Record of State Road Continued



Sta	Course	Dist	Remarks
1	S 84 W	28	
2	S 89 W	28	
3	S 85 W	19	
4	S 33 W	39	
5	S 47 W	38	
6	S 54 W	50	
7	S 76 W	17	
8	S 10 W	49	
9	S 7 W	22	
20 Miles		320	Beats 24 & 25 in S 70 W 20 Lines
1	S 20 W	20	
2	S 5 E	26	
3	S 16 E	18	
4	S 45 W	14	
5	S 13 W	10	
6	S 82 W	10	
7	S 8 E	18	
8	S 1 W	18	
9	S 63 W	50	
10	S 2 W	24	
11	S 22 W	38	
12	S 20 W	14	
13	S 60 W	43	
14	S 11 W	13	
21 Miles		320	Beats 11 & 12 in S 44 W 20 Lines
1	S 11 W	22	
2	S 8 W	34	
3	S 22 W	42	
4	S 17 W	24	
5	S 19 W	14	
6	S 4 W	17	
7	S 70 W	37	
8	S 63 W	26	
9	S 63 W	18	
10	S 63 W	44	
11	S 60 W	10	
12	S 29 W	28	
22 Miles		320	
1	S 29 W	4	
2	S 62 W	15	
3	S 28 W	27	
4	S 19 W	22	
5	S 10 W	52	
6	S 87 W	10	
7	S 23 W	50	
8	S 57 W	17	
9	S 83 W	11	
10	N 82 W	85	
11	N 75 W	105	
12	N 80 W	25	
13	S 48 W	28	
14	S 43 W	12	
15	S 32 W	14	
16	S 3 W	14	
23 Miles		320	White oak 30 in Dia S 23 W 40 Lines

Record of State Road Continuation



St	Course	Dist
1	S 52 1/2 W	36
2	S 44 W	14
3	S 58 1/2 W	18
4	S 65 1/2 W	16
5	S 81 1/2 W	40
6	S 87 W	12
7	S 87 1/2 W	12
8	S 63 W	8
9	S 39 W	18
10	S 45 W	42
11	S 9 W	3 7/10
12	S 1 E	3 1/10
13	S 16 E	6 7/10
14	S 25 1/2 E	5 5
15	S 7 E	12
16	South	7 25/100
17	S 7 E	11 25
18	S 5 W	10
19	S 8 1/2 W	20 3/4
20	N 39 W	6 1/4
21	N 9 W	4 1/2
22	N 65 W	5 1/4
23	N 87 1/2 W	3 05/100
24	S 7 1/2 W	1 1/4

St	Course	Dist
1	S 26 W	14
2	S 21 W	6 3/4
3	S 18 E	1 1/2
4	S 29 E	3 1/2
5	S 75 1/2 W	21 1/2
6	S 58 W	10
7	S 67 W	20
8	S 72 1/2 W	3 1/2
9	S 40 1/2 W	2 1/4
10	S 73 W	10
11	N 80 W	28
12	S 70 W	25
13	S 38 1/2 W	32
14	S 69 W	19
15	N 89 1/2 W	26
16	S 53 W	6

27 Miles 320
 N 20 1/2 W 15 1/2 S 15 1/2 E 15 1/2

1	S 89 W	69
2	S 30 1/2 W	31
3	S 22 W	41
4	N 69 W	27
5	N 84 W	27
6	N 75 W	27
7	S 77 W	22
8	S 80 W	22
9	S 49 1/2 W	30
10	S 48 W	28
11	S 22 W	14

24 Miles 320
 Nitrop Rocks 20 to 20 1/2 N 20 1/2 E 15 1/2

1	S 75 W	2
2	S 52 1/2 W	3 1/2
3	S 36 W	3 1/2
4	S 14 1/2 W	3 1/2
5	South	5
6	S 16 W	3 1/4
7	S 27 E	3 1/2
8	S 18 1/2 E	4 1/2
9	S 38 W	3 1/2
10	S 53 W	7
11	S 69 1/2 W	7 1/2
12	S 78 W	14
13	S 20 E	18
14	S 29 E	32
15	S 20 E	21 1/2
16	S 18 E	5 1/2
17	S 7 1/2 E	6 1/4
18	S 21 1/2 W	16 1/2
19	S 5 W	38
20	S 37 1/2 E	38
21	S 14 W	14
22	S 27 W	20
23	S 25 W	20
24	S 21 1/2	14
25	S 4 W	16
26	S 7 1/2 E	10

28 Miles 320
 Nitrop Sugar Hill
 S 48 W 42
 Marked 28 N

25 Miles 320
 White Oak 30 to 30 1/2 N 75 W 30 1/2

1	S 7 1/2 E	6
2	S 2 E	14
3	S 11 1/2 E	20
4	S 6 E	32
5	S 17 W	22
6	S 29 W	14
7	S 44 W	12
8	S 60 W	14
9	S 87 W	5
10	N 69 1/2 W	11 25
11	S 86 W	20 9
12	S 57 W	8 7 1/2
13	S 30 W	10
14	S 26 1/4 W	7
15	S 9 1/2 W	11
16	S 10 W	10
17	S 19 1/2 W	8
18	S 7 E	9
19	S 11 E	13 1/2
20	S 22 1/2 E	11 1/2
21	S 29 E	18
22	S 27 E	11
23	S 49 E	6
24	S 44 W	7
25	S 17 W	9 1/2
26	S 7 1/2 E	10

26 Miles 320
 White Oak 30 to 30 1/2 N 75 W 30 1/2
 Marked 26 N

Record of State Road Continued

Sta	Course	Dist	Notes
1	S 22 W	14	
2	S 47 W	18	
3	S 21 W	12	
4	S 59 W	28	
5	S 64 1/2 W	48	
6	S 51 W	32	
7	S 35 W	36	
8	S 67 1/2 W	14	
9	S 43 W	20	
10	S 85 W	14	
11	S 41 W	31	
12	N 81 W	33	
13	N 59 W	14	
29 Miles		320	Back to India S 61 1/2 W 31 Links

1	N 59 W	3	
2	S 38 1/2 W	14	
3	N 76 1/2 W	15	
4	S 67 1/2 W	17	
5	N 85 1/2 W	15	
6	S 42 1/2 W	18	
7	S 67 W	12	
8	S 85 W	15	
9	S 34 W	23	
10	S 55 W	18	
11	S 88 W	18	
12	N 47 W	23 1/2	
13	S 57 1/2 W	10 1/2	
14	N 70 W	19 1/2	
15	N 51 W	7 3/8	
16	N 67 W	8 4/5	
17	S 86 W	16 2/5	
18	N 69 1/2 W	40 1/5	
19	N 62 W	34	Back to India S 49 1/2 W 71 Links
30 Miles		320	

1	N 62 W	12	
2	N 88 W	18	
3	N 88 1/2 W	46	Woodford's Corn Pump in Pub Square
4	N 69 W	24	
5	N 67 W	26	
6	N 42 W	12	
7	N 87 1/2 W	25	
8	S 73 W	29	
9	S 82 W	35	
10	N 74 1/2 W	37	
11	N 80 W	19	
12	N 73 W	37	
31 Miles		320	Back to India S 21 1/2 W 46 Links

1	N 89 1/2 W	26	
2	N 12 1/2 W	24	
3	N 1 W	54	
4	N 10 1/2 E	14	
5	N 26 W	38	
6	N 26 1/2 W	40	
7	N 57 1/2 W	26	
8	N 63 W	72	
9	N 75 1/2 W	22	
32 Miles		320	Sum 10 in India N 51 W 48 Links

1	N 75 1/2 W	4	
2	N 64 W	48	
3	N 85 1/2 W	45	
4	S 64 W	41	
5	S 77 1/2 W	34	
6	S 43 W	15.1	
7	S 73 W	27.5	
8	S 58 1/2 W	42	
9	S 57 1/2 W	54	
10	S 44 1/2 W	16	
11	S 30 W	24	
33 Miles		320	White oak 30 in India S 77 W 33 Links

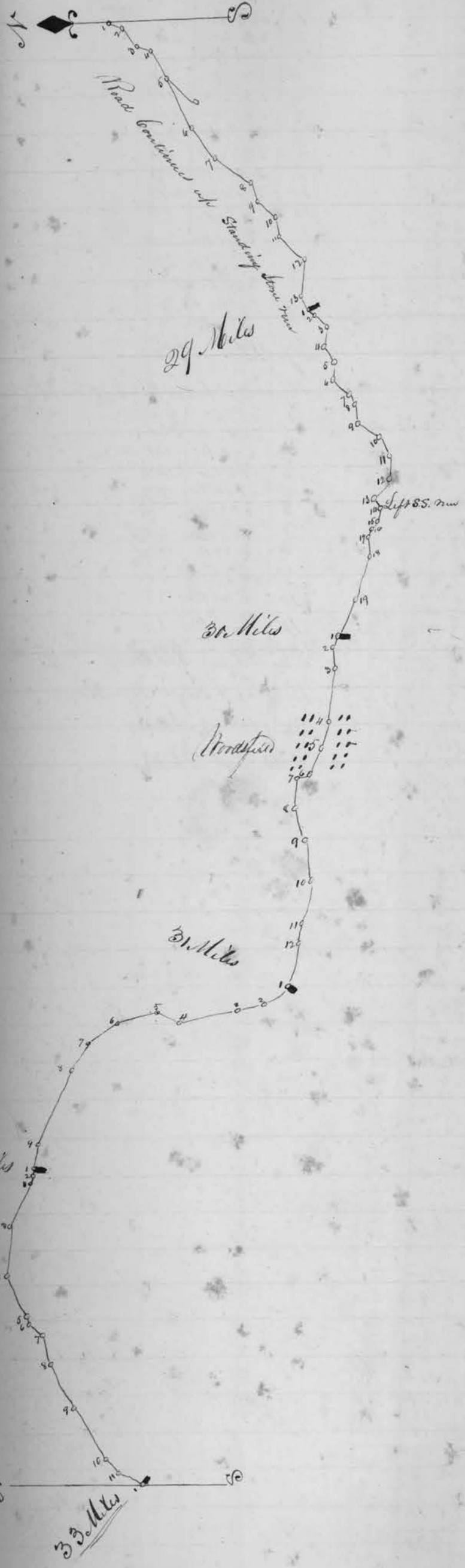

Records of State Road Continued



Sta	Course	Dist
1	S 20 W	8
2	S 32 W	30
3	S 46 1/2 W	40
4	S 47 W	18
5	S 16 1/2 W	12
6	S 3 1/4 E	22
7	S 2 W	22
8	S 32 W	38
9	S 65 W	32
10	N 79 W	19
11	S 59 1/2 W	30
12	S 47 W	25
13	S 73 1/2 W	20
14	S 62 1/2 W	4

34 Miles 320

Rock oak 14 in dia N 88 1/2 W 41 Linty

1	S 62 1/2 W	8
2	S 85 W	12
3	N 68 1/4 W	44
4	N 25 W	21
5	N 55 W	16
6	N 34 W	34
7	N 83 W	8
8	N 56 W	10
9	N 81 1/2 W	11
10	N 59 W	59
11	N 73 W	34
12	N 45 W	27
13	N 75 W	40
14	N 45 1/2 W	40

35 Miles 320

Rock oak 12 in dia S 72 W 92 Linty

1	S 45 W	26
2	S 42 W	48
3	S 20 W	46
4	S 52 W	8
5	S 21 W	16
6	S 69 W	18
7	S 39 W	44
8	S 76 W	26
9	S 76 1/2 W	12
10	S 80 W	6
11	N 85 W	8
12	S 72 W	32
13	N 56 W	16
14	N 49 W	14

36 Miles 320

Rock oak 12 in dia S 50 W 41 Linty

1	N 49 W	38
2	N 39 W	44
3	N 68 W	42
4	N 70 1/2 W	64
5	N 88 1/4 W	80
6	S 88 1/2 W	22
7	S 89 1/2 W	36
8	N 89 W	28

37 Miles 320

Maple 12 in dia N 73 1/2 E 9 Linty

1	N 88 1/2 W	32
2	West	26
3	S 36 1/2 W	18
4	N 89 W	36
5	S 12 W	17
6	S 62 W	15
7	S 59 1/2 W	62
8	S 31 1/2 W	33
9	S 77 1/2 W	8
10	S 89 1/2 W	15
11	S 60 1/2 W	16
12	N 88 1/2 W	20
13	S 48 W	20

38 Miles 320

Rock oak 30 in dia S 43 1/4 E 15 Linty

Record of State Road Continued

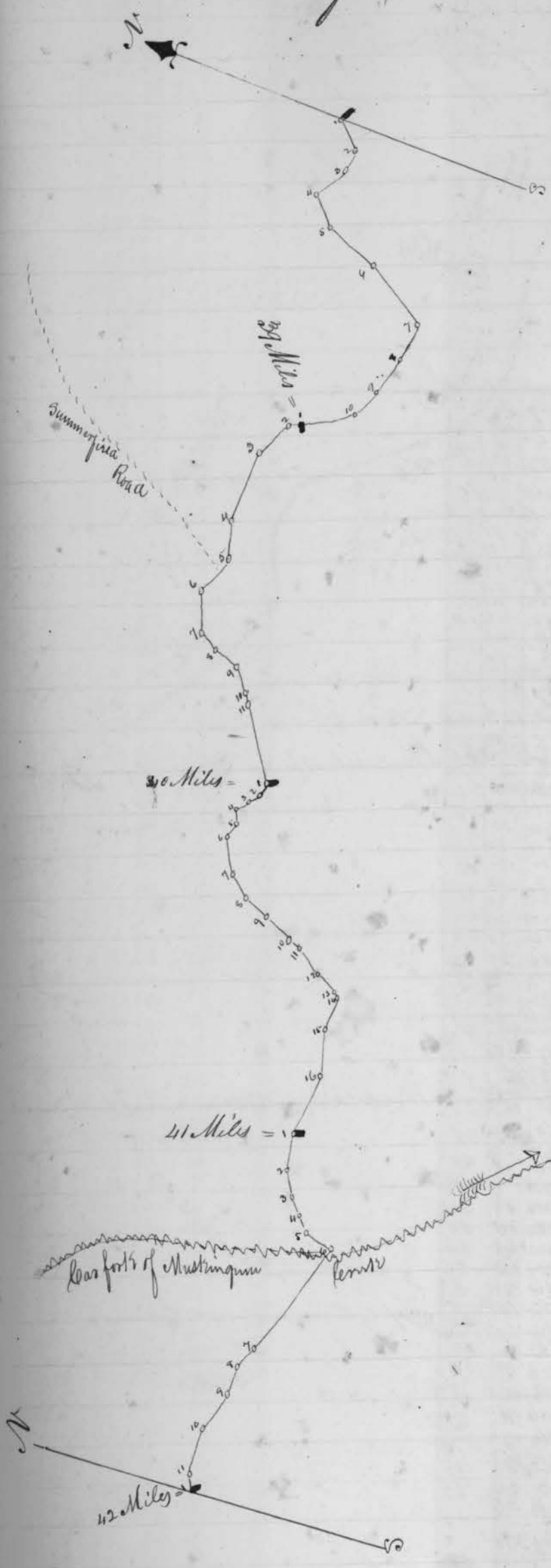

Sta	Course	Dist	Part
1	S 48 W	26	
2	N 82 1/2 W	14	
3	N 59 W	30	
4	S 47 W	26	
5	S 21 W	48	
6	S 34 W	54	
7	N 89 W	38	
8	N 74 W	32	
9	N 69 W	22	
10	N 39 W	40	
29 Miles		320	North 16 in line N 71 1/2 W 39 Link
1	N 29 W	8	
2	N 61 1/2 W	30	
3	N 86 W	58	
4	S 73 1/2 W	28	
5	N 72 W	34	
6	S 67 1/2 W	30	
7	S 27 W	18	
8	S 15 1/2 W	20	
9	S 52 1/2 W	22	
10	S 76 W	8	
11	S 54 1/2 W	64	
40 Miles		320	N. Ash 14 in line S 50 W 9 Link
1	N 76 W	10 3/4	
2	N 51 1/2 W	10 6	
3	N 45 W	10 1	
4	S 63 W	13	
5	S 75 1/2 W	12	
6	S 58 1/2 W	28	
7	S 35 1/2 W	22	
8	S 18 W	24	
9	S 24 1/2 W	24	
10	S 22 1/2 W	10	
11	S 33 W	24	
12	S 24 W	18 3/5	
13	S 54 1/2 W	4 0/5	
14	N 88 1/2 W	26 6	
15	S 75 W	36	
16	N 87 W	48	
41 Miles		320	North 24 in line N 29 1/2 E 22 Link
1	S 81 1/2 W	29	
2	S 65 1/2 W	19	
3	S 51 1/2 W	16	
4	S 38 1/2 W	16	
5	S 13 1/2 W	24	
6	N 73 W	96	
7	N 70 W	18	
8	S 87 W	22	
9	N 78 1/2 W	32	
10	S 86 W	36	
11	S 58 1/2 W	12	
42 Miles		320	North 16 in line N 26 1/2 W 41 Link

Record of State Road Continues

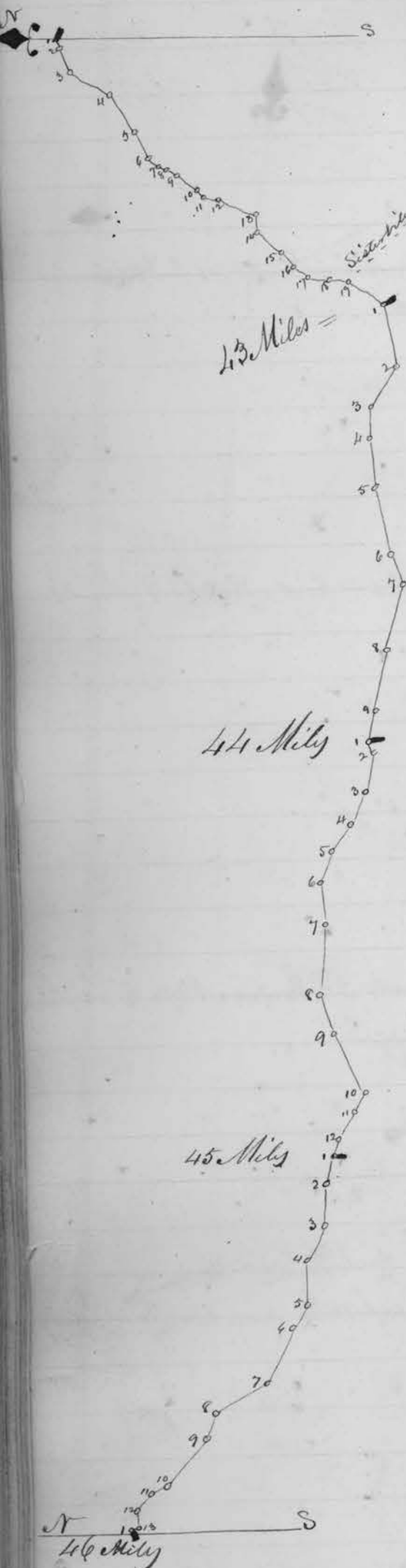

St County	Sec
1	S 38 1/2 W 9
2	S 66 W 17
3	S 22 1/2 W 32
4	S 54 W 32
5	S 60 W 2
6	S 45 1/2 W 8
7	S 25 W 6
8	S 32 W 8
9	S 33 1/2 W 17
10	S 30 W 7 1/2
11	S 16 W 7 1/2
12	S 18 W 30
13	S 87 W 12
14	S 39 1/2 W 24
15	S 45 1/2 W 12
16	S 29 W 14
17	S 9 W 14
18	S 14 W 15
19	S 35 W 33
43 Miles 320	
North Indiana	
N 28 1/2 W 53 1/2 Sec	
1	S 80 1/2 W 43
2	N 58 W 35
3	N 83 1/2 W 22
4	S 81 W 36
5	S 82 W 50
6	S 74 W 21
7	N 75 W 49
8	N 80 W 42
9	N 73 W 22
44 Miles 320	
Beach 8 in dia	
S 43 W 60 1/2 Sec	
1	S 83 1/2 W 8
2	N 75 W 29
3	N 63 W 25
4	N 60 W 25
5	N 69 W 21
6	S 87 W 30
7	S 82 W 52
8	S 72 1/2 W 30
9	S 62 W 49
10	N 60 W 16
11	N 48 W 25
12	N 70 1/2 W 10
45 Miles 320	
Beach 10 in dia	
S 43 1/2 W 51 1/2 Sec	
1	N 70 1/2 W 20
2	N 99 1/2 W 31
3	N 64 1/2 W 27
4	N 87 W 31
5	N 85 W 21
6	N 66 W 43
7	N 29 1/2 W 43
8	N 72 W 17
9	N 81 W 45
10	N 25 W 12
11	N 47 1/2 W 14
12	N 87 W 13
13	N 36 W 3
46 Miles 320	
Beach 6 in dia	
N 32 1/2 W 108 1/2 Sec	
1	N 86 W 10
2	N 55 W 44
3	N 79 1/2 W 60
4	S 74 W 57
5	S 87 W 28
6	S 50 W 18 1/2
7	S 7 1/2 W 103 1/2
47 Miles 320	
Beach 12 in dia	
S 36 1/2 Sec	
1	S 27 1/2 W 10
2	S 41 1/2 W 18
3	S 37 1/2 W 18
4	S 10 W 22
5	S 21 W 93
6	S 2 E 43
7	S 21 E 114
8	S 35 E 10
9	S 60 1/2 E 80
10	S 52 E 51
11	S 25 E 27
12	S 69 E 11 1/2
13	S 4 E 62 1/2
14	S 30 1/2 E 4 1/2
15	S 26 W 8
16	S 11 W 9
17	S 1 W 17
48 Miles 320	
White oak	
14 in dia N 57 1/2 E 27 1/2 Sec	

1	S 17 1/2 E 16
2	S 15 E 10
3	S 6 W 31
4	S 43 W 52
5	S 59 W 24
6	S 71 1/2 W 11
7	S 1 W 11
8	S 32 1/2 E 11
9	S 8 1/2 E 14
10	S 31 E 24
11	S 22 1/2 E 40
12	S 8 1/2 E 16
13	S 30 E 40
14	S 6 E 24
49 Miles 320	
Walnut 12 in dia	
N 77 1/2 E 95 1/2 Sec	
1	S 6 E 4
2	S 40 W 42
3	S 17 W 54
4	S 50 1/2 W 10
5	S 28 1/2 W 20
6	S 41 W 20
7	S 66 W 16
8	N 83 1/2 W 24
9	S 70 1/2 W 24
10	S 62 1/2 W 20
11	S 70 1/2 W 22
12	S 53 W 22
13	S 58 1/2 W 18
14	S 48 1/2 W 20
50 Miles 320	
Beach 10 in dia	
S 33 E 26 1/2 Sec	
1	S 39 W 10
2	S 68 W 24
3	S 65 1/2 W 22
4	N 86 W 10
5	S 74 W 6
6	S 78 W 18
7	S 80 W 10
8	S 66 1/2 W 65
9	S 82 W 13
10	N 87 W 11
11	N 73 W 15
12	N 57 1/2 W 42
13	N 87 W 8
14	N 71 1/2 W 8
15	N 42 W 11
16	N 66 1/2 W 9
17	N 69 W 17
18	N 76 1/2 W 20
19	N 84 W 34
20	S 75 1/2 W 26
51 Miles 320	
White oak	
14 in dia	
S 49 E 25 1/2 Sec	

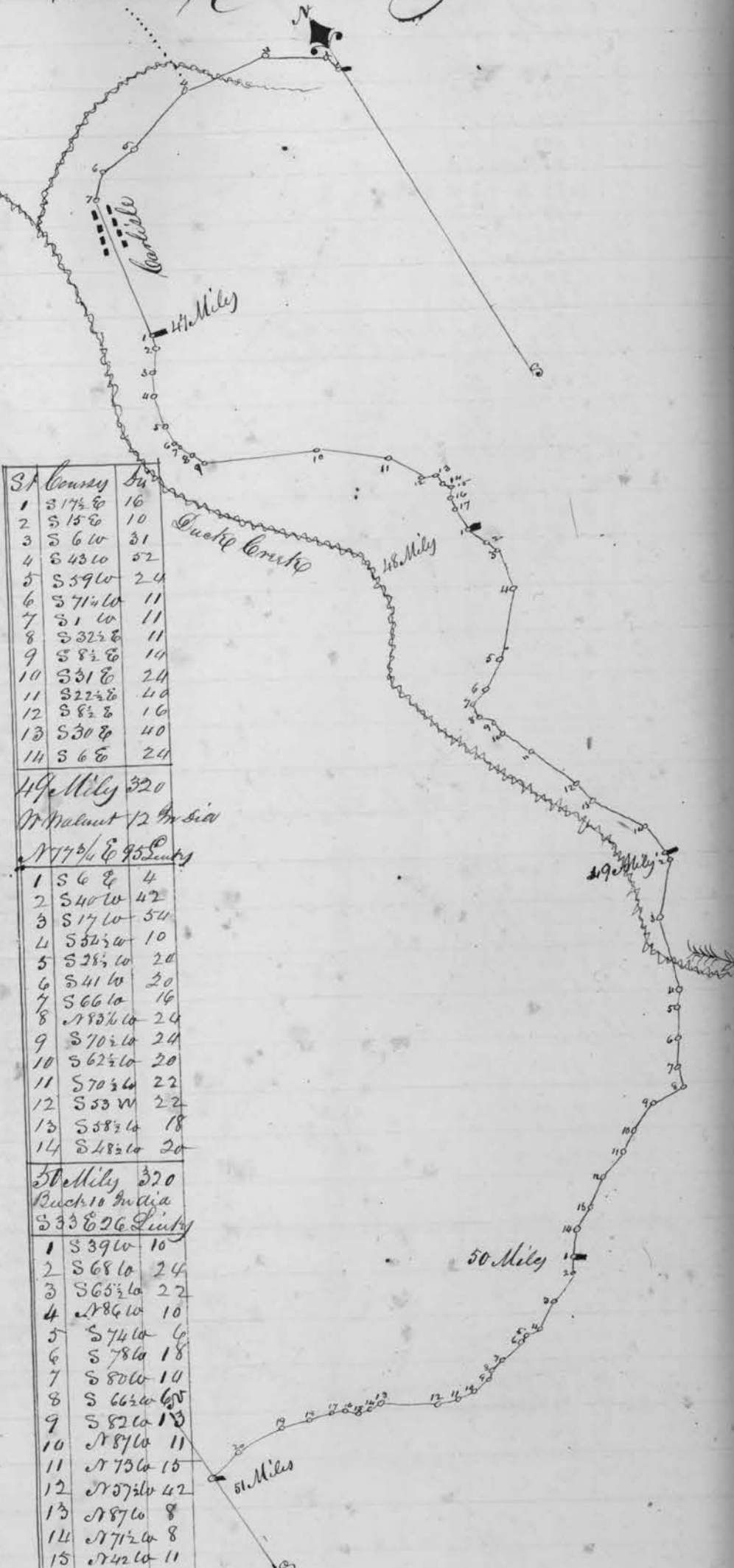

White oak 14 in dia N 57 1/2 E 27 1/2 Sec

Record of State Road Continued

52 County Dist		
1	N64 W	30
2	N56 1/2 W	76
3	N87 1/2 W	19
4	S 50 1/4 W	24
5	S 35 1/2 W	14
6	S 58 1/4 W	23
7	S 32 W	24
8	S 58 W	22
9	S 83 1/2 W	20
10	S 44 1/2 W	18
11	S 28 W	44
12	S 38 W	6
52 Miles	320	North 18 in Sec N. C. E. 23 Linky
1	S 38 W	12
2	S 53 1/2 W	20
3	S 25 W	29
4	S 3 E	52
5	S 28 W	13
6	S 21 1/2 W	9
7	S 1 1/2 W	26
8	S 56 W	31
9	S 73 1/2	24
10	S 26 1/2 W	20
11	S. S. E.	14
12	S 7 E	22
13	S 3 W	18
14	S 5 E	8
15	S 16 E	12
16	S 31 W	8
17	S 6 W	2
53 Miles	320	Back to India } S 49 E 21 Linky }
1	S 6 W	6
2	S 22 E	12
3	S 7 E	9
4	S 4 W	39
5	S 4 1/2 E	32
6	S 4 E	30
7	S 1 W	34
8	S 21 W	8
9	S 32 1/2 E	18
10	S 13 E	15
11	S 67 1/2 W	115
12	S 86 1/2 W	95
13	N 87 1/4 W	18
14	S 86 W	52
15	N 79 W	28
54 Miles	320	Monument Marked S 4 NW
1	S 62 1/2 W	30
2	S 53 W	22
3	S 33 1/2 W	13
4	S 43 1/2 W	29
5	S 42 W	16
6	S 17 1/2 W	24
7	S 7 E	34
8	S 10 W	11
9	S 39 W	10
10	S 31 W	9
11	S 18 W	12
12	S 6 1/2 E	13 1/2
13	S 9 W	6 1/2
14	S 21 W	28
15	S 11 W	14
16	S 5 1/2 W	14 1/2
17	S 43 1/2 W	8 1/2
18	S 10 W	16
19	S 22 W	9
55 Miles	320	Monument 20 in Sec N 64 W 23 Linky

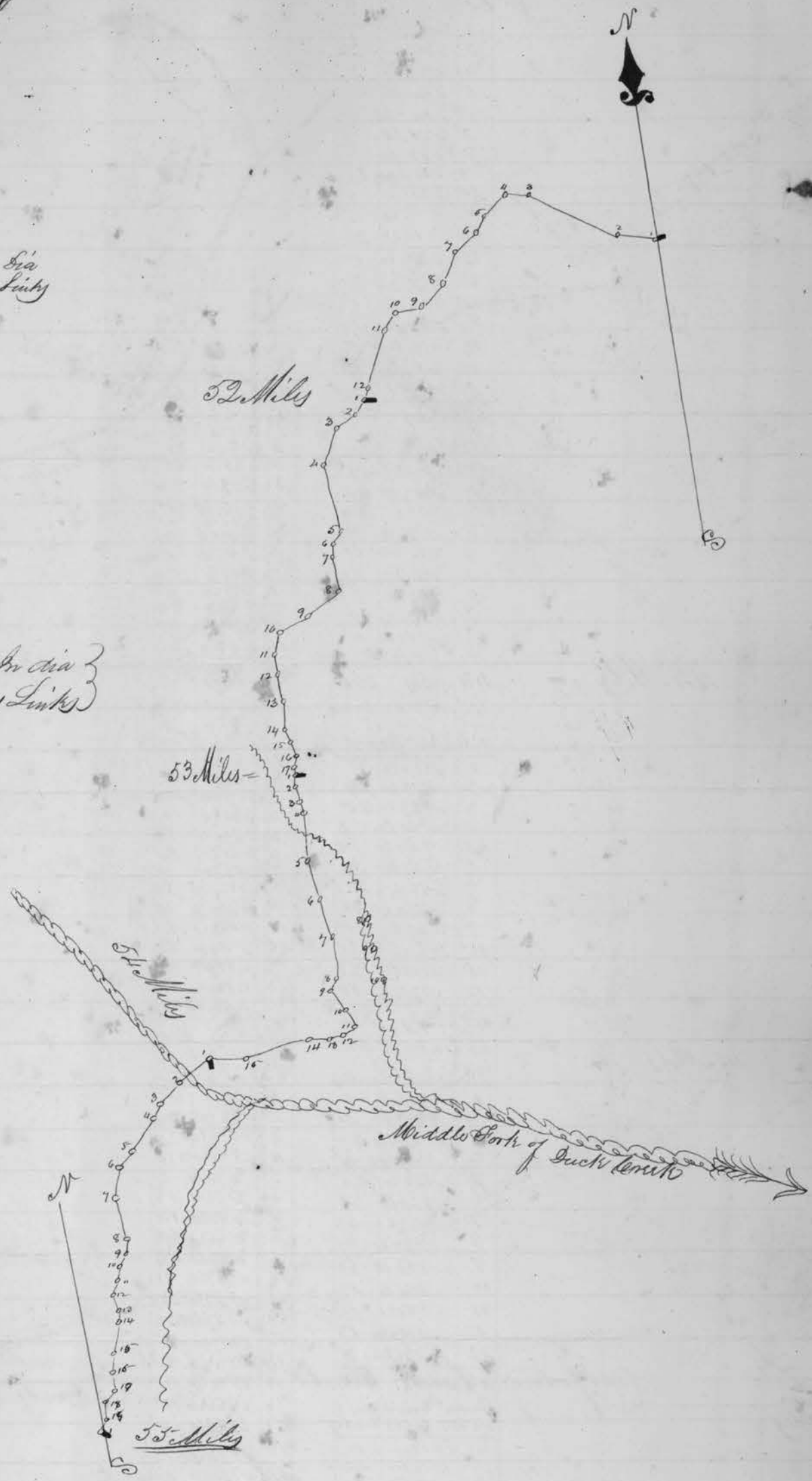

Record of State Road Continued

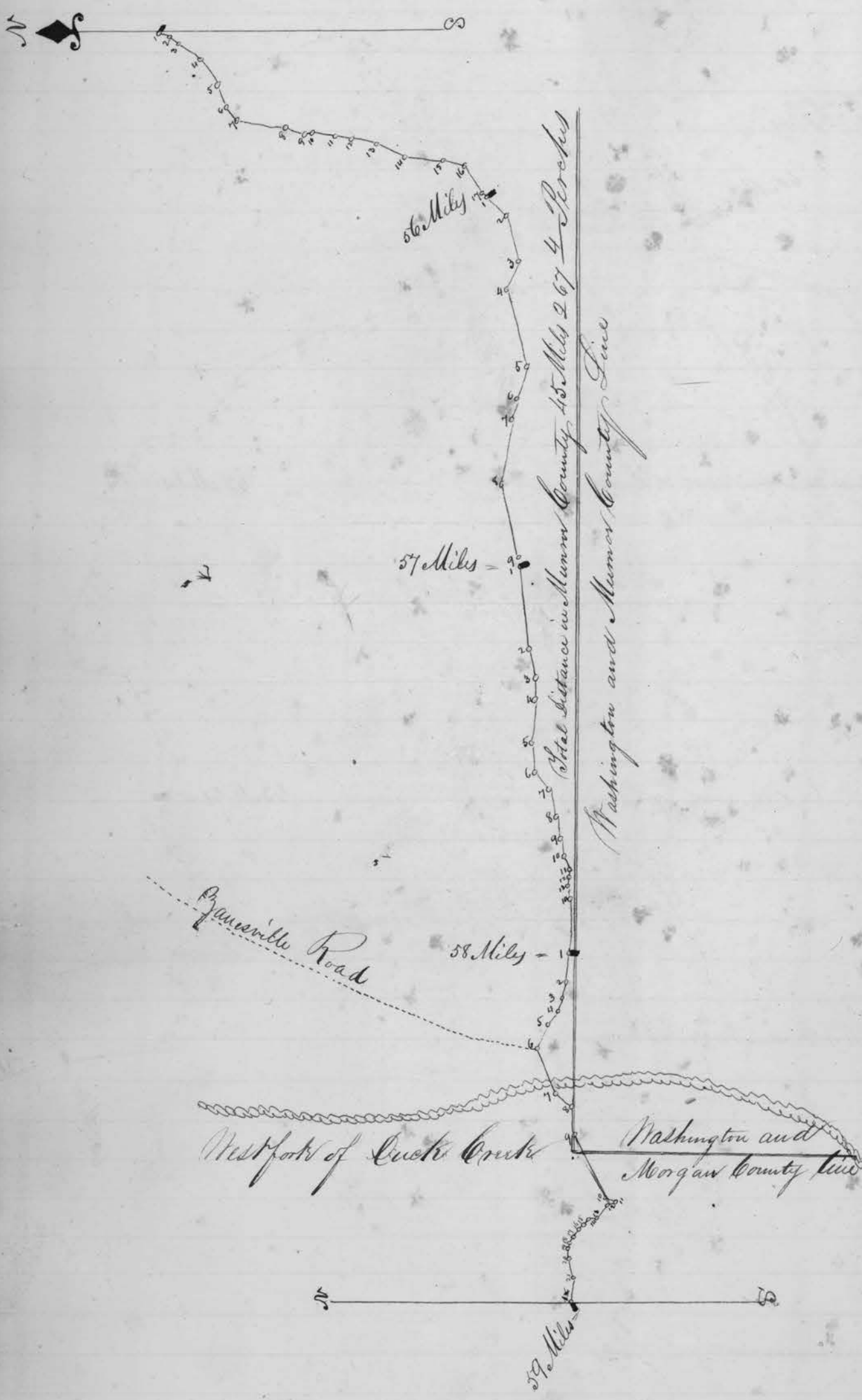

St. Courcy Dist		Witness
1	S 22 W	9
2	S 41 W	7
3	S 35 W	23 ⁵
4	S 58 W	24 ⁵
5	S 67 W	20
6	S 49 W	14
7	S 72 W	40
8	S 13 W	18
9	S 12 W	5
10	S 7 W	19
11	S 12 W	14
12	S 14 W	20
13	S 15 W	26
14	S 9 W	32
15	S 14 W	18
16	S 58 W	27
17	S 45 W	6
56	Mily	320
Sugar 10 An. dia S 59 E 18 Linby		
1	S 45 W	24
2	S 76 W	31
3	N 66 W	24 ⁷
4	S 75 W	66 ³
5	N 70 W	27
6	N 78 W	17 ⁵
7	N 82 W	54 ⁵
8	S 78 W	62
9	S 84 W	6
57	Mily	320
Bucklin dia N 36 E 43 Linby		
1	S 84 W	70
2	S 75 W	22 ⁸
3	N 85 W	17 ²
4	N 84 W	35
5	S 81 W	21
6	S 52 W	18
7	S 75 W	24
8	S 74 W	18
9	West	15
10	S 72 W	12
11	S 89 W	5
12	N 73 W	6
13	S 81 W	10
14	N 88 W	46
58	Mily	320
Walnut, 6, An. dia N 18 W 31 L		
1	N 82 W	24
2	N 79 W	15
3	N 72 W	11
4	N 49 W	14
5	N 68 W	20
6	S 65 W	40
7	S 37 W	17
8	S 85 W	23
9	S 64 W	59
10	S 27 W	5 ⁸
11	N 32 W	47 ⁵
12	N 48 W	11 ²⁵
13	N 9 W	6 ⁸⁵
14	N 36 W	38 ²
15	N 64 W	41
16	N 58 W	62
17	N 52 W	45
18	N 75 W	59 ²
19	S 83 W	7 ⁹
20	S 77 W	17
21	N 88 W	21
59	Mily	320
And Iron Road		
8 An. dia S 12 W 41 Linby		

56 Miles -
 57 Miles -
 58 Miles -
 59 Miles -

Total distance in Munro County 45 Miles 267 4 Perches

Washington and Morgan County Line

Piquette Road

Mouth of Cuck Creek

Washington and Morgan County Line

Record of State Road Continued

St	Course	Dist
1	N 83 1/2 W	10
2	S 86 W	20
3	S 77 1/2 W	56
4	S 86 W	21
5	S 82 1/2 W	345
6	S 66 1/2 W	625
7	S 74 1/2 W	105
8	S 26 W	105
9	S 60 1/2 W	260
10	S 16 W	37
11	N 85 1/2 W	50
12	N 63 W	19
13	N 85 1/2 W	30
14	S 60 W	30
60 Miles		320
Red oak 16 in Dia N 53 1/4 W 14 Links		
1	S 60 W	8
2	S 87 1/2 W	28
3	West	26
4	S 51 W	26
5	S 2 1/2 W	26
6	S 4 1/2 W	14
7	S 22 1/2 E	25
8	S 61 1/2 E	49
9	S 2 E	56
10	S 29 E	10
11	S 53 E	18
12	S 20 1/2 E	12
13	S 22 W	22
61 Miles		320
A Buck 20 in Dia S 66 E 38 Links		
1	S 33 1/2 W	30
2	S 4 W	30
3	S 18 1/2 W	13
4	S 11 1/2 E	28
5	S 14 W	23
6	S 11 1/2 W	28
7	S 23 1/2 W	28
8	S 53 W	21
9	S 35 W	15
10	S 38 W	18
11	S 3 1/2 W	22
12	S 63 E	24
13	S 42 W	32
14	S 38 1/2 W	12
62 Miles		320
A Buck 8 in Dia S 44 E 37 Links		
1	S 38 1/2 W	40
2	S 57 W	36
3	S 53 1/2 W	54
4	N 85 W	27
5	N 34 1/2 W	30
6	N 16 W	23
7	N 65 1/2 W	20
8	N 7 1/2 W	20
9	N 52 W	22
10	N 64 W	24
11	S 62 W	29
63 Miles		320
No oak 14 in dia N 81 1/2 W 23 Links		
1	S 62 W	16
2	S 84 1/2 W	32
3	N 55 1/2 W	18
4	N 74 1/2 W	19
5	N 66 1/2 W	32
6	S 49 W	19
7	S 24 W	29
8	S 58 W	24
9	N 80 1/2 W	30
10	S 46 W	18
11	S 48 1/2 W	94
12	S 4 1/2 E	80
64 Miles		320
White oak 16 in Dia N 67 W 27 Links		

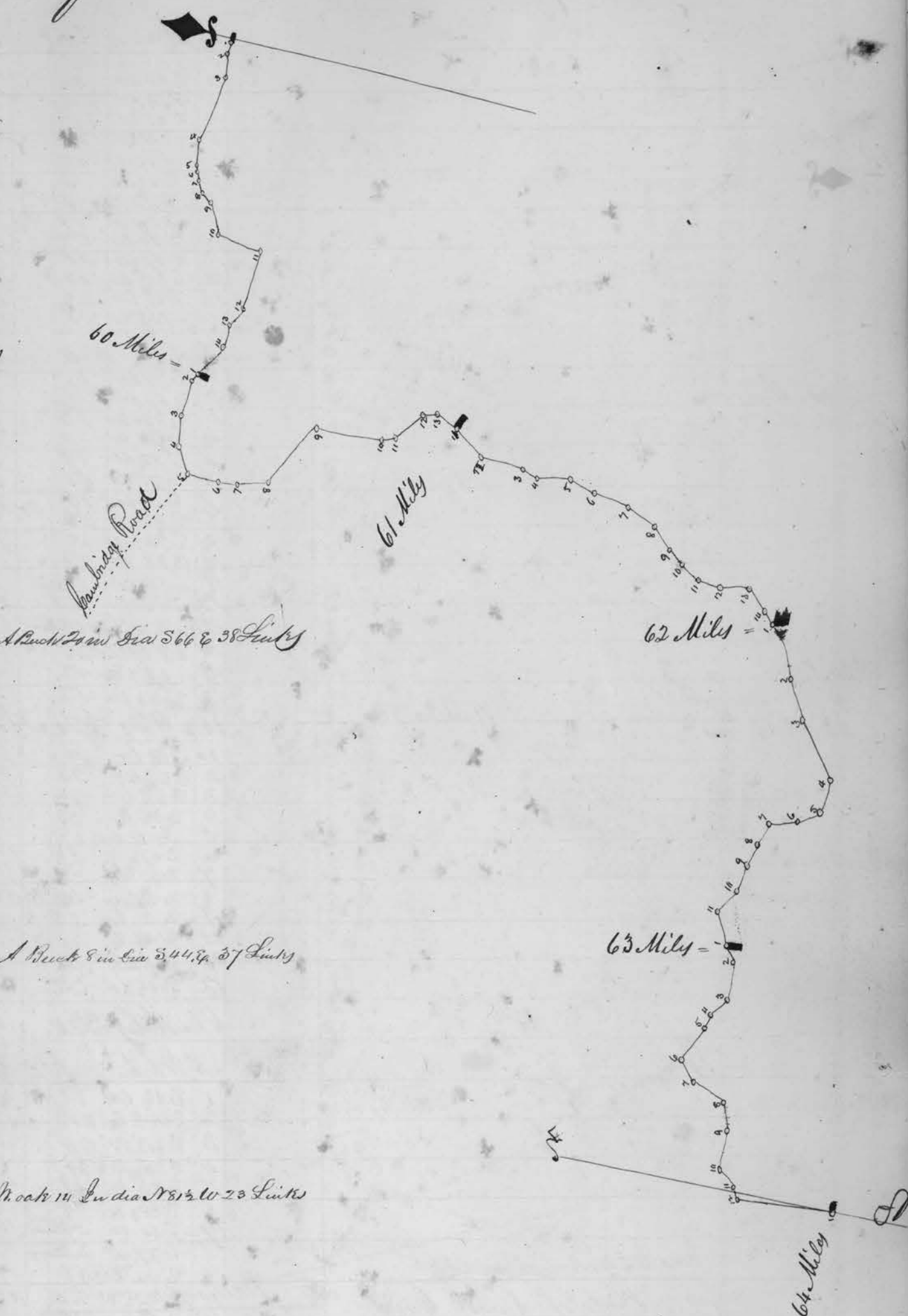

Record of State Road Continues

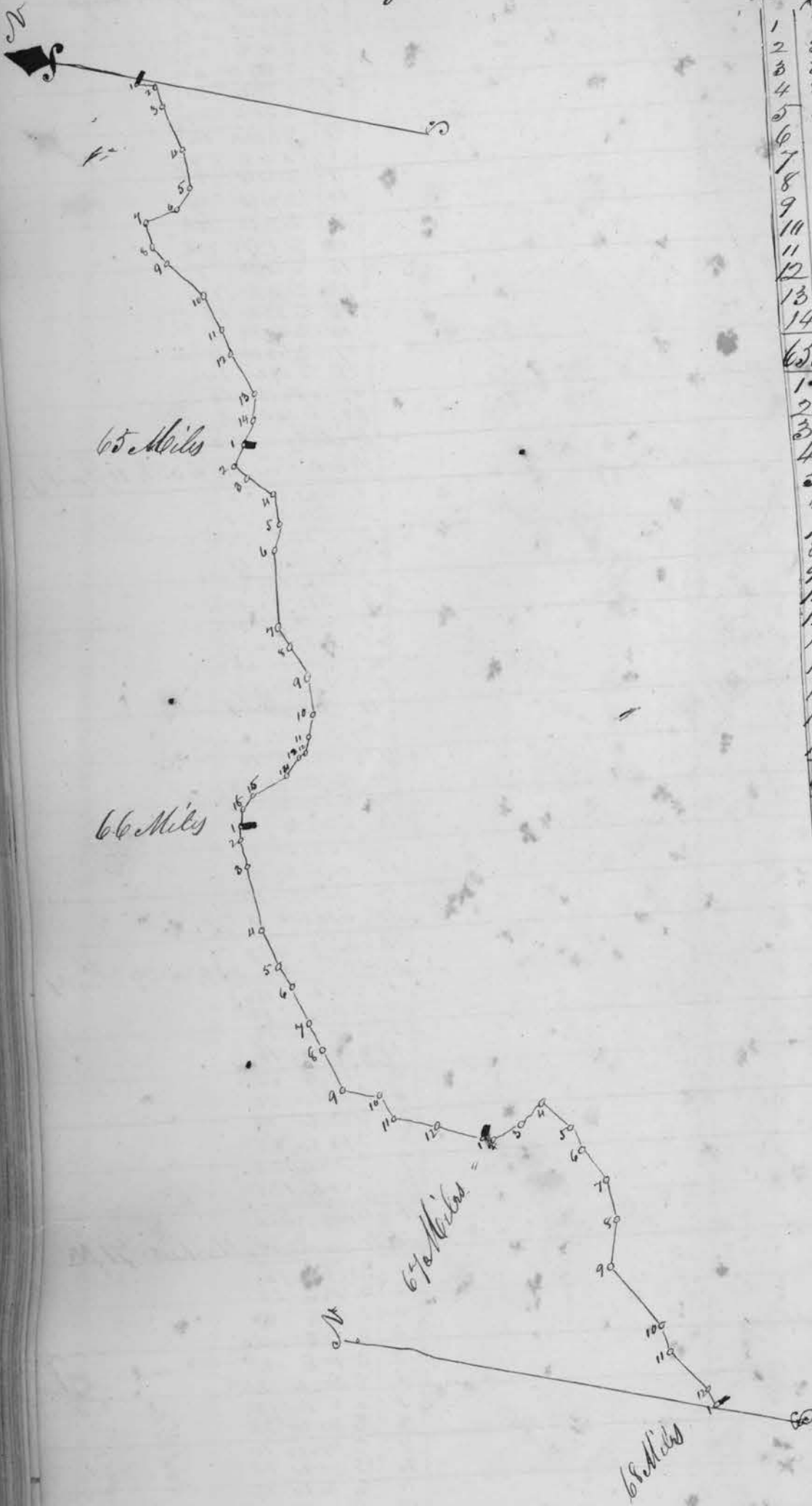

St	Survey	Dist	Remarks
1	S 42 E	15	
2	S 68 W	15	
3	S 58 W	32	
4	S 68 W	27	
5	N 65 W	19	
6	N 36 E	24	
7	S 66 W	16	
8	S 50 W	15	
9	S 29 W	37	
10	S 54 W	24	
11	S 57 W	21	
12	S 48 W	32	
13	S 88 W	22	
14	N 87 W	18	
65 Miles 320			<i>Road is 12 in. dia. N 30 W 31 L</i>
1	S 79 W	14	
2	S 41 W	12	
3	S 29 W	23	
4	S 70 W	22	
5	S 82 W	19	
6	S 75 W	56	
7	S 41 W	16	
8	S 42 W	26	
9	S 72 1/2 W	28	
10	S 88 W	14	
11	N 81 W	114	
12	N 55 W	6 1/2	
13	N 60 W	16 5/8	
14	N 39 1/2 W	28	
15	N 57 1/2 W	12	
16	S 84 W	12	
66 Miles 320			<i>A Monument Marked 66 M</i>
1	S 84 W	10	
2	S 63 W	20	
3	S 66 W	46	
4	S 56 W	36	
5	S 49 1/2 W	18	
6	S 47 1/2 W	28	
7	S 55 W	22	
8	S 49 1/2 W	32	
9	S 2 E	28	
10	S 46 E	20	
11	S 23 E	31	
12	S 12 W	35	
67 Miles 320			<i>A White oak 12 in dia N 65 W 41 L</i>
1	S 12 W	8	
2	S 40 1/2 E	21	
3	S 61 1/2 W	23	
4	S 29 W	31	
5	S 53 W	18	
6	S 38 1/2 W	28	
7	S 60 W	29 1/2	
8	S 79 W	32 1/2	
9	S 32 W	38	
10	S 53 1/2 W	20	
11	S 29 1/2 W	38	
12	S 56 W	14	
68 Miles 320			<i>White Oak 12 in dia S 20 W 25 L</i>