

Roads Established at March Session 1830

S56 N19 E 172 N23 - S59 N 28 - N78 N22 - N42 N20 - N72 E25 - N28 E19 - N48 E27  
 N23 E16 - N2 E23 - N52 N 29 - N37 N18 - N72 N19 - N81 N16 - N50 N18 - N18 N14  
 N20 E25 - N11 E 37 - N27 N24 - N52 N30 - N43 N38 - N78 N22 - S72 N14 - S84  
 N22 - S31 N26 - S71 N20 - S48 N26 - N65 N12 - S81 N13 - S74 N17 - N53  
 N12 - N24 N38 - N57 N15 - N50 N30 - N44 N16 - N1 N11 - N15 N22 - N8 N18  
 N6 N30 - N52 N20 - N87 N15 - S48 N20 - S67 N30 - N48 N18 - N77 N17  
 N41 N50 - N67 N13 - S76 N18 - S42 N44 - S47 N20 - S89 N12 - N59 N6 -  
 N20 N28 - N12 N30 - N66 N16 - N89 N19 - S9 N16 - S10 N42 - S67 N20 - S30  
 N34 - N67 N22 - N38 E15 - N6 E20 - N14 N17 - N61 N24 - N72 N31 - N67  
 N30 - N48 N22 - N9 N11 - N40 N7 - N2 E14 - N5 N13 - N27 N13 - N15  
 N15 - N41 N22 - N6 N26 - N4 E16 - N32 E41 - N6 E13 - N11 N6 - N16 E  
 24 - N75 N25 - N51 N20 - N72 N12 - N38 N13 - N61 N30 - N57 N30 - N37  
 N31 - N54 N21 N25 N30 - N59 N14 intersecting the county road at Henry

Lampz Mill certificate annexed to plat  
 to wit - I certify the within to be a true return & plat of the aforesaid con-  
 templated road  
 Thomas Lewis Surveyor

March 2<sup>nd</sup> 1830

The following report was made yesterday by Eleazer Evans and read in open  
 meeting - (Court) - We the subscribers having viewed and examined the route prescribed  
 in the within order are of opinion that the proposed road if opened & kept in repair  
 will be of public utility inasmuch as it will in our opinion open a better way in  
 the direction to Belville and Woodfield than any that is now laid out

Eleazer Evans  
 John Ewers  
 Stephen Gregg

The foregoing report is in favor of a road beginning at Henry Keens <sup>on section 16</sup> on township  
 5 and Range 3 thence a north direction past Water Kings Mill thence through  
 John Wards Land thence through William Wilsons land thence through  
 Centreville the nearest and best way to intersect the road from St. Blairs  
 ville to Woodfield at Thomas Fosters which report being again read on  
 this day and no objections being offered the commissioners order that said road be  
 established as a public highway and the plat and survey thereof be recorded &  
 placed on file in this office

order issued for opening April 1<sup>st</sup> 1830

words counted to this page in Auditor's acct.

Courses and distance of a graded State Road leading from Cadiz in Harrison County to M'Leansville in Belmont County located agreeable to an act of the Legislature of the State of Ohio passed January 18<sup>th</sup> 1836. Beginning on the west street of the town of Cadiz South 40° West from the S<sup>th</sup> Corner of Ralph Paracruffs Brick House 44 links distant

St	Course	Dist	ft	Remarks
1	S 90° W	68	" "	Road made in part some cut
2	S 80° W	123	" "	Do Do
3	S 26° W	13	" "	Do Do
4	S 46° W	23	" "	Do Do
5	S 30° W	11	" "	Do Do
6	S 5° E	6	" "	
7	S 1° W	12	" "	
8	S 1° E	16	" "	
9	S 9° E	12	" "	Some fill in this station
10	South	36	" "	Some fill in this station
one mile		320		Post to the left of M'Hadens house 3 miles
1	S 12° E	31		Ridge M'Hadens Spring run
2	S 58° E	14		M'Hadens field
3	S 13° E	52		Road made
4	S 5° E	72		Do Do
5	S 24° W	11		Some Cut
6	S 49° W	28		
7	S 54° W	16		
8	S 57° W	7		
9	S 45° W	10		
10	S 21° W	14		
11	S 37° W	10		
12	S 13° W	10		
13	S 2° W	30		
14	S 14° E	17		
two miles		320		W East 37 links

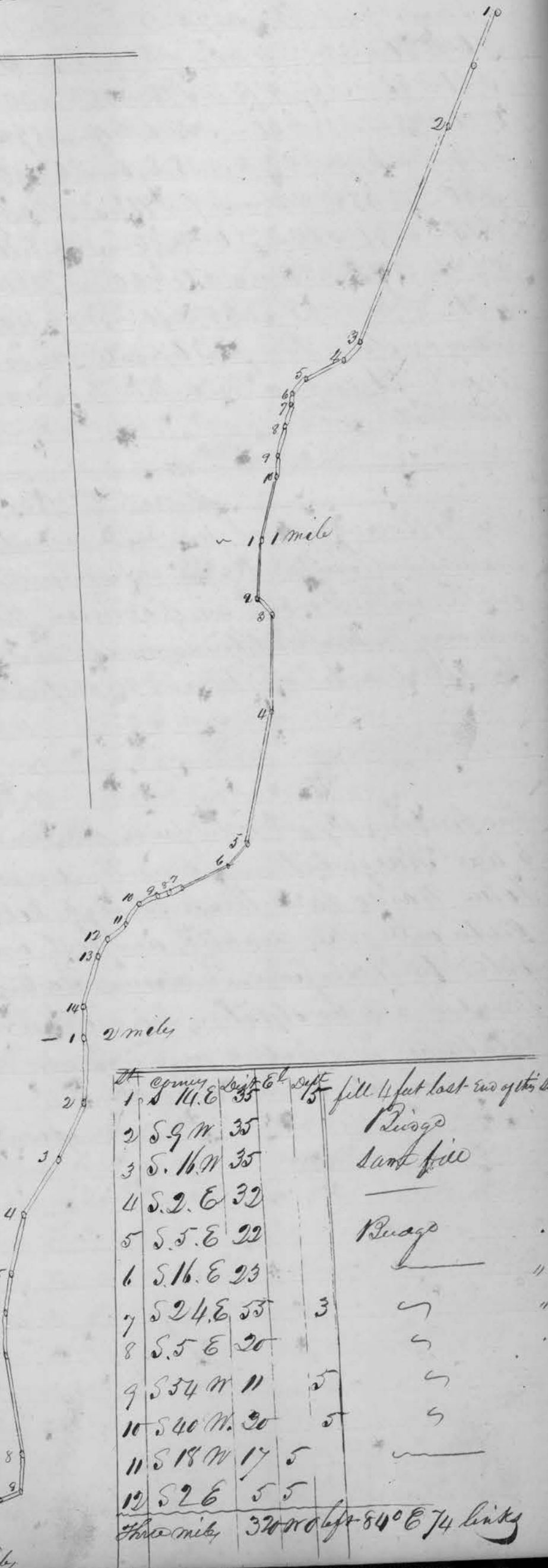

St	Course	Dist	ft	ft	Remarks
1	S 14° E	35		15	fill 4 feet last end of this station
2	S 9° W	35			Ridge
3	S 16° W	35			Some fill
4	S 2° E	32			
5	S 5° E	22			Ridge
6	S 16° E	23			"
7	S 24° E	53		3	"
8	S 5° E	20			"
9	S 54° W	11		5	"
10	S 40° W	30		5	"
11	S 18° W	17		5	"
12	S 26°	5		5	"
three miles		320			W 84° E 74 links

# Records of a New Road from Cadiz Harrison Co.

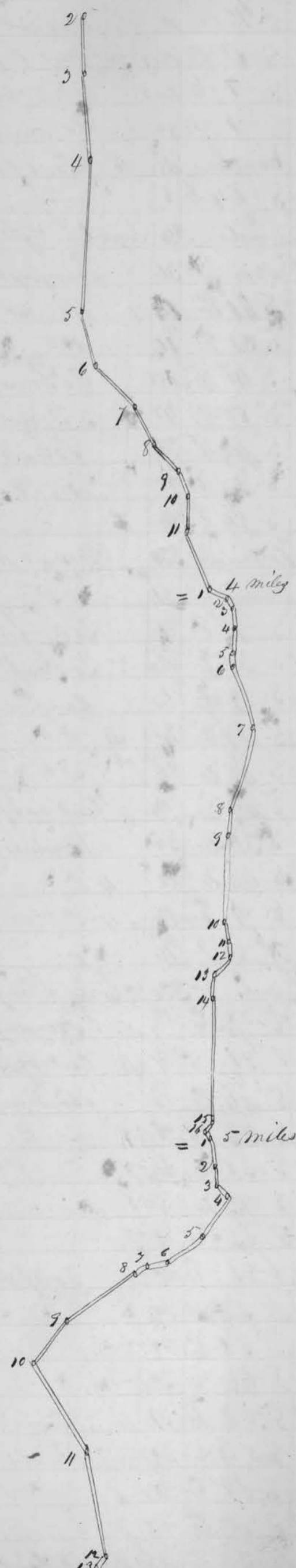

1	S 9 E	10	5	Old road made
2	S 13 E	32		Cut 4 feet by S. M. Hadwin
3	S 17 E	47		Wood Land
4	S 10 E	84		Do Do
5	S 26 E	32	5	Do Do
6	S 57 E	18	5	
7	S 40 E	24		side cut to right
8	S 57 E	20		
9	S 28 E	15	5	fill 5 feet on place
10	S 15 E	19	5	last part of this station
11	S 36 E	34		
from miles 320				to Right 39 m 57 Links
1	S 64 E	11	5	
2	S 46 E	6	5	
3	S 23 E	11	5	
4	S 8 E	14	5	
5	S 13 E	8	5	
6	S 31 E	36		
7	S 30 W	47	4	Worley's field
8	S 7 E	14	3	Do Do
9	S 9 E	48	4	
10	S 27 E	13	5	
11	S 13 E	7	0	
12	S 24 W	12		
13	S 5 E	14	5	
14	S 13 E	70	4	To foot Web's hill
15	S 29 W	4	5	side cut to the left
16	S 29 E	5	5	Do Do
Five miles 320				Stamp to the left
1	S 25 E	16	5	side cut left Worley's field
2	S 16 E	10	5	Do - Do - Do -
3	S 39 E	10	4	Beary in this station
4	S 19 W	26	5	Worley's field
5	S 41 W	24	5	Wood
6	S 46 W	12	5	
7	S 44 W	8	5	
8	S 42 W	45		Top of Web's hill
9	S 25 W	30	3	Web's corn field
10	S 44 E	57	2	Do pasture field
11	S 24 E	58		
12	S 28 W	8	5	
13	S 6 W	12	5	
14	S 5 E	4	5	
Six miles 320				to the Right 508 m 45 links

143

To *Harrisville* Belmont County Ohio

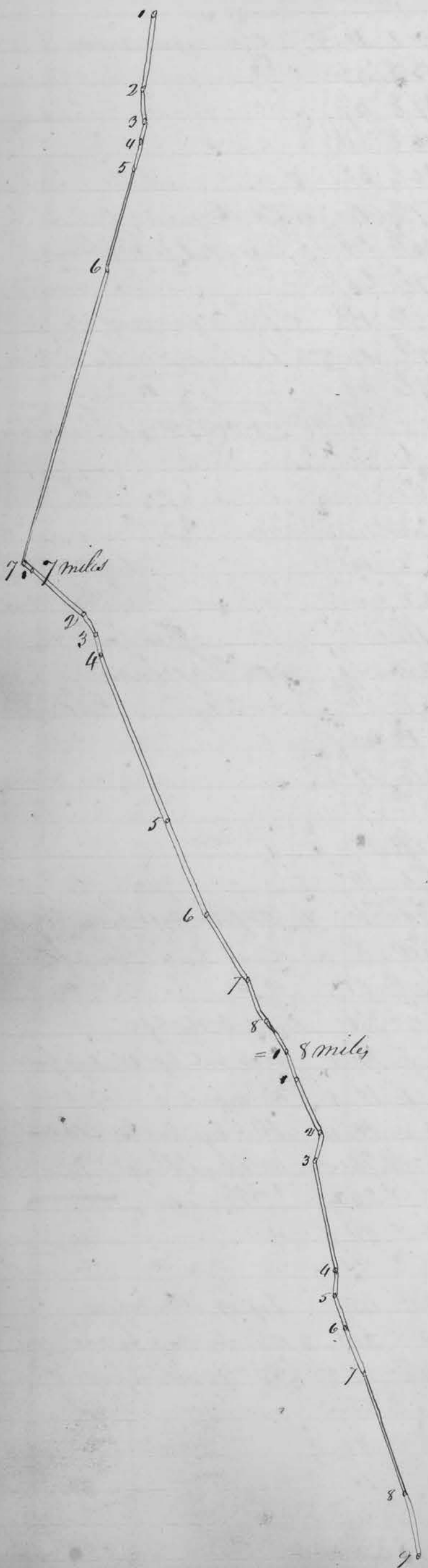

1	S 70° E	42	5	To the foot of the hill
2	S 16° E	18		cut and fill 3 feet
3	S 3° E	13	5	cut 1 1/2 feet
4	S 1° E	14	5	Fill two feet in the station
5	S 1° W	38		To Harrisville Street & Station
6	South	168	5	Last part cut 1 1/2 feet at ball
2.5	S 64° E	5		
Seven miles 320				Sugar tree Right S 31 W 82 Links
1	Same	36		Perregron's land
2	S 41° E	14	4	side cut to the left
3	S 31° E	10		do do do
4	S 41° E	158		To Perregron's line
5	S 50° E	42		Moses Canon's land
6	S 42° E	26		some cut & fill
7	S 50° E	20		at M. Cannon's house
8	S 39° E	14		
Eight miles 320				Walnut to left N 50 E 12 links
1	Same	34		
2	S 90° E	46		some fill
3	S 30° E	62		To County line of Belmont 146 P.
4	S 19° E	14		side cut to the left
5	S 37° E	20	4	do do do
6	S 43° E	28		do do do
7	S 39° E	72		cut and fill two places
8	S 31° E	36		Henderson's field
9	S 64° E	12	4	do do
10	S 71° E	12	4	do do
11	N. 82° E	14		
Nine miles 320				Cherry Stamp left N 18 W 60 Links
1	N 38° E	18		Henderson's meadow
2	E 75° E	9		do do
3	S 31° E	8	4	cut & fill side cut left
4	S 44° E	13		Henderson's house
5	S 26° E	8	5	
6	S 35° E	16	5	
7	S 42° E	8	5	
8	S 43° E	4	5	
9	N 81° E	6	5	Lot of Henderson's hill
10	N 53° E	30	5	
11	N 58° E	28		
12	S 66° E	24		
13	S 63° E	32	4	To wood land
14	S 52° E	20	3	to old road
15	S 10° E	34		road made
16	S 16° E	29		
17	S 23° E	33	5	at last end
Ten miles 320				N. O. Right S 62 W 33 Links

# Record of State Road Continued

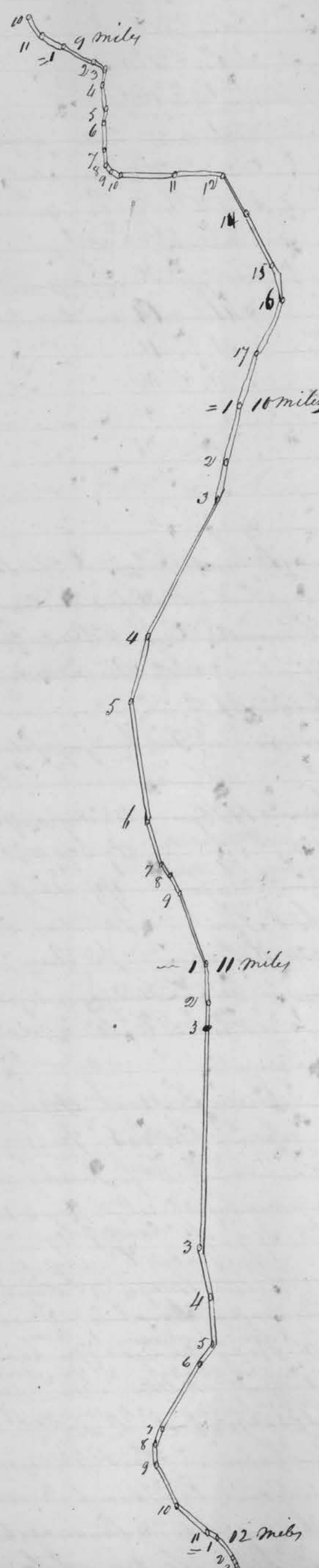

St	Course	Dist. Ch.	Remarks
1	Same	23	Road made
2	S 83 E	84	Do Do
3	S 63 E	65	Do Do
4	S 45 E	24	Road made
5	S 57 E	8	Side cut right
6	S 57 E	12	Do Do Do
7	S 60 E	40	Same cut in the station
8	S 57 E	23	Same cut and fills
<b>Clear miles 320</b>			<b>Stump left N 8 E 35 Links</b>
1	Same	13	Same file
2	S 34 E	173	Road made
3	S 46 E	28	Do Do
4	S 42 E	26	To Pat. Armstrong
5	S 49 E	12	Do Do
6	S 5 E	42	Side cut to left
7	S 12 E	10	Do Do
8	S 40 E	12	Do Do
9	S 61 E	25	Same Linghys house
10	S 89 E	23	with land
11	S 85 E	6	Do Do wet
<b>Tinler miles 320</b>			<b>N. O. S 2 E 65 Links</b>
1	S 76 E	14	Wet land
2	S 43 E	9	Side cut to right
3	S 32 E	18	Do Do
4	S 44 E	42	Road made
5	S 27 E	20	at Smith run
6	S 73 E	8	Road made
7	East	8	Do Do
8	A 88 E	10	M. Williams side
9	East	46	Side cut
10	A 75 E	14	Down Whaling Creek
11	A 83 E	34	Do Do
12	A 81 E	50	Meadow
13	East	30	Do Do
14	A 92 E	19	Meadow
<b>Thirteen miles 320</b>			<b>Sugar tree S 41 E 11 links</b>
1	Same	21	creak seven paces wide
2	S 34 E	16	Side cut right
3	S 71 E	16	Side cut right
4	S 64 E	27	To sugar tree opposite Nashs house
5	S 55 E	24	up the run
6	S 34 E	19	crop run for way
7	S 24 E	14	last end of this station
8	S 19 E	14	all the orchard
9	S 16 W	24	all the orchard
10	S 31 W	11	all the orchard
11	S 25 W	11	all the orchard
12	S 44 W	4	M. Colcloughs Farm
13	S 17 W	4	Side cut to left
14	S 13 W	4	Side cut to left
15	S 18 E	26	Side cut to left
16	S 12 E	9	Side cut to left
17	S 10 W	8	Side cut to left
18	S 16 E	4	Point of hill
19	S 65 E	20	Side cut to left
20	S 71 E	12	Side cut to left
21	S 68 E	15	Side cut to left
<b>Forteen miles 320</b>			<b>N. O. Right S 52 W 20 Links</b>
1	S 68 E	13	To the top of hill
2	S 31 E	41	Range far first end
3	S 6 E	18	Side cut to left
4	S 22 E	8	Top of hill
5	S 37 E	73	Trough field
6	S 31 W	60	on first end cut 4 feet last end
7	S 31 W	12	Side cut to left
8	S 21 W	32	Cut to left 2 places
9	S 7 E	17	Side cut to left
10	S 41 E	15	Side cut to left
11	S 37 E	18	Side cut to left
12	S 50 E	12	Side cut to left
13	S 79 E	19	Side cut to left
<b>Fifteen miles 320</b>			<b>Sugar tree right S 10 E 7 links</b>
1	Same	9	To foot of hill
2	S 5 E	10	Bottom land
3	S 19 W	64	Bottom land
4	S 5 E	94	To foot of hill & Smiths land
5	S 1 E	11	Side cut to left
6	S 90 E	6	Side cut to left
7	S 36 E	18	Side cut to left
8	S 14 E	19	Side cut to left
9	S 4 E	17	Side cut to left

# Records of State Road Continued -

Remarks

10	S 50 E	4			Top of Point
11	S 36 E	8			do
12	East				field
13	N 56 E	11	3		do do
14	N 58 E	30	3		do
15	N 64 E	10	3		wood land
16	S 67 E	9	5		do do
Total Miles		320			Sugar trees left at 927 cuts
1	S 44 E	26			road made
2	S 44 E	26			4 cut 1 foot
3	S 21 E	18			road made
4	S 7 E	12	4		do do
5	S 4 E	28			do do
6	South	33			do do
7	S 18 E	85			upto Strains at Chainville
- 16 - 228 whole distance is six = teen miles and two hundred & twenty eight feet.					

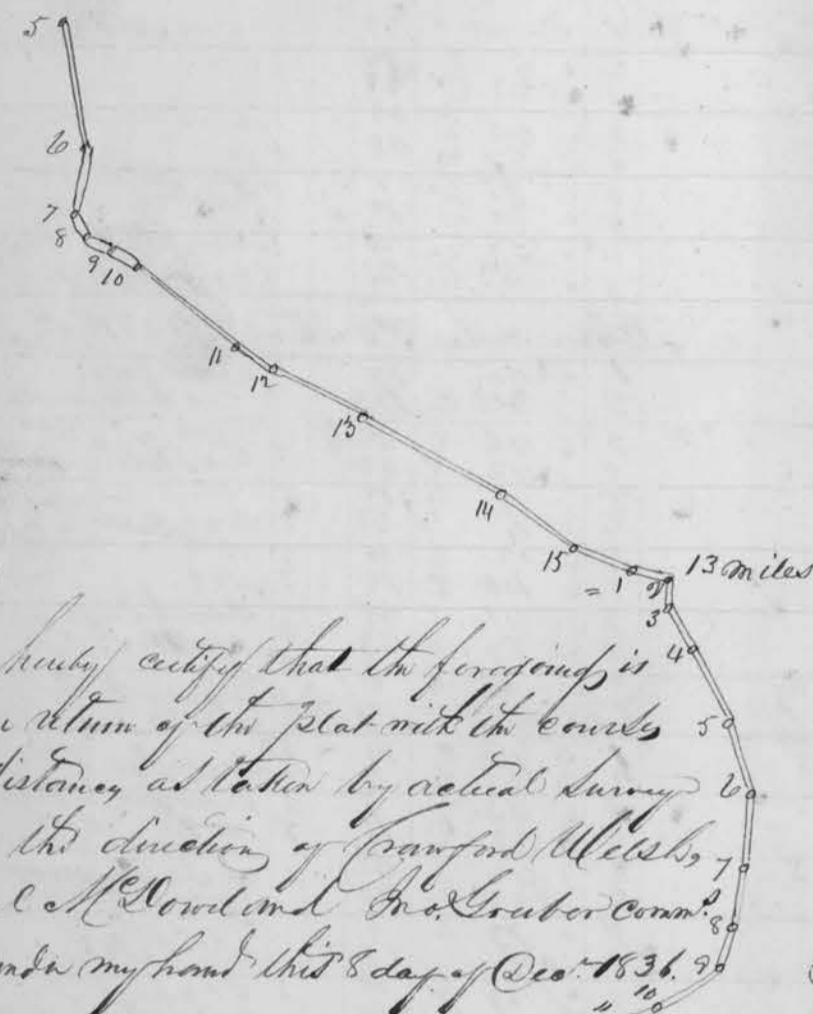

I do hereby certify that the foregoing is a true return of the plat with the courses and distances as taken by actual survey under the direction of Crawford Welch, Samuel McLowrie and Geo. Gruber Commrs. Given under my hand this 8 day of Dec: 1836.

John Caldwell  
Surveyor

Payment County D. for locating this road.  
Crawford Welch 7 1/2 days @ 150 = 11.25  
Commr. Samuel McLowrie 7 days @ do = 10.50  
John Gruber 6 days @ do = 9.75  
John Caldwell  
Surveyor For surveying & platting road 17.25

Chainmen  
Coonrod Hilligaz 4 1/2 days @ 75 pr. day 3.37 1/2  
Georgell McDonald 4 1/2 days @ 75 pr. day 3.37 1/2  
Samuel H. Wilson 1 day .75  
Jenny Ferrigo 1/2 day .37 1/2  
John Baby 1/2 day .37 1/2  
Robert Walker 1/2 day .37 1/2  
Haymen  
William Hilligaz 4 days @ 75 pr. day 3.00  
Tho. McCall 1/2 day .37 1/2

Marking  
Henry J. Hays 4 days @ 75. 3.00  
Sam. Pincaw 1/2 day .37 1/2

Harrison County D. for locating this road  
Commr. Crawford Welch 7 1/2 days @ 150 11.25  
Sam. McLowrie 7 days @ do 10.50  
John Gruber 6 1/2 days @ do 9.75  
Chainmen  
Coonrod Hilligaz 4 1/2 days @ 75 pr. day 3.37 1/2  
Georgell McDonald 4 1/2 days @ do 3.37 1/2  
Sam. Harrison 1 day .75  
Jenny Ferrigo 1/2 day .37 1/2  
John Baby 1/2 day .37 1/2  
Robt. Walker 1/2 day .37 1/2  
Haymen  
Wm. Hilligaz 4 days @ 75 pr. day 3.00  
Tho. McCall 1/2 day .37 1/2  
Marking  
Henry J. Hays 4 1/2 days @ 75. 3.37 1/2  
Sam. Pincaw 1/2 day .37 1/2

Each county having alike distance of the road with the exception of eight perches



# Record of State Road Continued

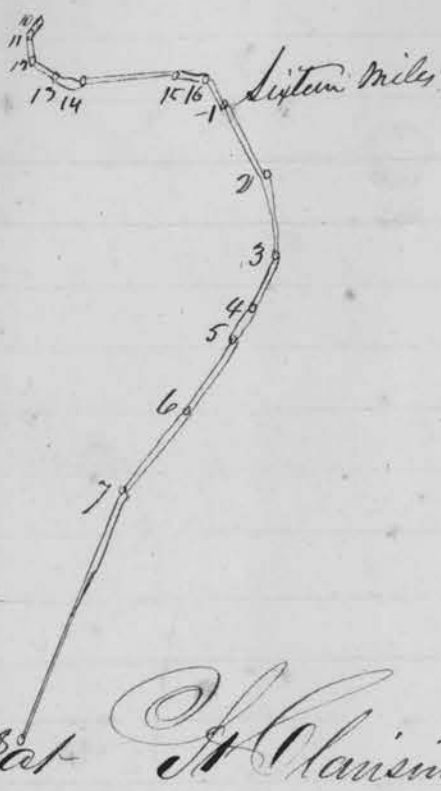

We the undersigned Commissioners appointed by an act of the Legislature passed the 18 day of January 1836. to lay out and establish a Graded State Road from the Town of Cadiz in Hancock County Via New Athens to St. Clairsville Belmont County; do hereby certify that said location is made agreeable to the above return: And that the bills of costs are correctly made to each County having alike distance with the exception of eight perches

Crawford Welsh  
Jas. McDowell  
John Gruber  
Commissioners

# Record of State Road from the Ohio River opposite the flats of Grant Creek to the town of Pleasanton in Washington County. Located agreeable to an act of the Legisla- -tion of the State of Ohio

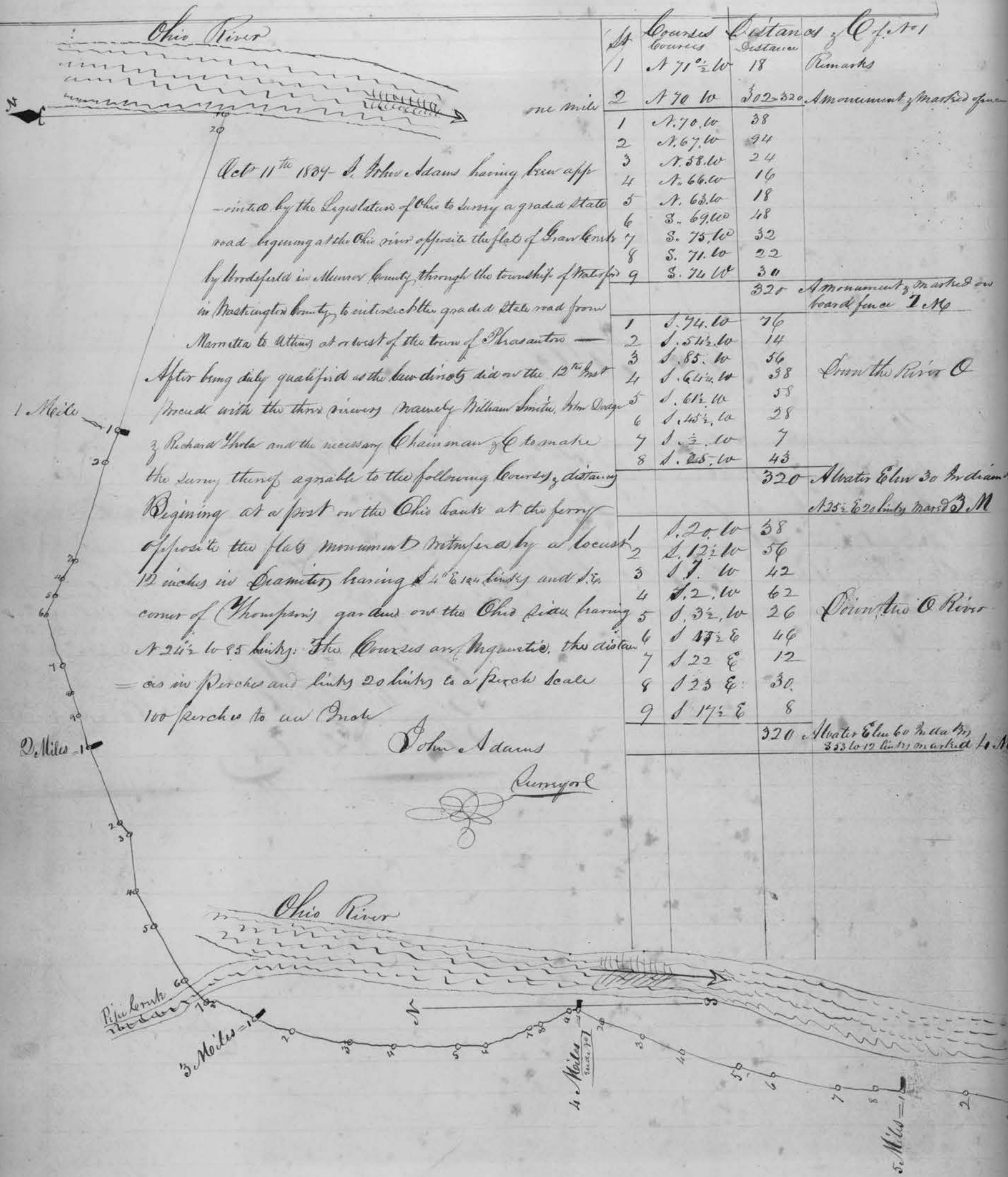

Oct 11<sup>th</sup> 1804 - J. Adam Adams having been app-  
-ointed by the Legislature of Ohio to survey a graded state  
road beginning at the Ohio river opposite the flats of Grant Creek  
by Woodsfield in Meigs County through the township of Matisfield  
in Washington County to intersect the graded state road from  
Marietta to Athens at or west of the town of Pleasanton -  
After being duly qualified as the law directs did on the 12<sup>th</sup> Inst  
proceed with the three surveyors namely William Smith, Wm Dwyer  
& Richard Thole and the necessary Chainman &c to make  
the survey thereof agreeable to the following courses, distance  
Beginning at a post on the Ohio bank at the ferry  
opposite the flats monument determined by a locust  
12 inches in diameter bearing S 4<sup>th</sup> E 124 links and S. E.  
corner of Thompson's garden on the Ohio side bearing  
N 24<sup>th</sup> W 85 links. The Courses are magnetic, the distan-  
-ces in perches and links 20 links to a perch scale  
100 perches to an Inch

John Adams  
Surveyor

St	Courses	Distances	Remarks
1	N 71 <sup>th</sup> W	18	Remarks
2	N 70 W	302-320	Monument marked open
1	N 70.10	38	
2	N 67.10	24	
3	N 58.10	24	
4	N 66.10	16	
5	N 63.10	18	
6	S. 69.10	18	
7	S. 75.10	32	
8	S. 71.10	22	
9	S. 74 W	30	
		321	Monument marked on board fence T.M.
1	S. 74.10	26	
2	S. 54 <sup>th</sup> W	14	
3	S. 85.10	56	
4	S. 64 <sup>th</sup> W	38	From the River O
5	S. 61 <sup>th</sup> W	58	
6	S. 45 <sup>th</sup> W	28	
7	S. 3.10	7	
8	S. 25.10	43	
		320	Altogether 30 Indian M at 25 <sup>th</sup> E 20 links marked D.M.
1	S. 20.10	38	
2	S. 12 <sup>th</sup> W	56	
3	S 7.10	42	
4	S. 2.10	62	
5	S. 32.10	26	From the O River
6	S 17 <sup>th</sup> E	49	
7	S 22 E	12	
8	S 23 E	30	
9	S 17 <sup>th</sup> E	8	
		320	Altogether 60 Indian M 333 to 12 the 17 <sup>th</sup> on marked T.M.



# Records of State <sup>Road</sup> Continued

St	Course	Dist
1	S 17 1/2 E	24
2	S 23 E	42
3	S 23 1/2 E	40
4	S 30 E	36
5	S 29 1/2 E	32
6	S 33 1/2 E	64
7	S 41 1/2 E	36
8	S 39 E	24

Sugar 50 in dia  
S 7 1/2 E 26 Links

St	Course	Dist
1	S 39 E	62
2	S 32 E	57
3	S 28 1/2 E	57
4	S 11 W	102
5	S 9 W	58
6	S 2 1/2 W	6

Red oak 30 in diam  
S 57 W 76 Links

St	Course	Dist
1	S 22 W	22
2	S 14 W	20
3	S 23 1/2 W	18
4	S 21 1/2 W	38
5	S 34 W	16
6	S 26 W	12
7	S 34 W	28
8	S 26 W	24
9	S 43 1/2 W	64
10	S 89 W	12
11	N 82 W	34

N Walnut 14 in dia  
S 30 W 25 Links

St	Course	Dist
1	N 82 1/2 W	14
2	N 72 W	20
3	N 62 W	34
4	N 56 W	24
5	N 49 W	20
6	N 32 1/2 W	24
7	N 15 W	14
8	N 13 W	28
9	N 27 W	10
10	N 35 W	18
11	S 47 W	6
12	N 68 W	6
13	N 45 W	18
14	N 58 1/2 W	24
15	N 54 1/2 W	19
16	N 75 W	39

Red 12 in dia  
S 9 E 25 Links

St	Course	Dist
1	N 75 W	18
2	N 76 W	30
3	N 16 W	30
4	S 48 W	15.5
5	S 30 1/2 W	45
6	S 14 W	10
7	S 26 1/2 W	15
8	S 3 W	19
9	S 12 W	15
10	S 22 W	24
11	S 43 W	46
12	S 17 W	7.5
13	N 87 W	82

S. Corner of Surveyor's house  
N 82 W 38 Links

St	Course	Dist
1	N 87 W	14
2	West	20
3	N 79 W	36
4	N 66 1/2 W	30
5	N 67 W	38
6	N 45 1/2 W	24
7	S 31 W	40
8	N 89 1/2 W	54
9	S 86 1/2 W	26
10	S 86 1/2 W	32
11	S 65 1/2 W	14

Sycamore 30 in dia  
N 32 W 41 Links  
A Monument marked N

St	Course	Dist
1	S 59 W	24
2	S 53 1/2 W	46
3	S 65 W	40
4	S 56 W	36
5	S 55 1/2 W	55
6	S 61 W	24.5
7	N 74 1/2 W	25

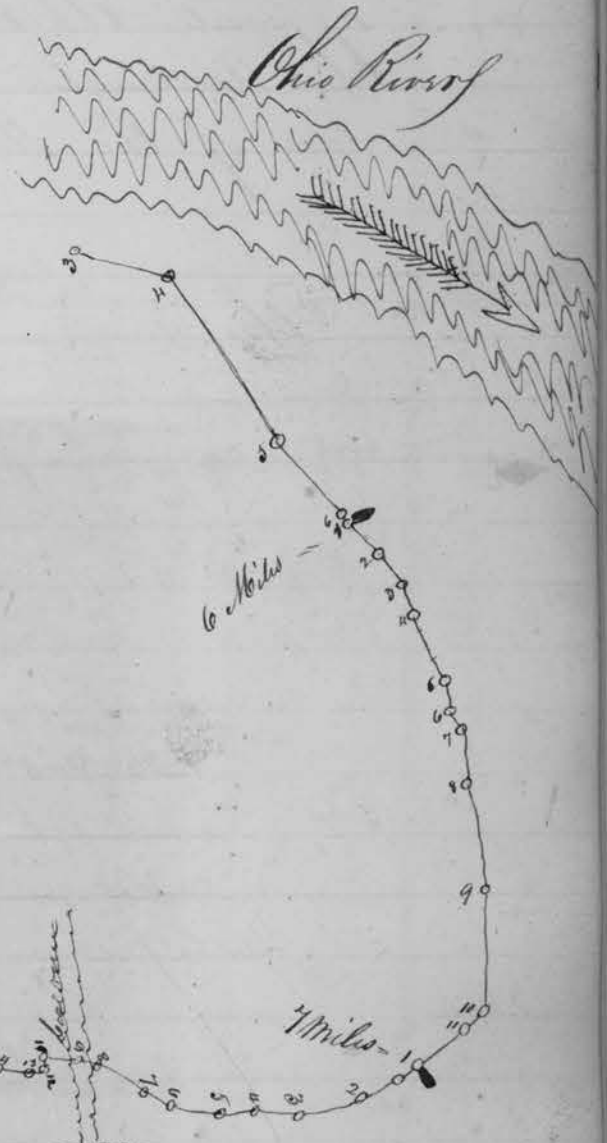

St	Course	Dist
1	S 65 1/2 W	38
2	S 26 1/2 W	30
3	S 26 1/2 W	32
4	S 57 W	48
5	West	15
6	N 55 W	49
7	N 55 1/2 W	18
8	West	14
9	S 12 1/2 W	20
10	S 13 E	32
11	S 43 1/2 W	34

St	Course	Dist
1	S 43 1/2 W	40
2	S 53 W	18
3	S 41 W	48
4	S 33 1/2 W	38 1/2
5	S 19 E	17 1/2
6	S 10 1/2 W	39
7	S 72 W	23
8	S 52 W	40
9	S 84 1/2 W	49
10	S 59 W	7

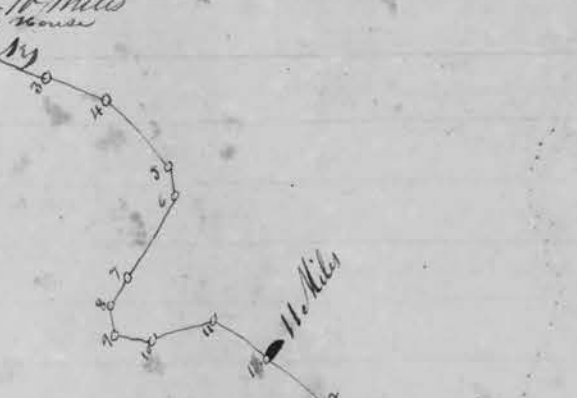

St	Course	Dist
1	S 59 W	24
2	S 53 1/2 W	46
3	S 65 W	40
4	S 56 W	36
5	S 55 1/2 W	55
6	S 61 W	24.5
7	N 74 1/2 W	25



A Sycamore 43 in dia  
monument  
Total distance between monument 12 N 191 bearing  
N 5 S 12 1/2 W 43 in dia

# Record of State Road Continued

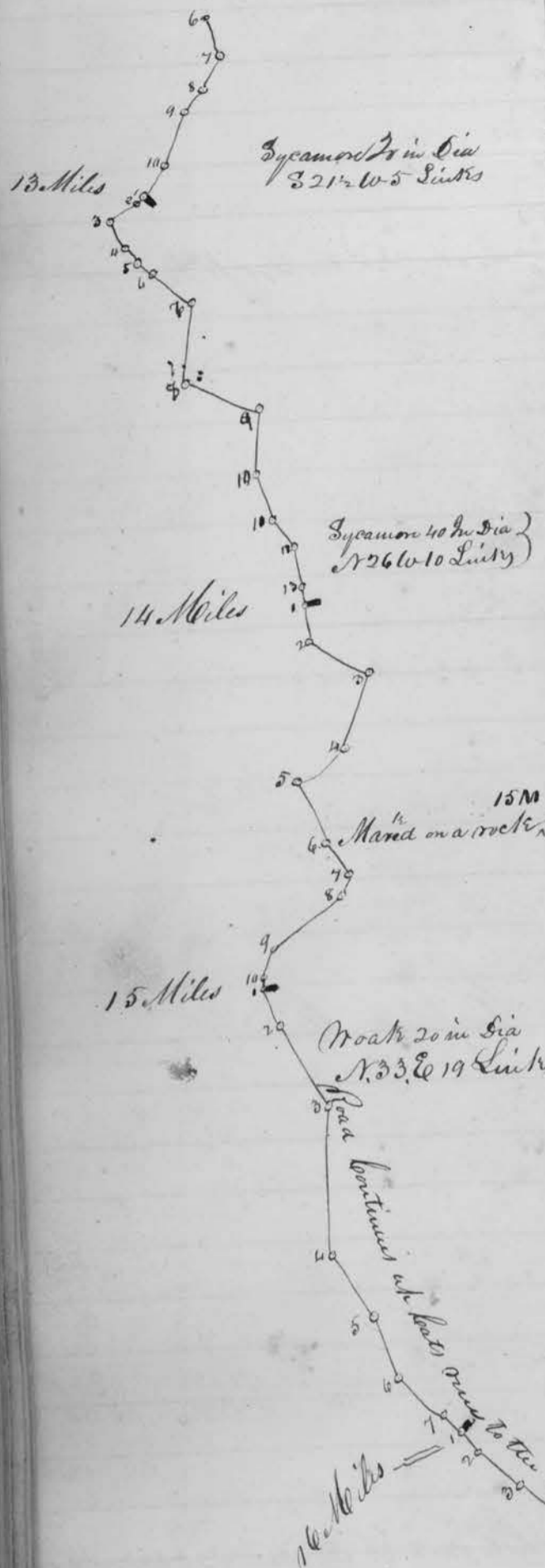

Sta	Counts	Dist
6	N 61 to	24 1/2
7	N 7 1/2 to	25
8	N 50 to	18
9	N 74 to	38
10	N 54 1/2 to	32
13 Miles		320
1	N 5 1/2 to	3 1/2 (Roaks)
2	N 44 to	24
3	N 87 1/2 to	7
4	S 43 1/2 to	12
5	S 33 1/2 to	12
6	S 33 1/2 to	112
7	N 89 to	52 1/2
8	S 11 to	48 1/2
9	N 89 to	41
10	S 67 to	30
11	S 48 to	12
12	S 70 to	26
13	S 78 to	10
14 Miles		320
1	S 78 to	25
2	S 21 1/2 to	45
3	N 77 1/2 to	50
4	N 68 1/2 to	40
5	S 59 to	46
6	S 52 to	22
7	N 74 to	15
8	N 38 1/2 to	53
9	N 76 to	20
10	N 99 1/2 to	6
15 Miles		320
1	N 89 1/2 to	26
2	S 74 1/2 to	60
3	N 73 to	94
4	S 74 to	46
5	S 81 1/2 to	42
6	S 59 1/2 to	38
7	S 64 to	14
16 Miles		320
1	S 64 to	18
2	S 57 to	32
3	S 52 1/2 to	54
4	WEST	8
5	S 46 1/2 to	21
6	N 88 1/2 to	27
7	S 71 to	19 1/2
8	S 76 to	11 1/2
9	S 89 1/2 to	8
10	N 73 1/2 to	10
11	N 53 to	7 1/2
12	N 42 to	6 1/2
13	N 12 1/2 to	6 1/2
14	N 86 1/2 to	7 1/2
15	N 76 1/2 to	5
16	N 53 to	7

St	Counts	Distance	Remarks
17	N 33 to	8	
18	N 51 1/2 to	8	
19	WEST	6	
20	N 83 to	12	
21	S 82 to	16	
22	S 74 to	12	
23	N 89 to	11	
24	S 42 to	12	
25	S 58 to	3	Roaks X 20 in Dia 32 to 27 Links
17 Miles		320	
1	S 60 to	20	
2	S 69 1/2 to	20	
3	N 72 to	16	
4	N 37 to	24	
5	N 22 1/2 to	22	
6	N 76 1/2 to	46	
7	S 49 to	18	
8	S 60 to	19	
9	N 83 1/2 to	28	
10	N 38 1/2 to	11	
11	N 79 1/2 to	20	
12	N 47 to	16	
13	S 45 1/2 to	21	
14	S 65 1/2 to	13	
15	S 60 to	20	
16	N 82 1/2 to	6	White oak 12 in Dia
18 Miles		320	N 37 to 20 Links
1	N 82 1/2 to	16	
2	N 46 to	16	
3	N 43 to	52	
4	N 87 to	32	
5	N 83 to	62	
6	S 67 1/2 to	32	
7	S 46 to	22	
8	N 89 to	50	
9	S 77 to	16	
10	S 84 to	22	
19 Miles		320	Roaks 12 in Dia 314 to 27 Links

