

Town of Belmont To Greepont in Harrison County - Continued

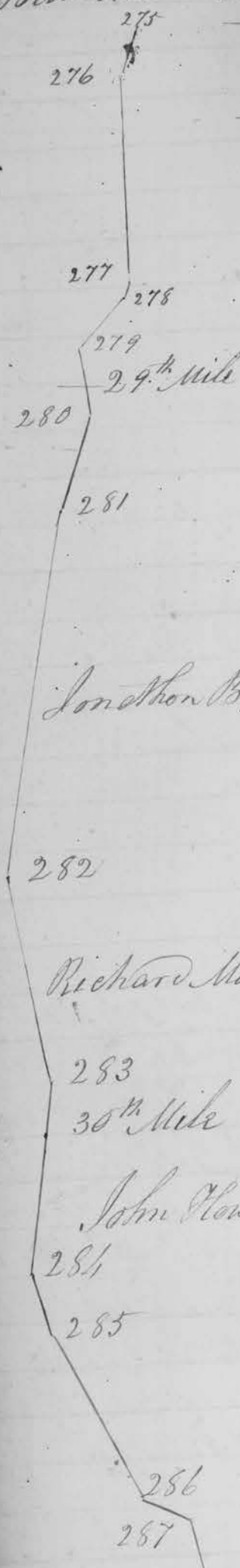

No. of Station	Course of each Station	Distance of each Station	Total Distance	Grade down	Grade down
290	N 87° W	28	16.7	Level	
291	N 55 W	14	60.7	L	
292	N 26 1/2 W	22	52.7	L	
293	N 11° W	1.8	130.7	L	
294	N 52 1/4 W	61.3	192	Unknown	
295	N 46 1/2 W	1.8	210	Unknown	School house S 75 1/2 E 110 links
296	S 87 1/2 W	10	250	5	
297	N 81 1/2 W	6	256	5	
298	N 73 1/4 W	8	264	5	
299	N 68 W	31	298	Nearly	
300	N 37 3/4 W	50	320	Level	32nd Mile, bearing N 7° E 32 links
301	N 66 1/4 W	18	44	Unknown	
302	S 65 W	32	78		
303	N 71 W	12	120		
304	N 66 1/4 W	16	136		
305	N 37 W	24	160		
306	N 30 W	4	164	5	
307	N 10 W	22	186	Unknown	
308	N 19 W	7	193	5	
309	N 33 1/2 W	16	209	5	
310	N 17 1/2 W	10	219		
311	N 38 W	7	226		
312	N 64 W	7	233		
313	N 74 W	12	245		
314	S 74 1/2 W	34	279		
315	N 64 1/2 W	10	289		
316	N 53 3/4 W	6	295	5	
317	N 35 W	8	303	5	
318	N 40 1/2 W	21	320		
319	N 30 3/4 W	10	13	4	

Jonathan Brooks

Richard Moores

John Howel

Sam Clark

School house S 75 1/2 E 110 links

32nd Mile, bearing N 7° E 32 links

33 Miles poplar 18 N 58 1/2 E 67 links

31st Mile

# Record of State Road from the Mouth of Captina by the

	No. of Station	Course of each Station	Distance of each Station	Total Distance	Grade Remaining	Grade descending
295	320	N 37° W	8 21		5°	
296	321	N 58 W	8 29		5	
297	322	N 50 1/2 W	6 35		5	
298	323	N 33 W	8 43		5	
299	324	N 57 W	15 58		3 1/2	
300	325	N 77 W	10 68		3 1/2	
301	326	N 63 1/2 W	14 82		5	
302	327	S 85 W	13 95	5°		
303	328	N 89 W	10 105	5		
304	329	N 68 1/2 W	6 111	5		
305	330	N 51 W	8 119	1 3/4		
306	331	N 16 1/2 W	9 128	3 1/2		
307	332	N 62 1/2 W	10 138	3 1/2		
308	333	N 76 3/4 W	21 159	2		Schoolhouse on the ridge
309	334	N 48 W	12 171	2		
310	335	N 68 1/2 W	6 177	5		
311	336	N 71 W	14 191	5		
312	337	S 81 W	12 203	5		
313	338	N 89 1/2 W	24 229	Level		
314	339	N 82 1/2 W	32 261	5		at 22 East side of hollow at 26 road full of 13 feet
315	340	S 67 3/4 W	4 265	5		
316	341	S 71 1/2 W	44 309	5		
317	342	N 79 1/2 W	12 313	3 1/2		3 1/2 Mile Dogwood S 5 E 36 S
318	343	N 85 W	20 20	4		
319	344	N 68 W	12 32			
320	345	N 40 W	15 6 47 6	5		at 15 rod a cut of 4 feet
321	346	N 89 W	6 53 6	Level		at 6 to cut 1 1/2 ft.
322	347	S 72 W	2 6 4 78			at 18 rod cut 3 ft 5 in.
323	348	N 66 1/2 W	18 126	5		in St. Longs Lane
324	349	N 3° E	20 146	Unknown		
325	350	N 10 E	18 164	5		
326	351	N 18 3/4 W	6 170	5		
327	352	N 34 W	73 52 13 5	2		
328	353	N 69 1/2 W	23 266 5			
329	354	N 75 1/2 W	90 360	320		at 32 road a full of 5 feet 3 in 35th Mile poplar 14 S 54 W 68 S
330	355	N 63 W	14 50	5		
331	356	N 23 W	36 86			
332	357	N 35 1/4 W	92 178			
333	358	S 88 1/2 W	8 186	5		at 27 rod cut of 3 ft 3 in at 38 full of 3 3
334	359	S 88 W	106 292	Unknown		at 50 rod full of 6 1/2 feet at 74 rod cut of 6 1/2 feet
335	360					
336	361	N 52 1/2 W	33 320	5		36th Mile W 10 28 S 43 1/4 W 49
337	362	N 83 1/2 W	65 70			
338	363	S 50 W	47 117			

32 Mile

33rd Mile

31st Mile

36th Mile

Map of Belmont to Greepart in Harrison County - Continued

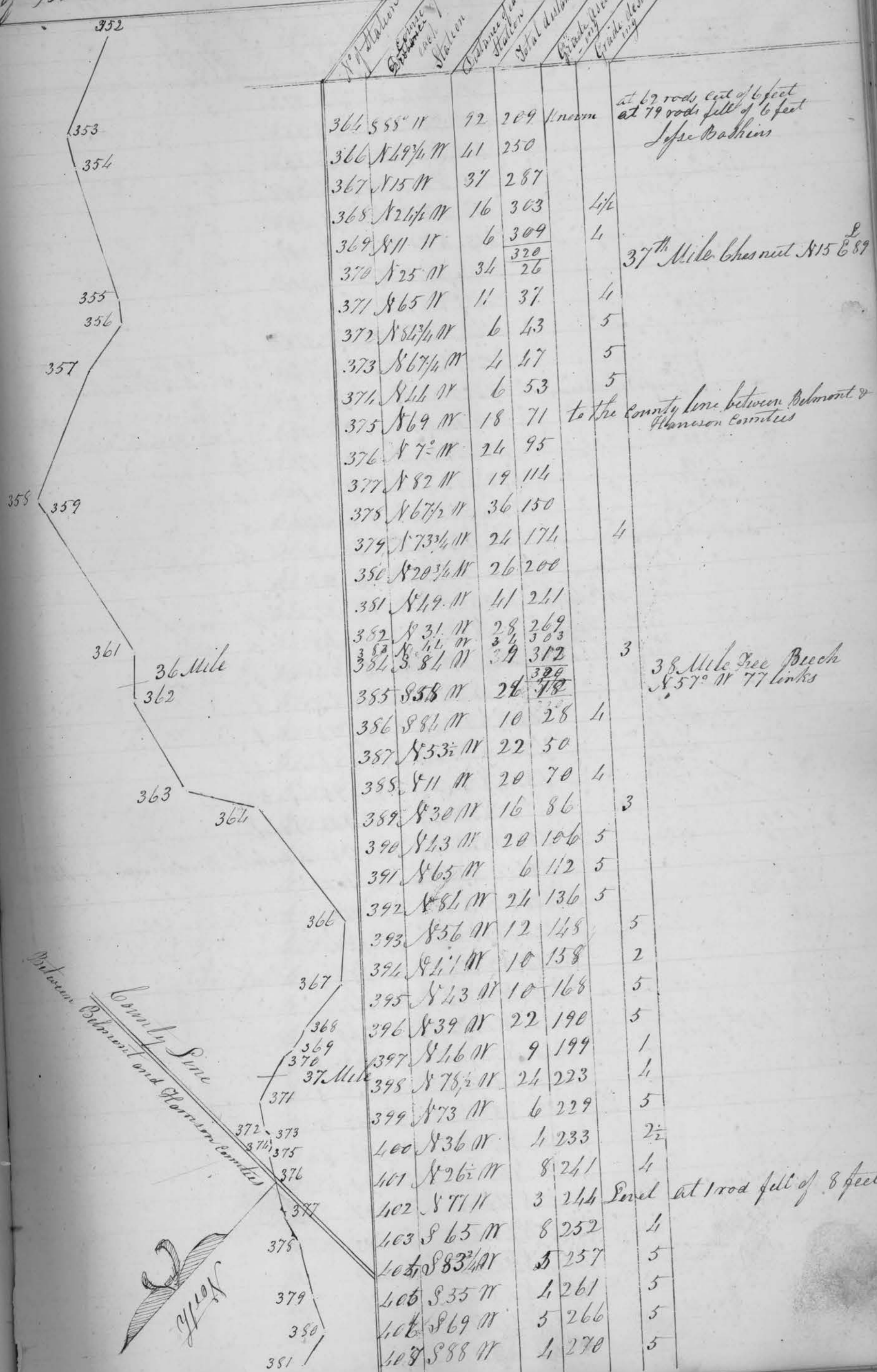

County Line  
Between Belmont and Harrison Counties



# Record of a State Road from the Mouth of Captina

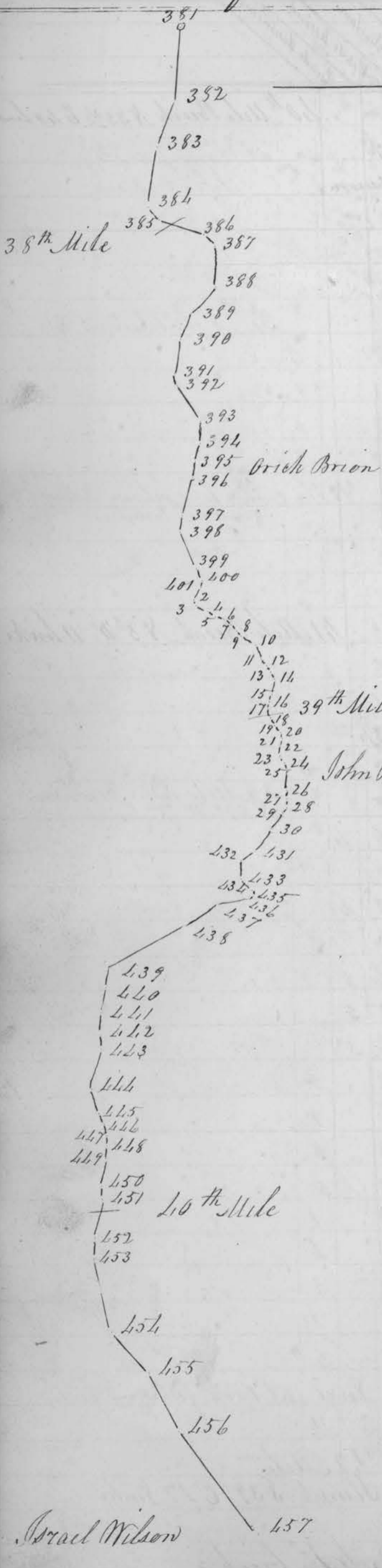

Station	Course of each Station	distance of each Station	Total distance	Grade down in ft	Grade down in ft
408	S 81 1/2 W	1	274	5	0
409	S 73 W	8	282	1	0
410	N 77 W	8	290	4	0
411	S 83 1/2 W	1	294	5	0
412	N 83 1/4 W	1	298	5	0
413	N 70 W	1	302	5	0
414	N 15 W	8	310	1	0
415	N 28 W	2	314	5	0
416	N 43 1/2 W	1	318	5	0
417	N 70 W	6	324	5	0
418	N 84 W	1	8	5	0
419	West	6	14	5	0
420	N 63 1/2 W	3	17	5	0
421	N 37 W	1	21	5	0
422	N 56 W	6	27	5	0
423	N 59 W	5	32	5	0
424	N 71 1/2 W	3	35	5	0
425	N 39 1/2 W	12	47	5	0
426	N 35 W	5	52	5	0
427	N 43 1/2 W	4	56	5	0
428	N 33 1/2 W	1	60	5	0
429	N 21 1/4 W	10	70	5	0
430	N 19 3/4 W	16	86	4	0
431	N 5 E	9	95	5	0
432	N 52 W	10	103	Level	0
433	S 82 1/2 W	10	115	to cross the bridge over big Stillwater	0
434	N 45 W	2	117		0
435	N 11 W	2	119		0
436	N 25 1/2 E	18	137		0
437	N 2 1/2 W	21	158		0
438	N 8 E	50	208		0
439	N 46 3/4 W	11	219	5	0
440	N 42 1/2 W	14	233	5	0
441	N 51 1/4 W	12	245	5	0
442	N 52 3/4 W	8	253	5	0
443	N 42 1/2 W	23	276	5	0
444	N 68 1/2 W	14	290	5	0
445	N 71 1/4 W	7	297	5	0
446	N 65 3/4 W	6	303	5	0
447	N 56 W	6	309	5	0
448	N 48 W	7	316	5	0
449	N 51 W	16	332	5	0
450	N 36 W	6	338	5	0

39th Mile Bench  
N 8 W 55 links

Israel Wilson

To Freeport in Harrison County - continued

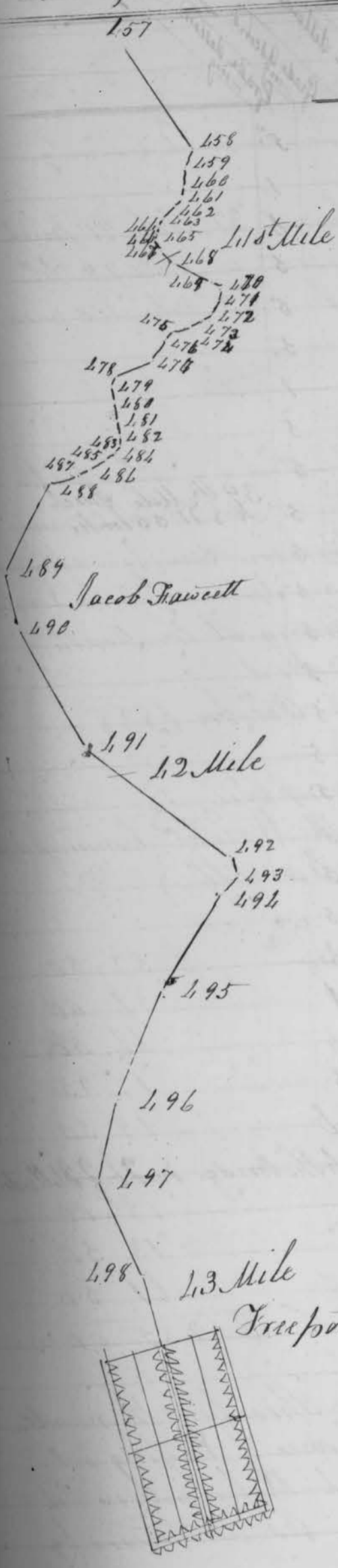

Sta	Course of each Station	Distance of each Station	Total Distance	Grade Ascending	Grade descending
451	N 23° W	22	320		
452	N 51 1/4° W	11	31	3 1/2	
453	N 88° W	12	73	None	
454	S 83 1/2° W	32	105		
455	N 81 1/2° W	36	141		
456	S 86 1/2° W	74	215		
457	N 81 1/2° W	58	273		
458	N 26° W	9	282	5	
459	N 13 1/2° W	9	291	5	
460	N 10 1/2° W	6	297	5	
461	N 9° W	1	301	5	
462	N 7 1/2° W	8	309	5	
463	N 2 1/4° W	3	312	5	
464	N 39 1/2° W	4	316	5	
465	N 10 1/2° W	2	318	5	
466	N 85 1/2° W	5	320	5	
467	S 77 1/2° W	8	11	4	
468	S 75 1/2° W	20	31	5	
469	S 77° W	5	36	3 1/2	
470	N 5 1/2° W	4	40		
471	N 33° W	7	47	5	
472	N 8 1/2° W	5	52	5	
473	N 1 1/2° E	8	60	5	
474	N 13 3/4° E	8	68	5	
475	N 23° W	4	72		
476	N 27° W	12	84		
477	N 8° E	18	102	5	
478	N 39 3/4° W	5	107	5	
479	N 38° W	7	114	5	
480	N 70 1/2° W	10	124	5	
481	N 69° W	7	131	5	
482	N 5 1/2° W	3	134	5	
483	N 26° W	4	138	5	
484	N 12 3/4° W	5	143	5	
485	N 5° W	9	152	5	
486	N 10° E	6	158	5	
487	N 15° E	13	173	5	
488	N 30 1/2° W	28	221	5	
489	N 77° W	28	249		
490	S 89 3/4° W	66	315	5	
491	S 68° W	86	81	None	
492	N 76 1/2° W	8	89		
493	N 25° W	12.8	101.8		

1.0<sup>th</sup> Mile Branch N 35 1/4° E 40 links

4.1 Mile Branch N 5° W 11 links

1.2 Mile  
Stump S 39° E 17 links  
cross the creek

85 State Road from the Mouth of Captina to Freeport in Harrison County — Continued —

Station	Course of each Station	Distance of each Station	Total distance	Grade ascending	Grade descending	
L 94	N 27 1/2 W	52	153.8			a cross the bottom
L 95	N 37 W	57	210.8	5		
L 96	N 17 1/4 W	1.0	250.8	Unknown		
L 97	N 83 1/2 W	1.92	300			
L 98	N 73 1/2 W	120	320 100			1.3 Mile a stump S 112 1/2 W 15 links
To the square in Freeport						

Distance in each County  
 In Belmont 37 Mile 71 perch  
 In Harrison 6 Mile 29 p.  
 Total 1.3 Mile 100 perch

In pursuance of an Act of the General Assembly of the State of Ohio for the Laying out of a Road from the Mouth of Captina Creek in Belmont County through Belmont in said County to Freeport in Harrison County. after being qualified as the Law directs. We the undersigned have surveyed and located a Road agreeable to the above plat and notes Beginning at the Mouth of Captina Creek and Ending at the Square in Freeport  
 Given under our hands County fourth day of October 1828

Belmont and Harrison Counties D  
 To John Campbell Nehemiah Wright }  
 & David Barrett. Road Commissioners }  
 John Campbell }  
 Nehemiah Wright } Commissioners  
 David Barrett }

John Campbell	35 Days @ \$1.50 per Day	\$ 52.50
Nehemiah Wright	36 days - 1.50	54.00
David Barrett	31 days 1.50	46.50
John Gault	23 days @ 75 cts	17.25
Chamberlain } David Sharp	26 days @ 75	19.50
George Preat	3 days @ 75	2.25
Axeman } Thomas Barrett	24 days @ 75	18.00
Staf beam } Uriah Barrett	18 days @ 75	13.50
Surveyor } Uriah McMullin	11 days @ 1.50	16.50
		\$ 285.00-

We the undersigned certify that the above Bill Specifies the number of days that each person was employed in the Service of Laying out a Road from the Mouth of Captina Creek through Belmont in Belmont County to Freeport in Harrison County as authorized by the Legislature of the State of Ohio  
 Given under our hands this 25<sup>th</sup> of 10<sup>th</sup> Month 1828

John Campbell } Road  
 Nehemiah Wright } Commissioners

Record of a State Road Beginning three and half Miles West of the Town of Mansville on the National Road. Thence through Uniontown Flushing, Moorfield and Freeport to the Ohio Canal & Salisbury

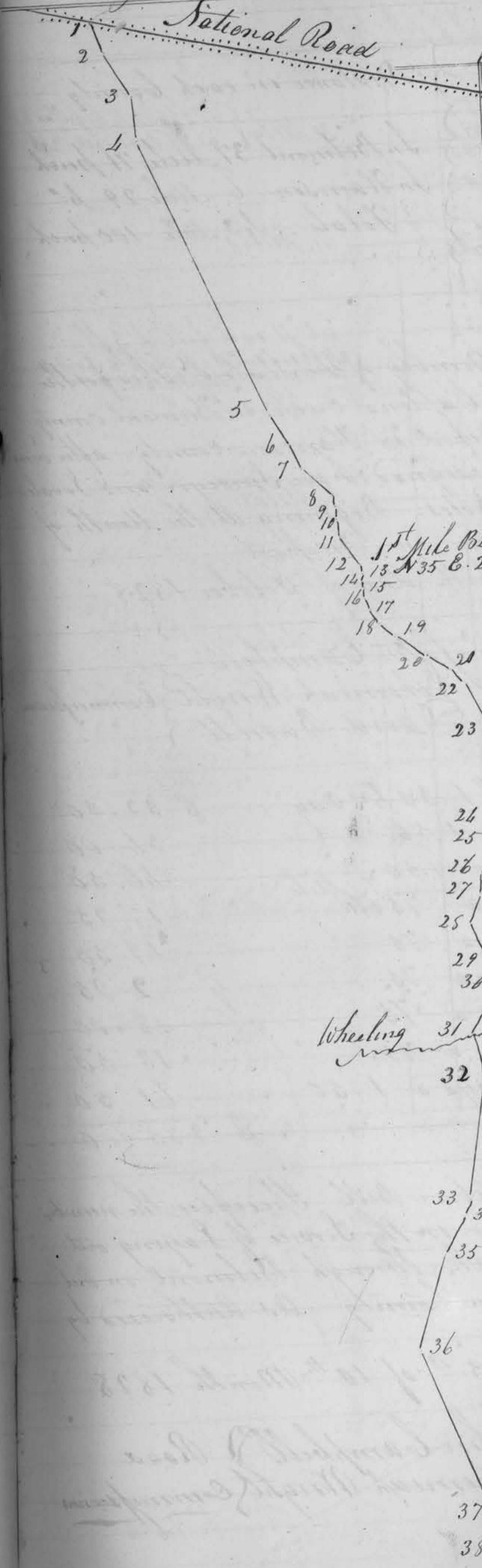

No of Station	Course of each Station	Distance of each Station	Total Distance	Grade	Remarks
1	N 22 1/2 W	18	18	5	
2	N 30 W		28		
3	N 7 1/4 W		23		
4	N 26 W	16 1/2			at 60 rod to be filled 2 1/2 feet at 68 to be cut 2 1/2 feet at 108 to be filled 2 1/2 feet
5	N 3 1/2 W	18			
6	N 30 W	14			
7	N 47 W	22		1	
8	N 11 1/2 W	6		5	
9	N 9 W	6		5	
10	N 13 W	10			
11	N 37 W	11			
			320		
12	Some course	7		1	1st Mile
1st Mile Branch 20 links					
13	N 35 E	23			
14	N 10 E		4	5	
15	N 10 W		4	5	
16	N 17 W		4	5	
17	N 19 W		6	5	at one rod to be filled 1 ft 9 in
18	N 35 W		9	2	
19	N 52 W		10	2	
20	N 64 W		20	5	for 10 rod
21	N 57 W		15		
22	N 50 W		10		
23	N 30 W		30	5	
24	N 3 W		50		
Wheeling					
2nd Mile					
25	N 6 3/4 E		10	3	
26	N 10 E		16	4	
27	N 3 3/4 E		11	5	
28	N 16 E		17	5	
29	N 29 1/2 W		22		
30	N 14 W		16		
31	N 2 1/2 E		29		
32	N 11 W		25		2nd Mile
			320		
33	N 1 E		64	2	
34	N 12 E		8	3	
35	N 26 E		24	4	
36	N 12 1/2 E		54	3	
37	N 25 W		94	2	

# Record of a State Road Beginning on the National



No. of each Station	Course of each Station	Distance of each Station	Grade Ascending	Grade Descending
37	N 6° W	20		
38	N 23 W	56		
	Some	35		
39	N 30 W	203		
40	N 37 W	82		
		320		
41	N 28 W	116		
42	N 11 3/4 W	136		
43	N 39 1/2 W	92		
44	N 88 W	52		
45	N 82 W	70.4		
46	N 69 W	6		
		320		
	Some course	26		
47	N 81 1/2 W	50		
48	N 72 3/4 W	106		
49	S 86 W	138		
		320		
	Some	14		
50	N 70 W	42		
51	N 52 W	60		
52	N 66 1/2 W	100		
53	N 57 1/2 W	20		
54	N 26 W	14		
55	N 17 W	70		
		320		
	Some	18		
56	N 60 W	58		
57	N 54 W	50		
58	N 67 1/4 W	23		
59	N 80 W	50		
60	S 88 1/4 W	12		

3<sup>rd</sup> Mile Wt. 0 8 in East 70 links

3 Miles { at 58 rod to be filled 3 ft.  
at 7 1/2 to be cut 2 1/2 ft.

1 1/2 Miles

at 11 rod full of 3 ft.  
at 23 rod cut of 3 ft at the end of Union  
at 60 rod The Square

5 Miles

6 Miles

7 Miles

1<sup>st</sup> Mile Thon 3 in N 57 3/4 E 32 links

5 Miles Wt. 0 28 in S 28 1/2 W 12 links

6 Miles Full 12 inches North



of Halsberg 88

Road 3 1/2 miles West of St. Clairsville thence to the Ohio Canal at the town

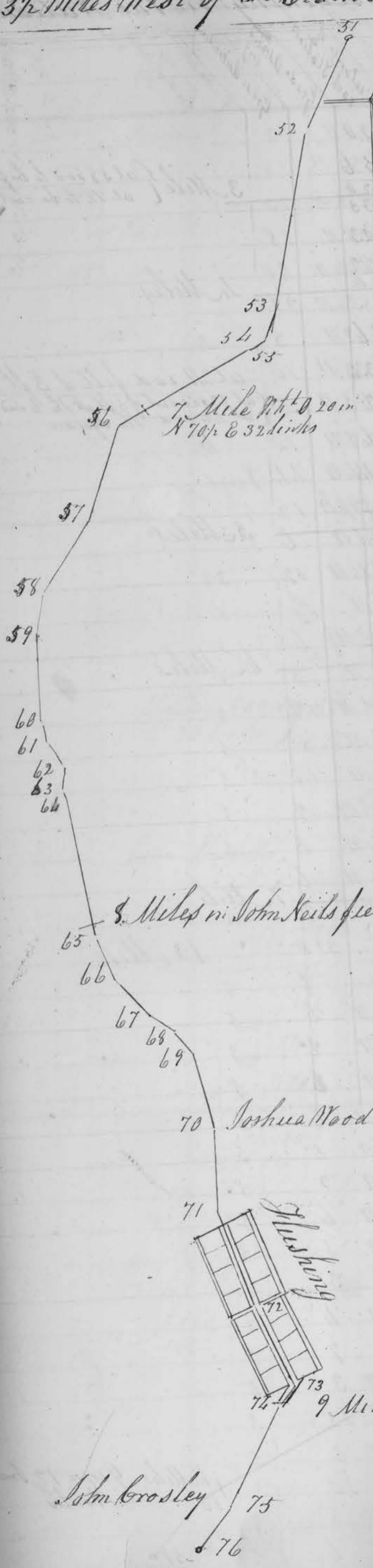

St. Station	Course of each Station	Distance of each Station	Grade ascending	Grade descending
61	S 70 W	16		
62	N 50 W	15		
63	S 85 W	1		
64	N 89 1/2 W	7 1/2		
		32 0		
Same		8		
65	S 81 1/2 W	26		
66	S 57 W	30		
67	S 19 W	16		
68	S 6 1/2 W	17		
69	S 87 W	4 1/2		
70	N 80 W	15		
71	S 81 1/2 W	60		
72	S 75 1/2 W	3		
73	N 28 W	14		
		312		
8 Mile				
74	S 53 W	66	5	
75	N 42 W	30		
76	N 77 W	35		
77	N 57 1/2 W	10		1
78	N 81 1/2 W	60		
79	N 13 1/2 W	28		
80	N 83 W	16		
81	N 61 1/2 W	8		
82	N 81 1/2 W	8		
83	N 66 W	31		
84	N 37 1/2 W	25		
		32 0		
10 Mile				
Same		16		
85	N 75 W	16		
86	S 66 1/2 W	20		
87	S 88 1/2 W	36		
88	N 80 W	18		
89	N 9 1/2 W	28		3
90	N 32 1/2 W	7		1 1/2
91	N 63 1/2 W	20		1
92	N 11 W	22		
93	N 33 W	6		
94	N 20 W	14		
95	N 21 1/2 E	32		
96	N 18 W	12		
97	N 10 W	3 1/2		
98	N 68 W	9		
		320		
11 Miles				

a bridge 1/2 rod long  
8 Mile  
at 3 a bridge to be 5 rod long

at 32 rod cut of 5 ft 11 inches  
at 38 fell off 5 ft 11 in  
at 38 cut of 9 feet 5 inches  
at 17 cut of 7 ft 11

at 35 rod cut to be 5 ft 3 in

at 22 rods line between Belmont and Harrison Counties

# Record of a State Road from the National

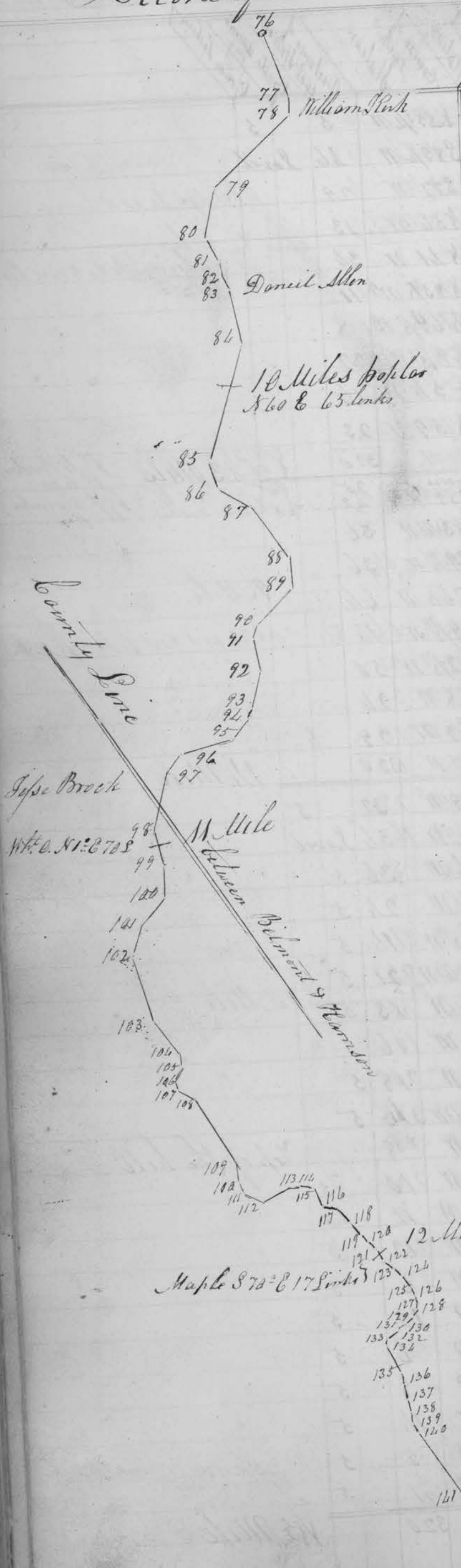

No of Station	Course of each Station	Distance of each Station	Grade ascending	Grade descending
76				
77				
78	William Park	N 65 W	12	
79				
80				
81				
82	Daniel Allen	N 55 W	15	
83				
84				
85				
86				
87				
88				
89				
90				
91				
92				
93				
94				
95				
96				
97				
98				
99				
100				
101				
102				
103				
104				
105				
106				
107				
108				
109				
110				
111				
112				
113				
114				
115				
116				
117				
118				
119				
120				
121				
122				
123				
124				
125				
126				
127				
128				
129				
130				
131				
132				
133				
134				
135				
136				
137				
138				
139				
140				
141				
142				
143				

320 12 Mile