

Record of a State Road from the Town of Mt Pleasant in Jefferson to Martins Ferry on the Ohio River in Belmont County

To the Honorable the Commissioners of Belmont County and State of Ohio

We the undersigned being appointed by an act of the Legislature of this State at their last sitting to lay out a Road from Mount Pleasant in Jefferson County to Absalom Martins Ferry in Belmont County in obedience to said Act Met at the Town of Mount Pleasant aforesaid and calling to our aid a Surveyor Chamberlains &c and being sworn as the Law directs proceeded to the several duties enjoined

When after an examination of the different Tracts between the aforesaid points we have agreed on the location of said Road Agreeably to the Survey and plat herein represented

I Witness whereof we have hereunto set our hands this 31st May A D 1828
Commissioners
George Atkinson
Absalom Martin
Surveyor
Robert Patterson

Beginning Mount Pleasant Mr. Vloggs corner

Thence South 71^o E. 39 perches Level S 21^o E 50 perches 5 degrees depres.
ion S 36^o E 44 L. S 11^o E 28 p^t L. S 9^o E 8 p^t L. S 52 perches L
S 9^o W 17 p^t L. S 2^o W 26 p^t L. S 7^o W 24 p^t L. S 32^o E 38 p^t L
S 13^o E 24 p^t L. S 28^o E 26 p^t L. S 31^o E 25 p^t L. S 11^o E 20 p^t L
S 6^o E 26 p^t L. S 14^o E 26 p^t L. S 26^o E 29 L. S 21^o E 18 p^t L. S 2^o W
23 p^t L. S 5^o E 22 p^t L. S 9^o E 26 p^t L. S 21^o E 24 p^t L. S 5^o W 20 p^t L
S 20^o W 10 p^t L. S 59^o E 18 p^t 5 degrees Elevation S 84^o E 6 p^t 5^o Elevation
S 40^o E 16 p^t 1^o Elevⁿ S 46^o E 19^o p^t 5 Elevⁿ N 55^o E 8 perches 5 Elevation
N 70^o E 11^o p^t 5 Elevation N 78^o E 9^o p^t 5 Elevation S 86^o E 10 p^t 5 Elevⁿ
S 77^o E 14 p^t 5 Elevation S 73^o E 10 5 Elevation S 67^o E 26 p^t 5 Elevation
S 3^o W 10 p^t 5 Elevation S 9^o W 35 p^t 5 Elevation S 41^o E 20 p^t 5 Elevation
S 57^o E 38 p^t 3 degrees depression S 35^o E 32 p^t 3 depressⁿ S 33^o E 31^o p^t 3
depression S 28^o E 20 p^t 3 depression S 84^o E 34 p^t 3 depression S 61^o E
12 p^t 3 depression S 18^o E 20 L. S 11^o E 11 p^t 5 Elevation S 45^o E 12 p^t
5 Elevation S 40^o E 14 p^t 5 Elevation S 17^o E 17 p^t 5 Elevation S 7^o E 18 p^t L
S 52^o E 18 p^t L. S 63^o E 37 p^t 2 Elevation S 80^o E 12 p^t 2 Elevation
S 76^o E 13^o p^t 2 Elevation S 14^o E 30 p^t 2 Elevation S 68^o E 10 p^t 5 Elevation
S 51^o E 6 p^t 5 Elevation South 20 p^t 3 Elevation S 49^o E 16^o p^t L. S 69^o
E 26 p^t L. S 27^o E 24 p^t 5 depression S 45^o E 68 p^t 2 depression S 20^o E
7 p^t 5 Elevation S 19^o E 14 p^t L. S 21^o E 27 p^t L. S 54^o E 59 p^t 1 depression
S 4^o E 88 p^t L. S 66^o E 6 p^t 5 depression N 51^o E 9 p^t 5 depression
N 75^o E 8 p^t 5 depression S 10^o E 57 p^t L. S 60^o E 17 p^t L. S 15^o E 50 p^t L
S 8^o W 12 p^t 5 depression S 17^o W 11 p^t 5 depression S 10^o E 5 p^t 5 depression
S 19^o E 5 p^t 5 depression S 65^o E 8 p^t 5 depression S 69^o E 8 p^t 5 depression
S 57^o E 16 p^t 5 depression S 61^o E 11 p^t 5 depression S 81^o E 22 p^t 5 depression
S 43^o E 28 p^t L. S 28^o E 26 p^t L. S 7^o W 38 perches 3 Elevation

11 Record of a State Road from N^o Pleasant continued

S 10^o E 16 p^s 3 degrees Elevation S 42³/₄ E 8 p^{ches} 3 Elevation. S 29^o E 5 p^s
 5 Elevation S 11^o E 6 p^s 5 Elevation S 13^o E 6 p^s 5 Elevation S 15^o E 1 p^s
 5 Elevation S 19^o E 6 p^s 5 Elevation S 21^o E 6 p^s 5 Elevation S 15^o E 12 p^s
 3 Elevation S 19^o E 9 p^s 5 Elevation S 25^o E 7 p^s 5 Elevation S 30^o E
 9 p^s 5 Elevation S 37^o E 10 p^s 5 Elevation S 46^o E 9 p^s 5 Elevation S 17^o E
 8 p^s 5 Elevation S 2^o W 7 p^s 5 Elevation S 40^o E 5 p^s 5 Elevation S 53^o E 14
 p^s 5 Elevation S 37^o E 7 p^s 5 Elevation S 75^o E 7 p^s 5 Elevation S 81^o E 16
 p^s 5 Elevation S 5^o E 34 p^s 5 Elevation S 87^o E 12 p^s 5 depression S 80^o E 8 p^s
 5 depression S 46^o E 10 p^s 5 depression S 54^o E 8 p^s 5 depression S 85^o E 6 p^s
 5 depression N 69^o E 7 p^s 5 depression S 65^o E 17 p^s 1 depression
 S 47^o E 6 p^s 5 depression S 77^o E 13 p^s 5 depression S 72³/₄ E 21 p^s 5 depre
 N 12^o E 11 p^s 5 depression N 19^o E 11 p^s 5 depression N 74^o E 9 p^s 5 depression
 S 61^o E 10 p^s 5 depression N 81^o E 6 p^s 5 depression N 41^o E 8 p^s 5 depression
 N 24^o E 8 p^s 5 depression S 83^o E 4 p^s 5 depression N 77^o E 17 p^s 5 depre
 N 65^o E 12 p^s 5 depression N 64^o E 21 p^s 5 depression S 20^o W 9 p^s 5 depression
 S 5^o W 8^o p^s 5 depression S 19^o W 12 p^{ches} 5 depression S 1^o W 41 p^s 5 depre
 S 22^o W 115^o p^s S S 62^o E 30 p^s 5 depression To the Ohio River be
 Being one mile 2 q^{rs} 16 p^{ches} & 17 links in Jefferson County And
 6 miles 2 q^{rs} 17 p^{ches} & 8 links in Belmont County

Bill of the Expenses of the survey of this Road &c

Commissioners Expenses	{	George Atkinson 8 days @ \$1.50 p ^s day.	\$ 12.00
		Abraham Martin 8 days @ 1.50	12.00
		William Hopkins 8 days @ 1.50	12.00
Surveyor	Robert Patterson	7 days @ 1.50	10.50
Chain bearers	{	James Wiley 1 day @ \$0.75 p ^s day	3.00
		William Wood 1 day @ .75	3.00
Markers	{	William Watson 1 day	75
		Jeremiah Madden 1 day	75
Iron Carriers			

We certify the above to be a correct list of the time each one has been employed in laying out the within Road

Given under our hands this 31st day of May 1828

George Atkinson
 Abraham Martin

Record of a State Road from the Mouth of Captina Creek to Belmont in Belmont County thence to Freeport in Harrison County

Ohio River

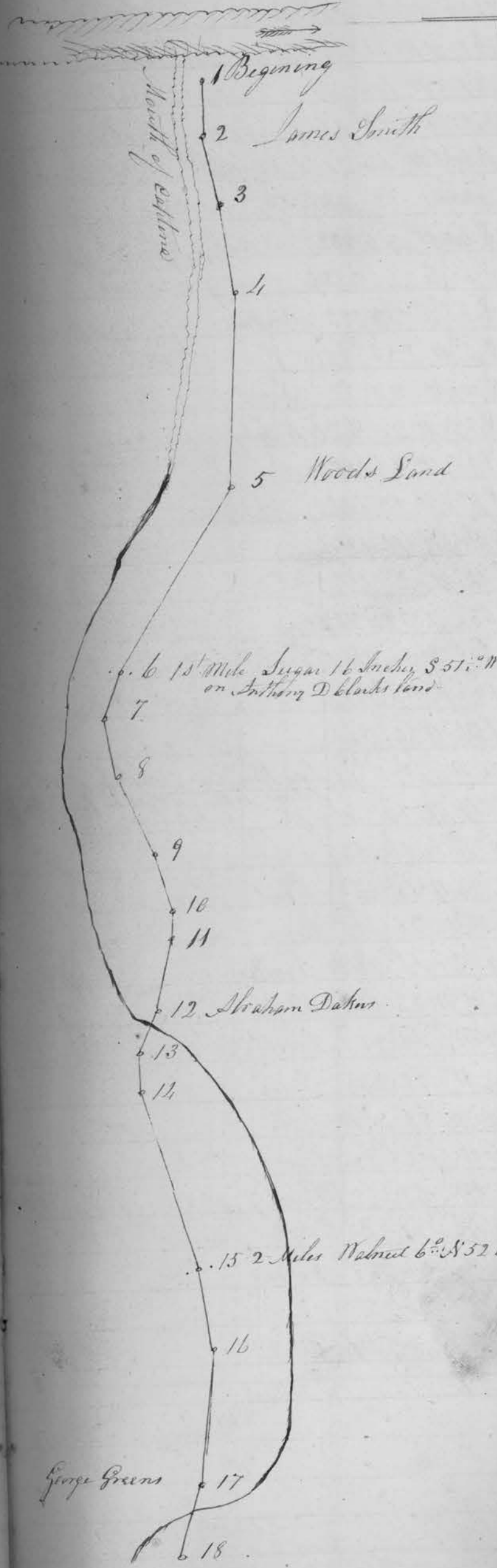

No of Station	Course of each Station	Distance of Station in Poles	Total Distance	Grade ascending	Grade descending
1	N 73 1/2° W	29	29	Level	
2	N 87° W	36	65	Level	
3	N 82° W	46	111	Level	
4	N 71° W	99	210	Level	
5	N 41 1/2° W	110	320	1st Mile	Sugar 16 S 51 1/2° W 42 links
6	N 50° W	26	26	Level	
7	N 87° W	30	56	Level	
8	S 82 1/4° W	44	100	Level	
9	N 89° W	30	130		at 27 Rods a fill of 2 feet 10 in
10	N 73° W	14	144		at 30 a cut of 3 feet
11	N 62 1/2° W	38	182		at 1 Rod a cut of 1 1/2 feet
12	N 18 1/3° W	23	205		at 9 a fill of 1/2 feet
13	N 76° W	20	225	4°	at 10 Rods a fill of 1 1/2 feet
14	West	95	320	Level	2nd Mile
15	N 83° W	12	42	to State	Joseph Layman's Meadon is N 8° W 58 links
16	N 67° W	70	112	Level	39 Rods then 3 1/2° descent 38 Rods
17	N 56 1/2° W	39	151		cross the creek
18	N 63 1/4° W	21	175	5 1/2°	
19	N 27 1/4° W	16	191	5 1/2°	
20	N 60° W	12	203	6°	
21	N 54° W	10	213	6°	
22	N 35 1/2° W	7.6	220.6	6°	
23	N 67° W	8.4	229	6°	
24	S 83° W	14	243	6°	
25	S 86 1/4° W	9	252	6°	
26	N 81 1/2° W	22	274	6°	
27	S 77 1/4° W	11	285	6°	
28	S 69 1/3° W	9	294	6°	
29	S 60 3/4° W	10	304	6°	
30	S 44 1/2° W	27	329	2	
31	S 76 1/2° W	27	38	near Level	
32	N 82 1/2° W	24	62	3°	
33	N 56° W	27	89	4°	
34	N 70° W	12	101	4°	
35	N 30° W	4	105		a hollow to be filled 5 feet at 2 Rods
36	N 18° W	34	139	5°	at 1 Rod cut of 8 feet
37	N 32 1/2° W	38	177	7°	
38	S 18° W	7	184	7°	a fill of two feet 8 inches at 12 Rod
39	N 24° W	12	196	7°	
40	N 38° W	40	236	6°	for 12 Rods then Level

State Road from The Mouth of Captina by the way

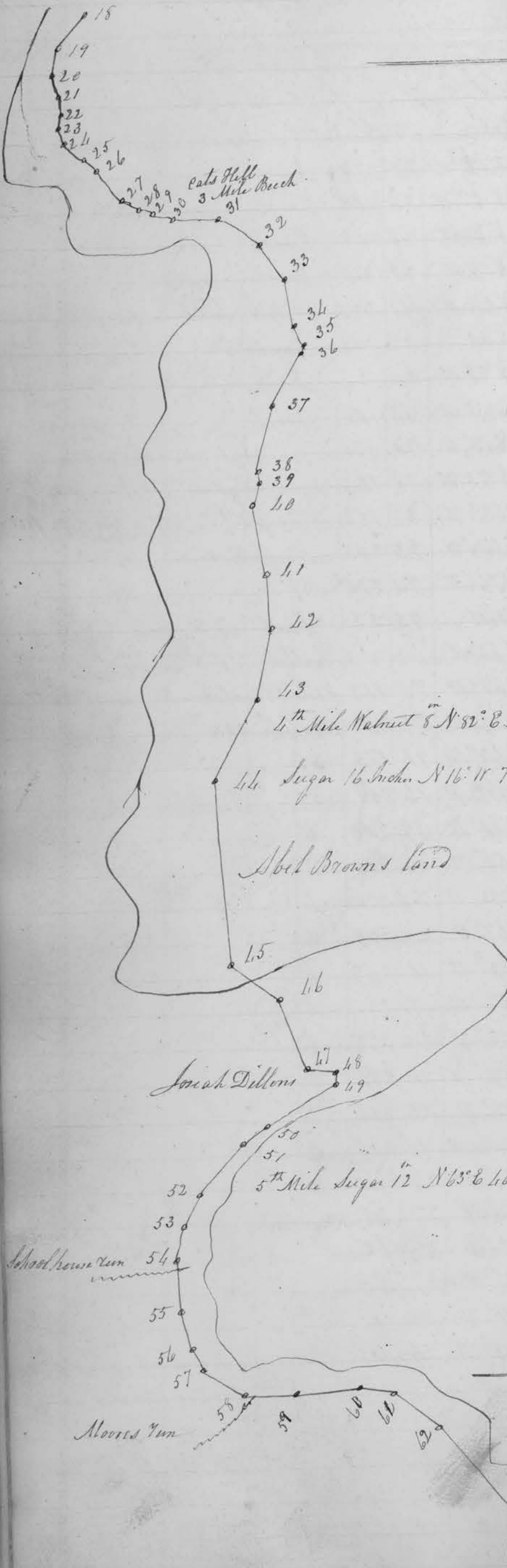

No. of Station	course of each Station	Distance of each Station	Total Distance	Grade	Remarks
11	N 50° W	30	266	Level	
12	N 31° W	40	306	Level	
13	N 18 1/2° W	51	³²⁰ 37	Level	1 st Mile
14	N 50° W	104	411		
15	S 78 1/2° W	34	175	break	
16	N 65° W	12	217	Level	
17	S 33° W	17	234	5°	
18	N 40° W	5.1	239.1		at the top to be cut 9 feet Dillon's point
19	N 41° E	44	283.1		for 20 rods
20	N 6° E	16	299.1	near Level	
21	N 41° W	38	³²⁰ 17.1		5 th Mile
22	N 20° W	20	37.1	Level	
23	N 31 1/3° W	20	57.1		to School house run a bridge 3 1/2 rods long
24	N 50° W	28	85.1		
25	N 62 1/2° W	22	107.1		
26	N 73 1/2° W	14	121.1		
27	S 76° W	26	147.1		
28	S 43 1/2° W	29	176.1		
29	S 40° W	35	211.1		
30	S 52 1/2° W	18	229.1		
31	S 63 1/4° W	31.6	261		
32	S 78° W	⁶⁹ 20	³³⁰ 21		here there was a mistake of 10 rods adding so there is 330 rods from 5 th to 6 th mile trees
33	N 71 1/4° W	20	41		
34	N 2° E	14	55		
35	N 71 1/4° W	18	73	Level	
36	S 63° W	28	101	Level	
37	S 49° W	11	112	Level	
38	S 68 1/2° W	22	164	Level	
39	N 89° W	44	208	Level	
40	N 62° W	25	233	Level	
41	S 81 1/4° W	59	292		
42	N 16° W	²⁸ 105	³²⁰ 72.2	Level	7 th Mile
43	N 24° W	60	182	Level	30 rods at 52 rods cut of 14 feet 14.8 at 34 rods full of 4.8
44	N 11 1/2° E	61	243	Level	
45	N 41° E	24	267	Level	
46	N 52° E	20	287	Level	
47	N 36° E	27	314	Level	

6th Mile Tree Apple 10 inches S 23° W 73 links
In John Brysons orchard

of Belmont Town to Iraport in Harrison County Continued

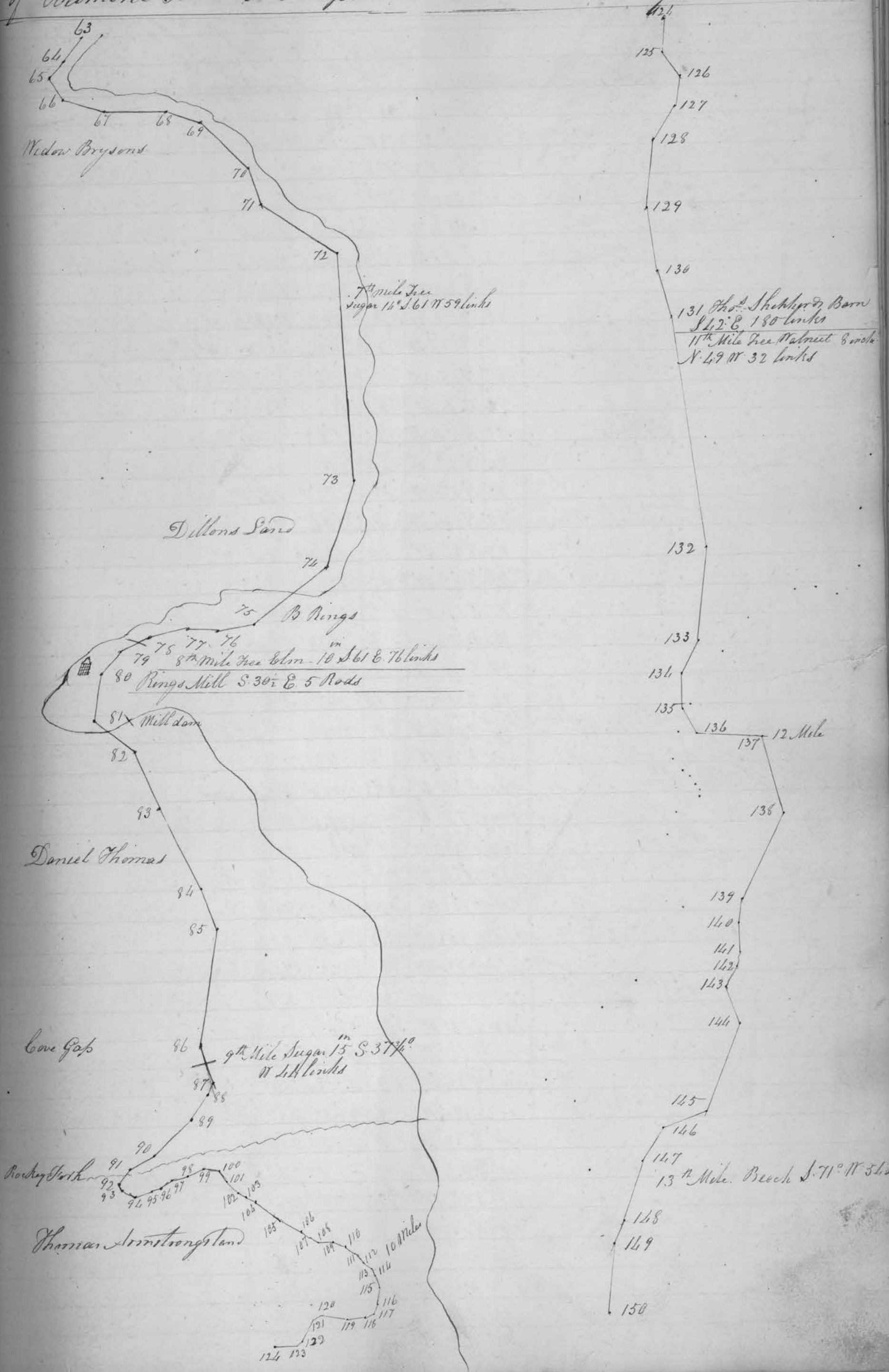

State Road from the Mouth of Captina Creek by the

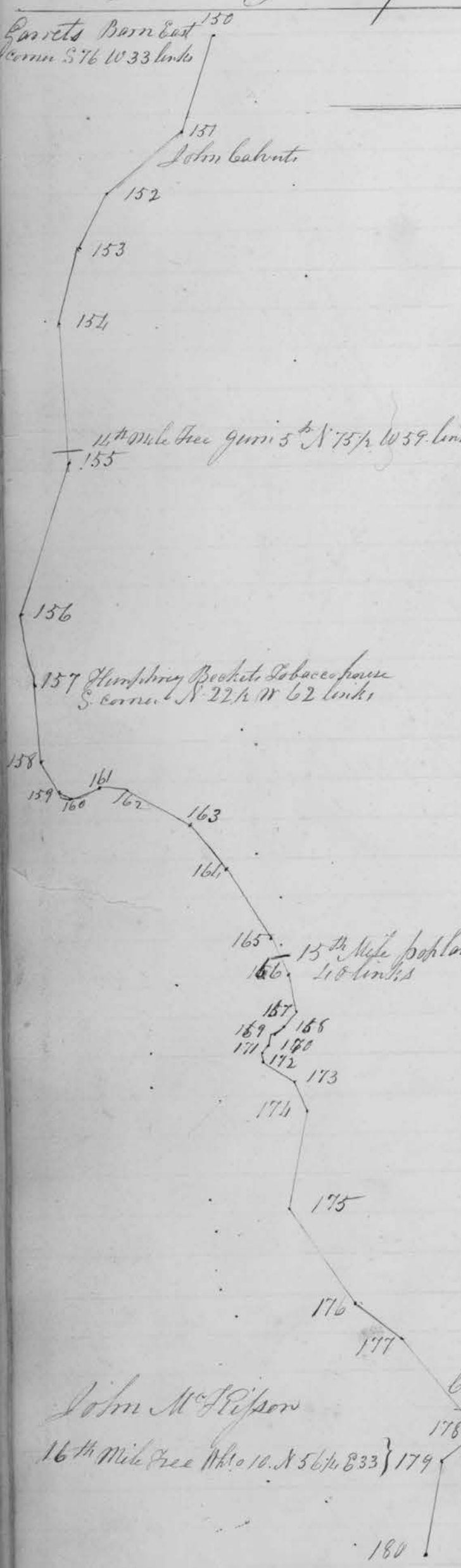

No of Station	Course of each Station	Distance of each Station	Total Distance	Grade ascending	Grade descending
78	N 22 1/2 E 20	320	14	Level	
79	N 1 1/2 W 20	31		Level	
80	N 31 W 30	61		Level	
81	S 86 1/2 W 31	98		break	
82	N 62 1/2 W 40	138		Level	
83	S 67 W 60	198		Level	
84	N 61 W 28	226		Level	
85	N 31 W 76	302		Near level 3 1/2 feet the	
86	N 57 W 28	320	10	2 1/2 1/4 mile	
87	N 17 W 6	16		1 1/2	
88	N 6 W 22	38		1 1/2	
89	N 7 1/2 E 31	72		1 1/2	
90	N 22 E 18	90		1 1/2	
91	N 1 1/2 W 12	102		Level	
92	N 56 1/4 W 1	106			
93	S 82 W 10	116			
94	S 32 W 12	128	5		
95	S 26 W 6	134	5		
96	S 11 1/4 W 9	143	5		
97	S 39 W 11	154	5		
98	S 31 W 10	164	5		
99	S 38 3/4 W 11	175	5		at 6 rods a cut of 3 feet
100	N 78 W 8	183	5		
101	N 58 W 10.5	193.5	5		
102	S 78 W 5	198.5	5		
103	S 71 3/4 W 7	205.5	5		
104	S 85 1/2 W 22.5	228	5		
105	S 71 1/2 W 15	243	5		
106	S 86 1/2 W 6.3	249.3	5		
107	S 71 W 6	255.3	Level		Cross a hollow bridge 6 feet
108	S 51 1/2 W 9.2	264.5	5		
109	S 71 W 8.5	273	5 1/2		
110	S 85 W 7	280	5 1/2		
111	S 85 W 9	289	5 1/2		
112	S 83 1/2 W 6	295	5 1/2		
113	N 72 W 5	300	5 1/2		
114	N 51 W 8	308	5 1/2		10 Mile tree
115	N 36 W 10	18	5 1/2		
116	N 19 1/2 W 7	25	5 1/2		
117	N 27 1/2 E 6	31	5 1/2		
118	N 43 1/2 E 12	43	Near level		
119	N 56 1/2 E 16	59			
120	N 22 E 6	65	5 1/2		

Way of the Town of Belmont to Iroport in Harrison County Continued

No. of Station	Course of each Station	Distance of each Station	Total distance	Grade ascending	Grade descending
121	N 12° W	16	81	5°	
122	N 10½° E	4	85	5	
123	N 14° E	14	99	5	
124	N 7° W	22	121	3	
125	N 50° W	19	140	near Level	
126	North	18	158	Level	
127	N 19½° E	26	184	along the ridge	
128	N 5° W	46	230		
129	N 20° W	12	242	3½°	
130	N 30° W	31	303	Level	
131	N 20° W	154	<u>320</u> 137		11th Mile
132	N 6½° W	62	199		
133	N 16° E	24	223		1° } at 4 rods a cut of 1½ feet at 12 full of 1½ feet
134	N 12½° W	24	247		
135	N 11° W	18	265		at 12 rods cross the district line
136	S 81¼° W	43	308	Level	
137	N 27¼° W	52	<u>320</u> 110	Unknown	12th Mile W. a 22 S. 11° W 69 links
138	N 15½° E	62	102		
139	N 3½° W	16	118	5°	
140	N 13° W	20	138	4½	
141	S 5½° W	8	146	5	
142	S 17° E	16	162	5	
143	N 35° W	25	187	3½	
144	N 5½° E	62	249		
145	N 54¾° E	30	279	Unknown	
146	N 18¾° E	25	304	2°	13th Mile at 10 rods a fall of 2 feet 2 in at 20 rods cut of 2. 2
147	South	12	<u>320</u> 26		
148	N 11° E	16	12	5°	
149	N 11° W	15.1	87.1	Unknown	Garrett's Barn S. 76. W 33 links at 8 rods a fall of 4 feet at 11 a cut of 1 foot
150	N 33½° W	50	137.1		
151	N 1½° E	18	155.1		
152	N 21° W	30	215.1		
153	N 36½° W	38.6	254	5	
154	N 55¼° W	68	<u>320</u> 52		14th Mile at 11 rods fall 18 inches / 194 at 18 a cut of 18 "
155	N 32½° W	80	82	Unknown	
156	N 64½° W	36	118	3°	
157	N 55½° W	38	156		
158	N 80¾° W	14	170	11°	
159	S 64¾° W	7	177	5	
160	S 16½° W	15	192	5	
161	S 12° W	14	206		
162	S 68½° W	36	242	3	
163	S 88° W	28	270		

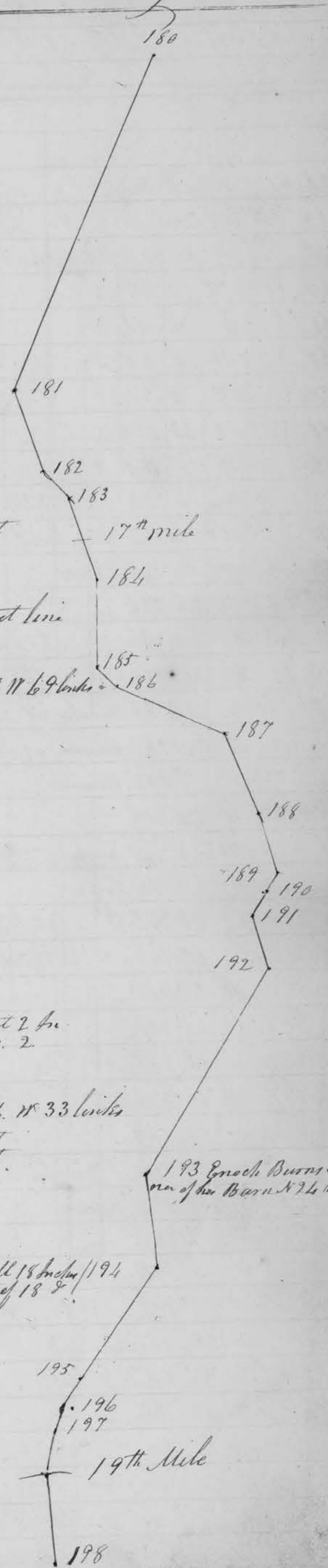

11th Mile

17th mile

12th Mile W. a 22 S. 11° W 69 links

13th Mile
at 10 rods a fall of 2 feet 2 in
at 20 rods cut of 2. 2

Garrett's Barn S. 76. W 33 links
at 8 rods a fall of 4 feet
at 11 a cut of 1 foot

193 Enoch Burns S. W. a 76 W 58 S
W. a 76 W 58 S

14th Mile
at 11 rods fall 18 inches / 194
at 18 a cut of 18 "

19th Mile

Record of a State Road from the Mouth of Captina Creek by the way

N ^o of Station	Course of each Station	Distance of each Station	Total Distance	Grade	Remarks
164	N 85 ^o W	10	310		
165	N 76 ^{3/4} W	20	320	5	Cut of 2 feet
166	N 66 ^o W	18	28	5	15 th Mile poplar S 29 ^{1/2} W 10 links for 10 rods then level
167	N 12 ^{1/2} W	10	38	5	
168	S 1 ^o E	6	44	5	
169	N 23 W	6	50	5	
170	S 13 ^{3/4} W	11	54	5	
171	N 61 W	35	57.5	5	
172	S 7 ^{1/2} W	18	75.5	2	
173	N 73 W	16	91.5		at 2 rods cut of 1 foot
174	N 41 ^o W	18.5	110		Near level
175	N 85 ^{3/4} W	55	198		Level
176	S 71 ^{3/4} W	28	226		
177	S 88 W	60	286		60 a fill of 21 inches
178	N 2 ^o W	24	310		16 th Mile W. O. N 56 ^{1/2} E 33 links at 9 rods cut of 21 inches
179	N 11 W	16	16	Unknown	at 20 rods a cut of 8 inches at 13 a fill of 8
180	N 28 W	200	216	Unknown	at 50 a fill of 15 at 56 a cut of 15
181	N 73 ^{3/4} W	16	292	Unknown	
182	S 87 ^{1/2} W	20	312		
183	N 70 W	16	320	Unknown	17 th Mile N 0-20 S 50 ^o W 50 links
184	N 50 W	18	88	Unknown	
185	S 89 W	16	104		at 6 rods fill of 2 feet
186	S 62 W	65	169	5	for 31 rods at 2 rods a fill of 2 feet
187	N 73 ^{1/2} W	18	217		
188	N 68 ^{1/2} W	31	251		
189	N 19 ^{1/2} W	18	262	5	
190	N 21 ^{1/2} W	16	278	5	
191	N 67 ^{1/2} W	31	309	3	
192	N 20 W	133	122	3 ^{1/2}	18 th Mile Turnpike N 75 E 81 links for 10 rods
193	N 58 W	52	174	Unknown	
194	N 20 W	92	266		
195	N 16 ^{1/2} W	16	282	5	
196	N 31 ^{1/4} W	21	306	1/2	
197	N 58 ^{1/2} W	50	36	Unknown	19 th Mile Cherry S N 1/2 E 182 links at 17 rods a cut of 2 feet 1 inch
198	N 26 ^o W	23	59	2 ^o	
199	N 15 ^{1/2} W	16	75	5	
200	N 19 ^{1/2} W	10	85	5	
201	N 71 W	21	104	Level	
202	S 86 ^{1/2} W	27	136	1/2	for 20 rods
203	N 57 ^{1/2} W	36	172	3/2	for 12 rods
204	S 74 W	26	198	1/2	for 24 rods

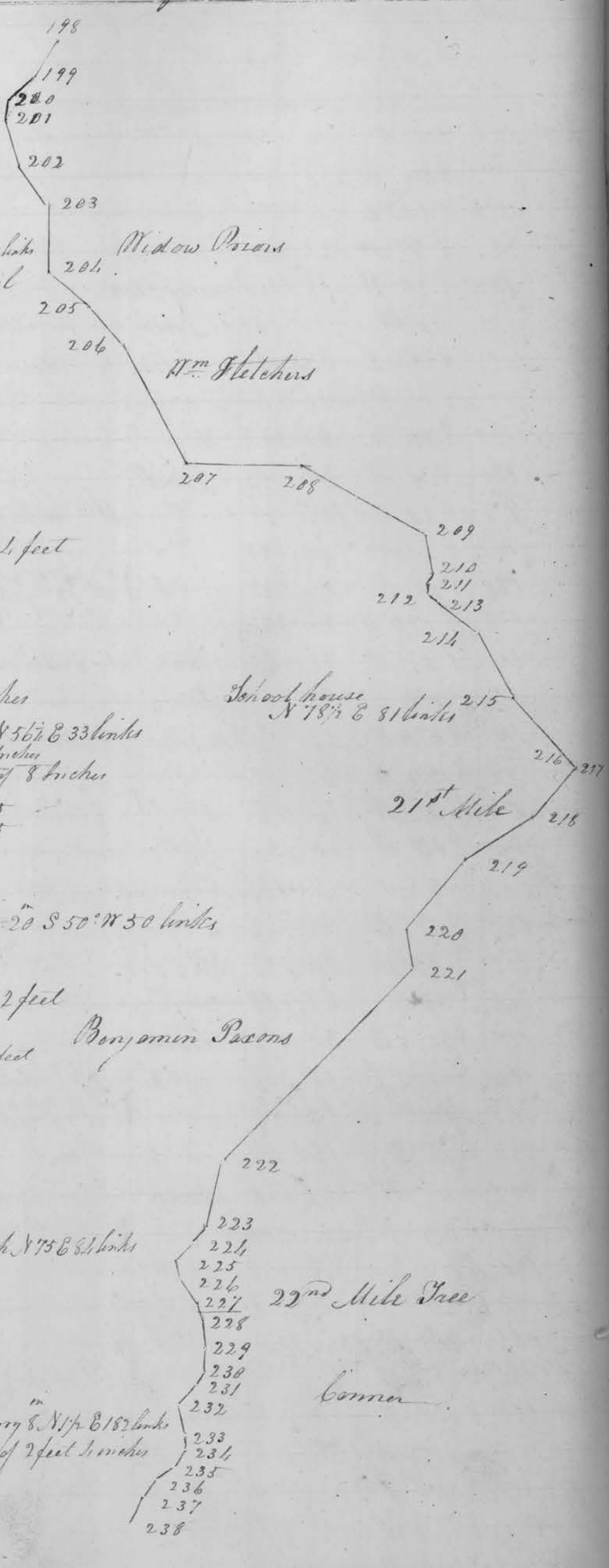

The Town of Belmont, To Freeport in Harrison County Continued

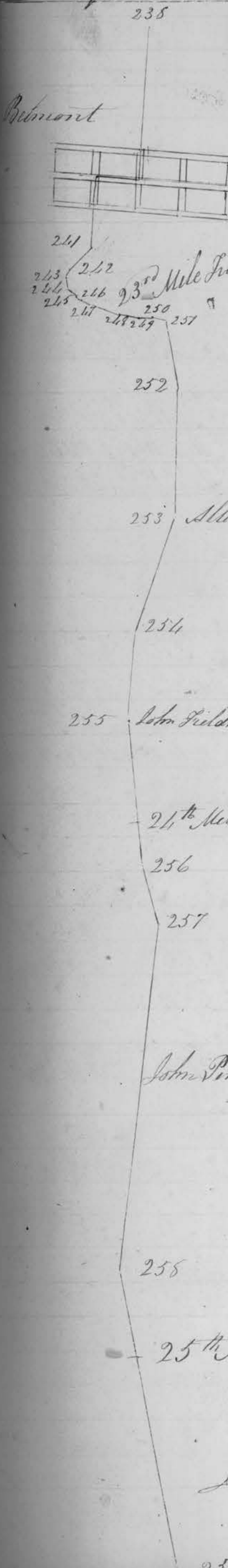

No. of Station	Course of each Station	Distance of each Station	Total Distance	Grade ascending	Grade descending
205	S 78 3/4 W	27	225	3°	
206	N 85 W	70	295		
207	S 31 W	60	320		
208	S 6 1/2 W	71	35		
209	N 67 W	19	109	Unknown	
210	N 51 1/2 W	6	128	5°	at 10 rods a fall of 5 feet 3 in at 26 a cut of 1 1/2 at 47 a cut of 1 1/2 at 63 a fall of 1 1/2 20 Miles N 0 1/2 W 63 1/2 W 65 in
211	N 56 W	6	134	5	
212	S 8 1/2 W	1	140	5	
213	S 69 1/2 W	29	144	5	
214	N 86 1/2 W	38	173	2	
215	S 79 W	17	211	Level	
216	N 6 1/2 W	2	258	hill side	
217	N 20 W	32	260	3	
218	North	19	292	320 14	
219	N 13 1/2 W	15	307	5°	for 20 rods then level
220	N 67 1/2 W	20	322	Level	at 60 rods a cut of 21 inches at 68 rods a fall of 21 at 82 a fall of 18 inches at 91 a cut of 18
221	N 14 W	140	362	5	
222	N 36 W	34	253	5	
223	N 13 1/4 W	10	263	1 1/2	
224	N 5 W	13	276	Level	
225	N 60 1/3 W	10	286	2	
226	N 83 W	16	302	5	
227	N 67 1/2 W	8	310	5	
228	N 56 3/4 W	16	316	5	
229	N 48 W	11	27	5	
230	N 21 1/2 W	8	35	5	
231	S 51 1/4 W	14	49	5	
232	N 59 1/4 W	18	67	5	
233	N 51 W	6	73	5	
234	N 14 W	10	83	5	
235	N 53 1/2 E	10	93	5	
236	N 12 1/2 W	11	104	5	
237	S 21 1/2 W	16	120	5	
238	N 13 W	87.4	207.4	Unknown	at 5 rods a fall of 8 feet at 16 rods a cut of 3 feet at 30 rods a fall of 5 feet 9 inches at 48 rods a cut of 5 feet 9 inches
239	N 73 E	23.3	230.7	Street of Belmont	cut of 1 foot at crop the
240	N 13 W	40	270.7	3 1/2	
241	N 27 1/2 E	18.3	289	2	
242	N 14 3/4 E	1	293	5	
243	S 30 3/4 W	6	299	5	
244	S 63 1/4 W	7	306	5	
245	N 76 W	1	310	5	
246	N 83 1/4 W	6	316	5	
247	N 88 1/2 W	16	320	5	
			72		
259					23rd Mile Free, N 0 1/2 W N 11 1/2 W 96 links

19 Record of State Road from the Mouth of Captina Creek by the

National Road	Station	Course of each Station	Dist. of each Station	Total Distance	Grade	Remarks
259	260	N 21 1/2° W	12	21	5	
261	262	S 69 3/4° W	7	31	5	
262	263	S 83 1/2° W	8	39	5	
264	265	N 28 1/2° W	38	77	Level	a cross the bottom
265	266	N 18 1/2° W	73	152	1°	
266	267	South	70	222	1	at 35 rod a bridge
267	268	N 16° W	50	272	5	at 10 rod a fall of 2 feet 2 in. at 20 cut of 2 1/2° Mile W. D. Humph. S. 58 10 1/2
268	269	N 25° W	82	320	5	at 50 rod cut of 6 feet at 68 rod fall of 6 feet
269	270	N 32 1/4° W	31	68	5	
270	271	N 13° W	200	268	Level 1.00°	at 31 rod cut of 3 feet
271	272	N 30° W	196	320	3	at 2 a fall of 3 feet
272	273	N 12° W	68	212	3	at 156 a cut of 2 1/2 feet
273	274	N 1° W	9	221	5	at 112 rod cross the National Road
274	275	N 20 3/4° E	12	233	5	
275	276	N 40 3/4° E	12	245	5	
276	277	N 53 3/4° E	12	257	5	
277	278	N 8° E	28	285	Uneven	at 70 rod fall of 4 feet at 78 cut of 4 feet
278	279	N 10° W	80	45	26	at 75 rod fall 9 inches
279	280	N 2° W	190	235	Uneven	at 80 rod cut of 9 feet at 180 rod cut of 7 feet 9 inches
280	281	N 12 1/2° W	93	320	8	at 189 rod fall of 2 feet 9 inches
281	282	N 35 1/2° W	115	133	Uneven	27 1/2 Mile W. D. 15 N 55 W 1.0 mile
282	283	N 11 1/2° W	113	266	Level 60 rod	at 156 a cut of 2 1/2 feet
283	284	N 82° W	10	276	5	
284	285	N 70° W	13.6	291.7	5	
285	286	N 59° W	28.3	320		
286	287	N 76° W	88	88	3°	28 1/2 Mile W. D. N 60 1/2° E to the hollow at the biggy 1 rod long
287	288	N 35 1/2° W	74	162	3	at 41 rods fall of 1 1/2 feet at 74 cut of 1 1/2 feet
288	289	N 5° W	22	184	4	
289	290	N 26° W	84.5	268.5	Uneven	at 38 rod fall of 1 foot at 50 cut of 1 foot at 56 cut of 1 1/2 feet at 70 fall of 1 foot
290	291	N 10° W	82	276.7	5	
291	292	N 17 1/2° E	27.3	304	5	at 22 rod fall of 11 feet
292	293	N 31° W	28	320	12	
293	294	N 7° W	111	53	3	29 1/2 Mile W. D. N 28 1/2° E 272
294	295	N 16° W	134	207		at 6 rods fall of 3 1/2 feet at 14 a cut of 3 1/2 feet at 80 rod a fall of 2 feet at 97 cut of 2 feet
295	296	N 36 1/2° W	87	294	Level	30 1/2 Mile W. D. S 72 1/2° E 1.02
296	297	N 17 1/2° W	80	320	Uneven	at 66 rod cut of 5 feet 1/2 in. at 76 a fall of 5 feet 1/2 in.
297	298	N 1.3° W	26	80	Near level	at 6 rod fall of 4 1/2 feet at 20 cut of 2 feet
298	299	N 53° W	78	138	Uneven	at 34 cut of 1 foot at 44 a fall of 1 foot
299	300	West	22	180	3	at 39 a fall of 18 inches at 1.7 a cut of 1 1/2 feet at 46 a fall of 5 feet 9 1/2 cut of 5 feet
300	301	N 38 1/2° W	99	279	Uneven	31 1/2 Mile Cum N 32 1/2° W 722
301	302	N 63° W	111	320		
302	303	N 76 1/2° W	18.7	18.7	5	at 3 rods 1 foot over grade

2 1/2 Mile W. D. 18 N 51 1/2° E 62 links

J. Holtz

James Haines

Thomas Gilham

28 Mile

275