

# ROAD PETITION.

For Establishing Road in Wheeling Tp.

To the Board of Commissioners of Belmont County, Ohio:

The undersigned petitioners, resident freeholders of said County, respectfully represent that the public convenience requires the establishment of a county road on the line hereinafter described, and pray that your body will institute and order the proper proceedings in the premises to view, lay out, establish and open such road, to-wit: Beginning at a point on the road leading from St. Clairsville to Harrisville near the residence of D W Coleman; thence in a southeasterly direction between the lands of John McGrew and John Huth to the section line between sections Nos 7 and 8; thence east along said section line between the lands of the said John McGrew and John Huth to the south-east corner of said section 8; thence south along the east line of section 7, about 600 feet, between the lands of John McGrew and Alonzo Fulton, and Samuel Coleman; thence in a south-easterly course through the lands of Samuel Coleman to the center of Section 1; thence in a direction north of east through the lands of John C Coleman and the Adena Railway Company to a point intersecting the public road on Cox's Run. All of said proposed road located in Wheeling township, Belmont County, Ohio.

C. J. 7 = P. 307

Dated this Tenth day of April A. D. 1892

PETITIONERS' NAMES.	PETITIONERS' NAMES.	PETITIONERS' NAMES.	PETITIONERS' NAMES.
John McGrew	Jas H Coleman	C L Ewan	Albert Beyer
Samuel Coleman	John Huth	William Koney	Fred Beyer
John C Coleman	A A Coleman	Allen Nelson	J P Mintier
My C Coleman	A C Moore	Jas S Mowery	G A Lyle
A S Fulton	Geo W Coleman	G E Calhoun	Alex Hampton
Eliza Garrett	T J Henderson	W H Gunnison	J O Stevens
David W Coleman	Evan Jenkins	W L Wilton	John Mintier

and 42 others

**Know all Men by these Presents:**

That we, John McGrew, Jas Smith and John C Moore  
are held and firmly bound unto the State of Ohio, for the use of Belmont County, in the penal sum of One  
Hundred Dollars, for the true and faithful payment of which well and truly to be made,  
we bind ourselves, jointly and severally, our heirs, executors and administrators, by these presents,

Sealed with our seals and dated at St. Clairsville this 7th day of July 1892.

The Conditions of the above obligations are such That whereas application has been made to the Board of Commis-  
sioners of said Belmont County for the establishment of a county road on the following line, to-wit:

*See page 113 for description*

Now if the said applicants shall pay into the Treasury of the said County the amount of all costs and ex-  
penses accruing thereon, in case the prayer of said petitioners shall not be granted, or when the proceedings had in  
pursuance thereof shall not be finally confirmed and established, then this obligation to be void; otherwise to be in  
full force in law.

ATTEST:

John C Coleman }

John McGrew SEAL.  
James Smith SEAL.  
John C Moore SEAL.

St. Clairsville, O., July 7th 1892.

The Commissioners met in special session at their office, and the Board being satisfied that the fore-  
going petition was signed by at least twelve freeholders of the County, residing in the vicinity of the establishment  
of said county road, and that the proper notices had been given according to law, bond filed, approved and accepted,  
thereupon the Board appointed Wm Gillespie, Clark Nichol and Edward Simpson  
three disinterested freeholders of the County, viewers, and John A Pond surveyor  
of said proposed road, to meet at the residence of W. Coleman on the 23rd day of July 1892, at 10 o'clock A.M.  
for the purpose of discharging their official duties relative to the object prayed for in the foregoing petition. And  
the Auditor is authorized to notify all non-resident land owners by publication, as required by law.

ATTEST:

W. Aldredge }

County Auditor.

Beatty Co. J. 7- P 309.

Geo M Wise  
J H Wilkerson  
J B Smith }

Commissioners.



# Report of Viewers.

To the Board of Commissioners of Belmont County, Ohio:

In obedience to your order, issued at your July session, A. D. 1892, we the undersigned, Viewers appointed under said order, met with John A Pond Surveyor, at Choleman's residence on 23rd of July and were severally sworn to discharge, faithfully and impartially, the duties required of us in said order.

If any Viewer is unable to attend here state by whom the vacancy was filled.

David Coleman, Alonzo Tult, and James Coleman were selected by us as chain carriers, and John Sells as a marker, who were also duly sworn.

We then proceeded to view said proposed county road on the line described in your order, and caused the same to be surveyed, "as prayed for in the petition, or as near the same as in our opinion a good road can be made at a reasonable expense, taking into consideration the utility, convenience, and inconvenience and expense which will result to individuals as well as the public," by the establishment of said road as follows:

See page 113 for description.

See page 119 for plat.

We would respectfully report that the said road ought to be opened and established for the following reasons:

First, a short route to Plaineville, second, better grade than old road, third, a great benefit to the public.

We have also determined that the public convenience requires that such county road shall be established 33 feet in width.

All of which is respectfully submitted,  
August 4th 1892

William Gillespie  
Clark Nichol  
E M Simpson Viewers.

### FEES.

<u>Wm Gillespie</u> Pd 8-4-02 Viewer, 3 days, \$4.50	<u>David Coleman</u> Chainman, 2 days, \$2.00
<u>Clark Nichol</u> Pd 8-4-02 " 3 days, \$4.50	<u>Alonzo Tulton</u> " 1 " 1.00
<u>Edward Simpson</u> Pd 8-4-02 " 3 days, \$4.50	<u>James Coleman</u> " 1 days, \$1.00
	<u>Allen Pond</u> Rodman 1 " 1.00
	<u>John Sells</u> Marker, 2 days, \$2.00
<u>John A Pond</u> Surveyor, 3 days, \$15.00	
	<u>plat</u> 2.50 Pd 9-1-02.

Pease & Co

~~Miss Geo H not Coal~~

		3820	Coal	2030
	48 a	1210	Coal	480
	68 1/2	2220	"	680
Mrs A A	36 a	990	"	110
Dr	39 a	2490	"	280
Mrs J A	5 1/2 a	110	"	50
Dr	50 1/2	1230	"	500
Mrs J E	12	780	"	120
Dr	32 1/2	850	"	320
Galloway	JC 34 a	1880	"	540
Mrs Geo K	127 1/4	4870	"	1270
Mellister K	50	1360	"	500
Mrs Philip	76 1/2	2600	"	760
Dr	2 1/5	80	"	20
Sarbet E E	8 1/2	190	"	80
Dr	97	3590	"	970
To Corie	Baker M V E	1 -	140	"
the value	Donley Jns	12 1/2	20	"
to Selas	Giffin Sarah	4 a	840	400
for #10	Caplunger N.	32 a	1660	"
Nichol	Berry Joanna	60 -	60	"
Matthew	Johnson Jas	297 1/4	8360	"
James M.	Dr	81	2180	"
Smiley Nelson for	Dr	8 1/4	1070	"
Mrs Asher for	Dr	113	2990	"
	Dr	21	340	"

To be paid on account of land  
 at the office of the Surveyor  
 at the office of the Surveyor  
 at the office of the Surveyor  
 at the office of the Surveyor

Andrew J. Caplinger }  
 Joanna Caplinger }  
 Joanna Berry }  
 James Johnson }  
 (George Krause }  
 signed after paying tax

W. Wooster O.

Dear Auditor

There was some understand-  
ing or agreement between those persons  
who sold their coal on High ridge in  
Pailtrey Township Belmont Co,  
that the Purchasers should be assess-  
ed \$10<sup>00</sup> per acre on their lands  
and that the assessment to those  
owning the surface should have their  
assessment reduced \$10<sup>00</sup> per acre.  
I have been informed that such agreement  
was entered into and that the parties  
respectively signed said agreement.

I do not understand the modus operandi  
of such business.

Now if this is the manner of adjusting  
such business, it has been suggested that  
we authorize you to place our names  
to the agreement, if such thing would  
be judged proper.

We sold the Coal on land as will  
appear in deed on record, and if  
at all proper We authorize you  
to place our names to said agreement.

J. G. Ashenbrent  
Near the Ashenbrent

Season 70

~~Miss Geo H not Coal~~

Name	Measure	Value	Coal	Value
	303a-	5820	Coal	2030
	48a-	1210-	Coal	480
	68 <sup>3</sup> / <sub>16</sub>	2220	"	680
Miss A A	36 a	990	"	110
Dr	59 a	2490	"	280
Miss J A	5 <sup>1</sup> / <sub>2</sub> a	1100	"	500
Dr	50 <sup>1</sup> / <sub>2</sub>	1230	"	500
Miss J E	12	780	"	120
Dr	32 <sup>1</sup> / <sub>5</sub>	850	"	320
		1880	"	540
Galloway	1034 a		"	1270
Miss Geo K	127 <sup>1</sup> / <sub>4</sub>	4870	"	500
		1360	"	
McAlister K	50		"	760
Miss Philip	76 <sup>1</sup> / <sub>2</sub>	2600	"	20
Dr	2 <sup>4</sup> / <sub>5</sub>	80	"	80
		190	"	
Sarbet E E	8 <sup>1</sup> / <sub>2</sub>		"	970
Dr	97 <sup>1</sup> / <sub>4</sub>	3590	"	10
		140	"	
Baker M V G	1-		"	120
		200	"	
Donley Jns	12 <sup>1</sup> / <sub>2</sub>	60	"	40
Giffin Sarah	4 a		"	400
		840	"	
Caplinger N.	32 a		"	100
		1660	"	
Berry Joanna	60-	60	"	
Dr	4 <sup>1</sup> / <sub>6</sub>		"	2970
Johnson Jas	297 <sup>1</sup> / <sub>4</sub>	8360	"	810
Dr	81	2180	"	80
Dr	8 <sup>1</sup> / <sub>4</sub>	1070	"	1130
Dr	113	2990	"	210
Dr	21	340	"	



St. Clairsville, O. Sept-1<sup>st</sup> 1892

To County Auditor:

We agree that the value <sup>for taxation</sup> of our coal lands sold to Selah Chamberlain, Trustee, shall be \$10 per acre

- A. G. Kilgore ✓
- Nicholas Schafer ✓
- Matthew Schafer ✓
- James M. Moore ✓
- Smiley Nelson for M. S. Nelson's heirs ✓
- Marcus Ackers by letter ✓
- Robt Alexander ✓
- ~~Wm~~ Nichol ✓
- John A. Wise ✓
- Alva A. Wise ✓
- J. E. Wise ✓
- J. S. Galloway ✓
- George S. Wise ✓
- Wm. Krummel - not transferred
- Hezia M<sup>c</sup>Allister ✓
- Philip Wise ✓

- Elmer E. Lobet ✓
- Martin Baker ✓
- Lewis Donley ✓
- Sarah Gifford ✓
- Andrew J. Caplinger ✓
- Mary Ann Caplinger ✓
- Yoanna Perry ✓
- James Johnson ✓
- (George Krause)
- (signed as an accompanying tax)



# Separate Report of Viewers.

To the Board of Commissioners of Belmont County, Ohio:

The undersigned, Viewers of the County road petitioned for by John Mc Grew and others, make the following separate report of the compensation and damages assessed and awarded by them to persons entitled thereto. The parties named below have filed their written applications for the said allowances, according to law, and the same are hereto appended and returned with this report.

Compensation for land taken for said road has been awarded in the following sums:

To	<u>John Coleman</u>	<u>Fifty</u>	Dollars;
To			Dollars;
To			Dollars;
To			Dollars;
To			Dollars;
To			Dollars;
To			Dollars;
To			Dollars;

Each of the above sums has been assessed without deduction for benefits to any property of the owner, which would accrue by the opening of said road.

The following sums are allowed as damages to be paid to claimants whose premises will be rendered less valuable by the opening and construction of said road through the same:

To	<u>John Huth</u>	<u>Twenty</u>	Dollars;
To	<u>Samuel Coleman</u>	<u>Two Hundred</u>	Dollars;
To			Dollars;
To			Dollars;
To			Dollars;
To			Dollars;
To			Dollars;
To			Dollars;

William Gillespie  
Clark Nichol  
E M Simpson } Viewers and Jurors to award damages.

August 4th 1892.

St. Clairsville, O., Sept 1st 1892.

The Commissioners met in regular session, and the report of the Surveyor and Viewers appointed to survey and view the road, as described in the above petition, was read the first time.

ATTEST: Waldrege } b. J. 7 = P. 324 } G M Wise  
 County Auditor. } J W Wilkinson } Commissioners.  
Beatty } T P Smith }

St. Clairsville, O., Sept 2nd 1892.

The Commissioners met in regular session, and the report of the Surveyor and Viewers appointed to survey and view the road, as described in the above petition, was read the second time.

ATTEST: Waldrege } b. J. 7 = P. 326 } G M Wise  
 County Auditor. } J W Wilkinson } Commissioners.  
Beatty } T P Smith }

St. Clairsville, O., Sept. 3rd 1892

The Commissioners met in regular session, and the report of the viewers in favor of the establishment of said road was this day publicly read for the third time, whereupon the Board deferred final action pending further investigation.

Attest: G M Wise }  
M Aldredge C.J. 7- P. 337 J W Wilkinson } Commissioners  
County Auditor. J P Smith }  
Beatty

St. Clairsville, Ohio, October 6th 1902.

The Board of County Commissioners having deferred final action on the foregoing road matter at their session held Sept. 3rd 1902, and after due and careful investigation, the report of the viewers in favor of the establishment of said road having been publicly read for the third time and said viewers having filed a separate report in writing of the amount of Compensation and damages which they have allowed to landowners by reason of the location of said road through their several premises which report was publicly read and damages agreed upon as follows:

John Huth	Damages	\$ 20.00	Pd-4-27-03
Samuel Coleman	Damages	200.00	Pd-4-27-03
J C Coleman	Damages	135.00	Pd-4-27-03
Andrew Knight	Damages	8.00	Pd-4-27-03

It appearing to the Board that said awards are reasonable and just that said road will be of public utility, and of sufficient importance to the public to justify the payment of said damages out of the public treasury and no petition having been filed for review it is ordered that the county auditor draw his warrant upon the county treasurer for the amount of damages so awarded to each respectively and that said road be established a public highway thirty three feet in width.

Attest: J W Wilkinson }  
M Aldredge C.J. 7- P. 349 J P Smith } Commissioners  
County Auditor. Robt McMillan }  
Beatty



## Surveyor's Report.

**To the Board of Commissioners of Belmont County, Ohio:**

The undersigned, in obedience to your order, dated July 7th 1892, proceeded on the 23rd day of July to survey and mark the county road described in said order, under the direction of the Viewers therein named, and respectfully submits the following return of said survey:

*See general description page 113.*

*See plat and record page 119.*

I Certify, That the above is a correct plat and return of the survey of the county road named above.....

John A Pond Surveyor of said road.



Plat of County Road.  
John M<sup>c</sup>G new

Below find change by agreement with Commissioners<sup>to</sup> John Hutn in order to make the lines from Stations 2, 3<sup>rd</sup> & 4 in lower Plat straight from Stations 2 to 3 as shown in upper Plat so that the field East of said line can be laid out in town lots from a straight front.

Sta	Deg	Min	Poles	Scale
1	S 38	10 E	6.40	.213
2	S 10	18 E	15.84	.528
3	S 25	20 E	2.64	.085
4	S 66	35 E	3.78	.126
5	S 86	25 E	13.66	.455
6	S 21	10 E	4.64	.155
7	S 3	15 W	34.92	1.164
8	S 29	35 E	6.14	.205
9	S 48	57 E	21.38	.701
10	S 37	02 E	22.80	.760
11	S 25	10 E	11.73	.391
12	S 00	32 W	2.38	.079
13	S 28	32 W	5.32	.177
14	S 12	00 E	14.32	.477
15	S 58	25 E	3.92	.130
16	S 73	04 E	22.64	.756
17	S 57	44 E	24.92	.830
18	S 64	54 E	9.96	.332
19	N 86	08 E	5.16	.172
20	S 44	30 E	12.12	.404
21	S 45	08 E	9.16	.305
22	S 54	38 E	9.33	.311
23	S 60	43 E	14.60	.487
24	S 59	13 E	15.88	.529
25	S 75	53 E	4.28	.143
26	N 89	53 E	11.12	.391
27	N 82	53 E	22.74	.758
28	S 84	40 E	13.14	.438
29	N 66	25 E	5.62	.187
30	N 54	35 E	10.42	.347
2 <sup>nd</sup> Route				
28	S 77	00 E	18.84	.628
29	S 19	49 E	5.50	.183
30	S 85	22 E	21.60	.720

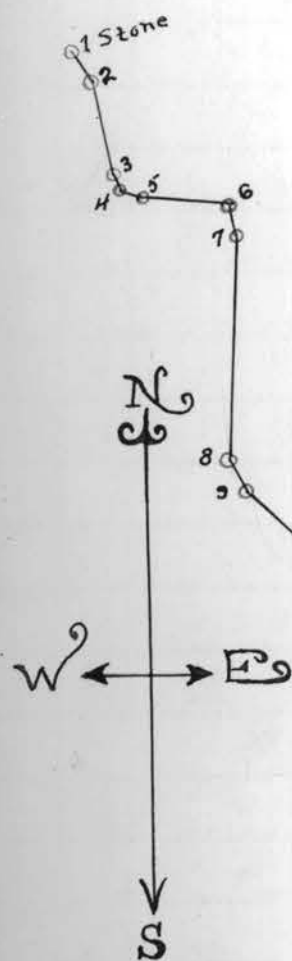
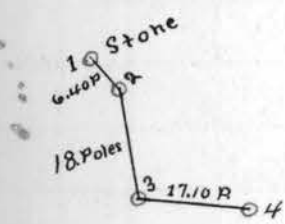

Length of 1<sup>st</sup> Route = 360.88 P = 1.127 miles  
 Length of 2<sup>nd</sup> Route = 377.62 P = 1.18 miles  
 Width of Road = 2 Poles = 33'

Grade from STA. 29 to 28 = 7° 19'  
 Grade from STA. 28 to 27 = 5° 11'  
 Grade from STA. 27 to 26 = 9° 26'  
 Grade from STA. 12 to 11 = 6° 22'

From STA 28 to 31X rejected and from STA. 28 to STA. 31 Accepted.

