

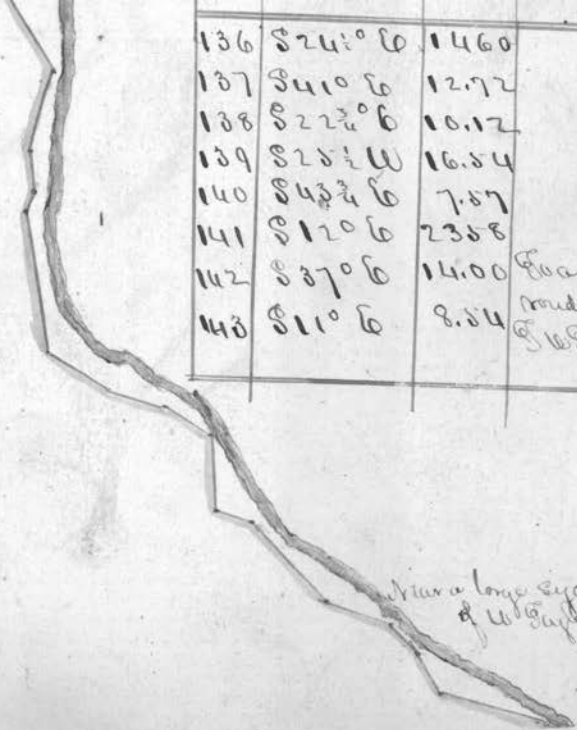

85	S 73° W	22.18	To a stake in the center of the ridge grade
86	N 78 1/2° W	48.48	
87	S 60° W	10.72	* With road to estate line
88	S 42° W	15.70	estate line
89	S 48 1/2° E	15.75	near Gladders Run
90	S 80° W	6.06	
91	S 40° W	6.06	
92	S 15° W	6.06	
93	S 50° W	18.18	
94	S 3 1/2° W	6.06	
95	S 30° W	12.12	
96	S 43 1/2° W	12.12	
97	S 30° W	16.78	
98	S 17° W	16.00	
99	S 20° W	13.24	
100	S 69 1/2° W	12.24	
101	S 70° W	19.33	
102	S 40° W	21.63	To a hole in the left bank of well
103	S 32° W	11.03	near hollow near the corner of Taylor's
104	S 41° W	5.51	Gladders farm
105	S 74° W	5.03	
106	S 54° W	10.60	
107	S 49 1/2° W	20.00	
108	S 1 1/2° W	10.54	
109	S 38° W	7.57	
110	S 80 1/2° W	7.59	
111	S 54 1/2° W	6.48	
112	S 63° W	16.30	
113	S 78° W	19.58	
114	S 56 1/2° W	11.18	
115	S 56 1/2° W	18.78	
116	S 32° W	9.39	
117	S 14 1/2° W	19.33	
118	S 25 1/2° W	13.57	
119	S 6 1/2° W	16.60	
120	S 3 1/2° W	23.21	
121	S 25 3/4° W	10.18	
122	S 26 1/4° W	8.12	
123	S 4 1/2° W	9.20	
124	S 37° W	15.20	
125	S 1° W	8.36	James Rhodes
126	S 12 1/2° E	6.36	
127	S 37° E	2.20	
128	S 11° E	18.84	
129	S 51 1/2° W	9.45	
130	S 44 1/2° W	18.42	
131	S 2 1/2° W	18.18	
132	S 48° W	17.27	
133	S 30° W	8.36	
134	S 59° W	3.87	
135	S 21° W	30.72	



136	S 24 <sup>o</sup> W	14.60	
137	S 41 <sup>o</sup> W	12.72	
138	S 22 <sup>o</sup> W	10.12	
139	S 25 <sup>o</sup> W	16.54	
140	S 43 <sup>o</sup> W	7.57	
141	S 12 <sup>o</sup> W	23.58	
142	S 37 <sup>o</sup> W	14.00	Two sycamores two rods South of
143	S 11 <sup>o</sup> W	8.54	W Taylor's line

Near a large sycamore two rods  
of W Taylor's south line

Continued

144	S 85° W	9.93
145	S 40° E	23.75
146	S 13½° W	13.57
147	S 44° E	10.66
148	S 59½° E	16.72
149	S 43½° E	10.78
150	S 23½° E	11.75
151	S 9½° E	30.54
152	S 48½° E	17.03
153	S 55° E	11.51
154	S 74° E	18.18
155	S 2° E	12.78
156	S 35° E	37.27
157	S 61½° E	21.45
158	S 44½° E	35.28
159	S 7½° E	14.78
160	S 58° E	7.27

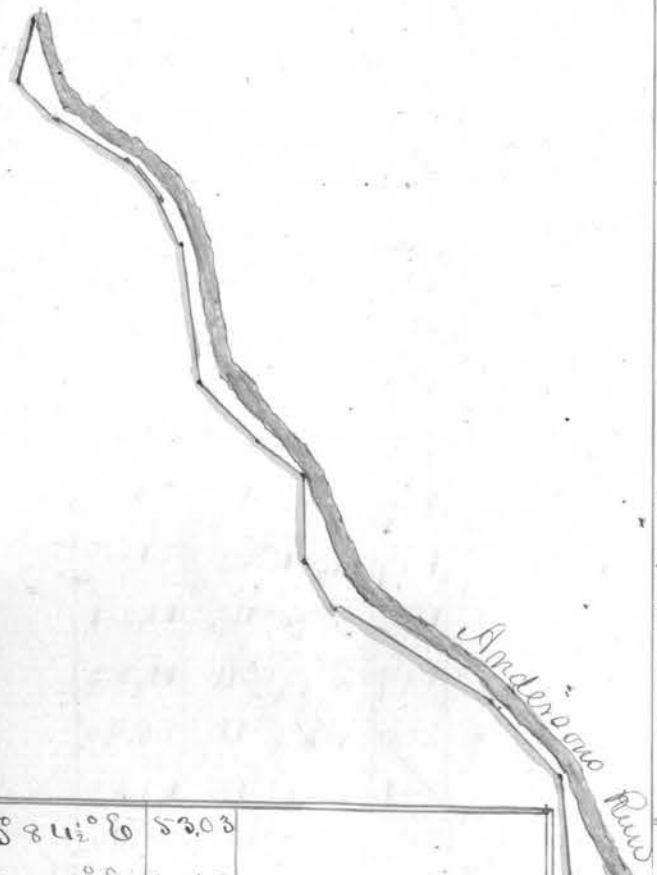

161	S 84½° E	53.03	
162	S 28½° E	15.63	
163	S 36½° E	31.20	
164	S 13½° E	27.09	
165	S 14½° E	16.36	
166	S 19½° W	7.40	
167	S 42° W	23.09	
168	S 89° E	13.03	
169	S 68° E	10.60	
170	S 87½° E	7.87	
171	S 31½° E	30.60	
172	S ½° W	28.42	
173	S 59° W	17.93	Bank of Captina
174	S 66½° W	14.25	at the mouth of
175	S 63½° W	7.40	Andersons run
176	S 62° W	8.06	9 miles from head
177	S 53° W	8.70	
178	S 43° W	8.54	
179	S 30° W	11.80	
180	S 2° E	15.03	
181	S 9½° E	17.57	
182	S 9½° E	11.35	
183	S 9° E	9.40	
184	S 14° E	7.27	
185	S 9½° W	3.67	
186	South	21.20	Sycamors Milling
187	S 9½° W	28.75	near creek crossing
188	S 5½° W	5.45	Saw mill at
189	S 12° E	18.06	Armstrongs
190	S 23° W	27.30	Bridge at
191	S 89½° W	29.45	Armstrongs

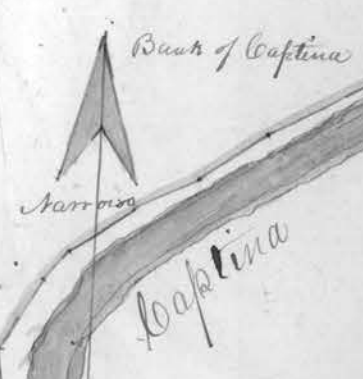

Saw mill at Armstrongs

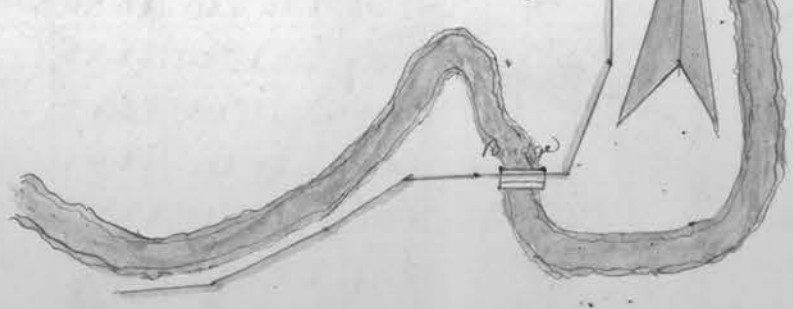



192	S 57° W	19.33	
193	S 63° W	26.70	Stations above
194	S 82° W	21.56	Demarcation
195	S 74° W	133.70	
196	S 86° W	6.66	
197	S 84° W	21.50	
198	S 75° W	15.21	
199	S 79½° W	11.33	
200	S 59° W	25.90	
201	S 71¼° W	17.50	
202	S 66° W	30.30	
203	S 68° W	14.54	
204	S 42½° W	30.00	
205	S 56½° W	28.25	
206	S 58½° W	13.93	
207	S 61° W	7.88	
208	S 43¾° W	13.33	
209	S 42° W	16.96	
210	S 16¾° W	17.33	
211	S 21½° E	16.54	
212	S 34½° E	25.75	
213	S 11¾° W	20.12	
214	S 78¾° W	20.36	
215	S 78° W	9.15	
216	S 82½° W	20.66	
217	S 56° W	30.66	
218	S 80° W	20.54	Mouth of West Apple
219	S 74½° W	19.87	
220	S 79° W	22.30	
221	S 65½° W	14.55	
222	S 53¾° W	18.30	
223	S 49° W	29.03	
224	S 12½° W	12.10	
225	S 68° W	11.63	
226	S 63¾° W	8.54	
227	S 84¼° W	8.70	
228	West	27.28	
229	S 56¼° W	40.96	
230	S 69° W	26.36	



Crab-Apple

228	Wrest	27.28
229	S 56 $\frac{1}{2}$ ° W	40.96
230	S 69° W	26.36
231	S 87° W	11.03
232	S 22 $\frac{1}{2}$ ° W	8.87
233	S 71° W	15.20
234	S 54 $\frac{1}{2}$ ° W	28.24
235	S 86 $\frac{3}{4}$ ° W	12.42
236	S 82 $\frac{1}{2}$ ° W	10.84
237	S 21 $\frac{1}{2}$ ° W	31.93
238	S 5 $\frac{1}{2}$ ° W	26.18
239	S 38° W	31.57
240	S 16 $\frac{3}{4}$ ° W	18.54
241	S 87° W	31.55
242	S 35 $\frac{3}{4}$ ° W	21.33
243	S 18 $\frac{3}{4}$ ° W	18.06
244	S 8 $\frac{1}{4}$ ° W	22.60
245	S 6 $\frac{3}{4}$ ° W	13.63
246	S 47 $\frac{1}{2}$ ° W	9.09
247	S 30° W	17.57
248	S 4° W	23.63
249	S 33 $\frac{1}{2}$ ° W	25.86
250	S 48° W	9.88
251	S 38 $\frac{1}{2}$ ° W	16.12

Pattersons Saw mill

Continued

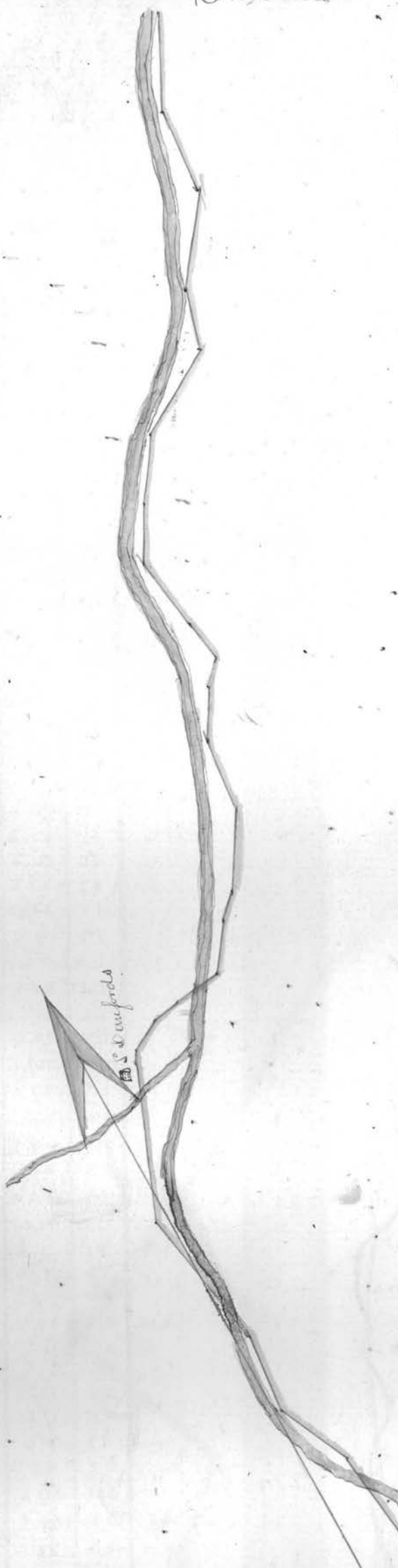

252	S 84° W	15.50
253	S 81½° W	10.72
254	S 64° W	10.89
255	S 35¾° W	4.84
256	S 22¾° W	48.96
257	S 9¾° E	45.09
258	S 4½° W	24.72
259	S 25½° E	24.60
260	S 4½° E	29.87
261	S 24½° W	30.25
262	S 31½° W	18.18
263	S 24½° W	55.28
264	S 2° W	12.42
265	S 32½° W	41.80
266	S 63¾° W	21.93
267	N 25° W	17.45
268	N 52½° W	18.87
269	S 72° W	12.30
270	S 80° W	16.60
271	S 64° W	18.84
272	S 44° W	24.54
273	S 66° W	25.57
274	S 36° W	22.48
275	S 20° W	21.60
276	S 84° W	10.90
277	S 83° W	6.06
278	S 81½° W	6.90
279	S 38¾° W	6.00
280	S 15¾° W	18.54
281	S 56° W	10.18
282	S 75° W	18.69
283	S 61° W	34.18
284	S 89° W	15.21
285	S 72° W	36.36
286	S 41° W	34.06
287	S 52½° W	33.87

to a stake in the road 2 rods SW of the one a white Oak tree N 57° E 30 ft another white Oak N 24° W 20 ft and a maple tree S 38½° E 12 ft  
 Whole length of Road 16 miles 2 furlongs and 38.24 rods  
 James R. McMillen Secy



Plat of a Road commencing at the forks of Flat Run and terminating at Jacob Malins on the Bridgeport and Hamoville Plank Road. Recorded Dec 11. 1855

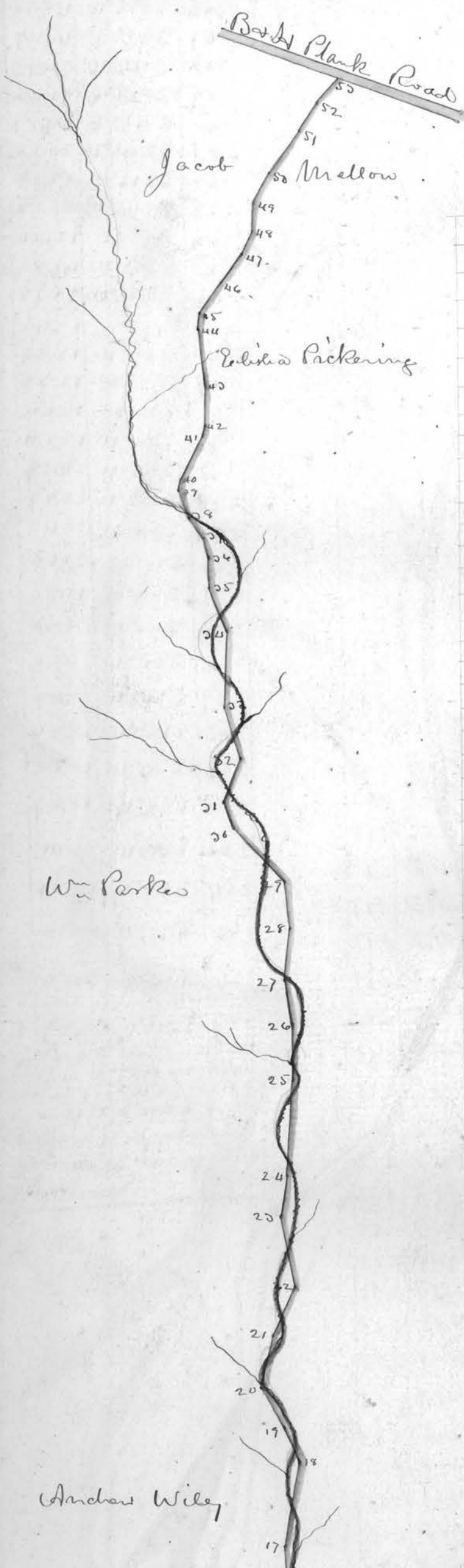

Field notes of the Road

	Sta	B	S	road
1	1	W 11/2 E	21.00	Post
2	2	46 E	20.50	do
3	3	8 E	21.50	do
4	4	20 1/2 E	20.00	do
	5	18 W	26.00	do
	6	12 W	5.00	do
	7	11 E	12.00	do
	8	2 E	9.00	do
	9	11 E	10.50	do
	10	22 1/2 E	10.50	do
	11	25 1/2 E	15.00	do
	12	20 1/2 E	18.00	do
	13	4 E	7.00	do
	14	25 E	20.00	do
	15	22 1/2 E	20.50	Beach & p
	16	26 E	26	Walnut
	17	22 E	12.00	Post
	18	22 1/2 E	18.00	do
	19	4 E	8	Walnut
	20	5 W	10.00	Post
	21	28 E	11.00	do
	22	50 1/2 E	11.00	do
	23	12 E	16.00	do
	24	24 1/2 E	7	Linn
	25	29 E	20	Sugar
	26	27 1/2 E	12.00	Post
	27	14 1/2 E	10.00	do
	28	22 E	11.00	Beach
	29	20 E	10.00	do
	30	16 W	16	Oak
	31	9 E	6.00	Post
	32	47 E	10.00	do
	33	9 1/2 E	11.00	Sugar
	34	29 E	16.50	Walnut
	35	4 E	10.00	Elm
	36	27 E	6.00	Post
	37	15 E	4.00	Beach
	38	7 W	6.00	Post
	39	9 E	6.00	do
	40	29 E	2.50	do
	41	57 E	10.00	do
	42	48 E	2.00	do
	43	20 E	8.00	do
	44	22 E	12.00	do
	45	22 E	2.50	do
	46	66 E	8.00	do
	47	71 E	7.50	do
	48	56 E	5.00	do
	49	22 1/2 E	6.00	do
	50	40 E	10.00	do
	51	50 1/2 E	11.00	do
	52	48 E	7.00	do
	53	52 E	7.00	do



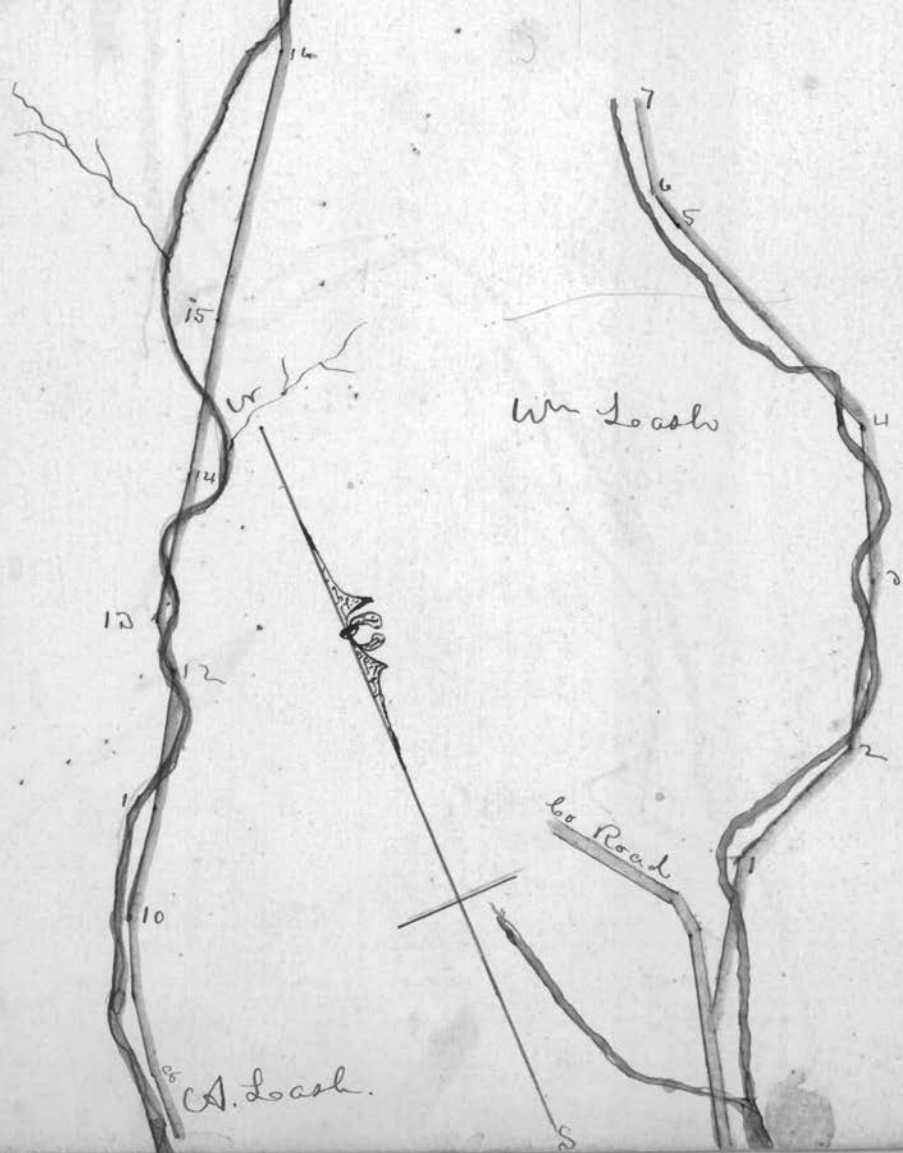

Wm Loash

to Road

A. Loash.

Plat of a road beginning on the road from Mt Pleasant to Martinsville through the lands of J P Mitchell & John Sheaker  
 Surveyed by Thos Mitchell Jay 10<sup>th</sup> 1856

11

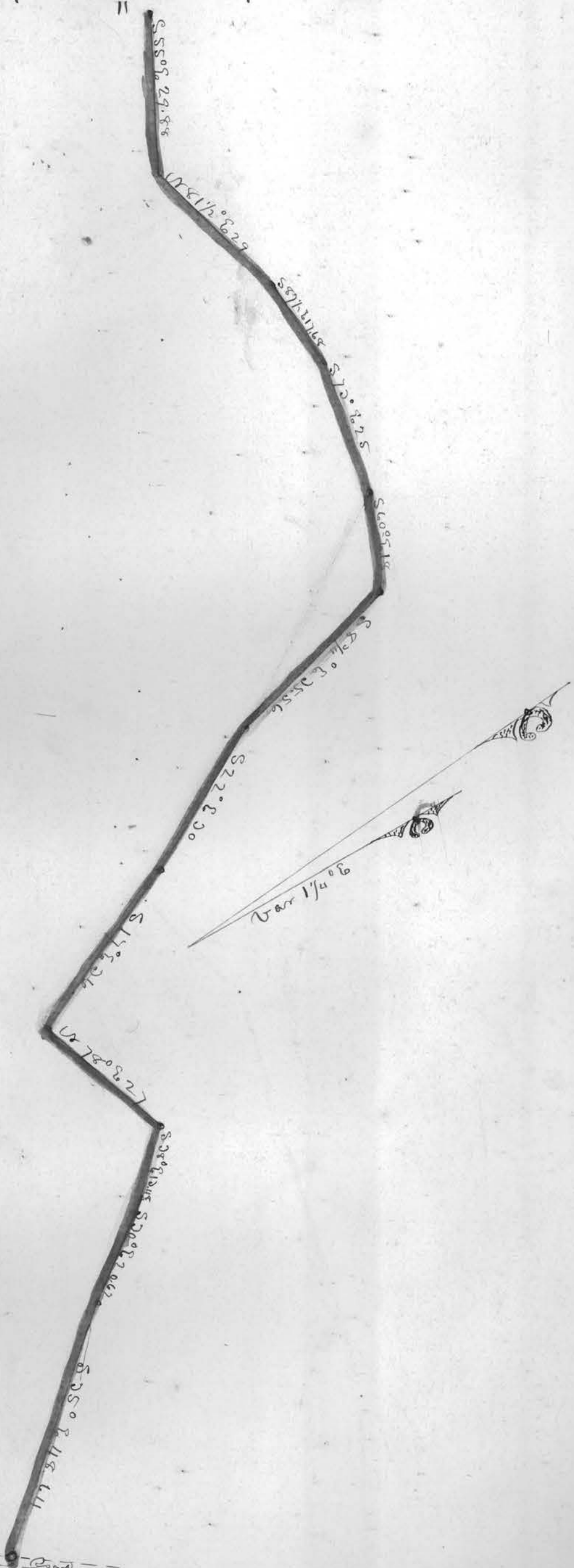

S 1/2' E 115' 111' 111' Point  
 Beach 18 in S 15 1/2° W 45 links

Beginning in the road from Mt Pleasant to Martinsville at or near the NW corner of lands of J P Mitchell from which an apple tree in John Sheakers orchard bears N 67 1/2° W 59 links thence according to diagram January 10<sup>th</sup> 1856

Thomas Mitchell

Surveyor Bel. Co. Va.

Plat of the alteration of the Road leading from St. Clairsville to Cadiz through the lands of Mr. Anderson, Mc.arty, Gossett to Ramapo Saw Mill & Surged Dec 1855 by B. De Haas

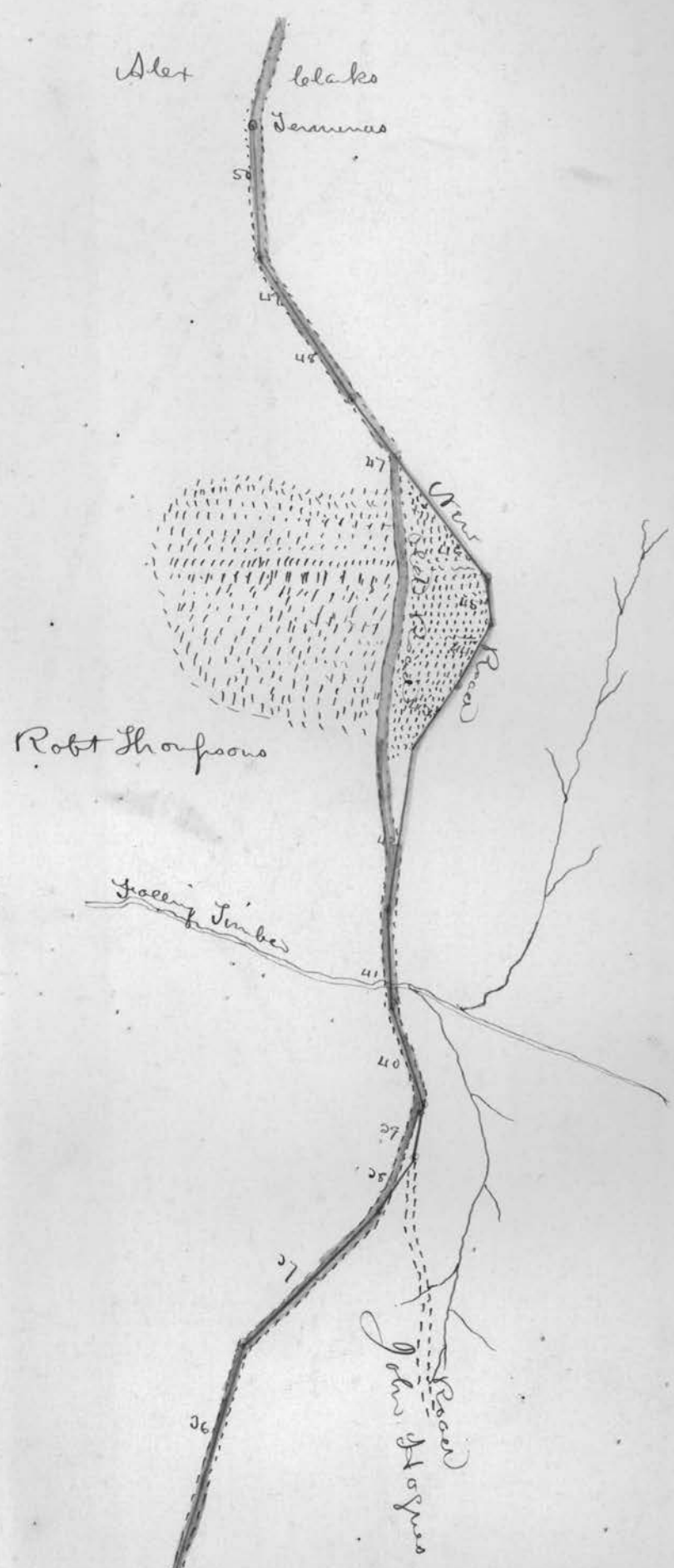

Stuy Mc Cartney  
Dwelling

-----  
Road

St Mc Cartney



35

34

33

32

31

29

29



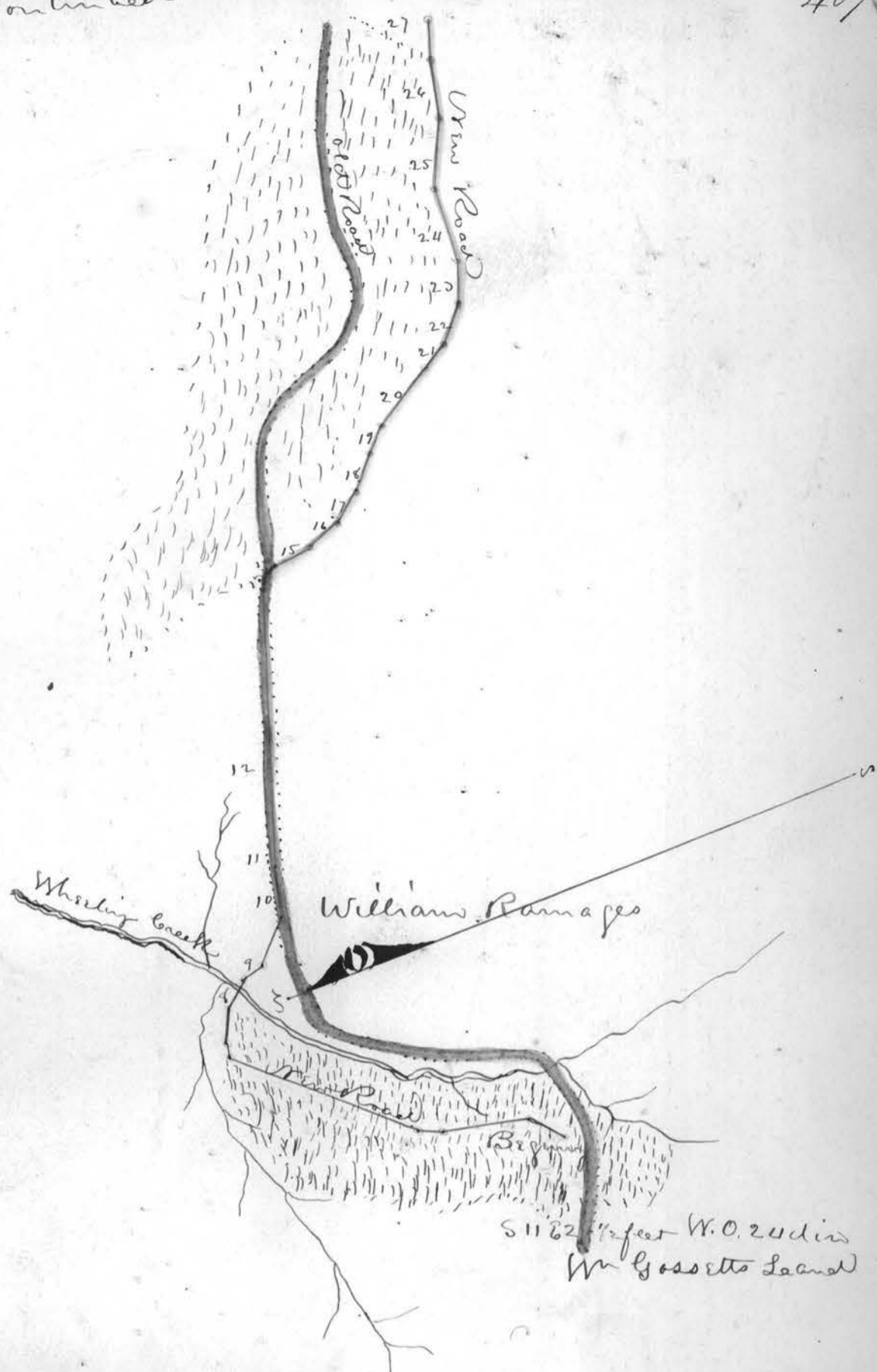

Field notes of the above Road

St.	Bearings	Distances	Mount	Remarks
1	N 64 E	7 00	Post	
2	N 29 1/4 E	15 00	do	
3	N 42 1/2 E	4 00	do	
4	N 55 1/2 E	24 00	do	
5	S 61 W	11 75		
6	S 60 W	2 00		
7	S 47 1/2 W	4 00		in Uniontown Road
8	S 25 W	6 00		west side of creek
9	S 7 W	4 00		cross creek
10	S 27 W	2 00		in old Road
11	S 55 W	9 00		opposite Saw Mill
12	S 51 1/4 W	42 75	Logcut Post	in Williams Ranges
13	S 28 1/2 W	2 00		in old Road
14	S 6 1/2 W	2 00		leaving old Road
15	S 16 W	7 00		in Williams field
16	S 1 1/2 E	4 75		do
17	S 18 E	4 60		do
18	S 30 E	8 50		
19	S 12 E	8 50		
20	S 7 E	15 50		
21	S 7 E	15 50		
22	S 27 E	7 50		
23	S 50 E	7 50		
24	S 66 E	13 50		
25	S 46 1/2 E	12 00	Stone Quarry	
26	S 54 E	10 00	Post	Stone Quarry
27	S 63 1/2 E	7 00		Section line
28	S 75 E	24 00		Andersons Land
29	S 70 E	8 00		in old Road
30	S 41 1/2 E	55 00		opposite the cutting
31	S 49 E	55 00		in old Road
32	S 27 1/2 E	55 00		
33	S 20 E	40 00		
34	S 29 E	24 00		
35	S 10 E	20 00		
36	S 58 1/2 E	9 50	Water Post	
37	S 66 E	8 00		
38	S 80 1/2 E	16 00		
39	S 57 1/4 E	15 50		
40	S 11 E	26 00		
41	S 17 E	12 00		
42	S 10 1/2 E	10 50		leaving old Road
43	S 82 E	22 00		
44	S 86 1/2 E	14 00		in old Road
45	S 75 1/2 E	16 00		do
46	S 50 1/2 E	10 00		
47	S 50 1/2 E	21 00		

I certify the above is a correct plat bearing and distances of the attention of the County road leading from Wm Gosselle to the Parks on the National road, as surveyed on the 18<sup>th</sup> 19<sup>th</sup> Dec 1855 Charles De Haas Surveyor

1851  
Plat of the County Road from the mouth of  
Kings Run to the National Road near Joseph  
Woodmansee's house.

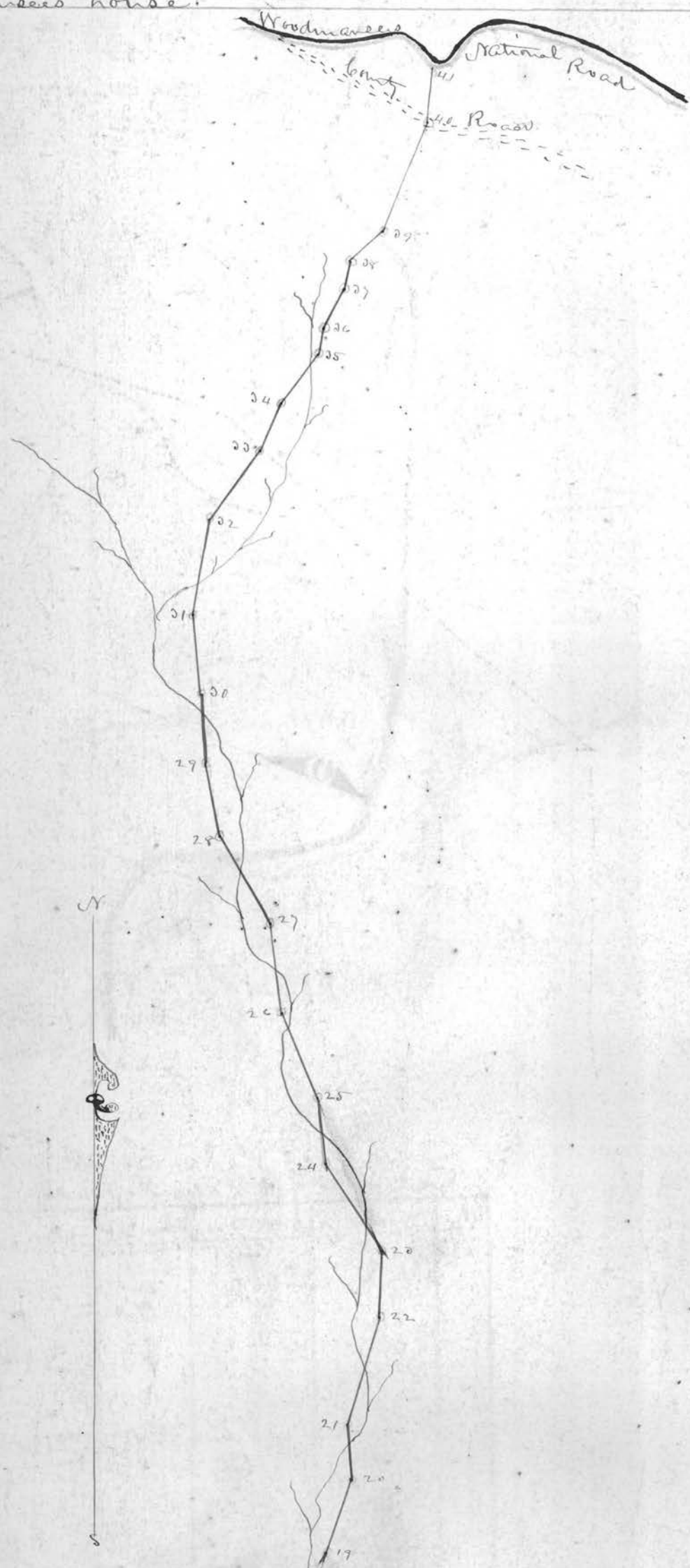





That of an alteration in the Road leading from  
 Barnesville to Williamsburgh, through the farms of  
 Isaac Reed in Warren Township, Belmont County.  
 Beginning for said Alteration  $S 74^{\circ} W$  of the Center of said  
 Reeds Run. Distance 10.95. per Running viz

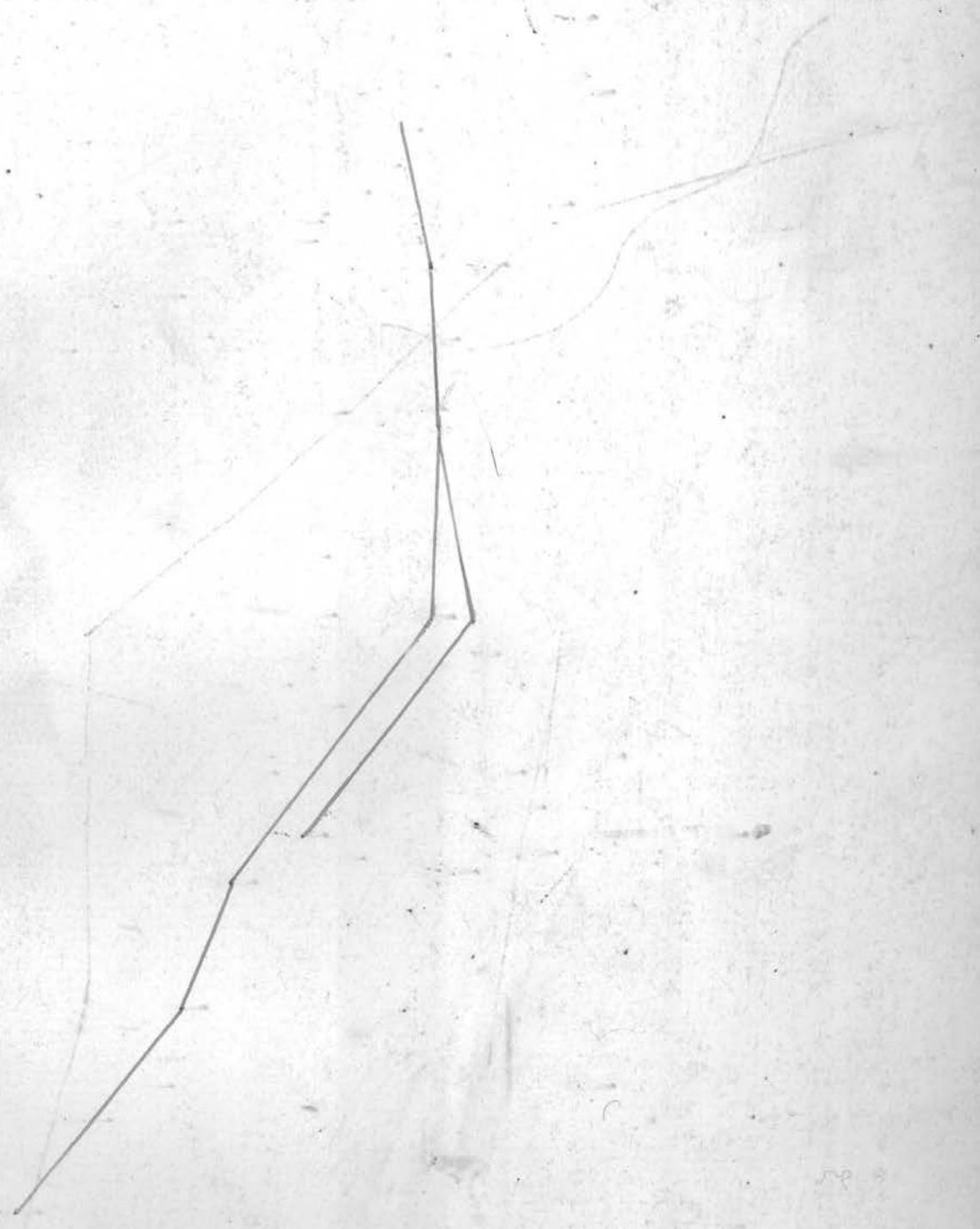



Plat of some alterations in the County Road  
leading from Wondry's bridge to Burnsville, commencing  
near the same two rods north of a Sugar Tree, thence  
South 14° East 170 perches, to a School house on  
School M. Semmes Land.

