

370.

Continued from 369.

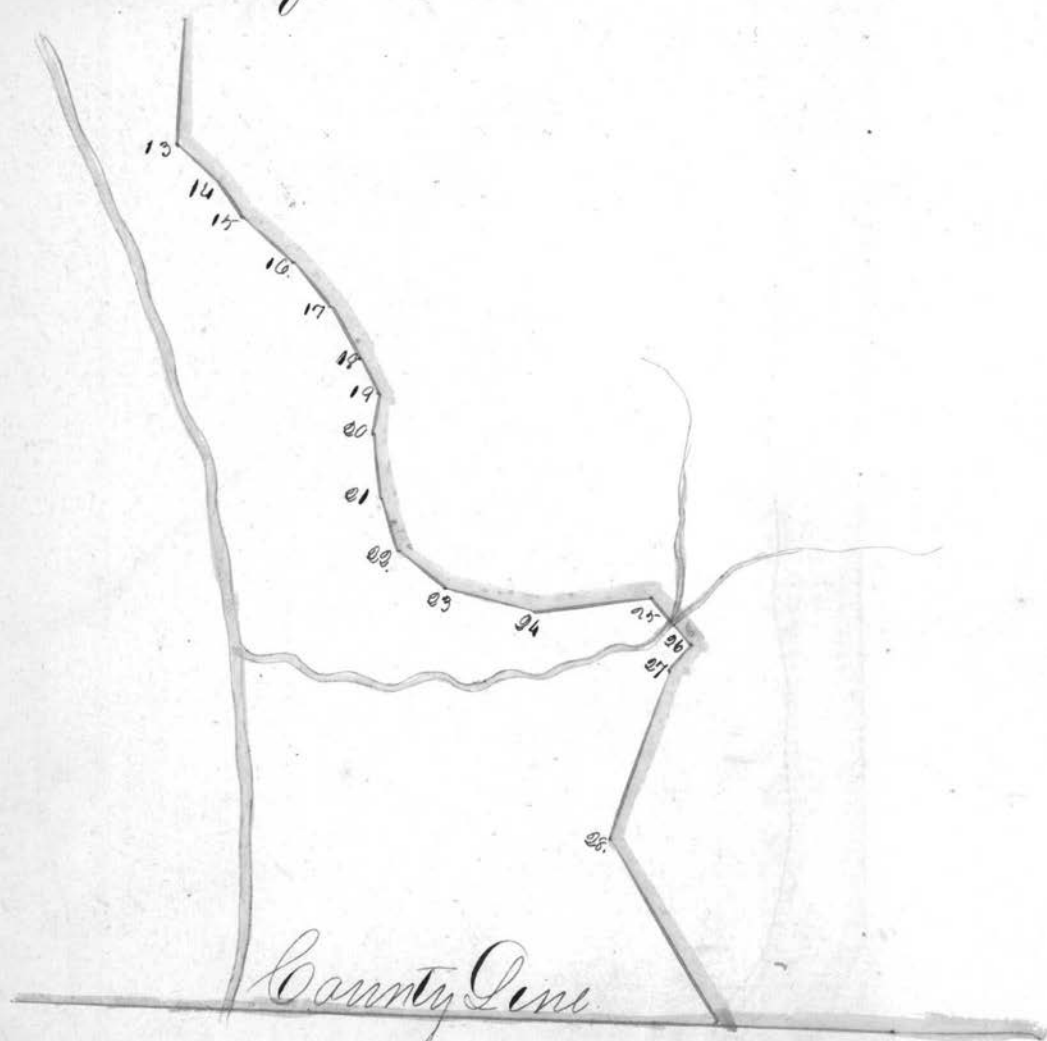

Plot of a County road beginning at the County line near the town of Moulaga thence by way of Sumertown to the town of Barnesville as surveyed by Asa Garrison A.D. 1853

Sta	Course	Dist
-----	--------	------

1	N 14 E	34. To Barnesville
---	--------	--------------------

1	N 10 1/2 E	6.
---	------------	----

2	N 33 W	10.
---	--------	-----

3	N 59 E	13.
---	--------	-----

4	N 37 E	24
---	--------	----

5	N 58 E	13
---	--------	----

6	N 41 E	13.
---	--------	-----

7	N 29 E	14.
---	--------	-----

8	N 48 E	10.
---	--------	-----

9	N 20 1/2 E	13.
---	------------	-----

10	N 31 1/2 W	2.
----	------------	----

11	N 14 W	2.
----	--------	----

12	N 10 E	2.
----	--------	----

13	N 31 E	4
----	--------	---

14	N 37 1/2 E	4
----	------------	---

15	N 26 E	4
----	--------	---

16	N 35 E	6
----	--------	---

17	N 48 E	8.
----	--------	----

18	N 52 E	5
----	--------	---

19	N 62 E	5
----	--------	---

20	N 68 E	2.
----	--------	----

21	N 26 E	5
----	--------	---

22	N 31 W	17.
----	--------	-----

23	N 27 1/2 W	28.
----	------------	-----

24	N 20 1/2 W	5
----	------------	---

25	N 14 1/2 W	26.
----	------------	-----

26	N 23 1/2 W	31
----	------------	----

27	N 18 E	13.
----	--------	-----

28	N 14 1/2 E	28.
----	------------	-----

29	N 14 E	32.
----	--------	-----

1	North	6.
---	-------	----

2	N 10 1/2 W	60.
---	------------	-----

3	N 25 W	28.
---	--------	-----

4	N 8 E	8. 6
---	-------	------

5	N 29 E	12
---	--------	----

6	N 7 1/2 W	6
---	-----------	---

7	N 27 1/2 W	14
---	------------	----

8	N 35 1/2 W	10
---	------------	----

9	N 36 1/2 W	18.
---	------------	-----

None omitted.

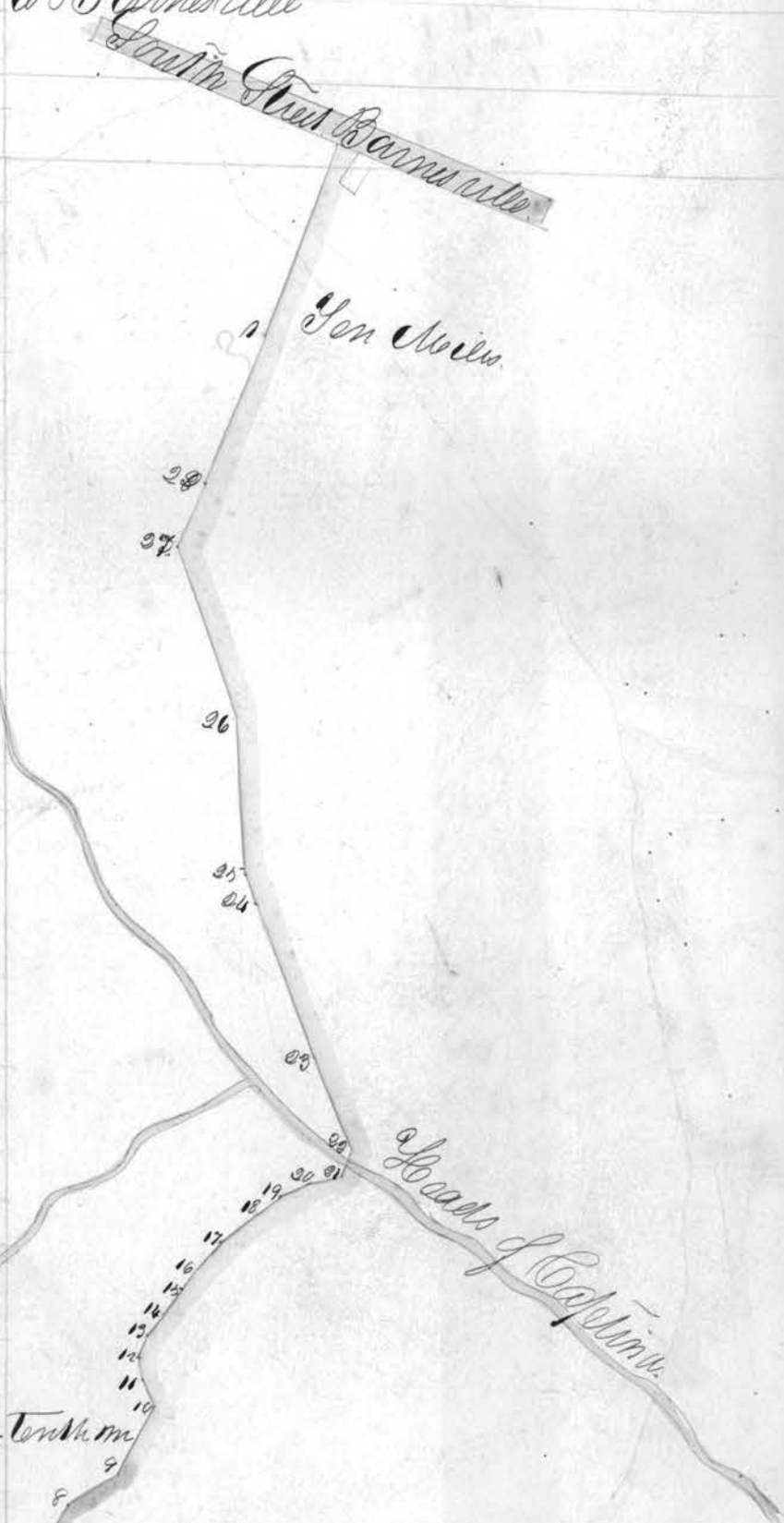

Continued on page 371

Continued from page 370



10	N 30° W	14
11	N 90° W	20
12	N 160° W	30
13	N 40° E	18
14	N 30° W	24
15	N 40° E	11
16	N 30° E	8
9 th	N 120° E	11
1	N 10° E	30
2	N 170° E	14
3	N 50° E	9
4	N 130° E	4
5	N 30° E	12
6	N 20° W	2
7	N 20° W	2
8	N 27° W	2
9	N 40° W	2
10	N 40° W	2
11	N 30° W	10
12	N 20° W	2
13	N 55° W	35
14	N 44° W	35
15	N 110° E	10
16	N 30° W	10
17	N 40° W	18
18	N 40° W	10
19	N 40° W	14
20	N 50° W	10
21	N 40° W	10
22	N 40° W	38
23	N 130° W	29
24	N 40° W	64 8 m
1	N 80° W	30
2	N 80° W	30
3	N 60° W	6
4	N 40° W	2
5	N 30° W	2
6	N 40° W	6
7	N 80° W	2
8	N 30° W	5
9	N 20° W	10
10	N 70° W	2
11	N 75° W	17
12	N 80° W	2
13	N 70° W	2
14	N 60° W	3



13	U 7 1/2 W	21
14	U 6 9 W	22
15	U 8 39 W	23
16	U 3 7 1/2 W	24
17	U 3 9 W	25
18	U 1 7 W	26
19	U 3 1/2 E	27
20	U 1 1/2 W	28
21	U 1 8 1/2 E	29
22	U 3 8	30
23	U 9 W	15
24	U 4 3 W	18
25	U 6 6 W	17
26	U 7 3 W	20
27	U 7 2 W	28
28	U 4 2 W	28
29	U 3 7 W	4
30	U 1 5 W	8
31	U 3 1/2 E	14
1	U 9 W	60
2	U 10 W	24
3	U 3 8	5
4	U 2 1 W	6
5	U 1 10 W	8
6	U 1 1/2 E	25
7	U 2 1 1/2 W	22
8	U 3 3 W	7
9	U 1 2 8	25
10	U 2 7 1/2 W	20
11	U 3 0 W	12
12	U 1 1 1/2 W	6 1/2
13	U 2 1 1/2 W	12
14	U 7 8 1/2 W	13
1	U 1 8 W	26
2	U 2 3 1/2 W	5 1/2
3	U 1 2 2 W	10
4	U 6 9 1/2 W	21
5	U 8 8 1/2 W	16
6	U 6 2 1/2 W	3 1/2

7 miles
 & continued on page 579

Continued from Page 371.



7	N 41° W	14
8	N 29° W	18.
9	N 25° W	29
10	N 6 1/2° W	23.
11	N 53° W	17.
12	N 57 1/2° W	15.
13	N 89° W	29.
14	N 50 1/2° W	2.
1	N 24° E	16.
2	N 24° E	16.
3	N 10 1/2° E	83.
4	N 8 1/2° W	9.
5	N 29° W	9
6	N 60° W	54
7	N 22° W	34.
8	N 33 1/2° W	13.
9	N 70 1/2° W	2.

5 1/2 mile

6 miles

14

8	U 82 1/2 W	13.
9	U 70 1/2 W	14.
10	Q 82 W	8.
11	U 73 W	8.
12	U 51 1/2 W	6
13	U 47 1/2 W	20.
14	U 56 1/2 W	14
15	U 18 W	8.
1	U 70 E	9
2	U 53 E	28.
3	U 26 1/2 E	20.
4	U 27 1/2 E	20.
5	U 25 W	6.
6	U 59 W	5.
7	U 49 1/2 W	7.
8	U 58 1/2 W	6.
9	U 65 1/2 W	5.
10	U 69 W	6.
11	U 50 W	5.
12	U 18 1/2 W	5.
13	U 8 E	24.
14	U 12 E	7.
15	U 28 1/2 E	34
16	U 12 1/2 E	16.
17	U 14 E	119.
18	U 5 1/2 W	18.
1	U 27 1/2 E	14
2	U 18 E	18.
3	U 10 E	14
4	U 16 E	14
5	U 29 E	14
6	U 22 E	8.
7	U 16 E	15
8	U 4 1/2 W	26.
9	U 15 E	31
10	U 22 E	11
11	U 30 1/2 E	13.
12	U 46 1/2 E	18.
13	U 51 E	21.
14	U 54 E	22.
15	U 45 E	11.
16	U 65 E	26.
17	U 35 E	18.
18	U 70 E	7
1	U 8 E	18.
2	U 31 E	15
3	U 73 E	14.

1st mile

2nd mile

3rd mile



Continued on Page 373.

Continued from page 372.

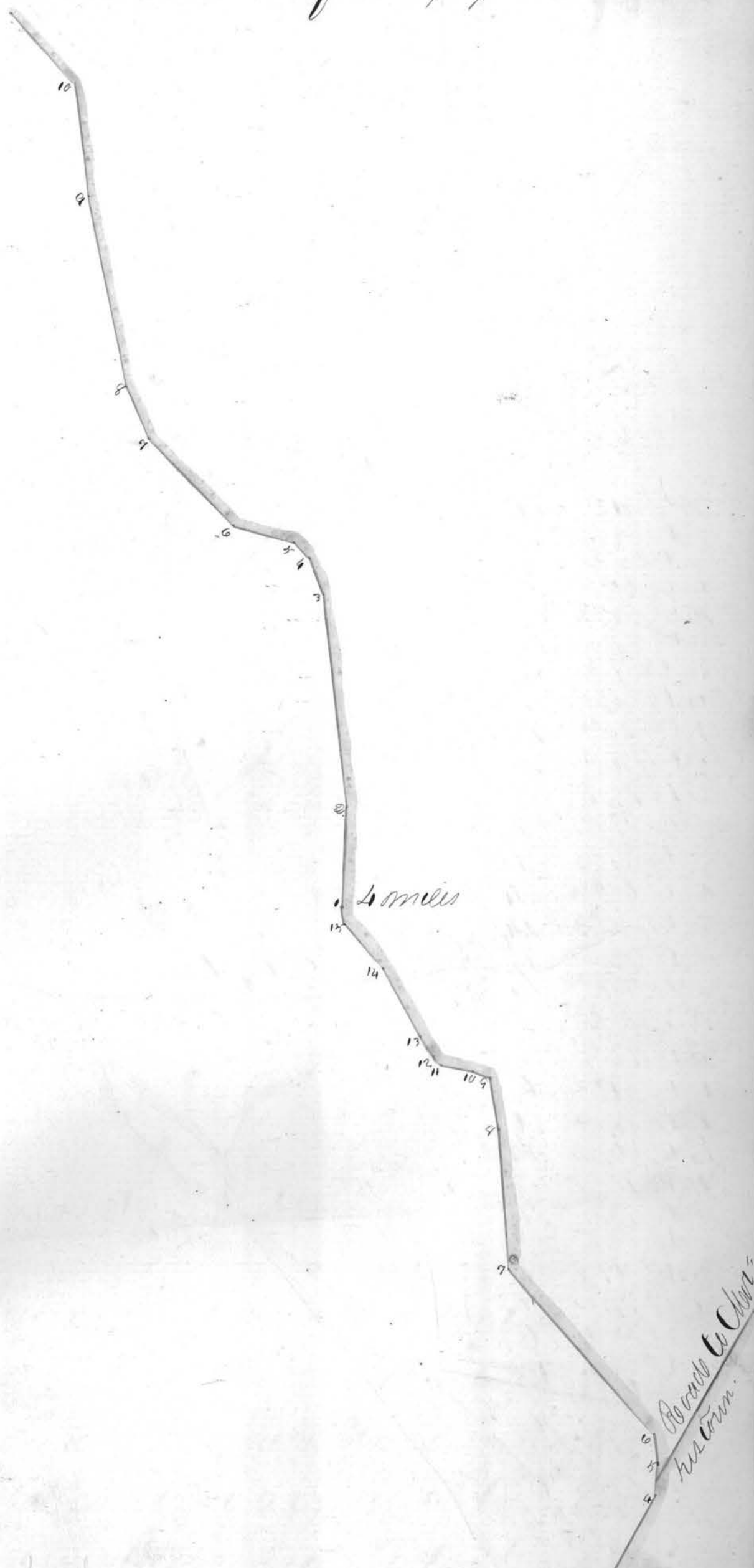

4	U 12 S E	7
5	U 11 S E	20.
6	U 10 S E	7.
7	U 12 S E	14
8	U 9 S E	10.
9	U 7 1/2 N W	10.
10	U 6 1/2 S E	19
11	U 2 1/2 S E	2.
12	U 3 1/2 N W	5
13	U 1 1/2 S E	18.
14	U 7 S E	14
15	U 1 1/2 N W	10.
16	U 2 1/2 N W	8.
17	U 2 1/2 N W	11
18	U 1 1/2 N W	8.
19	U 1 3/4 N W	8.
20	U 1 1/4 N W	10.
21	U 1 1/4 N W	18.
22	U 1 1/2 N W	8.
23	U 1 1/2 S E	10.
24	U 1 1/2 S E	10
25	U 1 1/2 S E	17.
26	U 2 1/2 S E	11

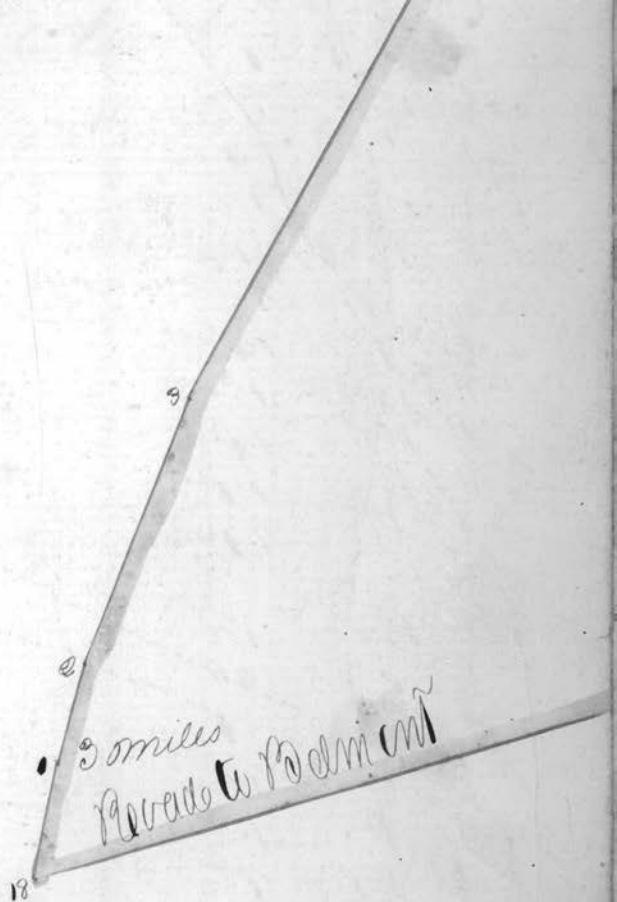

1st mile Continued on 374

Continued from page 373.

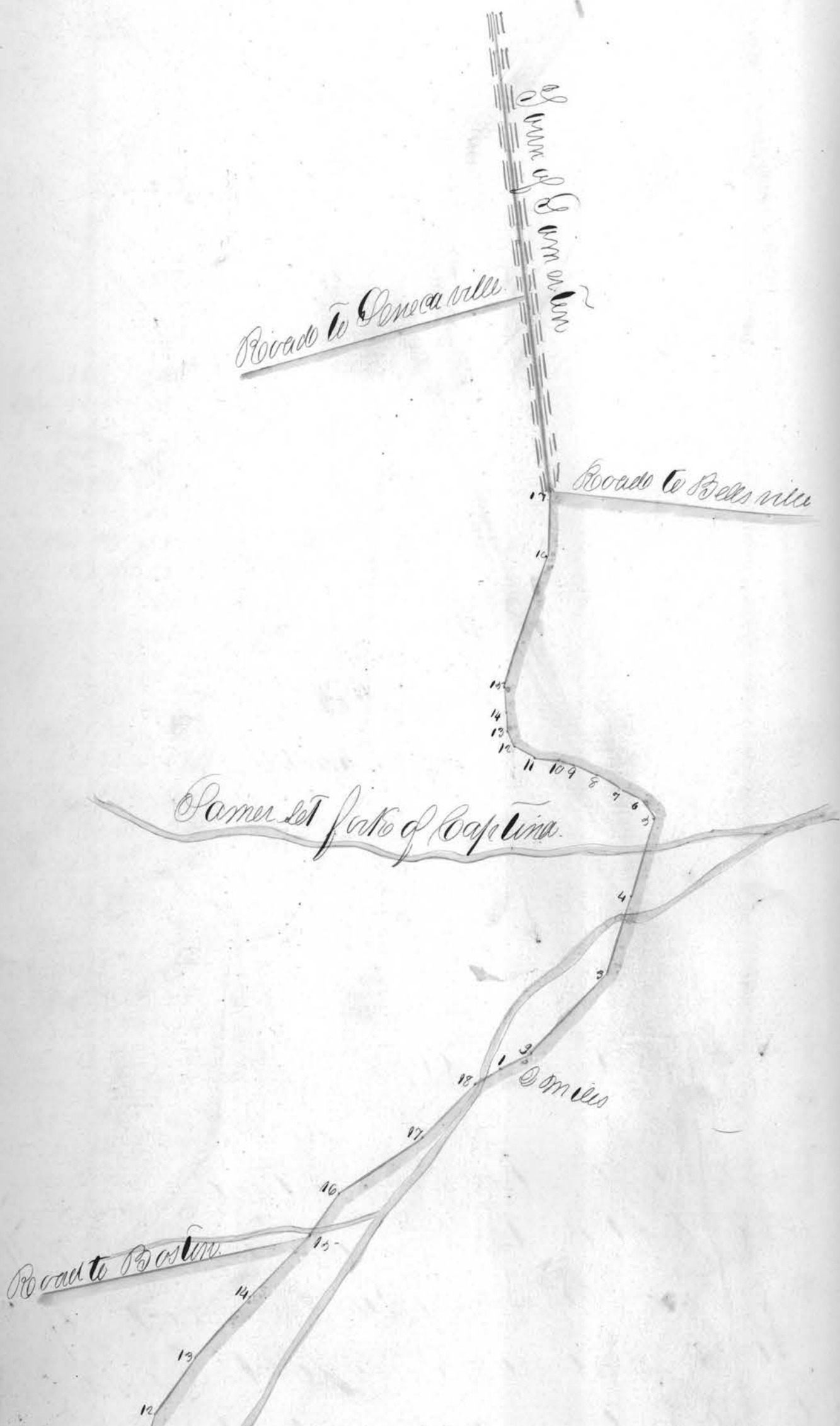

Road to Boston.

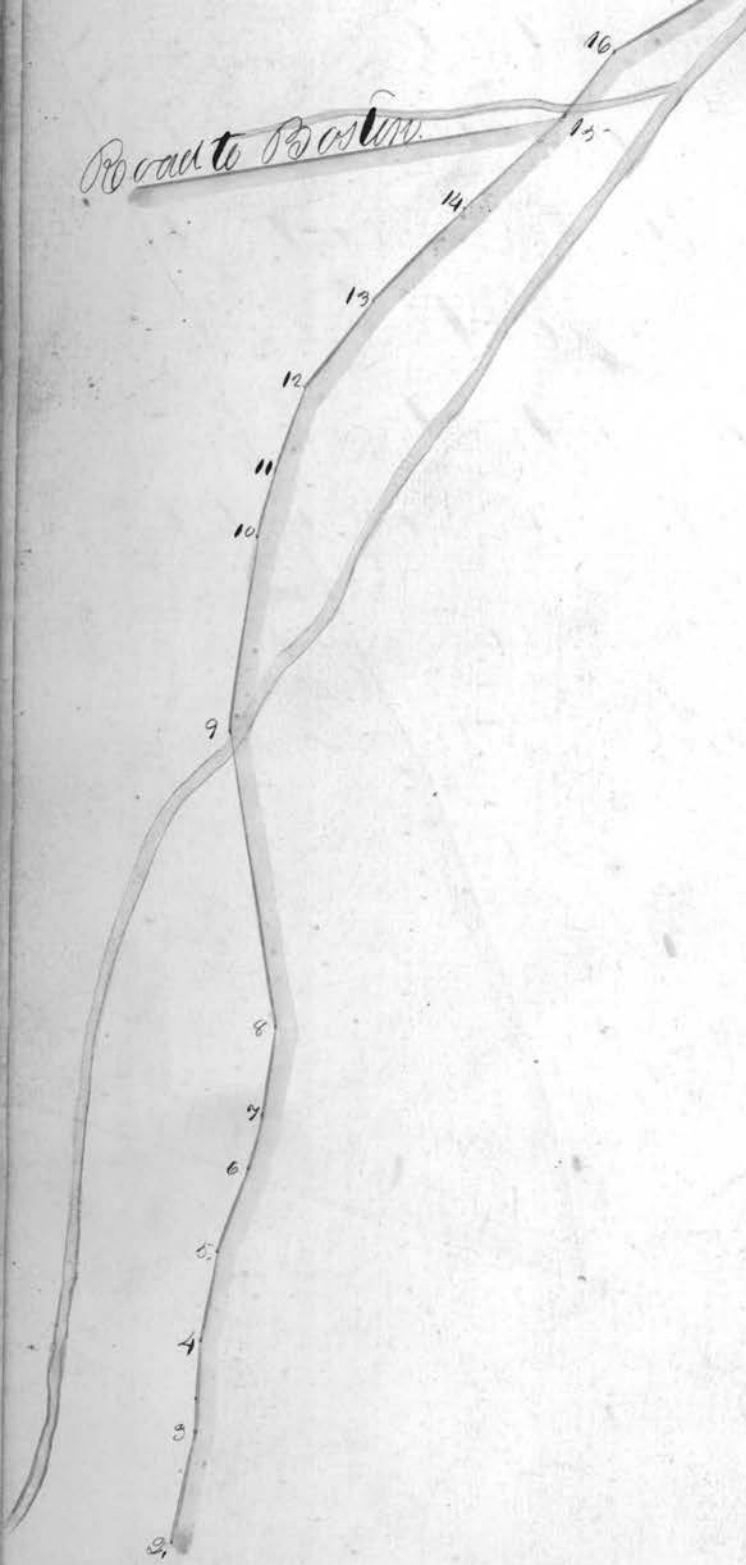

Continued on page 373.

Continued from Page 374



One mile

County Pine

Plan of a State road alteration from
a point on the Belmont & Monroe Co
line near Fredericks Hoges by Boston to
Barnesville. also a plat of the road from
the County line via Boston to Barnesville
as surveyed by Charles Dehass A.D. 1853

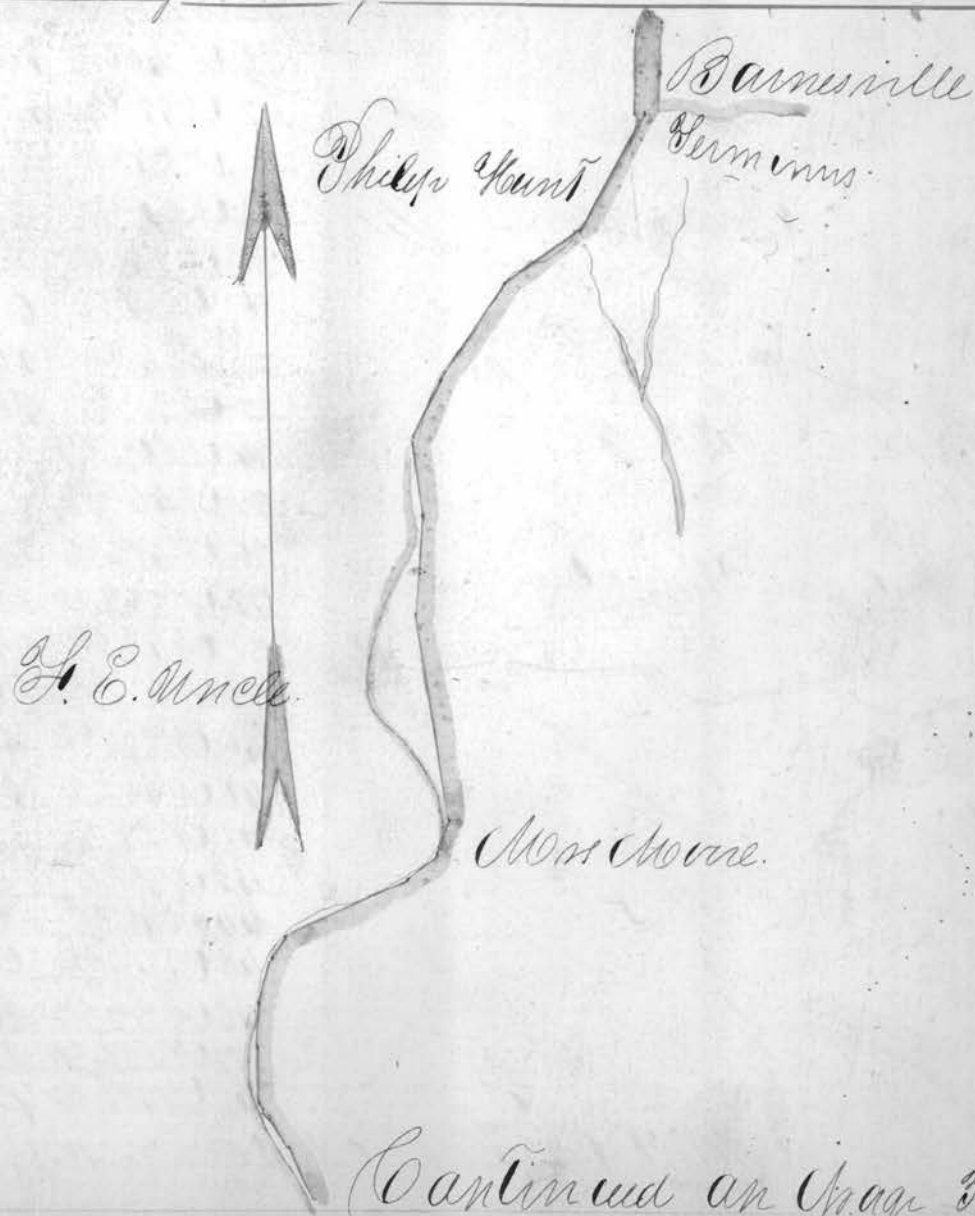

Continued on Page 376.

376

Continued from page 375

Summit Cut 3 ft.

Stae Souana

John Souana



Pomersetz Warren Sp. Line

John Mowbray

Shot Sullivan

Abel Barnes

Deer Whately

Dot. Whately

50 ft fall

The Runne Dist Uoon

1 N 39° W 30 Spots

2 N 67° W 50.

3 N 92° W 6.

4 N 99° W 20.

5 N 83 1/2° W 10.

6 N 80 1/4° W 20.

7 S 47 1/2° W 2.

8 N 95° W 2.

9 N 95° W 2.

10 N 5° E 10.

11 N 97 1/2° W 2.

12 N 88 1/2° W 20.

13 N 48° W 14.

14 N 20° W 2.

15 North 10.

16 N 60° W 20.

17 N 31° W 24.

18 N 47 1/2° W 18.

19 N 48 1/2° W 20. 1 m.

20 N 39 1/2° W 9.

21 N 42° W 5.

22 N 96° W 2.

23 N 83° W 20.

24 N 70° W 2.

25 N 50° W 38.

26 N 24° W 10.

27 N 11° W 10.

28 N 31° W 2.

29 N 31° W 2.

30 N 74 1/2° W 2.

31 West 6.

32 S 81° W 10.

33 N 90° W 10.

34 N 20 1/2° W 30.

35 N 26° W 29.

36 N 28 1/2° W 24.

37 N 33 1/2° W 22.

38 N 10° W 25. 2 m 1 sup.

39 N 6° E 20.

40 N 54 1/2° W 45.

41 N 15° E 19.

42 N 39° E 5.

43 N 2° E 2.

44 N 10° W 20.

45 N 18° W 20.

46 N 88° W 20.

47 N 28 1/2° W 22.

48 N 22 1/2° W 28.

Continued on Page 379.

Continued from Page 376.

Bing's Estate

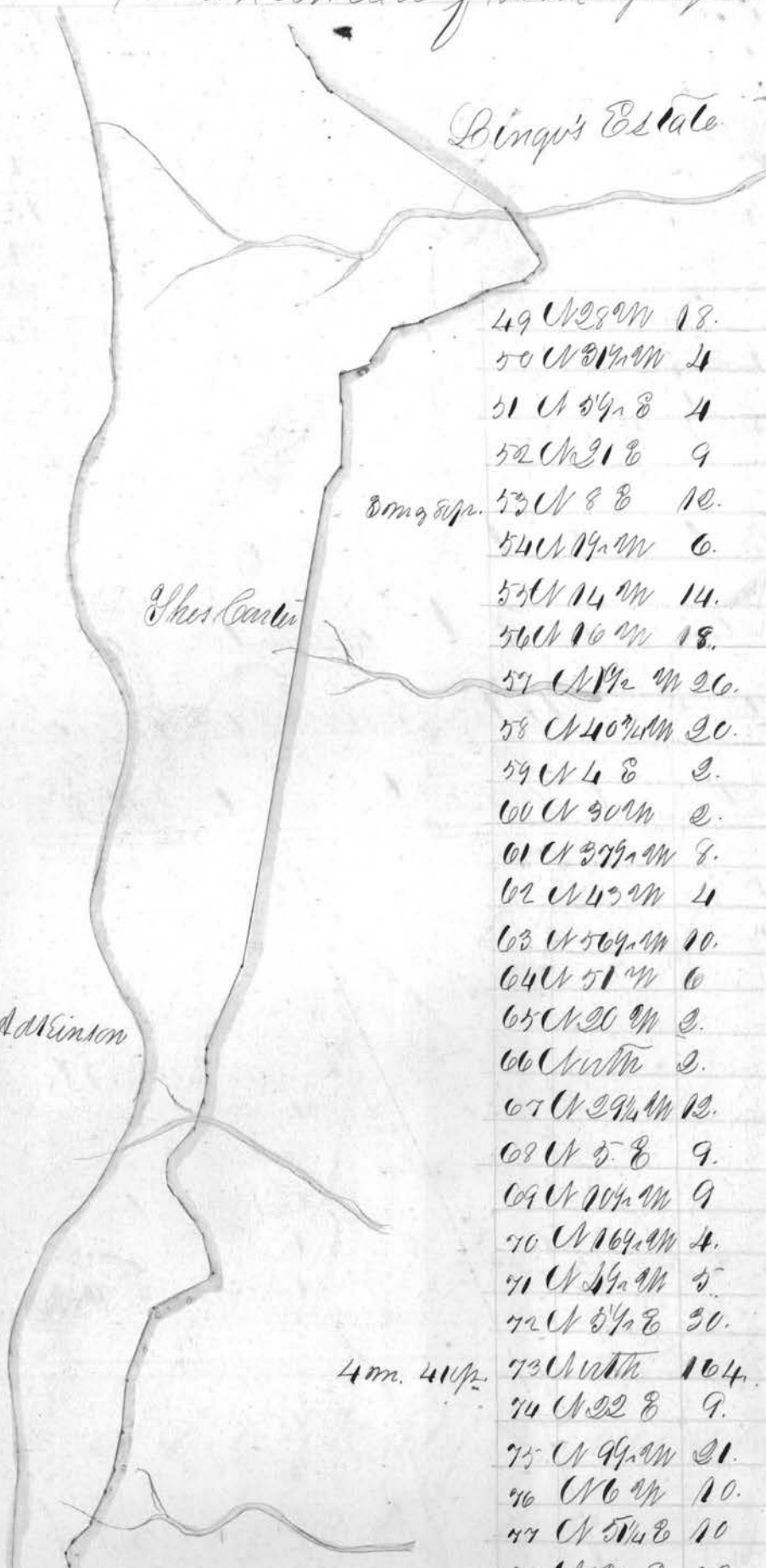

	7	N 20° W	8.			
	8	N 3° W	8.			
	9	N 37° E	3.			
49	N 28° W	18.	10	N 33½° E	4.	
50	N 31½° W	4	11	N 36½° E	4	
51	N 34° E	4	12	N 10° W	38.	
52	N 31° E	9	13	N 10½° E	14.	
Bing's Edge	53	N 8° E	10.	14	N 39½° E	10.
	54	N 19½° W	6.	15	N 55½° E	38.
	55	N 14° W	14.	16	N 81½° E	26.
Phos. Center	56	N 16° W	18.	17	N 37½° E	10.
	57	N 1½° W	20.	18	N 79° E	4.
	58	N 40° W	20.	19	N 5° W	12.
	59	N 4° E	3.	20	N 17° E	12 A Burns
	60	N 30° W	2.	21	N 23° W	31
	61	N 39½° W	8.	22	N 75½° E	12 6 miles
	62	N 45° W	4	23	N 19° E	12.
	63	N 56½° W	10.	24	N 2° W	14.
	64	N 51° W	6	25	N 19° W	26.
Geo. Adkinson	65	N 20° W	3.	26	N 14½° W	20.
	66	N 10° W	3.	27	N 13½° E	14.
	67	N 29½° W	12.	28	N 33° E	14.
	68	N 5° E	9.	29	N 44½° E	18.
	69	N 20½° W	9	30	N 44½° E	18.
	70	N 169° W	4.	31	N 95° E	14.
	71	N 24½° W	5.	32	N 41° E	8.
	72	N 5½° E	30.	33	N 60° E	6.
	73	N 10° W	104.	34	N 70½° E	8.
4 m. 41/2	74	N 32° E	9.	35	N 34° E	12.
	75	N 99° W	21.	36	N 10½° E	18.
	76	N 6° W	10.	37	N 49° E	8.
	77	N 5½° E	10	38	N 66° E	12.
	78	N 30° E	13.	39	N 70° E	10.

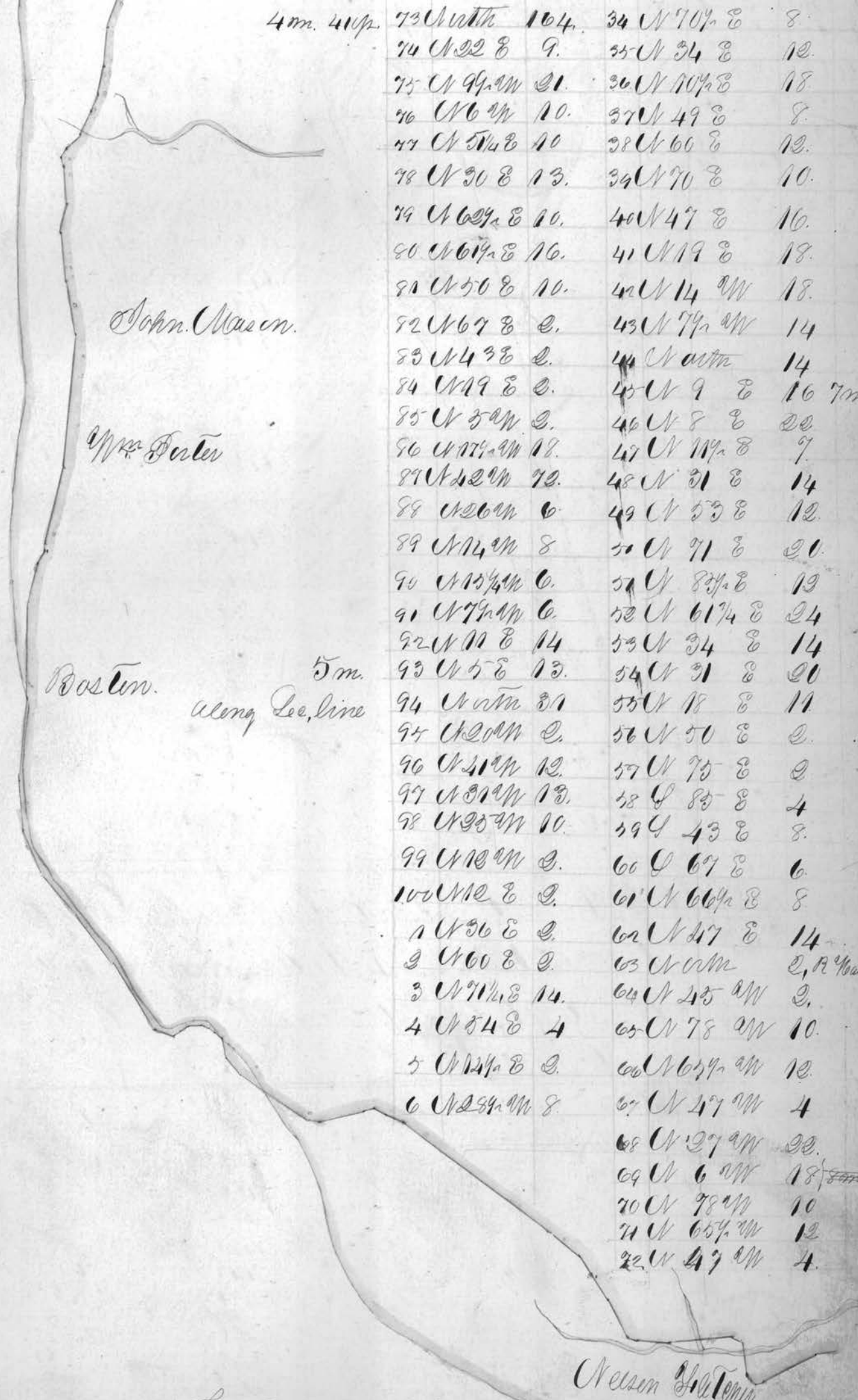

73	U 104	8	34	N 70 1/2 E	8
74	U 22 E	9	35	N 34 E	10
75	U 9 1/2 W	21	36	N 10 1/2 E	18
76	U 6 W	10	37	N 49 E	8
77	U 5 1/4 E	10	38	U 66 E	12
78	U 30 E	13	39	N 70 E	10
79	U 6 1/2 E	10	40	N 47 E	16
80	U 6 1/2 E	16	41	U 19 E	18
81	U 50 E	10	42	U 14 W	18
82	U 67 E	2	43	N 7 1/2 W	14
83	U 43 E	2	44	U 10 W	14
84	U 19 E	2	45	N 9 E	16 7m
85	U 3 W	2	46	N 8 E	20
86	U 11 1/2 W	12	47	N 11 1/2 E	7
87	U 22 W	7	48	N 21 E	14
88	U 26 W	6	49	N 53 E	12
89	U 14 W	8	50	N 71 E	20
90	U 15 1/2 W	6	51	N 8 1/2 E	19
91	U 7 1/2 W	6	52	N 61 1/4 E	24
92	U 11 E	14	53	N 34 E	14
93	U 5 E	13	54	N 31 E	20
94	U 10 W	3 1/2	55	N 18 E	11
95	U 20 W	2	56	N 50 E	2
96	U 4 1/2 W	12	57	N 75 E	2
97	U 3 1/2 W	13	58	N 85 E	4
98	U 23 W	10	59	N 43 E	8
99	U 10 W	2	60	N 67 E	6
100	U 12 E	2	61	N 66 1/2 E	8
1	U 36 E	2	62	N 17 E	14
2	U 60 E	2	63	U 10 W	2, R. 1/2 m
3	U 71 1/2 E	14	64	N 25 W	2
4	U 84 E	4	65	N 78 W	10
5	U 12 1/2 E	2	66	N 65 1/2 W	12
6	U 25 1/2 W	8	67	N 47 W	4
			68	N 27 W	20
			69	N 6 W	18 8 1/2
			70	N 78 W	10
			71	N 65 1/2 W	12
			72	N 47 W	4

Continued on page 378

Continued from page 377

170	N 37 1/2 W 20.	85	N 42 E 16.
174	N 6 W 18	87 1/2	N 34 E 20.
175	N 12 1/2 W 20	87	N 47 E 12.
176	N 32 W 6.	88	N 10 W 20
177	N 46 W 10.	89	N 18 W 16
178	N 58 1/2 W 8.	90	N 24 W 14
179	N 20 W 18.	91	N 10 1/2 W 9.
180	N 41 W 10.	92	N 3 1/2 E 10.
181	N 26 W 14.	93	N 13 E 12.
182	N 60 W 8	94	N 21 1/2 E 14
183	N 35 1/2 W 6.	95	N 33 1/2 E 6.
184	N 12 W 2.	96	N 74 1/2 E 10.



97	N 57 1/2 E 10.
98	N 26 E 11
99	N 10 W 60 def. wt
200	N 10 E 28. 10 def.
1	N 2 E 21.
2	N 10 1/2 E 18. 10 m
3	N 36 1/2 E 34. 45 ft.
4	N 54 1/2 E 26
5	N 91 E 39.
Total 10 miles 45 poles	
in Belmont 3 1/2 975	
in Warren 3290	
Total 11,45	

That of an alteration on the St. Charlesville & Mount Pleasant road through the lands of Abner Sturck & Slater Browns in Colerain Sp. as surveyed by Charles Dehass A.D. 1853

Sta	Course	Dist	Chase
1	N 20 1/2 E	24.50	Post
2	N 81 1/4 E	10.50	"
3	N 32 E	20.	"
4	N 15 E	8	"
5	N 30 E	9	"
6	N 10 W	9	"
7	N 30 W		"
8	N 20 W		"
9	S 50 W		"
10	S 12 1/2 W	10.	"
11	S 59 1/2 W	8	"
12	N 60 W	4	"
13	N 45 W	8	"
14	N 17 1/2 E	4	"
15	N 30 E	6	"
16	N 5 1/4 E	24.50	
Total 147.50 poles			

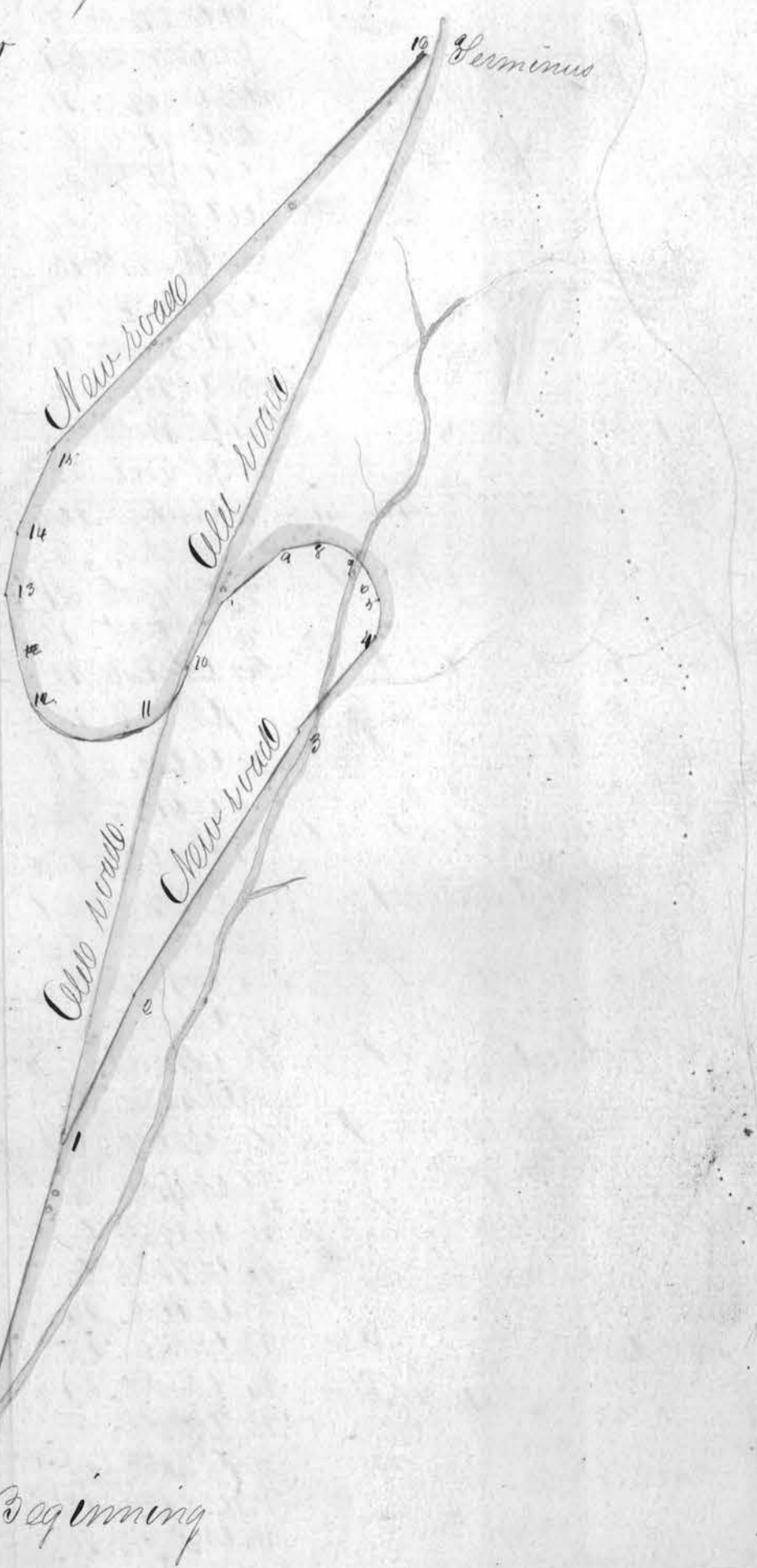

That of The County road by Isaac Quess
 running thence to the St Chairesville and
 Jacobsburgh road as surveyed by Chas-
 Dehuss A.D. 1858

No	Course	Dist	Open
1	East	88	Post
2	S 79° E	12	"
3	N 80 1/2° E	21,40	"
4	S 63 1/2° E	20	"
5	S 68° E	56,60	"
6	S 57 1/2° E	36	"
7	S 26° E	36	"
8	S 72 1/2° E	21	"
9	N 81° E	28,75	"
10	N 61 1/2° E	18	"
Total		340,75	



Continued on p. 379.

Continued from page 378

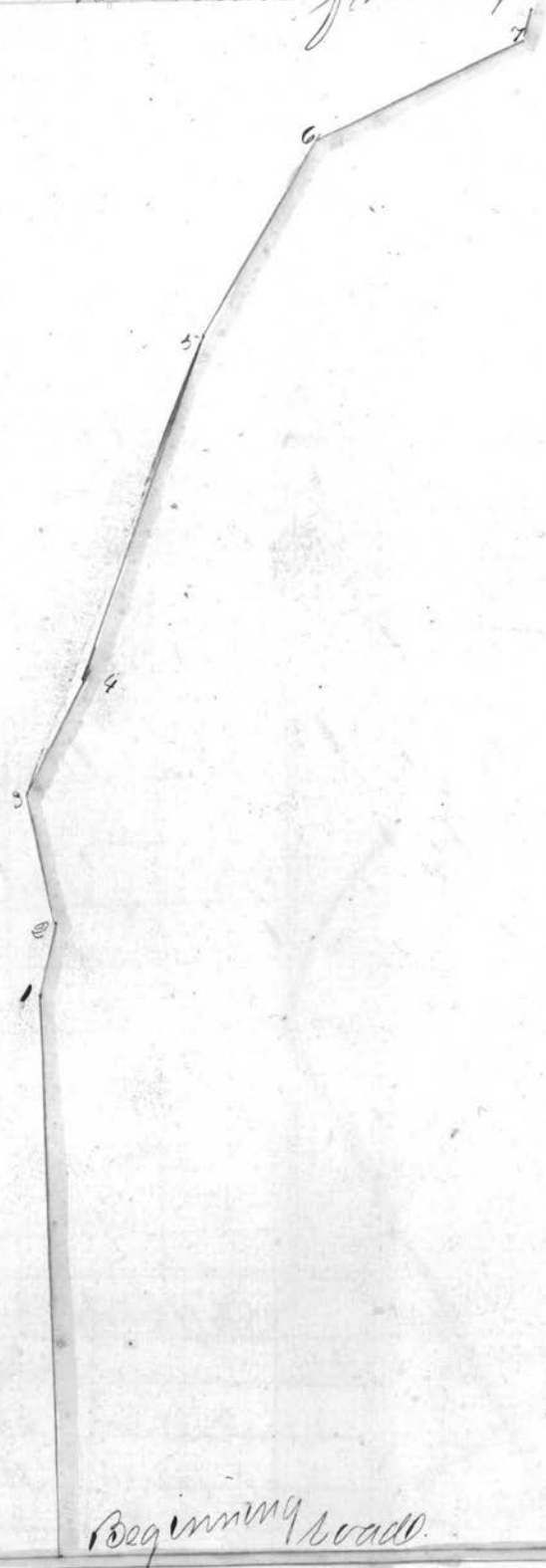

State

Beginning road.

That of a County road located to Snyper
 That part of the road leading from Snyper
 to Hinney's to Meclan's Tavern, beginning
 for same alteration or new location at the
 east end of the "Deep Cut" on the Martins
 Hill and Mount Pleasant Asst. road
 and terminating on the old road east of
 Jacob Wamplett's barn as surveyed by
 Charles Dehass A. D. 1858.

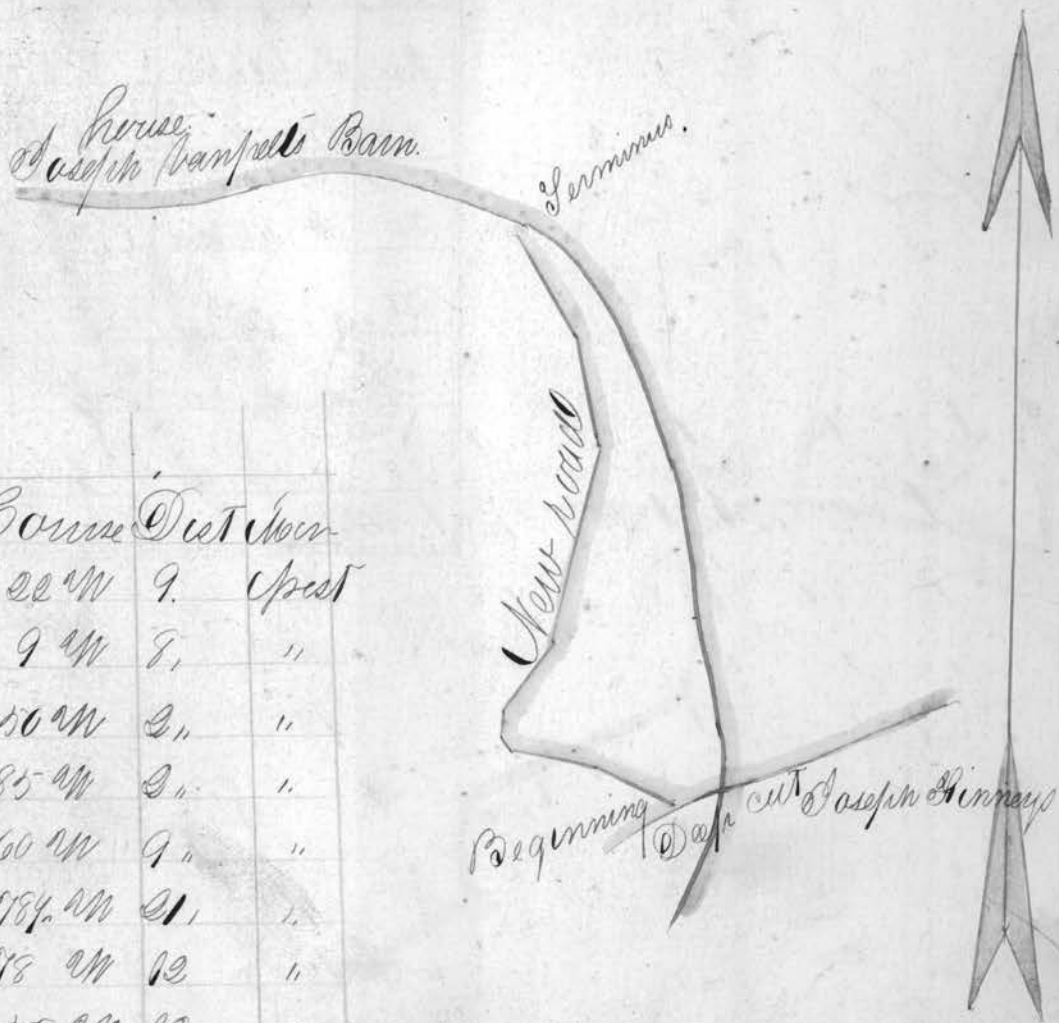

Sta	Course	Dist	Notes
1	S 22° W	9	West
2	S 9° W	8	"
3	S 50° W	3	"
4	N 85° W	3	"
5	N 60° W	9	"
6	S 78° W	21	"
7	S 78° W	12	"
8	S 59° W	12	"
		75	Up road