

Part of a County road beginning on the road from Cambridge to Millwood near the line between Somerset and Warren Townships and runs thence to the road from Barnesville to Maratta as surveyed by J. Dehass A.D. 1852



No	Course	Dist	Remarks
1	N 71 1/2 E	10	posts
2	N 51 1/4 E	11	
3	N 31 1/2 E	12	
4	N 20 1/2 E	12	
5	N 40 E	8	
6	N 47 1/2 E	15	
7	N 37 1/2 E	10	
8	N 76 1/2 E	11	
9	S 60 E	9	
10	S 33 1/2 E	15	
11	N 62 E	6	
12	N 8 E	15	
13	N 65 E	2	
14	N 78 1/2 E	56	
15	N 80 E	14	
16	N 69 1/2 E	27	
17	S 87 1/2 E	7	
18	S 79 1/2 E	13	
19	N 83 1/2 E	13	
20	N 43 1/4 E	17	
21	N 30 E	8	
22	N 44 E	18	
23	N 46 E	22	
24	N 48 1/2 E	20	
25	N 40 E	18	
26	N 71 E	25	
27	N 78 E	12	
28	N 75 E	14	
29	N 2 E	29	
30	N 27 1/2 E	15	
31	N 37 1/2 E	24	
32	N 53 E	14	
33	N 37 E	23	
34	N 22 E	8	
35	N 37 E	13	
36	N 26 E	16	
37	N 17 1/2 E	24	
38	N 9 1/2 E	16	
39	N 37 E	15	
40	N 23 E	10	
41	N 37 1/2 E	20	
42	N 77 E	21	
43	N 74 E	12	
44	N 39 E	12	
45	N 1 1/2 W	45	Post Mount
46	N 2 E	18	
47	N 60 W	26	
48	N 2 E	6	

Sum. 144 1/2

Woodcock Woods

Barnesville

Plot of an alteration on the ^{Probaseo} road from Stake
 No 3. on the original survey and terminates
 where it intersects the Domestic Bellville road at
 the former residence of William Lloyd as sur-
 veyed by Asa Garrison A.D. 1852

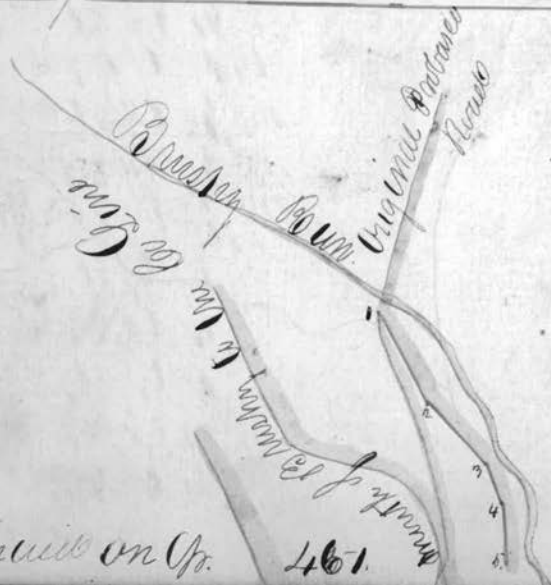

No	Course	Dist	Cham.
1	N 90° W	10.	
2	N 89° W	9	
3	N 88 1/2° W	8.50	
4	N 9° W	5.	
5	N 1° E	8	
6	N 10° W	10.	
7	N 85° W	17.04	
8	N 48° W	6.	
9	N 3° W	4.	
10	N 29° E	10.50	
			88.04

Continued on Op.

Continued from page 450.

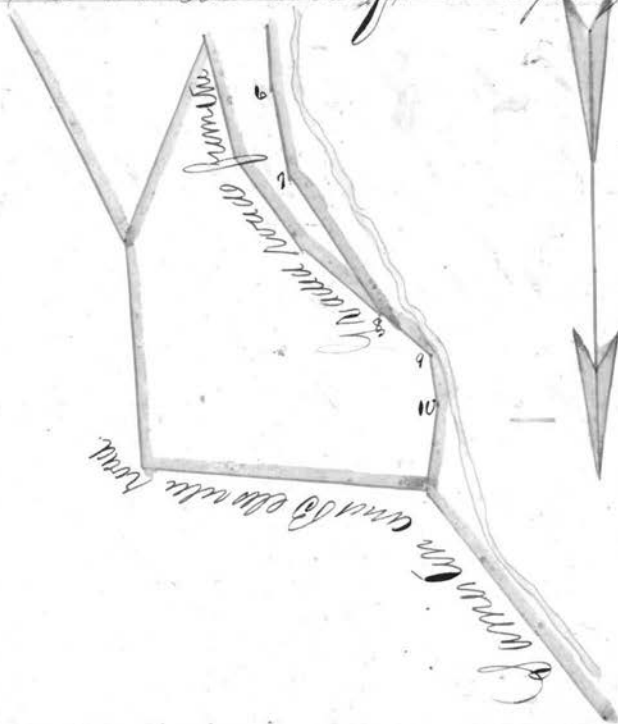

That of a County road beginning near Andersons mill and running thence to the Barnesville and Harrew road on lands of Aquilla Cowgill as surveyed by Charles Dehass A.D. 1852

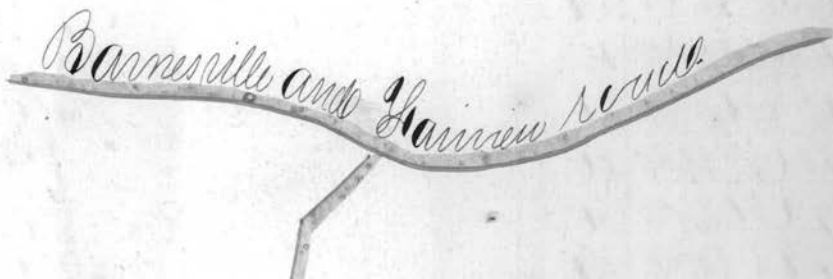

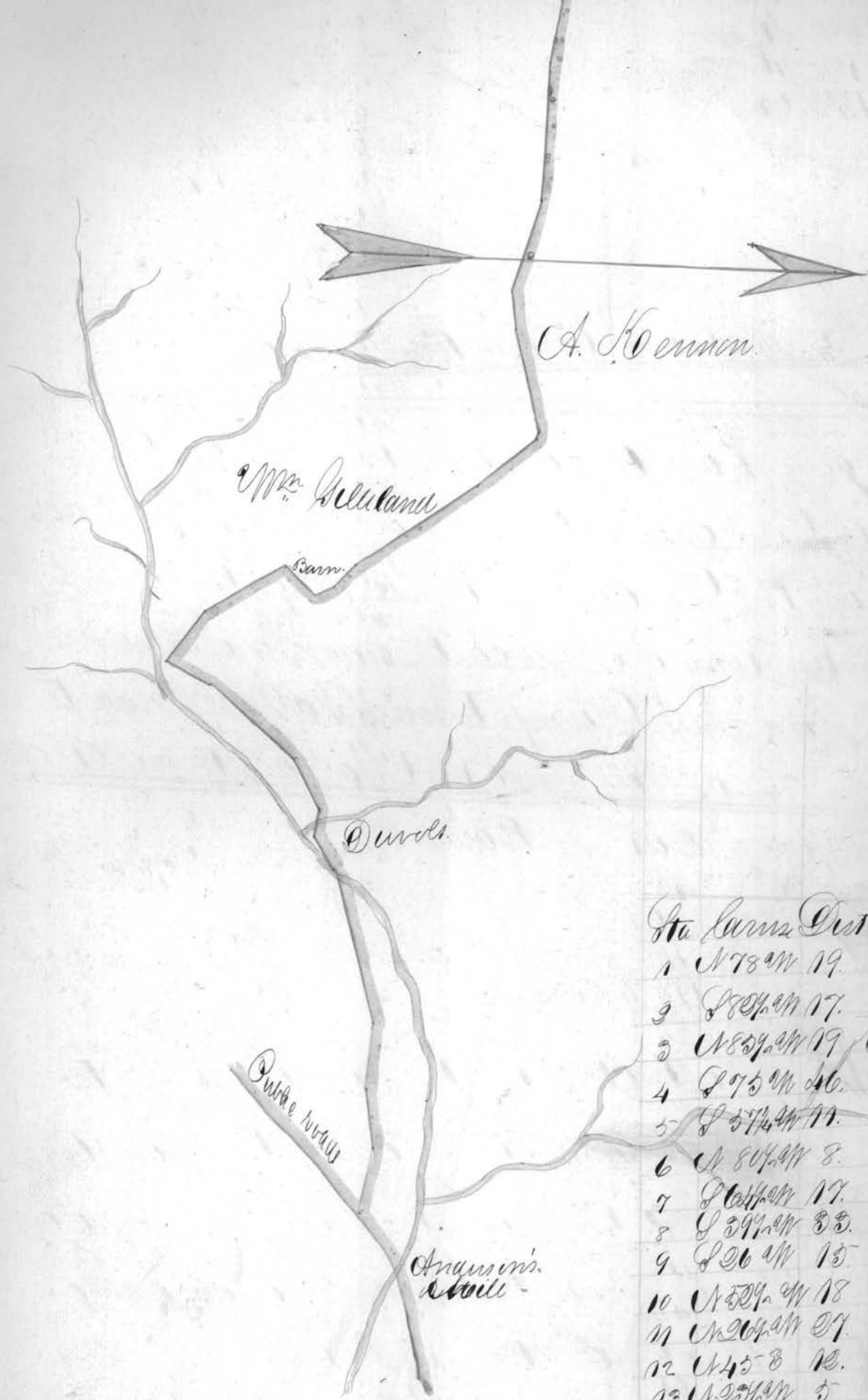

- Sta Linnæ Post Ulen.
- 1 N 78° W 19. Linnæ
 - 2 S 80° W 17. Dugan.
 - 3 W 85° W 19. Post.
 - 4 S 75° W 40.
 - 5 S 57° W 11.
 - 6 N 80° W 8.
 - 7 S 60° W 17.
 - 8 S 59° W 33.
 - 9 S 26° W 15.
 - 10 W 50° W 18.
 - 11 W 20° W 27.
 - 12 W 45° E 10.
 - 13 W 25° W 5.
 - 14 W 46° W 9.
 - 15 W 35° W 43.
 - 16 W 57° W 20.
 - 17 W 66° W 2.
 - 18 S 97° W 31.
 - 19 S 86° W 12.
 - 20 W 73° W 33.
 - 21 W 86° W 20.
 - 22 W 80° W 21.
 - 23 W 102° W 20.

460
 Plat of a County road beginning at a gate
 a few rods south of Joseph Walkers house and
 running thence to the Blushing & Morris Town
 road. as surveyed by Jacob McElroy A.D. 1852!

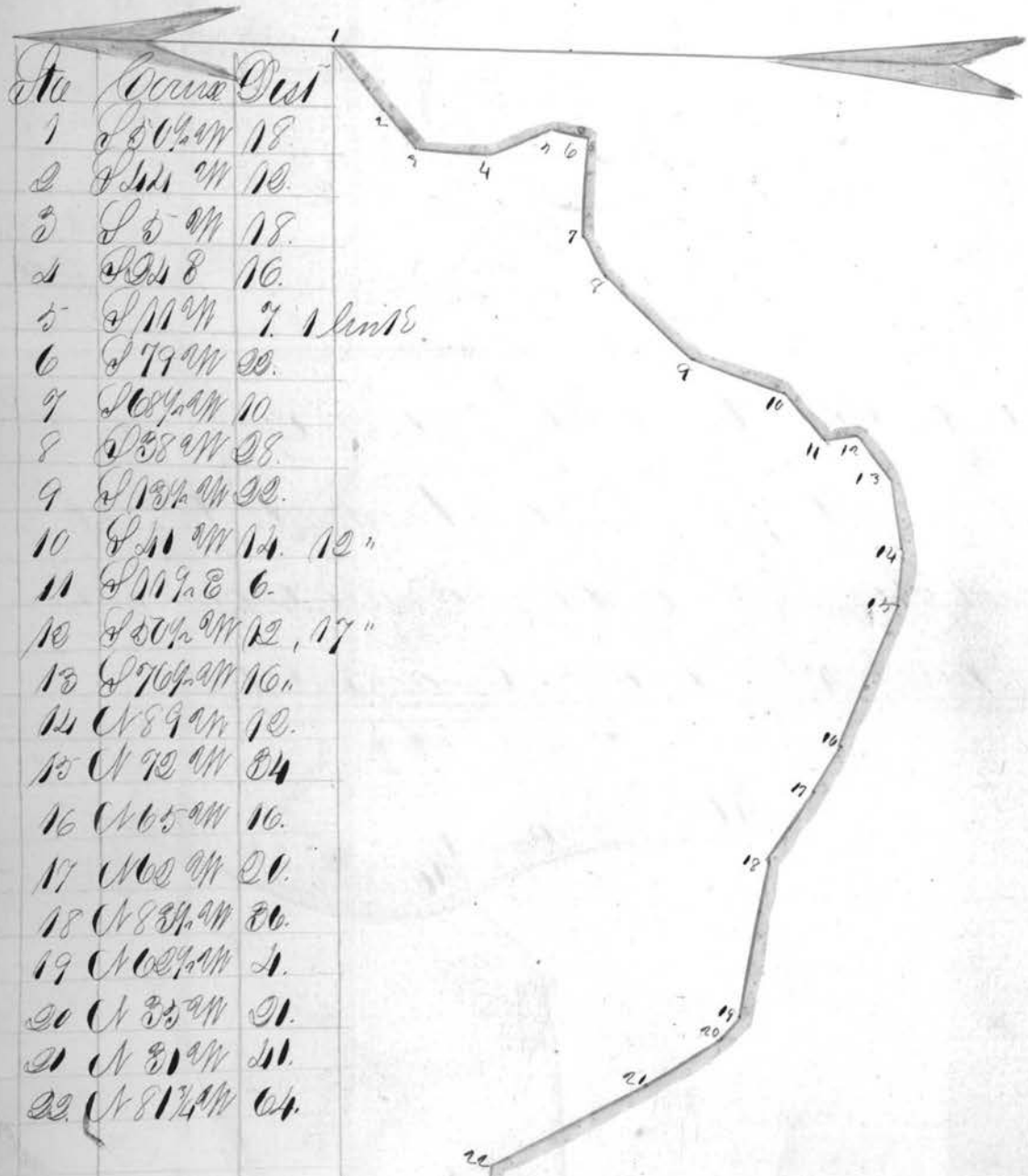

Blushing and Morris Town road

Plat of a County road beginning at the
 County Line about one & a half miles from Bell-
 ville on the S. E. quarter of Sec. 7. Twp. 6 & 7 Range 5
 thence by way of Newcastle mouth of Brushy
 Greys Saw Mill Stumps Town & Pattons mile to
 Barnesville as surveyed by Aso Garrison A.D. 1852

Sta	Course	Dist
1	S 58° W	26
2	S 69 1/2° W	56
3	S 75° W	18
4	S 72° W	110 to Barnesville
1	N 69° W	2.30 24
2	N 48 1/2° W	21
3	S 86 1/2° W	25
4	N 69° W	56
5	N 18° W	8
6	N 8° W	9
7	N 78 1/2° W	118
8	S 30 1/2° W	23
9	S 58° W	21 13 th mile
10	N 41 1/2° W	61
11	N 38° W	68
12	N 66° W	60
4	S 67 1/2° W	23 1/2
5	N 68° W	14
6	N 38 1/2° W	14
7	N 57° W	30 1/2
8	N 48° W	7
9	N 26° W	33
10	N 69° W	26 12 th mile Continued on page 363

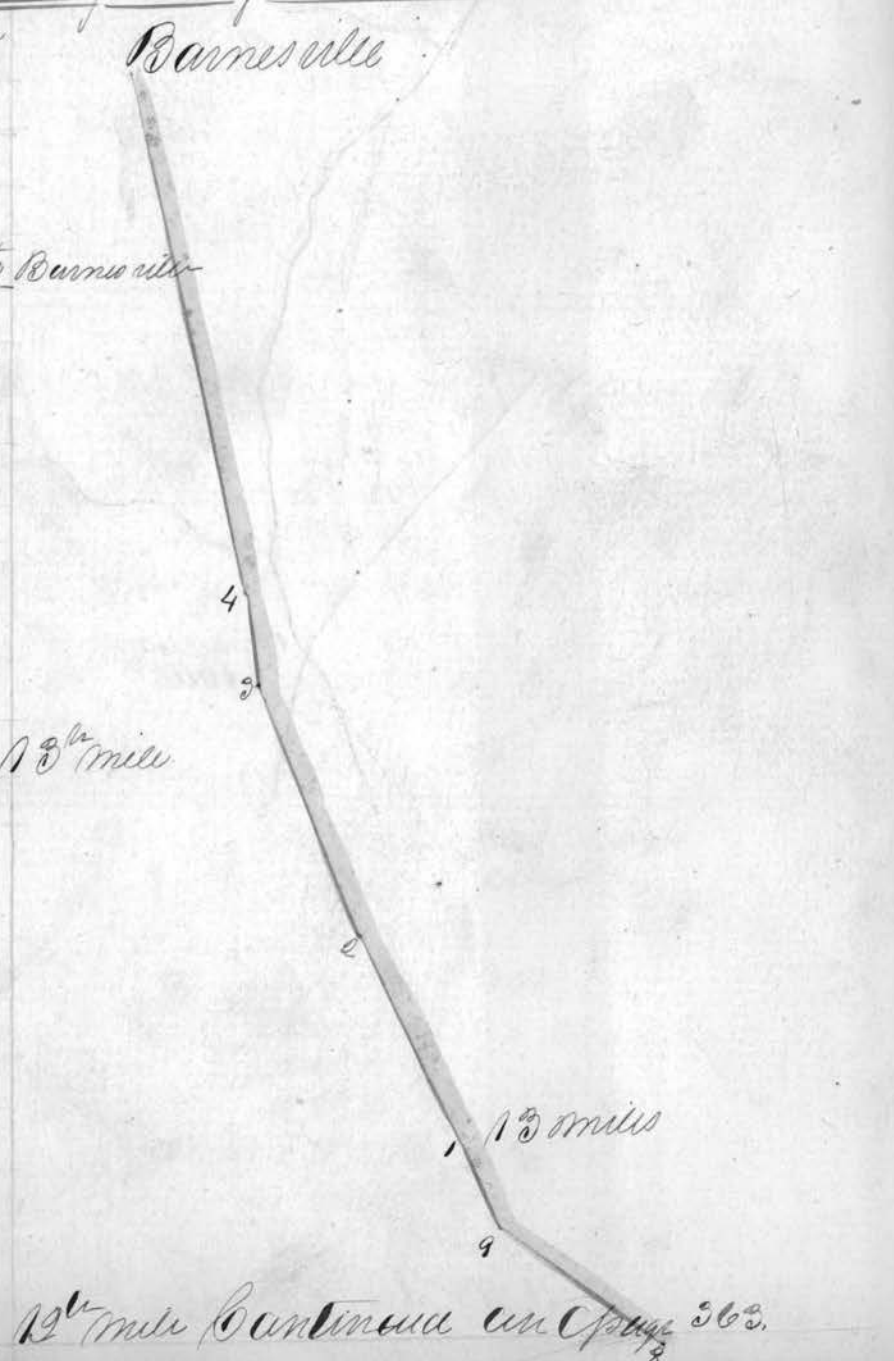

Continued from page 302.

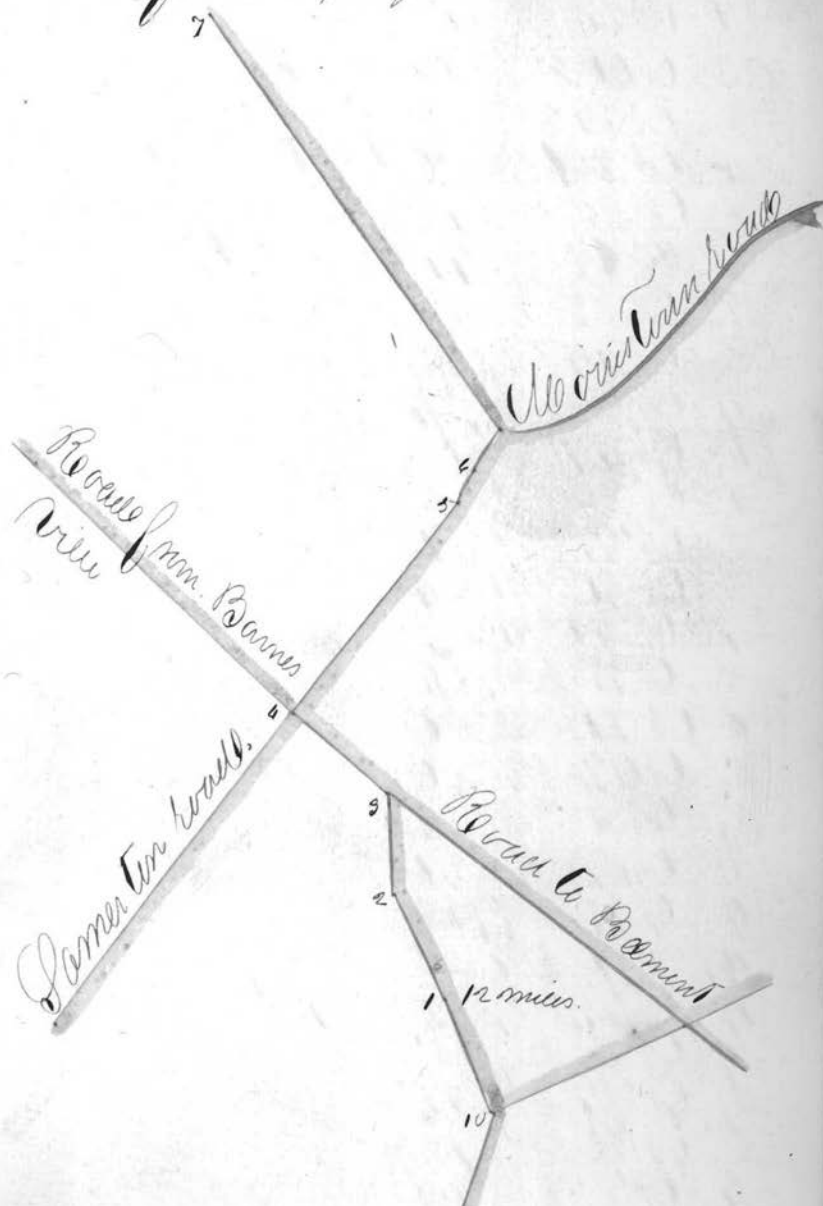

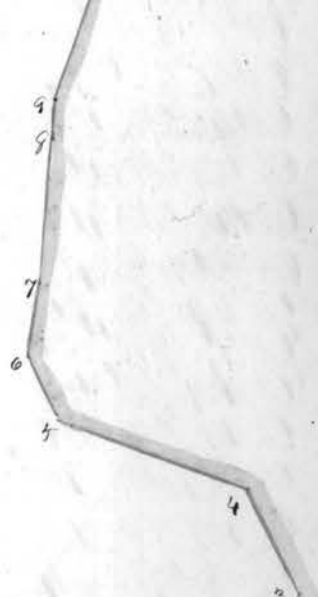

11 miles



10 miles

Continued on Op.

1364

1	N 74 1/2 W	16
2	N 61 W	16
3	N 39 W	26
4	N 30 1/2 W	26
5	N 25 W	48
6	N 17 E	41
7	N 8 1/2 E	28
8	N 44 W	10
9	N 31 1/2 W	34
10	N 44 1/2 W	63
1	N 39 W	8
2	N 79 W	26
3	N 74 1/2 W	24
4	N 37 W	29
5	N 33 1/2 W	54
6	N 31 1/2 W	20
7	N 17 1/2 W	36
8	N 9 W	39
9	N 2 1/2 E	36
10	N 43 1/2 W	13
11	S 81 W	20
12	N 74 1/2 W	10
1	N 16 E	0
2	N 24 E	17
3	N 12 W	10
4	N 8 E	10
5	N 7 E	14
6	N 40 W	9
7	N 63 W	6
8	N 46 W	14
9	N 30 1/2 W	28
10	N 31 W	26
11	N 7 W	50
12	N 46 1/2 W	30
13	N 19 W	26
14	N 35 1/2 W	10
15	N 13 1/2 W	13
16	N 32 W	34
17	N 39 W	20
1	N 20 1/2 W	15
2	N 32 W	24
3	N 55 W	18
4	N 65 W	18
5	N 73 W	26
6	N 60 W	9
7	N 5 E	31
8	N 9 1/2 E	12
9	N 11 W	9
10	N 12 1/2 E	7
11	N 22 E	10
12	N 29 1/2 E	10
13	N 27 1/2 W	12
14	N 4 E	11
15	N 18 W	8

11^{1/2} mile

10^{1/2} mile

9^{1/2} mile

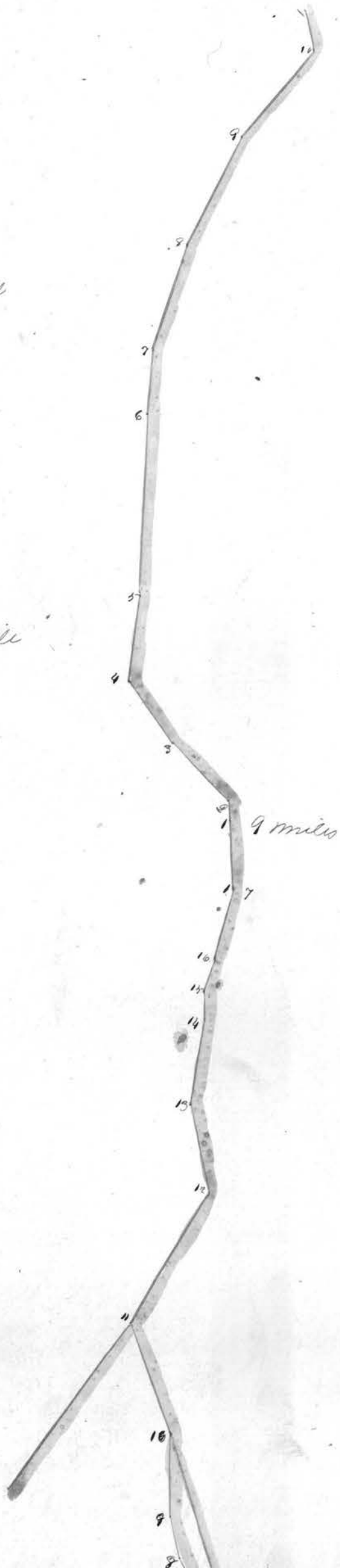

14 U 2 8 10.
 15 U 18 AM 8.
 16 U 9 AM 10
 17 U 10 1/2 AM 8.
 18 U 19 1/2 AM 6.
 19 U 4 1/2 E 15-
 20 U 24 E 7.
 21 U 20 E 7.
 22 U 35 E 7
 23 U 12 AM 7
 24 U 29 AM 6.
 25 U 39 AM 6
 26 U 9 E 9
 27 U 16 E 10.
 1 U 61 AM 31
 2. S 89 AM 33 1/2

3 U 18 AM 28
 4 U 8 E 10.
 5 U 5 AM 11 1/2
 6 U 25 E 6
 7 U 42 E 8.
 8 U 62 AM 6.
 9 U 58 AM 6
 10 U 8 E 5-
 11 U 23 E 4
 12 S 80 AM 4
 13 S 91 AM 14
 14 S 80 AM 8.
 15 U 89 AM 8.
 16 U 80 AM 8.
 17 U 84 AM 6.
 18 U 79 AM 13
 19 Crest 9
 20 U 17 AM 12.
 21 U 20 1/2 AM 6
 22 U 35 AM 6.
 23 U 35 AM 6
 24 U 53 AM 7
 25 U 63 AM 14
 26 S 65 AM 7
 27 U 5 E 8.

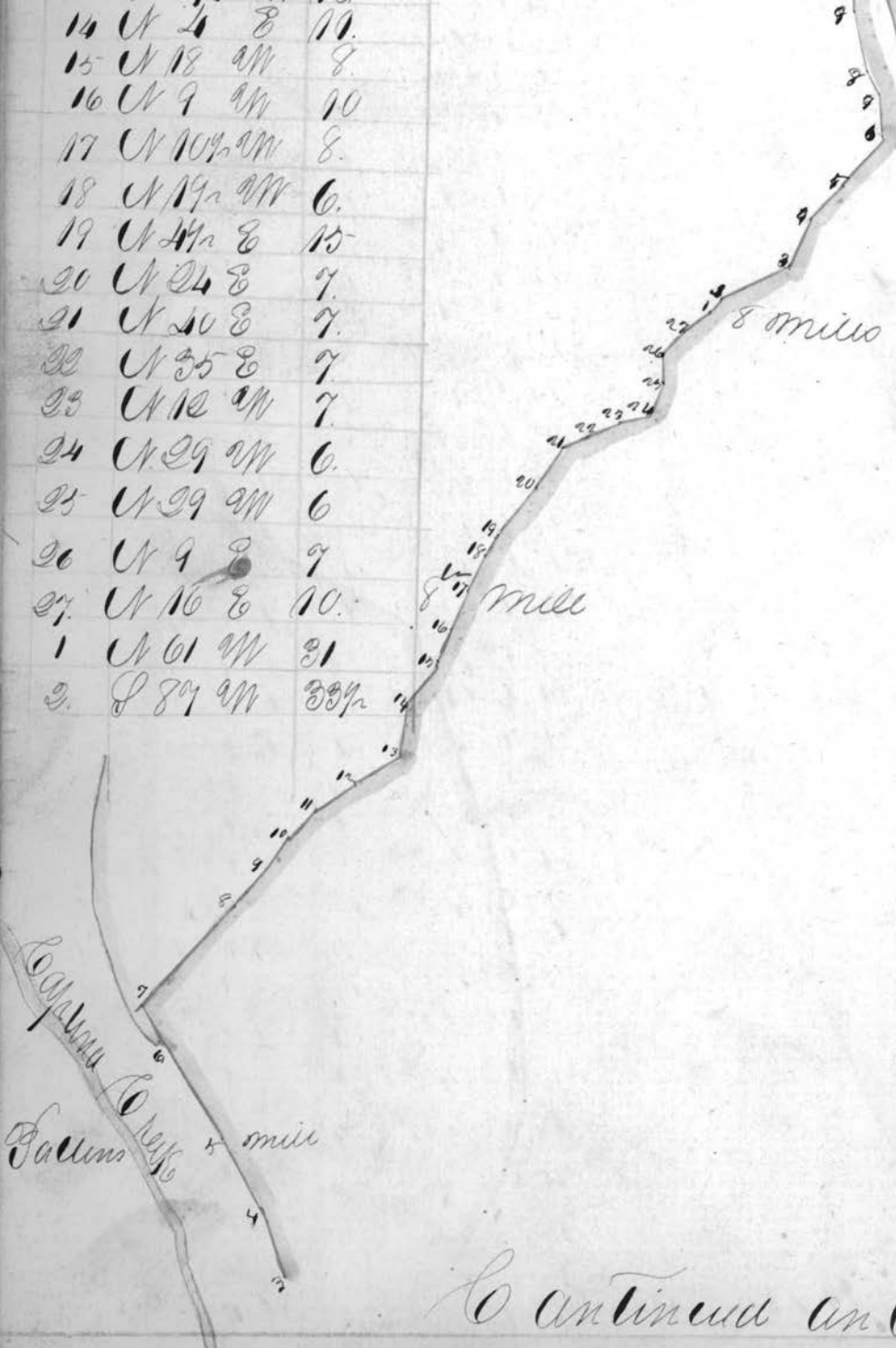

Continued on Page 365

Continued from page 364

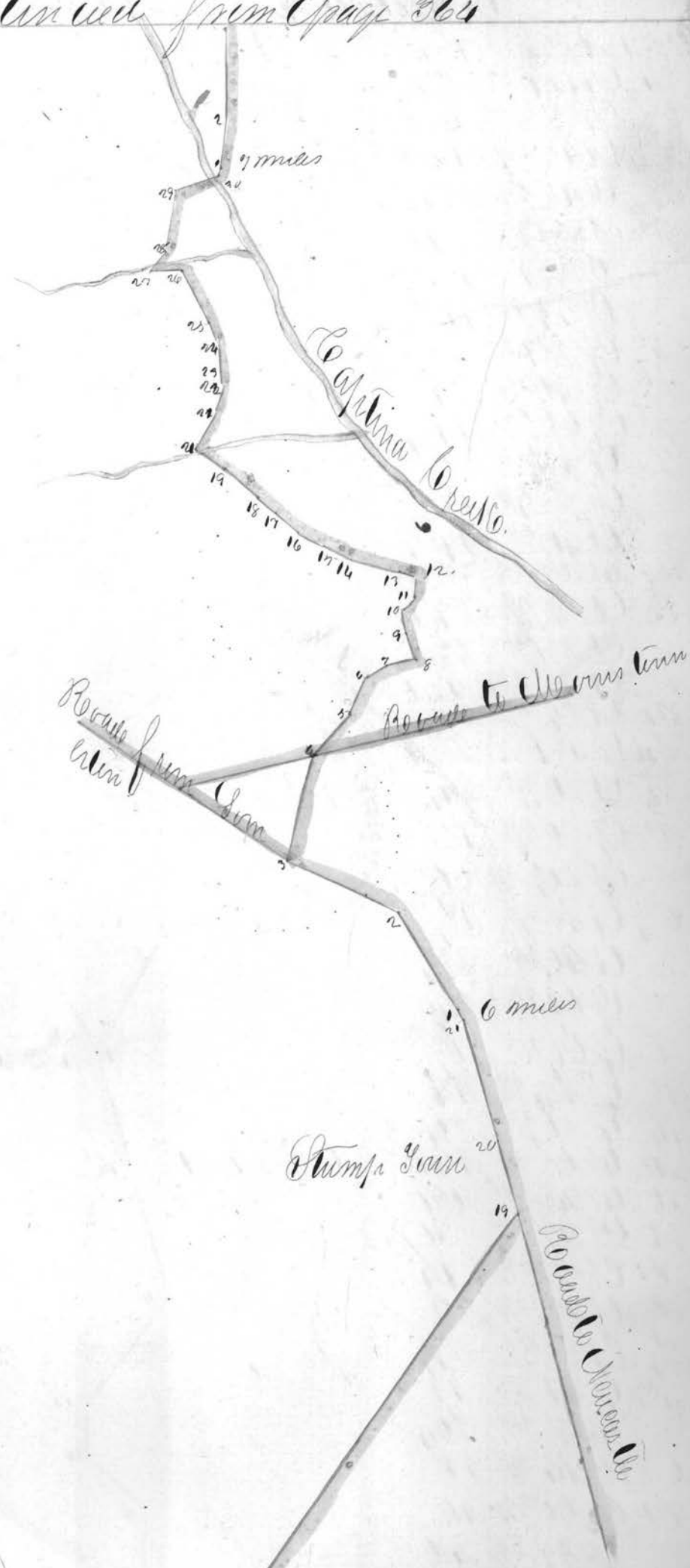

Wm Gregg Gammell

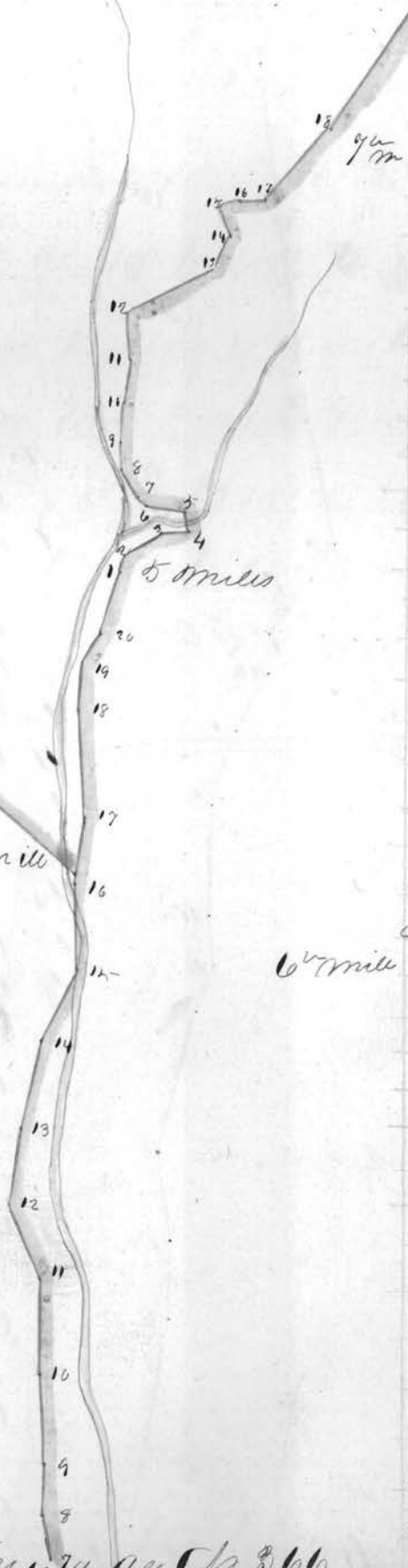

Continued on p 366

28	N 31 W	10.	15	N 30 W	20.
29	N 82 E	10	16	N 15 W	14
30	N 80 W	1.	17	N 33 W	28.
1	N 10 W	5	18	N 30 W	13
2	N 29 E	9	19	N 5 E	7
3	N 50 E	6	20	N 10 W	15.5
4	N 88 W	3.	1	N 70 W	26.
5	S 69 W	8.	2	S 66 W	16.
6	N 86 W	5	3	S 25 W	11
7	N 53 W	6	4	S 19 W	7
8	N 57 W	6	5	S 49 W	6.
9	N 31 W	10	6	S 69 W	10.
10	N 29 W	10.	7	S 79 W	10.
11	N 30 W	10	8	S 89 W	2.
12	N 31 E	24	9	N 84 W	4
13	N 32 W	7.	10	N 72 W	2
14	N 48 W	7	11	N 48 W	4
15	N 49 E	3.	12	N 30 W	4
16	N 52 E	6	13	N 25 W	3.
17	N 13 E	23.	14	N 43 W	20
18	N 42 E	116	15	N 8 W	2.
19	N 45 W	18.	16	N 4 E	6.
20	N 47 W	36	17	N 9 W	5-
21	N 61 W	3.	18	N 30 W	6.
1	N 40 W	2	19	N 25 W	5
2	N 10 E	14	20	N 8 W	4
3	N 24 E	36	21	N 9 E	9
4	N 26 E	8.	22	N 24 E	7
5	N 4 W	10	23	N 17 E	9
6	North	9	24	N 15 E	6
7	N 23 W	10	25	N 7 E	5-
8	N 25 W	14	26	N 50 W	4
9	N 34 W	20	27	N 70 W	3 1/2
10	N 32 W	24	28	N 13 W	6
11	N 54 W	17	29	N 19 W	9
12	N 29 W	8.	30	N 61 W	7
13	N 27 W	22.	31	S 83 W	6
14	N 19 W	18.	32	N 62 W	1 3/4

33	U 22 AM	18
34	U 30 AM	8
35	U 38 AM	16
36	U 48 AM	16
37	U 40 AM	26
1	U 55 AM	1
2	U 77 AM	16
3	U 34 AM	40
4	U 44 AM	74
5	U 63 AM	14
7	U 48 AM	20
8	U 2 AM	19
9	U 31 AM	14
10	U 69 AM	38
11	U 33 AM	39
12	U 30 AM	33
13	U 76 AM	7
1	U 36 AM	35
3	U 10 AM	28
8	U 21 AM	24
4	U 20 AM	16
5	U 56 AM	50
6	U 45 AM	18
7	U 40 AM	22
8	U 62 AM	34
9	U 69 AM	10
10	U 24 AM	14
11	U 30 AM	20
13	U 65 AM	19
13	U 73 AM	25
14	U 55 AM	9
1	U 9 E	14
2	U 10 AM	9
3	U 33 AM	27
4	U 37 E	19
5	U 3 AM	20
6	U 14 E	10
7	U 30 AM	19
8	U 39 AM	28
9	U 30 AM	34
10	U 61 AM	37
11	U 47 AM	20
12	U 20 AM	20
13	U 22 AM	14
14	U 36 AM	23

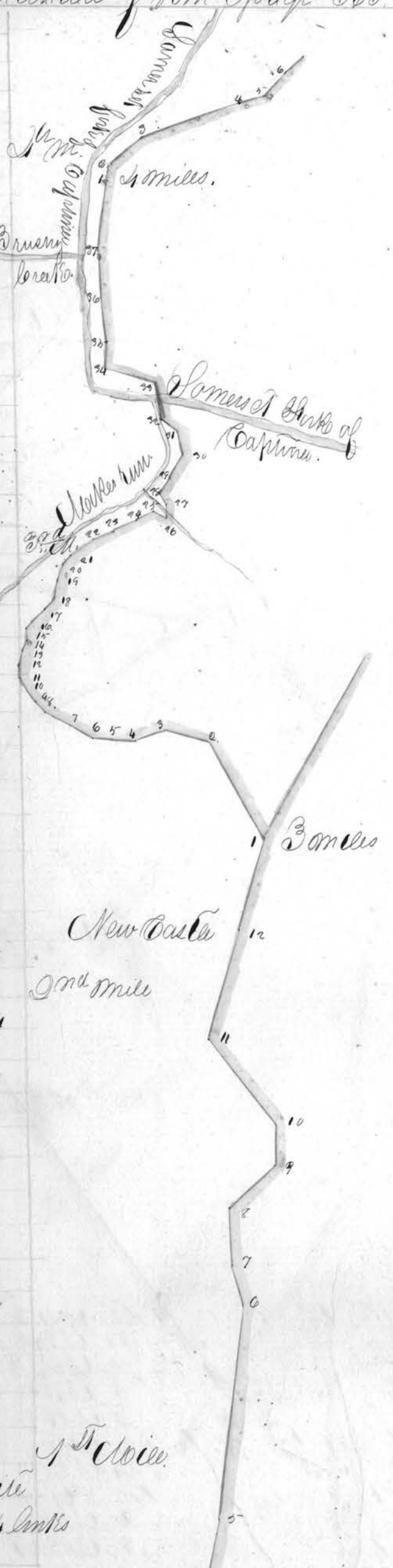

At Stone B. White
 Call on U.S. & 24 miles

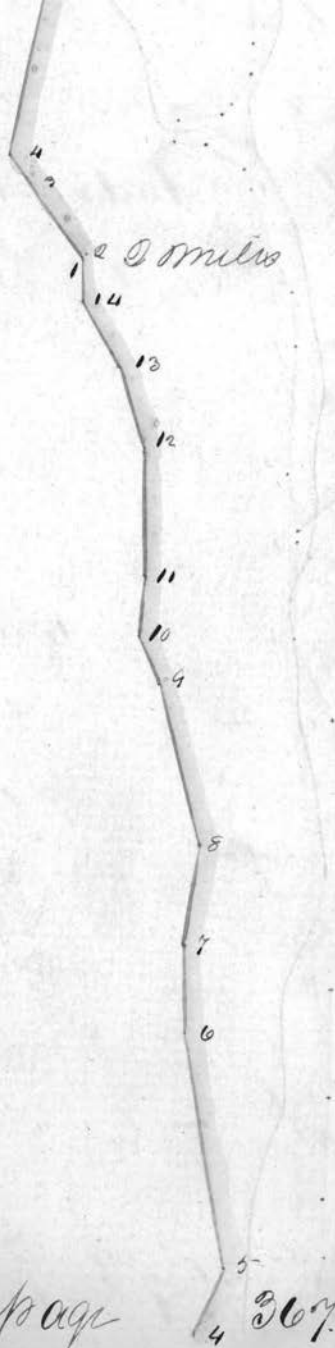

Continued on page

4 267.

Continued from Page 366.

367.

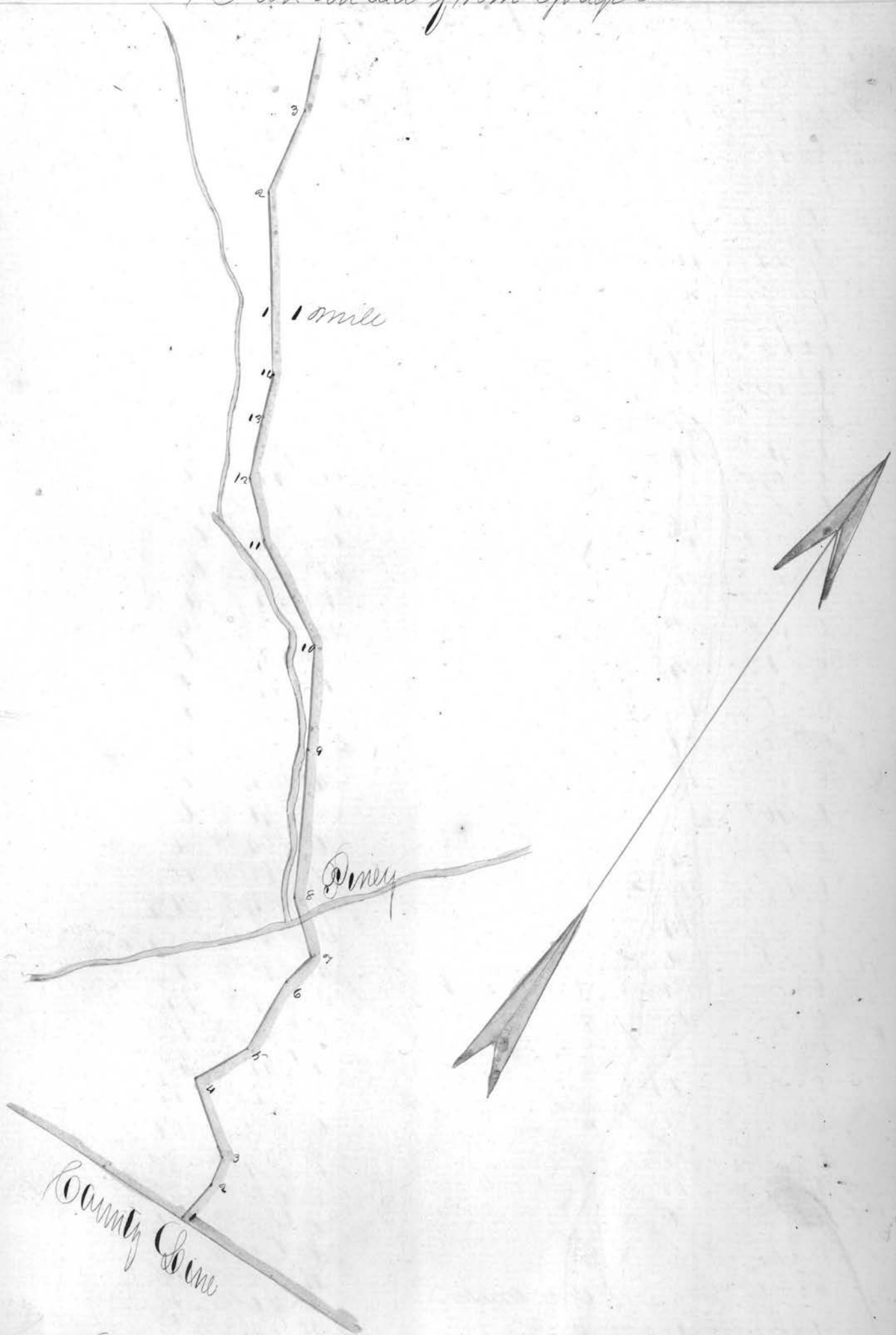

That of a County road beginning on the grade
road from Bellville to Barnesville at the mouth
of Brushy Creek thence to its forks thence to the
County line by way of a certain bridge in Isaac
Booths lane also commencing on the aforesaid
Creek on the old Federal road thence to John
Booths gate thence to the County line intersecting
the present road as surveyed by Asa Gar-
retson A.D. 1852.

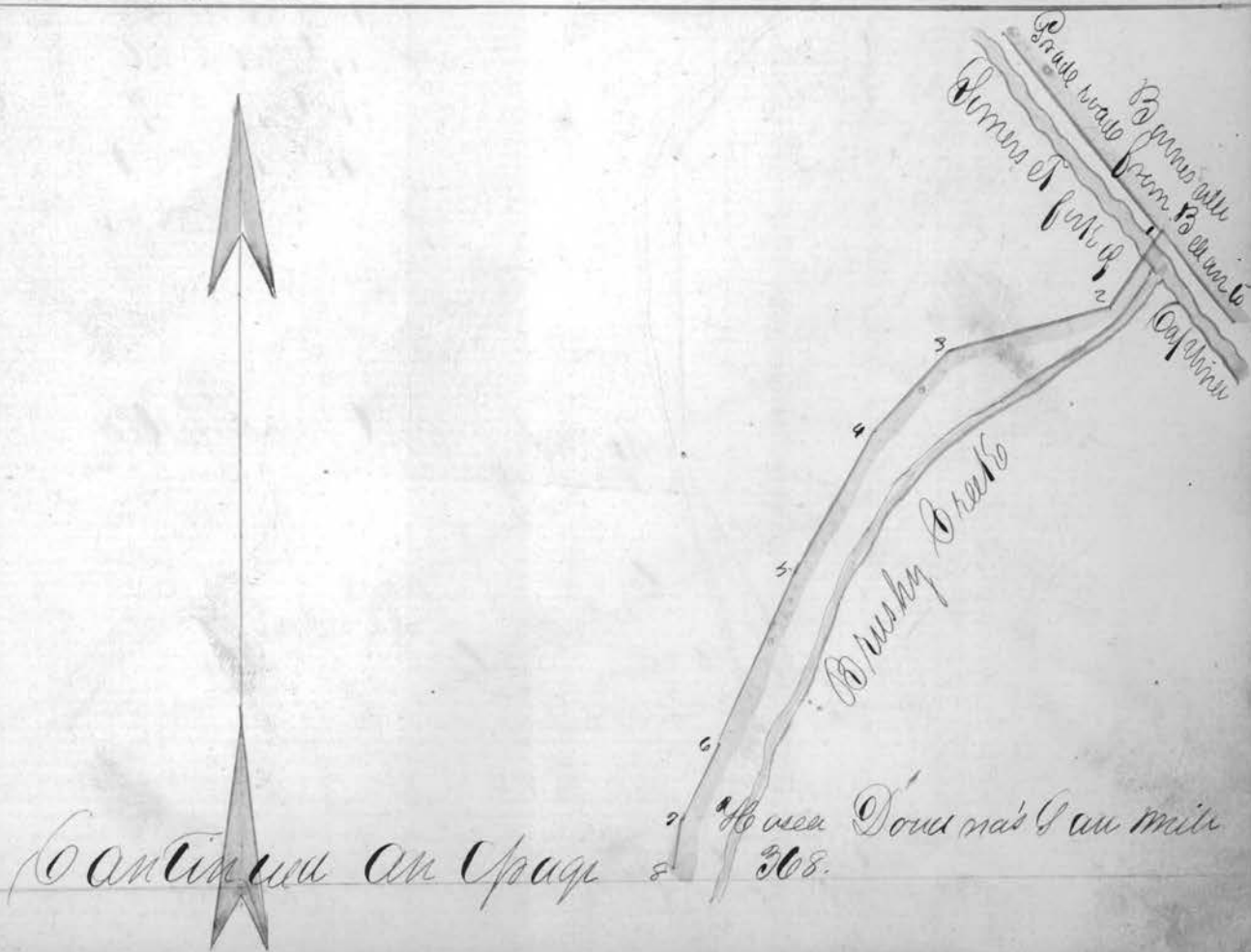

Continued from Page 367

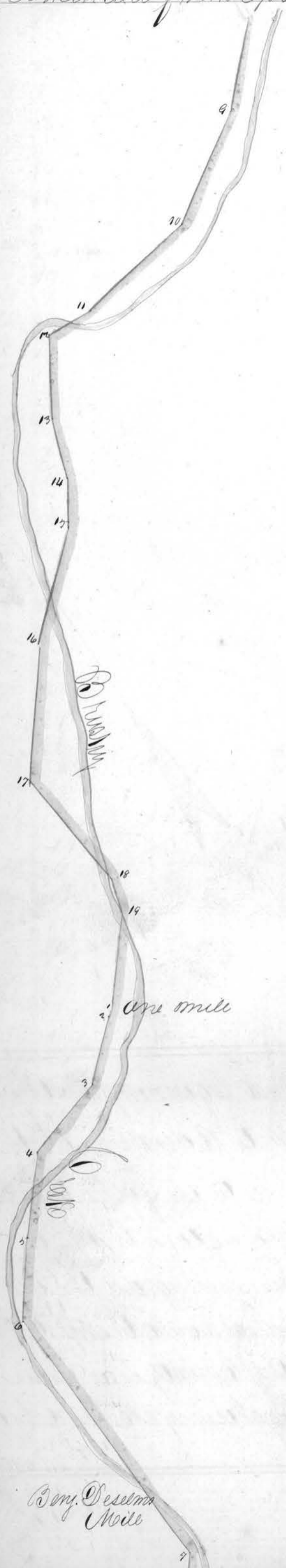

Sta.	Course	Dist
1	S 8 W	2.
2	S 18 E	15
3	S 24 E	8.
4	S 22 E	17
5	S 62 E	17
6	S 2 E	4
7	S 17 E	6.
8	S 53 E	10.
9	S 24 E	20.
10	S 34 E	15.
11	S 25 E	8.
12	S 2 W	10 1/2
13	S 45 E	6.
14	S 44 E	4
15	S 50 E	7
16	S 87 E	6.
17	S 24 E	6.
18	S 29 E	4
19	S 3 W	1 1/2
20	S 9 E	6.
21	S 19 1/2 E	6.
22	S 50 E	6.
23	S 80 E	10.
24	N 81 1/2 E	12.
25	S 41 E	6.
26	S 24 W	21.
27	S 13 W	18.
28	S 31 1/2 E	21 1/4
to the Coline 25 1/4		
1	S 12 W	1.
2	S 17 W	14.
3	S 10 1/2 W	18.
4	S 11 W	18.
5	S 7 W	17.
6	S 22 E	29
7	S 21 W	32.
8	S 30 W	30.
9	S 28 W	26.
10	S 30 W	28.
11	S 25 W	15.
12	S 6 W	12.
13	S 17 1/2 W	8.
14	S 8 W	12. 1/2 mile
1	S 26 W	10.
2	S 77 W	18.
3	S 42 W	12.
4	S 54 W	18.
5	S 25 W	20.
6	S 26 1/2 W	9.
7	S 9 W	8.
8	S 13 1/2 W	20.
9	S 28 W	25.
10	S 50 1/2 W	26.
11	S 64 1/2 W	10.
12	S 1 W	18.
13	S 8 1/2 E	10.
14	S 27 W	10.
15	S 19 1/2 W	25.
16	S 9 W	28.
17	S 24 E	26.
18	S 16 E	7.
19	S 12 W	21.

Genl. Deselmas Moile

Board from Bellisally to Farneston
Road from New-Castle
No curms
Saw-mill

Continued on Page 369

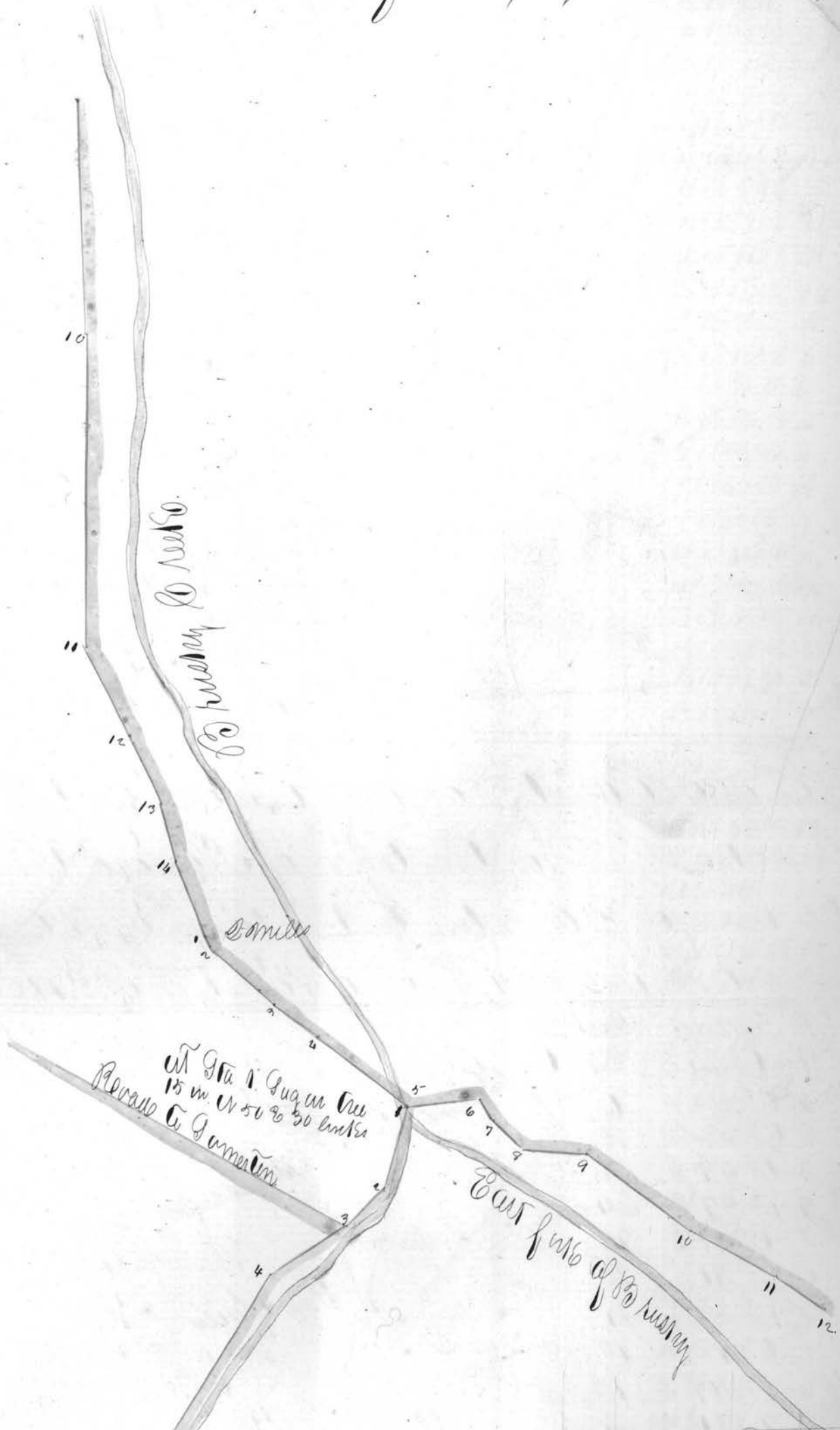

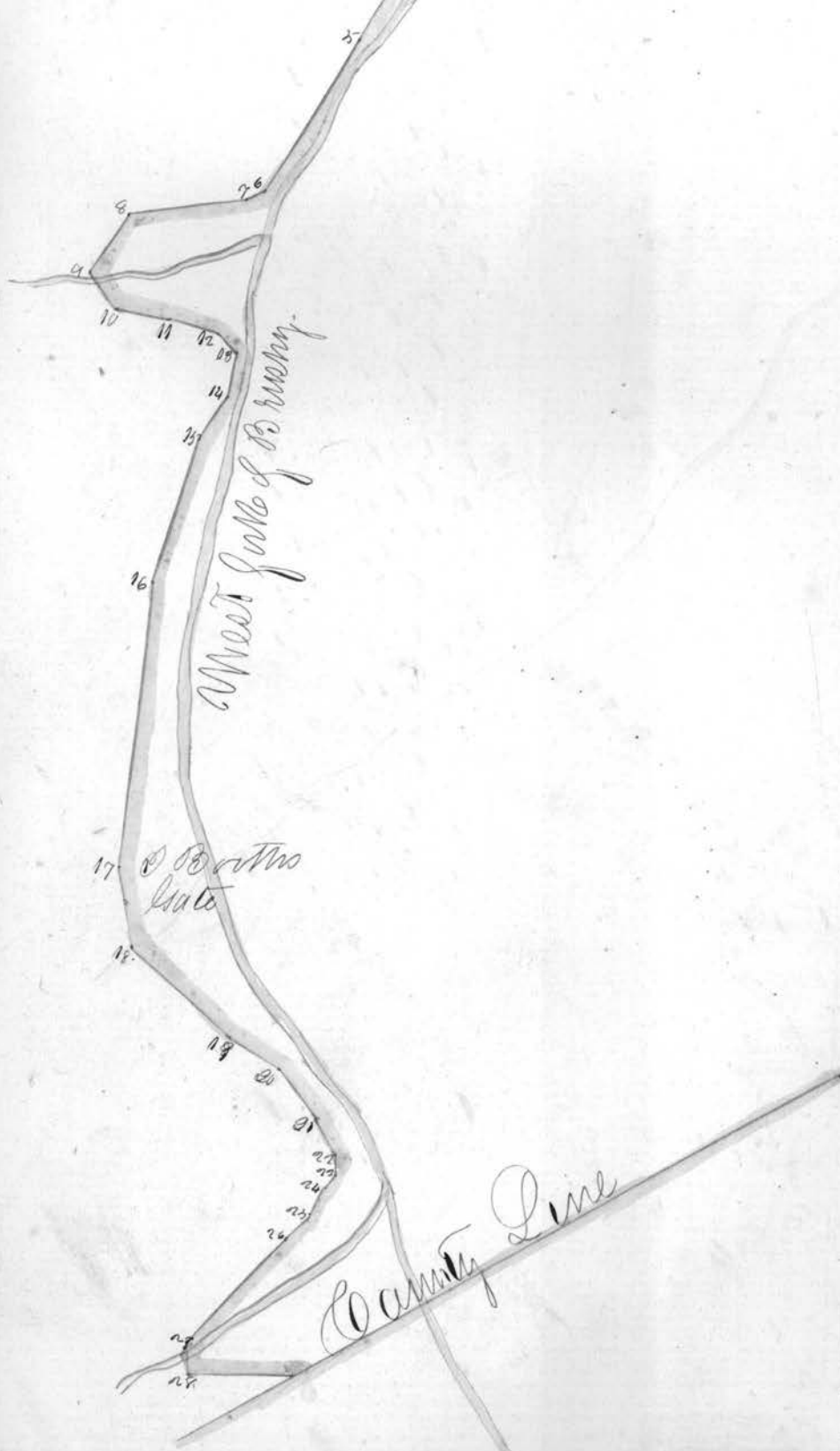

The Corns Dist

- 1 S 24 N 14
- 2 S 81 N 7
- 3 S 86 N 14
- 4 S 19 N 30.
- 5 S 62 N 22
- 6 West 9.
- 7 N 67 N 14.
- 8 S 61 N 8.
- 9 S 94 E 1/2.
- 10 S 49 E 6
- 11 S 34 E 6
- 12 S 9 E 3/4.
- 13 S 35 N 3.
- 14 S 65 N 6.
- 15 S 47 N 18.
- 16 S 36 N 34.
- 17 S 91 N 9.
- 18 S 139 E 16.
- 19 S 84 E 7.
- 20 S 8 E 8.
- 21 S 79 N 4.
- 22 S 92 N 9
- 23 S 30 1/2 N 0.
- 24 S 60 N 4.
- 25 S 85 N 3.
- 26 S 93 1/2 N 17.
- 27 S 30 N 3 1/2
28. S 49 E 10 1/4 S 81 1/4

Continued on Page 370.