

Continued from p 429

456	S 32 E	6
57	S 4 1/2 E	16
58	S 23 E	6
59	S 30 E	10
60	S 23 1/4 E	10
61	S 15 E	5
62	S 2 1/4 E	6
63	S 1 1/2 E	15
64	S 31 E	8
65	S 26 E	17
66	S 63 E	37
67	S 59 1/2 E	18
68	S 59 1/2 E	18
69	S 50 E	4
70	S 10 E	21
71	S 14 E	8
72	S 21 E	26
73	S 35 1/2 E	26
74	S 17 1/2 E	9
75	S 16 NW	18
76	S 6 1/2 E	14
77	S 22 E	23
78	S 12 E	18
79	S 6 1/2 E	14
80	S 22 E	23
81	S 40 E	8
82	S 61 E	16
83	S 73 E	36
84	S 64 E	30
85	N 53 1/2 E	12
86	N 2 E	210
87	N 63 E	17
88	N 20 E	12
89	S 84 E	16
90	S 74 E	2

post

to W B ranch

of Sunfish

down

along

the

East

Side

head of Hors  
Dams

along the  
East Side

Roller Dam  
dams

Wm Johns line

Hors mill Dam.

across Sunfish  
ascending at  
to day.

End of  
Sec. 10.



91	S 25 8	4
92	S 48 1/2 8	4
93	S 30 1/2 8	8.
94	S 48 1/2 8	6.
95	S 30 1/2 8	4
96	S 50 1/2 8	4
97	S 10 8	3.
98	S 11 8	4.
99	S 30 1/2 8	4.
100	S 38 1/2 8	9
1	S 28 1/4 8	6.
2	S 30 1/2 8	4.
3	S 40 1/2 8	3.
4	S 18 8	5.
5	S 11 1/2 8	4
6	S 1 8	4
7	S 17 1/2 8	3.
8	S 28 1/4 8	3.
9	S 44 8	9.
10	S 60 1/2 8	7.
11	S 61 1/2 8	3.
12	S 4 8	8.
13	S 17 8	5.
14	S 80 1/2 8	6.
15	S 40 1/2 8	9.
16	S 30 8	8.
17	S 50 8	18 Summit
18	S 37 1/2 8	72550 sum. 1157. 1/2 p. 1000
19	S 15 8	18. Descending
20	S 39 1/2 8	8.
21	S 37 1/2 8	14 AT 5 deg.
22	S 64 1/2 8	6.
23	S 47 8	15.
24	S 54 8	10.

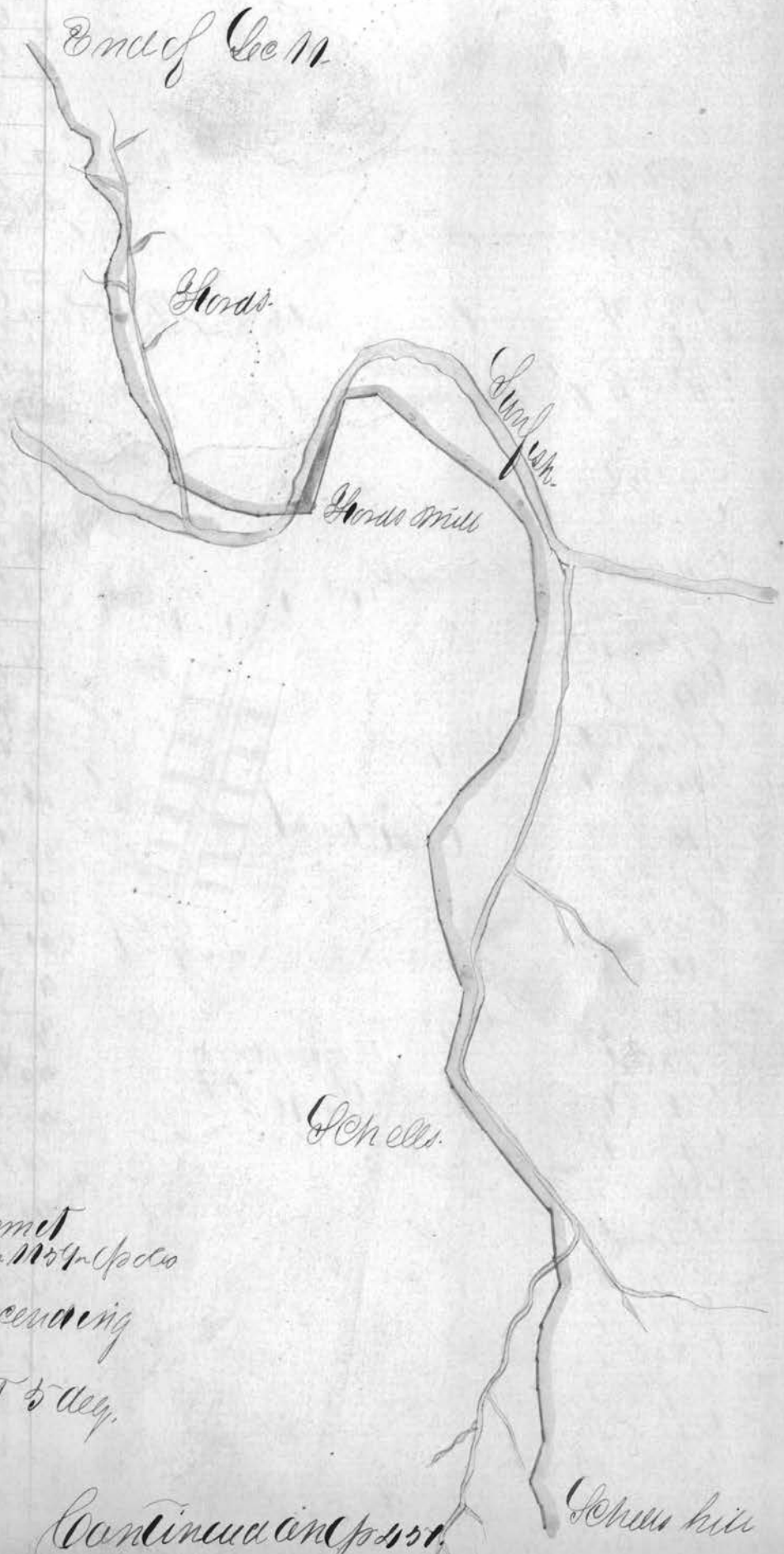

Continued in p. 101.

Continued from Page 450



25	Q 488	9	post
26	Q 514.8	10	Ac-
27	Q 514.8	8.	cen
28	Q 744.8	1905	at 15
29	Q 76	8	50.75
30	Q 994.8	10.	decy.
31	Q 604.8	9.	
32	Q 774.8	8.	At-
33	Q 798	5	cen-
34	Q 528	5	Arny
35	Q 468	6.	at
36	Q 828	4	5 decy.
37	Q 18	4	
38	Q 32.11	4	
39	Q 30	11	4.
40	Q 90	8.	
41	Q 658	8.	
42	Q 81	8	3.
43	Q 824.8	4	
44	Q 91	8	5-
45	Q 194.8	11.	
46	Q 514.8	8.	
47	Q 484.8	8.	
48	Q 294.8	4	
49	Q 84.8	4	
50	Q 104.11	2	
51	Q 414.11	10	
52	Q 21.11	56.	
53	Q 148	19.	Sum-
54	Q 24.8	10.	mit
55	Q 2	8	9.
56	Q 328	26.	
57	Q 658	24	
58	Q 714.8	27.	
559	Q 684.8	12	main
Total 486 p. in			
Arny. 166 p. in			
Woodfield			

Plot of a road beginning at Chambers  
Mill and thence up Six mile run and  
thence to a road near Gas Sentens Saw  
mill as surveyed by John Briggs A.D. 1858

---

---

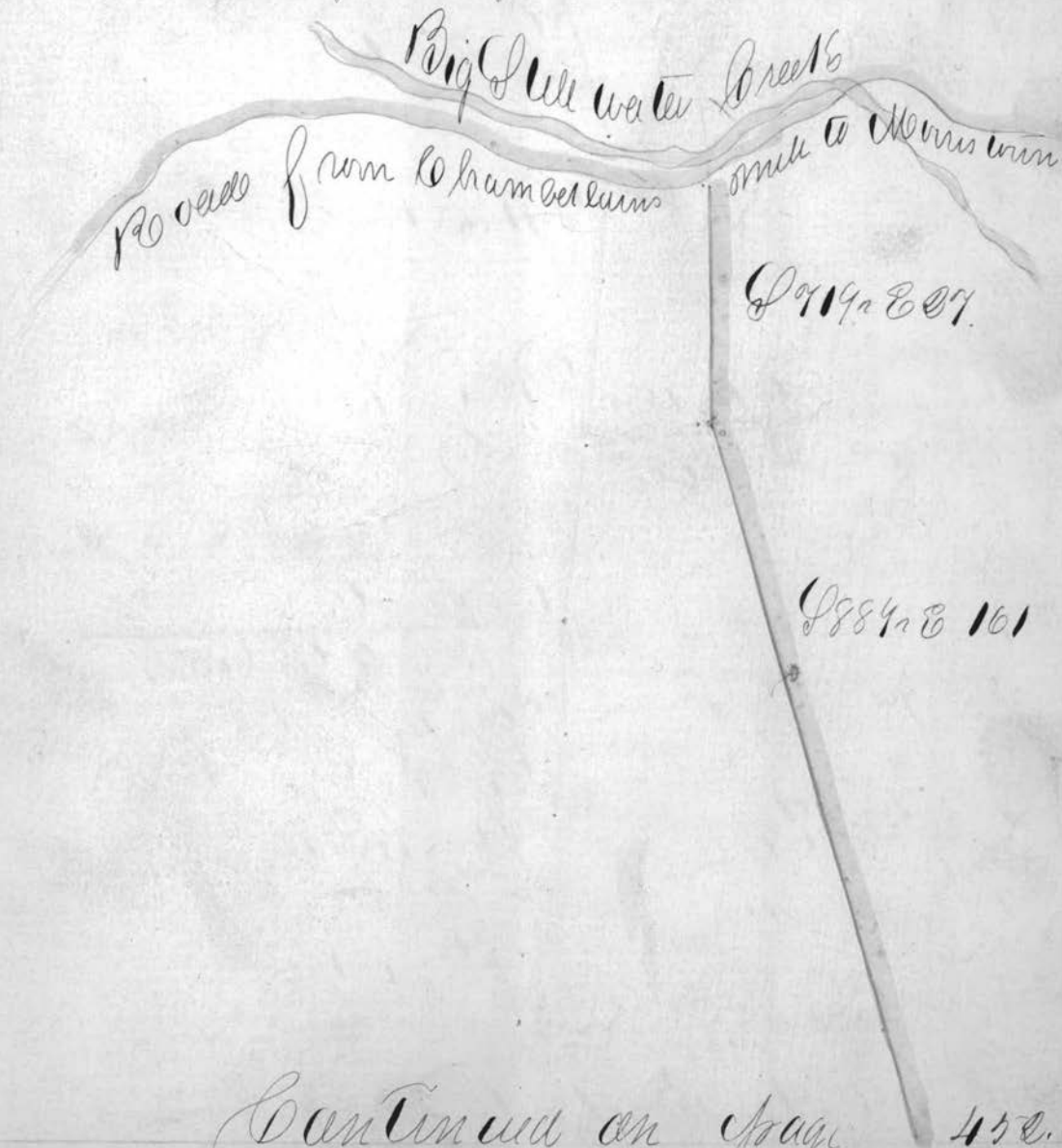

Continued on page 458.

Continued from page 451.

Same.

48 cr of  
Russell tract  
S 54 1/2 E 12

S 46 1/2 E 12

S 66 E 12

S 69 E 52

S 73 E 70

One mile

Co. roads to  
the flint being  
road an old one  
Sumps well place

S 12 E 12

S 28 1/2 E 14

Y 51 226.

Y 71 3/4 210.

Y 76 3/4 237.

Co. roads to the town  
between roads near Jas. Down-  
sherp.

to P. Duns Lane.

Co. roads to the Helms with  
road on the only Barnes Hill place.  
Y 68 212.

Y 78 89

Y 87 212

Y 54 210.

Continued on page 458.

Continued from page 453

981 E 44

957 E 19

958 1/2 E 35

976 E 16

To same Dennis East line

989 E 14

Dennis

989 1/2 E 8

944 1/2 E 15

960 1/2 E 39

969 E 36

969 1/2 E 47

Be road leading to the Husting road on

to the Ocean  
own road

of  
the  
Dennis  
road

I used in Wright's land  
9 1/2 E 11 to the end of the Dennis line on the road  
leading from the Dennis East line to the  
Husting road on land of Gov.  
Wright

That of a County road beginning at Houma  
McCaughy's Saw mill running thence to the  
County road on lands of Mr. Irwin as  
Surveyed by Charles Dehas A.D. 1851.



Continued on page 454.



## Continued from Page 353

No	Course	Dist	Chem
1	N 11 W	14	Upcast
2	N 34 W	10, 33	"
3	N 49 W	22	Copper
4	N 30 1/2 W	17, 66	Sugar
5	N 43 1/2 W	8, 33	Beach
6	N 9 W	10	Upcast
7	N 17 1/2 W	2, 50	Sugar
8	N 17 1/2 W	28	"
9	N 24 W	13	Quinn
10	N 60 W	17, 50	Upcast
11	N 45 W	11, 50	Foot of run.
12	N 79 1/2 W	22, 50	Ash tree.
13	N 74 W	23, 50	Beach
14	West	33	Upcast
15	N 63 W	22, 50	"
16	N 40 W	11	B. Walnut.
17	N 77 W	31	Upcast
18	N 45 1/2 W	18	Upcast
19	N 60 W	11, 50	"
20	N 27 W	14	Upcast.

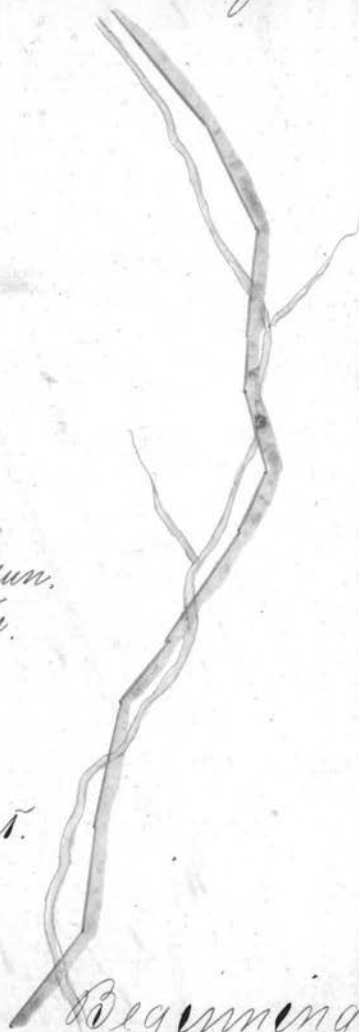

Beginning

to Course Dist Chain.

- 1 S 76° E 28.
- 2 S 59° E 33.
- 3 S 74° E 10.
- 4 East 10
- 5 S 69° E 15.
- 6 S 55° E 13.50
- 7 S 45° E 20.

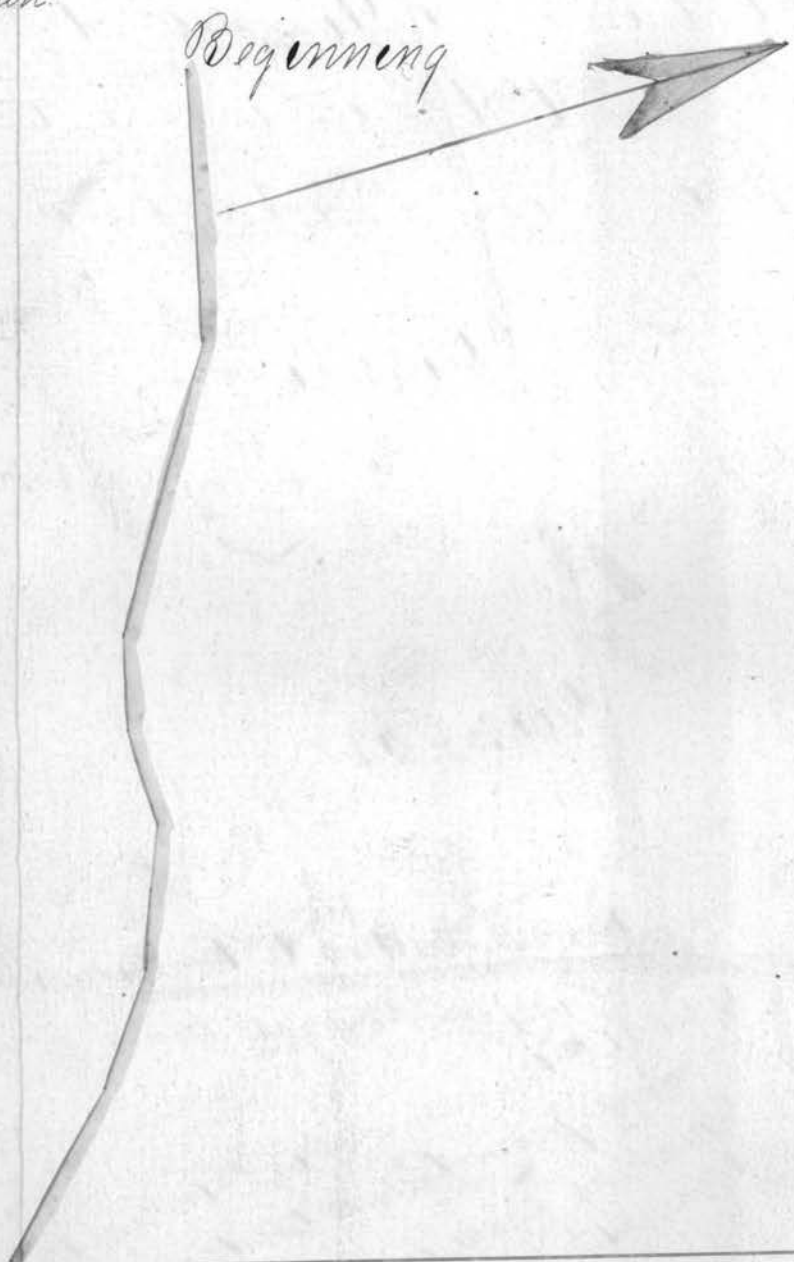

That of an alteration on the road from to Blushing beginning at Stake marked A and ending at a Stake on old road as surveyed by James Kemmer A.D., 1852

- to Course Dist
- 1 N 59° E 8.
- 2 N 55° E 40
- 3 N 24° E 20
- 4 N 25° E 20
- 5 N 30° E 12.92
- 6 N 1° E 18.72
- 7 N 26° W 10.
- 8 N 57° E 4
- 9 N 33° E 4.76

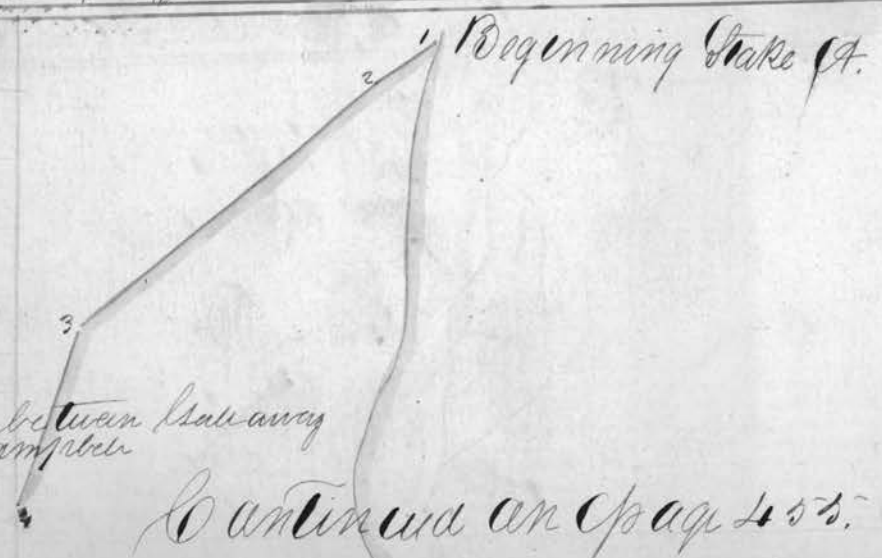

Continued on page 455.

Continued from page 454

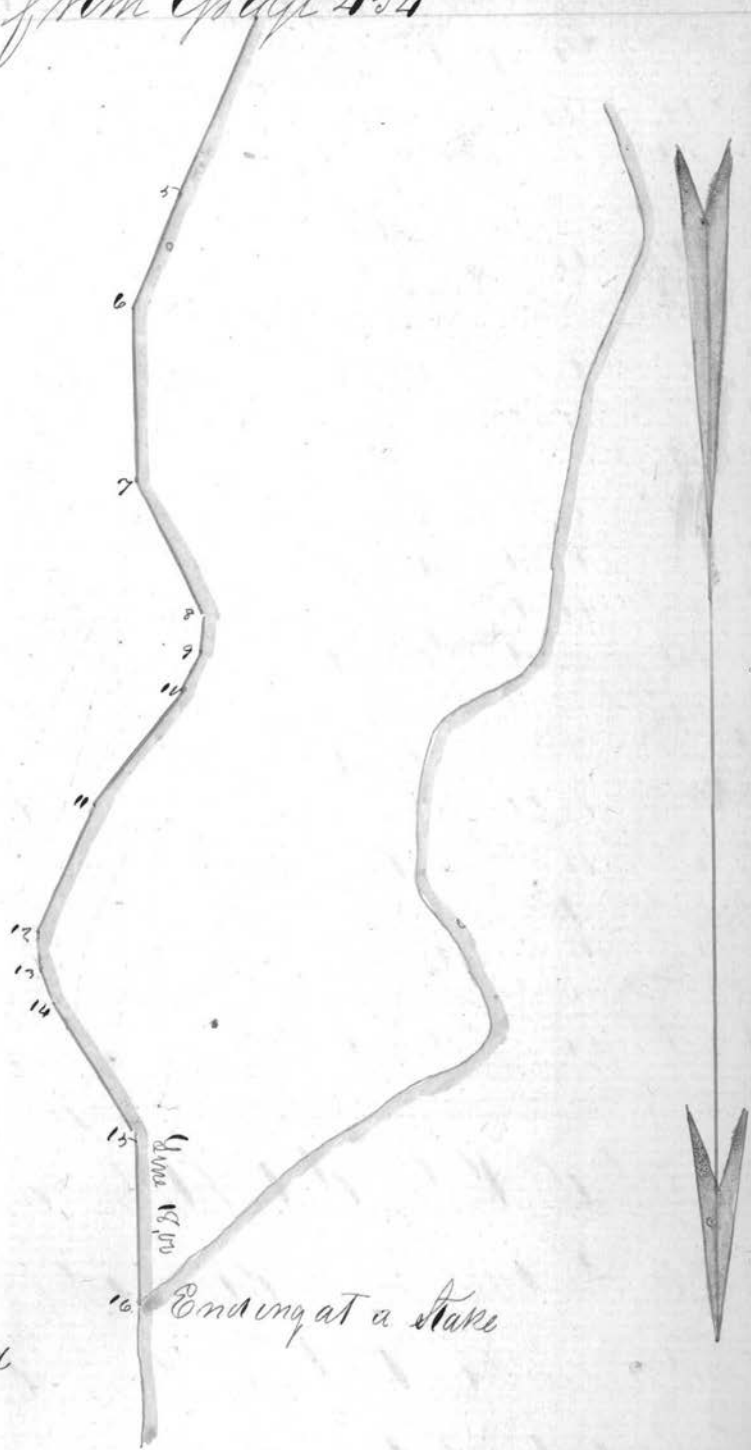

- 10 N 47 3/4 W 126.
- 11 N 20 3/4 W 14
- 12 N 4 1/4 W 204
- 13 N 20 1/4 W 808
- 14 N 31 1/4 W 10.
- 15 N 1 1/4 W 18. Cent of old road line

Ending at a Stake

Part of a part of the County road from  
 Bridgeport to the Mouth of McWhaters  
 Creek as Surveyed by Charles Dehass 1850.

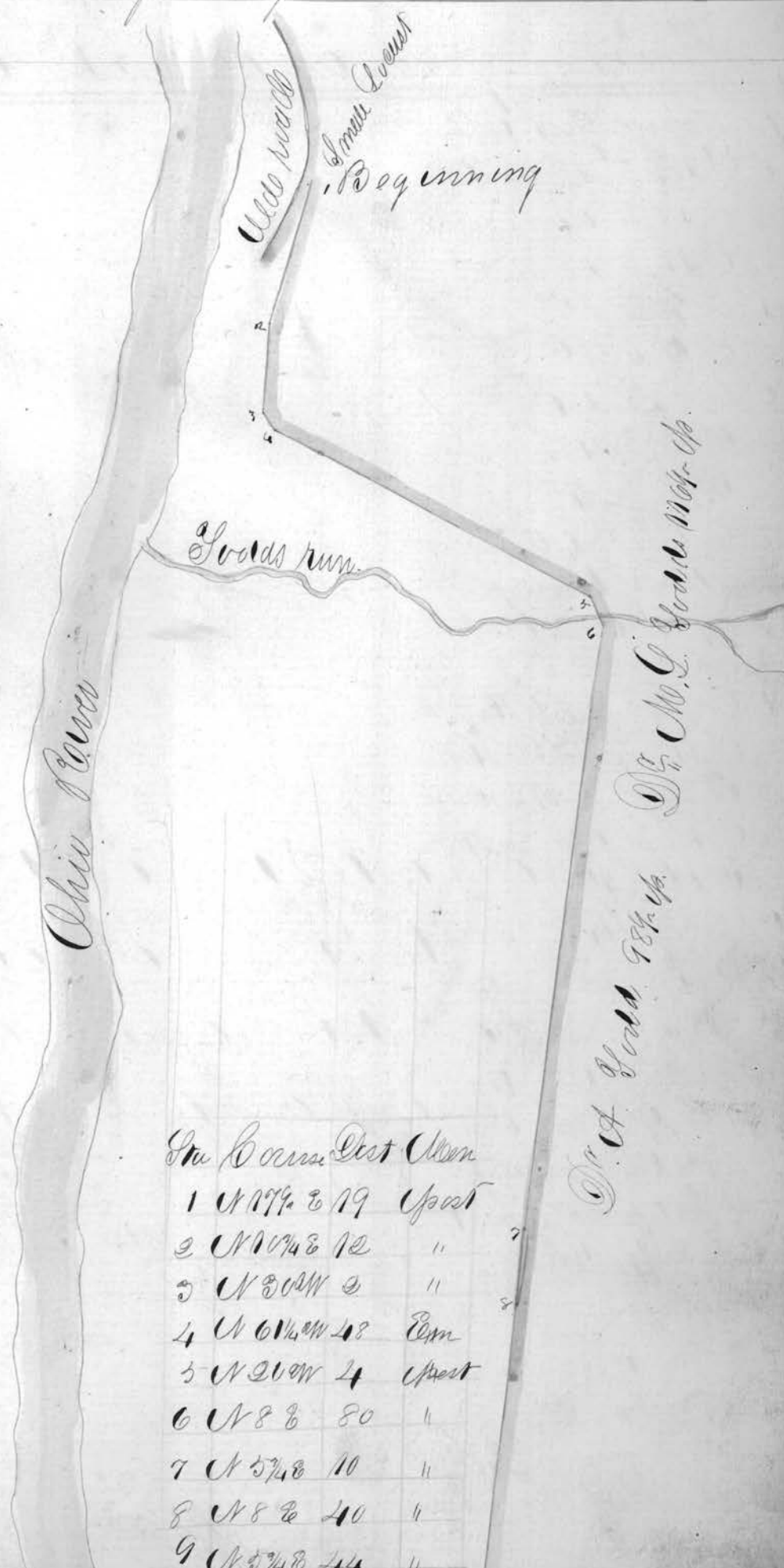

Sta	Course	Dist	Remark
1	N 77 1/2 E	19	Up post
2	N 10 1/4 E	12	"
3	N 30 1/2 W	2	"
4	N 61 1/2 W	48	Exam
5	N 20 W	4	Up post
6	N 8 1/2	80	"
7	N 5 1/4 E	10	"
8	N 8 1/2	40	"
9	N 5 1/4 E	44	"
10	N 2 1/2 E	40	down Secur
Total		308	

Continued on

Page 150

Continued from Page 450

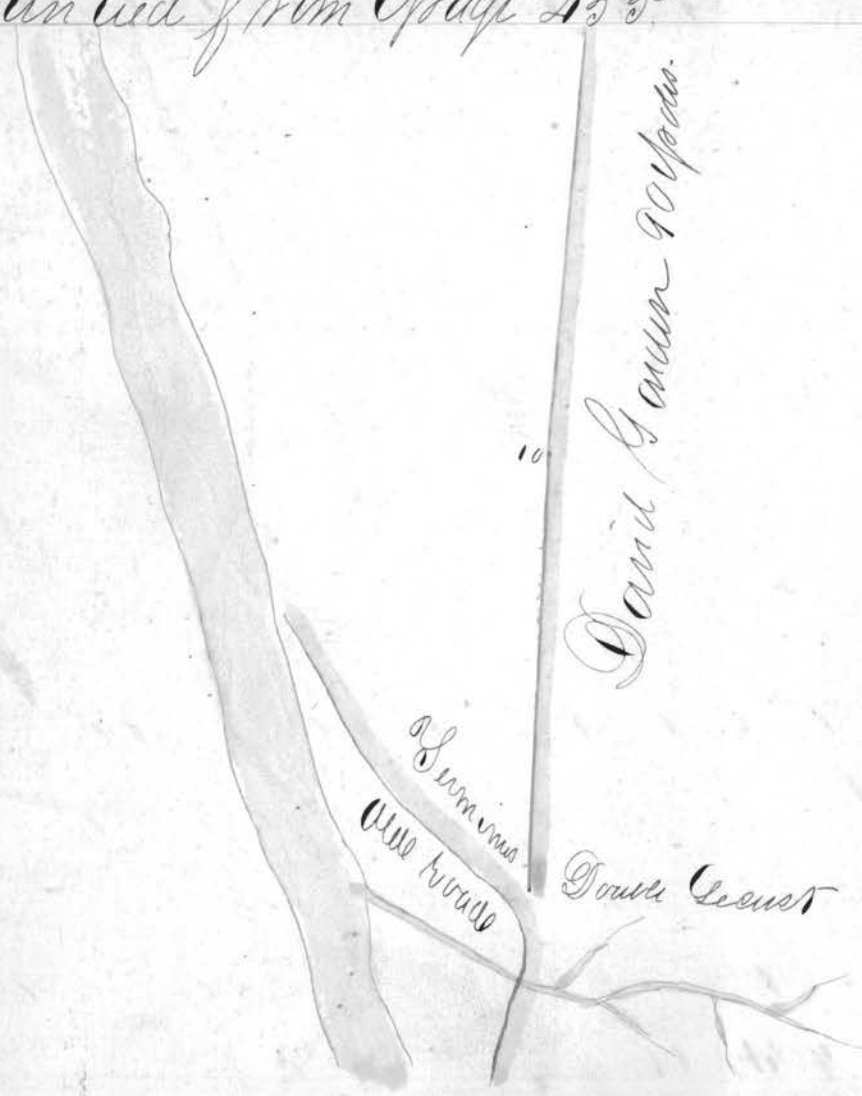

That of two alterations on the road mentioned  
 will to warrun beginning for the first near  
 Phoburng & Thomson line and ends at the  
 junction of the Deep run road with the  
 river road. beginning for the second at the  
 western corner of the bridge over Deep run and  
 ending at the line between the Counties of  
 Belmont & Jefferson as surveyed by A. Dehart 1850

Continued from Page 456



That of a County road beginning on the  
 Steiner's road near a School house west of  
 Northampton and ending at the Belmont of Monroe  
 County line on lands of John York as Surveyed  
 by Charles Dehass A.D. 1852

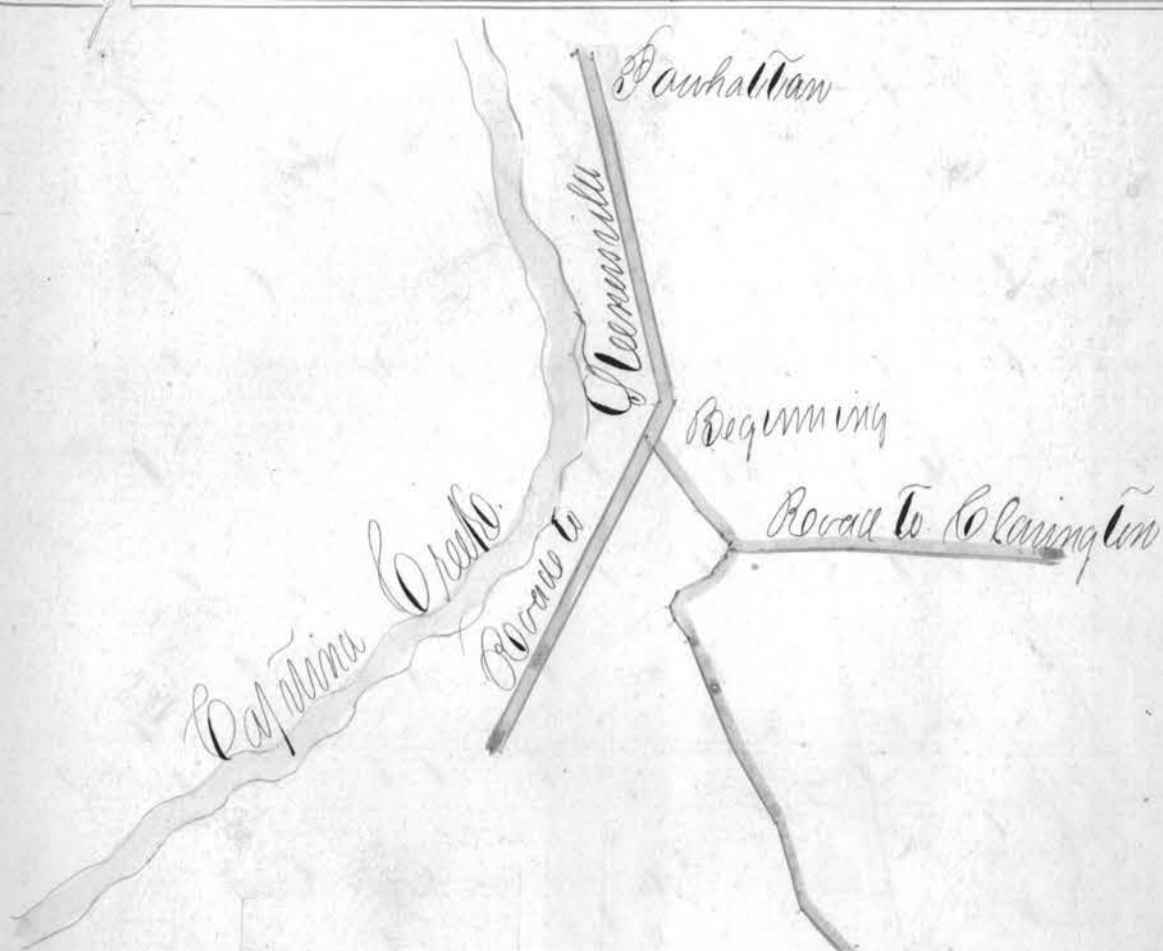

No	Course	Dist	Use.
1	S 50 W	86.	Spots
2	S 82 1/2 W	70.	
3	S 55 W	0.	
4	S 72 1/2 W	0.	
5	N 80 W	6.	
6	N 43 1/2 W	12.	
7	N 60 W	0.	
8	West	0.	
9	S 27 W	8.	
10	S 63 1/2 W	82.	
11	S 57 1/2 W	27.	
12	S 67 W	20.	
13	S 43 1/2 W	18.	
14	S 21 1/2 W	30.	
15	S 30 W	20.	
16	S 29 W	30.	
17	S 65 W	0.	
18	N 73 W	12.	
19	S 27 W	14.	
20	S 31 W	20.	
21	S 17 W	20.	
22	S 21 W	10.	
23	N 76 W	18.	
24	S 79 W	20.	
25	N 76 W	85.	
26	S 78 1/2 W	20.	
27	S 20 W	20.	
28	S 30 W	10.	
29	S 27 W	10.	
30	S 82 1/2 W	88.	
31	N 70 W	18.	
32	N 88 1/2 W	24.	
33	West	20.	
34	N 70 W	80.	
35	S 77 1/2 W	24.	
36	S 60 W	10.	
37	S 85 W	84.	
38	S 77 1/2 W	12.	
39	S 73 1/2 W	20.	
40	S 60 1/2 W	20.	

792 sp. 2 on 152 sp. 100

That of an alteration on the graded road from Bellville to Barnesville beginning at the section line between Joseph Shumbery and Robert Adair and from thence intersecting the grade on the lands of Mathew Booth as surveyed by Asa Garretson A.D. 1850.

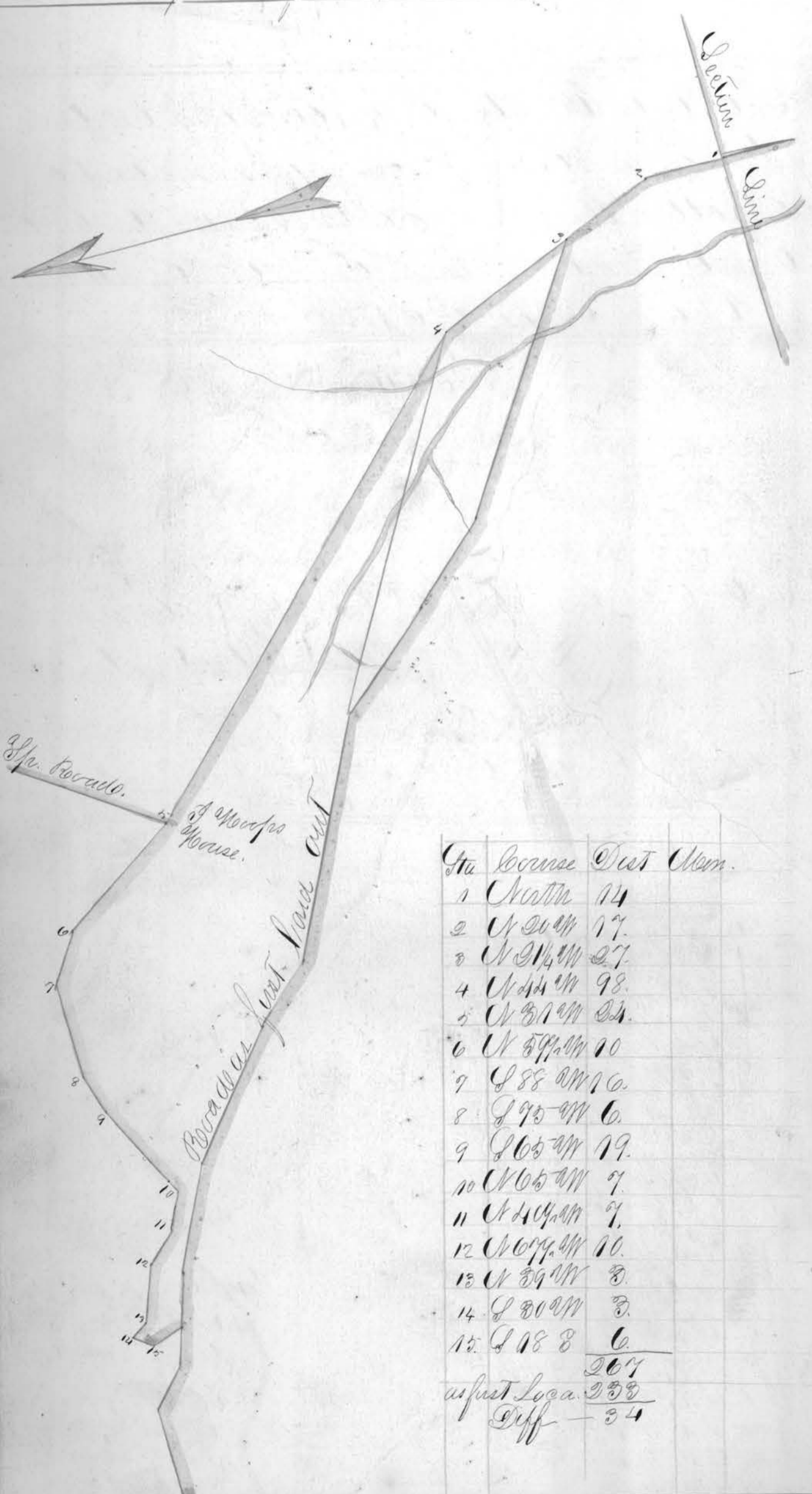

Sta	Course	Dist	Mem.
1	N 20° W	14	
2	N 20° W	17	
3	N 21 1/4° W	27	
4	N 24° W	98	
5	N 31° W	24	
6	N 59 1/2° W	10	
7	S 88° W	16	
8	S 95° W	6	
9	S 65° W	19	
10	N 65° W	9	
11	N 44° W	9	
12	N 67 1/2° W	10	
13	N 39° W	8	
14	S 80° W	8	
15	S 18° E	6	
		267	
as per Loca.		238	
Diff		34	



That of an alteration on the Welbinger mill  
road on lands of Cephas West Smith  
Township as surveyed by Chas Dehus 1850.

State road to Dillies Bottom.

beginning

East 40 poles

John Wilson

Chas. Hoiney

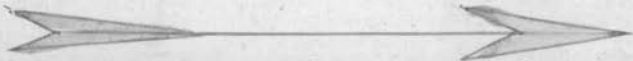

Continued on page 159.

Continued from page 458

359 ~~459~~



N 68 1/2 E 38.

Sermenus

of the old road

Map of a County road beginning near  
 Andersens Mill and runs thence to the  
 Harview and Barnsville road on lands of  
 Aquilla Conger as surveyed by C. Dehass 1852

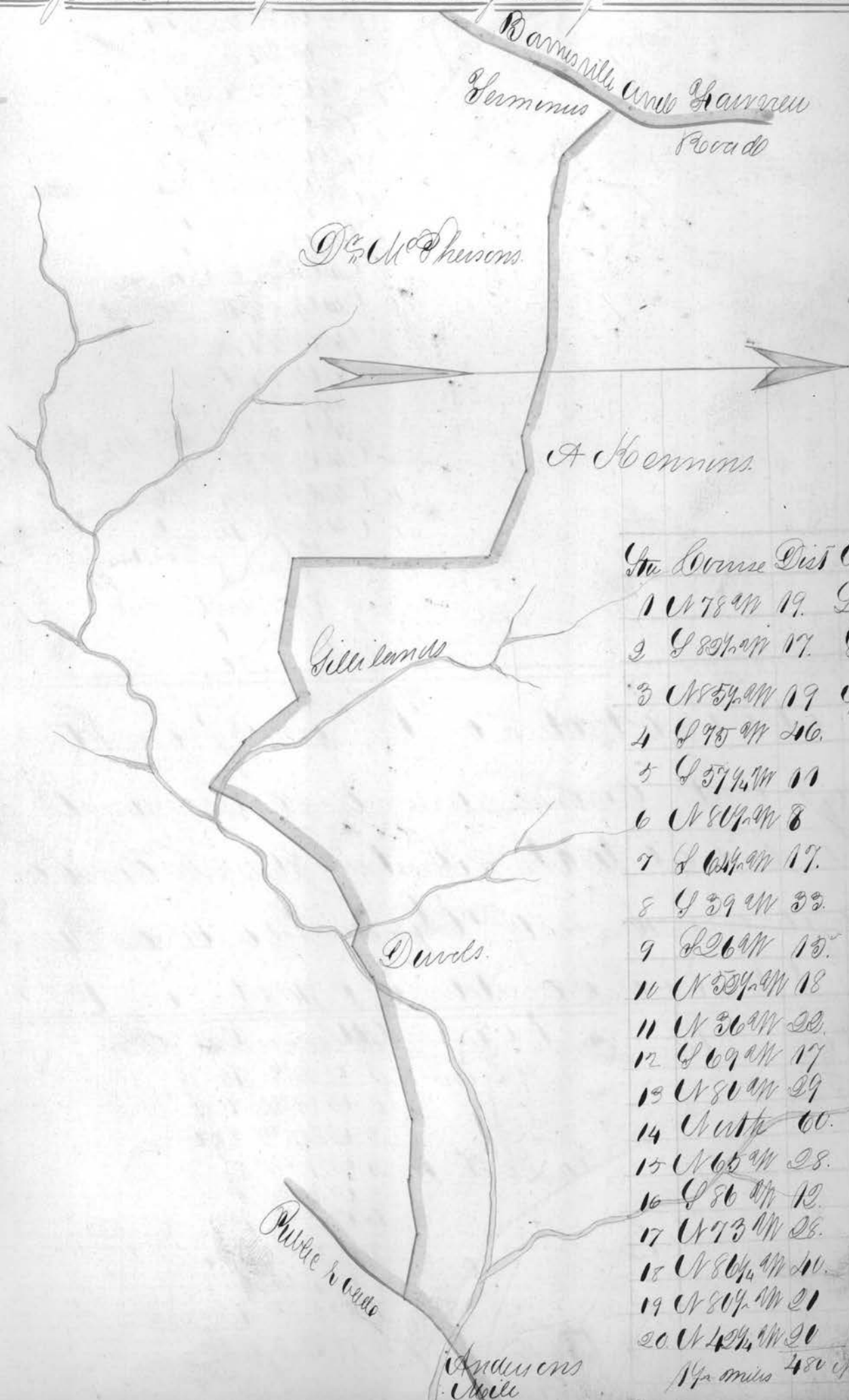

No	Course	Dist	Ulen
1	N 78° W	19	Ginn
2	S 89° W	17	Sugar
3	N 85° W	19	Spence
4	S 95° W	26	
5	S 57° W	11	
6	N 80° W	8	
7	S 64° W	17	
8	S 39° W	32	
9	S 26° W	15	
10	N 53° W	18	
11	N 36° W	20	
12	S 69° W	17	
13	N 80° W	29	
14	Cont'd	60	
15	N 65° W	28	
16	S 86° W	12	
17	N 73° W	28	
18	N 86° W	10	
19	N 80° W	21	
20	N 42° W	20	

1 1/2 miles 180 Acres