

53
 Plat of a County road beginning at the
 Glens run and running thence to the Pa-
 tiz road near No. Bridges as surveyed
 by Charles Dehass A.D. 1849.

Stk	Course	Dist	Ucen.
1	S 2 E	7	Posts
2	S 7 1/2 W	23	
3	S 32 1/2 E	7	
4	S 1 E	10	
5	S 10 1/2 W	20	
6	S 21 1/2 E	14	
7	S 10 1/2 E	21	
8	S 8 E	38	
9	S 18 W	9	
10	S 55 W	26	
11	N 86 W	7	
12	S 80 W	12	
13	S 55 W	16	
14	N 88 W	11	
15	N 88 1/2 W	32	
16	N 72 1/2 W	36	
17	S 83 1/2 W	26	
18	N 82 1/2 W	8	
19	N 62 W	17	
20	N 28 W	10 50	
21	N 61 W	12	
22	N 77 1/2 W	28	
23	N 76 1/2 W	9	
24	S 58 1/2 W	12	
25	S 72 1/2 W	12	Beach.
26	S 73 1/2 W	9 50	"
27	S 80 1/2 W	38	W. Walnut.
28	S 65 W	18	Post.
29	S 52 1/2 W	32	" 3/4 miles

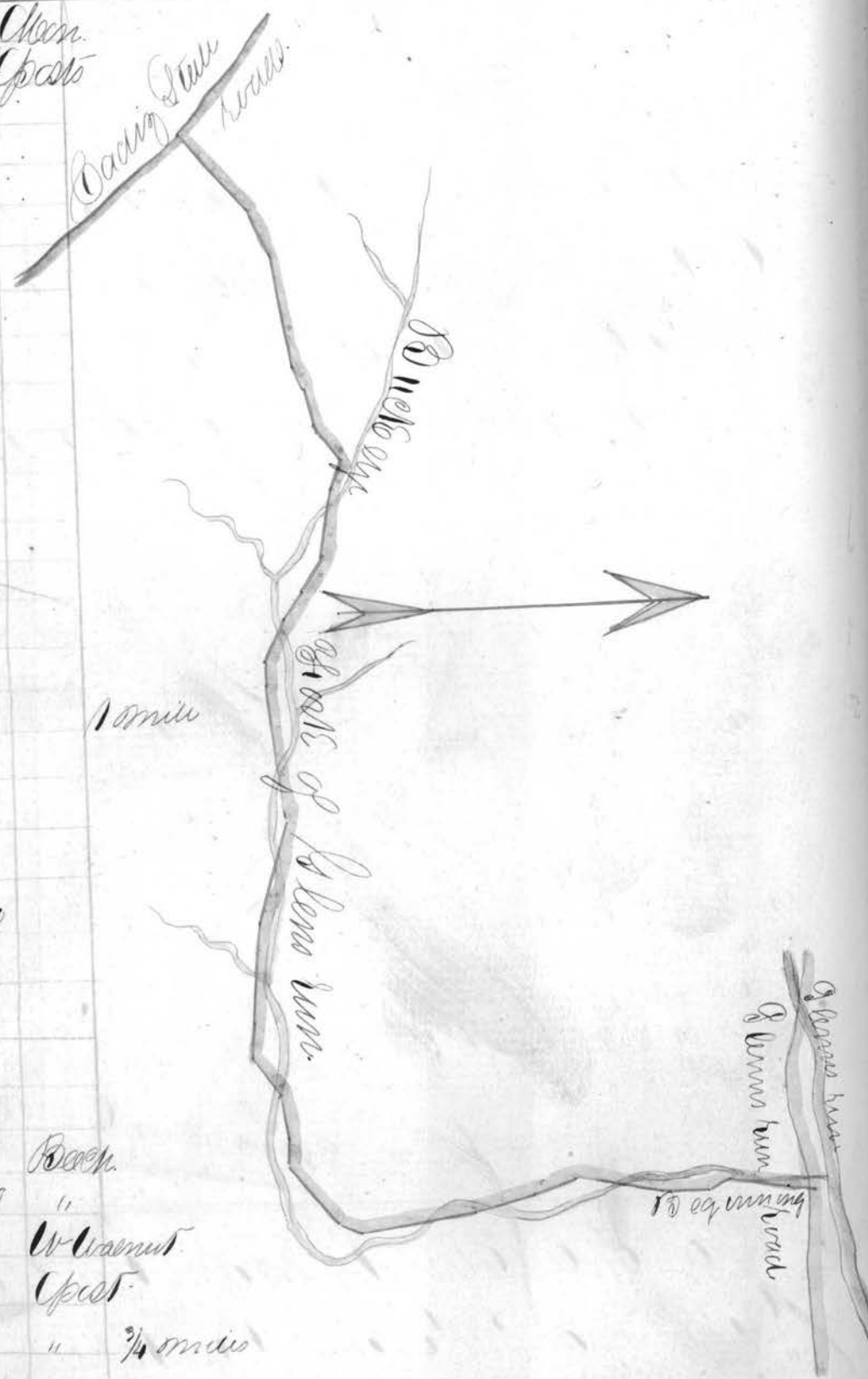

Plat of a County beginning at the State
 road near Isaac Lays and running
 thence to the Warren road on Bailey's Land
 as surveyed by Charles Dehass A.D. 1849

Plat of a County beginning at the State
road near Isaac Lays and running
thence to the Mountains on Bailey Land
as Surveyed by Charles Dehas A.D. 1849

No.	Course	Dist	Mon.
1	S 15° E	6	Post
2	S 88° E	9	
3	S 50° E	12.50	Sugar
4	S 210° E	15.50	"
5	S 56° E	10.50	Post
6	S 71° E	21	Beach
7	S 74° E	11	Post Isaac Lays field
8	S 71° E	10	
9	S 77° E	11	
10	S 115° E	16	Beach & Lays field
11	S 91° E	12.50	Locust
12	S 38° E	20	Post
13	S 30° W	9	Locust corner at terminus

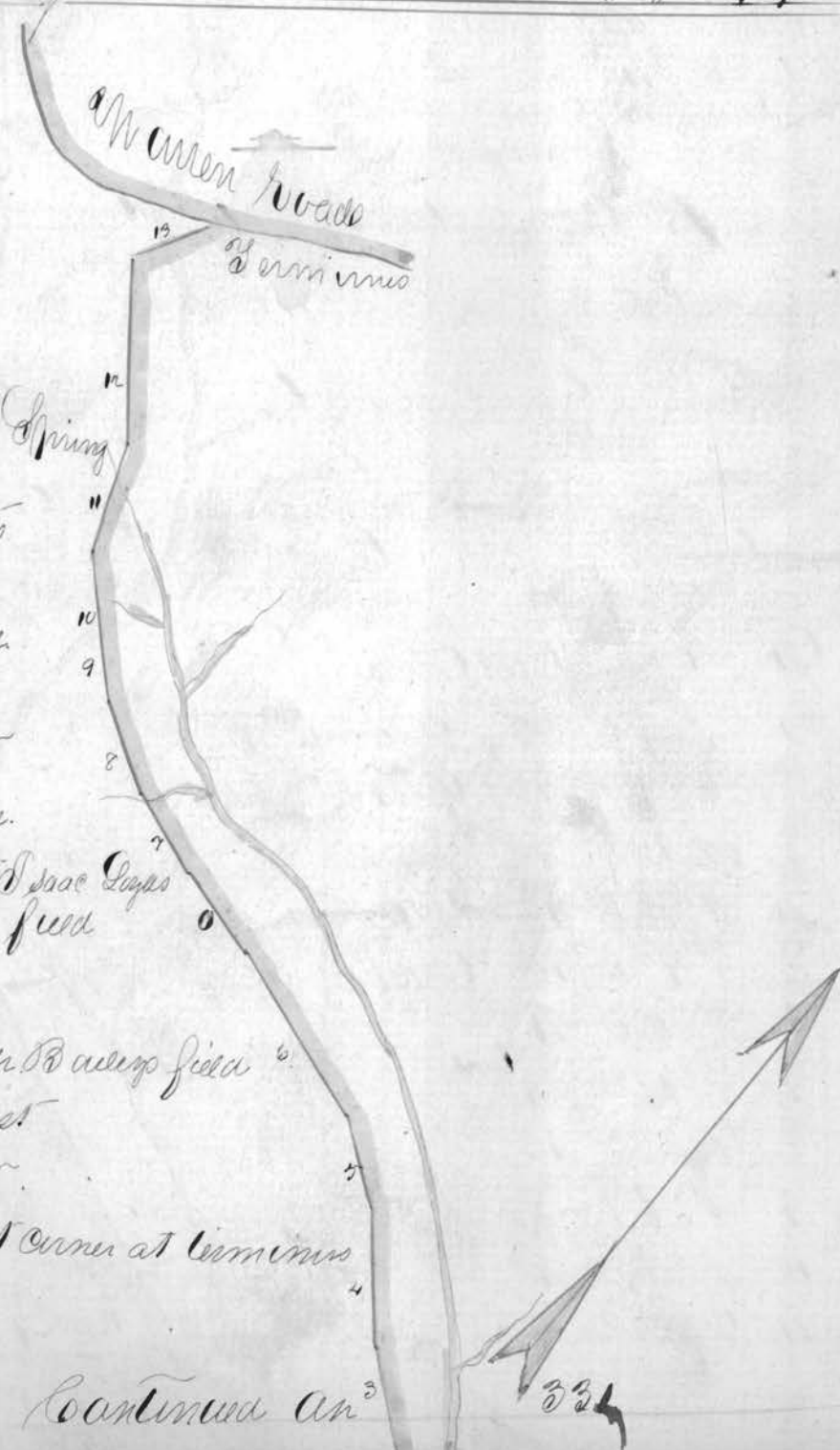

Continued on 331

Continued from page 330.



That of a County road beginning at Outlands Waggon making Shop and running thence to Evan Phillips as surveyed by Charles Dehass A. D. 1849.

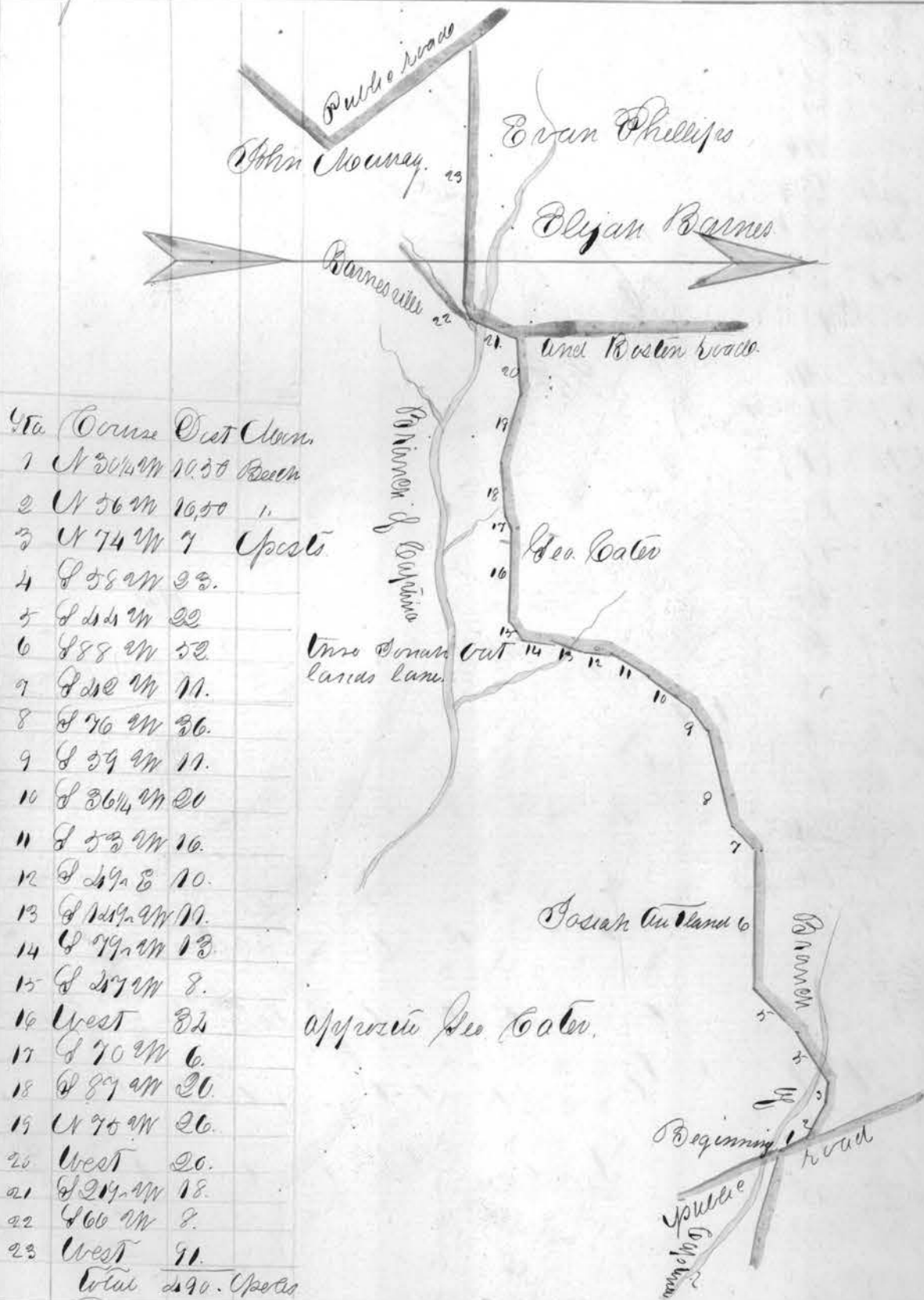

Plat of an alteration on the road from or
 along Dillins run beginning near Mr. Smiths
 Saw-mill and ends where the road intersects
 the road from Capatina to Bellsville as
 a Surveyed by ^{James Lewis} Charles DeHass A.D. 1849

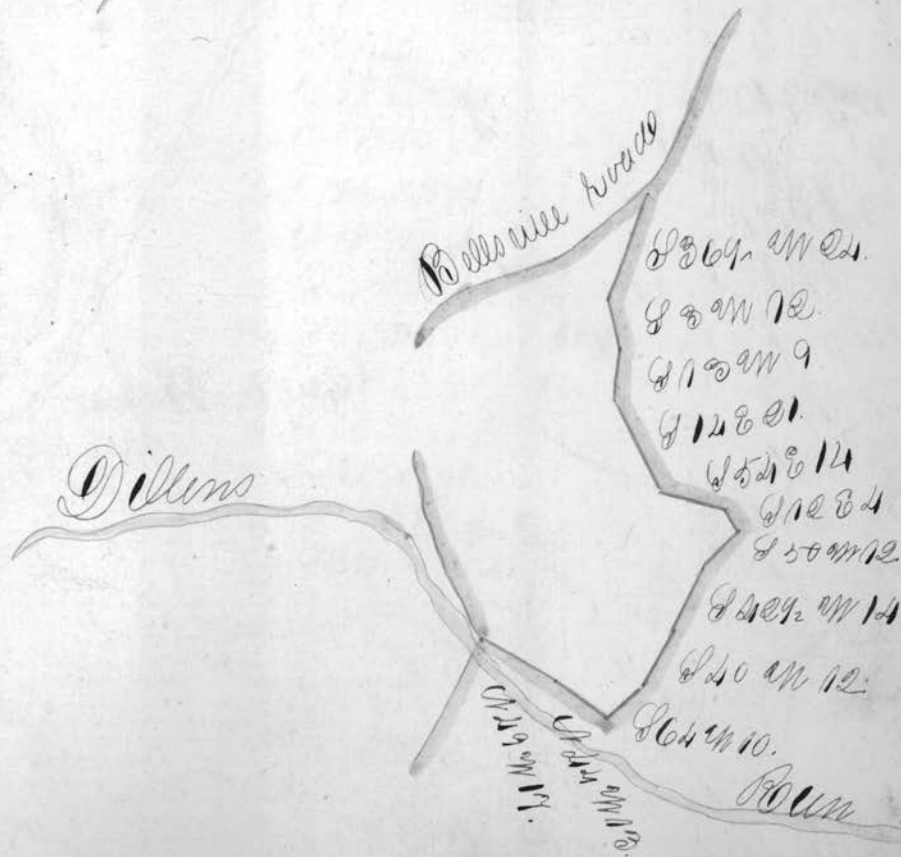

That of a County road beginning on
 the Ben fork of Captina Creek near
 Woques Gulling mill. and running thence
 down Captina Creek below and near
 Ambrose Sanford as Survey by Charles
 Dehass A. D. 1850

No	Course	Dist	Elem
1	S 20 1/2 E	23	Sugar
2	S 51 1/2 E	8	Upate
3	S 13 E	24	
4	North	12	
5	S 36 1/2 W	16	
6	S 69 W	6	
7	N 23 W	7	
8	S 88 1/2 W	12	
9	S 30 1/2 W	7	
10	S 2 W	8	
11	S 19 1/2 E	3	
12	S 8 W	10	
13	S 13 1/2 E	24	
14	S 14 1/2 E	13	
15	S 32 E	30	
16	S 29 W	13	
17	S 11 E	11	
18	S 12 E	10	
19	South	66	
20	S 15 1/2 E	22	
21	S 34 E	26	



19	S 1/2 W 66.
20	S 1/2 E 22.
21	S 3/4 E 26.
22	S 1/2 W 10.
23	S 3/8 W 24.
24	S 1/2 W 14.
25	S 3/8 W 2.
26	S 1/4 W 10.
27	S 3/4 E 12.
28	S 1/2 E 10.
29	S 3/4 E 7.
30	S 1/4 E 14.
31	S 3/8 E 10.
32	S 1/2 E 25.
33	S 1/4 E 27.
34	S 3/8 W 27.
35	S 3/4 E 20.
36	S 1/4 E 5.
37	S 3/4 E 14.
38	S 1/2 E 8.
39	S 3/4 E 22.
40	S 1/2 E 2.
41	South 2.
42	S 3/4 E 9.
43	S 1/4 W 10.
44	S 1/4 E 4.
45	S 3/4 E 9.
46	S 1/4 W 10.
47	S 3/4 W 10.
48	S 3/4 W 9.
49	S 1/4 W 18.
50	S 1/2 W 15.
51	S 1/4 W 18.
52	S 3/4 W 22.
53	S 1/4 E 10.
54	S 1/4 E 26.

S 1/2 W 22 1/2 W 26

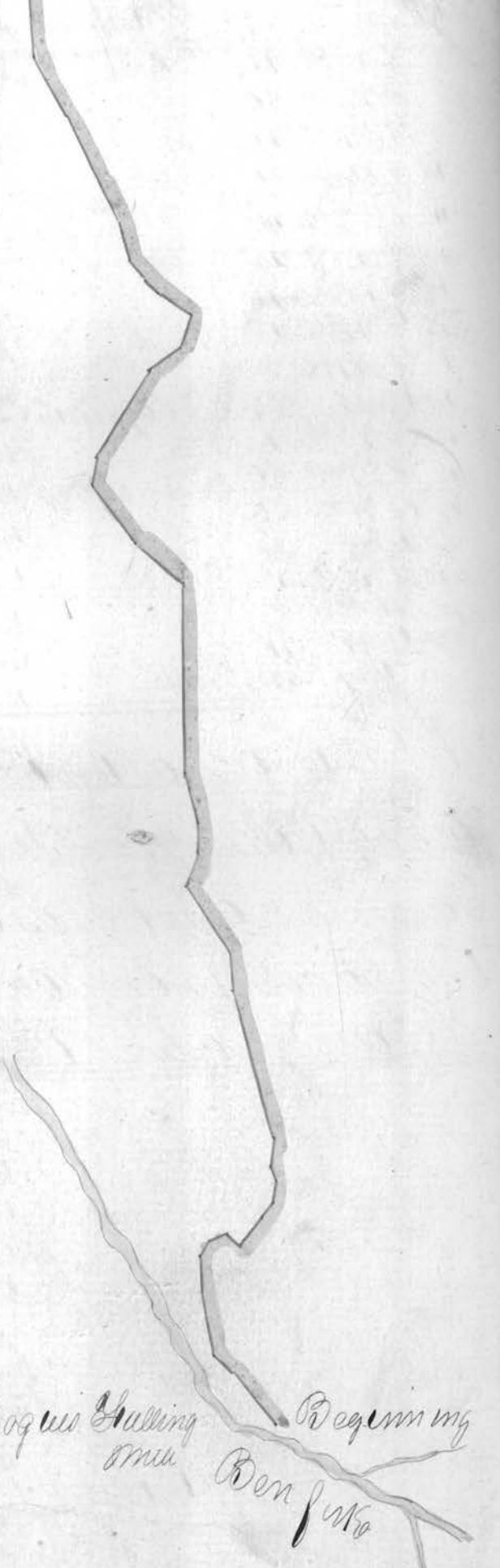

Yogues Halling
Ben Juko

That of a County road beginning near
Campbell's mill in Wheeling Co and run-
ning thence to the St Charles and Ca-
dig State road near George Pogue as
Surveyed by Charles DeBass A.D. 1850

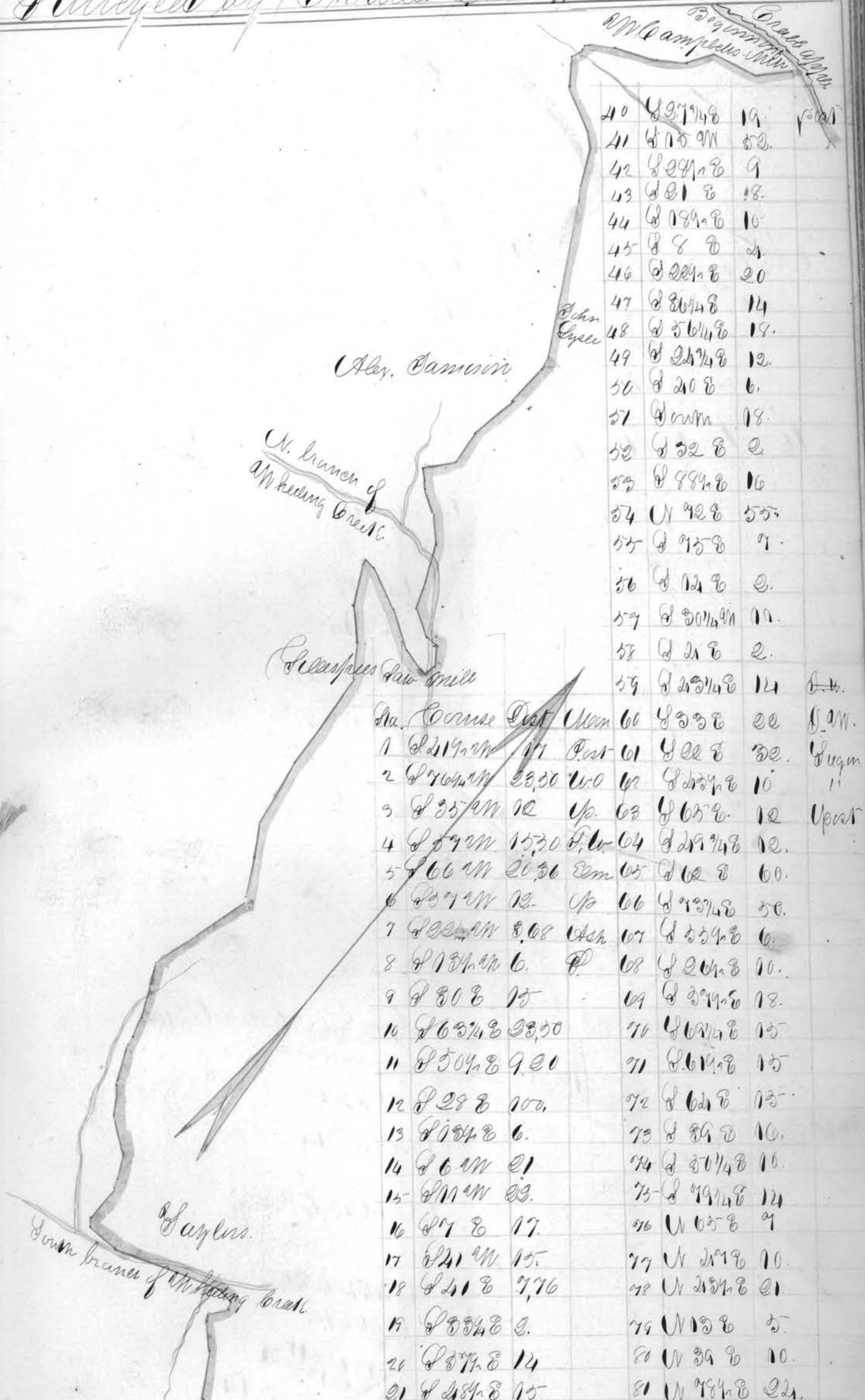

Campbell's mill
St Charles and Cadiz State road

40	S 27 1/2 E	19	19
41	S 15 1/2 W	52	52
42	S 24 1/2 E	9	9
43	S 21 E	18	18
44	S 18 1/2 E	10	10
45	S 8 E	2	2
46	S 22 1/2 E	20	20
47	S 26 1/2 E	14	14
48	S 56 1/2 E	18	18
49	S 24 1/2 E	12	12
50	S 20 E	6	6
51	S 20 W	18	18
52	S 52 E	2	2
53	S 84 1/2 E	16	16
54	N 92 E	55	55
55	S 95 E	7	7
56	S 12 E	2	2
57	S 30 1/2 W	11	11
58	S 21 E	2	2
59	S 23 1/2 E	14	14

Sta.	Course	Dist	Mean	60	61	62	63	64	65	66	67	68	69	70	71	72	73	74	75	76	77	78	79	80	81		
60	S 33 E	22	22	60	S 33 E	22	22	60	S 33 E	22	22	60	S 33 E	22	22	60	S 33 E	22	22	60	S 33 E	22	22	60	S 33 E	22	22
61	S 22 E	32	32	61	S 22 E	32	32	61	S 22 E	32	32	61	S 22 E	32	32	61	S 22 E	32	32	61	S 22 E	32	32	61	S 22 E	32	32
62	S 21 1/2 E	10	10	62	S 21 1/2 E	10	10	62	S 21 1/2 E	10	10	62	S 21 1/2 E	10	10	62	S 21 1/2 E	10	10	62	S 21 1/2 E	10	10	62	S 21 1/2 E	10	10
63	S 65 E	12	12	63	S 65 E	12	12	63	S 65 E	12	12	63	S 65 E	12	12	63	S 65 E	12	12	63	S 65 E	12	12	63	S 65 E	12	12
64	S 27 1/2 E	12	12	64	S 27 1/2 E	12	12	64	S 27 1/2 E	12	12	64	S 27 1/2 E	12	12	64	S 27 1/2 E	12	12	64	S 27 1/2 E	12	12	64	S 27 1/2 E	12	12
65	S 12 E	60	60	65	S 12 E	60	60	65	S 12 E	60	60	65	S 12 E	60	60	65	S 12 E	60	60	65	S 12 E	60	60	65	S 12 E	60	60
66	S 93 1/2 E	50	50	66	S 93 1/2 E	50	50	66	S 93 1/2 E	50	50	66	S 93 1/2 E	50	50	66	S 93 1/2 E	50	50	66	S 93 1/2 E	50	50	66	S 93 1/2 E	50	50
67	S 55 1/2 E	6	6	67	S 55 1/2 E	6	6	67	S 55 1/2 E	6	6	67	S 55 1/2 E	6	6	67	S 55 1/2 E	6	6	67	S 55 1/2 E	6	6	67	S 55 1/2 E	6	6
68	S 26 1/2 E	10	10	68	S 26 1/2 E	10	10	68	S 26 1/2 E	10	10	68	S 26 1/2 E	10	10	68	S 26 1/2 E	10	10	68	S 26 1/2 E	10	10	68	S 26 1/2 E	10	10
69	S 39 1/2 E	18	18	69	S 39 1/2 E	18	18	69	S 39 1/2 E	18	18	69	S 39 1/2 E	18	18	69	S 39 1/2 E	18	18	69	S 39 1/2 E	18	18	69	S 39 1/2 E	18	18
70	S 62 1/2 E	15	15	70	S 62 1/2 E	15	15	70	S 62 1/2 E	15	15	70	S 62 1/2 E	15	15	70	S 62 1/2 E	15	15	70	S 62 1/2 E	15	15	70	S 62 1/2 E	15	15
71	S 61 1/2 E	15	15	71	S 61 1/2 E	15	15	71	S 61 1/2 E	15	15	71	S 61 1/2 E	15	15	71	S 61 1/2 E	15	15	71	S 61 1/2 E	15	15	71	S 61 1/2 E	15	15
72	S 62 E	15	15	72	S 62 E	15	15	72	S 62 E	15	15	72	S 62 E	15	15	72	S 62 E	15	15	72	S 62 E	15	15	72	S 62 E	15	15
73	S 84 E	10	10	73	S 84 E	10	10	73	S 84 E	10	10	73	S 84 E	10	10	73	S 84 E	10	10	73	S 84 E	10	10	73	S 84 E	10	10
74	S 30 1/2 E	10	10	74	S 30 1/2 E	10	10	74	S 30 1/2 E	10	10	74	S 30 1/2 E	10	10	74	S 30 1/2 E	10	10	74	S 30 1/2 E	10	10	74	S 30 1/2 E	10	10
75	S 99 1/2 E	12	12	75	S 99 1/2 E	12	12	75	S 99 1/2 E	12	12	75	S 99 1/2 E	12	12	75	S 99 1/2 E	12	12	75	S 99 1/2 E	12	12	75	S 99 1/2 E	12	12
76	N 65 E	9	9	76	N 65 E	9	9	76	N 65 E	9	9	76	N 65 E	9	9	76	N 65 E	9	9	76	N 65 E	9	9	76	N 65 E	9	9
77	N 29 E	10	10	77	N 29 E	10	10	77	N 29 E	10	10	77	N 29 E	10	10	77	N 29 E	10	10	77	N 29 E	10	10	77	N 29 E	10	10
78	N 23 1/2 E	21	21	78	N 23 1/2 E	21	21	78	N 23 1/2 E	21	21	78	N 23 1/2 E	21	21	78	N 23 1/2 E	21	21	78	N 23 1/2 E	21	21	78	N 23 1/2 E	21	21
79	N 13 E	5	5	79	N 13 E	5	5	79	N 13 E	5	5	79	N 13 E	5	5	79	N 13 E	5	5	79	N 13 E	5	5	79	N 13 E	5	5
80	N 39 E	10	10	80	N 39 E	10	10	80	N 39 E	10	10	80	N 39 E	10	10	80	N 39 E	10	10	80	N 39 E	10	10	80	N 39 E	10	10
81	N 94 1/2 E	22	22	81	N 94 1/2 E	22	22	81	N 94 1/2 E	22	22	81	N 94 1/2 E	22	22	81	N 94 1/2 E	22	22	81	N 94 1/2 E	22	22	81	N 94 1/2 E	22	22

Alex. Samson

N. branch of Wheeling Creek

George Pogue's saw mill

J. Ayler's

South branch of Wheeling Creek

John Lytle

20	S 87 1/2 E 14	80	N 39 E 10.
21	S 84 1/2 E 15	81	N 48 1/2 E 22.
22	S 93 E 23.	82	N 82 E 8.
23	S 118 E 10.	83	N 92 E 12
24	S 63 E 14	84	N 80 E 14
25	S 87 1/2 E 20	85	N 69 1/2 E 22.
26	S 38 1/2 E 10.	86	N 68 E 15
27	S 6 W 50	87	N 78 1/2 E 5
28	S 52 1/2 W 1.	88	S 90 E 15
29	N 73 1/2 W 14	89	N 27 E 2
30	N 57 1/2 W 20.	90	N 23 E 2.
31	N 66 1/2 W 21	91	N 84 1/2 E 20.
32	N 88 W 6.	92	N 32 E 12.
33	S 45 W 1	93	N 39 1/2 E 17.
34	S 29 1/2 E 20	U. W. 94	N 92 1/2 E 8, 20
35	S 21 E 18	Up to 95	N 23 1/2 E 10, 21
36	S 30 1/2 E 17	96	N 32 E 2.
37	S 41 E 28	97	N 64 E 2.
38	S 8 E 22, 80	98	S 88 E 1
39	S 24 1/2 E 16, 00	99	S 53 E 1
		100	S 23 E 1
		101	S 9 W 1
		102	S 5 W 1

S. Mechner
etc.

Cherry
Up to

Dragon
Up to

4 1/2 miles

Pogues run

Pogues run
Cabin

White Road
mill

334
 That of four alterations on the road
 from Mount Liberty to the National
 road west of St. Clairsville as surveyed
 by Thomas Lewis A. D. 1850

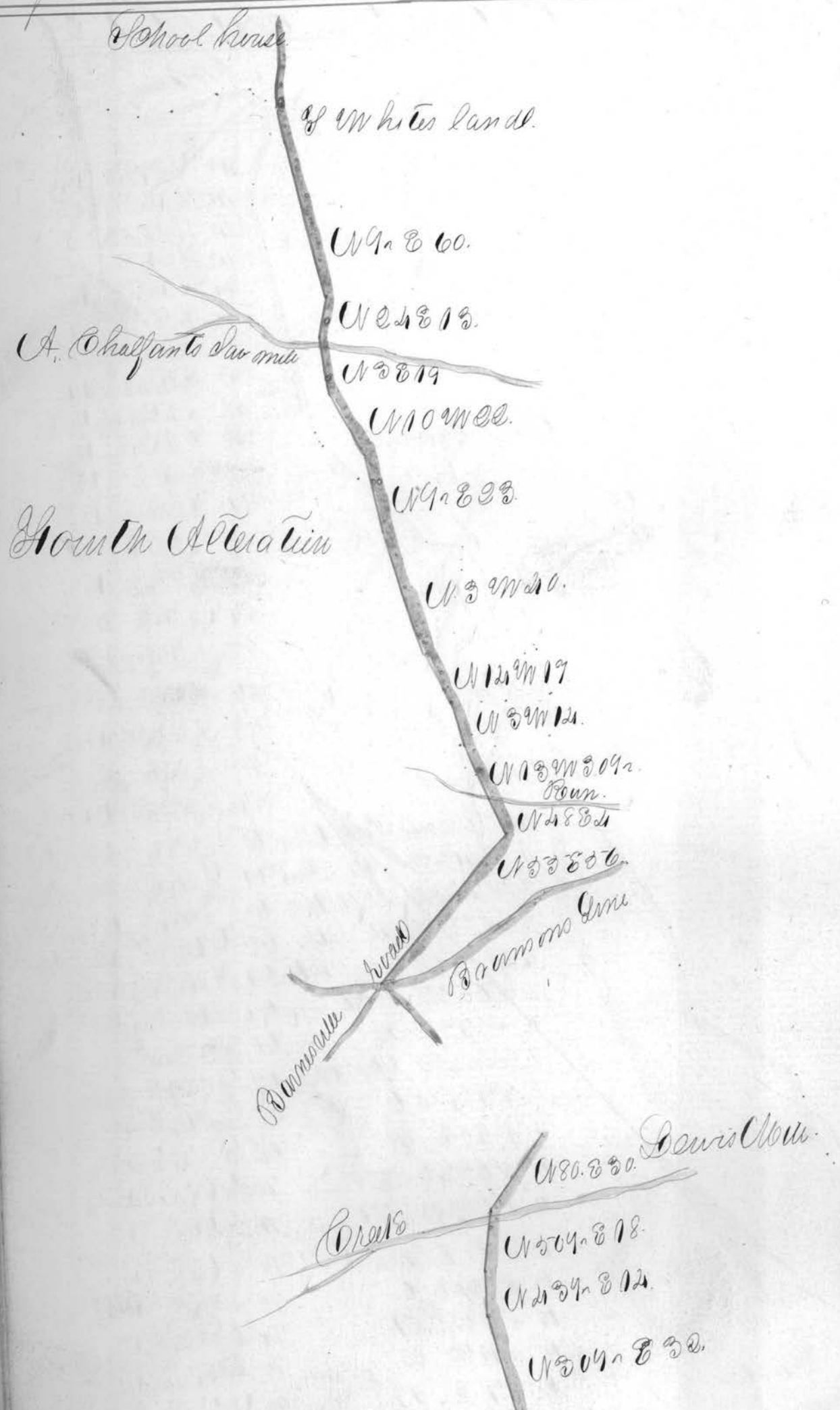

Grass
Lewis Mou.
U 80.8 30.

U 75 9 8 18.
U 71 9 8 12.

U 70 9 8 20.

U 74 9 8 25.
U 68 10.

1 m. U 6 11 12
U 1 12 12
U 1 14 14

U 70 8 14
U 12 8 14

U 50 8 17

Boole Alteration

Michael Snyder

U 73 9 8 12

U 9 9 9 11.

U 71 9 8 25

U 69 9 8 16

Continua on page 335

Continued from Page 334

W 318 50

W 418 98

John
W 248 4
Dull

W 458 20

W 338 00

W 997 8 30

W 1047 8 26

W 1, 30 90

Mrs. Kimmings

W 5, 60

Jim

Mrs. Kimmings

W 488 24

Original
Family

W 4-21-60 Yp.

W 21-2-35

W 6-2-30

W 2-3-20

W 1-3-26

W 4-5-36

W 5-1-38

④ Kulpas Line

W 9-1-34

W 1-1-34

336 Plat of a County road beginning at Kuntwood and running from thence to Bellair, also an alteration on the said road beginning at the 10th side on the 8th Station and ending at the 10th Station on the Original Survey as Purvised by Charles Dehass A. G. 1850

Sta Course Dist. Mem.

1	S 26 E	28
2	S 29 E	10
3	S 31 1/2 E	44
4	S 24 1/2 E	25.37
5	S 14 1/2 E	9.50
6	S 25 1/2 E	12.60
7	S 17 1/2 E	26
8	S 20 E	9
9	S 3	N 14.46
10	S 31 1/4 E	18
11	S 37 1/2 E	31.50
12	N 75 E	13
13	S 13 1/4 E	42
14	S 13	N 21
15	S 2	E 64
16	S 11 E	32
17	S 9 1/2 N	5
18	S 25 1/2 N	10
19	S 9 E	20
20	S 25 1/2 E	6

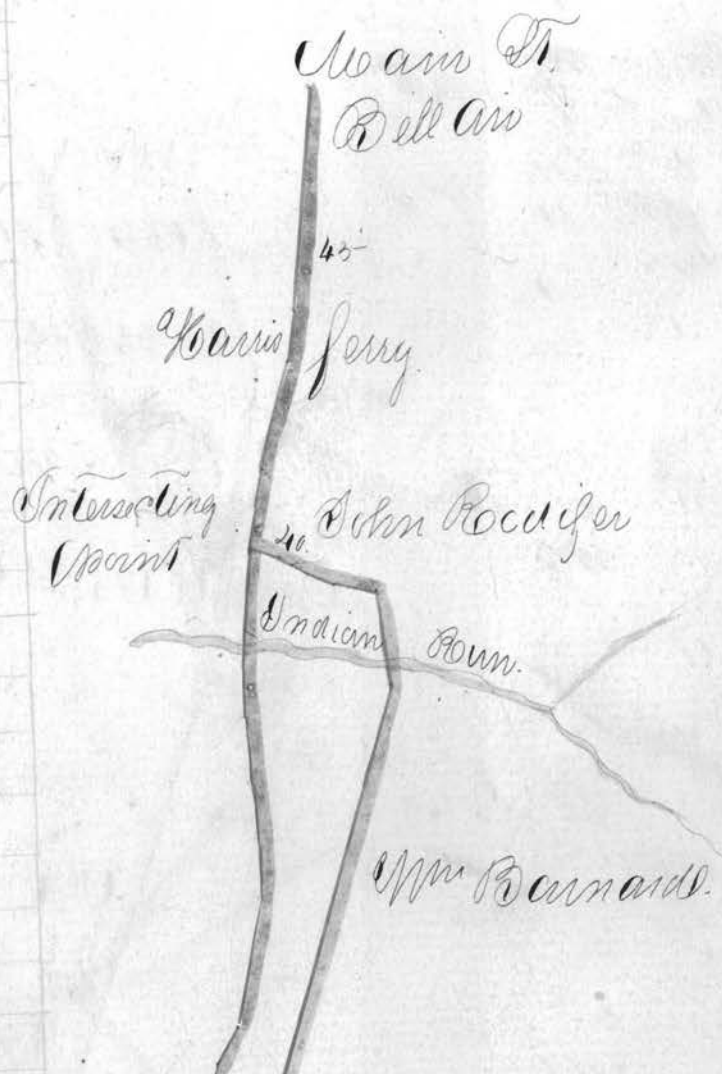

20	S 25 1/2 E	6
21	S 3 E	39,50
22	S 4 1/2 W	26
23	S 5 1/2 W	26
24	S 7 1/2 W	210
25	S 5 W	25
26	S 8 1/4 W	72
27	S 10 1/2 W	36
28	S 12 1/2 W	14
29	S 16 W	51
30	S 31 W	14
31	S 3 1/2 E	2
32	S 25 E	2
33	S 25 E	6
34	S 17 W	225
35	S 5 1/2 E	135
36	S 82 1/2 E	26
37	S 69 1/2 E	11
38	S 66 E	10
39	S 75 E	7
40	S 67 1/2 E	16
41	S 8 W	21
42	S 72 W	16
43	S 104 W	52
44	S 112 W	24
45	S 6 W	104

Sum of 45 up. 1355.50 Up.
Course of the alteration of
the above road. Post

1	S 21 E	21
2	S 74 E	21,50
3	S 79 1/2 E	20,50
4	S 81 1/2 W	44
5	S 77 1/2 W	46
6	S 25 1/2 W	20
7	S 11 W	60
8	S 10 1/2	27
9	S 8 E	25
10	S 39 E	30
11	S 5 1/2 W	28
12	S 8 1/4 W	28,75 374,75 Up into

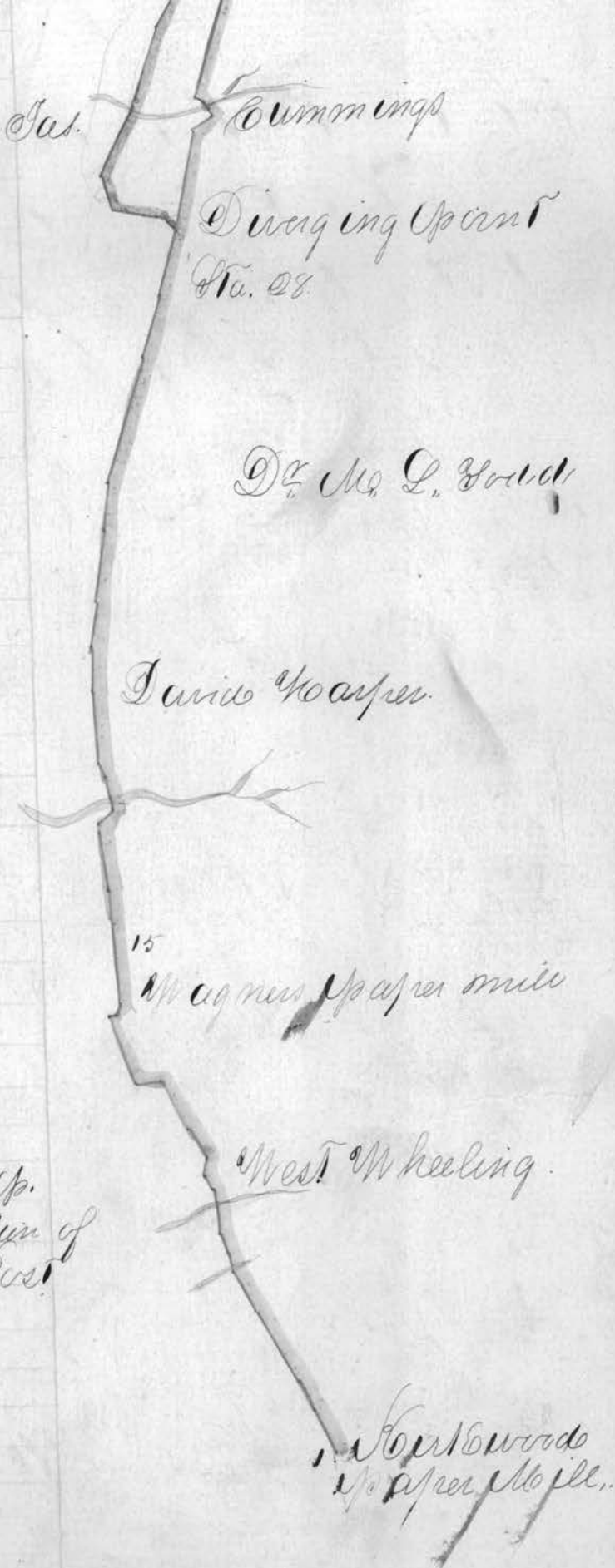

Dr. Mr. L. Gold,

David Woopser

15
Mr. Woopser

West Wheeling

Fort Woods
Up river No. 11

Plan of a County road beginning at James Jenkins Saw mill and running thence to the morefield road near Woods. As surveyed by Charles Dehass A.D. 1850

No	Course	Dist	Urbn
1	S 45 E	40	Good Roads
2	S 65 E	32	Mill roads
3	S 62 1/2 E	21, 00	
4	N 82 1/2 E	38	
5	S 88 E	70	
6	S 20 E	7	
7	S 80 E	60	
8	East	25	
9	S 64 1/2 E	22, 50	
10	S 86 E	50	
11	N 73 E	20	
12	S 64 1/2 E	24	
13	N 81 E	2	
14	N 82 1/2 E	4	
15	N 86 1/2 E	29, 50	
16	N 21 E	15	
17	N 58 1/2 E	28	
18	N 85 E	30	
19	N 66 E	9	
20	N 75 E	26	
21	N 30 E	11, 75	W.O.
22	N 2 E	16, 75	Upst
23	N with	10, 05	Jas Jenkins Saw mill
24	N 8 E	25, 50	
25	N 77 E	38	
Total		729, 75	poles

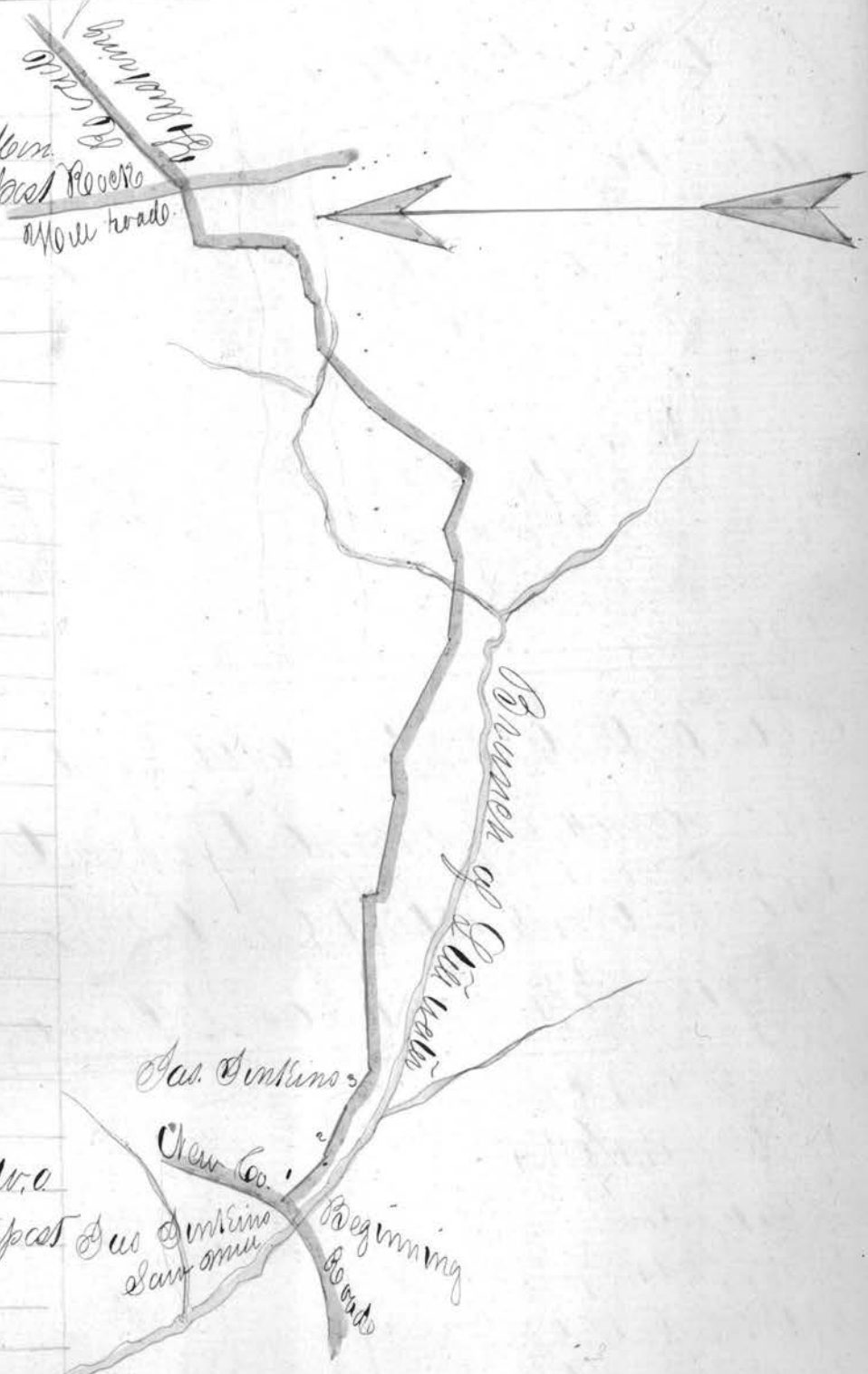

Plan of a County road beginning at the
 South end of Hubbard and running
 thence to the town of Bellair as surveyed
 by Charles DeWass A.D. 1850

No	Course	Dist	Notes
1	S 20 E	28	Start
2	S 29 E	16	
3	S 31 1/2 E	24	
4	S 21 1/2 E	25,50	
5	S 14 1/2 E	9,20	
6	S 25 1/2 E	12,60	
7	S 13 1/2 E	26	
8	S 20 E	9	
9	S 30 W	10,40	
10	S 31 1/2 E	18	
11	S 27 1/2 E	31,50	
12	N 75 E	13	
13	S 78 1/2 E	22	
14	S 10 E W	2	
15	S 2 E	64	
16	S 11 E	30	
17	S 9 1/2 W	5	
18	S 25 1/2 W	10	
19	S 9 E	20	
20	S 24 E	6	
21	S 3 E	39,50	
22	S 24 W	26	
23	S 31 W	26	
24	S 79 1/2 W	20	
25	S 5 W	20	
26	S 8 1/2 W	78	
27	S 14 1/2 W	36	
28	S 12 W	24	
29	S 16 W	37	
30	S 31 W	14	
31	S 3 1/2 E	2	
32	S 25 E	2	
33	S 28 E	6	

South end of Hubbard
 Beginning

West Wheeling

24	S 77 W	22,5	Post
25	S 34 E	25	
26	S 89 E	20	
27	S 69 1/2 E	11	
28	S 60 E	10	
29	S 95 E	7	
30	S 69 1/2 E	10	
31	S 8 W	21	
32	N 10 1/2 W	16	Cham
33	S 10 1/2 W	32	Post
34	S 12 W	24	
35	S 6 W	104	

Total Dist. 73 1/2

Continued on Page 338.

Continued from Page 337.



Plot of a County road beginning at Glenns
 run and running thence to the School
 House in District No. 6 Grass Township
 as surveyed by Charles Dehass A.D. 1850

The Course Past Udon.

- 1 N 30 W 17, 48 Post
- 2 S 67 1/2 W 17.
- 3 N 80 1/2 W 14.
- 4 N 60 1/2 W 15, 75
- 5 N 47 1/2 E 28.
- 6 N 12 1/2 W 51.
- 7 N 63 1/2 W 27, 64 Stone
- 8 N 33 1/2 W 10, 88 "
- 9 S 76 1/2 W 21. Post
- 10 N 32 1/2 W 37.
- 11 N 8 1/2 W 91.

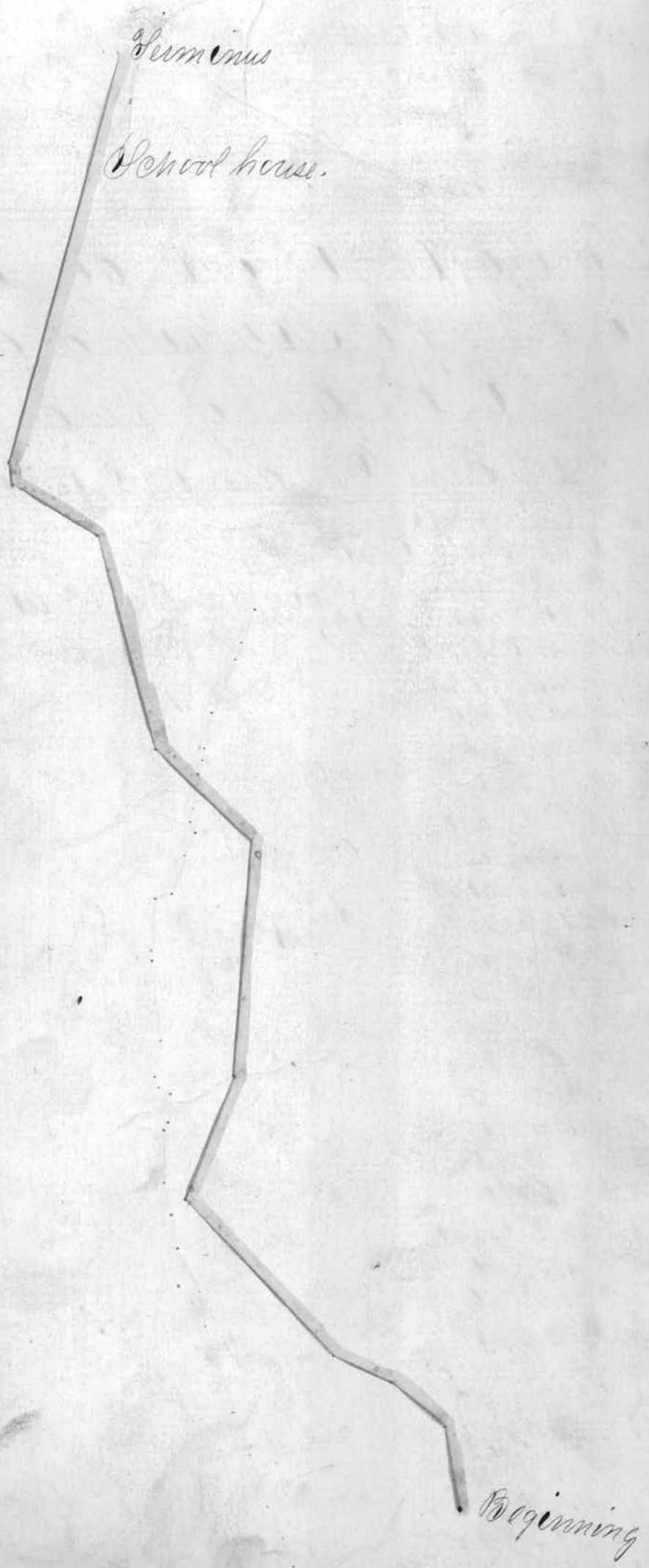

Plan of a County road beginning near
Boston and running from thence to the
Manroe County Line at John Henrichs
as Surveyed by Charles Deane A.D. 1850

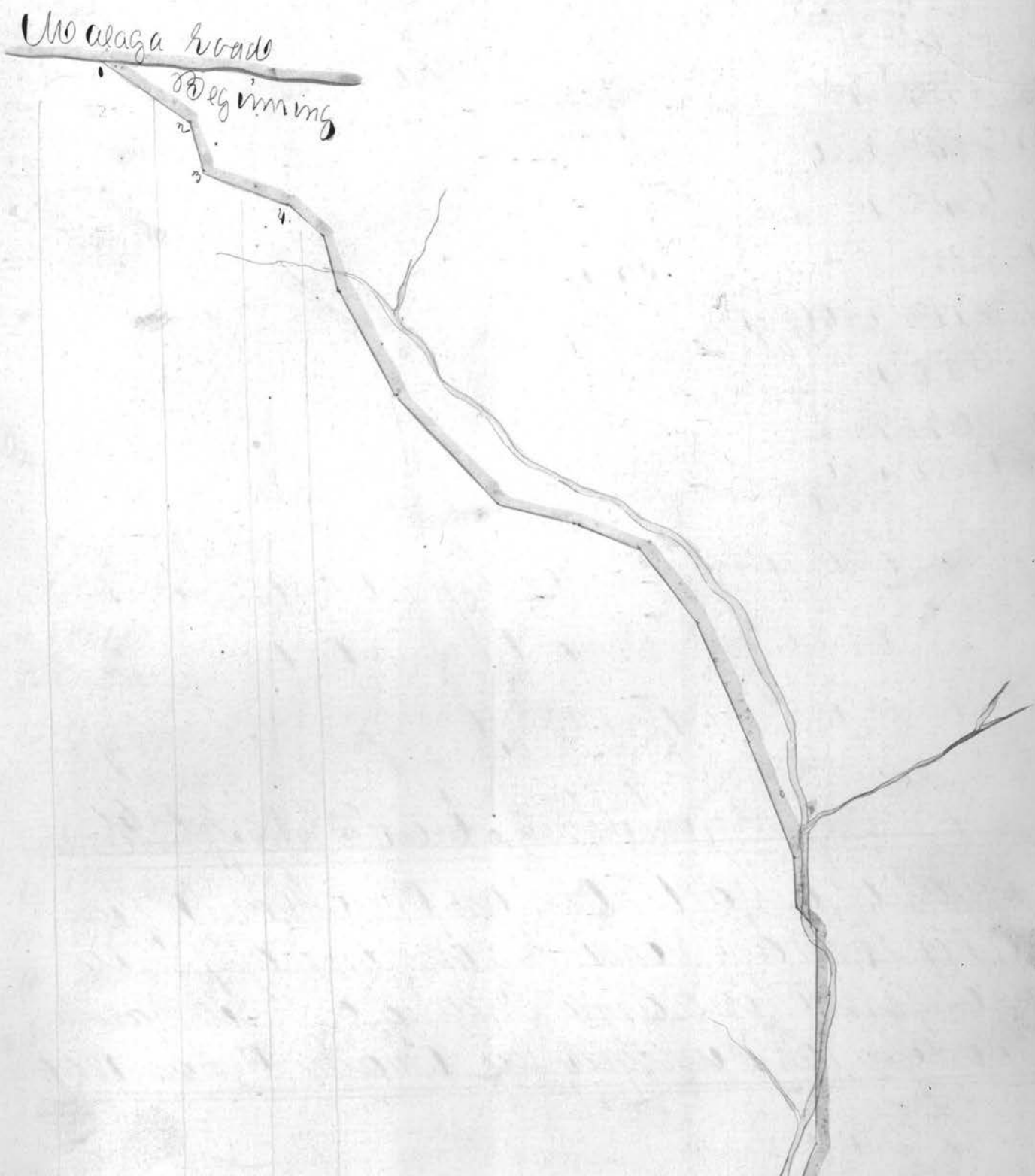

No.	Course	Dist	Union
1	S 2 E	20	None.
2	S 83 1/4 W	11, 30	Up east.
3	S 20 1/2 E	20	
4	S 7 1/4 W	10	
5	S 83 W	12	
6	S 21 W	24, 60	
7	S 6 1/4 W	30	
8	S 23 E	18	
9	S 19 E	14	
10	S 10 W	20	
11	S 25 1/2 W	27	
12	S 29 1/2 W	28	
13	S 16 W	11	
14	S 10 1/2 W	7	
15	S 29 W	13	
16	S 73 W	30	
17	S 18 1/4 W	23	
18	S 21 W	31	
19	S 58 1/2 W	20	
20	S 8 1/2 W	10	
21	S 79 1/2 W	38	
22	S 83 1/2 W	11, 37	
23	S 50 1/2 W	24, 20	
			At mile 19 1/2 Up east

