

Continued from page 269

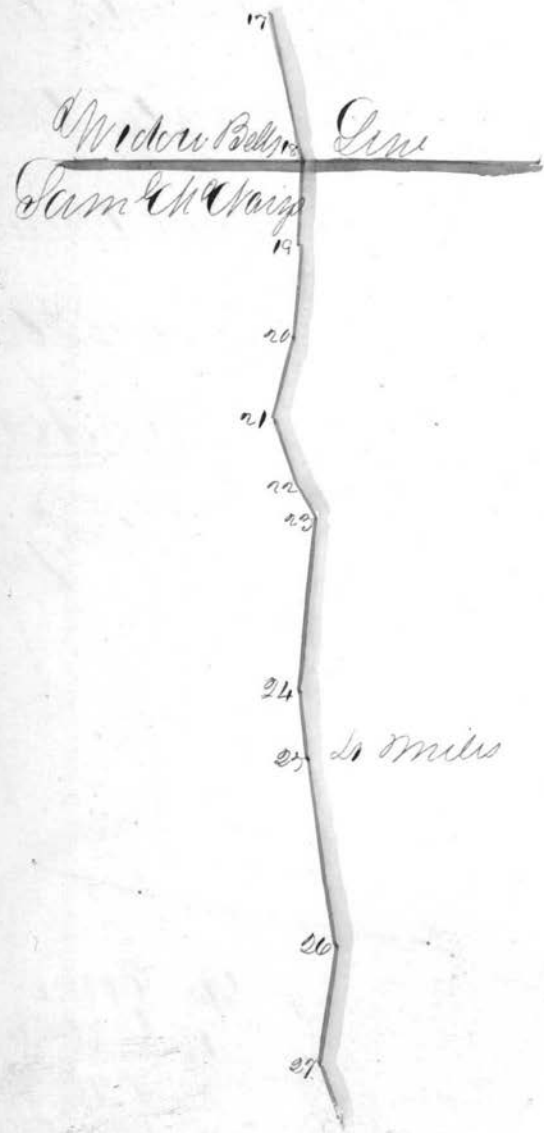

10	S 48 E	20
13	S 26 W	17
14	S 63 E	12
15	S 74 E	12
16	S 54 E	10
17	S 40 E	17
18	S 21 E	19
19	S 5 E	16
20	S 10 E	6
21	S 89 W	10
22	S 9 E	16
23	S 30 W	19
24	S 25 E	24
25	S 9 E	15
26	West	3
	Sam	44
27	N 80 W	15
	S 29 W	25
1	S 34 W	17
2	S 50 W	17
3	S 83 W	20
4	N 96 W	15
5	S 91 W	30
6	S 28 W	18

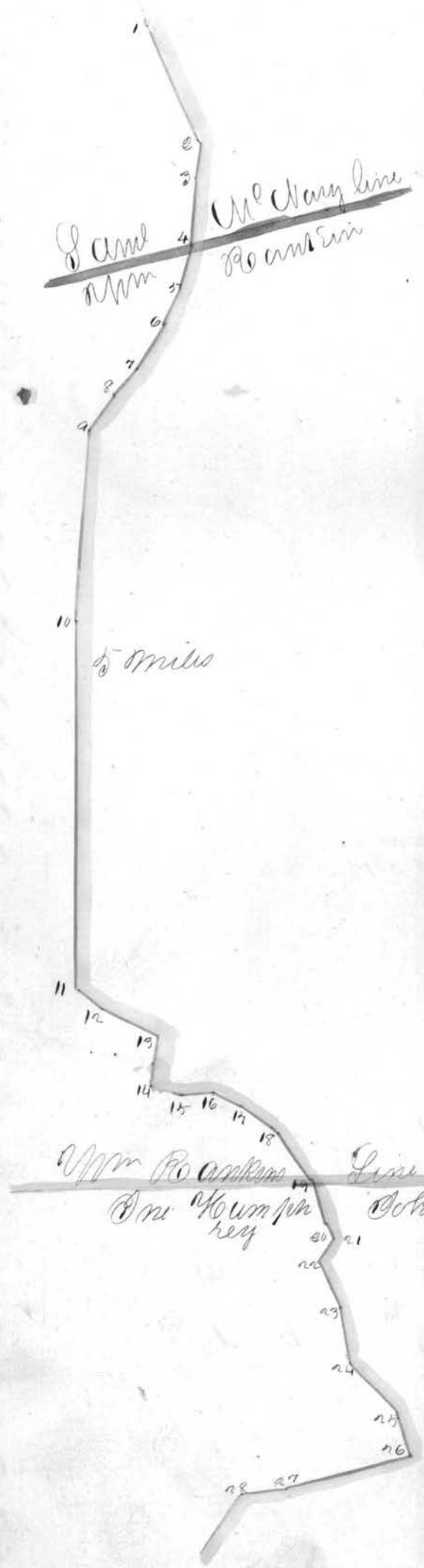

6	S 28 W	18.	
7	S 10 W	25	
8	S 8 W	52.	
9	S 6 W	21	
10	S 14 W	13.	7
	Sum	13	
11	S 3 E	15	
12	S 4 W	56	
13	S 14 W	36	
14	S 28 W	32.	
	Sum	27	
15	S 14 W	19	
16	S 70 W	19	
17	S 74 W	15	
18	S 29 W	31	
19	S 20 W	12	
20	S 10 E	8	
21	S 56 E	22.	8
	Sum	22	
22	S 12 E	16	
23	S 2 W	16	
24	S 3 E	20	
25	S 6 E	8	
26	S 32 E	21	
27	S 40 E	38.	
1	S 26 E	57	
2	S 10 W	8.	
3	S 10 E	54	
4	S 20 E	26	
5	S 26 E	14	9
6	S 9 W	24	
7	S 31 W	21	
8	S 12 W	30	
9	S 29 W	27	
10	S 9 W	108	
11	S 6 W	32	
12	S 12 W	18	10
	Sum	16	
13	S 30 W	20	
14	S 18 W	21	
15	S 9 W	9	
16	S 10 E	17	
17	S 4 E	12.	
1	S 1 E	13	
2	S 11 W	5	

Continued on page 271.

Continued from page 270

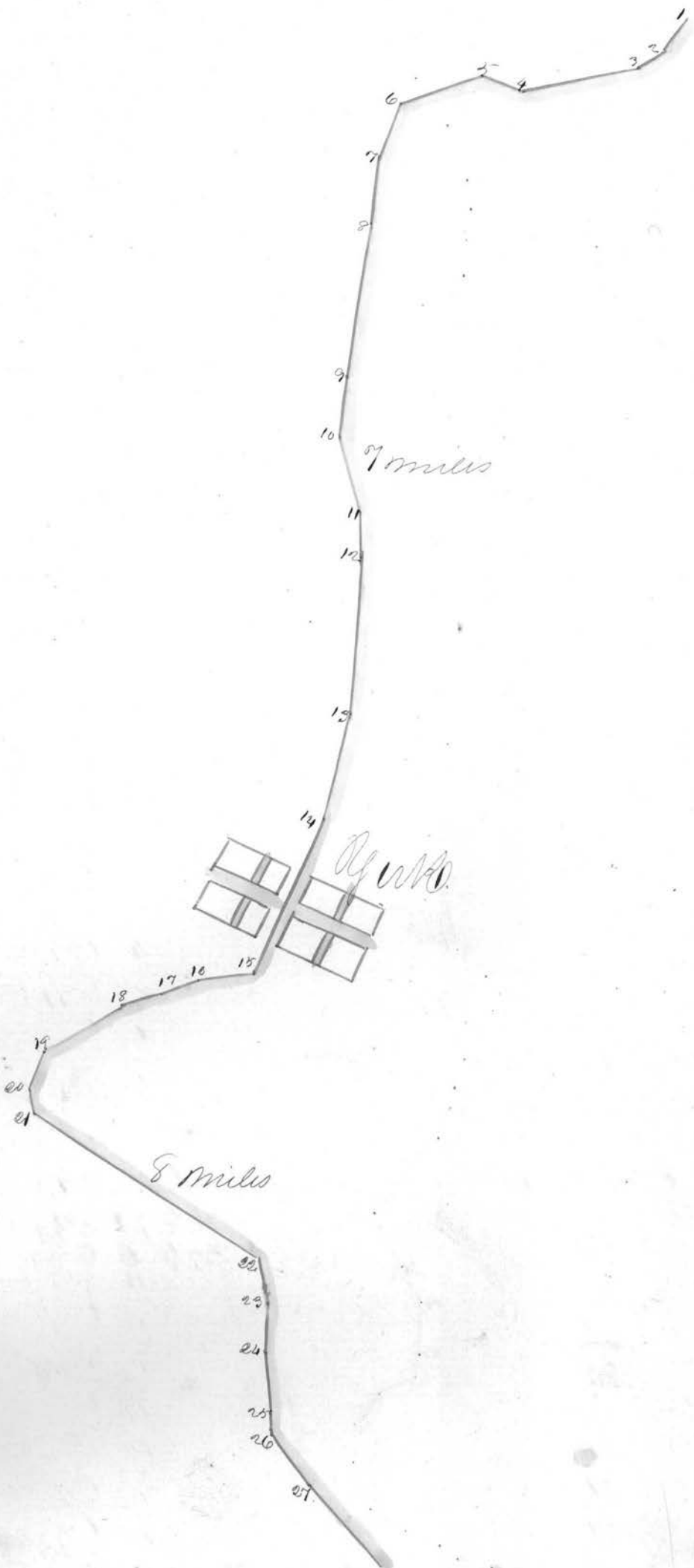

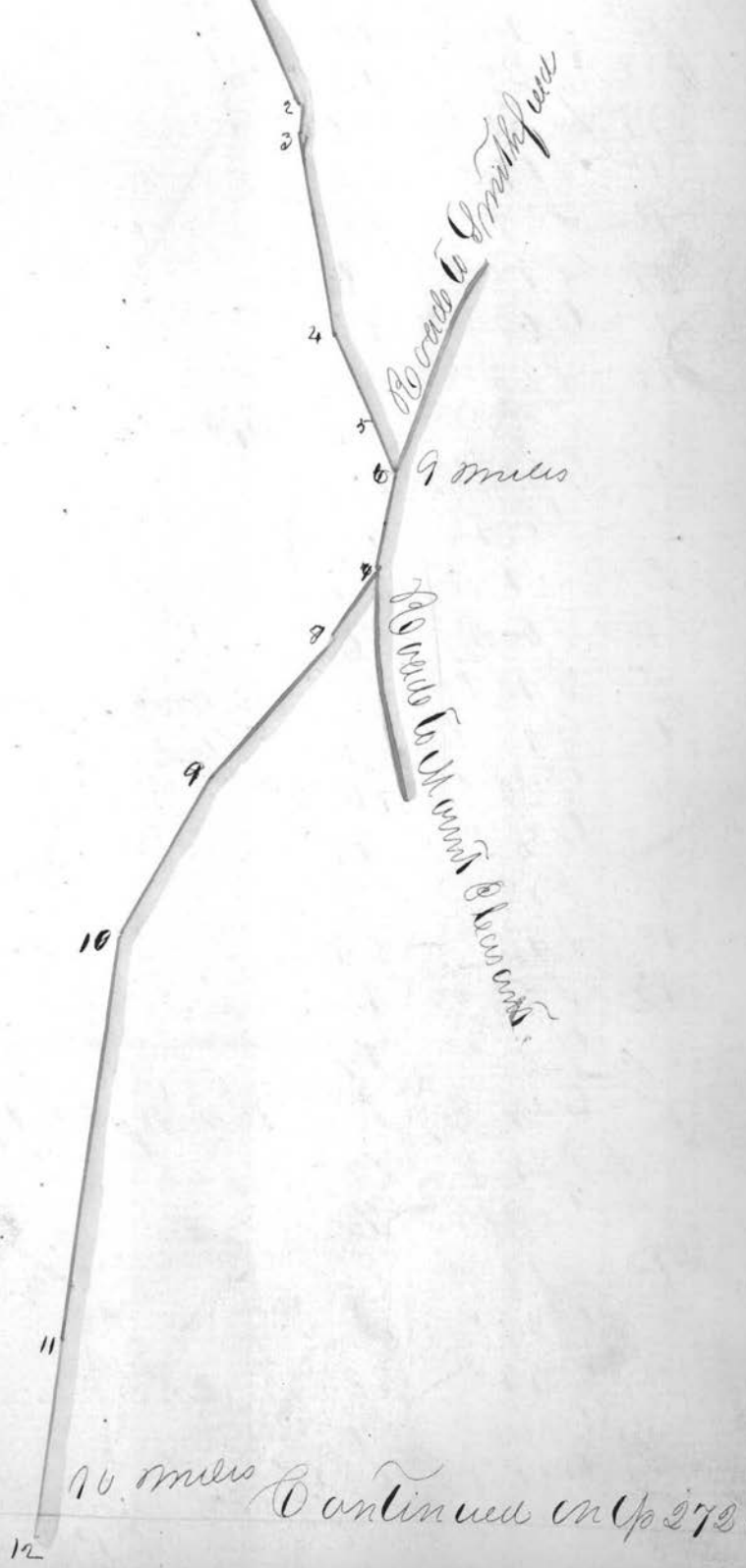

Continued from page 271

2	8 58 AM	35
3	8 55 AM	13
4	8 40 AM	32
5	8 29 AM	26
6	8 16 AM	27
7	8 13 AM	11
8	8 18 AM	13
9	8 33 AM	7
10	8 13 E	6
11	8 09 E	11
12	8 11 AM	9. Mon.
13	8 05 E	10.
14	8 12 E	7
15	8 26 E	10
16	8 40 E	34
17	8 07 AM	20
18	8 30 AM	13.
19	8 41 E	18.
20	8 9 E	8.
21	8 03 E	12.
22	8 15 E	12.
23	8 25 AM	17
24	8 01 AM	12.
25	8 05 AM	12.
26	8 32 AM	8.
27	8 33 AM	8.
28	8 9 AM	11
29	8 30 AM	10.
30	8 25 AM	14
31	8 15 AM	8.
32	8 30 E	56.
33	8 21 E	24
34	8 9 AM	20
35	8 20 AM	10.
36	8 11 E	36.
37	8 52 AM	50
38	8 00 AM	22.
39	8 19 AM	36.
40	8 10 AM	21
41	8 32 AM	20
42	8 11 AM	25
43	8 10 AM	25
44	8 12 AM	17.
45	8 55 AM	12.
46	8 41 AM	20
47	8 61 AM	24
48	8 29 AM	11.
49	8 13 AM	36.
50	8 08 AM	19
51	8 83 AM	26.
52	8 83 AM	39
53	8 03 AM	132.

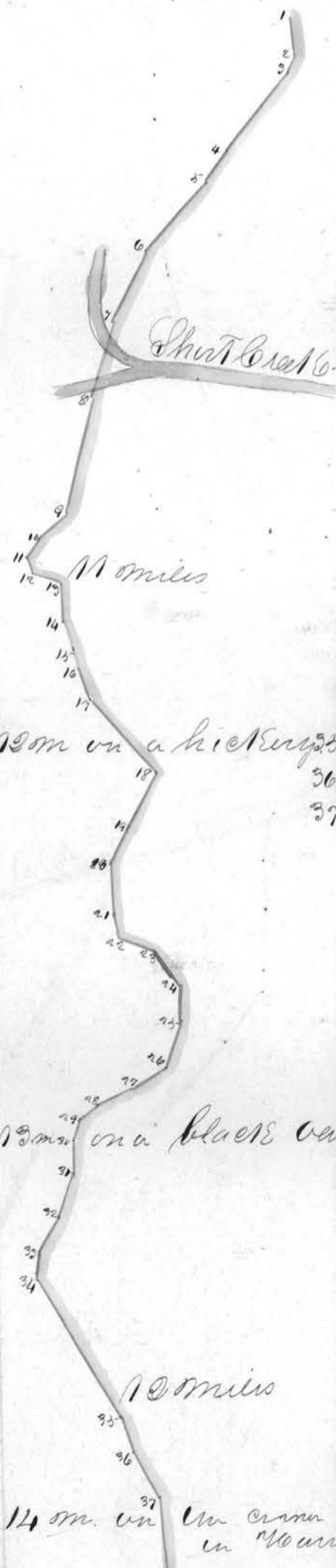
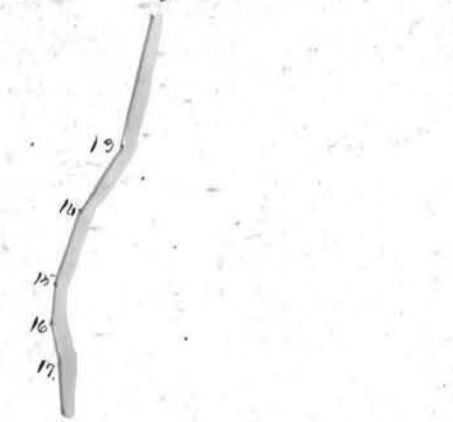

12m on a black oak 8 22 E 13
 36 8 31 E 17
 37 8 6 E 29

12m on a black oak

Nomis

14m on the crown of St. Blansaria St. in the woods

- | | | |
|-----|---------|------|
| 17 | ♀ 113 W | 36. |
| 18 | ♀ 68 W | 19. |
| 19. | ♀ 83 W | 26. |
| | ♀ 83 W | 39 |
| 1 | ♀ 63 W | 132. |
| 2 | South | 210 |
| 3 | ♀ 21 E | 34 |
| 4 | South | 26 |
| 5 | ♀ 12 W | 85- |
| 6 | ♀ 18 W | 29 |
| 7 | ♀ 22 W | 110. |
| 8 | ♀ 7 W | 217 |
| 9 | ♀ 13 W | 7 |
| 10 | ♀ 11 W | 34 |
| 11 | ♀ 53 W | 16 |
| 12 | ♀ 8 W | 17 |
| 13 | ♀ 21 E | 12. |
| | ♀ 24 E | 25 |
| | South | 7. |
| 1 | ♀ 19 W | 8. |
| 2 | ♀ 37 W | 13. |
| 3 | ♀ 49 W | 38. |
| 4 | South | 20 |
| 5 | ♀ 26 E | 60 |
| 6. | ♀ 22 E | 19 |

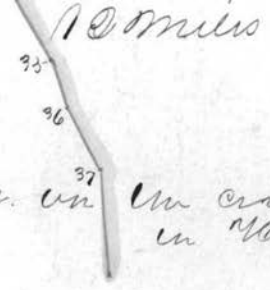

14 m. on the corner of St. Clairville St. in Newark N.J.

15 miles on a White oak in S. Sag. G. G. Lane.



16 m on an Apple tree

13 miles Continued on 273.

Continued from Page 272

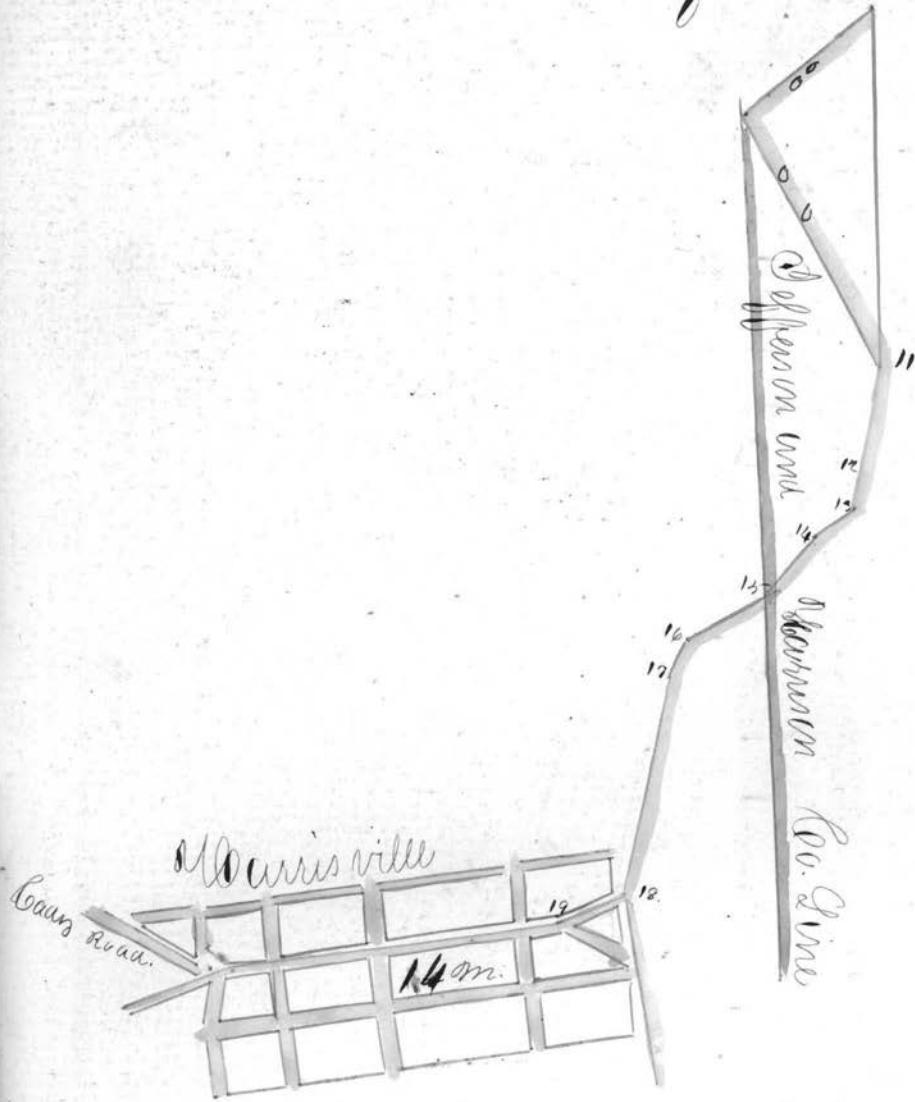

Coaly Road

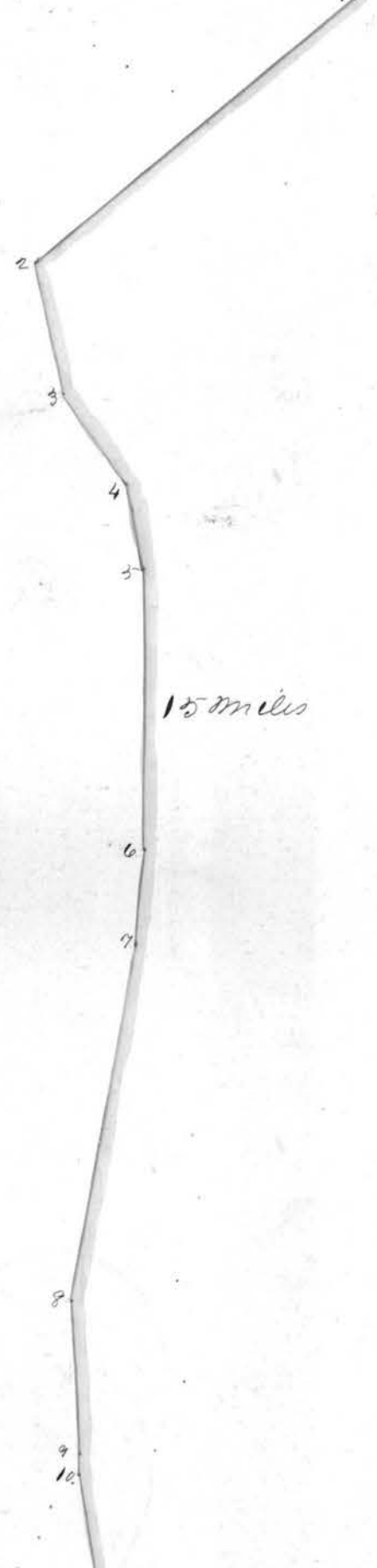

15 miles

Co. Line

Mcarron Co

11 Geo. Coane

Belmont Co.

10 miles on an apple tree



Continued on Page 274.

Continued from Page 273.

7	Q 45 E	15
8	Q 16 W	20
9	Q 5 W	11
10	Q 8 W	33
11	Q 17 E	31
12	Q 10 E	15
13	Q 11 W	10
14	Q 29 W	12
15	Q 8 E	7
16	Q 12 E	12
17	Q 1 W	11
18	Q 7 W	15
19	Q 70 W	13
20	Q 81 W	10
21	Q 87 W	15
22	Q 98 W	10
23	Q 72 W	16
24	Q 76 W	11
25	Q 78 W	10
26	Q 68 W	14
27	Q 72 W	30
28	West	28
29	Q 70 W	31
30	Q 1 W	20
31	Q 80 W	9
32	Q 20 W	20
33	Q 50 W	17
34	Q 36 W	27
35	Q 38 W	17
36	Q 36 W	6
37	Q 55 W	9
38	Q 71 W	5
39	Q 8 E	18
40	Q 2 E	23
41	Q 12 E	10
42	Q 7 E	19
43	Q 12 E	19
44	Q 5 E	12
1	Q 65 W	130
2	South	40
3	Q 21 E	34
4	South	26
5	Q 12 W	35
1	Q 10 W	17
2	Q 16 E	28
3	Q 6 W	31
4	Q 21 E	22
5	Q 6 E	22
6	Q 20 E	8
7	Q 21 E	10
8	Q 26 E	10
9	Q 22 E	20
10	Q 23 E	31
11	Q 12 E	29

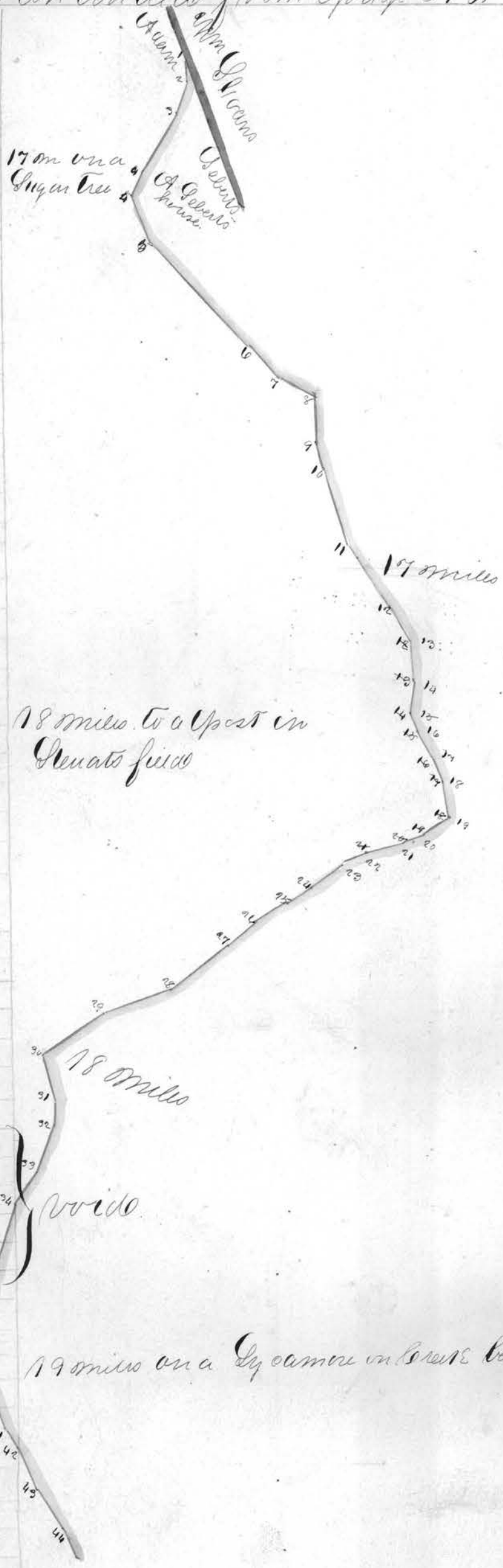

void

19 miles on a Sy camore on Senats bank

11	Q 12 E	29
10	Q 10 E	33
13	Q 23 W	52
14	Q 7 W	34
15	Q 20 E	35
16	Q 36 E	54
17	Q 49 E	15
18	Q 14 E	24
19	Q 6 E	10
20	Q 8 E	55
21	Q 5 E	60

1	South	95
2	Q 38 W	17
3	Q 30 E	25
4	Q 47 E	12
5	Q 78 E	22
6	South	32
7	Q 46 W	24
8	Q 28 W	17
9	Q 15 E	37
10	Q 2 E	81
11	Q 11 E	37
12	Q 16 W	24
13	Q 21 E	13
14	Q 46 E	10
15	Q 19 E	18
16	Q 41 E	35
17	South	65
18	Q 10 E	30
19	Q 23 E	24
20	Q 40 E	11

20 miles on Walnut Tree in Ganago Lane.

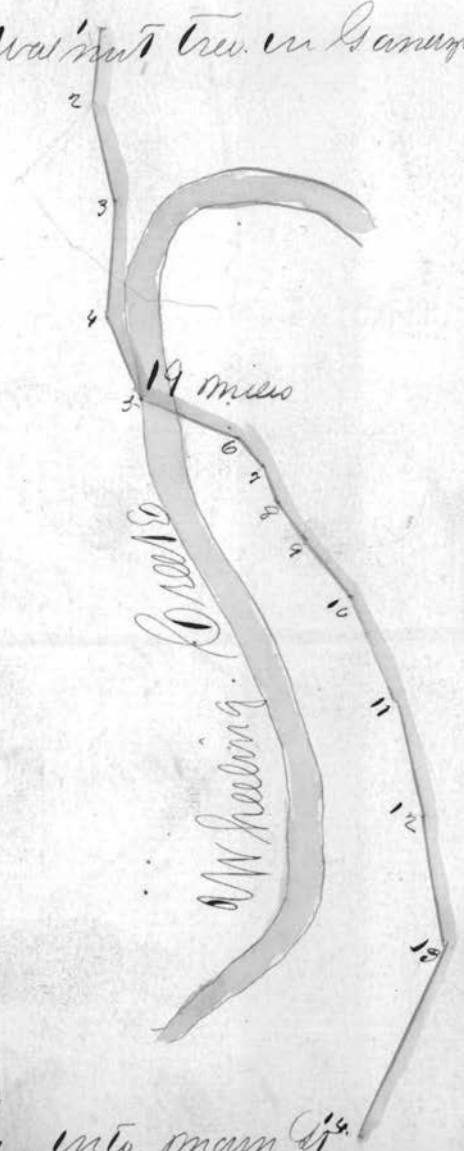

22 miles

21 Q 88 E 10
 22 Q 19 E 24 into main st
 Concluded on Page 275

Continued from Page 274

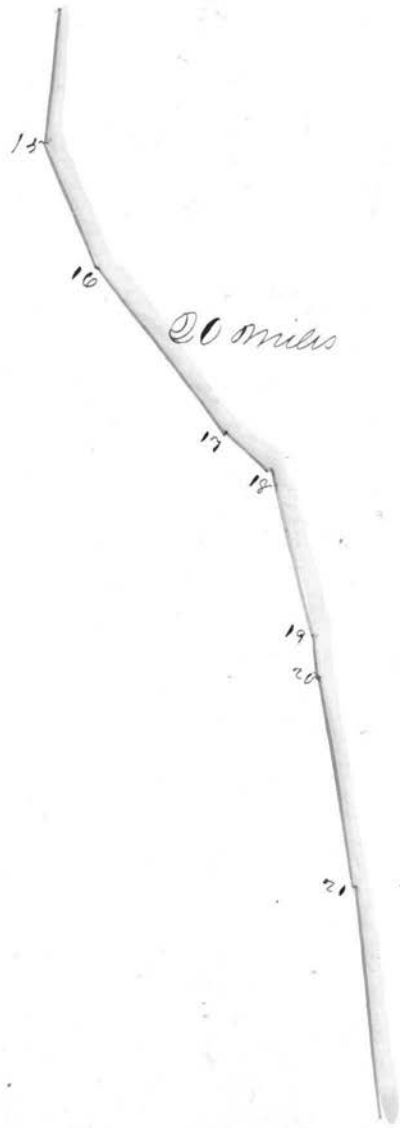

1
2
3 *21 miles on a beach*

4
5
6
7
8
9

10

11

12

13

14 *22 miles on a beach*

15

16

17

18

19

20

21

22

St. Charles river

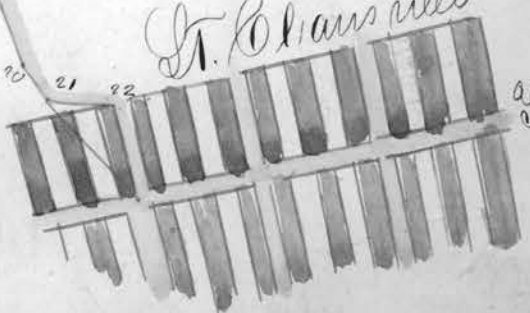

St. Charles

St. Charles

296
 That of a road beginning at a bridge over
 Robinsons fork of Millwater on Sec 16 T₉ R₂ E
 running thence to a road from Chambers
 Mill north of Amos Shephards barn thence
 to the Jewelsville road near The Sawe barn.
 As Surveyed by Charles Dehase A.D. 1845

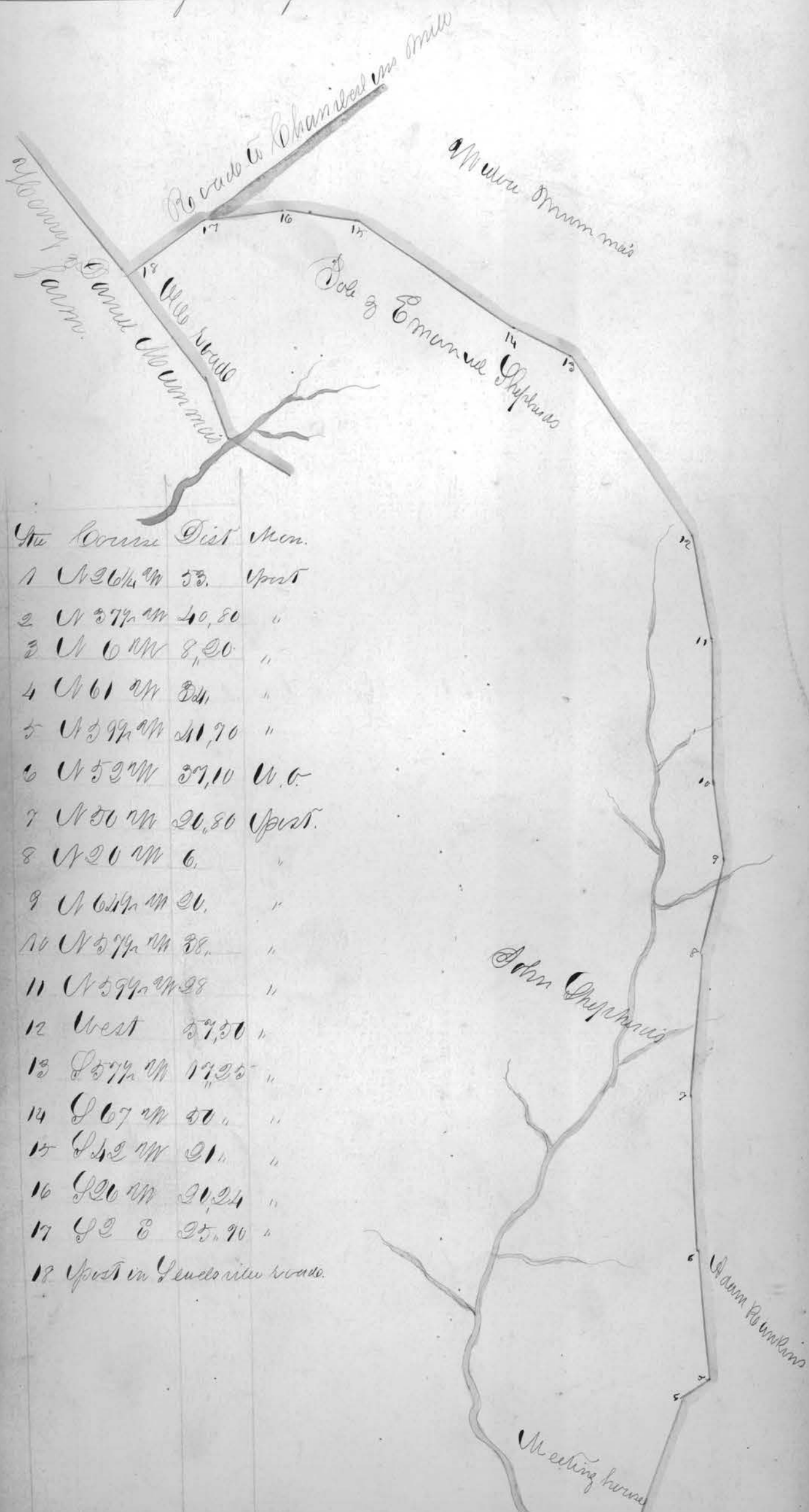

No	Bearing	Dist	Mon.
1	N 36 1/4 W	58	Upst
2	N 57 1/2 W	40, 80	"
3	N 6 W	8, 00	"
4	N 61 W	34	"
5	N 59 1/2 W	21, 70	"
6	N 53 W	37, 10	W.C.
7	N 50 W	20, 80	Upst.
8	N 20 W	6	"
9	N 64 1/2 W	20	"
10	N 57 1/2 W	38	"
11	N 59 1/2 W	28	"
12	West	57, 50	"
13	S 57 1/2 W	17, 35	"
14	S 67 W	50	"
15	S 42 W	31	"
16	S 20 W	21, 24	"
17	S 2 E	25, 70	"
18	Upst	in Jewelsville road.	

As Surveyed by Charles De Pass A.D. 1843

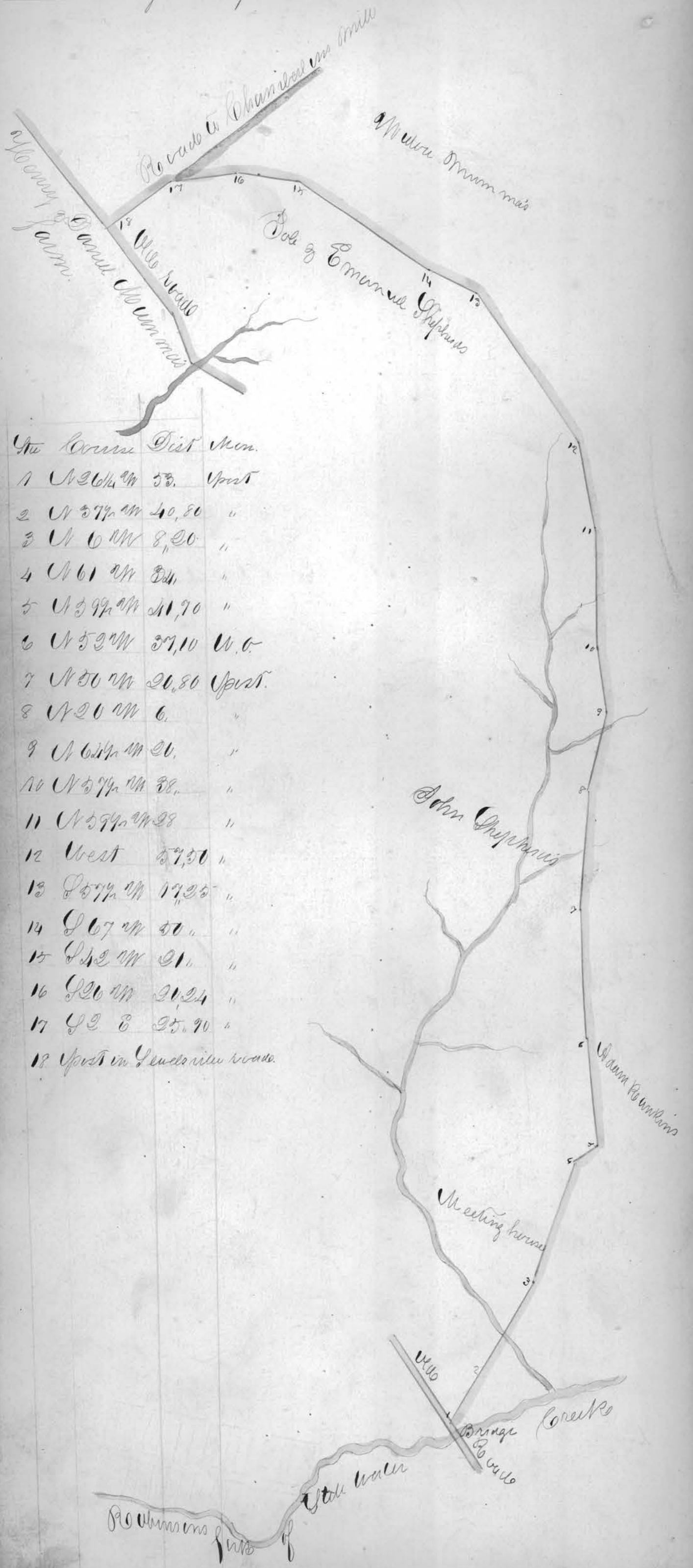

No	Course	Dist	Mon.
1	N 26 1/4 W	53	Upst
2	N 57 1/2 W	40, 80	"
3	N 6 W	8, 20	"
4	N 61 W	8 1/2	"
5	N 59 1/2 W	41, 70	"
6	N 53 W	37, 10	W. C.
7	N 50 W	20, 80	Upst.
8	N 20 W	6	"
9	N 61 1/2 W	20	"
10	N 57 1/2 W	38	"
11	N 59 1/2 W	28	"
12	West	57, 50	"
13	S 57 1/2 W	17, 25	"
14	S 67 W	50	"
15	S 42 W	21	"
16	S 20 W	20, 24	"
17	S 2 E	25, 70	"
18	Upst in General's line		

That of a road beginning at the Barnsville
 road and running thence to intersect the
 St. Charles and McWhans Creeks roads
 as Surveyed by Charles Schass A.D. 1845

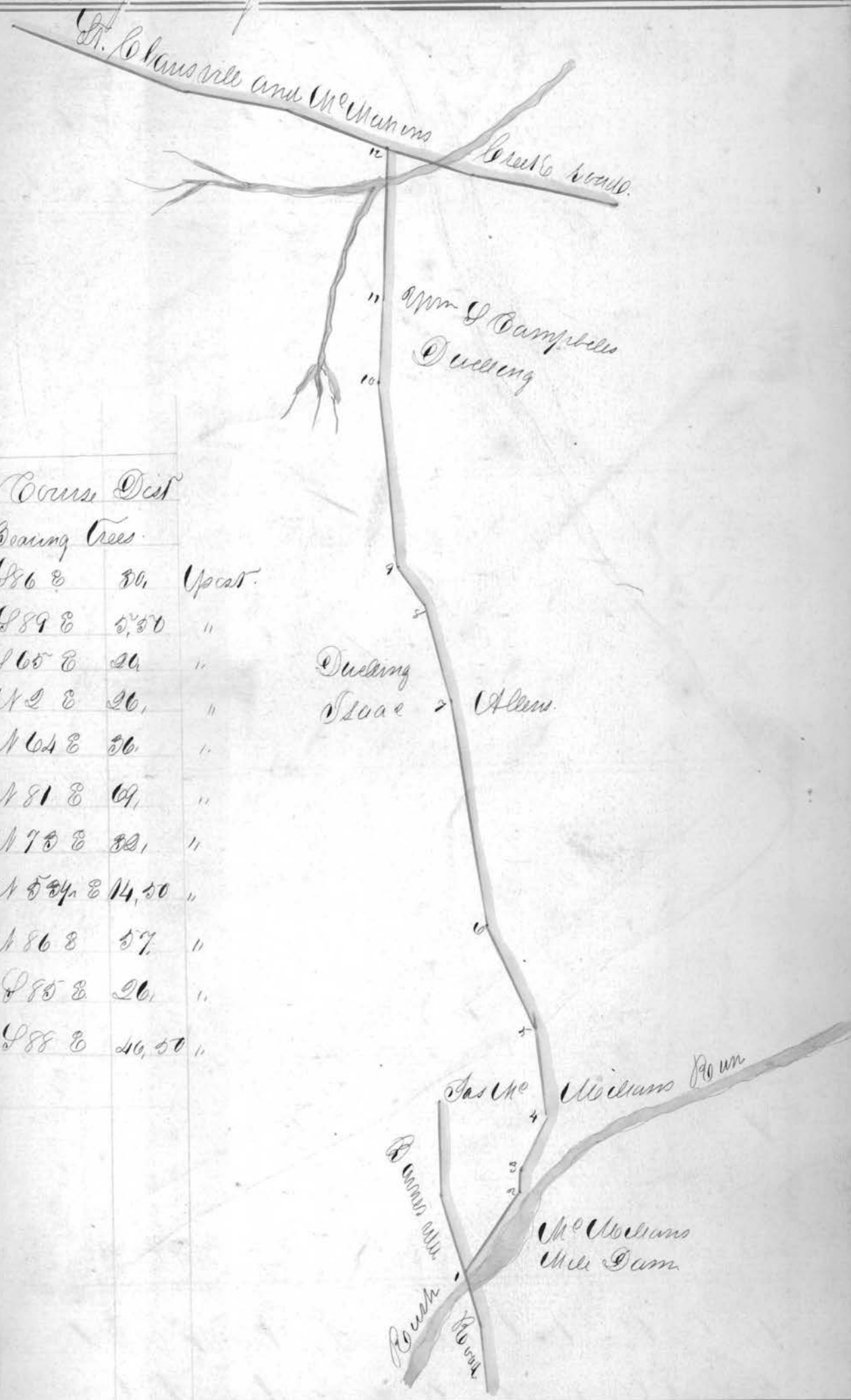

Sta Course Dist

1	Boaring Trees		
2	S 86 E	30	Up cat.
3	S 89 E	5,50	"
4	S 65 E	20	"
5	N 42 E	20	"
6	N 64 E	26	"
7	N 81 E	69	"
8	N 78 E	30	"
9	N 54 E	14,50	"
10	N 86 E	57	"
11	S 85 E	20	"
12	S 88 E	46,50	"

Dwelling
 Isaac & Allen

The Williams Run
 The Williams Mill Dam
 Barnsville Road

Plat of a road beginning on the South bank
 of McWhanons Creek, running thence past
 Pt. No. 10, to the grade road, as surveyed
 by William Shepherd, A. S., 1844

Sta	Course	Dist
1	S 13 1/2 E	13.
2	S 5 1/2 E	23.
3	S 49 E	38.
4	S 62 E	13.
5	S 78 E	26.
6	S 5 1/2 E	30.
7	S 5 1/2 E	34.
8	S 71 1/2 E	38.
9	N 68 E	38.
10	N 65 1/2 E	26.
11	N 57 E	33.

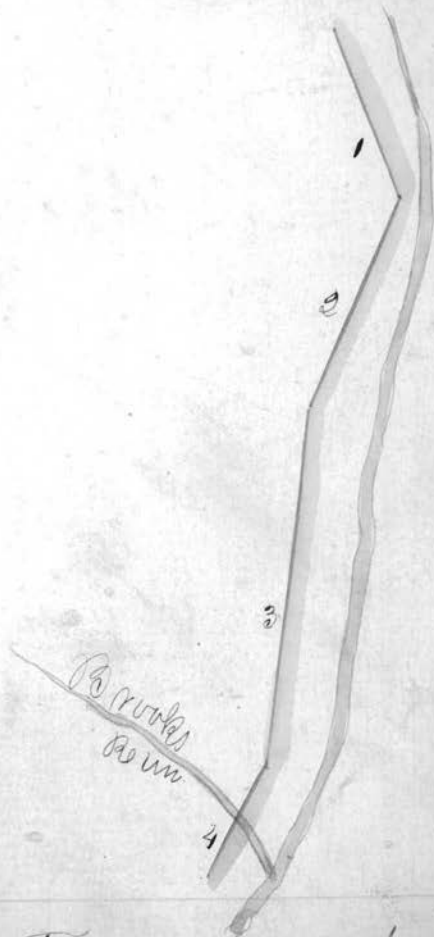

Continued on page 279.

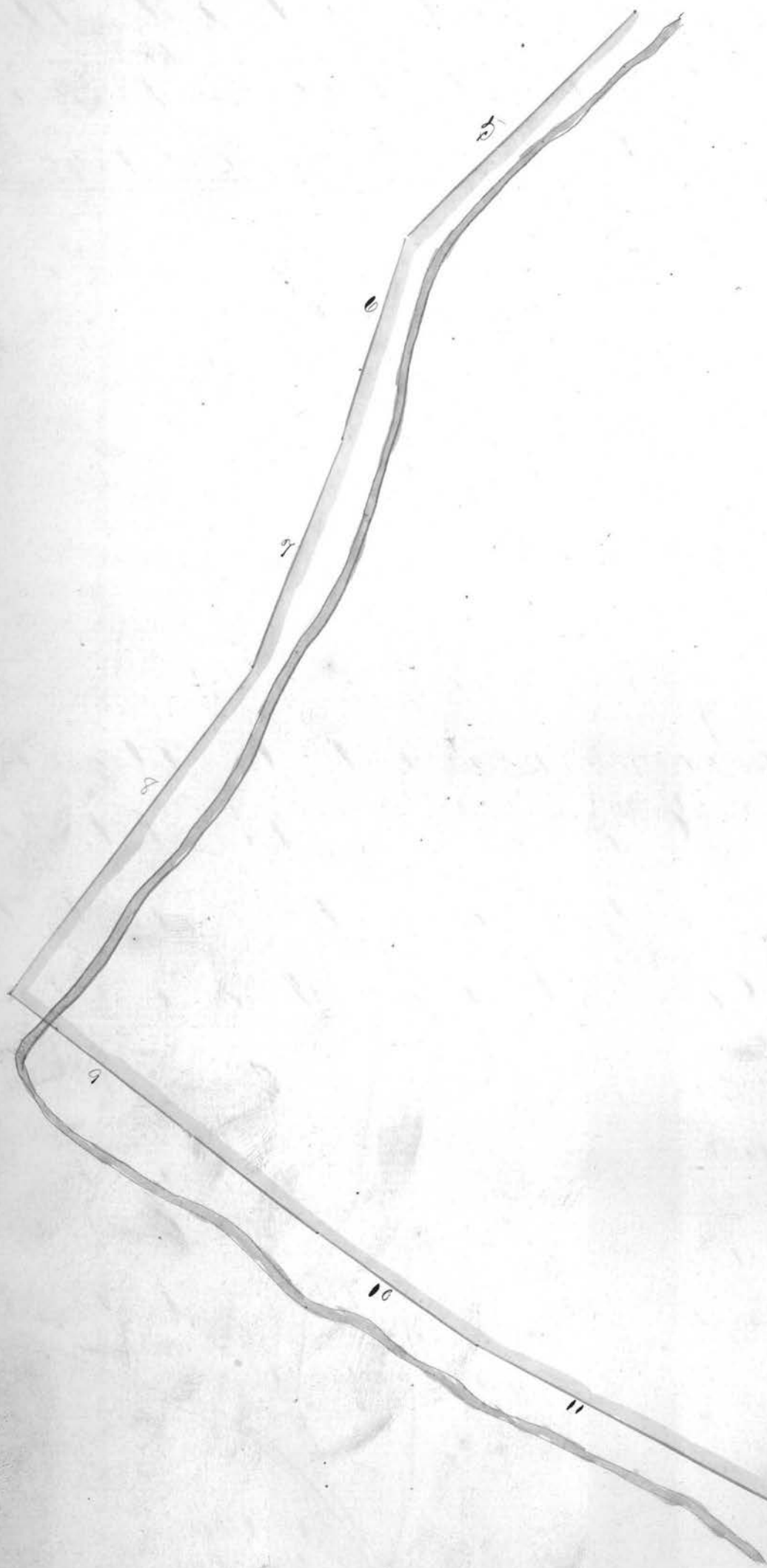

See page 278 for scale

Plan of an alteration on the County road
 from Cunninghams fording to the Jacobs
 burgh ^{Road} near St. Charville beginning at the $7\frac{1}{2}$
 mile post and ending at Thos. Harwells
 as surveyed by Charles Dehaus A. D. 1845

No	Course	Dist
1	N 77 1/2 W	21
2	N 88 1/2 W	14
3	N 20 W	29
4	N 25 W	14, 70
5	N 25 W	14, 30
6	N 39 W	8, 70
7	N 25 W	10, 50
8	N 35 W	17, 50
9	N 80 W	9, 00
10	N 65 W	7
11	N 89 W	10
12	N 21 W	28
13	N 57 W	76
14	N 60 W	27
15	N 36 W	50, 50
16	N 61 W	25
17	N 56 W	20
18	N 70 W	28
19	N 28 W	21
20	N 80 W	50
21	N 49 W	12
22	N 57 W	24
23	N 22 W	28
24	N 50 W	20
25	N 60 W	17

Thomas Harwells

Thos Harwells
 Lands

John
 Mcvinnens
 Lands

Cont. on p 280