

Continued from page 209

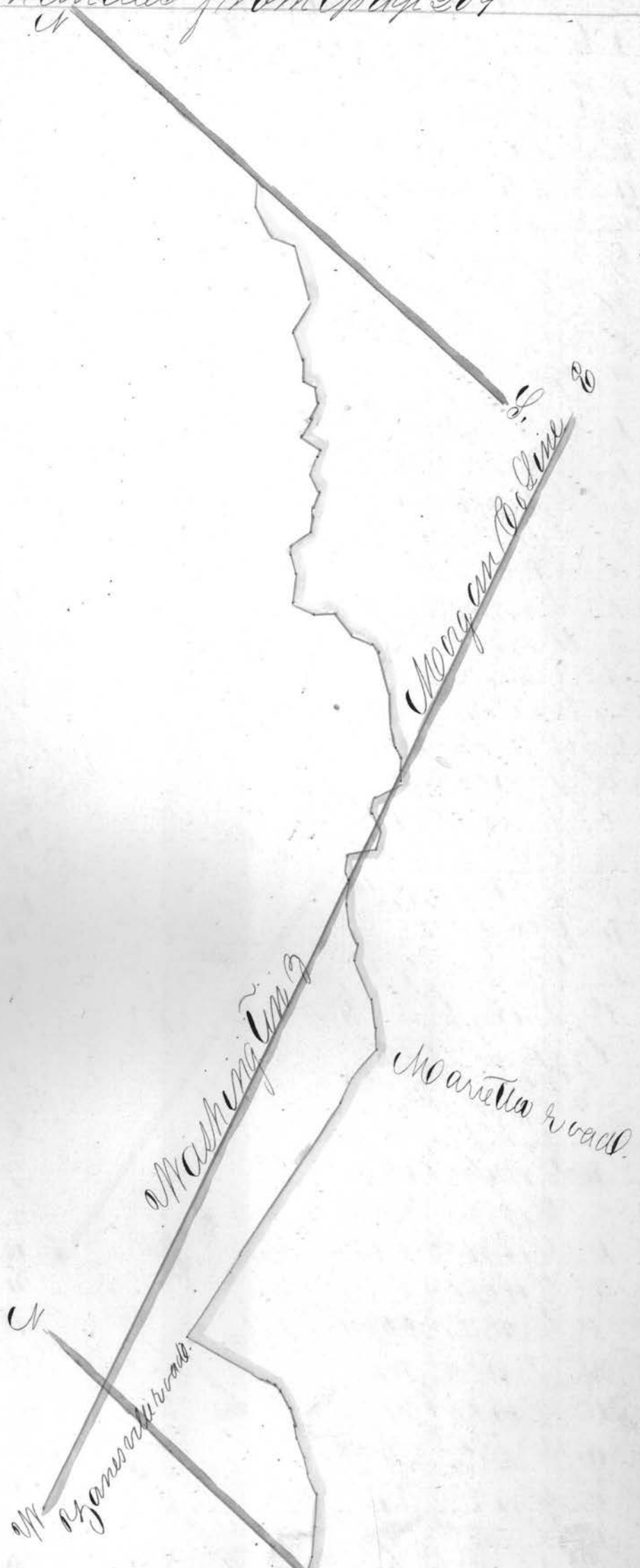

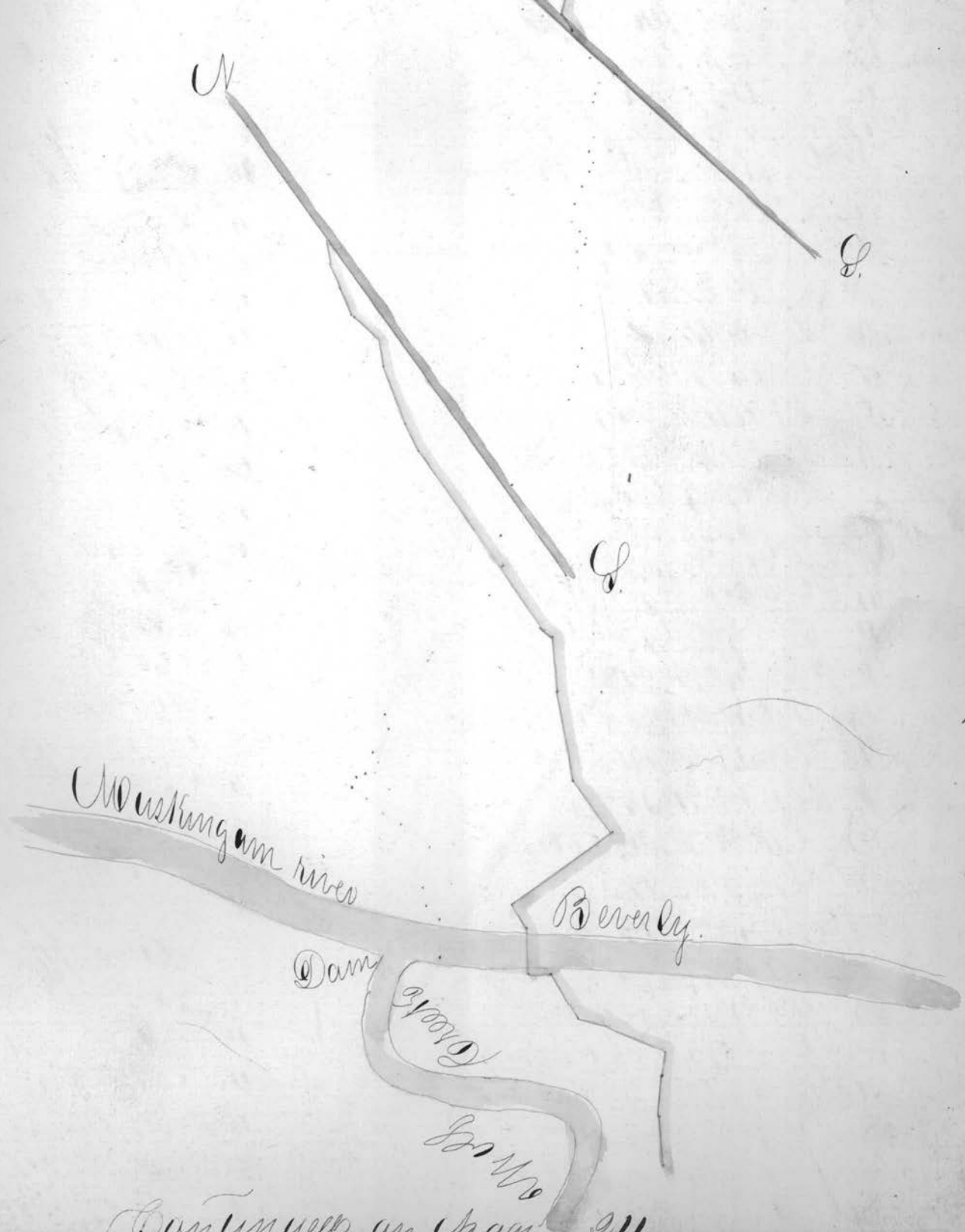

S.

S.

S.

Westlingam river

Dam

Brook

Saw

Beverly

Continued on page 111

Continued from page 910.

7	♂	79 1/2 W	20
8	♂	71 W	13.5
9	♂	20 1/2 W	34.5
10	♂	61 W	30
11	♂	54 W	9
12	♂	99 1/2 E	32
13	♂	3 1/2 E	12
1	Same		12
2	♂	17 W	28
3	♂	10 W	16
4	♂	17 W	19
5	♂	7 W	69
6	♂	18 W	68
7	♂	60 W	53
8	♂	10 1/4 W	21
9	♂	79 W	14
1	Same		12
2	♂	399 1/2 W	37.5
3	♂	179 W	55
4	♂	12 1/2 W	18.5
5	♂	73 1/2 W	23
6	U	739 1/2 W	12
7	♂	81 W	21.5
8	♂	209 1/2 W	31
9	♂	5 E	9.5
10	♂	20 1/2 W	21.75
11	♂	33 W	38
12	♂	28 1/2 W	9
13	♂	199 1/2 W	3
1	Same		9.5
2	♂	9 W	10.5
3	♂	3 W	13
4	♂	3 1/2 W	13
5	♂	38 W	5.5
6	♂	84 1/2 W	5.5
7	♂	309 1/2 W	3.85

76 miles

77 miles

78 miles

2	♂	20 1/2 W	31
3	♂	239 1/2 W	25
4	♂	66 W	78
5	♂	38 W	20.4
6	♂	209 1/2 W	11.6
1	Same		100
2	♂	21 1/2 W	24
3	♂	80 1/2 W	30
4	U	89 1/2 W	39
5	♂	23 W	27
6	♂	249 1/2 W	20
1	♂	18 W	12
2	♂	38 1/2 W	18
3	♂	33 1/2 W	32.3
4	♂	4 W	11.7
5	U	89 W	32
6	U	64 W	10
7	U	83 W	84
8	U	83 W	33
9	U	73 W	16
10	♂	78 W	18
11	♂	89 W	36
12	U	87 W	23
13	U	40 W	33
14	U	68 W	2
1	Same		20
2	U	81 W	64
3	♂	64 W	54
4	♂	88 1/2 W	24
5	U	83 1/2 W	31
6	♂	28 1/2 W	17
7	♂	37 W	24
8	♂	27 1/2 W	64
9	♂	399 1/2 W	8.3
10	♂	209 1/2 W	73
11	♂	83 W	33

82

83

84

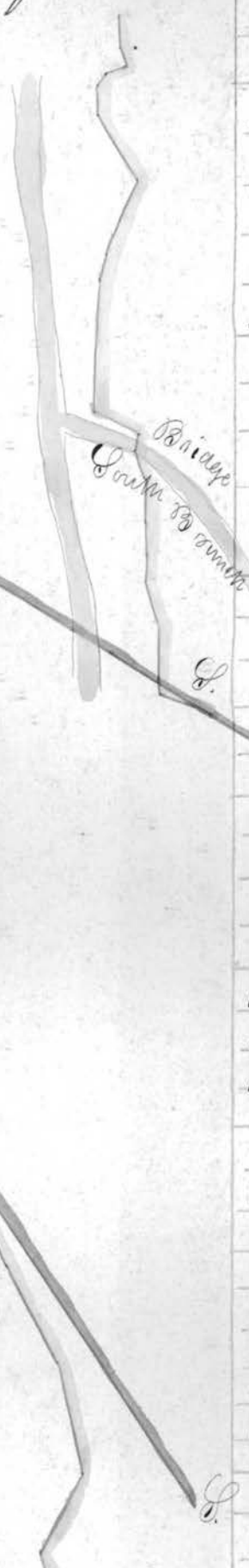

- 8 8 10 8 6.65
- 9 8 10 21 10.5
- 10 8 80 21 25
- 11 8 82 21 29
- 12 8 19 21 14
- 13 8 22 21 8
- 14 8 18 21 14
- 15 8 24 21 72
- 16 8 21 21 34
- 17 8 29 21 20
- 18 8 11 21 23
- 1 8 18 21 08
- 2 8 24 21 21
- 3 8 1 21 218
- 4 8 50 21 10
- 5 8 14 21 25
- 6 8 17 21 34
- 7 8 38 21 9.2
- 8 8 20 21 6.45
- 9 8 29 21 5.2
- 10 8 80 21 10.75
- 11 8 83 21 18
- 12 U 89 21 12
- 13 U 84 21 27.5
- 14 8 31 21 30.5 U
- 15 8 11 21 11
- 16 8 82 21 14.5
- 17 8 30 21 20.5-80m
- 1 8 33 21 11
- 2 8 26 21 19
- 3 8 12 21 34
- 4 8 31 21 90
- 5 8 33 21 38
- 6 8 37 21 35
- 7 8 2 21 32.85
- 8 U 88 21 89.15
- 1 U 89 21 44



- 11 88 21 22
- 12 86 21 18
- 1 87 21 20
- 2 U 77 21 19
- 3 U 73 21 11
- 4 U 80 21 24
- 5 U 73 21 16
- 6 U 80 21 10
- 7 U 89 21 20
- 8 86 21 29
- 9 83 21 10.65
- 10 83 21 6.6
- 11 88 21 7.5
- 12 88 21 7.85
- 13 88 21 6.6
- 14 81 21 5.7
- 15 89 21 9.9
- 16 80 21 19
- 17 81 21 7.5
- 18 83 21 23.5
- 19 88 21 30
- 20 83 21 16
- 21 87 21 10
- 1 86 21 29
- 2 86 21 25
- 3 U 89 21 14
- 4 U 80 21 23
- 5 89 21 3.31
- 6 83 21 19.9
- 7 80 21 12
- 8 80 21 29
- 9 84 21 28.3
- 10 82 21 12.7
- 11 87 21 17
- 12 89 21 29
- 13 87 21 24
- 1 Same 20

85

86

87



Continued from page 911

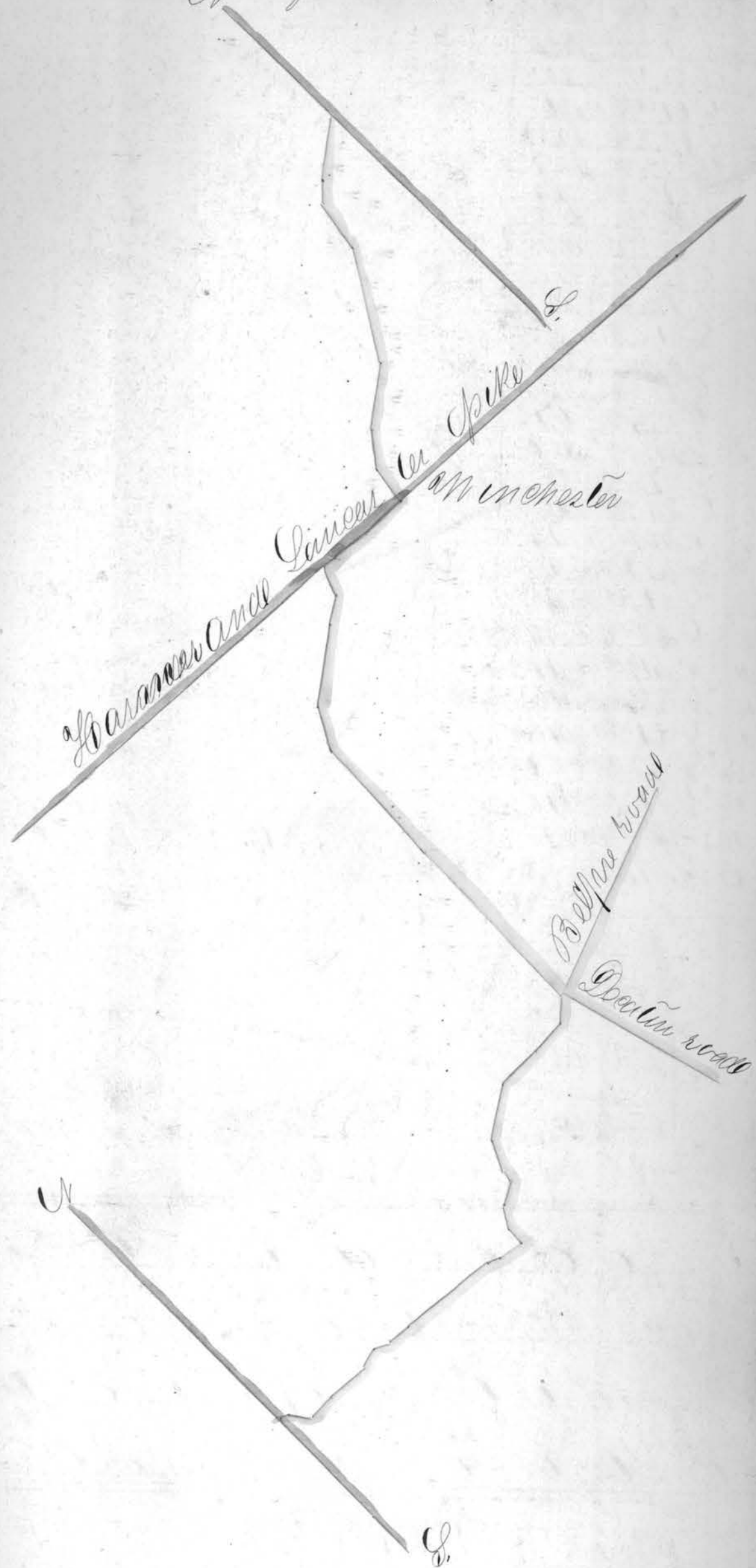

N

S

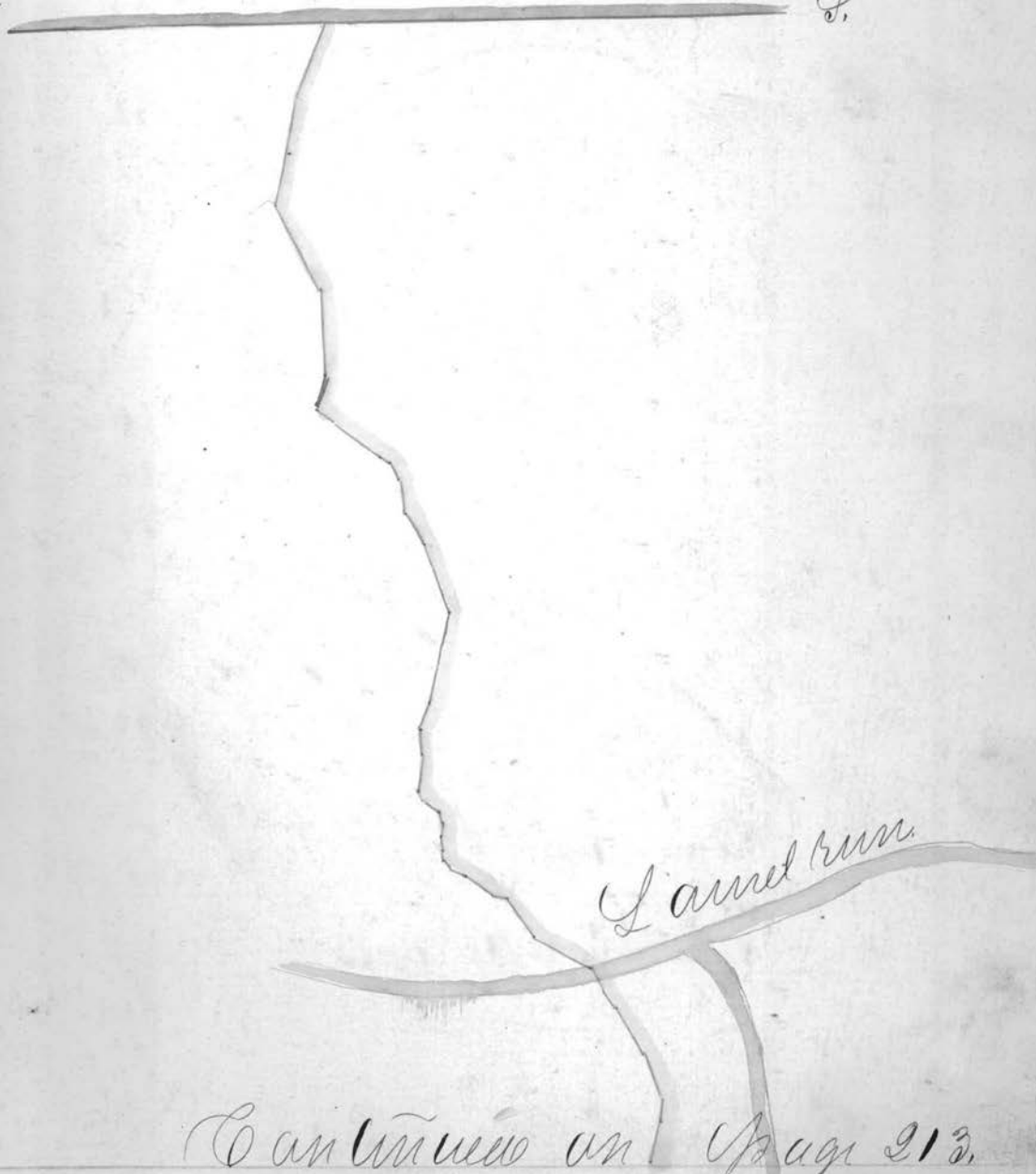

Continued on Page 213.

Continued from page 012.

2	884 AM	20.
3	881 AM	20.
4	870 AM	20.
5	861 AM	20.
6	850 1/2 AM	19.25
7	838 1/2 AM	15.7
8	831 1/2 AM	2.4
9	823 AM	6.3
10	813 AM	16.25
11	802 AM	17.
12	791 1/2 AM	27.
13	781 AM	8.
14	Same	20.
15	778 AM	7.25
16	767 1/2 AM	6.15
17	759 1/2 AM	10.6
18	749 1/2 AM	20.
19	741 AM	16.
20	734 1/2 AM	12.
21	728 1/2 AM	10.
22	721 1/2 AM	10.
23	713 AM	27.
24	704 1/2 AM	11.
25	696 1/2 AM	10.
26	681 AM	20.
27	678 AM	20.
28	666 AM	20.
29	658 AM	18.
30	649 1/2 AM	23.

88 miles

319 miles

Prussian tow.

Graded road from Manama to Athens.

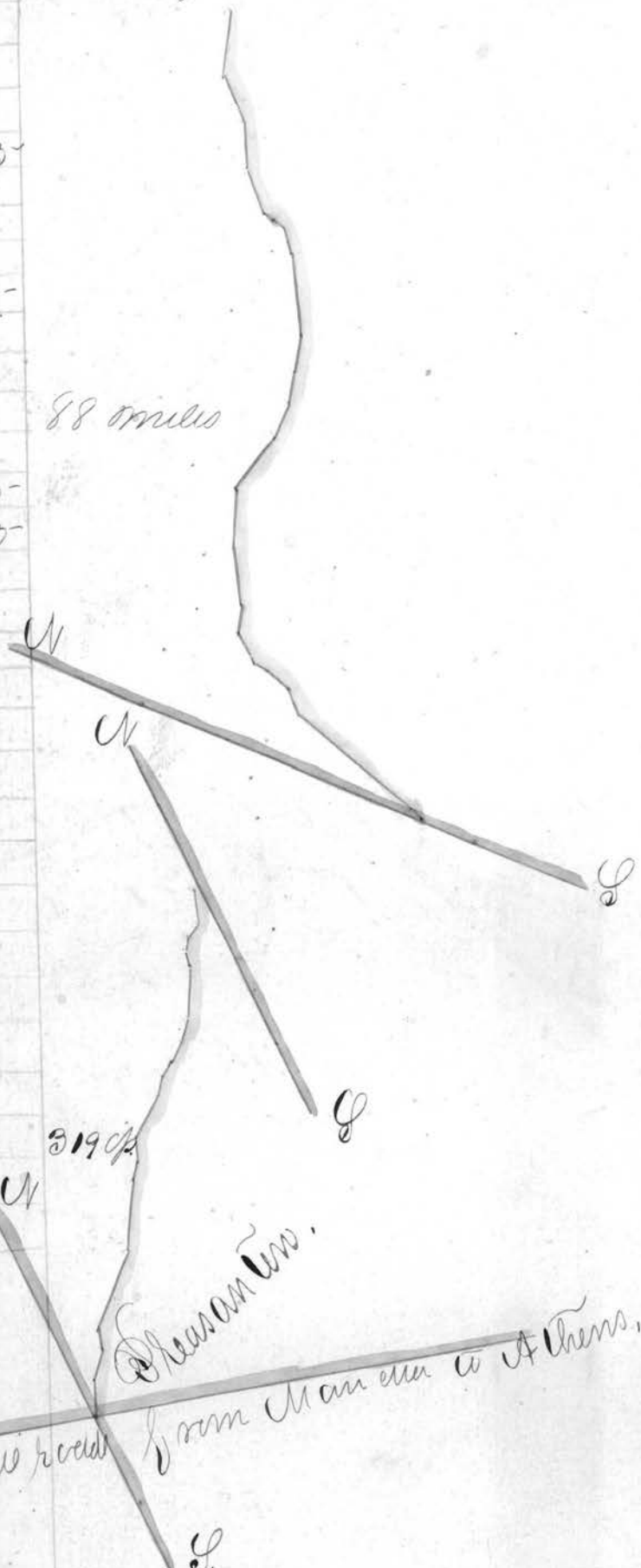

Plat of a road beginning on the road  
 from Belmont to Barnesville at John Greas  
 and ends on the road from Morristown to  
 Somerton as surveyed by Thomas Lewis 1840

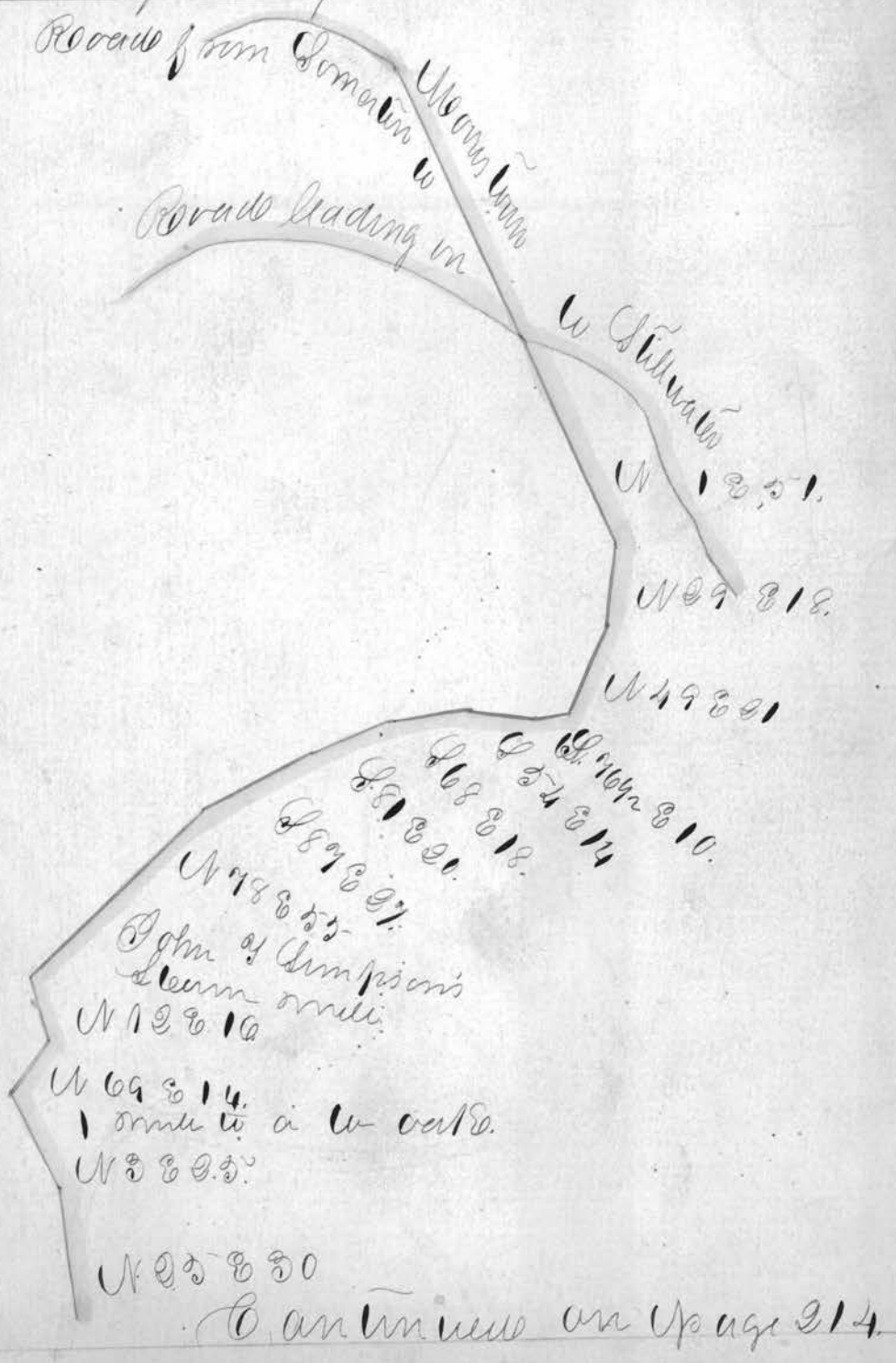



Continued from Page 213  
W 75810.

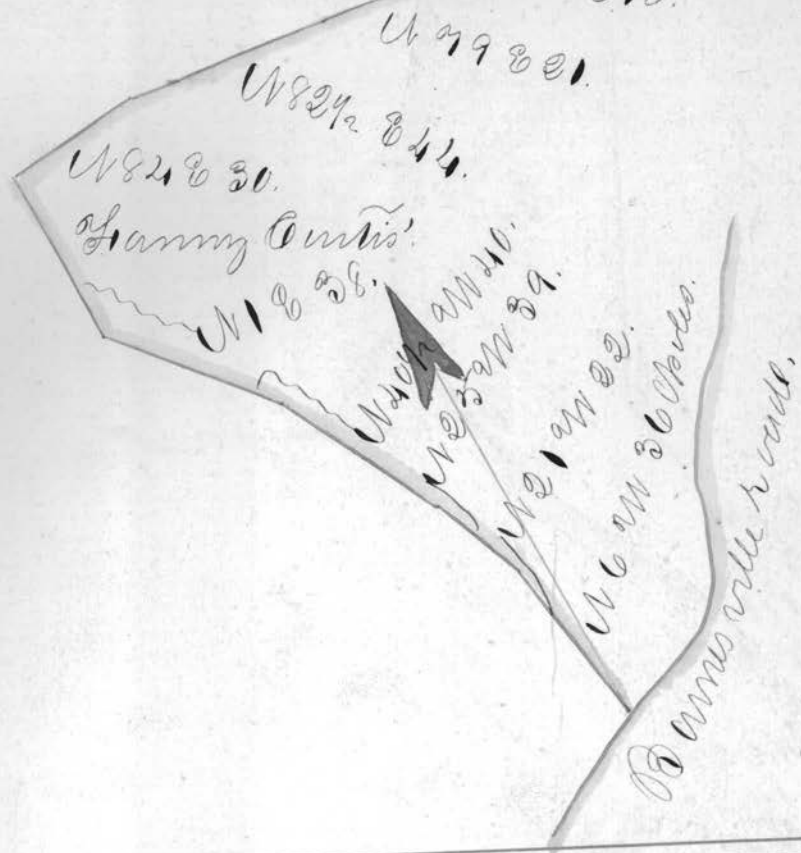

Plot of a County road beginning near Centre  
ville and running thence to the Ohio river near  
Moanys river Ferry as surveyed by James  
C Moore A.D. 1840s.

# Ohio River

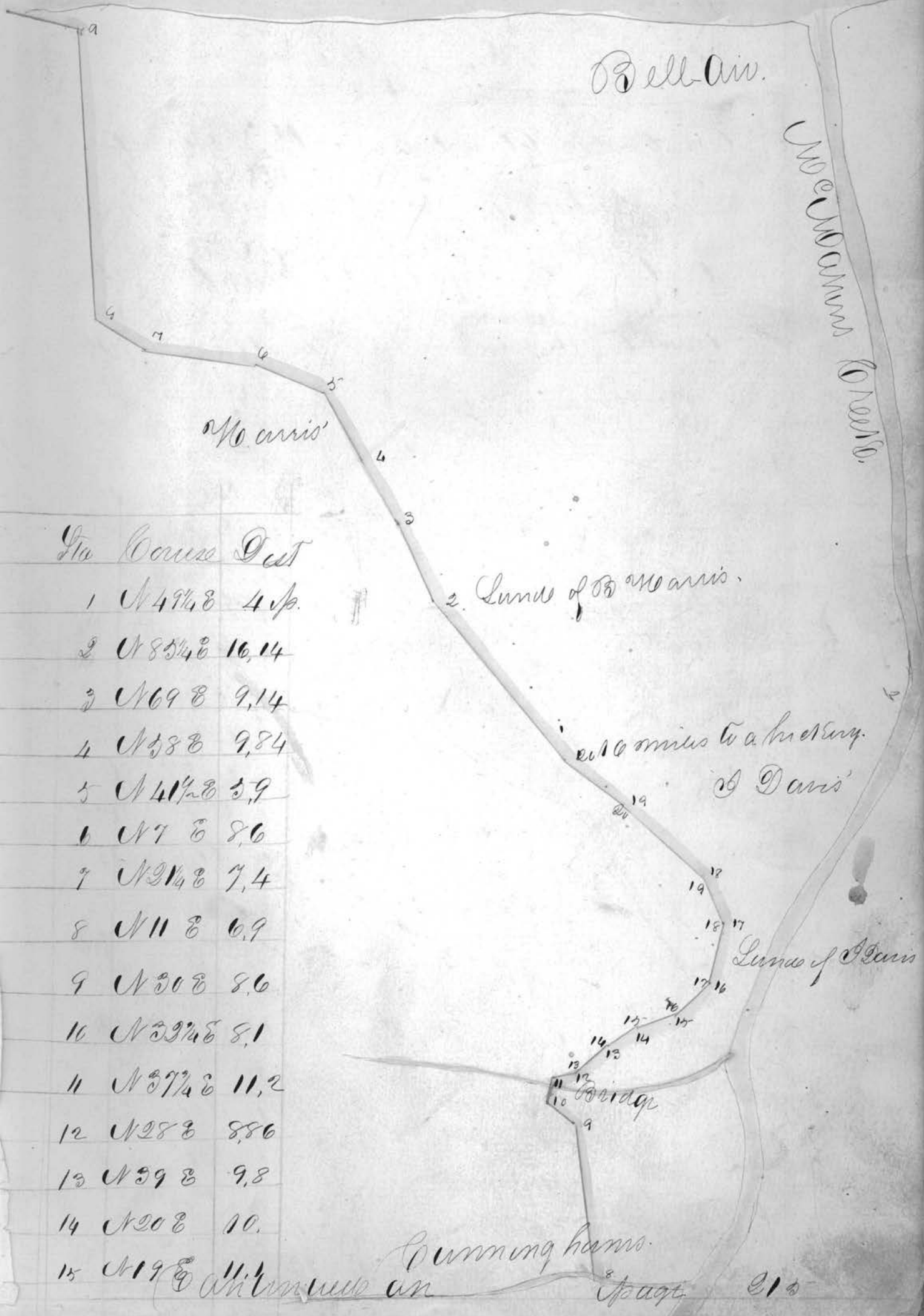

Continued from Page 214

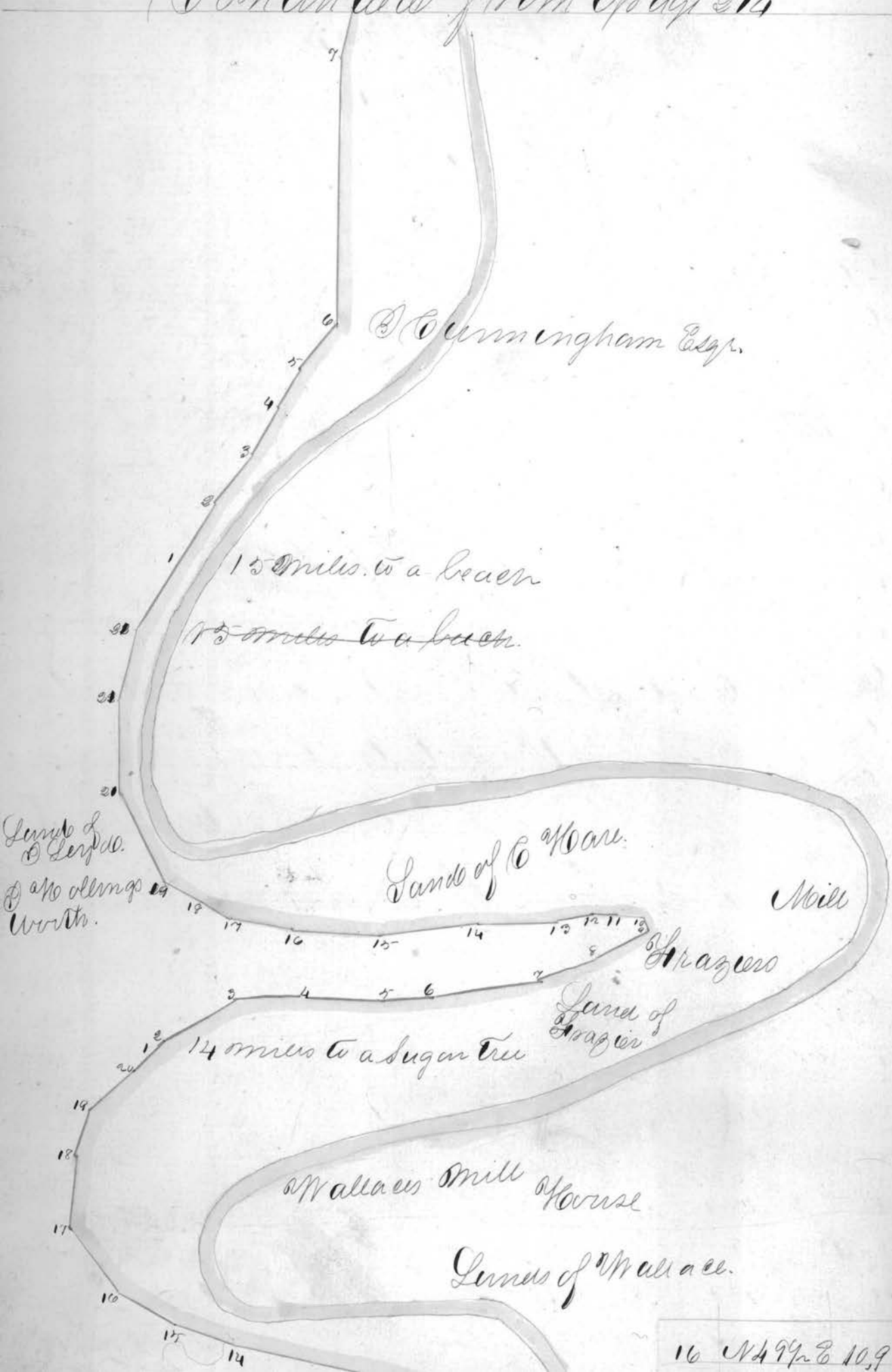

© Cornish.

Lands of Alexander

Ro Morris  
His house

Lands of Robert Morris

13 miles to a Beach.

Lands of Jas Willigan

Continued on page 216.

- 17 N 64 1/2 E 6, 36
- 18 N 56 1/2 E 8, 4
- 19 N 45 E 11, 7
- 20 N 60 E 9, 66
- 21 N 78 1/4 E 9, 3
- 22 N 40 E 14, 36
- 23 N 85 1/4 E 23, 1
- 24 S 75 1/4 E 14,
- 25 S 85 1/4 E 18,
- 26 S 66 E 16,
- 27 S 55 1/2 E 20, 7
- 28 S 33 E 17, 44
- 29 S 53 1/2 E 4, 5 1/2 m.
- 1 S 10m 19, 7
- 2 S 86 E 9, 1
- 3 N 65 1/4 E 24, 2
- 4 N 79 E 16, 6
- 5 S 55 E 12, 8
- 6 S 67 E 11, 3
- 7 S 87 1/2 E 8, 8
- 8 N 45 1/2 E 9, 4
- 9 S 83 1/4 E 2, 4
- 10 S 6 E 4, 5
- 11 S 43 E 5,
- 12 S 66 1/2 E 13, 5
- 13 S 63 1/2 E 12,
- 14 S 51 1/4 E 19, 2
- 15 S 47 1/4 E 7, 4

Continued from page 215.

16 S 63 1/2 E 11.

17 S 66 E 10,5

18 S 70 1/2 E 5,8

19 N 71 1/2 E 25,3

20 N 75 E 27,

21 N 80 E 6.

22 N 87 E 9,4

23 N 75 E 7,

24 S 82 E 29.

25 S 59 E 27,5

26 S 72 1/4 E 16.9 3 miles

1 Same 10,6

2 S 89 E 9,6

3 S 88 E 23,

4 S 48 E 29,5

5 N 57 1/2 E 20,3

6 N 88 E 17,8

7 N 93 W 6.

8 N 8 E 15,4

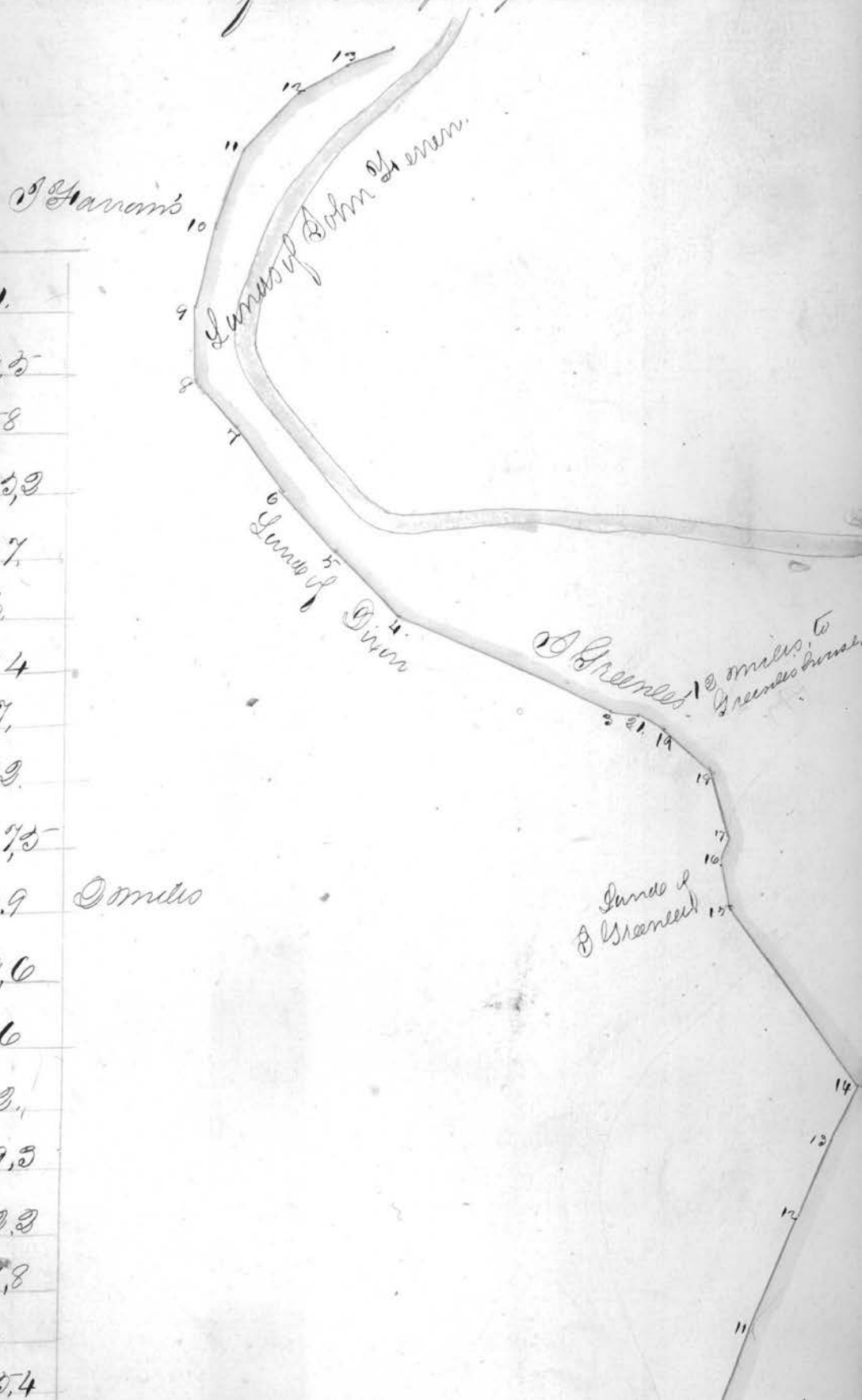



- 8 N 88 E 15,4
- 9 N 138 E 11,8
- 10 N 23 1/2 E 12,1
- 11 N 25 E 15,6
- 12 N 17 E 21,4
- 13 N 22 E 14,5
- 14 N 88 1/2 E 25 - Barn
- 15 N 31 1/2 E 18,8
- 16 N 20 1/2 E 3,36
- 17 N 33 E 21,2
- 18 N 37 1/4 E 3,246

Little Mill  
to river

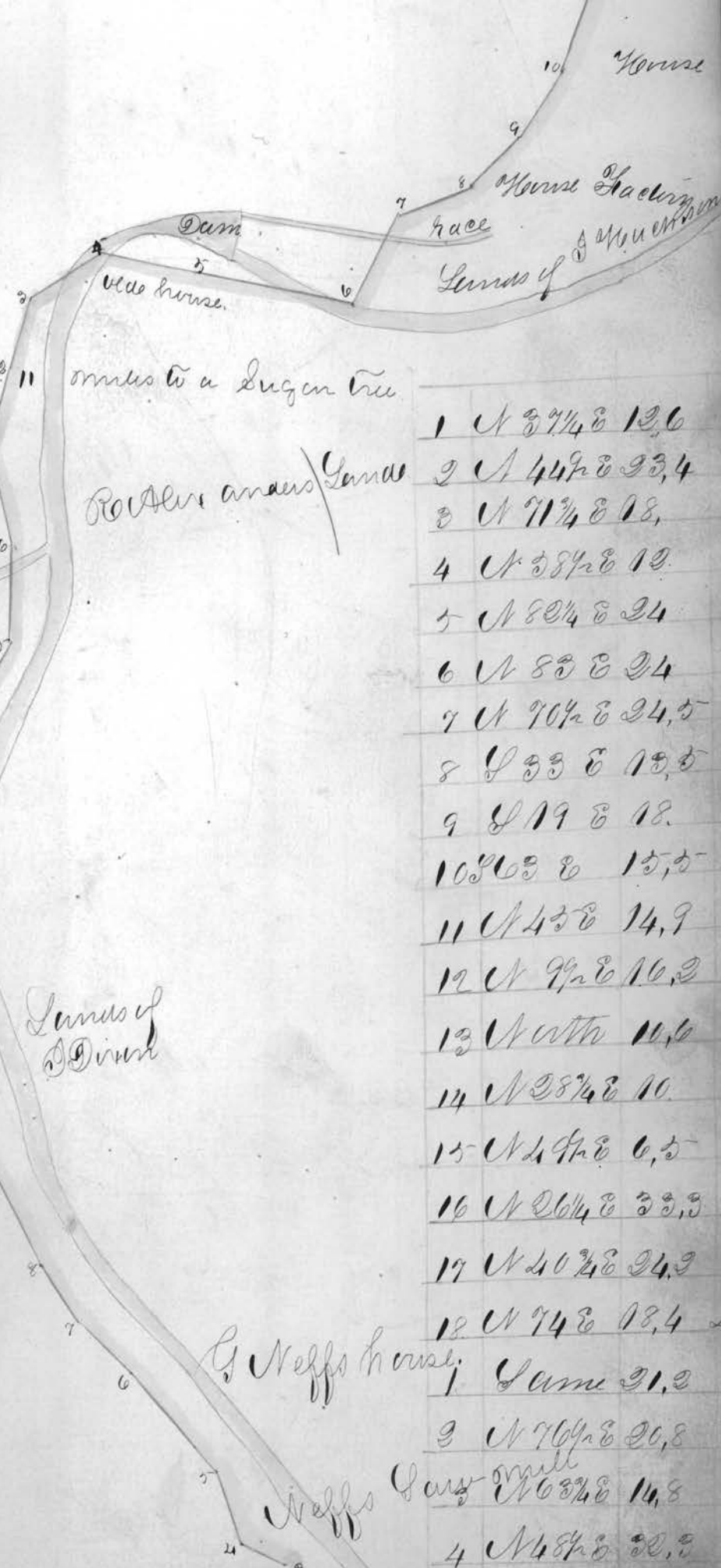

- 1 N 37 1/4 E 12,6
- 2 N 44 1/2 E 23,4
- 3 N 71 1/4 E 18,
- 4 N 58 1/2 E 19,
- 5 N 80 1/4 E 24
- 6 N 83 E 24
- 7 N 70 1/2 E 24,5
- 8 S 33 E 15,5
- 9 S 19 E 12,
- 10 S 63 E 15,5
- 11 N 45 E 14,9
- 12 N 99 E 16,2
- 13 N with 11,6
- 14 N 28 1/4 E 10,
- 15 N 49 1/2 E 6,5
- 16 N 26 1/4 E 23,3
- 17 N 40 1/4 E 24,9
- 18 N 74 E 12,4
- 1 Same 21,2
- 2 N 76 1/2 E 20,8
- 3 N 63 1/4 E 14,8
- 4 N 48 1/2 E 22,5

Continued on page 31

Can Finned from Page 216.

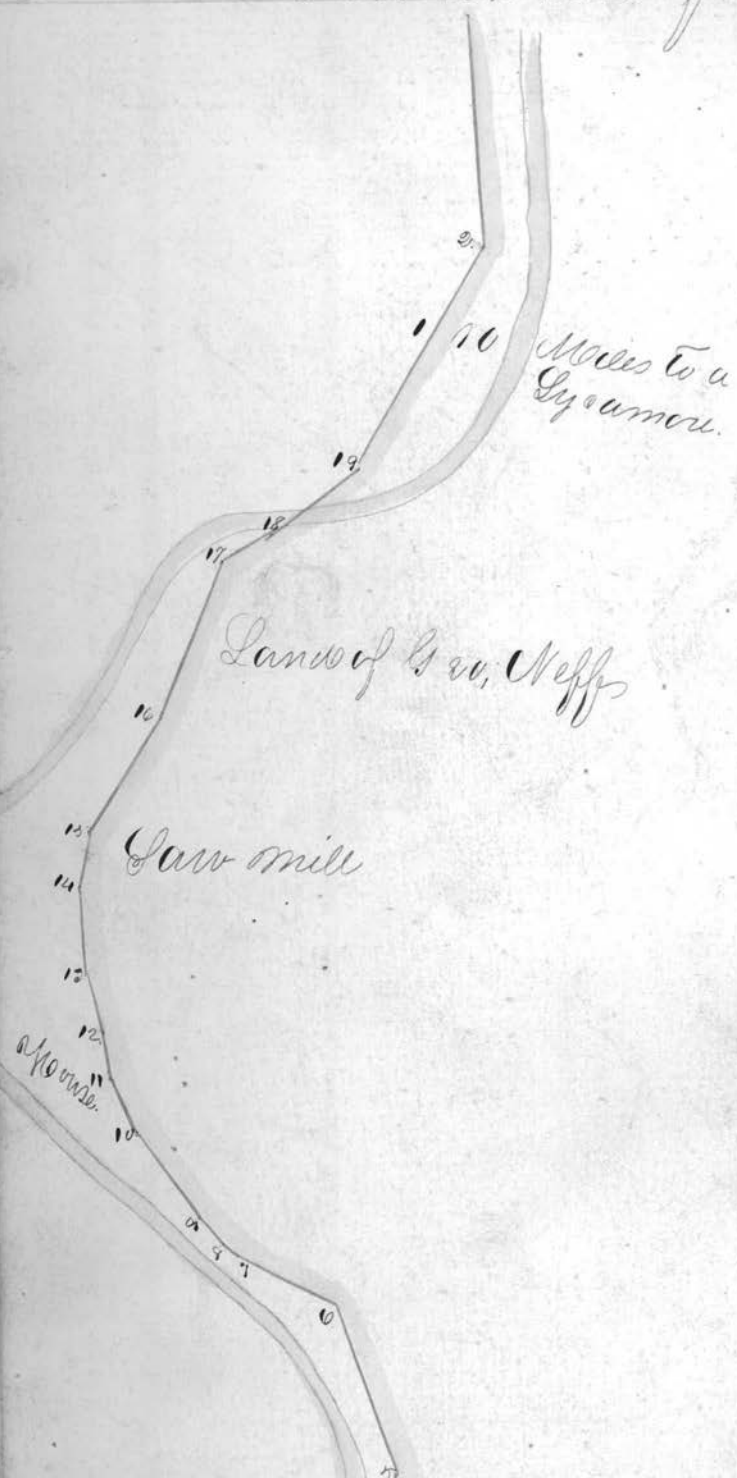

1	S 79 1/2 E	8.
2	N 69 E	14,6
3	N 70 E	13.
4	N 80 E	10,4
5	N 67 1/2 E	14.
6	N 62 3/4 E	17,5
7	N 71 1/4 E	19,5
8	S 82 E	26,1
9	S 62 1/2 E	16,2
10	S 55 E	10,5
11	S 49 E	9,1
12	S 57 1/4 E	9,3
13	S 33 1/2 E	10,6
14	N 75 1/2 E	14,5
15	N 50 1/2 E	13,7
16	N 44 1/2 E	20,4
17	N 29 1/2 W	18,5
18	N 34 W	27.
19	N 30 3/4 W	6,4
20	N 1 1/4 W	10,8.
21	N 19 W	14,2
22	N 35 3/4 W	13,5
1	N 4 1/4 E	18,8



- 22 N 33 1/4 E 15.5 7m
- 1 N 4 1/2 E 18.8
  - 2 N 6 1/4 E 20.4
  - 3 N 8 3/4 E 18.8
  - 4 S 8 1/4 E 18.1
  - 5 S 7 3/4 E 18.
  - 6 S 7 3/4 E 18.8
  - 7 S 8 3/4 E 9.
  - 8 S 5 3/4 E 14.2
  - 9 S 3 3/4 E 14.9
  - 10 S 3 1/4 E 18.3
  - 11 S 5 0 E 18.3
  - 12 S 5 1/4 E 20.
  - 13 N 5 8 1/4 E 18.6
  - 14 N 4 4 E 17.2
  - 15 N 3 7 1/4 E 8.
  - 16 N 3 3 1/2 E 18.3
  - 17 N 3 7 1/4 E 20.9
  - 18 N 2 5 E 14.5
  - 19 N 3 3 1/4 E 15.5
  - 20 S 8 5 1/4 E 18.3
  - 21 S 7 1 E 7.4
  - 22 S 2 1 1/2 E 11.2 8m
  - 1 S 4 E 10.4
  - 2 S 8 1/2 E 18.5
  - 3 S 3 1/4 E 17.3
  - 4 N 8 0 E 6.9
  - 5 N 4 6 E 20.3
  - 6 N 13. E 11.5
  - 7 N 5 1/4 W 19.1
  - 8 N 4 9 1/2 E 28.6
  - 9 N 6 0 1/2 E 33.
  - 10 S 8 E 30
  - 11 S 8 3/4 E 16

- 6 N 8 1/2 W 21.8
  - 7 N 11 W 23.6
  - 8 N 14 E 27.4
  - 9 N 5 5 E 23.3
  - 10 N 2 3 E 22.6
  - 11 N 3 1/4 E 20.
  - 12 N 11 1/2 E 20.3 5 miles
  - 1 Same 7.3
  - 2 N 4 5 E 17.8
  - 3 N 6 2 E 18.8
  - 4 S 7 8 E 31.
  - 5 S 6 1 E 17.5
  - 6 N 8 5 E 6.6
  - 7 N 6 E 30.
  - 8 S 8 1 1/4 E 21
  - 9 S 6 5 1/4 E 33.4
  - 10 S 5 3 1/2 E 7.
  - 11 S 3 0 1/2 E 26.2
  - 12 S 8 5 E 18.
  - 13 N 7 4 1/2 E 30.7
  - 14 N 8 E 16.3
  - 15 House
- Continued on page 218.



# Continued from page 217

12	N 79 1/2 E	10.9
13	N 88 E	7.4
14	N 9 3/4 W	10.9
15	N 33 W	8.2
16	N 20 3/4 W	10.7
17	N 41 1/2 W	13.8
18	N 79 W	13.1
19	N 13 1/4 W	6.8
1	Same	14.3
2	N 68 E	25.3
3	N 84 3/4 E	26.2
4	N 71 E	17.6
5	N 43 E	28.5
6	N 1 E	16.1
7	N 8 1/2 W	8.1
8	N 30 1/4 E	8.6
9	N 27 1/2 E	16.1
10	N 38 1/4 E	9.3
11	N 50 1/2 E	7
12	N 45 E	10.2
13	N 60 E	13.2
14	N 71 E	8.4
15	N 80 E	22.6
16	N 84 1/2 E	23.9
17	N 84 E	8

9 m.



W. V. V. house.

Corner of W. V. V.

7 miles to a Sugar Tree.

P. P. map house.

Corner of Lot 9 Mrs. B. B.

18	U 649 8	17.5	
19	U 888 8	24.8	10 am
1	Same	15.2	
2	U 588 8	30.0	
3	U 177 8	9.2	
4	U 668 8	15.2	
5	U 48 1/4 8	30.8	
6	U 399 2 8	14.4	
7	U 508 8	14.1	
8	U 38 3/4 8	20.0	
9	U 599 2 8	8.1	
10	U 679 8	6.9	
11	U 74 8	24.4	
12	U 54 8	5.8	
13	U 84 1/2 8	35.4	
14	U 65 8	34.3	
15	East	19.	
16	U 749 8	19.2	
17	U 83 1/2 8	14.7	11 am
1	Same	2.9	
2	U 98 3/4 8	13.5	
3	U 40 8	17.2	
4	U 8 am	19.8	
5	U 8 3/4 am	33.2	
6	U 69 8	19.2	
7	U 23 1/2 8	16.4	

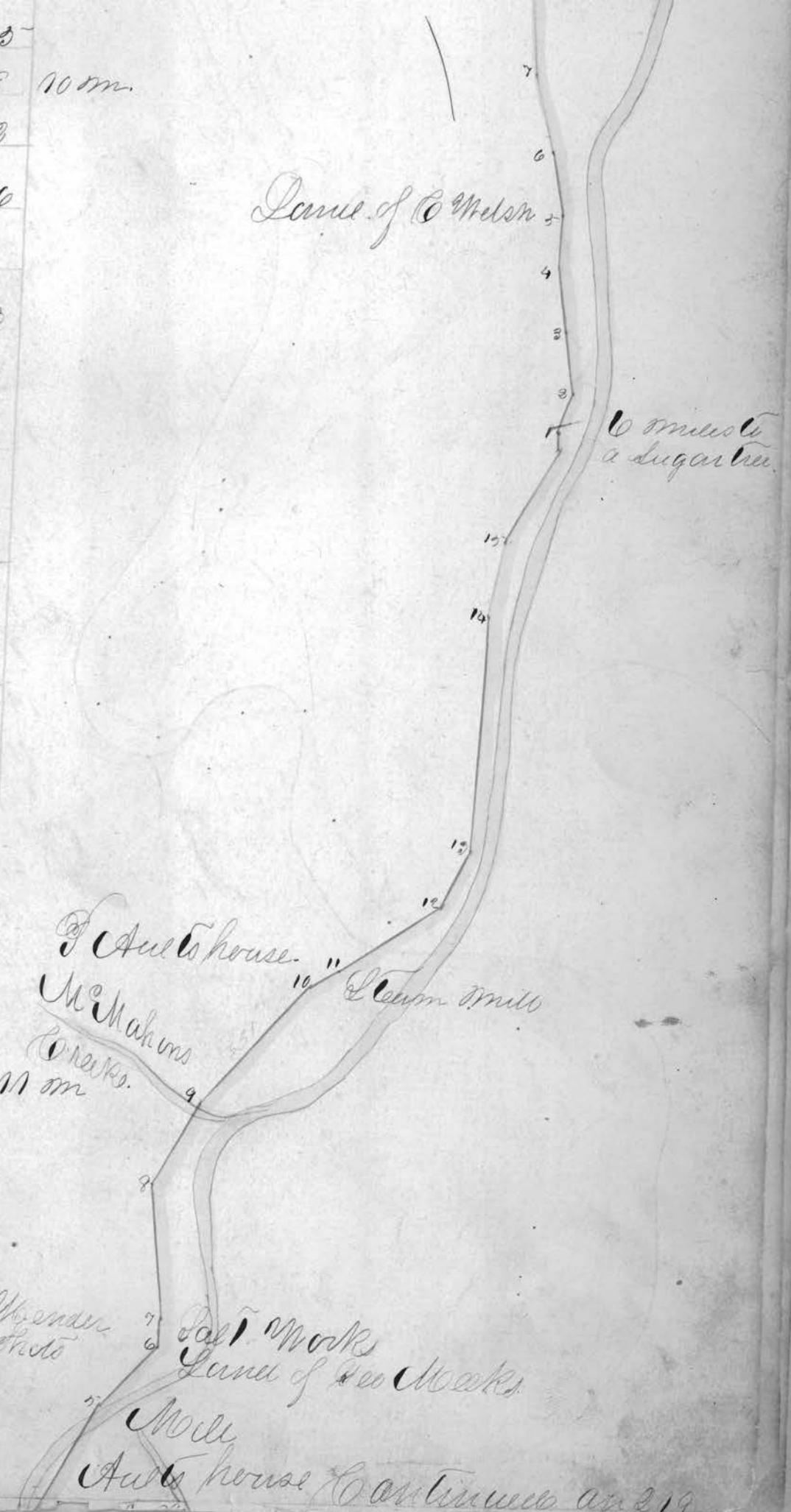



Continued from page 018.

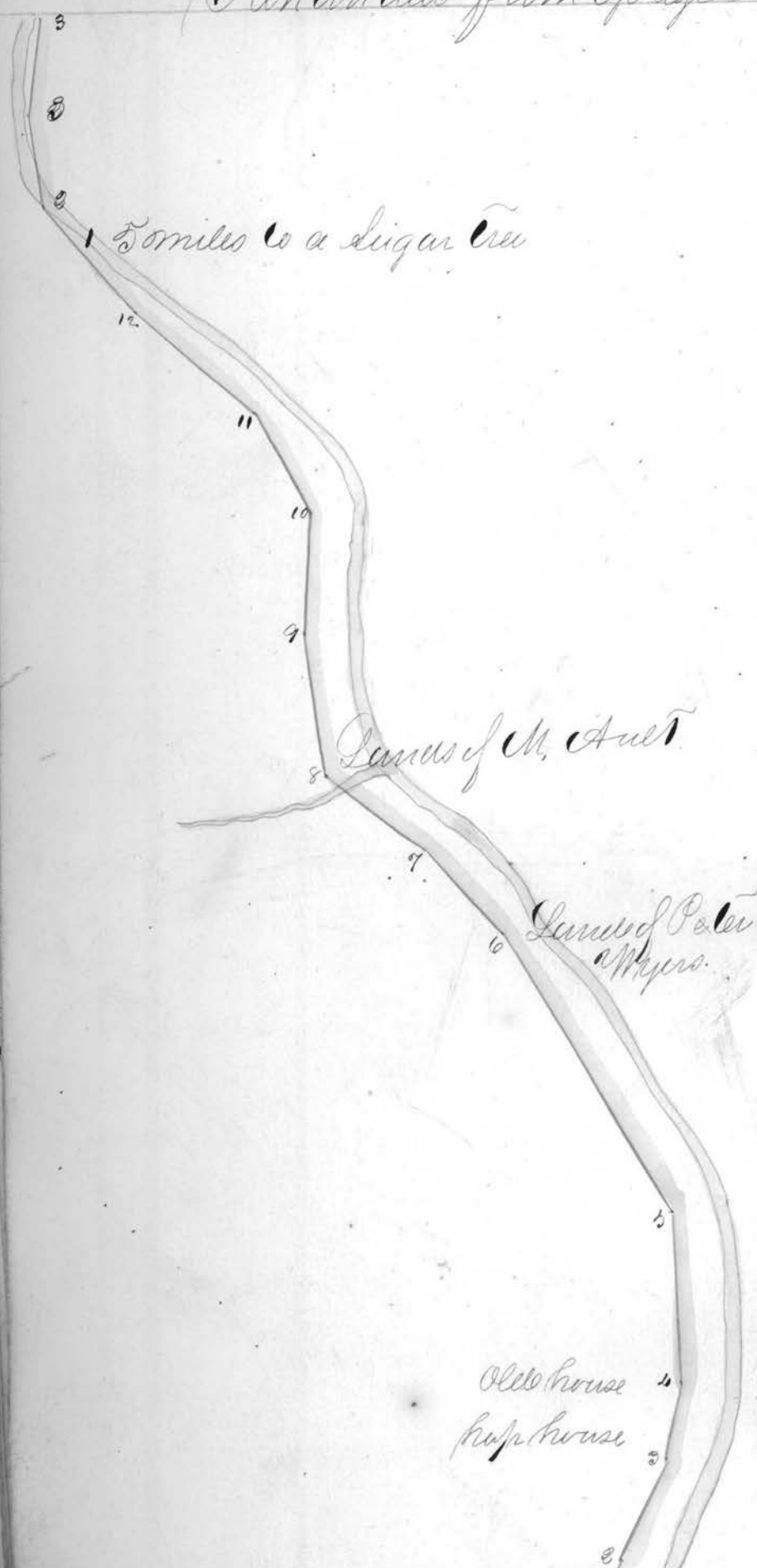

8	S 51 E	13.9
9	S 59 E	10.8
10	S 78 E	20.7
11	S 70 1/2 E	27.6
12	S 78 E	16.5
13	S 60 1/2 E	12.4
14	N 49 E	21.5
15	N 83 E	9.6
16	N 89 1/2 E	3.9
17	N 73 1/2 E	12.7
18	N 39 E	12.5
19	N 39 1/2 E	3.3 12m
1	N 21 1/2 E	8.4
2	N 14 E	7.9
3	N 01 1/2 E	21.6
4	N 42 E	17.4
5	N 46 E	16.
6	N 28 E	14.9
7	N 48 1/4 E	10.8
8	N 88 1/2 E	13.5
9	S 84 1/2 E	17.1
10	S 71 1/2 E	13.4
11	S 49 1/2 E	15.4
12	S 33 E	10.5
13	S 03 1/2 E	9.2
14	S 33 E	13.5
15	S 56 E	20.8
16	S 28 1/2 E	7.6
17	S 33 1/2 E	12.4
18	S 31 1/2 E	10.1



18	S 31 1/2 E	12.1
19	S 33 1/2 E	21.9
20	S 33 1/2 E	16
21	S 40 E	13.4
22	S 22 1/2 E	1.8 13 am
1	Same	10.4
2	S 33 1/4 E	20.2
3	S 31 E	11.7
4	S 48 E	12
5	S 10 E	14.6
6	S 35 E	9.1
7	S 38 E	20.2
8	S 73 1/2 E	20.8
9	S 86 E	26.5
10	N 87 1/2 E	6.2
11	N 71 1/2 E	6.7
12	N 72 E	11.4
13	N 33 1/2 E	21.4
14	N 31 1/2 E	14.5
15	N 52 E	16
16	N 73 E	17.6
17	S 65 E	16.6
18	S 31 1/2 E	11.8
19	S 21 1/2 E	12.2
20	S 26 3/4 E	3.8 14 am
1	Same	5.6
2	S 9 1/2 E	19.5
3	S 18 1/4 W	14
4	S 21 W	19.8
5	S 16 1/2 W	10.2
6	S 11 1/2 W	23.2
7	S 1 E	21.3
8	S 1	