

Continued from page 199.

11	N 80 1/2 W	34
1	Same	14.
2	N 73 1/2 W	30.
3	N 60 W	34
4	N 56 W	34
5	N 49 W	30.
6	N 30 1/2 W	34
7	N 15 W	16.
8	N 13 W	28.
9	N 07 W	10.
10	N 38 1/2 W	18.
11	S 27 W	6.
12	N 65 1/2 W	6.
13	N 45 W	18.
14	N 38 1/2 W	34
15	N 34 1/2 W	19.
16	N 75 W	39. 8 miles
1	Same	18.
2	N 70 W	30.
3	N 16 W	30.
4	S 48 W	15, 5
5	S 30 1/2 W	2, 5
6	S 14 W	10.
7	S 26 1/2 W	15, 5
8	S 3 W	19.
9	S 10 W	15, 5
10	S 23 W	27.
11	S 48 W	26. N
12	S 17 W	9, 55
13	N 87 W	32, 45 9 miles
1	Same	14.
2	West	30.
3	N 79 W	30.

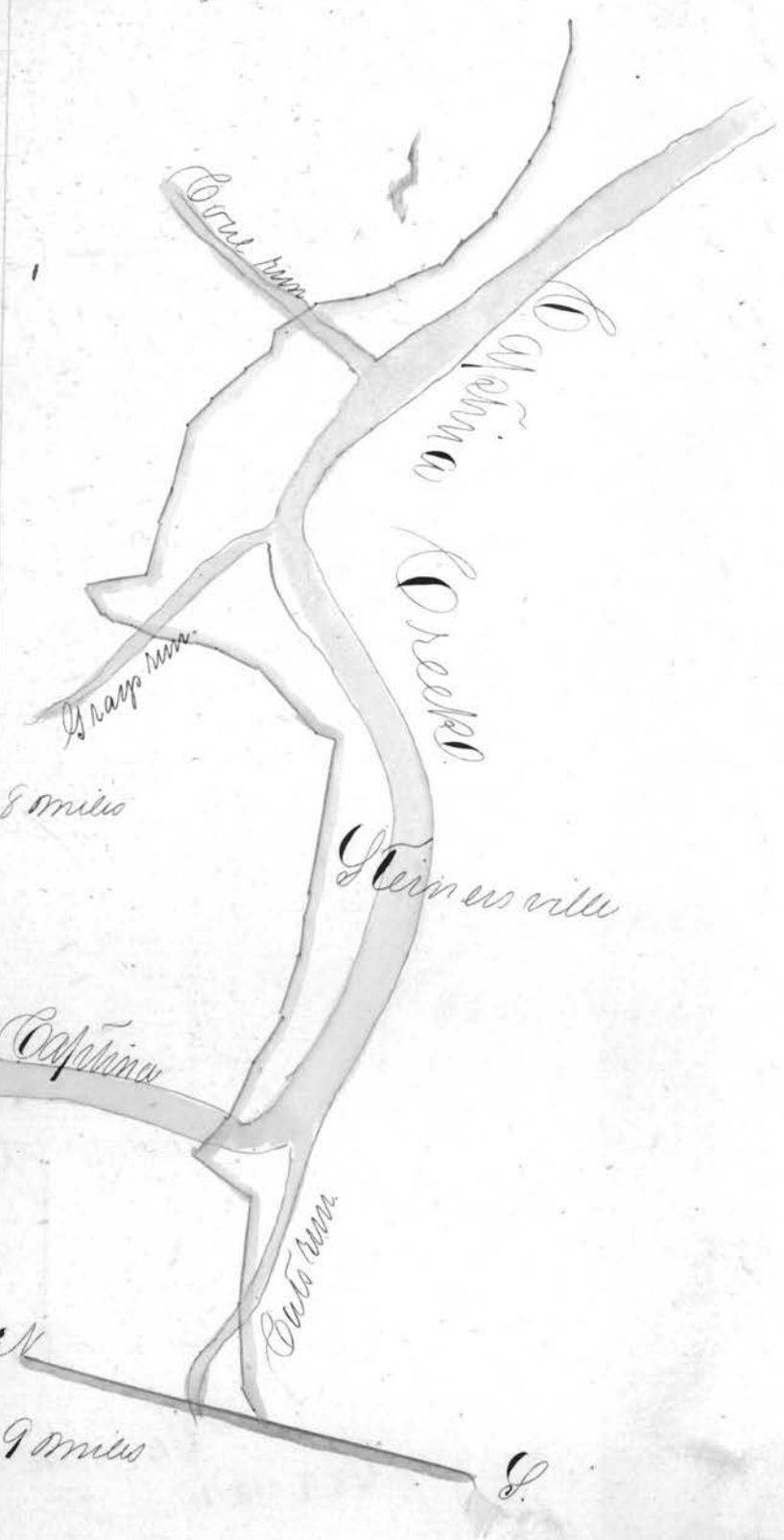

- 3 U 79 20.
- 4 U 66 20
- 5 U 67 28.
- 6 U 43 20
- 7 83 20.
- 8 U 89 54
- 9 80 20
- 10 80 22.
- 11 63 14
- 1 Same 28.
- 2 20 20.
- 3 26 29.
- 4 52 28.
- 5 West 15.
- 6 U 55 29.
- 7 U 43 28.
- 8 West 14
- 9 70 20.
- 10 78 22
- 11 71 24
- 1 Same 20
- 2 53 18.
- 3 41 28.
- 4 33 28 1/2
- 5 19 2 17 1/2
- 6 10 29.
- 7 92 23.
- 8 52 20
- 9 81 29
- 10 39 9
- 1 Same 24
- 2 53 43.
- 3 65 20
- 4 36 20.6
- 5 55 23.9
- 6 61 24.5
- 7 U 74 23-
- 8 U 51 28.
- 9 U 74 28.
- 10 U 54 29.

Road continues up Cabo Wawa

1 U 34 2	11 miles
2 U 44 24.	
3 U 87 21.	
4 45 22.	
5 83 22.	
6 83 42.	
7 U 89 23.5	
8 81 28.5	
9 U 89 41.	
10 67 20.	
11 48 20.	
12 70 26.	
13 78 20.	14 miles
1 Same 25	
2 21 21.2	
3 U 77 20.	12 miles
4 U 68 40.	
5 59 20.	
6 52 20.	
7 U 74 25	
8 U 89 23.	
9 U 76 20	
10 U 89 6.	15 miles

0

Domini Mill

to Monroe Co Line

Monroe Co Line

14 miles

13 miles Continues on N 201

0

Continued from page 301

- 1 N 89 1/2 W 20
- 2 S 94 1/2 W 60
- 3 N 75 W 94
- 4 S 74 W 40
- 5 S 81 1/2 W 40
- 6 S 59 1/2 W 38
- 7 S 64 W 14
- 1 Same 18
- 2 S 57 W 33
- 3 S 54 W 54
- 4 West 8
- 5 S 46 W 31
- 6 N 88 1/2 W 27
- 7 S 71 W 9.5
- 8 S 76 W 4.5
- 9 S 89 1/2 W 8
- 10 N 75 1/2 W 10
- 11 N 55 1/2 W 70
- 12 N 42 W 6.5
- 13 N 10 1/2 W 6.5
- 14 N 86 1/2 W 7.5
- 15 N 76 1/2 W 5
- 16 N 55 1/2 W 7
- 17 N 88 W 8
- 18 N 51 1/2 W 8
- 19 West 6
- 20 N 85 W 13
- 21 S 82 W 16
- 22 S 74 W 10
- 23 N 89 W 11
- 24 S 42 W 13
- 25 S 58 W 3
- 1 S 60 W 20
- 2 S 69 1/4 W 20
- 3 N 72 W 10
- 4 N 82 W 24

16 miles

17 miles

to Bellville road

- 5 S 110 E 18
- 4 S 45 1/2 W 10
- 3 S 78 1/2 W 10
- 6 S 84 W 10
- 7 S 83 18
- 8 S 1 W 18
- 9 S 63 1/2 W 30
- 10 S 2 W 26
- 11 S 20 1/2 W 38
- 12 S 20 W 14
- 13 S 64 1/2 W 43
- 14 S 11 W 13

- 1 Same 22
- 2 S 84 W 26
- 3 S 20 1/2 W 42
- 4 S 79 W 24
- 5 S 19 W 16
- 6 S 4 W 17
- 7 S 75 W 37
- 8 S 61 1/2 W 26
- 9 S 65 W 18
- 10 S 84 W 44
- 11 S 64 W 10
- 12 S 29 W 28

- 1 Same 4
- 2 S 64 W 15
- 3 S 28 W 37
- 4 S 79 W 22
- 5 S 10 W 22
- 6 S 71 1/2 W 10
- 7 S 24 W 20
- 8 S 21 W 17
- 9 S 27 1/2 W 11
- 10 N 83 W 25
- 11 N 75 1/2 W 16.5
- 12 N 80 W 25

30 miles from miles up Red Hill
 from the top of
 the hill to the
 30 miles to the
 30 miles to the

31 miles

30 miles

2 1891 20.

3 1892 10. to Bellville road.

4 1893 24

5 1894 22.

6 1895 46

7 1896 18.

8 1897 19

9 1898 28.

10 1899 17.

11 1900 20

12 1901 16

13 1902 21

14 1903 13

15 1904 20.

16 1905 6.

17 Same 10.

18 1906 16

19 1907 22.

20 1908 22.

21 1909 22.

22 1910 22.

23 1911 22.

24 1912 22.

25 1913 22.

26 1914 22.

27 1915 22.

28 1916 22.

29 1917 22.

30 1918 22.

31 1919 22.

32 1920 22.

33 1921 22.

34 1922 22.

35 1923 22.

36 1924 22.

37 1925 22.

38 1926 22.

39 1927 22.

40 1928 22.

Amptong roads

18 miles

Roads to Portville
Coral of Hill

Roads to Bellville

19 miles

Allinsons run.

20 miles

Continued on 203

4 1891 21.

10 1892 22.

11 1893 20.5

12 1894 25.

13 1895 28.

14 1896 12.

15 1897 14

16 1898 14

1 1899 26

2 1900 14

3 1901 12.

4 1902 16

5 1903 40.

6 1904 12.

7 1905 12.

8 1906 8

9 1907 12.

10 1908 42

11 1909 3.7

12 1910 3.6

13 1911 6.7

14 1912 2.5

15 1913 12.

16 South 7.35

17 1914 11.25

18 1915 10.

19 1916 20.5

20 1917 6.6

21 1918 4.5

22 1919 5.15

23 1920 3.05

24 1921 1.6

1 Same 2

2 1922 2.0

3 1923 2.9

4 1924 3.7

5 South 5

33m.

ND

S.

24 miles

Continued from 212.

6	Y 108	24
7	Y 278	28
8	Y 1848	4.1
9	Y 24W	25
10	Y 28W	7.
11	Y 40W	7.5
12	Y 48W	14.
13	Y 208	18.
14	Y 298	32.
15	Y 208	127
16	Y 188	2.6
17	Y 728	6.9
18	Y 214W	16.8
19	Y 3W	28.
20	Y 248	28.
21	Y 17W	10.
22	Y 21W	21.
23	Y 25W	21.
24	Y 12W	14.
25	Y 4W	16.
26	Y 728	10.
1	Same	6.
2	Y 28	14
3	Y 1148	20.
4	Y 108	20.
5	Y 17W	22
6	Y 29W	14.
7	Y 12W	12.
8	Y 64W	14.
9	Y 27W	22
10	Y 69W	17.25
11	Y 86W	20.9
12	Y 27W	27.5
13	Y 80W	20.
14	Y 26 1/2 W	7.

Bridge

Dominio

Orney Survey

Surfack

Creek

Bridge

8	Y 21W	23.
9	Y 49W	20.
10	Y 48W	28.
11	Y 23W	16. 280m.
1	Same	14.
2	Y 24W	18.
3	Y 21W	12.
4	Y 29W	28.
5	Y 69 1/2 W	28.
6	Y 51W	22.
7	Y 23W	26
8	Y 69 1/2 W	17.
9	Y 23W	20.
10	Y 85W	17.
11	Y 41W	21
12	Y 81W	23
13	Y 29W	12. 29
1	Same	8.
2	Y 28 1/2 W	14.
3	Y 76 1/2 W	15.
4	Y 67 1/2 W	17.
5	Y 83 1/2 W	15.
6	Y 48 1/2 W	18.
7	Y 67W	12
8	Y 23W	15
9	Y 24W	22
10	Y 23W	18.
11	Y 28W	18.
12	Y 27W	22.25
13	Y 27 1/2 W	20.2
14	Y 70W	19.9
15	Y 51W	7.25
16	Y 67W	8.45
17	Y 86W	10.25

W.

14	S 26 1/2 W	7.
15	S 9 1/2 W	11.
16	S 10 W	10.
17	S 19 1/2 W	8.
18	S 4 8	9
19	S 11 8	13.5
20	S 33 1/2 W	11.5
21	S 39 8	18.
22	S 27 8	11.
23	S 47 8	6.
24	S 44 W	9.
25	S 17 W	9.5
26	S 3 W	8.5
1	S 26 W	16.
2	S 11 W	6.3
3	S 18 8	1.7
4	S 29 8	36.8
5	S 29 1/2 W	21.9
6	S 28 W	10.
7	S 6 W	20
8	S 70 1/2 W	30.
9	S 10 1/2 W	20.
10	S 13 W	10.
11	S 38 W	33.
12	S 73 W	25.
13	S 38 W	33.
14	S 69 W	19
15	S 89 1/2 W	20
16	S 83 W	6
1	S 89 W	69
2	S 30 1/2 W	31.
3	S 22 W	21
4	N 69 W	27.
5	N 84 W	27
6	N 75 W	7.
7	S 77 W	22.

26 miles

Purdys creek

Continuing same run

Continued and 204.



17	S 26 W	10.5
18	N 69 1/2 W	20.5
19	N 62 W	24 30.
1	Same	12.
2	N 88 W	18.
3	N 89 1/2 W	21.0
4	N 69 W	24
5	N 69 W	26
6	N 12 1/2 W	12.
7	N 89 1/2 W	23.
8	S 13 W	29
9	S 80 W	33.
10	N 94 1/2 W	34.
11	N 80 W	19
12	N 73 W	37 31.
1	N 39 1/2 W	26.
2	N 13 1/2 W	22.
3	N 1 W	26.
4	N 10 8	16
5	N 36 W	32.
6	N 37 1/2 W	26.
7	N 63 W	13
8	N 75 1/2 W	33 30
9	Same	21
2	N 64 W	28.
3	N 85 1/2 W	14.5
4	S 64 W	21
5	S 79 W	3.4
6	S 13 W	13.1
7	S 73 W	27.5
8	S 39 W	22.
9	S 77 W	24
10	S 12 1/2 W	10.
11	S 30 W	24. 33.
1	S 20 W	8.

Continued from p. 203.

1	Same	8
2	U 800m	30.
3	U 400m	40
4	U 470m	18
5	U 460m	12
6	U 470	22.
7	U 800m	22.
8	U 800m	38.
9	U 600m	22.
11	U 790m	19
11	U 890m	30.
12	U 470m	25.
13	U 730m	20.
14	U 630m	2
1	Same	8.
2	U 850m	13.
3	U 680m	44.
4	U 550m	4.1
5	U 550m	10.9
6	U 540m	3.45
7	U 830m	8.55
8	U 560m	10.
9	U 840m	11.
10	U 520m	59.
11	U 750m	24.
12	U 450m	27.
13	U 750m	20.
14	U 430m	20
1	Same	20.
2	U 420m	18.
3	U 200m	40.
4	U 340m	8.
5	U 200m	10.
6	U 600m	18.
7	U 390m	22.
8	U 900m	20.
9	U 700m	10.
10	U 800m	6.
11	U 850m	8.
12	U 900m	32.
13	U 560m	10.
14	U 490m	14.
1	Same	38
2	U 390m	40.
3	U 680m	22.
4	U 900m	24.
5	U 880m	50.



6	U 340m	54
7	U 890m	28.
8	U 740m	30.
9	U 690m	22.
10	U 390m	20. 39 miles
1	Same	8.
2	U 690m	30.
3	U 860m	38.
4	U 730m	28.
5	U 720m	24.
6	U 690m	30.
7	U 270m	18.
8	U 150m	20.
9	U 320m	22.
10	U 900m	8.
11	U 540m	64 40 miles
1	U 700m	10.3
2	U 510m	10.6
3	U 450m	10.1
4	U 600m	13.
5	U 750m	12.
6	U 840m	38
7	U 350m	22.
8	U 780m	24.
9	U 240m	24.
10	U 300m	10.
11	U 330m	24.
12	U 240m	18.35
13	U 390m	4.15
14	U 840m	20.6
15	U 750m	30.
16	U 870m	48 21 miles
1	U 240m	29.
2	U 650m	19.
3	U 510m	10.
4	U 380m	10.
5	U 180m	24.
6	U 930m	90
7	U 700m	18.
8	U 870m	22.
9	U 980m	32.
10	U 860m	26
11	U 580m	12 22 miles
1	Same	9.
2	U 600m	17.
3	U 350m	32.
4	U 540m	32.
5	U 600m	22.
6	U 250m	8
7	U 200m	6
8	U 300m	8.
9	U 330m	17
10	U 210m	7.

6 U889m 22.

7 U892m 30.

8 U899m 28.

1 U889m 30.

2 Most 20

3 U864m 18.75

4 U899m 30.80

5 U892m 17.2

6 U60m 15.

7 U399m 20.

8 U314m 33.

9 U974m 8.

10 U899m 13.

11 U009m 10

12 U889m 20

13 U48m 20.

1 Sam 20.

2 U829m 14.

3 U399m 30.

4 U49m 26

5 U21m 18.

37m.

38m.

Continued on 315.

10 U21m 18.

11 U16m 18

12 U18m 30.

13 U87m 12.

14 U399m 24

15 U139m 12.

16 U29m 14.

17 U9m 14.

18 U114m 15

19 U33m 33.

1 U804m 13.

2 U58m 33.

3 U839m 20.

4 U80m 30.

5 U82m 30

6 U59m 21.

7 U929m 29

8 U80m 212.

9 U939m 20

1 U839m 8.

2 U73m 29

3 U63m 25.

4 U60m 23.

5 U69m 21

6 U89m 30.

13 orules

14 orules

Continued from Page 214

7	880 AM	25
8	894 AM	20.
9	860 AM	19
10	860 AM	16
11	848 AM	25.
12	870 1/2 AM	10
1	Same	20
2	899 1/2 AM	31.
3	864 1/2 AM	27
4	887 AM	31.
5	855 AM	31.
6	860 AM	18
7	892 1/2 AM	25.
8	872 AM	17.
9	851 AM	25.
10	835 AM	19.
11	877 1/2 AM	14
12	809 1/2 AM	18
13	850 AM	3
1	Same	10.
2	855 AM	44
3	894 AM	60
4	874 AM	56.
5	889 AM	28.
6	830 AM	18, 25

45 miles

Lewisville

20 miles

G.

10	869 1/2 AM	20.
11	876 1/2 AM	22.
12	853 AM	23.
13	884 1/2 AM	18.
14	848 1/2 AM	20 50
1	839 AM	10.
2	868 AM	21.
3	869 1/2 AM	22.
4	886 AM	10.
5	892 AM	6.
6	878 AM	18.
7	880 AM	10
8	869 1/2 AM	6.
9	883 AM	13.
10	887 AM	11
11	894 1/2 AM	15
12	879 1/2 AM	12.
13	899 1/2 AM	8.
14	871 1/2 AM	8.
15	842 AM	11.
16	869 1/2 AM	9
17	869 AM	10.
18	876 1/2 AM	20
19	884 AM	24
20	873 1/2 AM	26 57.
1	864 AM	30
2	856 1/2 AM	76
3	881 1/2 AM	19
4	850 1/2 AM	24

Continued from Page 205

206

N

S

Sistersville
road

N

S

Somerfield
road

N

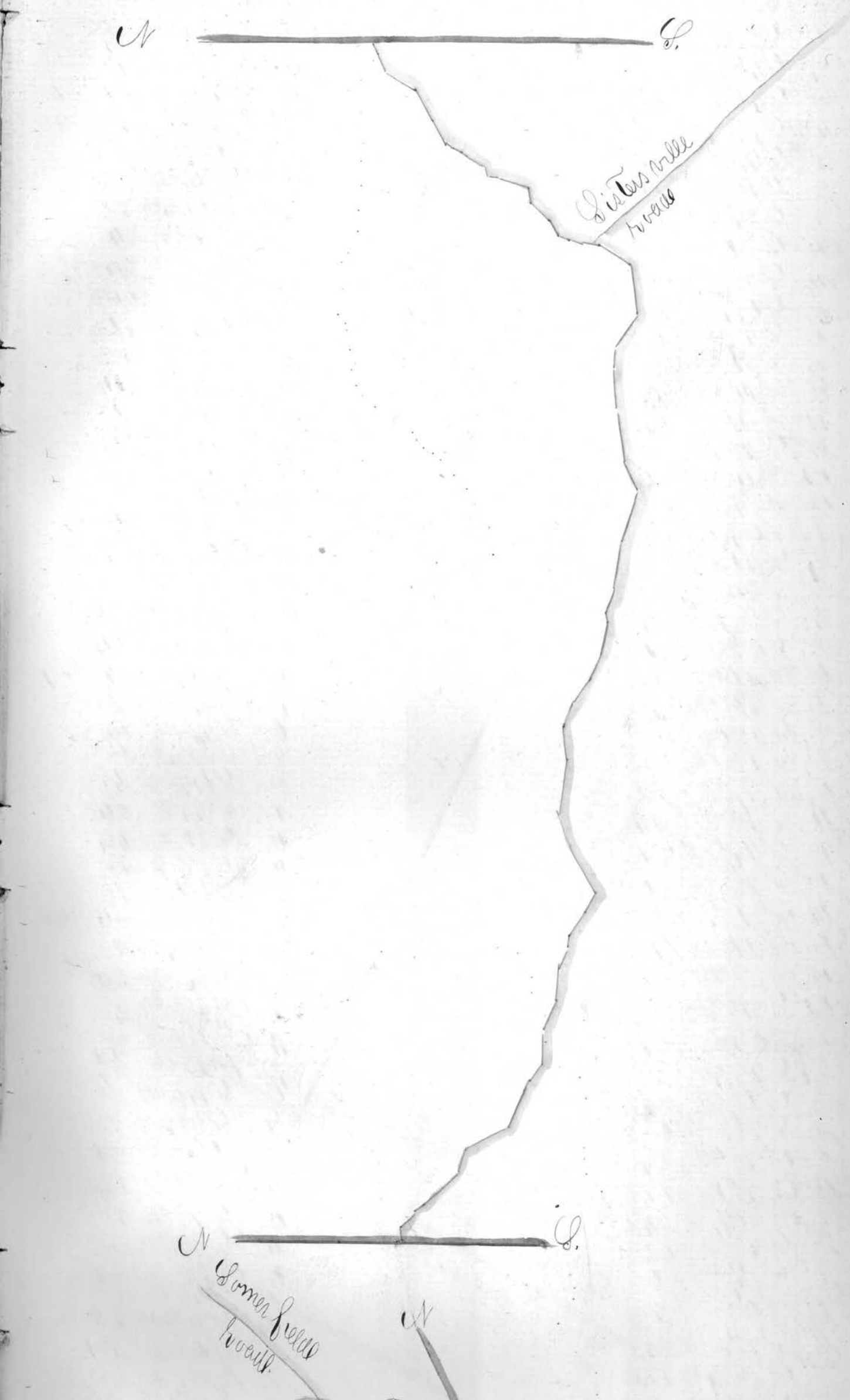

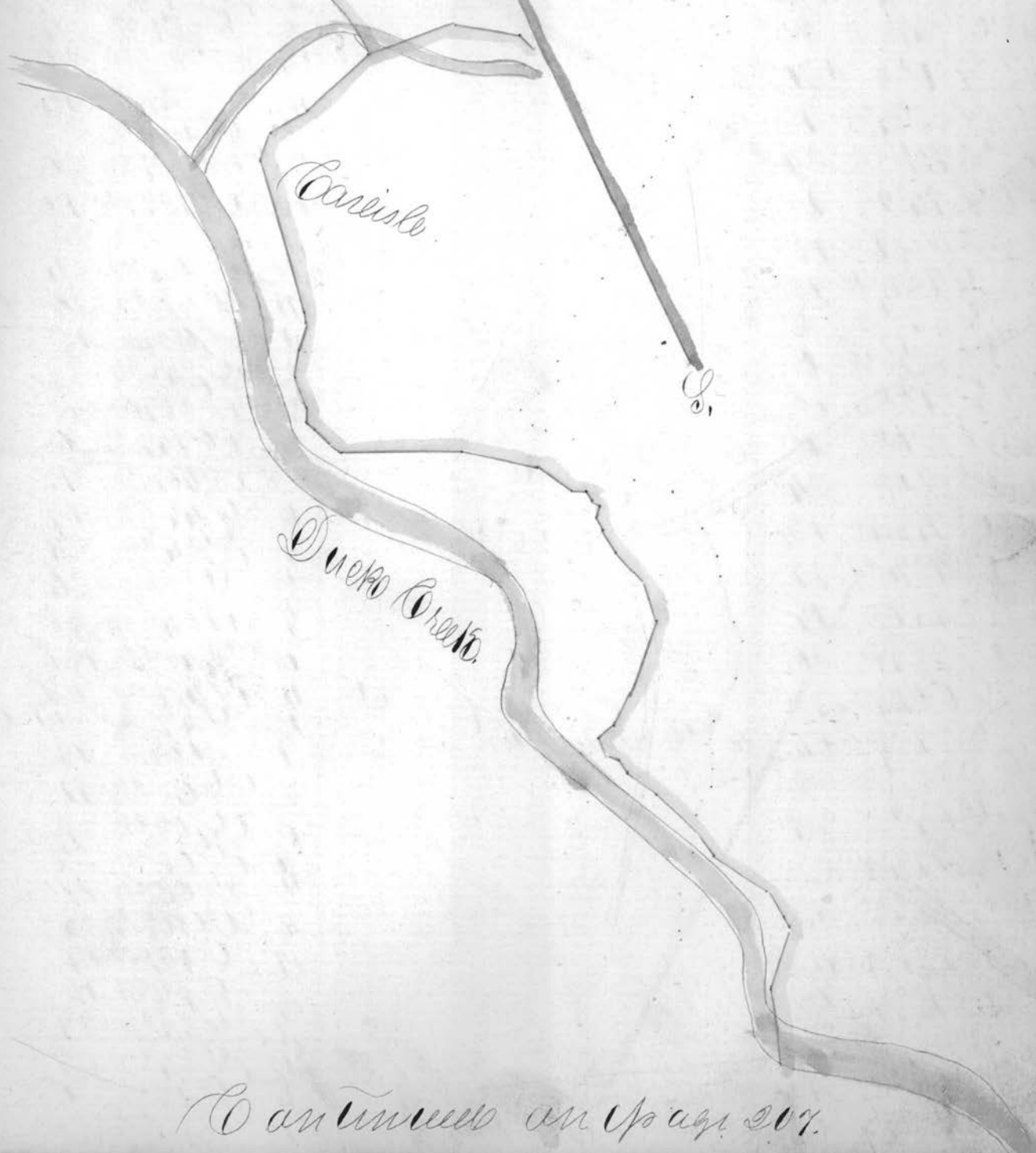

Carroll

Duro Creek

Continued on page 207.

Continued from p 200

3	S 53 1/2 W	22.
3	S 32 1/2 W	13
4	S 43 1/2 W	29
5	S 42 W	10.
6	S 17 1/4 W	34
7	S 7 E	24
8	S 10 W	11.
9	S 39 W	10
10	S 31 W	9
11	S 18 W	13
12	S 6 1/2 E	13.5
13	S 9 W	6.7
14	S 31 W	28.
15	S 11 W	14
16	S 5 1/2 W	14.5
17	S 23 1/4 W	8.5
18	S 10 W	10.
19	S 22 W	9
1	Same	9
2	S 41 W	7
3	S 25 W	23.5
4	S 38 1/2 W	24.5
5	S 6 1/2 W	20.
6	S 19 1/2 W	14
7	S 49 1/2 W	20.
8	S 13 W	28
9	S 14 1/2 W	5-
10	S 0 1/2 W	19.
11	S 12 W	14
12	S 14 1/2 W	20.
13	S 15 W	20.
14	S 9 W	23.
15	S 14 1/2 W	18.
16	S 33 W	27
17	S 15 W	3
1	Same	24
2	S 70 W	28.
3	N 66 W	24.7.
4	S 75 1/2 W	60.3
5	N 90 W	27.

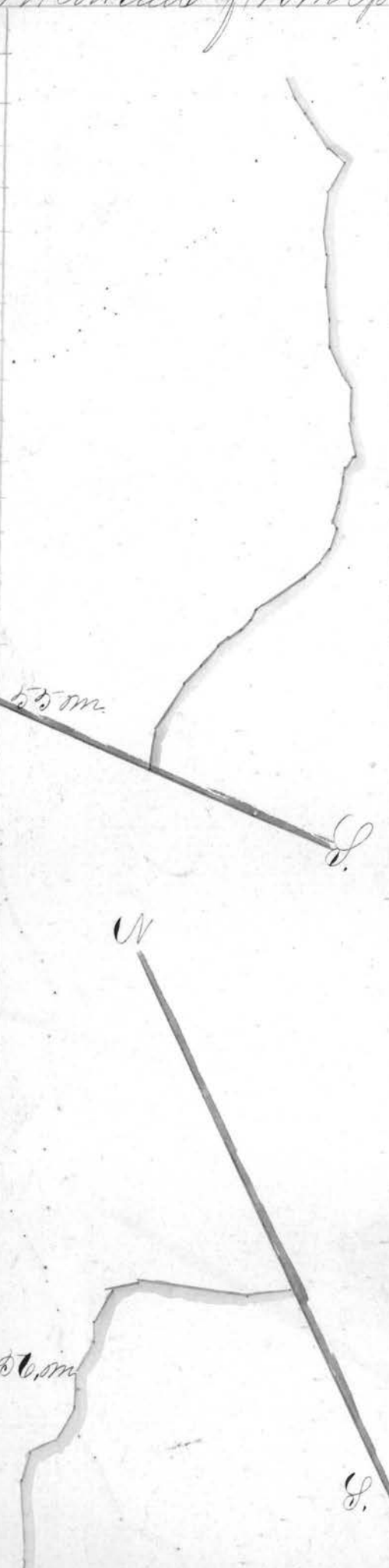

17	N 33 1/2 W	4.15
18	N 75 1/2 W	5.95
19	S 83 W	7.0
20	S 77 W	17.
21	N 88 1/2 W	21 59
1	Same	10.
2	S 86 W	20.
3	S 77 1/2 W	26.
4	S 86 W	21.
5	S 24 W	3.45
6	S 64 1/2 W	6.25
7	S 74 1/2 W	10.0
8	S 30 W	10.5
9	S 60 1/2 W	20.0
10	S 10 W	37.
11	N 83 1/2 W	30.
12	N 63 W	19
13	N 83 1/2 W	20.
14	S 60 W	30 60
1	Same	8.
2	S 87 1/2 W	28.
3	West	26
4	S 31 W	26
5	S 24 W	26.
6	S 44 W	14
7	S 22 1/2 E	25-
8	S 61 1/2 E	29
9	S 2 E	36.
10	S 29 E	10.
11	S 53 E	12.
12	S 20 1/2 E	12.
13	S 22 W	22 61
1	S 33 1/2 W	20.
2	S 4 W	30.
3	S 18 1/2 W	13.
4	S 17 1/2 E	28.
5	S 10 W	23.
6	S 17 1/2 W	28.
7	S 33 1/2 W	28.
8	S 53 W	21

3	U 100 AM	21.7
4	U 95 1/2 AM	20.3
5	U 90 AM	21
6	U 98 AM	19.3
7	U 80 1/2 AM	22.5
8	U 98 AM	22
9	U 81 AM	6
1	Same	70
2	U 93 1/2 AM	22.8
3	U 85 3/4 AM	17.2
4	U 84 1/2 AM	25
5	U 81 AM	21
6	U 83 3/4 AM	18
7	U 93 1/2 AM	24
8	U 74 AM	18
9	U 100 AM	15
10	U 90 1/2 AM	12
11	U 89 AM	5
12	U 93 1/2 AM	6
13	U 81 1/2 AM	10
14	U 88 1/2 AM	16
1	U 80 AM	24
2	U 99 1/2 AM	13
3	U 90 1/2 AM	17
4	U 49 AM	14
5	U 68 AM	21
6	U 65 1/2 AM	21
7	U 87 AM	17
8	U 85 AM	23
9	U 61 AM	29
10	U 87 1/2 AM	25
11	U 32 AM	21.75
12	U 48 1/2 AM	11.35
13	U 9 AM	6.85
14	U 36 1/2 AM	3.85
15	U 64 AM	4.1
16	U 38 1/2 AM	0.7



5	U 10 AM	23
6	U 11 1/2 AM	28
7	U 23 1/2 AM	22
8	U 53 AM	21
9	U 35 AM	15
10	U 78 AM	12
11	U 34 1/2 AM	20
12	U 64 1/2 AM	24
13	U 12 AM	22
14	U 38 1/2 AM	12
1	Same	20
2	U 57 AM	30
3	U 38 1/2 AM	24
4	U 85 AM	27
5	U 24 1/2 AM	20
6	U 16 AM	23
7	U 63 1/2 AM	20
8	U 93 1/2 AM	20
9	U 82 AM	22
10	U 64 AM	24
11	U 62 AM	26
1	Same	16
2	U 84 1/2 AM	32
3	U 33 1/2 AM	18
4	U 74 1/2 AM	12
5	U 66 1/2 AM	33
6	U 49 AM	19
7	U 24 AM	29
8	U 38 AM	24
9	U 84 1/2 AM	30
10	U 46 AM	18.3
11	U 48 1/2 AM	9.7
12	U 49 1/2 AM	20
1	Same	15
2	U 68 AM	13
3	U 53 AM	32
4	U 68 AM	27
5	U 65 AM	19
6	U 36 1/2 AM	24
7	U 66 AM	16
8	U 50 AM	15
9	U 29 AM	37
10	U 54 AM	27
11	U 37 AM	21
12	U 48 1/2 AM	32

Continued on 208.

Continued from p. 207

208.

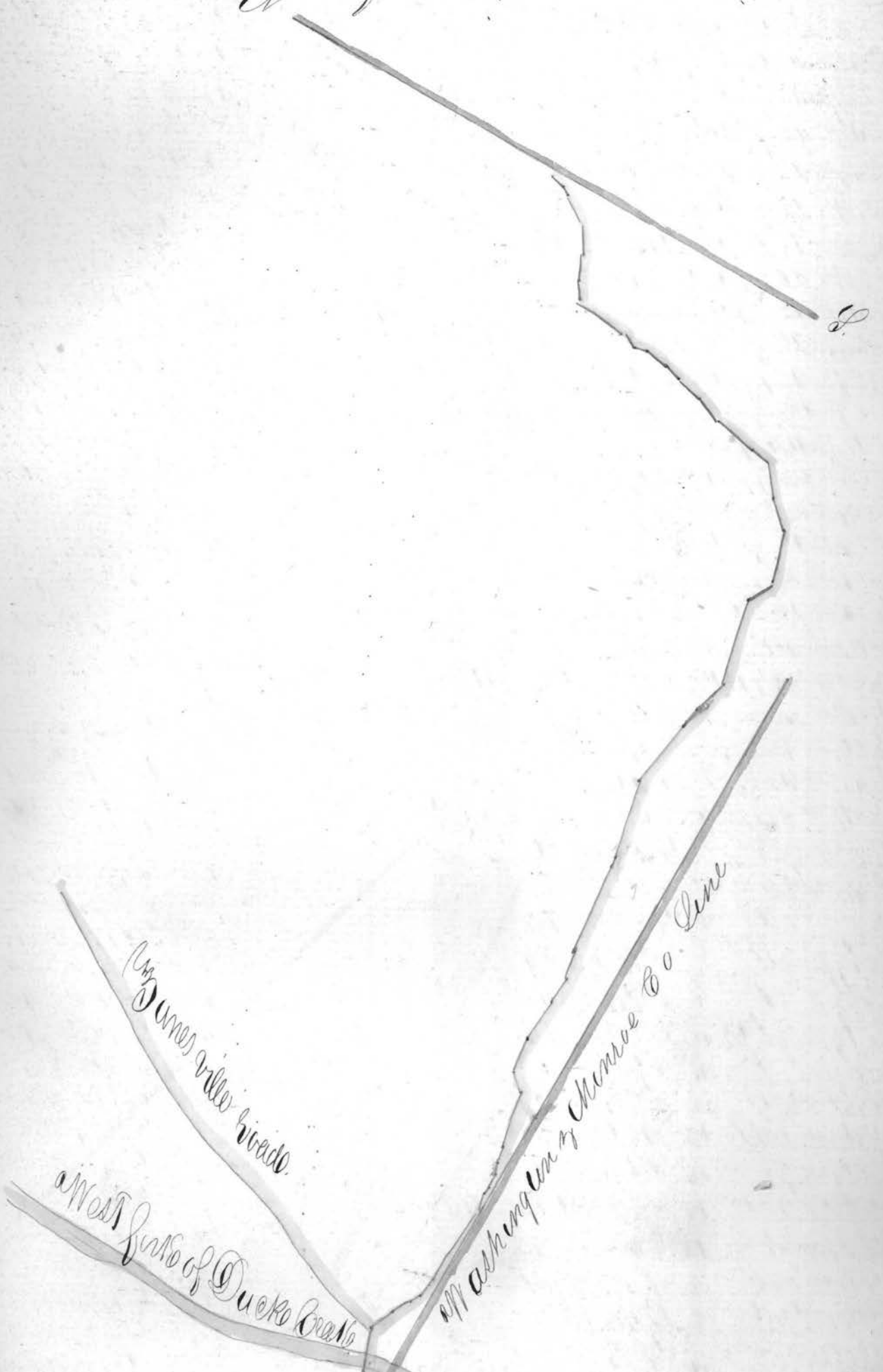

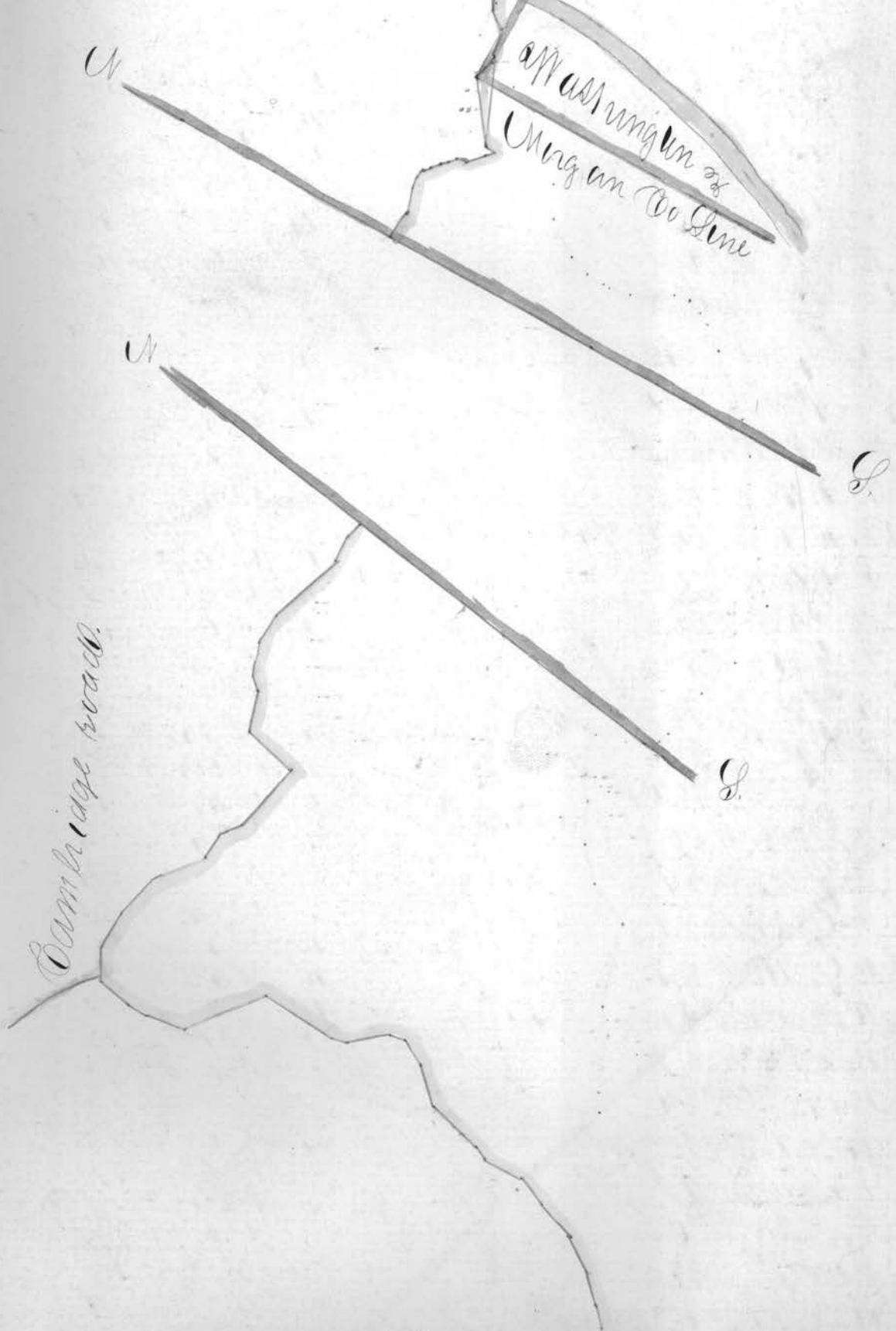

Continued on page 209.

Continued from Page 208

13	888m	22	11	849m	6.
14	U877m	18	00	849m	8.
1	879m	16.	13	851m	10.
2	841m	12.	14	U734m	20.
3	829m	22.	15	852m	12.
4	870m	22.	16	809m	10.
5	882m	19	17	809m	14
6	875m	26.	18	U64m	25-
7	821m	16.	19	853m	12.
8	829m	26.	20	837m	4
9	872m	28.	1	851m	18
10	888m	16.	2	844m	18
11	U874m	11,4	3	832m	12.
12	U855m	6,15	4	861m	16.
13	U604m	10,35	5	834m	20.
14	U892m	22.	6	835m	20.
15	U574m	12.	7	U444m	18
16	882m	12	8	888m	28.
1	Same	16.	9	873m	22.
2	863m	20.	10	880m	12
3	860m	210.	1	Same	12.
4	850m	20.	2	8124m	27.
5	849m	18.	3	811	8.
6	847m	28.	4	827	5,5
7	835m	22.	5	810	6.
8	849m	22.	6	804m	25-
9	82	28.	7	88m	15-
10	846	20.	8	834m	24
11	834	21.	9	829m	10.
12	812m	25,07	10	822m	14
1	Same	8.	11	830m	16.
2	844	21.	12	824m	18.
3	861m	22.	13	850m	22.
4	829m	20.	14	855m	12.
5	838m	18.	15	803m	12
6	838m	28.	16	Same	12.
7	860m	29,5	3	818m	20.
8	879m	22,5	8	813m	22.



1	800	29.5	9	818	20.
2	879	32.5	8	813	22.
3	832	28.	4	898	20.
4	832	28.	5	809	21.
5	829	28.	6	817	22.
6	856	14	7	813	20.
7	Same	18.	8	817	18.5
8	824	20.	9	827	21.5
9	815	20	1	Same	28.
10	848	20.	2	826	20.
11	879	28.	3	824	16.5
12	830	22.	4	West	84.6
13	842	14	5	South	19.1
14	842	9.5	6	832	21.9
15	840	13.5	7	848	12.8
16	871	14.	8	817	26.2
17	874	15.5	1	Same	7.5
18	818	17.5	2	818	20.2
19	832	7.	3	832	23.2
20	809	13.	4	835	72.3
21	832	13.	5	820	28.1
22	800	11	6	828	26.6
23	843	7.	7	834	20.
24	807	14	8	882	9.7
25	805	16	9	849	8.9
26	845	6.09	10	871	5.4
27	Same	16.	11	824	19.
28	850	20	12	832	27.
29	842	20.	13	832	24
30	832	10.	14	878	12.
31	813	22.	1	Same	18
32	812	15.5	2	809	18.
33	834	10.5	3	832	29.5
34	837	22.	4	832	10.5
35	847	22	5	827	15.
36	832	18.	6	824	27

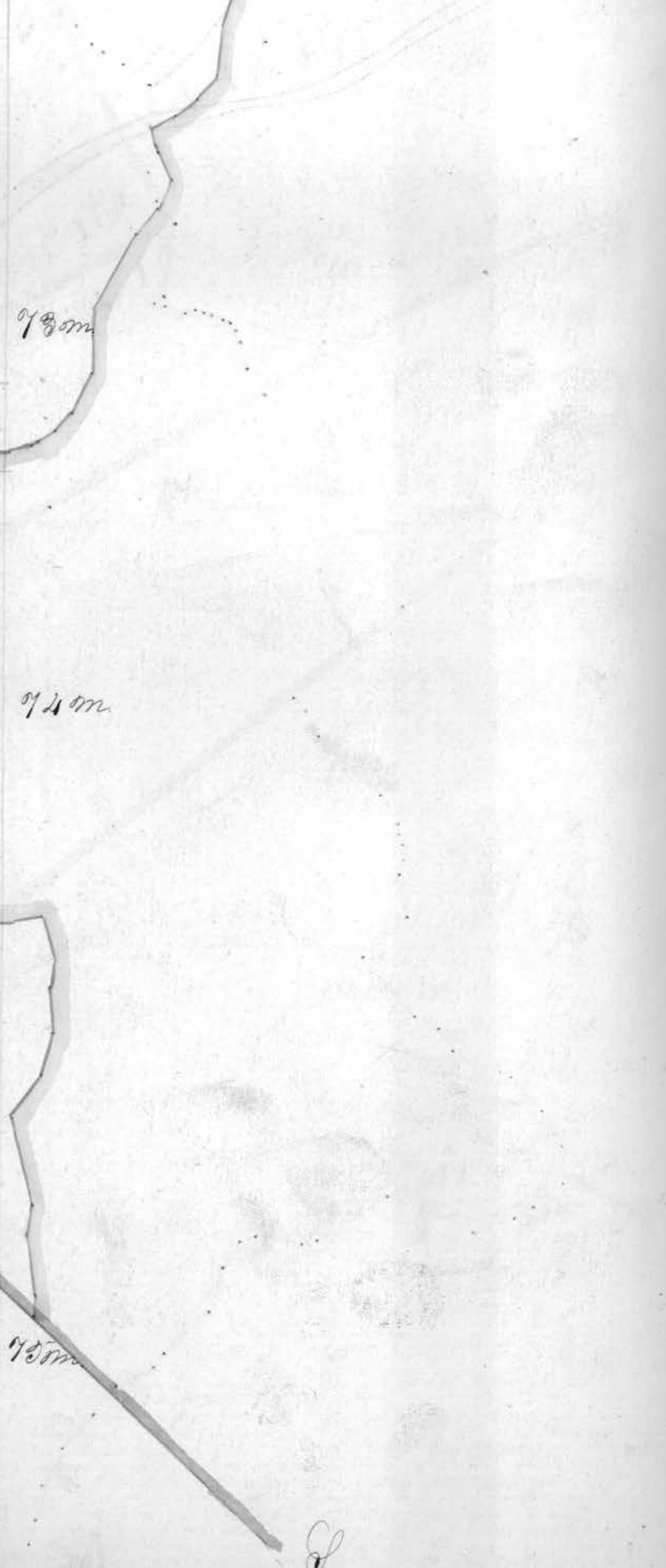

Continued on p 200.