

960. That of an alteration on the State road leading from a point at which it intersects the State road from the mouth of Caprina creek to Prospect, to where said road crosses the west line of Sec. 10 in Harrison Co. as surveyed by Uman McMillan 1838

No	Course	Dist
1	N 40 W	22
2	N 55 E	24
3	N 35 E	17
4	N 5 W	13
5	N 37 W	16
6	N 25 W	19
7	N 2 W	10
8	N 3 E	21
9	N 10 1/2 W	50
10	N 10 1/4 E	17
11	N 20 1/2 E	12
12	N 6 1/2 E	21
13	N 21 W	12
14	N 1 1/4 W	8
15	N 15 E	28
16	N 25 W	53
17	N 15 E	30
18	N 29 E	25
19	N 18 1/2 E	20
20	N 3 W	19
21	N 11 W	20
22	N 16 E	21
23	N 11 E	25 1/2
24	N 20 E	10
25	N 3 W	19
26	N 28 W	20

To the old survey.

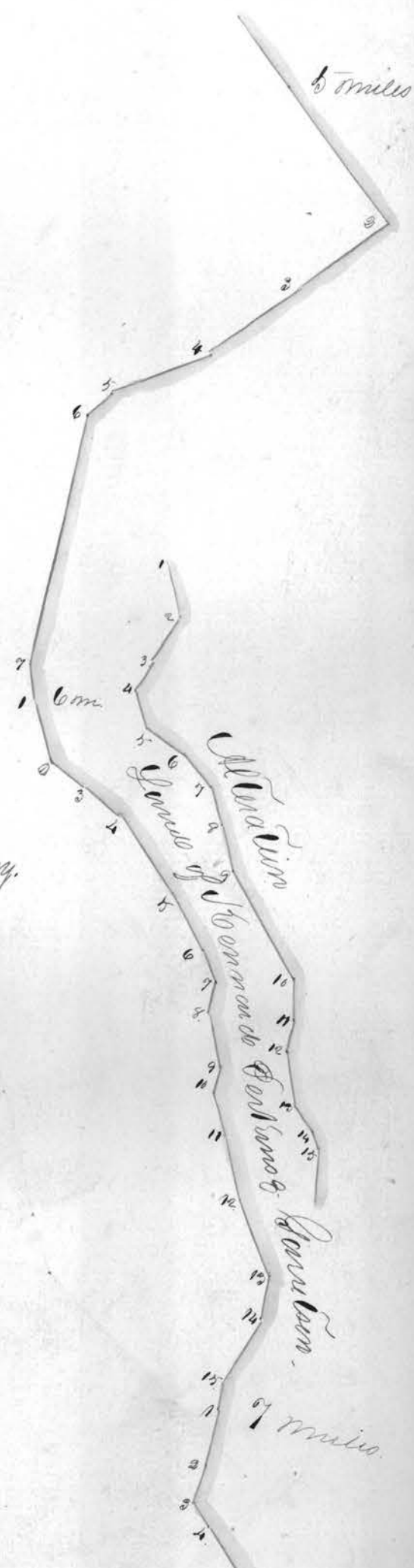

N 30 W 210 on 20.

N 30 W 39 on 20.

N 20 W 95 on 21.

To the West Side of  
Sec 10

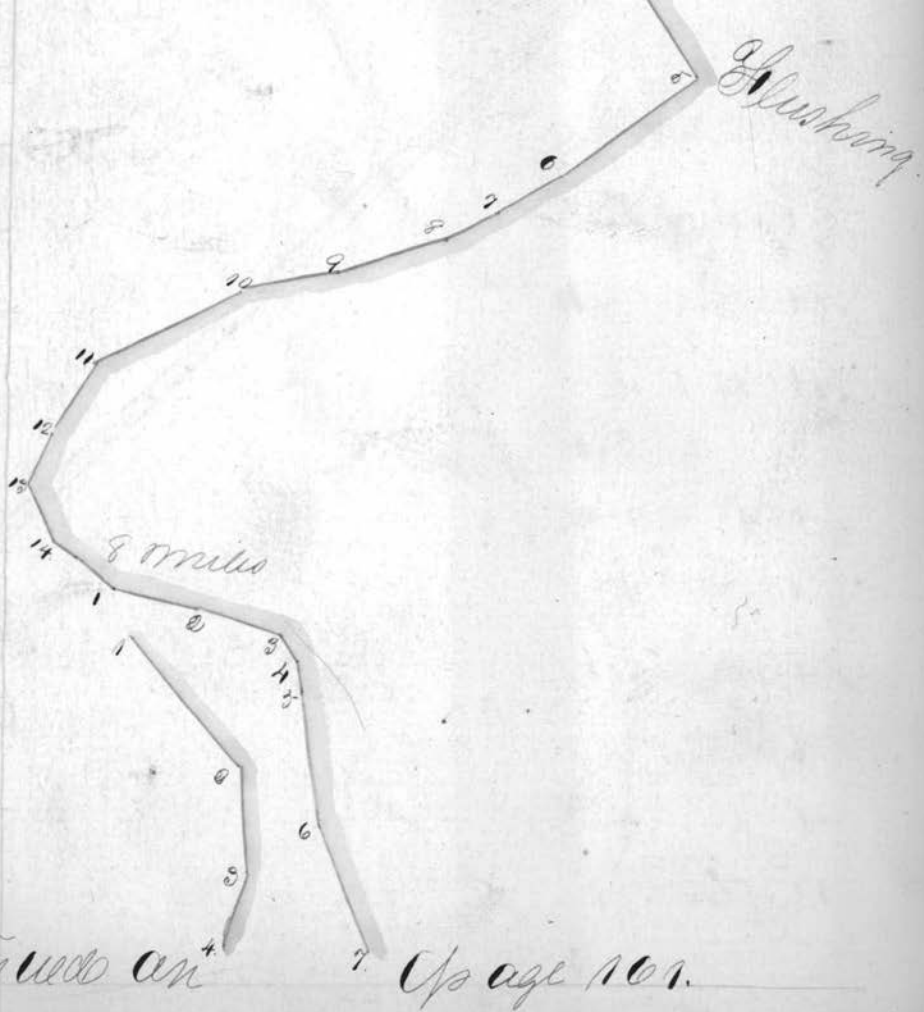

Continued on <sup>+</sup> Up page 101.

Continued from page 100

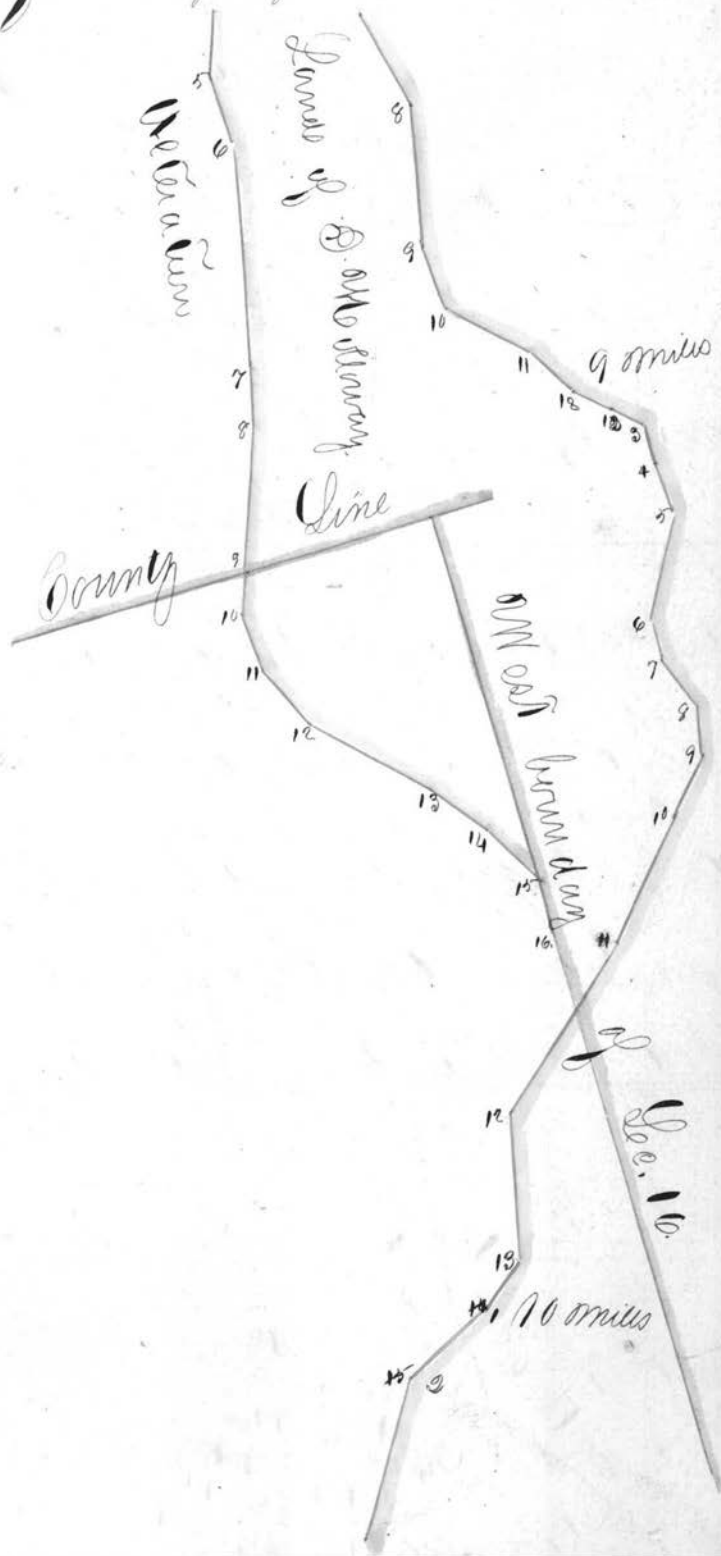

Plot of a road beginning at the S. end  
 at the road from the flats of Gravel  
 to Senecaville and running thence to the Browns  
 ville & Mantua road. As surveyed by John W  
 Defferis A.D. 1838

In Course Dist  
 1 N 10th 100.  
 2 N 34 1/2 E 17, 15  
 3 N 54 3/4 E 18. "  
 4 N 44 E 8. "  
 5 N 25 1/2 E 9. "  
 6 N 15 E 12. "  
 7 N 10 W 10. "  
 8 N 57 E 8 1/2. "  
 9 N 17 E 12. "  
 10 N 34 E 20. "  
 11 N 54 1/2 W 30. "  
 12 N 10 W 19. "  
 13 N 34 1/2 W 20. "  
 14 N 13 E 10. "  
 15 N 1/2 W 24, 18  
 16 N 1/2 W 18. "  
 17 N 0 W 18. "  
 18 N 12 W 11, 13  
 19 N 20 W 18. "  
 20 N 15 W 18. "  
 21 N 37 W 29.



22 N 25 E 12. "  
 23 N 27 W 20, 12  
 24 N 26 E 8. "  
 25 N 5 E 12. "  
 26 N 15 W 19. "  
 27 N 10th 21. 7  
 28 N 30 E 18. "  
 29 N 69 E 2, 20  
 30 N 24 W 19, 15  
 31 N 41 W 27, 20  
 32 N 49 W 15. "  
 33 N 13 W 12. "  
 34 N 11 W 14. "  
 35 N 16 W 24. "  
 36 N 51 W 3, 13  
 37 N 6 W 17. "  
 38 N 0th 8 1/2  
 39 N 15 E 27.  
 40 N 14 E 19  
 41 N 10 E 9.  
 42 N 38 E 8, 10  
 43 N 37 E 14.  
 44 N 37 W 17  
 45 N 84 1/2 W 15.

Continued on 160.

Continued from page 161.



Plan of Grave Creek & General roads.

That of a road beginning at the line between  
 Belmont & Monroe Counties near the Lands of  
 Luke Ripston and terminates in the road  
 from Corns to Maraga on Sec. 31 in Wayne Sp.  
 as surveyed by Thomas Lewis A.D. 1838

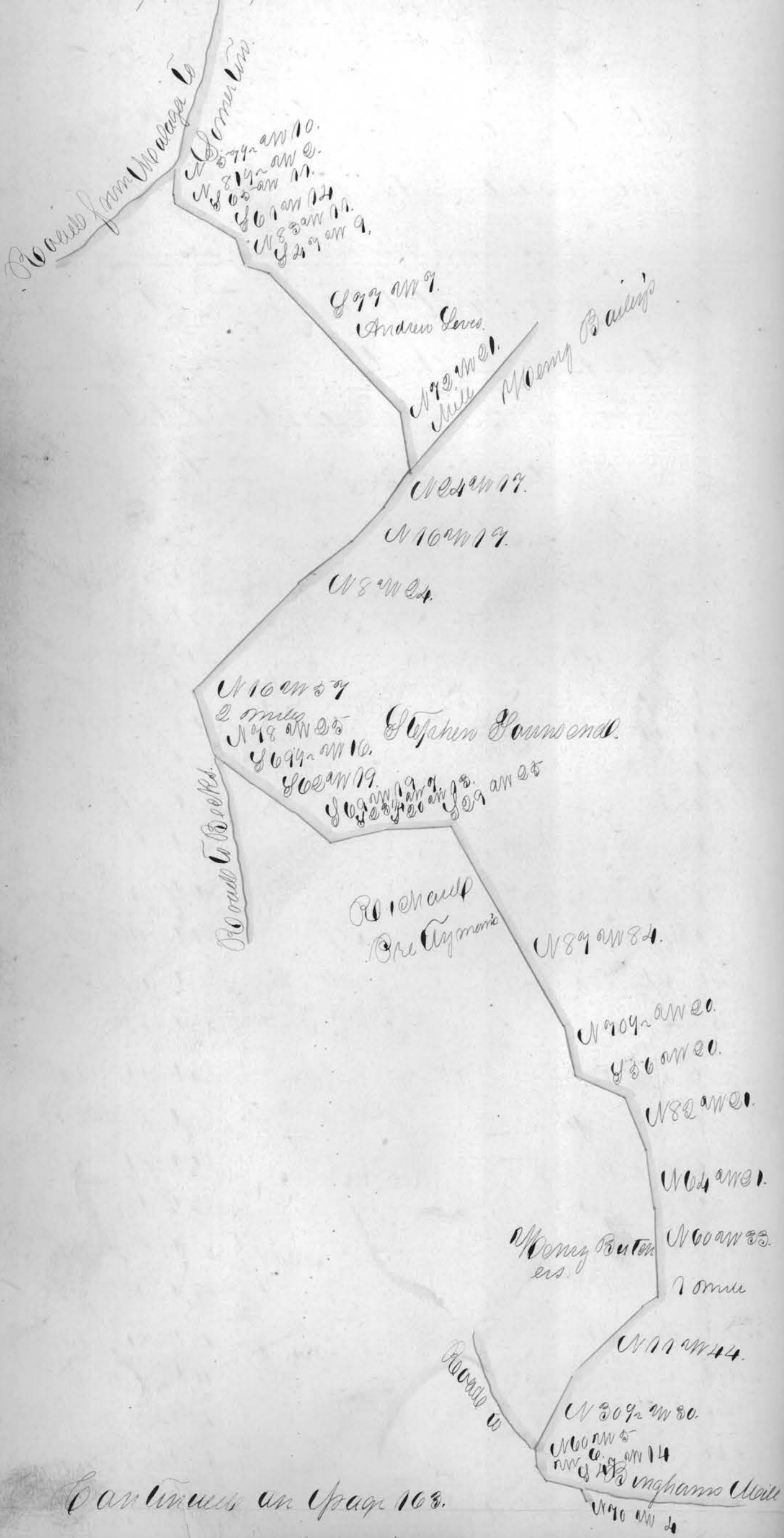

Continued on page 103.

Continued from page 102

N 59 W 14

N 26 W 14

N 23 W 14

N 31 W 13

N 24 W 9

N 80 W 30

N 4 W 20

N 25 W 28

N 21 1/4 W 10

N 20 W 14

N 40 W 8

N 31 W 18

N 56 W 20 Appls.

State Barrels

Barrel 100 lbs

One barrel 100 lbs

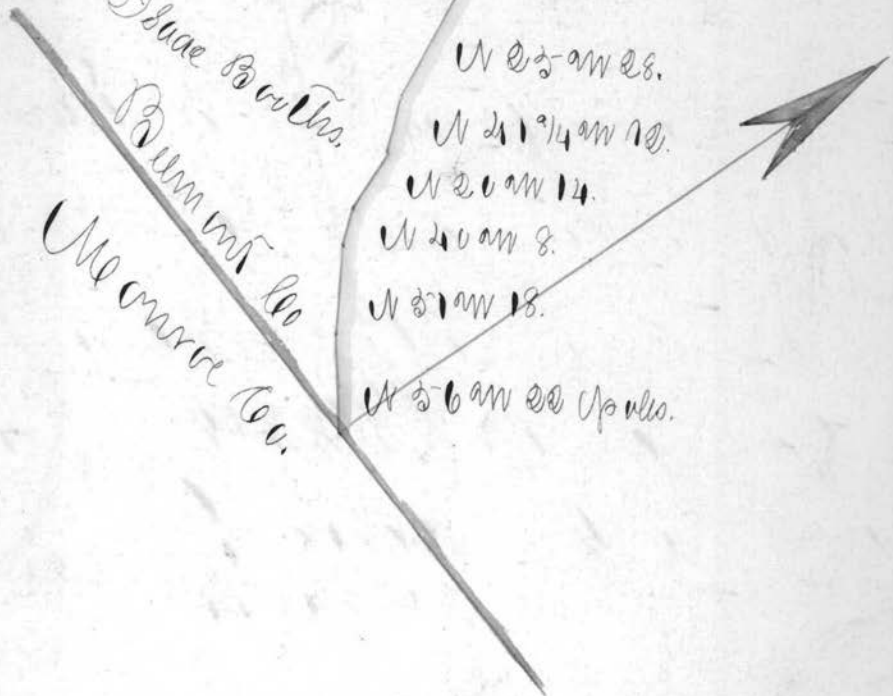

That of the road beginning at the road  
 from Morristown to Simeron near the line  
 of Hastings Wayne Sp. and ends near Henry  
 Camps Mill on the road south from S Hill  
 as Surveyed by Thomas Lewis 1838

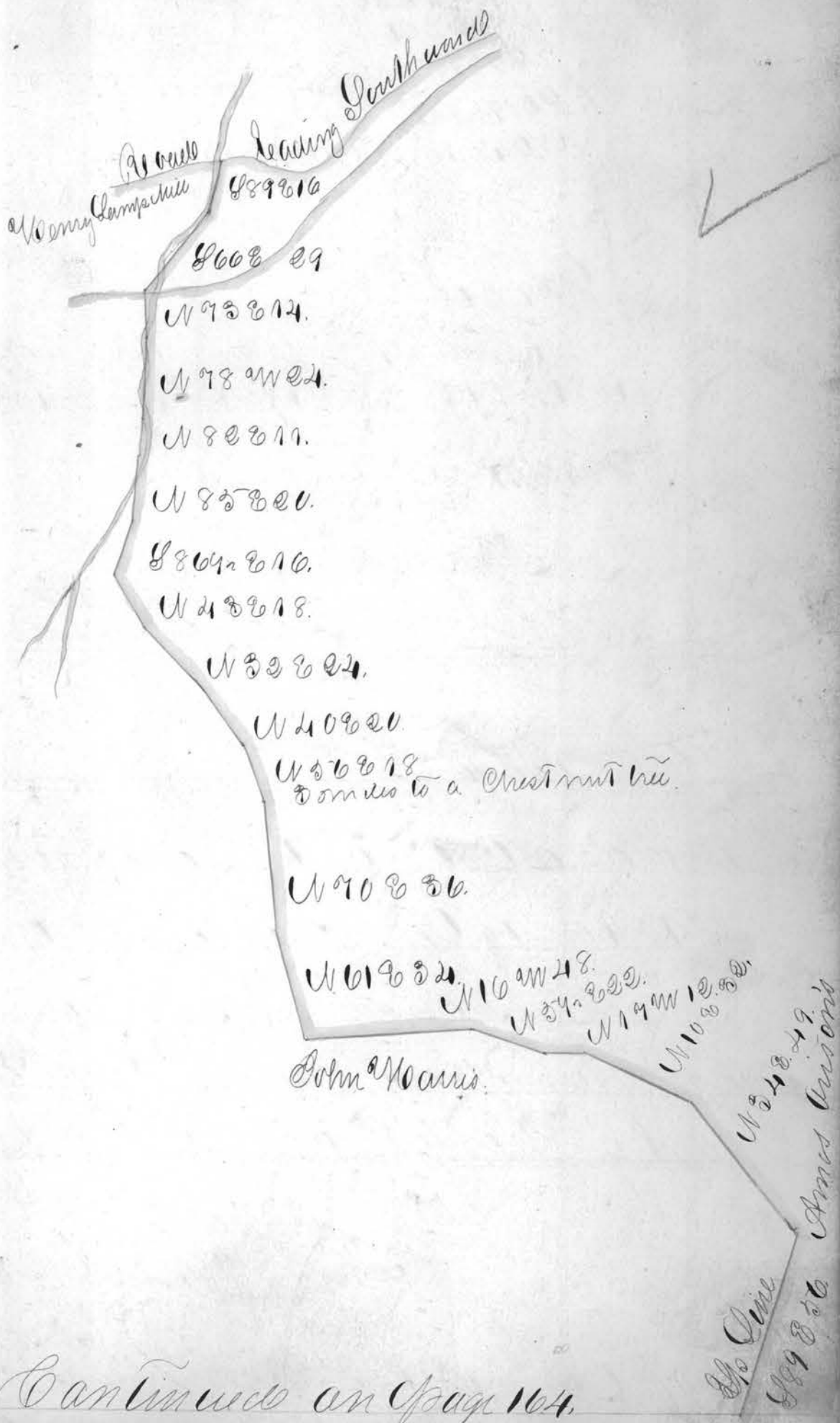

Continued on page 104.



Continued from page 103.

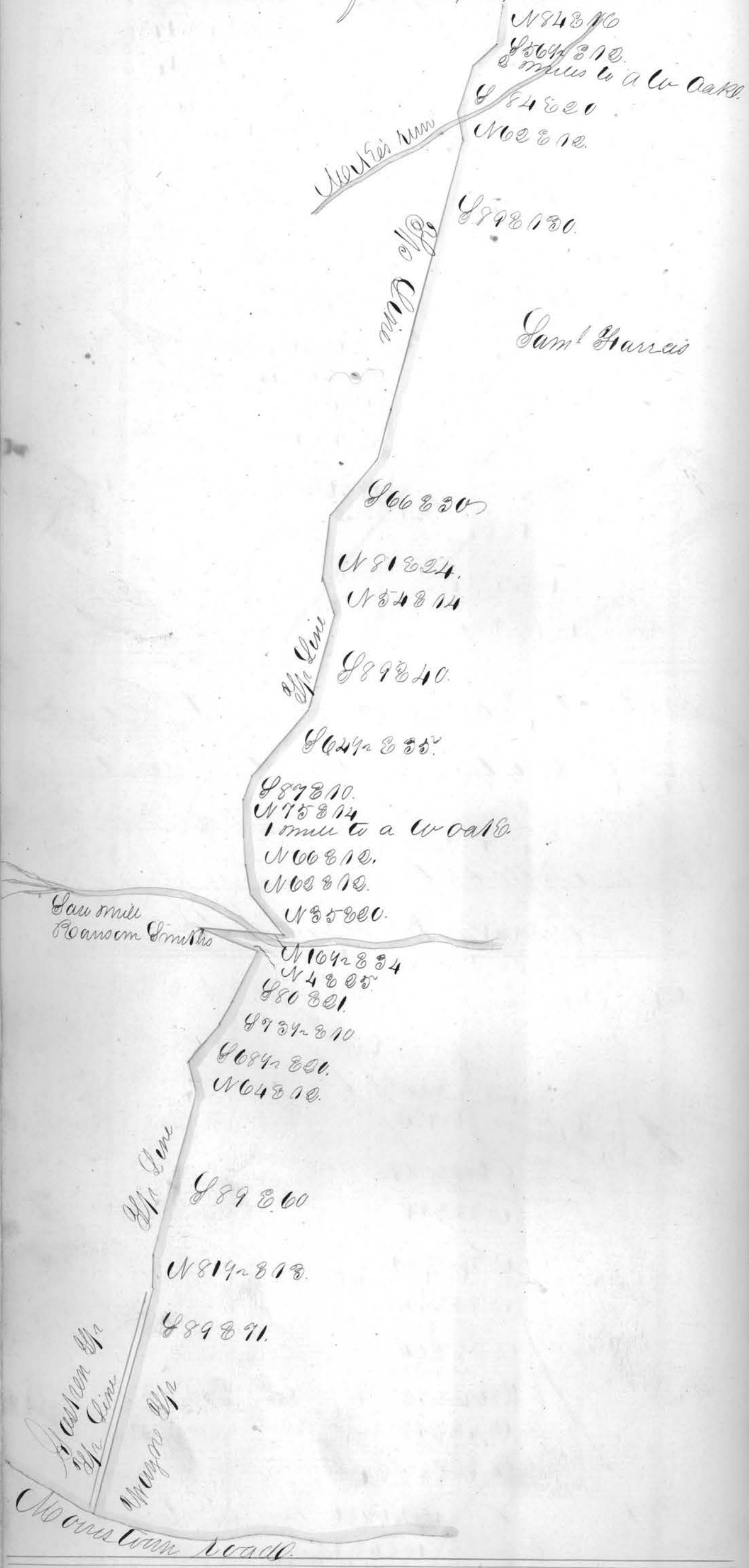

Plot of an alteration on the road from Brooks  
 Mill to County Line, beginning at the County  
 line near San Francisco, and ends on said

Plat of an alteration in the road from Becks  
mill to County Line, beginning at the County  
line near Gas Yamall, and ends in said  
road at Sonathan Edwards line as sur-  
veyed by Thomas Lewis A.D. 1838.

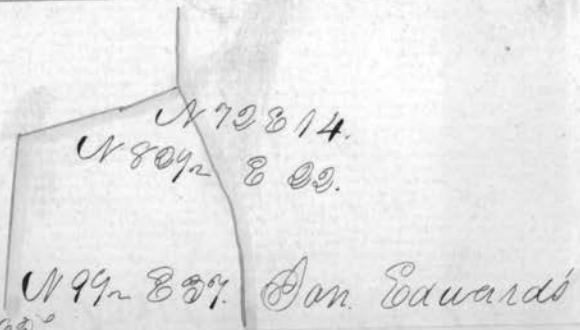

Continued on 103.

Continued from page 104

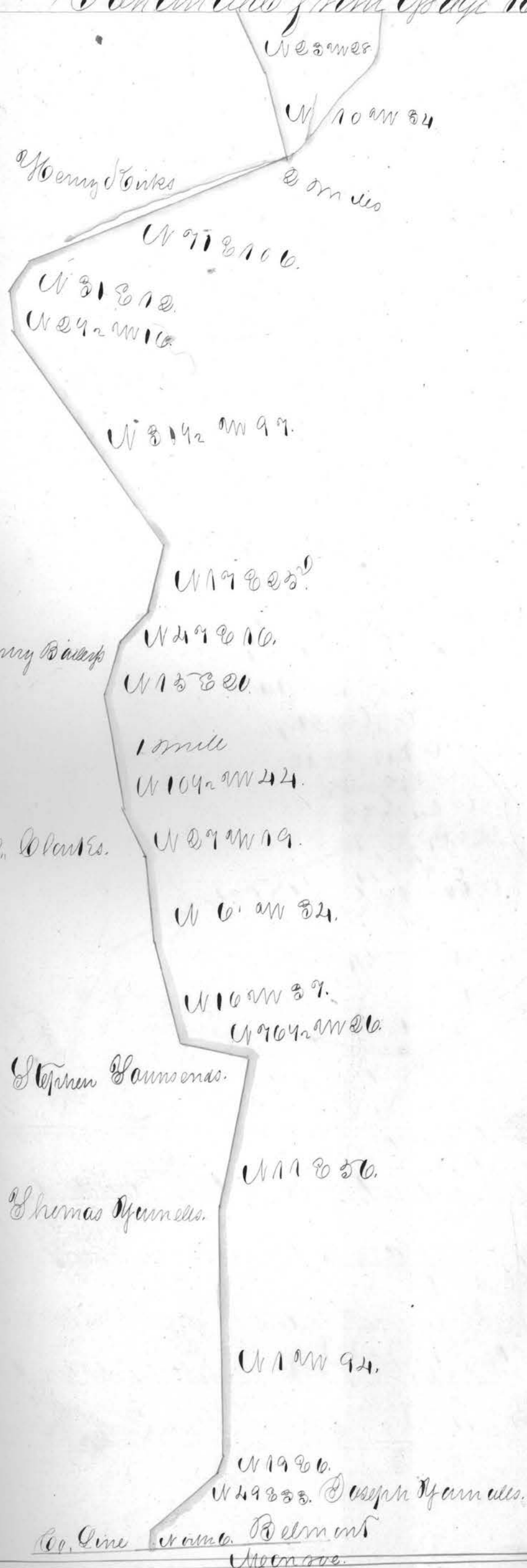

Plans of a road beginning on the road  
from the <sup>Ferry</sup> mouth of Captina to John  
Boek's mill, at a Sun monument  
and ends in the road from 1<sup>st</sup> mile to  
Barnesville, as surveyed by Chas. Lewis 1838



Continued from 163

N 10 1/2 W 60.

N 48 W 4 3/4.  
A small to a white cap.

N 8 1/4 W 8.  
N 9 1/4 W 10.

N 8 1/4 W 100.

Sand Hilneys

N 30 1/2 W 20.

N 40 W 20.

N 30 W 14.

N 4 W 20.

N 14 1/2 W 12.

N 19 W 13.

N 24 W 13.

N 30 1/2 W 12.

N 61 W 28.

N 30 1/2 W 24.

20 W

That of an alteration on the road up  
 the Bend forks creek to Lamps Mill, begins  
 for same on the South side of said creek on  
 the S.E. qr. of Sect. 1. Tps. 7 R. 5. and ends on the  
Abel rays bottom fields as surveyed by Thos Lewis 1838.



Sta.	Course	Dist
1	S 63 E	20 1/2
2	S 19 E	15
3	S 17 W	10
4	S 81 W	18
5	S 85 W	30 1/2
6	S 88 W	28

That of the attraction on the road on the road  
from Gas Shephards to the National road, be-  
ginning at the bridge over Robinsons Run. and  
running to the Merifield road as surveyed  
by John Briggs A.D. 1838

Road from Merifield to the National  
Road.

1842 818.

1898 808.

1848 8.

1810.

1888.

1889.

1830.

Old Road  
15 3/4 poles long.

1804 814. Road to Steuart's Mill  
Robinsons Run of Steuart's

St. Charles Run

That of an alteration in the roads from  
S. Bingham's mill to Permuton beginning  
on the line between the lands of James Butcher  
and Isaac Strahl, on the N<sup>o</sup> W<sup>o</sup> Q<sup>o</sup> of Sec. 30. 3<sup>o</sup> R. 6  
of Range. 5 of Ems on the same sp. as per-  
veyed by Thomas Lewis A. D. 1838

Old  
roads  
of Butcher  
N 27 E. 6.

N 90 4 2 E 114  
108.

Continued on page



Continued from Page 107.

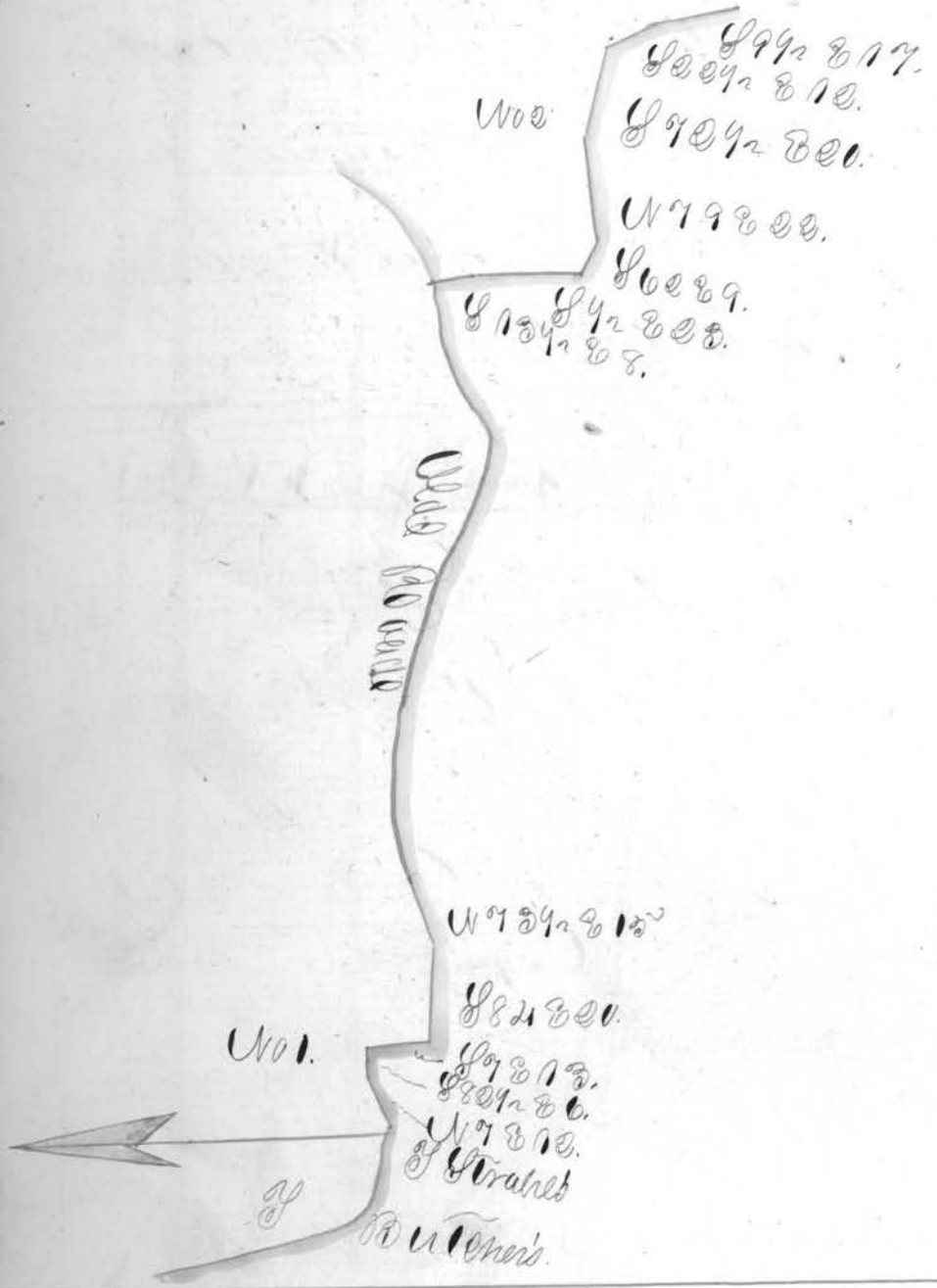

That of a road beginning on the road from  
 the forks of Captina to Cemetery and ends  
 in the road from Captina to Monroe City  
 line as surveyed by Thomas Lewis. A.D. 1838

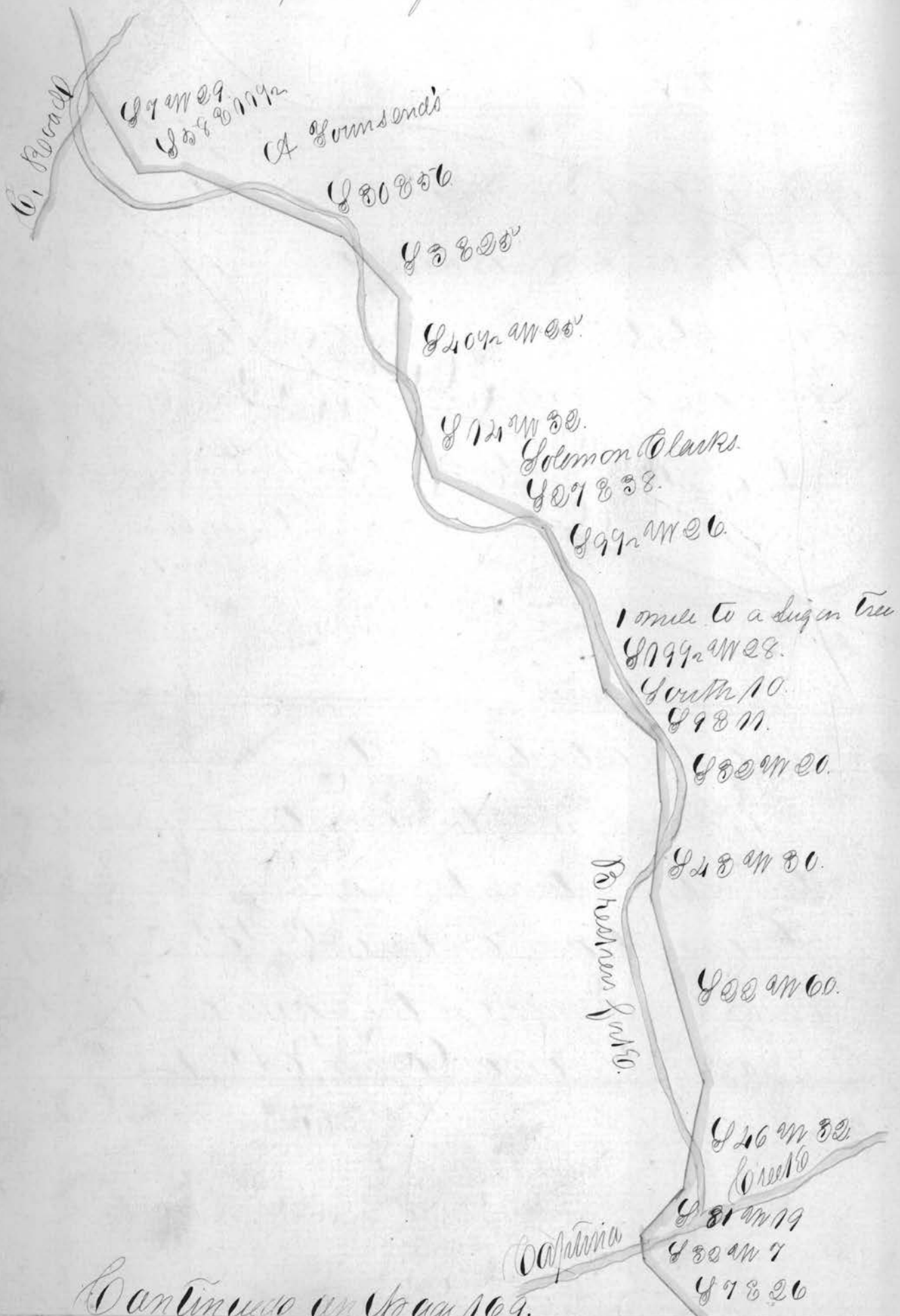

Continued on page 109.

Continued from page 108.



That of an alteration on the road from  
 the forks of Capstun to Hemerton, beginning  
 where the Woods fence crosses the same, and  
 ends on the same at Spencer Smith's mill  
 as surveyed by Thomas Lewis A.D. 1838

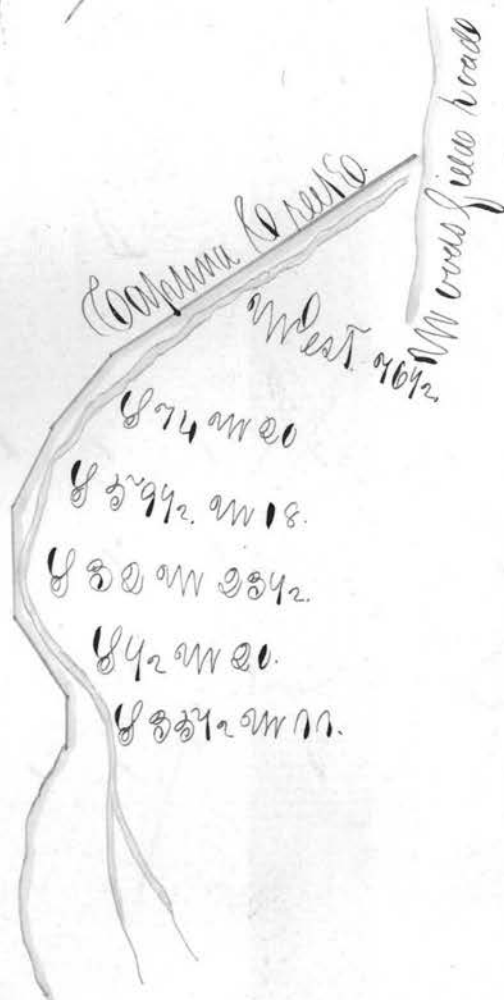

Plat of a road beginning on the old road  
 from the Mill belonging to heirs of Morgan  
 Gilliland to the Turnpike, and intersects the  
 national road at Samuel Dennis as sur-  
 veyed by Jesse C. Sangill A.D. 1833

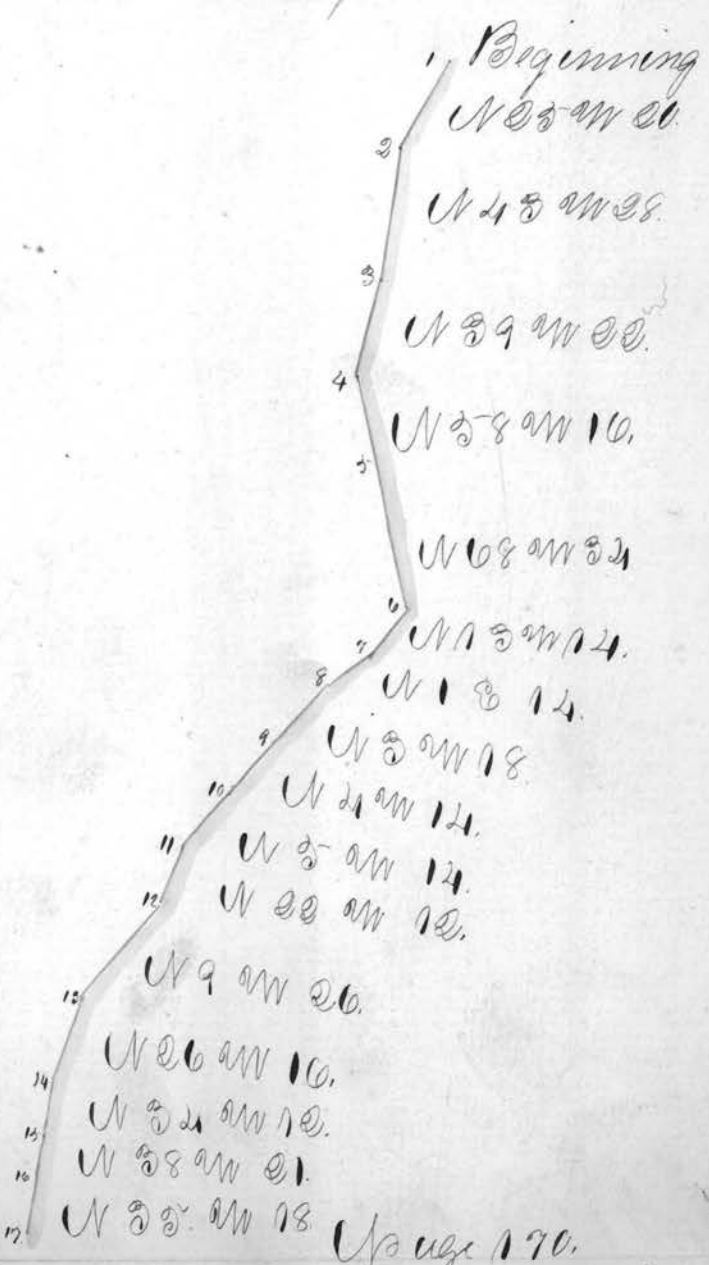

Continued on Page 170.