

Continued from page 59

N 28 1/2 E 54

N 13 E 48

To Barnesville

Line of Bell =
Montgomery County

Plat of a road beginning on the road from
 Boston to Somerton and terminates in the
 State road from Barnesville to Boston as
 Surveyed by Thomas Lewis A.D.

State road from Barnesville to Boston

Bound 4000 lbs.

64 N 85 1/2 W 28.
 63 N 48 1/2 E 18.
 62 N 15 W 9.
 61 N 35 W 10.
 60 N 54 W 7.
 59 N 67 W 14.

58 N 89 W 20.
 57 N 69 1/2 W 8.

56 N 63 W 18.
 55 N 89 W 11.

54 N 81 W 20.

53 N 75 W 30.

4 miles to a brook

52 N 64 W 28.

51 N 40 1/2 W 50.
 John Cates.

50 N 35 W 40.

49 N 38 1/2 W 34.

48 N 34 W 34.

47 N 31 W 17.

46 N 35 W 27.

Continued on page

61.
 45 N 39 W 27

Continued from page 60

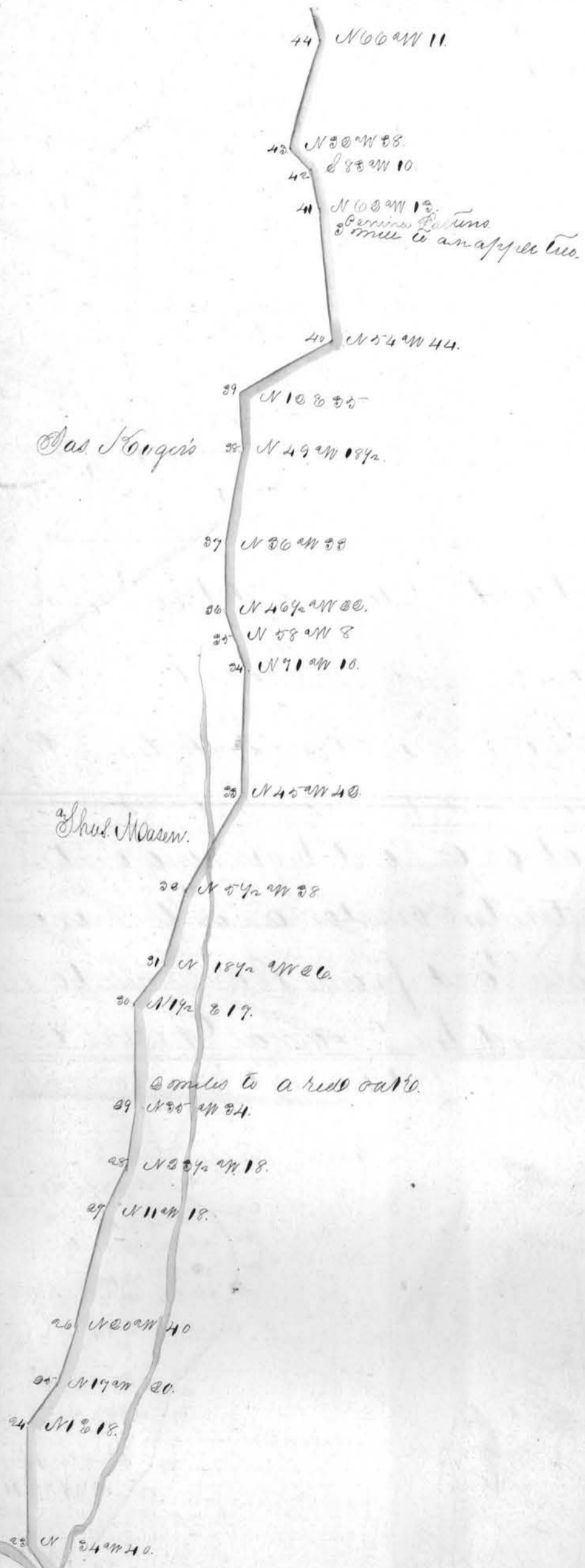

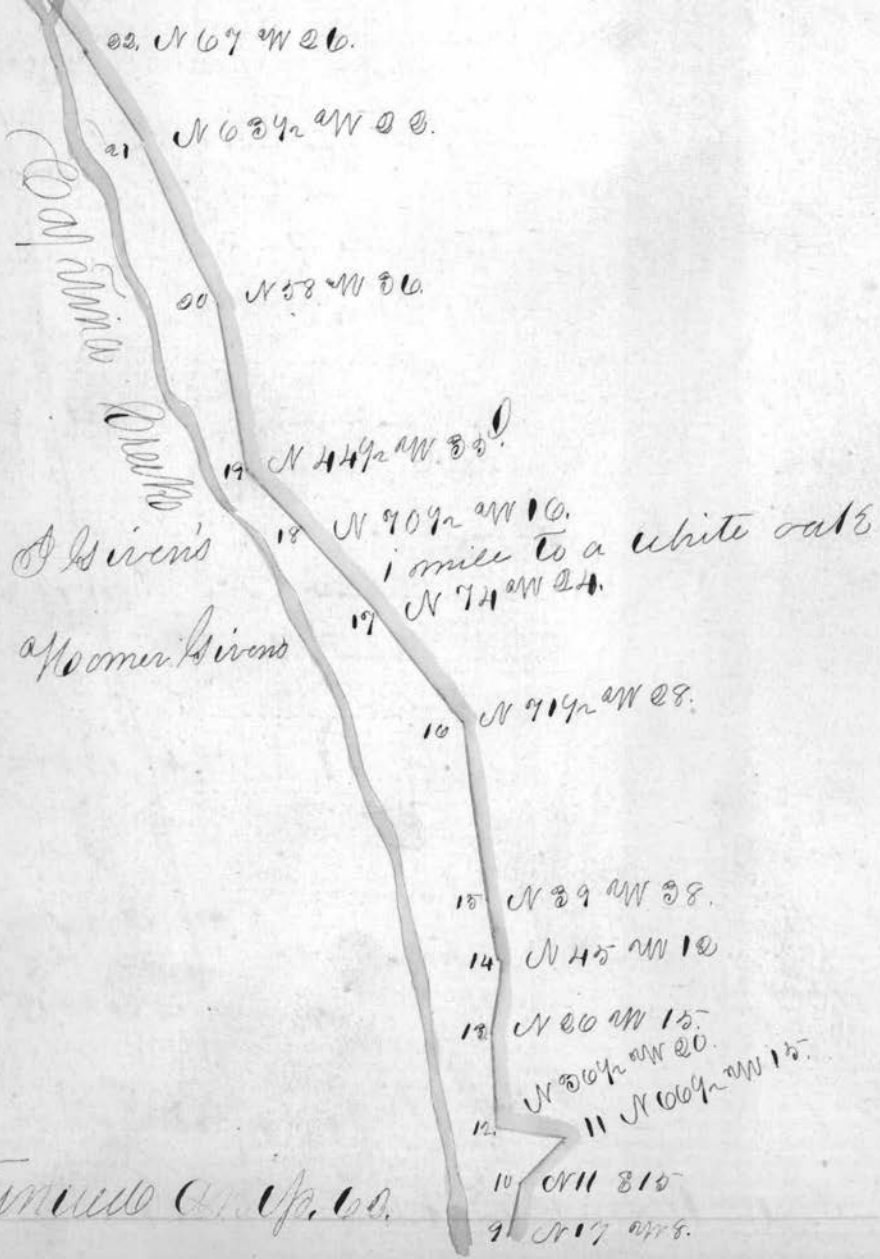

To Antineau Camp, Co.

Continued from page 61.

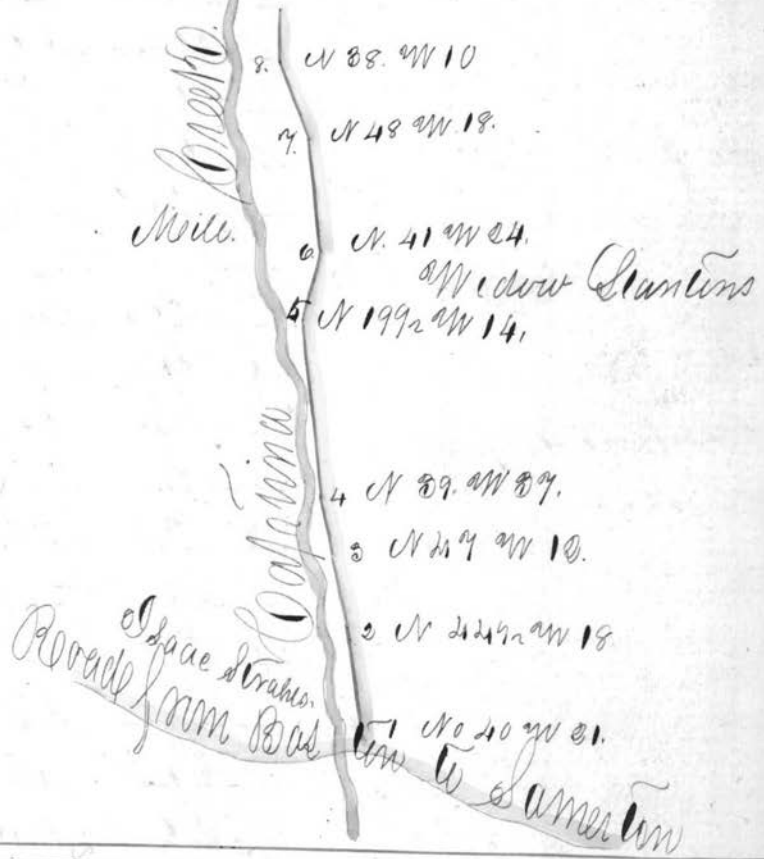

Mill.

Dredge

Duffin

Edge Strata Road from Bar to Lamer ton

Plot of The State road beginning at Summer-
 set in Perry Co. running thence to the Ohio
 river opposite Elizabeth town Virginia
 as surveyed by Jas. C. Moore A.D. 1834

The Courses Dist

1	S 89 1/2 E	53.41	chains
2	S 65 1/2 E	6.16	
3	S 73 1/2 E	10.60	
4	S 83 1/2 E	10.89	1 mile
1	S 88 1/2 E	9.92	
3	S 86 1/4 E	9.92	
3	S 54 E	4.80	
4	S 68 1/4 E	3.12	
5	N. 73 E	4.78	
6	East	31.00	
7	S 60 E	15.00	3 miles
1	S 60 E	3.90	
2	S 80 E	10.39	
3	S 87 1/2 E	30.09	
4	S 24 1/4 E	11.06	
5	S 24 E	31.30	
6	S 31 1/2 E	7.35	
7	S 68 1/2 E	4.51	3 miles
1	S 68 1/2 E	3.00	
3	S 87 1/2 E	21.38	
3	S 69 E	5.90	
4	S 25 1/2 E	10.08	
5	S 51 E	10.07	
6	S 24 E	4.50	
7	S 21 E	6.98	
8	S 3 W	21.00	
9	S 37 1/2 E	21.25	
10	S 31 1/4 E	9.50	
11	S 39 E	8.39	1/2 miles
1	S 39 E	15.15	
3	S 77 1/4 E	30.07	
3	S 85 1/2 E	36.81	1/2 miles
4	S 70 1/4 E	10 1/2	a Ches Nut Stamp 1/2 miles
5	S 63 1/2 E	7.55	5 miles

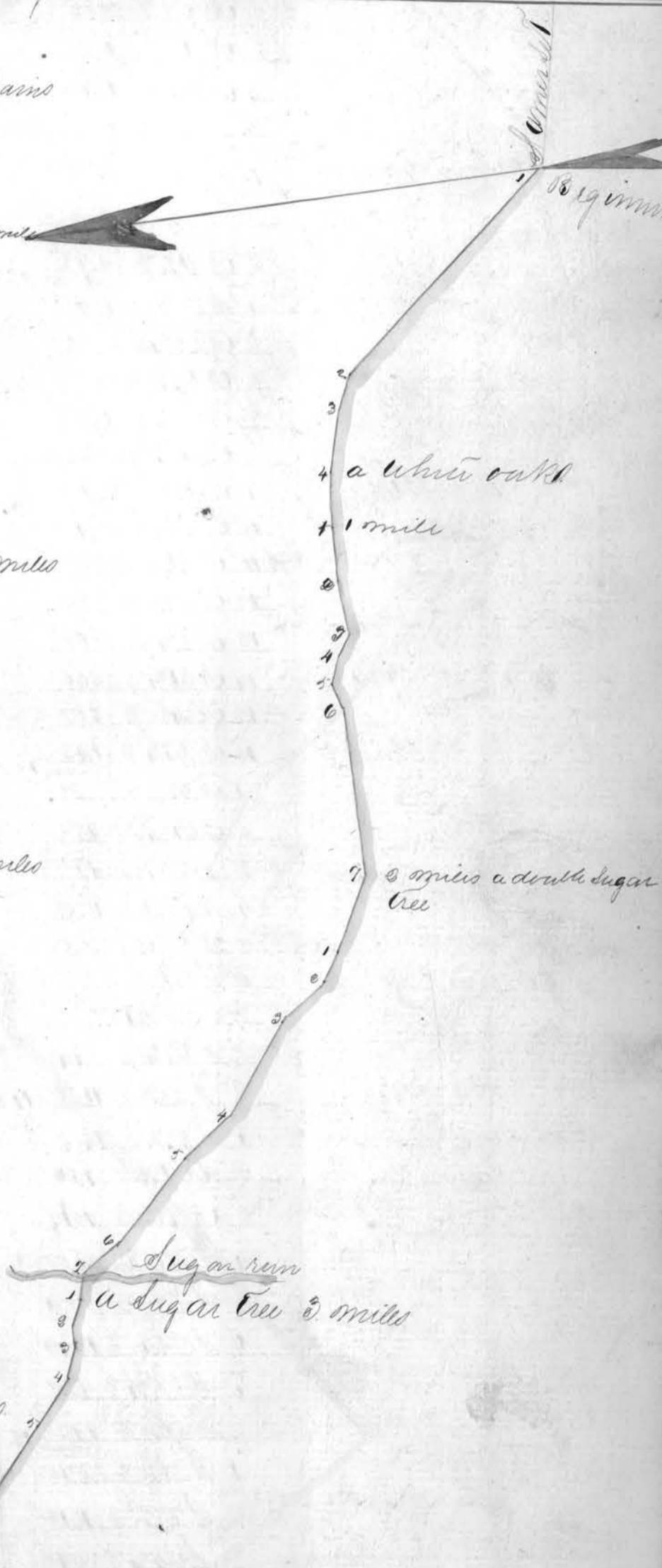

Continued on page 68.

Continued from page 67

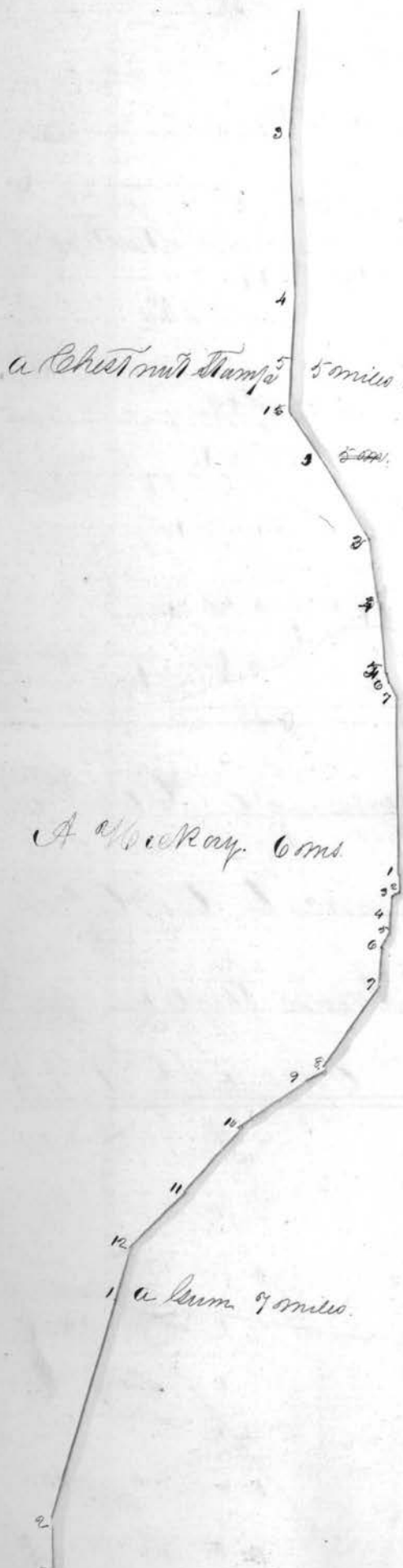

1	S 89 1/4 E	7.55	
2	N 87 1/4 E	15.10	
3	S 65 1/2 E	9.57	
4	S 64 E	12.00	
5	S 84 E	2.02	
6	S 74 E	5.89	
7	S 61 1/4 E	38.00 21.00	6 miles
1	S 61 1/4 E	3.87	
2	S 84 E	1.42	
3	S 89 1/2 E	2.20	
4	S 57 1/2 E	2.79	
5	S 50 1/2 E	2.85	
6	S 56 1/4 E	3.88	
7	S 27 E	15.80	
8	S 17 1/2 E	4.09	
9	S 6 E	12.41	
10	S 30 E	12.20	
11	S 10 E	10.14	
12	N 25 1/4 E	2.72 20.00	7 miles
1	S 45 1/4 E	41.29	
2	S 60 1/2 E	7.28	
3	S 70 E	12.29	
4	East	10.00	
5	N 61 E	5.84 20.00	8 miles
1	N 61 E	6.00	
2	N 82 E	22.58	
3	N 81 E	12.20	
4	N 74 1/2 E	10.42	
5	S 89 E	15.78 20.00	9 miles
1	S 70 1/2 E	4.00	
2	S 80 1/2 E	5.76	
3	N 81 1/4 E	2.93	
4	S 80 E	10.92	
5	N 56 1/4 E	2.05	
6	N 29 1/2 E	9.28	

Rochester W.
 1000
 1
 2
 3
 4
 5
 6
 7
 8
 9
 10
 11
 12
 13
 14
 15
 16
 17
 18
 19
 20
 21
 22
 23
 24
 25
 26
 27
 28
 29
 30
 31
 32
 33
 34
 35
 36
 37
 38
 39
 40
 41
 42
 43
 44
 45
 46
 47
 48
 49
 50
 51
 52
 53
 54
 55
 56
 57
 58
 59
 60
 61
 62
 63
 64
 65
 66
 67
 68
 69
 70
 71
 72
 73
 74
 75
 76
 77
 78
 79
 80
 81
 82
 83
 84
 85
 86
 87
 88
 89
 90
 91
 92
 93
 94
 95
 96
 97
 98
 99
 100

7	N 87 1/4 E	6.65
8	N 25 1/2 E	8.90
9	N 19 E	5.19
10	N 5 1/2 W	2.45
11	N 3 1/2 E	2.78
12	N 33 1/2 W	3.29
13	N 7 1/4 E	2.08
14	N 21 1/4 E	2.00
15	N 24 E	2.07
16	N 37 1/4 E	1.49
17	N 57 1/4 E	1.85
18	N 57 1/4 E	1.72
19	N 80 1/2 E	1.80
20	N 80 1/2 E	10.27
21	N 70 1/2 E	21.00
22	N 57 1/2 E	8.28
23	N 76 E	9.00
24	N 57 1/4 E	8.94
25	N 78 1/2 E	11.88
26	N 78 1/2 E	6.87
27	N 81 1/4 E	1.50
28	N 78 1/4 E	10.17
29	N 80 E	11.00
30	N 60 E	8.04
31	N 85 1/2 E	10.48
32	N 88 1/4 E	9.48
33	N 85 1/2 E	19.00
34	N 85 1/2 E	2.90
35	N 78 1/2 E	10.15
36	N 61 1/4 E	5.95
37	N 36 1/4 E	10.89
38	N 76 E	12.23
39	N 88 1/4 E	10.00
40	N 79 1/2 E	5.00

2 Sugar, 9 miles

10 miles

11 miles

Dec 10.

Sum 11 ms.

Continued on 64

Continued from page 03

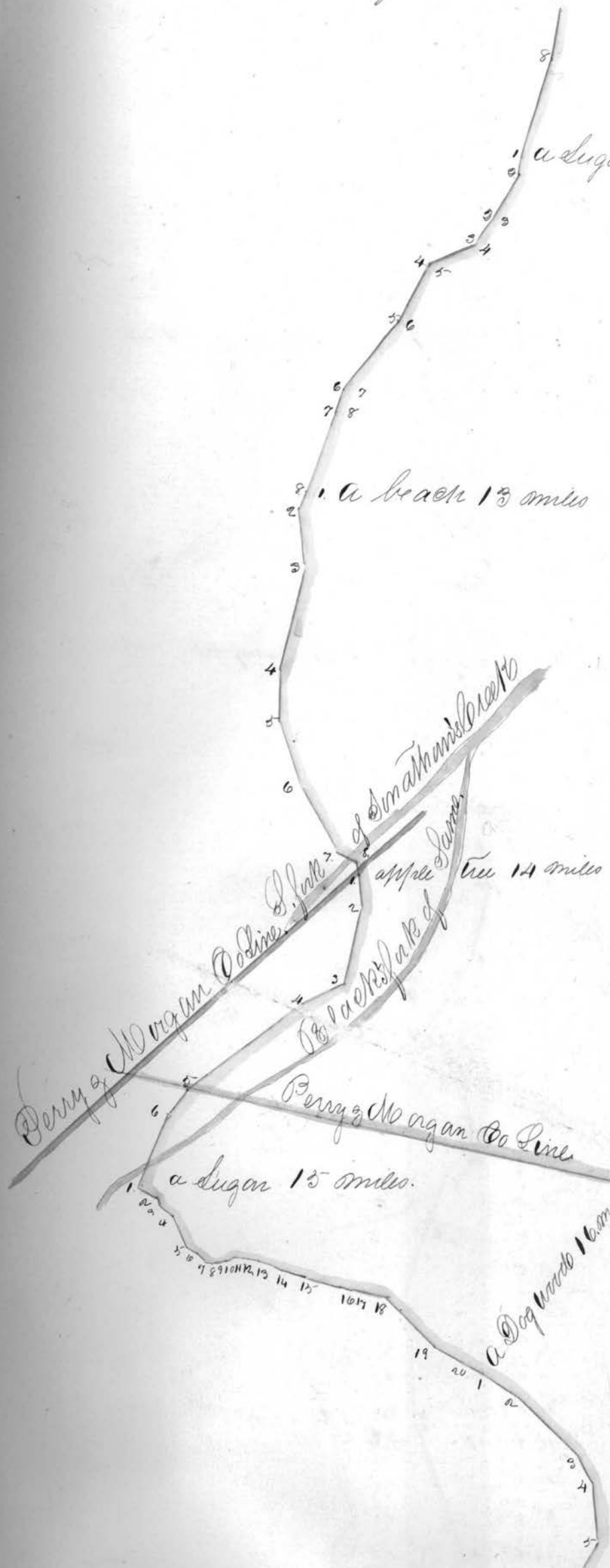

8.	S 80 8	$\frac{1960}{80.00}$	10
8	S 80 8	$\frac{1637}{80.00}$	12
1	S 80 8	346	
2	N 75 4 8	10.82	
3	S 89 4 8	30.62	
4	N 76 4 8	10.65	
5	N 59 4 8	12.12	
6	N 48 8	15.36	
7	N 14 8	4.65	
8	N 72 8	$\frac{2.52}{80.00}$	14
1	N 72 8	6.62	
2	S 89 4 8	15.50	
3	S 33 4 8	8.74	
4	S 48 4 8	38.27	
5	S 69 4 8	5.20	
6	S 79 4 8	$\frac{15.57}{80.00}$	12
1	N 80 8	4.14	
2	S 32 4 8	1.51	
3	N 75 8	3.00	
4	S 75 8	6.44	
5	N 79 8	1.22	
6	N 79 4 8	2.40	
7	N 59 8	1.27	
8	N 33 4 8	3.39	
9	N 27 8	1.22	
10	N 31 8	1.18	
11	N 44 8	2.51	
12	N 46 8	2.18	
13	N 69 4 8	2.91	
14	N 50 4 8	2.77	
15	N 38 4 8	7.09	
16	N 03 8	2.88	
17	N 46 4 8	6.77	

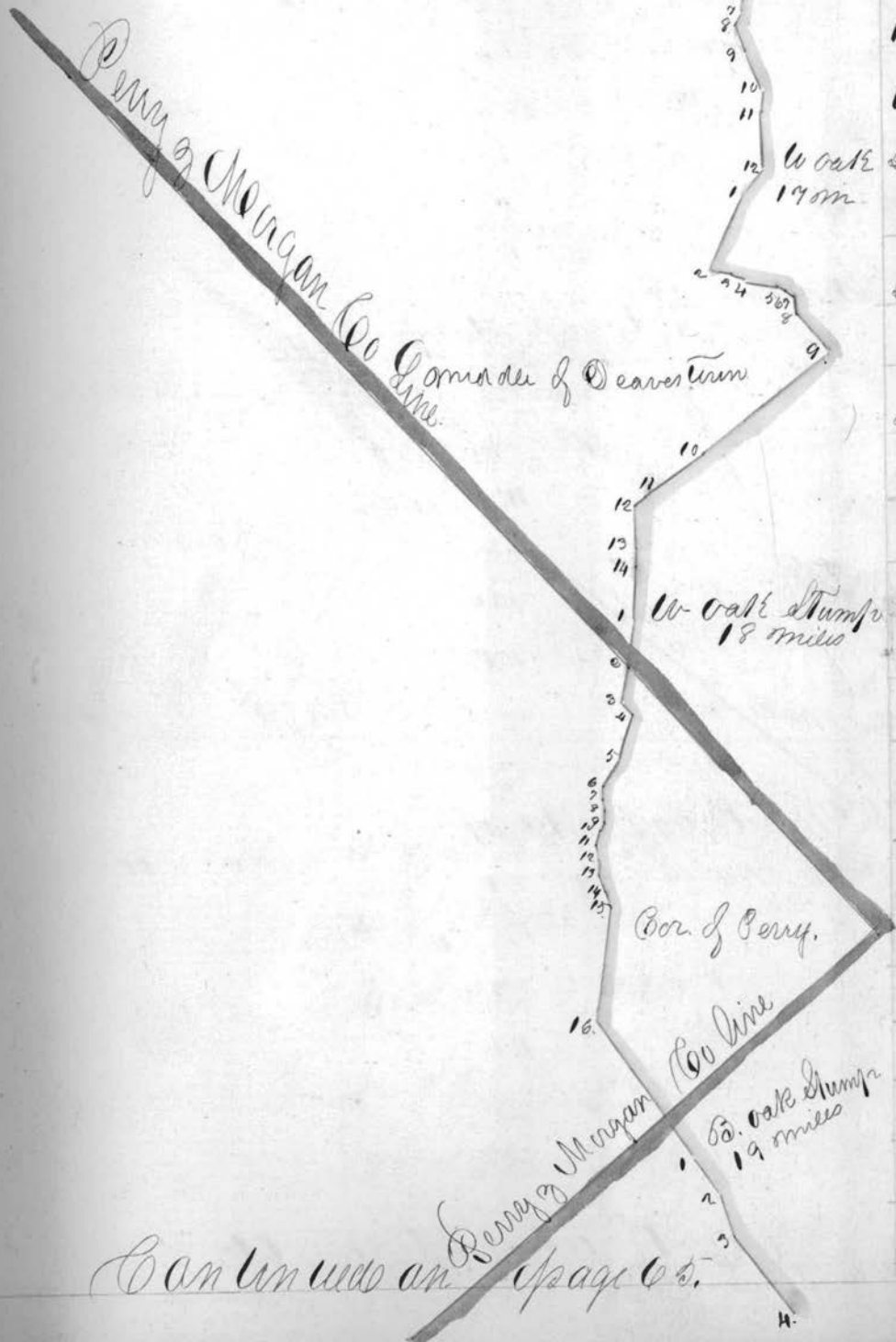

18	N 89 1/2 E	1300
19	N 60 E	912
20	N 73 1/2 E	399
		80.00
1	N 73 1/2 E	8.10
2	N 82 1/2 E	19.00
3	S 71 E	5.30
4	S 55 E	11.40
5	S 50 1/2 E	9.08
6	S 46 1/2 E	1.90
7	S 31 E	0.00
8	S 66 E	2.88
9	S 79 1/2 E	0.12
10	S 55 E	3.70
11	S 45 E	9.15
12	S 87 1/4 E	2.57
		80.00
1	S 90 1/2 E	10.00
2	N 45 E	0.50
3	N 53 E	0.39
4	N 60 1/2 E	4.00
5	N 65 E	1.50
6	S 88 E	1.50

Can be used on page 65.

Continued from page 64

7	S 69 1/4 E	2.80
8	S 89 1/2 E	6.00
9	S 1 N W	23.50
10	S 69 1/2 W	11.00
11	S 51 E	1.59
12	S 10 1/2 E	6.00
13	S 83 1/4 E	1.96
14	S 13 1/4 E	3.00
		<u>21.00</u>
1	S 13 1/4 E	6.00
2	S 35 1/2 E	4.87
3	N 88 E	0.03
4	S 89 1/4 E	6.04
5	S 12 1/2 E	8.84
6	S 43 1/2 E	1.70
7	S 63 E	1.04
8	S 54 1/4 E	1.14
9	S 30 1/2 E	1.55
10	S 89 1/4 E	2.19
11	S 57 E	0.14
12	S 83 1/2 E	1.87
13	S 63 1/4 E	2.80
14	S 80 1/2 E	2.93
15	S 11 1/2 E	15.87
16	S 83 E	16.82

Same		6.59
		<u>20.00</u>
1	S 83 E	6.00
2	S 71 1/4 E	0.50
3	S 87 E	14.00
4	N 63 1/4 E	14.20
5	S 83 1/4 E	7.80
6	S 00 E	10.17
7	S 13 1/2 E	13.04
8	S 14 1/4 E	7.07
		<u>50.00</u>
1	S 14 1/4 E	2.00
2	South	18.00
3	S 35 E	13.10
4	S 30 E	10.50
5	S 12 1/2 E	14.20
6	S 69 1/4 E	7.00
7	N 86 E	0.37
8	N 97 1/2 E	5.31

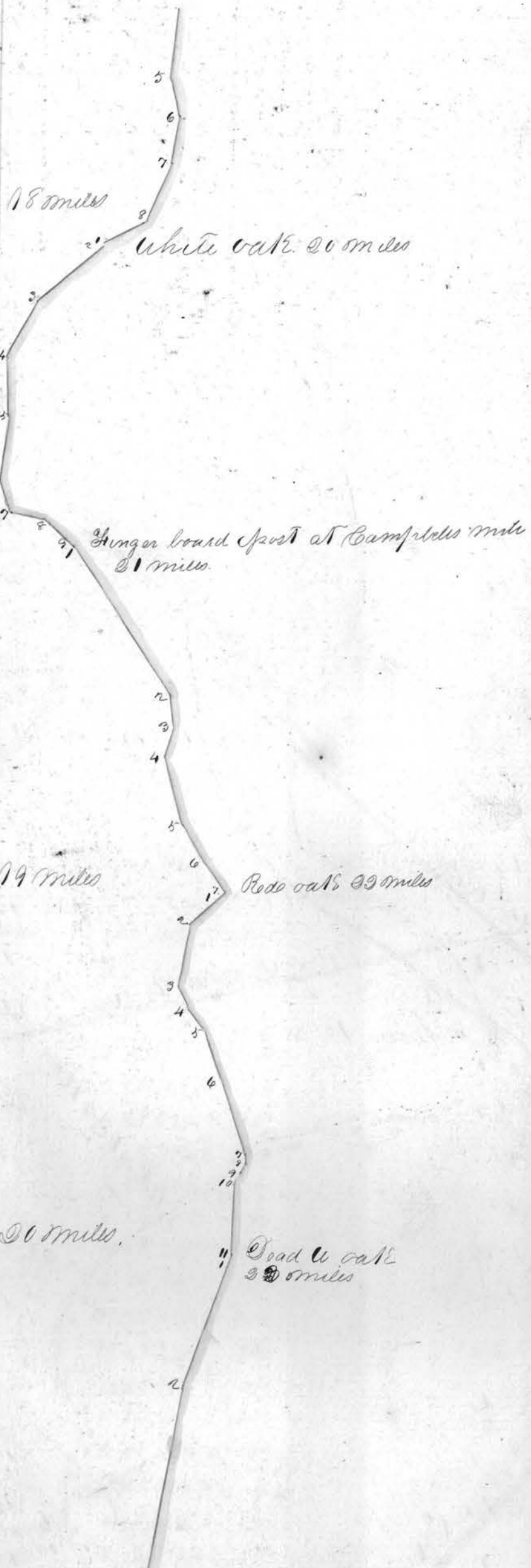

9	\$ 85 1/4	8	820
1	\$ 88 1/2	8	8000
3	\$ 52	8	0.81
3	\$ 83 1/4	8	0.59
4	\$ 05 3/4	8	12.07
5	\$ 77 1/2	8	8.50
6	\$ 81 1/4	8	7.50
7	\$ 8 1/4	8	95.00
1	\$ 8 1/4	8	8.80
2	\$ 40 1/2	8	12.41
3	\$ 04 3/4	8	4.08
4	\$ 8 1/2	8	2.65
5	\$ 70 1/4	8	10.00
6	\$ 67 1/4	8	17.36
7	\$ 13 1/4	8	1.89
8	South		1.57
9	\$ 15 1/2	8	2.50

21 miles

1 White oak Swamp
2 1/4 miles

31 miles

White oak Swamp
2 1/2 miles

Continued on Page 66

Continued from page 65

10 S 178	14.86
11 S 208	1.61
1 S 308	37.59
2 S 398	39.07
3 S 399	13.24
1 S 398	4.00
2 S 304	36.50
3 S 394	8.12
4 S 184	14.09
5 S 414	4.43
6 S 484	8.38
7 S 158	9.01
1 S 138	4.30
2 S 109	3.16
3 S 88	0.14
4 S 71	1.65
5 S 88	1.09
6 S 80	3.33
7 S 89	0.90
8 S 71	3.96
9 N 21	1.40
10 N 43	16.88
11 S 70	2.50
12 S 33	0.09
13 S 01	1.01
14 S 76	.04
15 N 80	0.90
16 N 43	4.93
17 N 86	10.77
18 S 70	0.58
19 N 78	0.09

0.3 miles

0.4 miles

0.5 miles



White oak 27 miles

28 miles Cherry tree

16 S 608	0.38
17 S 548	3.12
18 S 692	1.70
19 S 554	0.50
20 S 614	0.50
21 S 778	3.54
22 N 864	0.75
23 S 604	0.10
1 S 634	7.90
2 S 548	3.00
3 S 594	0.50
4 S 464	4.09
5 S 318	8.11
6 S 338	10.60
7 S 384	4.30
8 S 214	0.77
9 S 548	5.50
10 S 384	1.03
11 S 654	0.09
12 S 564	5.59
13 S 658	3.09
14 N 892	7.04
15 N 642	3.30
1 N 642	1.50
2 N 594	14.39
3 S 898	5.50
4 N 808	4.79
5 N 608	0.81
6 S 542	8.04
7 N 754	4.04
8 N 494	0.71

0.7 miles

0.8 miles

20 U 80 1/2 2.47

21 U 80 2 2.79

22 U 80 1/2 2.14 20 miles

1 U 80 1/2 2.48

2 U 80 2 1.90

3 U 79 2 2.14

4 U 76 2 0.99

5 S 81 1/2 2.18

6 S 85 1/2 2.10

7 S 89 2 2.59

8 East 2.20

9 S 70 1/2 2.00

10 U 66 1/2 1.50

11 U 68 1/2 2.48

12 U 61 1/2 8.90

13 U 89 1/2 9.30

14 S 81 2 0.50

15 U 66 1/2 1.71

29 miles a Beach.

30 miles a Beach.

9 U 81 1/2 2.90

10 S 90 1/2 2.14

11 S 80 1/2 2.95

12 U 75 1/2 2.10

13 S 84 1/2 2.90

14 S 70 2 2.90

15 S 86 2 2.70

16 U 85 1/2 2.80

17 S 79 1/2 2.76 2.90
5000

1 S 79 1/2 2.74

2 U 80 1/2 2.00

3 U 77 1/2 2.85

4 U 71 1/2 0.64

5 S 72 2 1.00

6 S 87 1/2 2.81

7 U 84 1/2 2.56

8 S 78 2 2.54

9 S 65 1/2 2.91

10 S 81 1/2 2.08

11 S 88 1/2 14.00

12 S 66 2 11.00

13 S 79 1/2 2.65

14 S 83 1/2 2.70 2000

Continued on page 67

Continued from page 66

1	S 77° E	250	17	N 53 1/2° E	100	12	N 30 1/2° W	242
2	S 94 1/2° E	150	18	N 71° E	134	13	N 9° W	298
3	S 61 1/4° E	116	1	N 71° E	20	14	N 16° E	213
4	S 65 1/4° E	55	2	N 63° E	190	15	N 51 1/4° E	600
5	S 74 1/4° E	194	3	N 37° E	151	16	N 85 1/4° E	210
6	S 78 1/2° E	213	4	N 24 1/2° W	197	17	N 69 1/4° E	120
7	S 82 1/4° E	210				18	N 48 1/4° E	350
8	N 86° E	324				19	N 23 1/2° E	250
9	S 83 1/2° E	153				20	N 57 1/4° E	837
10	N 83 1/4° E	137						8000
11	N 83° E	154				1	N 20 1/2° E	200
12	S 88 1/4° E	308				2	N 16 1/2° E	1015
13	S 81 1/2° E	210				3	N 41° E	774
14	N 81 1/4° E	211				4	N 40 1/2° E	494
15	N 25 1/4° E	160				5	North	1101
16	N 31 1/4° E	71				6	N 8° E	732
17	N 21 1/4° E	208				7	N 57 1/2° W	834
18	N 88 1/4° E	978				8	N 67 1/2° E	207
19	S 88 1/4° E	2118				9	N 86 1/4° E	242
20	N 33 1/4° E	895				10	S 63° E	1030
21	N 85 1/4° E	292				11	S 53° E	268
22	N 85 1/4° E	1050				12	N 36 1/2° E	128
						13	N 28 1/4° E	193
						14	N 84° E	196
						15	N 23° E	207
						16	N 10 1/2° E	119
						1	N 16 1/2° E	124



1 U 8 3/4 8 60

2 U 8 9/16 8 1808

3 U 1 8 916

4 U 5 7/16 8 857

5 U 8 5/16 8 1135

6 U 2 6 1/2 W 990

7 U 1/2 W 099

8 U 5 3/16 8 380

9 U 3 7/16 8 183

10 U 8 5/16 8 161

11 U 6 8 219

12 U 1 1 1/2 W 165

13 U 1 0 1/2 8 133

14 U 3 0 1/2 8 140

15 U 2 2 1/2 8 173

16 U 0 7 8 148

3 1/2 miles

Arm Creek

3 1/2 miles

5 U 8 6 1/2 8 190

6 U 8 3 1/2 8 227

7 U 4 8 8 307

8 U 7 8 8 600

9 U 0 5 8 1509

10 U 1 4 8 276

11 U 2 5 1/4 8 225

2 U 1 8 1/2 8 176

3 U 7 1/2 8 374

4 U 5 4 8 324

5 U 7 5 8 544

6 U 7 6 1/2 8 463

7 U 4 1/2 8 156

8 U 1 0 1/2 8 173

9 U 9 1/4 8 213

10 U 2 8 8 293

11 U 2 5 8 521

12 U 3 1 1/2 8 590

13 U 3 7/16 8 1304

14 U 3 1/4 8 454

15 U 9 3/4 8 778

16 U 1 1/4 W 698

17 U 3 7 8 763 3 1/2 m.

Continued on page 68.

Continued from page 67

Run	Courses	Dist				
1	N 37 E	2,38	Chain	7	N 77 W	1,69
2	N 70 1/2 E	6,28		8	N 31 1/2 E	1,59
3	N 81 E	4,68		9	N 70 E	1,43
4	N 56 1/2 E	4,91		10	S 86 1/2 E	1,37
5	N 37 1/2 E	3,47		11	N 68 1/2 E	1,83
6	N 53 1/2 E	6,03		12	N 61 1/2 E	1,51
7	N 24 1/2 E	2,65		13	N 65 1/2 E	2,92
8	N 31 E	4,00		14	N 66 1/2 E	2,28
9	N 68 1/2 E	4,50		14		210 m
10	N 71 1/2 E	1,52		1	N 66 1/2 E	1,53
11	S 11 E	3,06		2	N 69 1/2 E	1,58
12	S 7 W	1,31		3	S 30 1/2 E	1,90
13	S 49 E	1,00		4	S 74 E	1,48
14	S 66 1/2 E	1,08		5	N 62 1/2 E	1,82
15	S 82 1/2 E	1,33		6	N 53 E	1,58
16	N 88 E	1,35		7	N 68 1/2 E	1,79
17	S 79 1/2 E	1,78		8	N 78 1/2 E	2,03
18	S 86 1/2 E	1,18		9	S 88 1/2 E	2,10
19	N 77 E	1,63		10	N 79 1/2 E	1,88
20	N 57 1/2 E	3,40		11	N 15 E	1,41
21	N 24 1/2 E	6,40		12	N 69 E	3,72
22	N 53 1/2 E	1,15	30 m	13	N 62 1/2 E	6,58
1	N 53 1/2 E	1,30		14	N 39 1/2 E	8,45
				15	N 66 1/2 E	9,42

19 U 77 E 763
 20 U 77 1/2 E 840
 21 U 29 1/2 E 640
 22 U 59 1/2 E 115 36m
 1 U 59 1/2 E 340
 2 U 26 1/2 E 380
 3 U 23 1/2 E 2288
 4 East 2100 37m
 1 East 1450
 2 P 60 1/4 E 967
 3 P 44 1/2 E 990
 4 P 64 E 290
 5 P 50 1/4 E 384
 6 P 64 1/2 E 671
 7 P 89 1/2 E 1390
 8 U 37 E 320
 9 U 40 E 677
 10 U 68 1/4 E 716 38m
 1 U 68 1/4 E 940
 2 P 89 1/2 E 2530
 3 P 83 1/2 E 917
 4 P 69 E 740
 5 P 31 1/4 E 190
 6 P 57 E 239
 7 P 71 E 229
 8 P 77 1/4 E 413
 9 U 65 1/4 E 371
 10 U 55 1/4 E 394
 11 U 44 1/2 E 364
 12 U 64 1/4 E 291
 13 U 67 E 210
 14 P 78 1/4 E 132 39m
 1 P 73 1/4 E 403
 2 U 73 E 3321
 3 U 59 E 854
 4 U 63 E 980
 5 U 36 E 632
 6 U 20 1/2 E 218

11 U 158 741
 12 U 69 E 372
 13 U 24 E 658
 14 U 39 1/2 E 845
 15 U 60 1/2 E 942
 16 U 34 E 210
 17 U 16 E 210
 18 U 56 1/2 E 318
 19 U 37 1/2 E 247
 20 U 28 1/4 E 145
 21 U 40 1/2 E 147
 22 U 84 E 137
 23 U 43 1/4 W 198
 24 U 49 W 180
 25 U 34 W 132
 26 U 73 E 140
 27 U 79 E 280
 28 U 62 E 215 41m
 1 U 62 E 46
 2 U 70 E 254
 3 U 56 1/2 E 300
 4 U 37 1/4 E 317
 5 U 60 E 129
 6 U 54 E 148
 7 U 54 1/2 E 265
 8 U 23 1/2 E 228
 9 U 33 1/4 E 323
 10 U 77 E 300
 11 U 3 1/2 E 163
 12 U 19 1/4 W 816
 13 U 3 1/4 E 729
 14 U 40 1/2 E 248

Continued on page 69

69 Continued from page 69

15	U 119 1/2 E	8,09
10	U 90 E	2,95
19	U 20 1/2 E	3,83
18	U 2 1/2 E	2,70
19	U 8 1/2 NW	3,65
20	U 14 1/2 NW	2,07
21	U 16 1/2 E	7,88
22	U 5 1/2 E	4,76
23	U 13 NW	2,92
1	Same	6,03
2	U 15 NW	11,04
3	U 8 NW	8,30
4	U 2 1/2 E	6,90
5	U 20 E	7,63
6	U 30 E	4,30
7	U 50 1/2 E	6,68
8	U 39 E	3,07
9	U 47 1/2 E	2,00
10	U 39 E	4,24
11	U 42 E	3,38
12	U 41 1/2 E	3,50
13	U 28 E	2,21
14	U 24 E	3,50
15	U 14 E	2,90
1	U 14 1/2 E	0,50
2	U 2 1/2 E	4,00
3	U 24 1/2 E	2,12
4	U 6 E	2,08
5	U 9 1/2 NW	3,75
6	U 30 1/2 E	8,48
7	U 8 1/2 E	2,70
8	U 68 E	3,95
9	U 7 1/2 E	6,33
10	U 88 1/2 E	3,82
11	U 8 1/2 E	3,84
12	U 60 1/2 E	6,00
13	U 48 1/2 E	3,50
14	U 63 E	3,54
15	U 50 E	3,92
16	U 8 1/2 E	3,29
17	U 7 1/2 E	9,30
18	U 54 1/2 E	1,68
1	Same	3,02
2	U 83 1/2 E	4,13
3	U 70 1/2 E	2,41
4	U 50 1/2 E	2,76

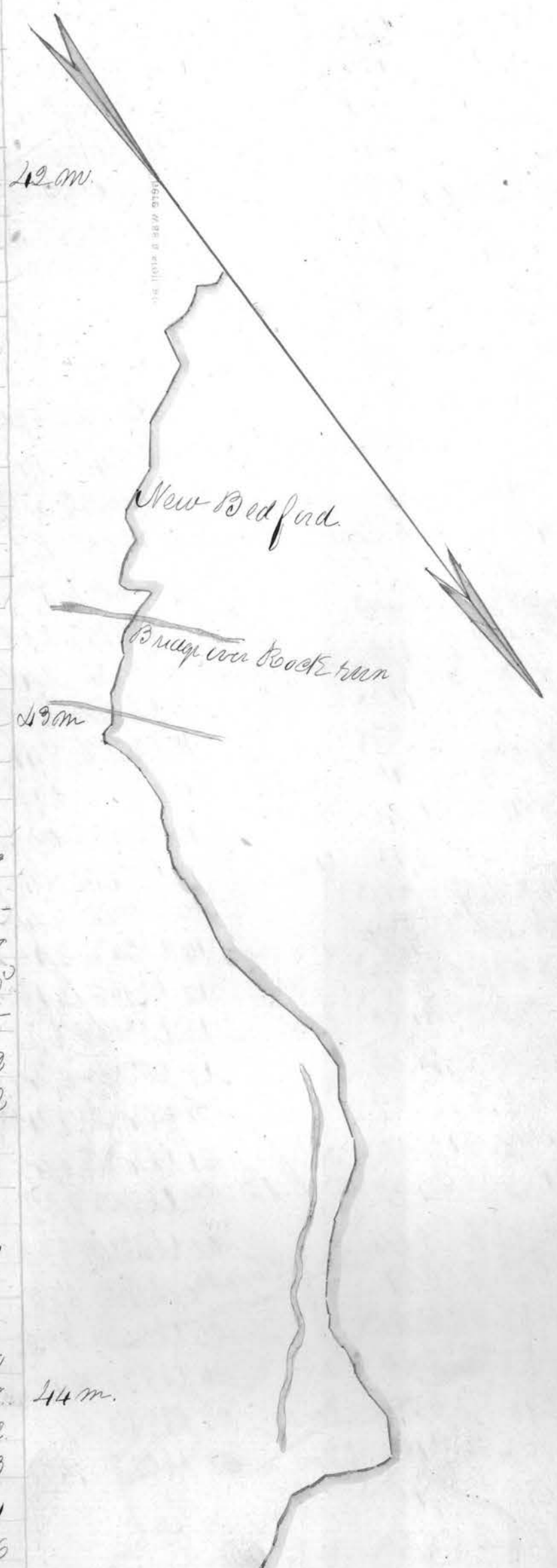

5 J 184.8 2.62
 6 J 51 8 2.50
 7 J 95 8 2.11
 8 J 604.8 2.07
 9 J 2174.8 1.93
 10 J 494.8 2.41
 11 J 42 8 1.78
 12 J 51 8 3.05
 13 J 874.8 1.76
 14 J 674.8 1.99
 15 U 50 8 .76
 16 U 24 8 1.17
 17 U 64.8 1.00
 18 U 24.8 2.08
 19 U 554.8 2.71
 20 U 67 8 16.27
 21 U 86 8 3.10
 22 U 50 8 2.20

13/14 on mens side of group room

23 U 264.8 1.78	7 U 774.8 3.24
24 U 194.8 1.75	8 J 68 8 1.50
25 U 724.8 2.00	9 J 404.8 2.59
26 U 21 8 1.70	10 J 82 8 4.02
27 U 497.8 2.08	11 U 594.8 6.83
28 U 87 8 1.66	12 U 294.8 5.81
29 J 764.8 .88	13 U 59 8 3.70
1 Same .71	14 U 604.8 3.13
2 J 644.8 2.55	15 U 59 8 5.43
3 J 874.8 3.32	16 U 50 8 4.26
4 J 85 8 1.63	17 U 444.8 3.39
5 J 65 8 1.54	18 U 824.8 2.64
6 J 75 8 2.13	19 J 784.8 10.05

45m